

EXISTING EQUINOX 9:00 AM

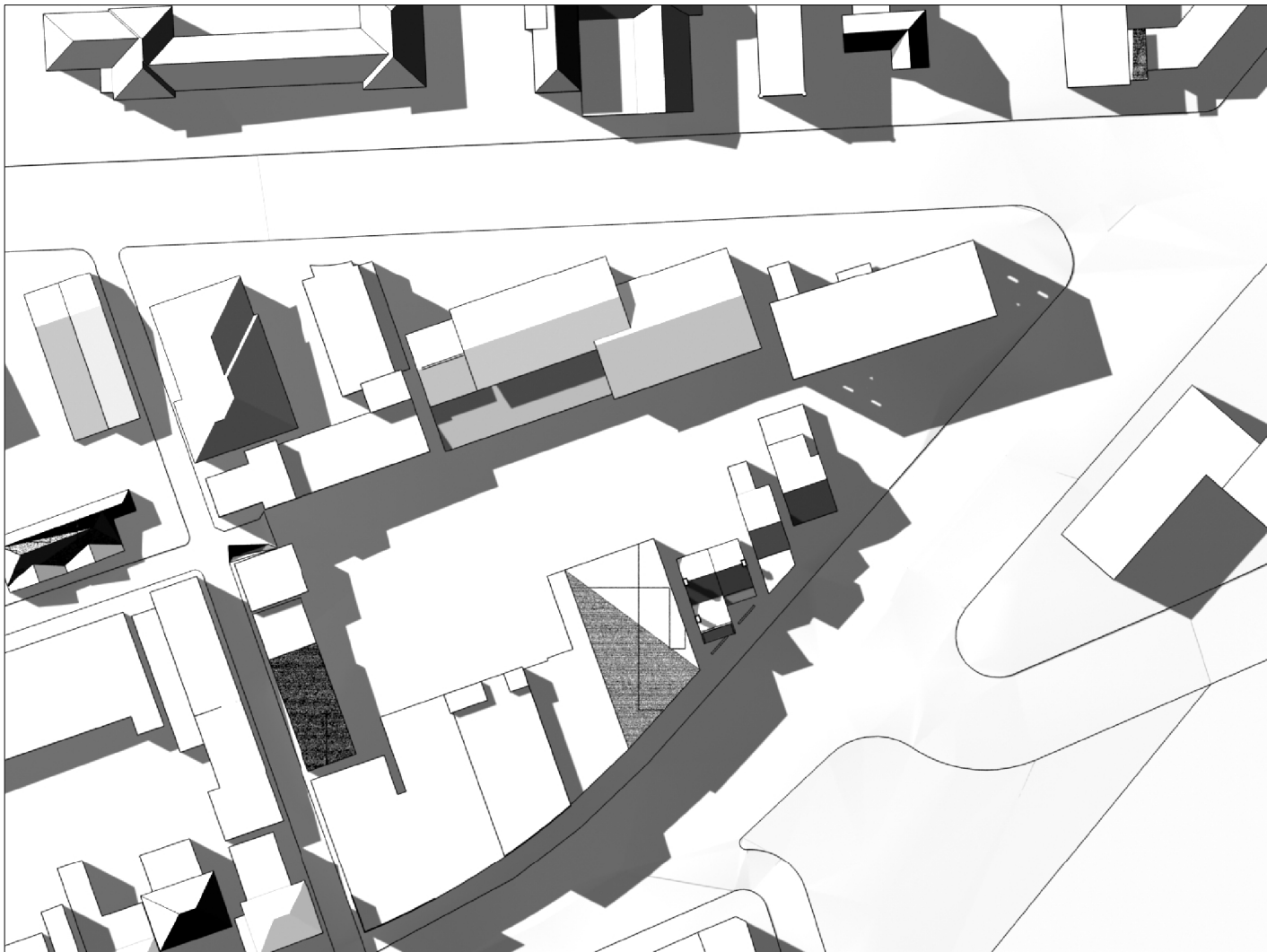

EXISTING EQUINOX 12:00 NOON



EXISTING EQUINOX 3:00 PM

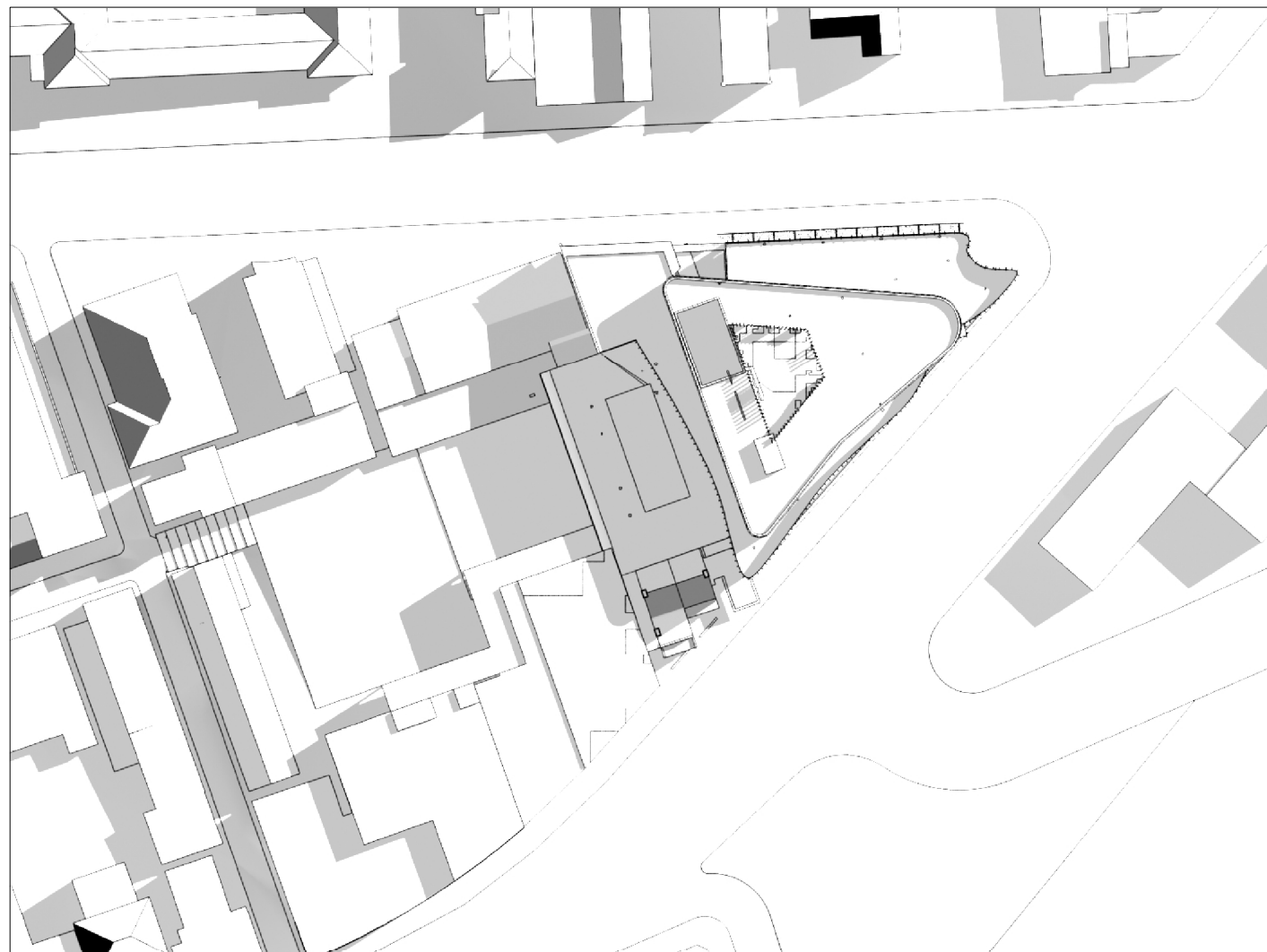

PROPOSED EQUINOX 9:00 AM

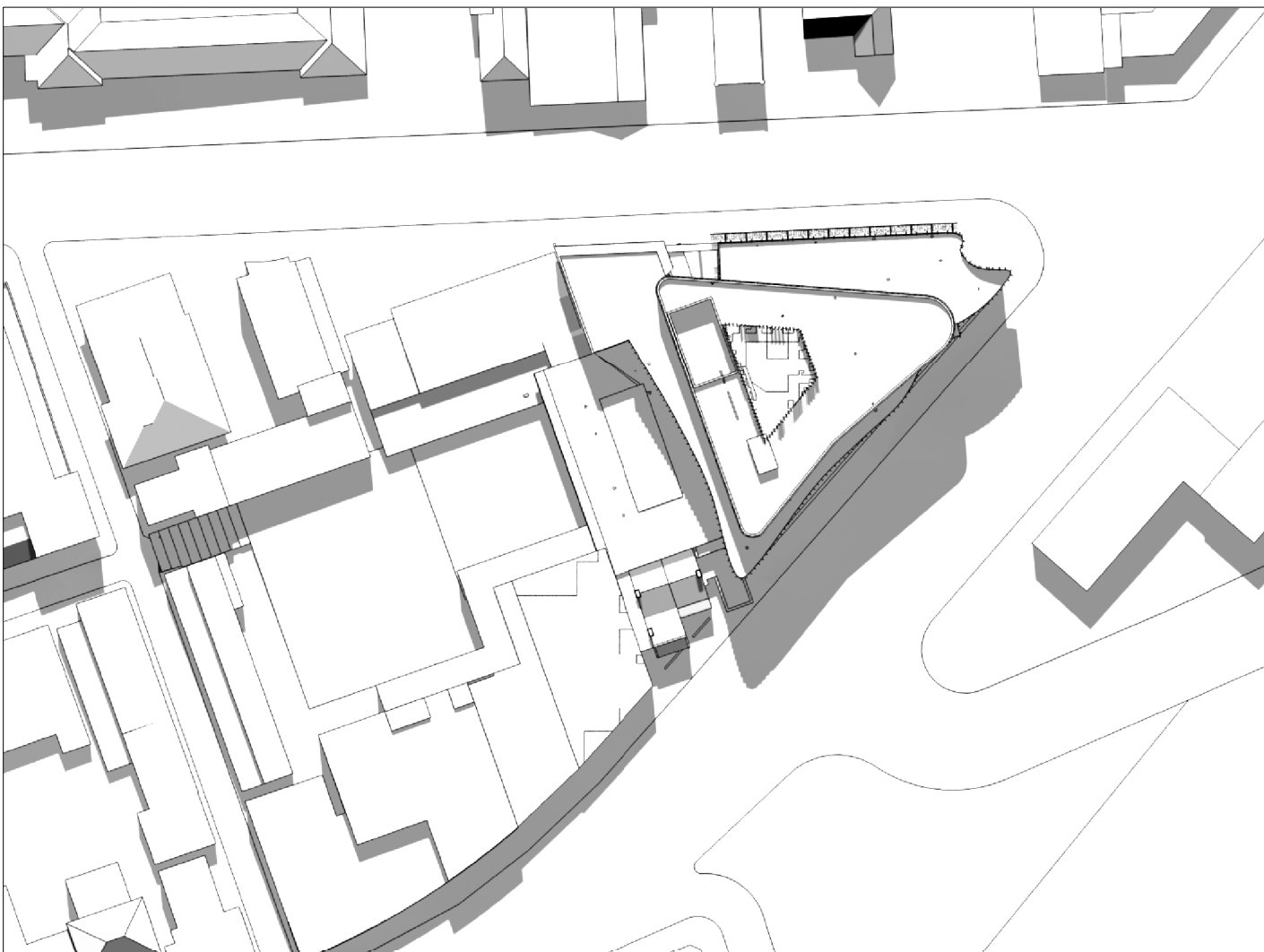

PROPOSED EQUINOX 12:00 NOON

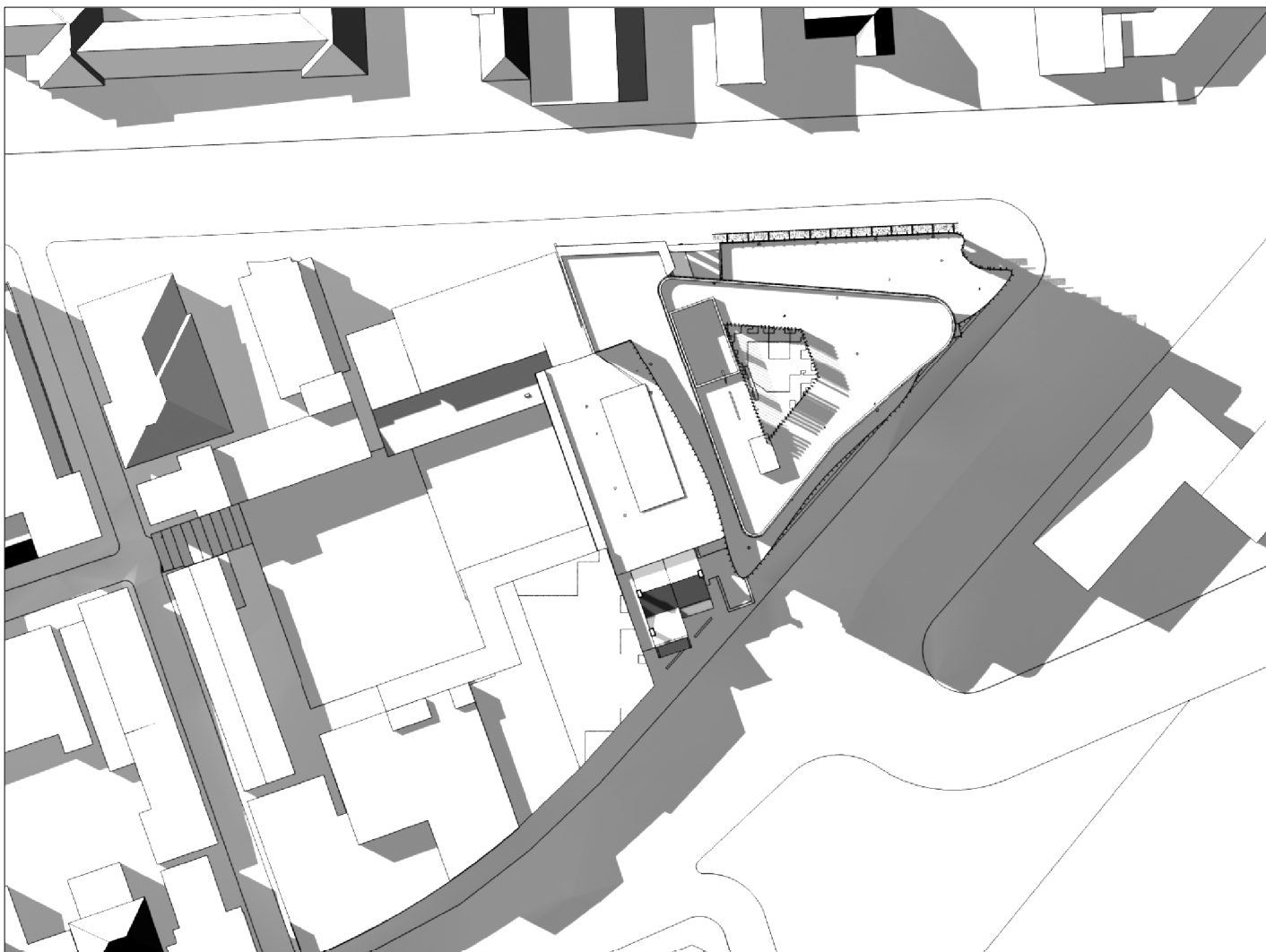

PROPOSED EQUINOX 3:00 PM

Revisions			
No	Date	Description	Ver App'd
A	09/10/09	PROJECT APPLICATION ISSUE	JG ML
Do not scale drawings. Use figured dimensions only. Check & verify levels and dimensions on site prior to the commencement of any work, the preparation of shop drawings or the fabrication of components.			
This drawing is the copyright of Allen Jack + Cottier Architects and is protected under the Copyright Act 1968. Do not alter, reproduce or transmit in any form, or by any means without the express permission of Allen Jack + Cottier Architects.			
Nominated Architects: Keith Cottier AM 2264, Glynn N Evans 2839, Michael Heenan 5264, Peter Ireland 6661, Reginald Smith 3312, Peter Stronach 3312.			

Site Location Plan

Client
MOORE THEOLOGICAL COLLEGE

Architect
ALLEN JACK+COTTIER
79 Myrtle Street Chippendale NSW 2008 AUSTRALIA
ph +61 2 9311 8222 fx +61 2 9311 8200 ABN 53 003 782 250

Project
MOORE COLLEGE RESOURCE
AND RESEARCH CENTRE
1 KING STREET NEWTOWN

Proj No. 09027

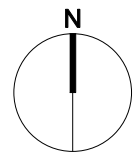

Drawing Title
SHADOW DIAGRAM 2

Drawing Status
PROJECT APPLICATION

Scale
N.T.S

Drawing No
PA 3801

0 10 20 50 80mm