

KEY PLAN

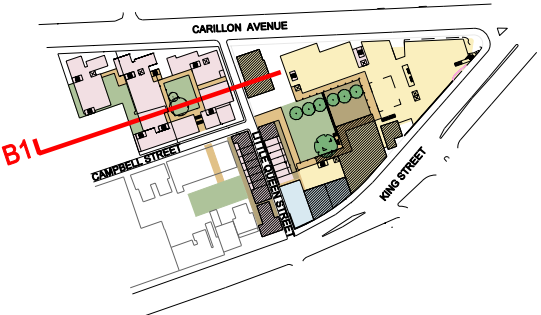

LEGEND

- CAMPUS GREEN
- RETAIL USES
- RESIDENTIAL USES
- ACADEMIC USES
- HARD PAVED LANDSCAPED AREA
- ROOF TERRACES + BALCONIES ETC
- CARPARKING
- ROOF
- RETAINED BUILDING FABRIC

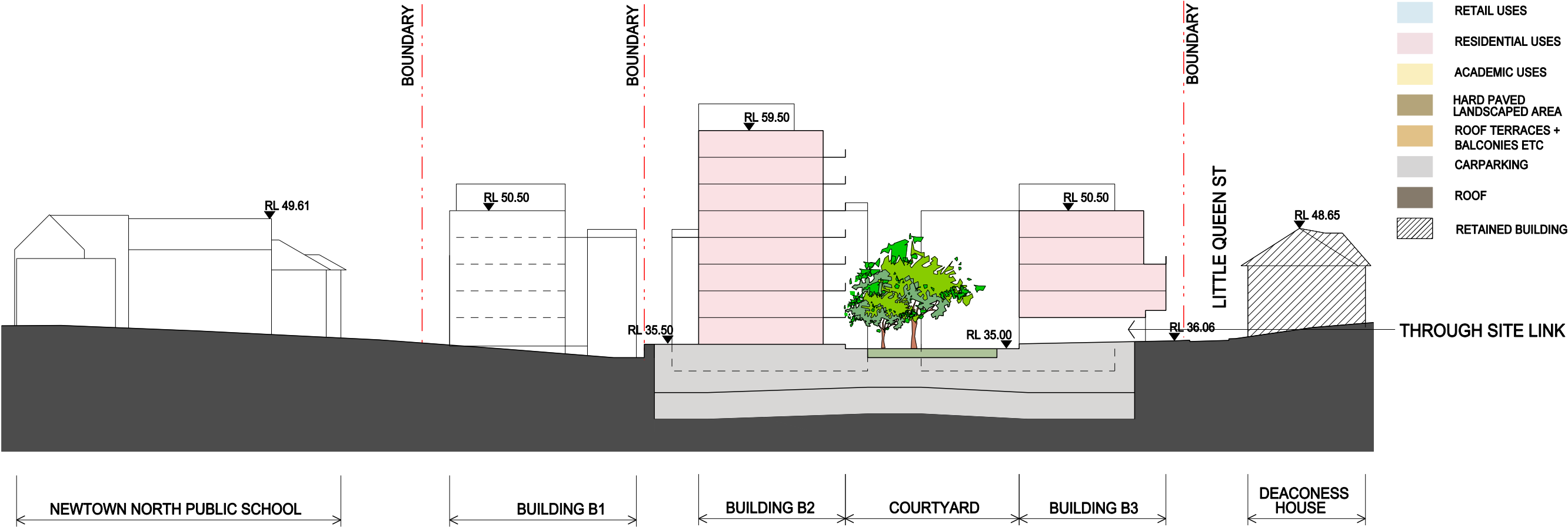

01 SECTION B1  
SITE B

1:500



Revisions				
No	Date	Description	Ver	App'd
A	16/10/09	CONCEPT PLAN	CC	ML

Architect  
**ALLEN JACK+COTTIER**  
79 Myrtle Street Chippendale NSW 2008 AUSTRALIA  
ph +61 2 9311 8222 fx +61 2 9311 8200 ABN 53 003 782 250

Client  
**MOORE THEOLOGICAL COLLEGE**  
  
Drawing Status  
**NOT FOR CONSTRUCTION**

Project  
**MOORE THEOLOGICAL COLLEGE  
CONCEPT PLAN**  
  
**NEWTOWN**

Drawing Title  
**SITE B SECTION 1**

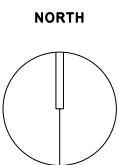

Proj No.	Scale at A3	Drawing No	Issue
09027	1:500	CP 3202	A

Do not scale drawings. Use figured dimensions only. This drawing is the copyright of Allen Jack + Cottier Architects and is protected under the Copyright Act 1968. Do not alter, reproduce or transmit in any form, or by any means without the express permission of Allen Jack + Cottier Architects. Nominated Architects: Keith Cottier AM 2264, Glynn N Evans 2839, Michael Heenan 5264, Peter Ireland 6661, Reginald Smith 3312, Peter Stronach 3372.