

08 21 June  
08:00 AM

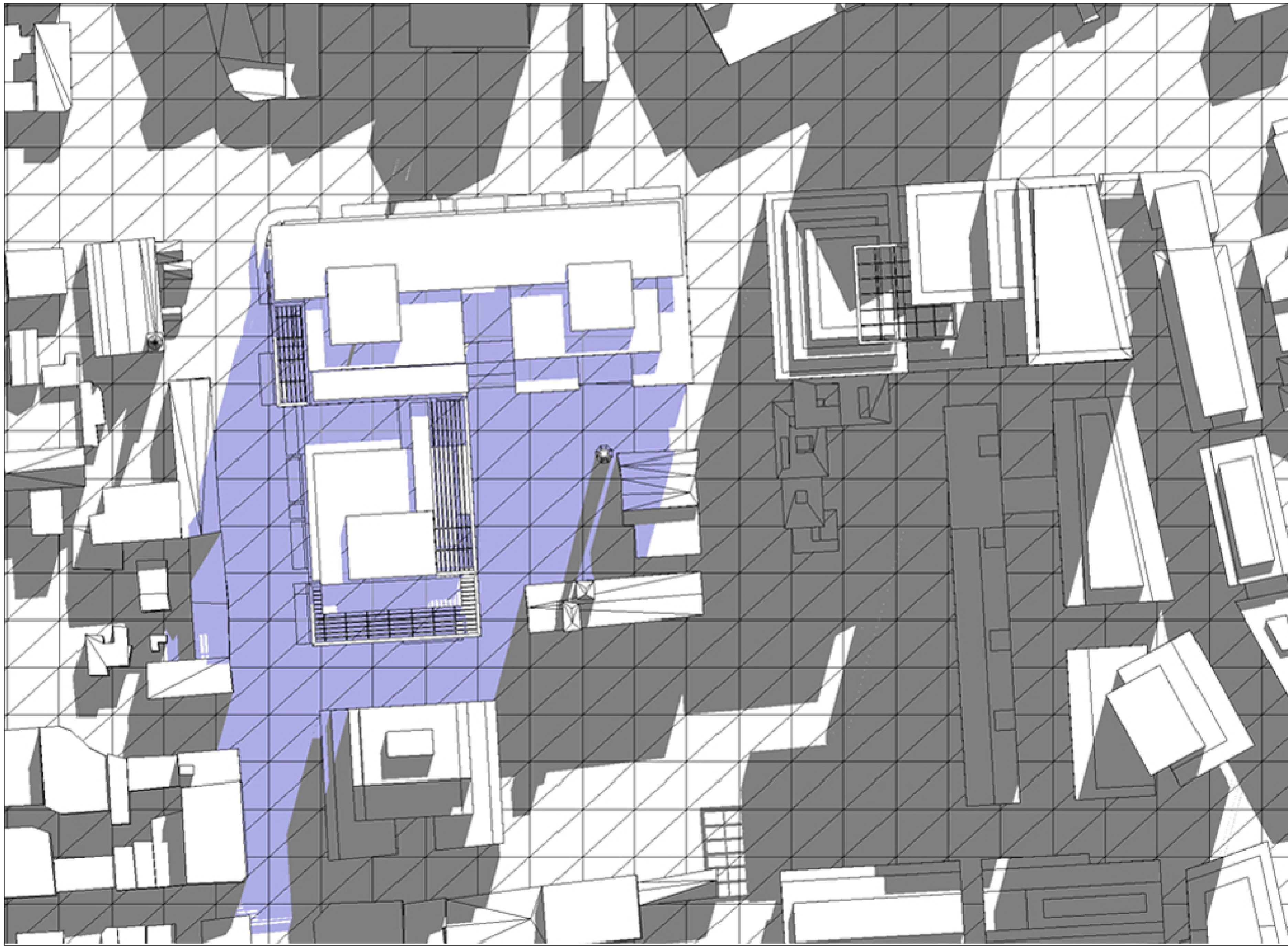

10 21 June  
11:00 AM

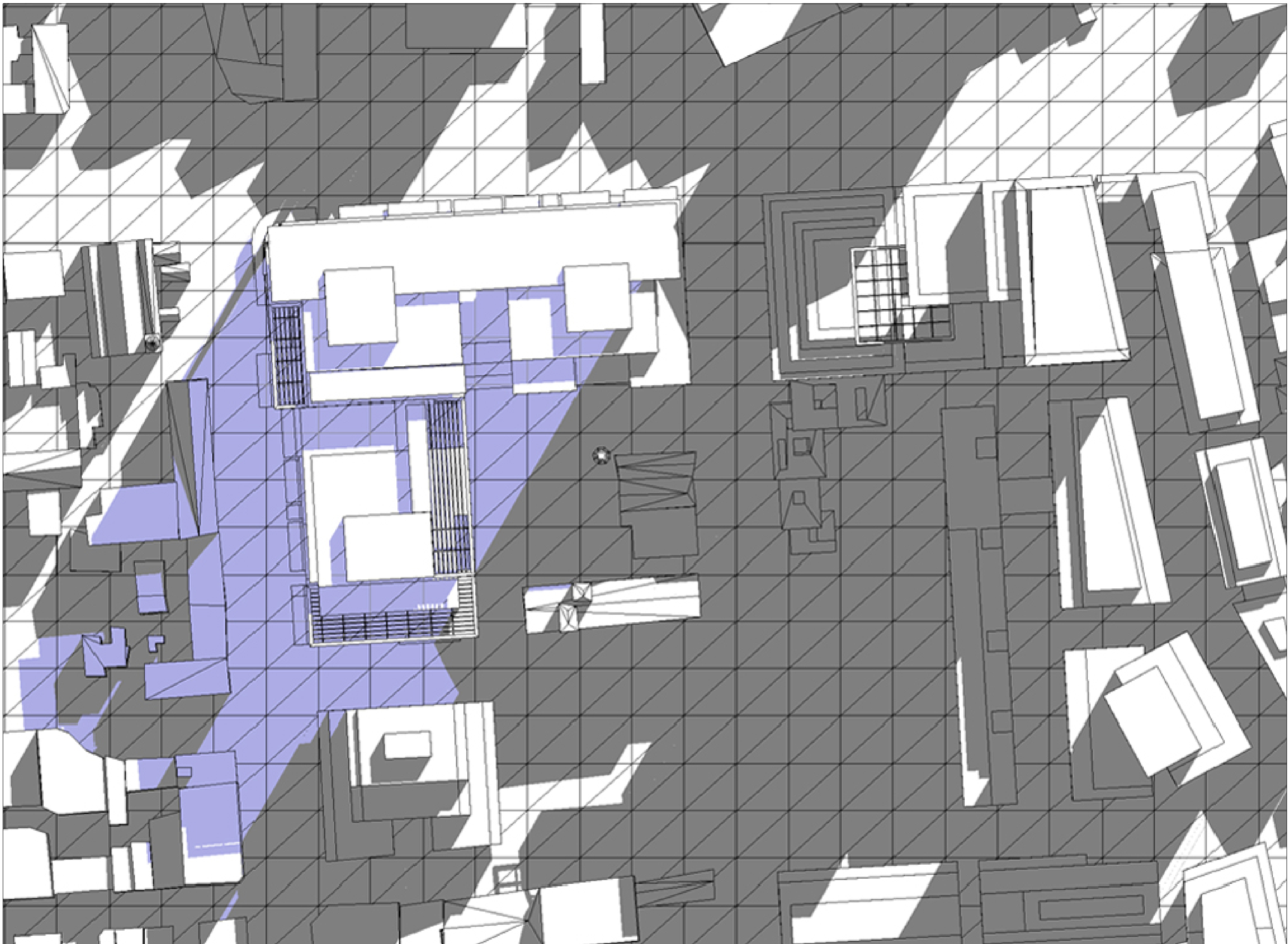

09 21 June  
10:00 AM



11 21 June  
12:00 PM

- General Notes
1. Do not scale drawings. Dimensions govern.
  2. All dimensions are in millimetres unless noted otherwise.
  3. All dimensions shall be verified on site before proceeding with the work.
  4. Foster + Partners shall be notified in writing of any discrepancies.
  5. Any areas indicated on this sheet are approximate and indicative only.

- shadow of blocks 1 + 4
- shadow line of approved amended concept plan indicated where data was available for comparison

NOTE: shadow study and comparison indicative only. All areas are to be confirmed by a specialist consultant

Rev.	Date	Reason For Issue	CHK
07	12/07/09	Planning Application Update	CAD
06	25/06/09	Blocks 1+4 shown in blue, outline updated	CAD
05	22/05/09	Planning Application Update	CAD
04	19/05/09	Planning Application Update	CAD
03	14/05/09	Planning Application Update	CAD
02	07/01/09	Planning Application Update	CAD
01	18/12/08	Planning Application Update	CAD
00	-	not issued	CAD

For information

Key Plan

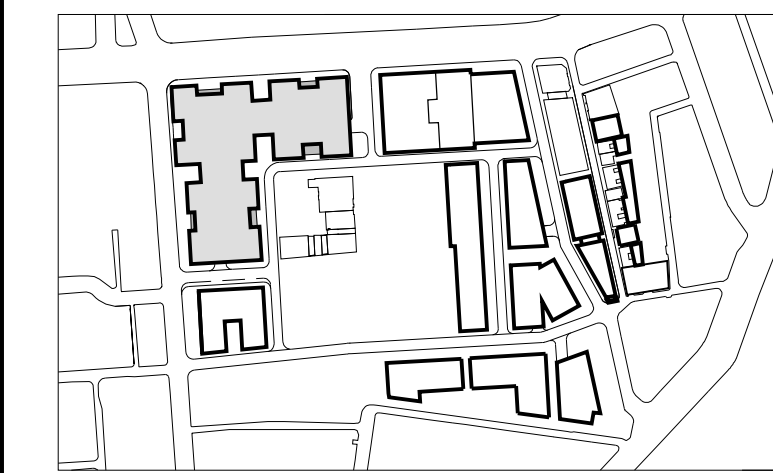

## FRASERS PROPERTY

Project Frasers Broadway  
20 - 102 Broadway Sydney NSW 2000

Client Frasers Broadway  
L11, 488 Kent Street Sydney NSW 2000  
T: 02 8823 8800 F: 02 8823 8801

Architect

## Foster + Partners

Riverside 22 Hester Road  
London SW11 4AN  
T +44 (0)20 7738 0455  
F +44 (0)20 7738 1107

Local Collaborating Architect

## PTW Architects

Level 17, 9 Castlereagh St  
Sydney NSW 2000 Australia  
P +61 (0)2 92325677  
F +61 (0)2 9221 4139  
www.ptw.com.au

Title

Block 1+4  
Shadow Studies  
21. June / Sheet 1

Project No.	Scale @ A0	Date	Drawn By
1645	NTS	28/11/08	CAD
Number			Revision
PA - A - 1287			07