

1 SHADOW DIAGRAM - 21stJUNE\_9AM  
5001 NOT TO SCALE

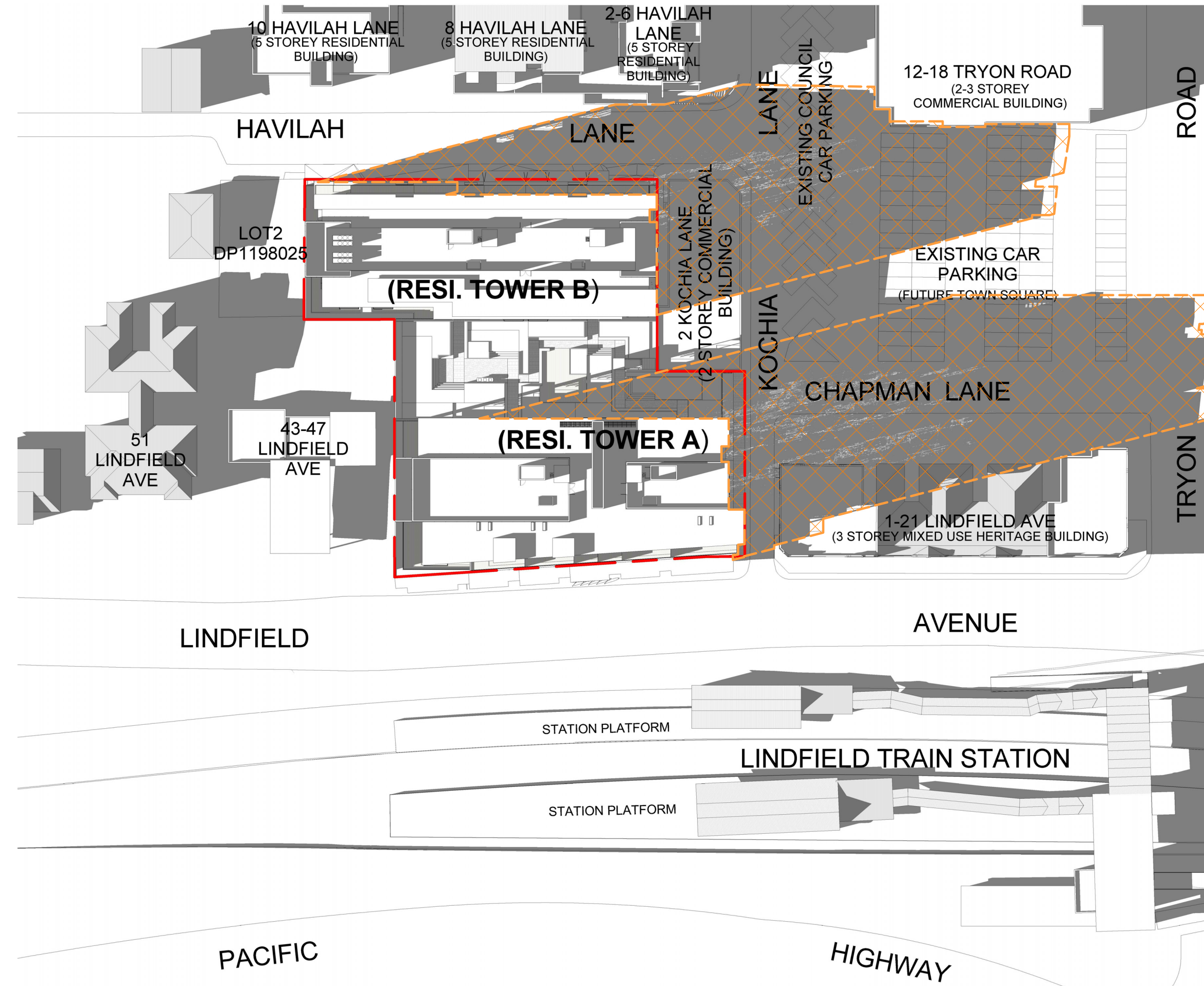

3 SHADOW DIAGRAM - 21stJUNE\_3PM  
5001 NOT TO SCALE

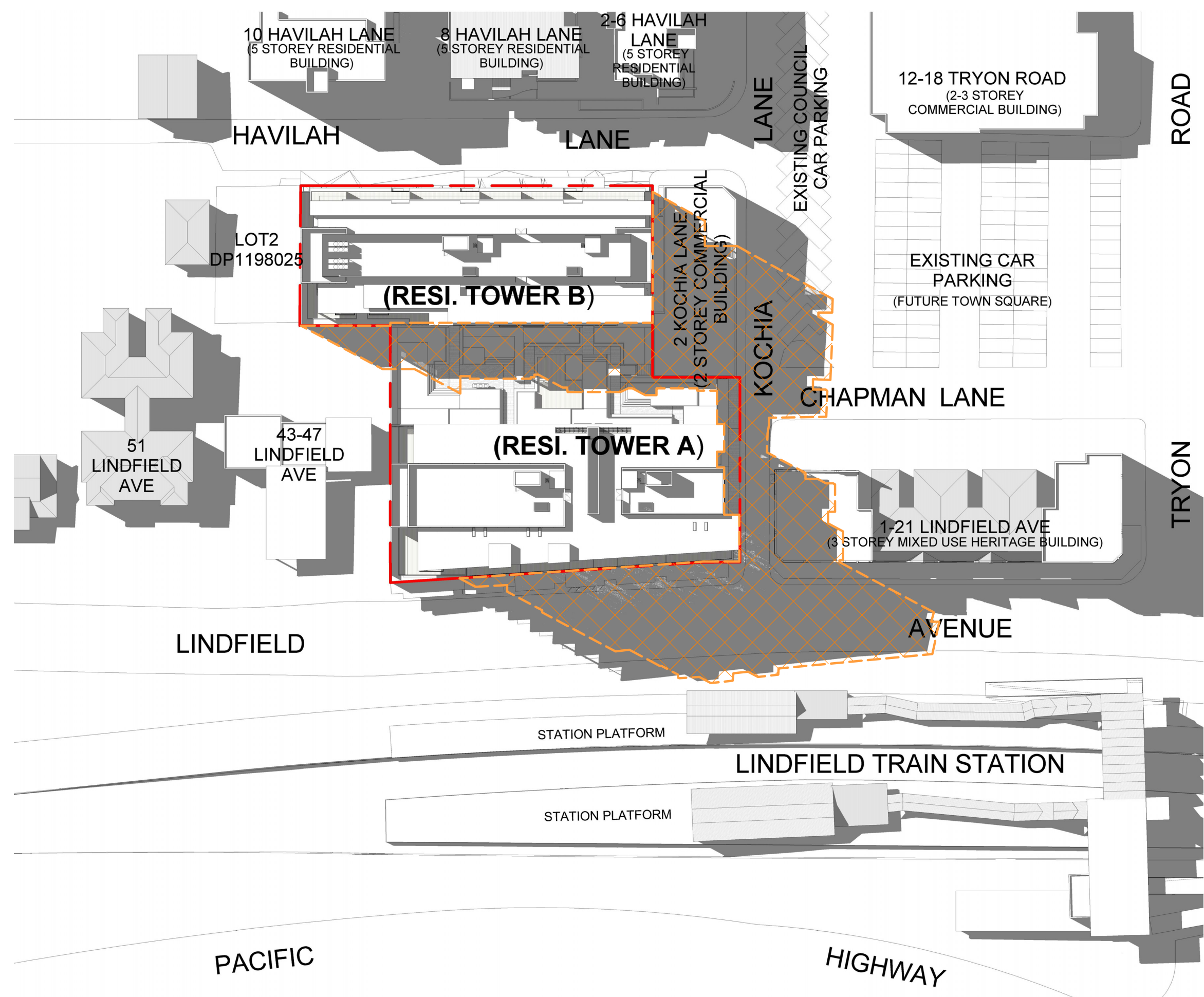

2 SHADOW DIAGRAM - 21stJUNE\_12PM  
5001 NOT TO SCALE

SHADOW DIAGRAM LEGEND:

JUNE 21st		
TIME	SUN AZIMUTH	SUN ALTITUDE
0900 AM	112.52°	18.91°
1200 PM	155.95°	32.63°
1500 PM	198.76°	17.95°

SHADOW LEGEND:

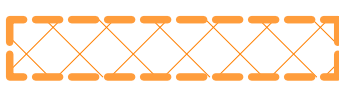
	DENOTES PROPOSED & EXISTING SHADOW
	DENOTES S75W MOD2 SHADOW

**Notes**  
All dimensions and setbacks to be verified prior to commencement, omissions or discrepancies to be notified to the architect.

**Copyright**  
The copyright of this drawing together with any other documents prepared by crone partners architecture studios. pty ltd (cp) remains the property of cp. crone partners grants licence for the use of this document for the purpose for which they are intended. The licence is not transferable without the permission of cp.

**Quality Assurance System**

Authorised By: \_\_\_\_\_ Date: \_\_\_\_\_

Rev	DESCRIPTION	By	Date
A	ISSUED FOR SECTION 75W SUBMISSION	MQ	20/11/2012
B	ISSUED FOR PREFERRED PROJECT REPORT SUBMISSION	MQ	20/05/2013
C	THE MARKET (PROPOSED MIX DEVELOPMENT) NEIGHBOURING BUILDING SHADOW CAST	BM	12/08/2013
D	ISSUED FOR SECTION 75W SUBMISSION	MQ	31/10/2014
E	ISSUED FOR SECTION 75W MODIFICATION 3 SUBMISSION	MQ	20/02/2015
F	ISSUED FOR SECTION 75W MODIFICATION 3 SUBMISSION	MQ	24/02/2015

**Builder**

**Client**  
**AQUALAND**  
LEVEL 32  
225 George Street  
SYDNEY NSW 2000  
Ph: +61 2 9252 3347  
Fax: +61 2 9241 1754



**Structural Engineer**  
**AECOM**  
Level 21, 420 George St. Sydney NSW 2000  
Ph: 02 8934 0000 Fax: 02 8934 0001

**Mechanical Engineer**  
**WOOD & GRIEVE ENGINEERS**  
Level 3, 454 - 456 Pacific Highway,  
St. Leonards, NSW 2000  
Ph: 02 8484 7000 Fax: 02 8484 7100

**Electrical Engineer**  
**WOOD & GRIEVE ENGINEERS**  
Level 3, 454 - 456 Pacific Highway,  
St. Leonards, NSW 2000  
Ph: 02 8484 7000 Fax: 02 8484 7100

**Hydraulic Engineer**  
**INSYNC SERVICES**  
Suite 8, Level 2, 56 Church Ave.  
Mascot, NSW 2015  
Ph: 02 9669 4311 Fax: 02 9669 4322

**Landscape Architect**  
**Land Live Arch**  
3 Sublime Point Ave  
Tascott, NSW 2250  
Ph: 0401 271 241

**KEY**

Scale As indicated@A1



**cronepartners**  
Cronepartners  
level 2, 364 Kent street,  
sydney, nsw 2000, australia  
Ph: +61 2 8295 5300  
Fax: +61 2 8295 5301

**Project**  
**LINDFIELD MIXED-USE DEVELOPMENT**  
**23-41 LINDFIELD AVE & 7,11 HAVILAH LA**  
**LINDFIELD NSW 2070**

Drawn: MQ	Checked: VD	Date: 24/02/2015
-----------	-------------	------------------

Drawing Title  
**SHADOW DIAGRAM - JUNE**

S75W(MOD3) SUBMISSION

CA 2924	ADAZ	5001	F
Project no.	Drawing Phase.	Drawing No.	Rev