

Sydney Cricket Ground Stage 2—MA Noble/Bradman Redevelopment Proposed by Sydney Cricket and Sports Ground Trust

MP08_0103 Section 75(w) Amendment—Heritage Impact Assessment

Background

The proposed development constitutes a major project and is being assessed under Part 3A of the Environmental Planning and Assessment Act, 1979.

A Statement of Heritage Impact (HIS) was prepared by GML as part of the Environmental Assessment for the proposed redevelopment of the Noble and Bradman stands in September 2008ⁱ, followed by an amendment in December 2008 as part of the Preferred Project Report. These HIAs were prepared following extensive discussions and deliberations regarding the options for potential adaptation of these structures and contained a series of recommendations regarding the final design detailing of the link building, protective measures during construction, archaeology management, archival recording of the proposed changes, integrated interpretation planning and the salvage of specific moveable heritage elements.

The Project Application was approved in March 2009, with a number of heritage conditions which reflected the recommendations in the HIA, and confirmed that the applicant's statement of commitments remains valid.

The Director-General's Environmental Assessment Report made under Section 75I of the Environmental Planning and Assessment Act 1979 noted that:

5.10 Heritage

The development will have a direct impact on the SCG site as well as individual items of heritage significance in that the MA Noble stand will be all but demolished and the oval will be lengthened, both of these are considered as having high heritage significance in the draft CMP.

The HIS notes that it would be preferable to retain the MA Noble stand and incorporate it into the design of the proposed new stand. However, it acknowledges that this has been examined by the proponent and was found to be unfeasible as the oval could not be extended and the existing construction could not accommodate or support the new seating requirements. The HIS therefore considers that while the demolition of the MA Noble stand will have a significant heritage impact on the SCG in its fabric and form, its main functions to accommodate spectators and broadcasting will be retained.

Furthermore, the western tower, considered to be the most prominent end of the MA Noble stand, will be retained and integrated into the new design. The HIS recommends archival recording prior to demolition, the salvaging of certain architectural elements for the SCG museum and interpretation of the heritage of the MA Noble Stand within the new development.

GML

Sydney

78 George Street Redfern
NSW Australia 2016

T +61 2 9319 4811
F +61 2 9319 4383

Canberra

2A Mugga Way Red Hill
PO Box 3171 Manuka
ACT 2603

T +61 2 6273 7540
F +61 2 6273 8114

Melbourne

PO Box 434
South Melbourne BC
VIC 3205

T +61 3 9380 1933
F +61 3 9380 4066

Hobart

GPO Box 554 Hobart
TAS Australia 7001

T +61 3 6223 2810
F +61 3 6223 2820

Godden Mackay Logan Pty Ltd
ABN 60 001 179 362

www.gml.com.au
heritage@gml.com.au

A further benefit of the new stand is the 'de-cluttering' of the area between the Members' Stand and the existing MA Noble Stand and the replaced with glass of the temporary panels cladding the western and southern faces of the retained western tower of the MA Noble stand. These measures will assist in reducing the ad hoc appearance in the area and will improve the setting of the Members' Stand and the views from the oval. It will also facilitate views of the roofscape of the Members' Stand from the glazed walls of the retained tower.

The Heritage Council and the City of Sydney Council acknowledge that the development will assist with the site's continued use as a cricket and football ground under contemporary needs and acknowledges that the recommendations in the HIS will reduce the impacts of the demolition to some extent.

The proponent has committed to implementing the recommendations listed in the HIS and to the protection of the retained portions of the MA Noble stand during works.

Members' and Ladies' Stands

While the Members' and Ladies' stands will not be physically altered as part of the development, the Members' stand and MA Noble stand are linked by a foot bridge on the second level and the increased height and bulk of the new stand will alter the visual setting of this part of the ground.

To mitigate the larger scale of new stand, the inner edge of the roof of the new stand is further back than the existing roof line and the new roof is set back from the eastern end of the Members' stand by approximately 10M which is considerably more than the existing roof. This, along with the 'de-cluttering' of the area between the Members' Stand and the MA Noble Stand as noted above, will help to negate the impact of the greater bulk of the new stand and enhance the setting of these two stands which have the most significant heritage items of the SCG.

Busby's Bore is known to cross beneath Paddington Lane around 50m south of Moore Park Road and at a depth of approximately 12m. Given the distance from the proposed development combined with the depth of the bore has led the proponent to consider it is highly unlikely that proposed works will affect Busby's Bore considering that no substantial excavation is proposed along the Paddington Lane either side of the bore. Nonetheless, a condition requiring the proponent to obtain confirmation of the location of Busby's Bore from the Heritage Section of Sydney Water is recommended.

Heritage Statutory context

The Noble Stand is directly adjacent to the State Heritage listed Members and Ladies stands, and the Cricket Ground itself are listed as a heritage conservation area under the *South Sydney Local Environmental Plan 1998*. Section 75J (3) says the Minister may take into account the provisions of an EPI because those of 75R do not apply. Relevant Conservation Area provisions were addressed within the HIS submitted with the project application and were assessed accordingly within Section 5 of the Director-General's Environmental Assessment Report.

The existing heritage listings and statutory context of the site have not altered since preparation of the HIS in 2008 and remain as described in Section 1.3 of that report, with the exception of the changes to the relics provisions of the *Heritage Act 1977* (NSW).

The proposal now includes a 2-storey link to the SHR-listed Members Stand, which will be designed to future detail and in negotiation with the Heritage Council. It is anticipated that a CMP or Special Elements Conservation Policy (SECP) for the Members Stand is likely to be required.

The Heritage Components

The Draft Conservation Management Plan (CMP) for the Sydney Cricket Ground site (GML, June 2008) identified the MA Noble Stand (1936) as having High heritage significance, the Bradman Stand (1973) as having Medium heritage significance, and the Dally Messenger Stand (1984) as having Low heritage significanceⁱⁱ, on a 4-level scale ranging from Exceptional to Low.

The adjacent Members and Ladies stands are graded as Exceptional, and both are listed on the State Heritage Register.

The Draft CMP provides guidance about the level of tolerance for change for each of the significant SCG components, and assesses the archaeological significance of the site.

Archaeological remnants of the earlier Northern Pavilion may remain under the existing MA Noble Stand. These have been assessed as being of moderate potential for survival and being of low archaeological significance and, as such, would not warrant in situ retention.

The Draft SCG CMP of 2008 has not yet been finalised and remains a draft document.

The Amended Project

The Sydney Cricket and Sports Ground Trust has recently reviewed the 2008 Project Application in the light of further consideration of facility needs and similar major sporting stadia developments elsewhere, and has determined to seek a Section 74(w) amendment in order to:

*...accommodate a higher level of facilities, providing an additional level for media and corporate use, moving the seats closer to the field of play, providing a new Members' lobby and atrium space, increasing the size and ambience of the new function room for 500 persons to approx. 700 persons and providing increased circulation and a higher level of amenities for spectators.*ⁱⁱⁱ

The current proposed amendments to the approved Project Application (as amended) will continue to be assessed under Part 3A of the *Environment Planning and Assessment Act 1979* (EP&A Act) Section 75(w).

Amendments to the Approved Development

The following drawings were reviewed as part of this assessment of impact:

Drawing No	Revision	Title
DA02 C Comparison	Sept 2011	Ground Floor Plan
DA03 C Comparison	Sept 2011	Level 1 Plan
DA04 B comparison	Sept 2011	Level 2 Plan
DA05 A Comparison	Sept 2011	Level 3 Plan
DA06 B Comparison	Sept 2011	Level 4 Plan
DA07A Comparison	Sept 2011	Roof plan
D-17A Comparison	Sept 2011	Section HH
D-17A Comparison	Sept 2011	Section CC
D-08A	Sept 2011	North Elevation

D-09A	Sept 2011	South Elevation
D-10A	Sept 2011	Section AA
D-11A	Sept 2011	Section BB
D-12A	Sept 2011	Section CC
D-13A	Sept 2011	Section DD
D-14A	Sept 2011	Section EE
D-15A	Sept 2011	Section FF
D-16A	Sept 2011	Section GG
D-17A	Sept 2011	Section HH
D-18A	Sept 2011	Section JJ
Photomontage Members' Main Entry	September 16 2011	

Note: Comparison drawings to be modified to reflect plan of Members Stand.

The drawings which demonstrate the differences between the two schemes are to be found in Appendix A.

The principle changes to the design of the approved new grandstand arise from the provision of additional facilities such as kitchens, dining areas, media facilities and change rooms, which add to the floor space to the rear of the grandstand, rather than an increase in the stand seating areas (the seating capacity does not increase).

The main changes include providing an additional dedicated level for media and corporate use, moving the spectator seats closer to the field of play, providing a new members' lobby and atrium space, increasing the size and ambience of the new function room from 500 to 700 persons, providing an increased circulation area and a higher level of amenities for spectators. (The extract from the full description of the changes prepared by the project architects is incorporated in the project documentation).

The differences between the identified likely impacts of the approved 2008 Project Application and the proposed amendments on the heritage significance of the site are summarised below.

Previously Identified Impact of Approved Application	Impacts Under Current Proposal	Assessment of the Impact of the Current Proposal
MA Noble Stand		
Demolition of the Noble Stand. Western Tower retained with important new function as the members' entry and lobby to the new stand.	Demolition of the Noble Stand. Western Tower façade is retained as an alternate entry, with access stair replacing former lobby area. Main members' entry relocated nearby.	No change in impact. Additional impact as the Western Tower loses prominence within context of increased height, bulk, scale and character of proposed extension to new stand and is no longer the main entrance to new member facilities. Requires mitigation via interpretation initiatives integrated throughout the new stand, tower and proposed links to the Members' Stand which will assist in understanding the former building and western tower facade.

Previously Identified Impact of Approved Application	Impacts Under Current Proposal	Assessment of the Impact of the Current Proposal
Western Tower floor levels, internal structural elements, clock and flagpole conserved but relocated to the roof of the tower.	Internal structure of the Western Tower is removed and replaced with new stairs. Northern façade, clock and flagpole retained in situ.	Additional heritage impact resulting from removal of internal structure; the stair function is retained. Front façade, clock and flagpole retained in situ.
Temporary cladding to the west and south sides of the tower will be replaced by glazed skin.	No change.	No additional impact
Link between tower and new Noble Stand expressed as lower glazed link to allow a view of the eastern face of the tower parapet.	Glazed link to new stand steps back slightly from tower façade. Trustees' terrace of new stand designed to allow upper south-eastern corner of Western Tower facade to be read as an individual element.	There is an increased impact on the ability to interpret the Western Tower façade due to the context of the increased bulk, height and proximity of the additional floors of the rear of the new stand to its immediate east. The design has evolved to be recessed, stepped and lowered to allow the upper tower parapet to continue to be seen in the round.
Building line behind the north face of the Western (clock) Tower.	The larger scale of the new stand's facilities results in a building line that is well forward (north) of the north face of the retained Western Tower façade. The service road is enclosed by the extension of the new stand to the north.	The additional height, bulk, character and scale of the rear of the stand structure sitting forward (north) of the line of the retained Western Tower facade is an additional impact on the setting of the Members' and Ladies' stands, and on the western tower of the Noble stand. The new rear of stand structure has been stepped down and back to reduce its impact on views of the Western Tower façade from the Walk of Honour.
The tower remains prominent in the views from Driver Avenue.	In views from Driver Avenue, the tower will be seen against the bulk of the new stand projecting further north.	The increased scale and bulk of the rear of the new stand to the north impacts the prominence of the views of the Western Tower façade from Driver Ave as it is now seen on approach against the substantial additional scale and bulk of the northern and western elevations of the new grandstand.
New grandstand higher than the existing Noble and Bradman Stands and significantly higher than Members' Stand.	The leading edge of the roof will be 2.77m higher than that of the previously approved roof. The rear edge of the roof falls from the centre towards each end. The highest point of the roof will be 5.3m higher than the rear of the roof of the approved stand.	The additional height will add significantly to the contrast between the heritage stands, and the new stand, impacting the relationship between the stands.
SCG Oval		
Extension of oval by 3m to the north.	Extension of oval by 3m to the north.	No additional impact.
Bradman Stand and Groundsman's Workshops		
Demolition of the Bradman Stand (Moderate) and Groundsman's workshops (Moderate).	Demolition of the Bradman Stand and the Groundsman's workshops.	No additional impact.
Archival recording and salvage of elements recommended.	Archival recording at a level consistent with its Moderate heritage value and salvage of elements such as plaques and memorabilia for the museum.	No additional impact.
Property Office and Shed, Car Port and Fernery		
Demolition of property office and shed.	Additional demolition of car port, property office and fernery.	Elements are of little significance. No additional impact.

Previously Identified Impact of Approved Application	Impacts Under Current Proposal	Assessment of the Impact of the Current Proposal
Dally Messenger Stand		
Partial demolition—an area of upper and lower level seating. Cast iron columns, riveted beams and concrete in subway remain and are protected during work.	Full demolition now includes the basement area where the c1910 column subway structure remains. It is proposed to remove, conserve and store the columns then reposition them as interpretative 'elements'. The CMP notes that the substructure can be recorded, removed and reused elsewhere on site (8.2).	The 2008 HIS assessed this area as having substantial capacity for change in regard to the form and fabric, and moderate capacity for change in regard to function and location. Additional impacts of loss of remnant fabric of Paddington Hill subway mitigated by conservation and retention of columns in similar configuration in area, and interpreted effectively.
Light Towers		
Light tower No. 1 relocated. Light tower No. 6 to be relocated closer to the rear of the Western Tower.	Light tower No. 1 to be relocated further south. Light tower No. 6 to be relocated slightly north, closer to the Western Tower.	No additional impact. Relatively minor change, landmark and functional attributes are not impacted.
Significant Uses		
Proposal aims to continue viability of site for sporting events. Provides fully accessible seating and access to the Members' Stand.	Proposal aims to continue the viability of the site for sporting events and functions. The functional brief for this area has changed as additional facilities and functions are to be accommodated. This necessitates significant additional floor space resulting in a significant additional footprint, scale and bulk to the north of the existing building line of the Noble Stand. Provides fully accessible seating and access to the Members' Stand.	On-going functionality of the SCG is enhanced and developed to support future conservation and interpretation of its heritage elements. Proposed Link between Noble Stand and Members' Stand subject to future detail and discussion with Heritage Council. Impact not assessed.
Archaeology		
Proposal has potential to disturb archaeological relics beneath the MA Noble Stand and Bradman Stand.	Proposal has potential to disturb archaeological remains beneath the MA Noble Stand, The Bradman Stand and The Dally Messenger Stand, where elements of the Paddington Hill remain will also be disturbed.	No additional impact, as potential archaeological significance of all potential remains is rated as Low in the Draft CMP. Note changes to relics provisions of Heritage Act since the application was approved. Columns of the Paddington Hill are to be interpreted, retained and reused on site. An archaeological watching brief will be maintained during construction.
Landscape		
Alterations to landscape elements adjacent to the Members' Garden and Walk of Honour, part of the setting of the Members' Stand.	Alterations to the landscape elements adjacent to Members' Garden including removal of approximately half of the Walk of Honour on the eastern side and its associated plantings. Walk of Honour will be redesigned in tandem. Four tennis courts (Moderate significance) will be demolished and then replaced with two reoriented courts. Paved forecourt leading to broad new entry stairs off Walk of Honour.	New entry area and proximity to the bulk of the rear of stand have an additional visual impact on garden area and Walk of Honour. Redesign of Walk and relocation of nearby sculptures can mitigate impact. Additional impacts of new stand in proximity to SFS, reduction of open and landscaped area.

Previously Identified Impact of Approved Application	Impacts Under Current Proposal	Assessment of the Impact of the Current Proposal
	The service road will be relocated inside the new stand bringing the rear of the stand closer to the Sydney Football Stadium.	Loss of two tennis courts of Moderate significance and the reorientation of the two remaining courts will change the landscaped approach, subject to future detailing
Views		
Retained Western Tower of the Noble Stand is prominent in views from the north west (Moderate) Walk of Honour and Members' Garden.	Bulk of new stand enters views from the Walk of Honour and Members' Garden. Prominence of Western Tower facade is diminished.	Prominence and views will be impacted but an analysis of options has led to a reduction of potential impacts on the tower by stepping back and lowering the additional rear of stand building bulk around the flights of access stairs and escalators.
Views provided to the east elevation of the Members' Stand from other stands to the east mitigated through the setback of the new roof.	New roof design is more open and transparent but is significantly forward of the approved scheme. It is designed to be read in two parts as a strategy to "pavilionise" the stand roofs, rather than unite them as a partial circle.	Open design of the new roof will provide opportunities for views from the other stands to the east through the upper stand structure. However its increased height and forward roof thrust will increase the contrast between the new stand and the Members and Ladies Stands.
More seating in the new grandstand to allow appreciation of the Members' and Ladies' stands.	No change to seat numbers.	No additional impacts.
Setting of Members and Ladies Stands		
Significant change in the view looking north and northwest from the oval and other grandstands from increase in scale, height and bulk of new stand, reducing views to the exterior .	Significant change in the view looking north and northwest from oval and other grandstands from further increase in scale, height and bulk of proposed stand. Open roof design will provide some views to exterior above seating tiers. Significant change of relationship to Members' Stand proposed via a glazed 2-storey link (yet to be detailed and subject to discussion with Heritage Council) which will close the opening between the new stand and the Members' Stand, impacting the views from the oval outwards. Change to the views looking south and southeast from the Members' entrance and Walk of Honour. The increased projection to the rear means that the new stand is not as readily perceptible as part of the suite of grandstand buildings around the oval, which—though varied in form and height—nevertheless articulated and reflected the essential shape of their function: that of spectator grandstands.	Additional impact of prominence of Western Tower form by the height, bulk, scale, and character of the new stand. Positive impact of new open partly transparent roof form which dips at either end at the rear towards its neighbouring stands. Additional impact on views from the oval and setting of Members' Stand from glazed link, closing external views. Views now impacted or terminated by new stand. The proposed rear extension of the Noble Stand will impact the ability to appreciate the oval form of the original arc or segment formed by the grouping of buildings around the oval. The incorporation of the service road within the new stand adds to the loss of perception of the oval enclosed by grandstands.
New grandstand is higher than the existing Noble and Bradman Stands and significantly higher than Members Stand.	The leading edge of the roof will be 2.77m higher than that approved. The rear edge falls from the centre towards each end. The highest point of the roof will be 5.3m higher than the rear of the previously approved roof of the new stand.	The additional height will add significantly to the contrast between the members and Ladies stands.

Previously Identified Impact of Approved Application	Impacts Under Current Proposal	Assessment of the Impact of the Current Proposal
<p>New stand provides more enclosed character, offering little opportunity for views to exterior.</p> <p>Lower tier of seating in new stand will be marginally forward and slightly higher.</p> <p>Area between Members' Stand and new stand rationalised to remove plant, de-clutter, etc.</p> <p>Existing lift well on western side of the clock tower relocated to south side (Amendment December 2008).</p> <p>No physical impacts on the Members' Stand except for replacement of pedestrian bridge using same access point. Design needs to be carefully detailed so that it appears as a recessive element.</p>	<p>Although higher, the proposed new roof is lighter and more open, articulated as two segments.</p> <p>Lower tier of seating in new stand will be slightly higher and of a different rake to the existing Members' Stand seating; however, it is in alignment with the lower tier of the Members' Stand seating.</p> <p>Four tiers of seating rather than three.</p> <p>3m separation between stands provided at the oval fence; Members' Stand and the new stand now proposed to be joined at rear by new 2-storey glazed link.</p> <p>Area between Members Stand and new stand rationalised to remove plant and be replaced by two storey glazed link.</p> <p>Existing lift well on west side of the Western Tower removed and relocated within main stand.</p> <p>Physical impact of 2-storey glazed link which reduces separation of Members' Stand from new grandstand and reduces the prominence of the Western Tower as a 3D form.</p>	<p>Reduced impact, benefits in segmentation of roof to reflect pavilion effect around the oval.</p> <p>Some additional impact</p> <p>The proposed, but as yet undetailed, glazed link to the Members' Stand may further diminish the separation of the tower as an architectural element from the oval.</p> <p>Approved application allowed less obstructed views of the east elevation of the Members' Stand. In the current proposal the plant is rationalised; however, a 2-storey glazed link will be inserted which, together with the proximity of the relocated Tower 6, will obscure most views of the east elevation. Careful detailing in a future application will be needed to avoid additional impact. Negotiation with Heritage Council essential to resolve detail.</p> <p>No additional impact</p> <p>Potentially significant additional impact from glazed link which is no longer a minor or recessive element. Subject to further detail and discussion with the Heritage Council.</p>
Amended Noble Stand Design		
<p>Solid roof form with a prominent curved edge on the north side.</p> <p>Freestanding grandstand well separated from the significant heritage buildings.</p> <p>Curved form reflects function.</p> <p>More integrated appearance when viewed from SFS.</p> <p>New additions will be clearly distinguishable.</p>	<p>More lightweight roof form which sits above the grandstand and does not wrap down over the north side of the structure. Segmented glazing pattern adds to the lightness of the roof.</p> <p>Extended grandstand separated from the significant heritage buildings at oval but joined at the tower base by proposed 2-storey glazed connection to Members' Stand.</p> <p>Scale and form of rear extension of stand diminishes ability to read traditional curved grandstand form.</p> <p>Larger and closer building when viewed from SFS. Loss of two of the four tennis courts and their reorientation and loss of landscaped area.</p> <p>The new link to the Members' Stand is proposed to be highly contemporary.</p>	<p>Positive new design outcome for roof shape; however, significantly higher structure over all.</p> <p>Additional impact of enlarged forward floor plate changes geometry of grandstand group and setting of Members' Stand.</p> <p>Glazed connection to Members' Stand to be subject to future detailing and negotiation with Heritage Council.</p> <p>Some additional impact of loss of open space and two of the four tennis courts; change from open views between stand and SFS to closer built forms.</p> <p>Design subject to future details and negotiation with the Heritage Council.</p>

Previously Identified Impact of Approved Application	Impacts Under Current Proposal	Assessment of the Impact of the Current Proposal
Western Tower (clock tower) retained as a transparent/neutral element to assist in transition between the two structures.	The Western Tower façade is retained as a transparent/neutral element to assist in transition between the two structures. However, the increased bulk, character, form and scale of the new rear of stand structure diminishes the ability for the tower to be read as a transition element. Use of terracotta to define eastern upper area of the tower may assist to differentiate the Tower from the bulk and massing of the new building.	Additional heritage impact as the prominence of the Western Tower façade is reduced by the height, bulk, character and scale of the new stand to the north.
New roof set back from eastern end of Members' Stand by 15m (existing setback is 5m).	New roof set back 10m from the eastern end of the Members' Stand.	New roof form is 5m closer to Members Stand and 2.7m higher than approved roof form.
Materials.	Extensive glazing to north and western elevations of new rear of stand building.	Change from masonry wall of existing Noble Stand to lightly framed glazed structure of significant bulk and scale. Use of terracotta panels and fritted glazing which may be interpretative, have been incorporated to reduce impacts.
	Additional excavation as the footprint and depth of the proposed stand has increased to six floors from four.	Archaeological watching brief to be maintained.
Fox Studios		
New stand would present more unified appearance when viewed from the north-western side of the Government Pavilion.	Stand no longer over hangs Fox Studio property.	Positive impact.
New stand will be a dominant feature from the northern end of Lottie Lyell Avenue but will present a more unified appearance.	New stand will be a dominant feature from northern end of Lottie Lyell Avenue but will present a more unified appearance.	No additional impact.
New stand will be visible from northern end of the former cattle judging rings; however, it would not be a dominant feature given scale of the Government Pavilion.	Less visibility.	No additional impact.
Overhang of 10m into the Fox Studios by approximately 10m.	No overhang into Fox Studio boundary.	Positive impact.

Conclusion

The redevelopment of the MA Noble, Bradman and Dally Messenger stands is intended to underpin the long term functionality and viability of the SCG, which will in turn support the ongoing conservation and maintenance of the heritage significance of the site.

The modifications to the approved development would additionally demolish the remains of the Dally Messenger stand, and will also impact on a number of structures and elements of landscape significance to varying degrees, most significantly in relation to the setting of the SHR listed Members' and Ladies Stands. A two level glazed link is now proposed into the side of the State Heritage Register listed Members' Stand, subject to detailing and future discussion with the Heritage Council.

The impacts of the development can be summarised as follows:

Positive impacts

- Less impact on Fox studio site through reduction of overhang.
- Enhanced functionality of SCGMPT facilities as host for major sporting and cultural events, in turn benefiting the conservation of heritage values and components of the site.
- Improved roof shape and transparency, articulation as two elements

No Additional Impacts

- Extension of Oval
- Demolition of the MA Noble Stand and the Bradman Stand
- Removal of external lift to western side of tower of Noble stand
- Change of temporary cladding of west and south of western tower to glazing
- Minimal relocation of light towers
- Increase in the bulk and scale of development adjacent to the heritage items in Fox Studios.
- Disturbance or destruction of potential archaeological remains (albeit of Low significance).
- Columns from Dally Messenger stand (to be retained for interpretation)
- Demolition of Property Office, car port, fernery and Shed
- No change to seat numbers

Some Change to Impacts

- Loss of open space and landscaping in tennis court/Walk of Honour area
- Loss of two tennis courts
- Changes to seating tiers

Additional Impacts

- Increased height, bulk, character and scale of new building adjacent to Members Stand
- Change to geometry and building line of grandstand group around the oval with inclusion of service road beneath the new stand and forward thrust of new roof over seating
- Loss of prominence of western tower of former MA Noble stand within context of increased height, bulk, character and scale of proposed extension to new stand.,
- Loss of internal structure of western tower resulting in retention of façade only.
- Full demolition of the Dally Messenger Stand (Hill columns retained for interpretation)
- Increased proximity of new roof structure to Members Stand (5 m)

- Increased height of new roof structure (2.77-5.3 m higher than the previously approved roof)
- Two storey, fully glazed link to Members Stand subject to future detail and negotiation with Heritage Council.

Mitigation Measures

The methods taken to mitigate the additional impacts include:

1. Existing Approval commitments to be implemented including:
 - Archival record of built elements
 - Salvaging of specific building elements and moveable heritage for use in interpretation of new stand and in SCG museum
 - Protection of identified heritage elements during construction
 - Preparation and implementation of an Interpretation Plan to be fully integrated in final design phase. Interpretation Strategy to be prepared for CC stage and full interpretation plan implementation prior to OC.
2. Landscape planning for new entry to reinforce and respect the heritage values of the Walk of Honour and Members Lawn
3. Completion of the draft CMP for SCG to provide context for on-going development of the site
4. Future detailing of Members stand link and negotiation with Heritage Council

Built Elements

Archival recording should be undertaken at the site prior to the commencement of works. The MA Noble Stand should be archival recorded both prior to and during the demolition works. A lesser level of recording should be carried out for the other elements of the site prior to their demolition. The archival records should be prepared using the Heritage Council, NSW Department of Planning's guidelines for archival recording.

Consideration should be given in the final design phases to the articulation, materials and colour of the new stand so that they are sympathetic to the adjacent elements within the SCG and the Fox Studios site.

Appropriate, protective measures should be adopted to ensure that significant built elements (for example, the older portions of the Dally Messenger Stand (the cast-iron columns) the retained portions of the MA Noble Stand and the boundary wall) are not damaged during the works. These should be included in the Construction Management Plan.

Landscape Elements

The detailed layout of the forecourt and any planting associated with the entry and Walk of Honour to the new stand through the retained western tower façade should be resolved so that they reinforce and reflect the heritage values of the significant landscape features in the vicinity.

Movable Heritage

Prior to demolition, GML, in tandem with the SCG museum staff, should carry out an assessment of elements and items to be salvaged for the museum collection. It should be recorded, catalogued, labelled and safely stored.

Interpretation

An Interpretation Strategy/Plan and implementation options are needed for the SCG site as a whole.

An Interpretation Strategy should be developed for the subject area as a priority before the construction certificate, and implemented prior to an occupation certificate for the new building. Utilising some of the moveable heritage elements salvaged from previous SCG projects, in tandem with interpretation should cover the subject site fully.

The Archaeological Resource

Since the original HIA in 2008, the “relics” provisions of the Heritage Act have been amended. The definition of a relic is now linked to its significance at a Local or State level. Based on the 2008 archaeological assessment of the remains of the former Northern Pavilion and previous occupation of the site, the subject area generally has low potential to contain intact archaeological remains. Any remains of the Northern Stand that do survive are likely to be disturbed and have little research potential to contribute to the significance of the site.

Archaeological monitoring of ground disturbance within the subject site is recommended in order to record any archaeological remains that do survive.

Section 146 of the Heritage Act applies if unexpected relics are encountered. The Heritage Branch would need to be notified and further assessment; investigation or recording may be required.

Yours faithfully

Godden Mackay Logan



Sheridan Burke

Partner

Appendix A

September 2011 comparison plans and sections showing the approved plans and the proposal superimposed.

ⁱ This HIS was lodged with the Department of Planning as part of the Part 3A application for approval for the redevelopment.

ⁱⁱ The Draft CMP is not yet publicly available. It is subject to Sydney Cricket and Sports Ground Trust review.

ⁱⁱⁱ Architects statement, Cox Robertson Marks, 14 September 2011.

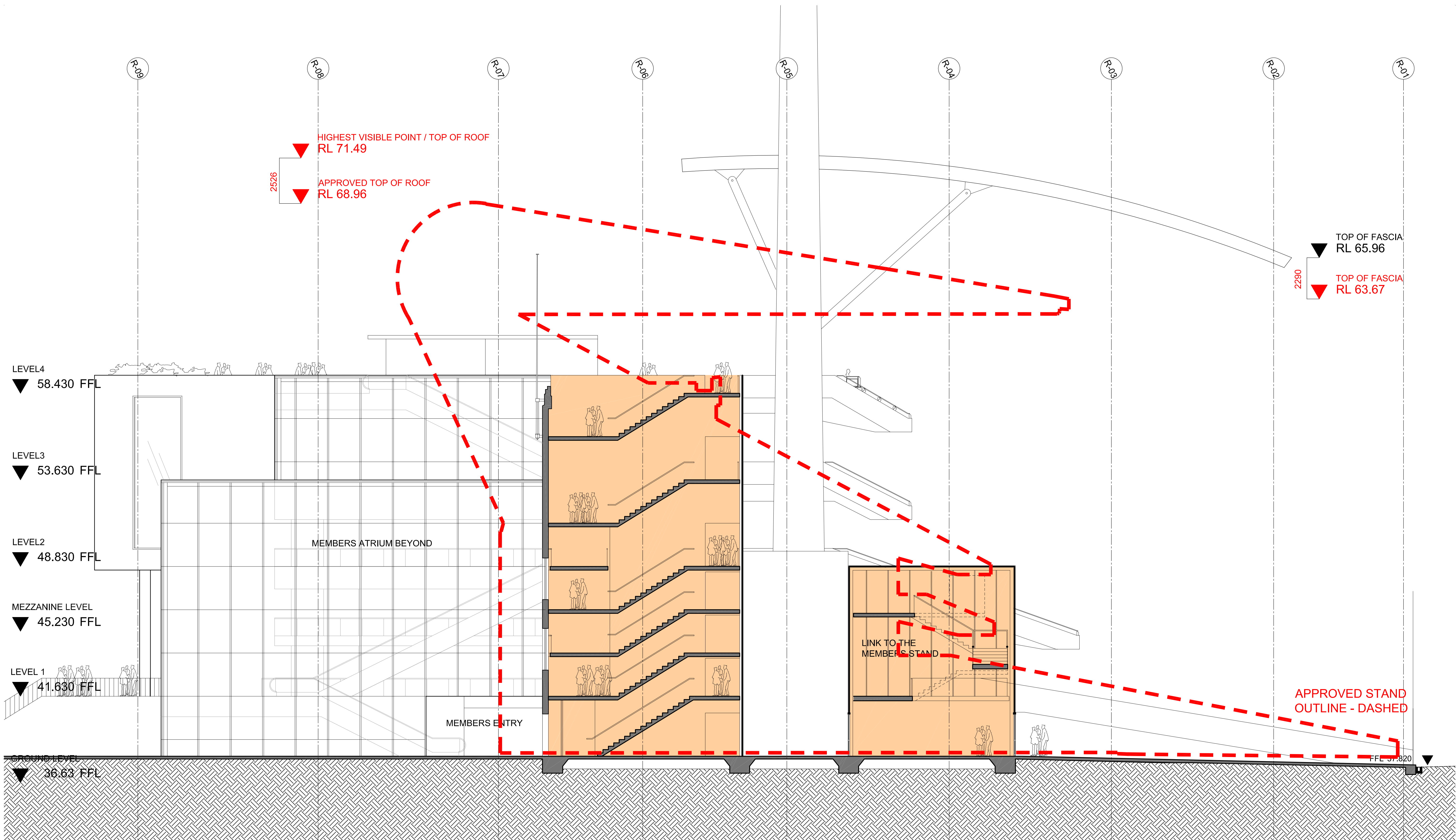

Cox Richardson

Level 2, 204 Clarence Street, Sydney 2000 Australia
Tel : 612 9267 9599 Fax : 612 9264 5844
Email : sydney@cox.com.au

Architecture Planning Urban design Interior design Health facility design

COX

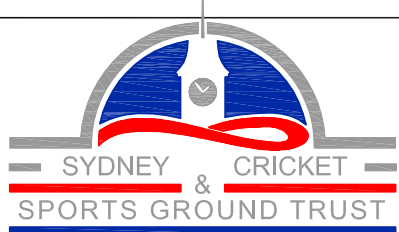

SCG STAGE 2: NORTHERN STAND

SYDNEY CRICKET GROUND, PADDINGTON

1:100@A1 / 1:200@A3

Drawing Title

SECTION C-C

Drawing Number

D-12A - COMPARISON

Date

SEPT-2011

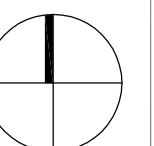

Cox Architecture Pty Ltd ACN 002 535 891

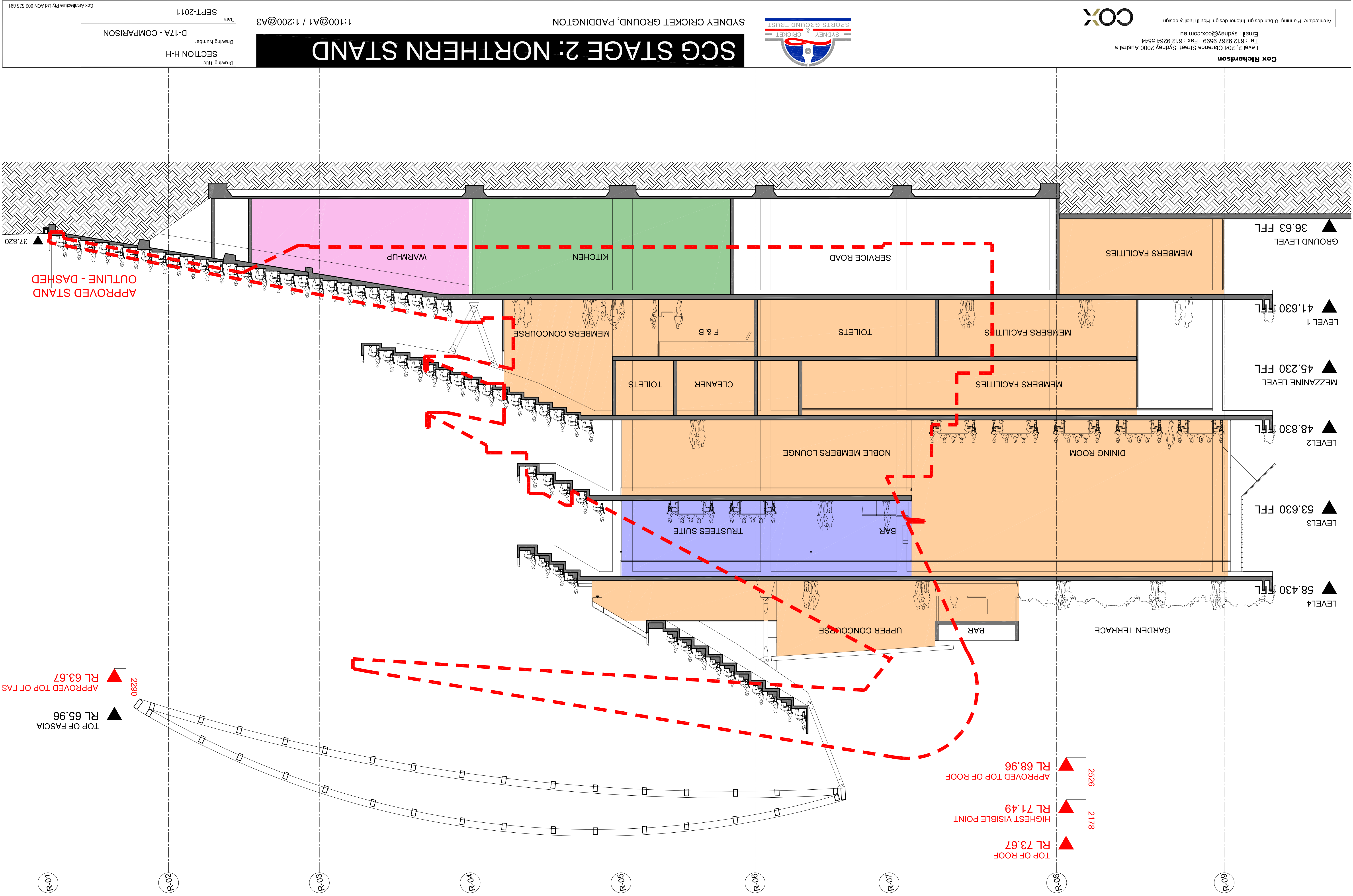

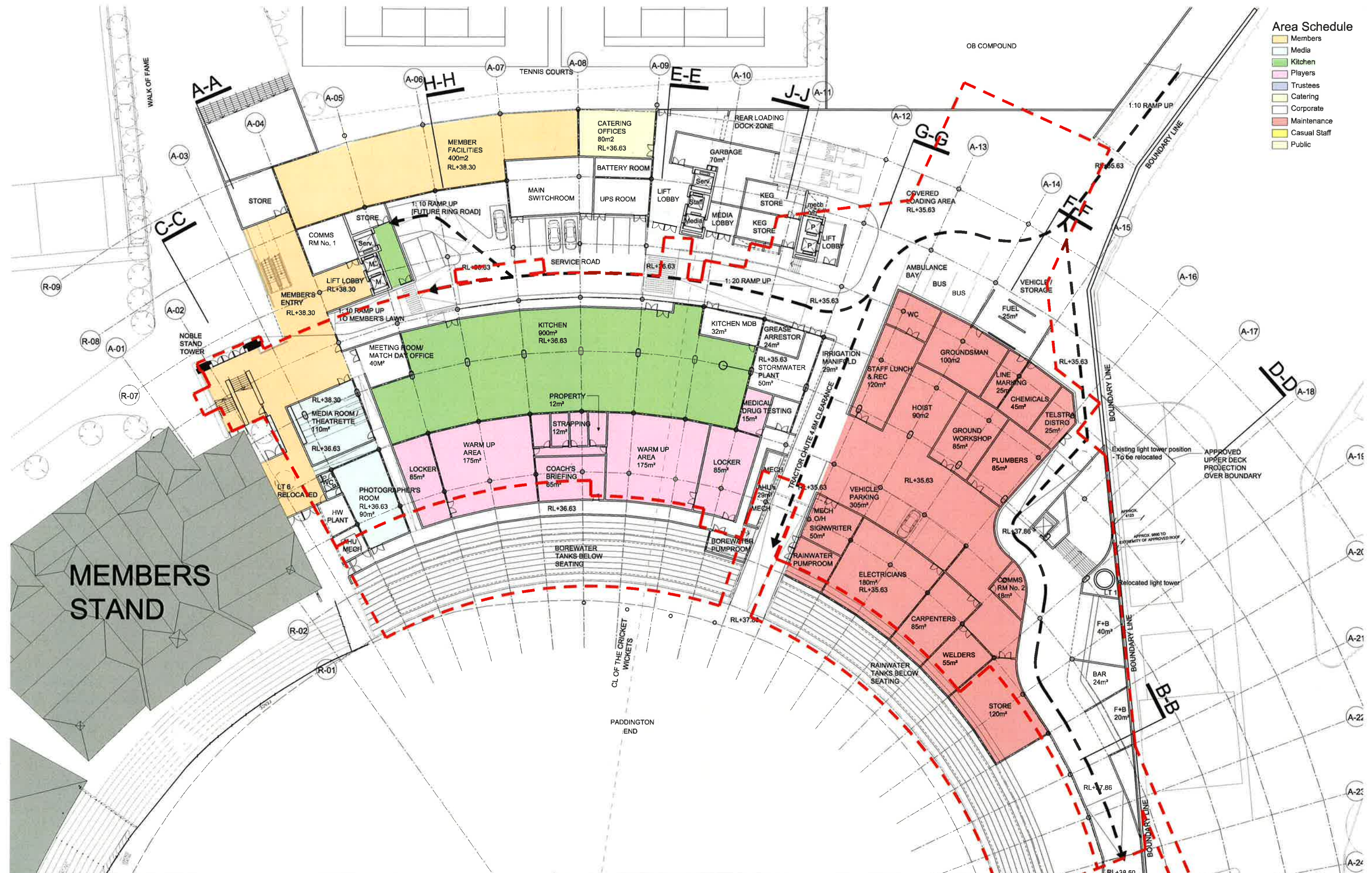

- Area Schedule**
- Members
 - Media
 - Kitchen
 - Players
 - Trustees
 - Catering
 - Corporate
 - Maintenance
 - Casual Staff
 - Public

MEMBERS STAND

SCG STAGE 2: NORTHERN STAND

SYDNEY CRICKET GROUND, PADDINGTON

1:250@A1 / 1:500@A3

Drawing Title
GROUND FLOOR PLAN
Drawing Number
D-02C - COMPARISON
Date
SEPT-2011

Cox Richardson
Level 2, 204 Clarence Street, Sydney 2000 Australia
Tel : 612 9267 9599 Fax : 612 9264 5844
Email : sydney@cox.com.au



Architecture Planning Urban design Interior design Health facility design

SEATING SUMMARY	
LOWER DECK:	6486 SEATS
MID DECK:	3062 SEATS
CORPORATE LEVEL:	574 SEATS
UPPER DECK:	3248 SEATS
TOTAL:	13360 SEATS

MESSSENGER STAND (28 ROWS)
 TOTAL: 1789 SEATS
NOBLE/BRADMAN
 LOWER DECK (28 ROWS)
 TOTAL: 4697 SEATS (INCL. 60 DIS.)
TOTAL LOWER DECK: 6486 SEATS

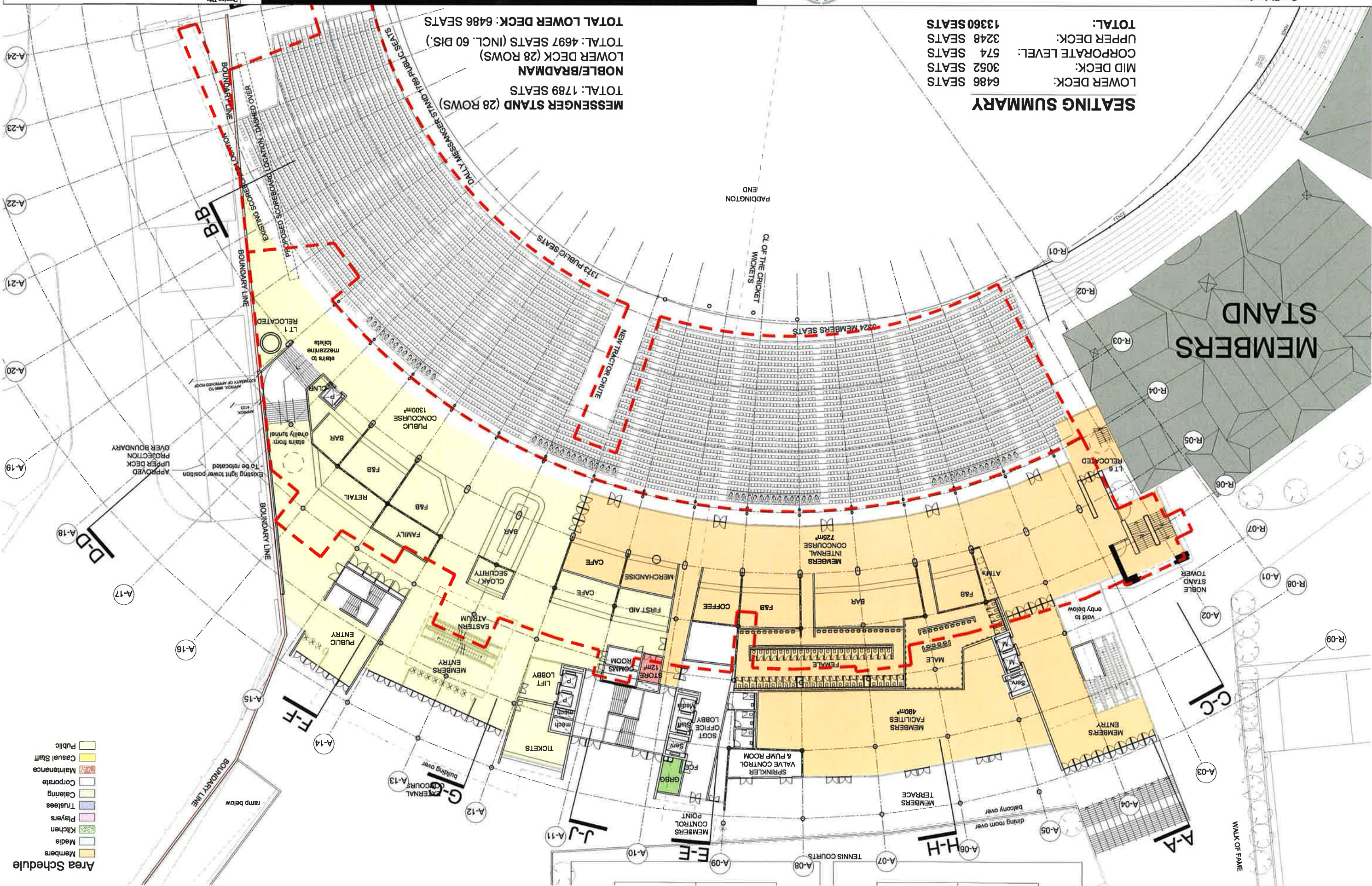

- Area Schedule**
- | | |
|--------------|---|
| Members |  |
| Media |  |
| Kitchen |  |
| Players |  |
| Trustees |  |
| Catering |  |
| Corporate |  |
| Maintenance |  |
| Casual Staff |  |
| Public |  |

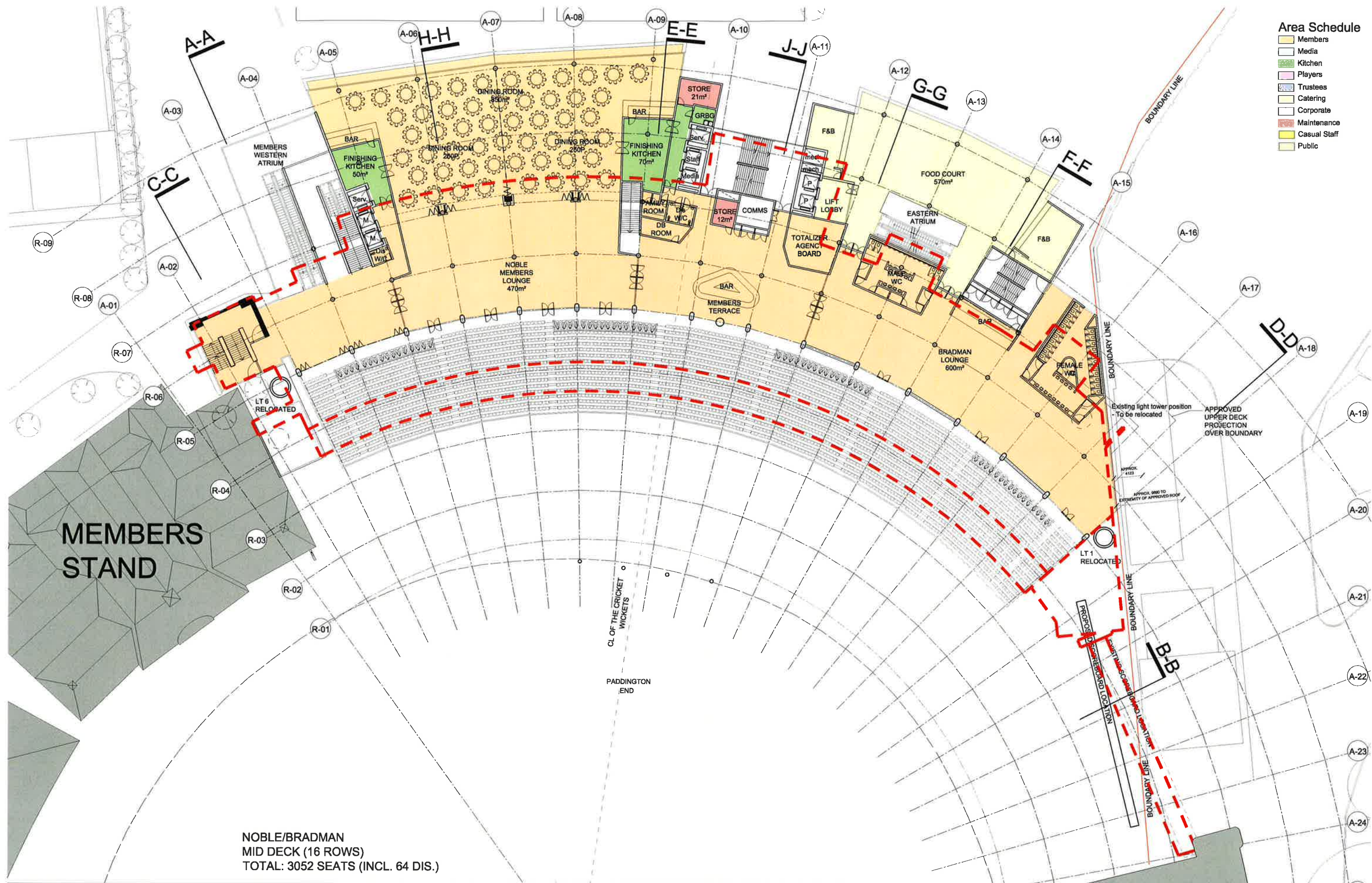



1:250@A1 / 1:500@A3

SCG STAGE 2: NORTHERN STAND

D-05A - COMPARISON

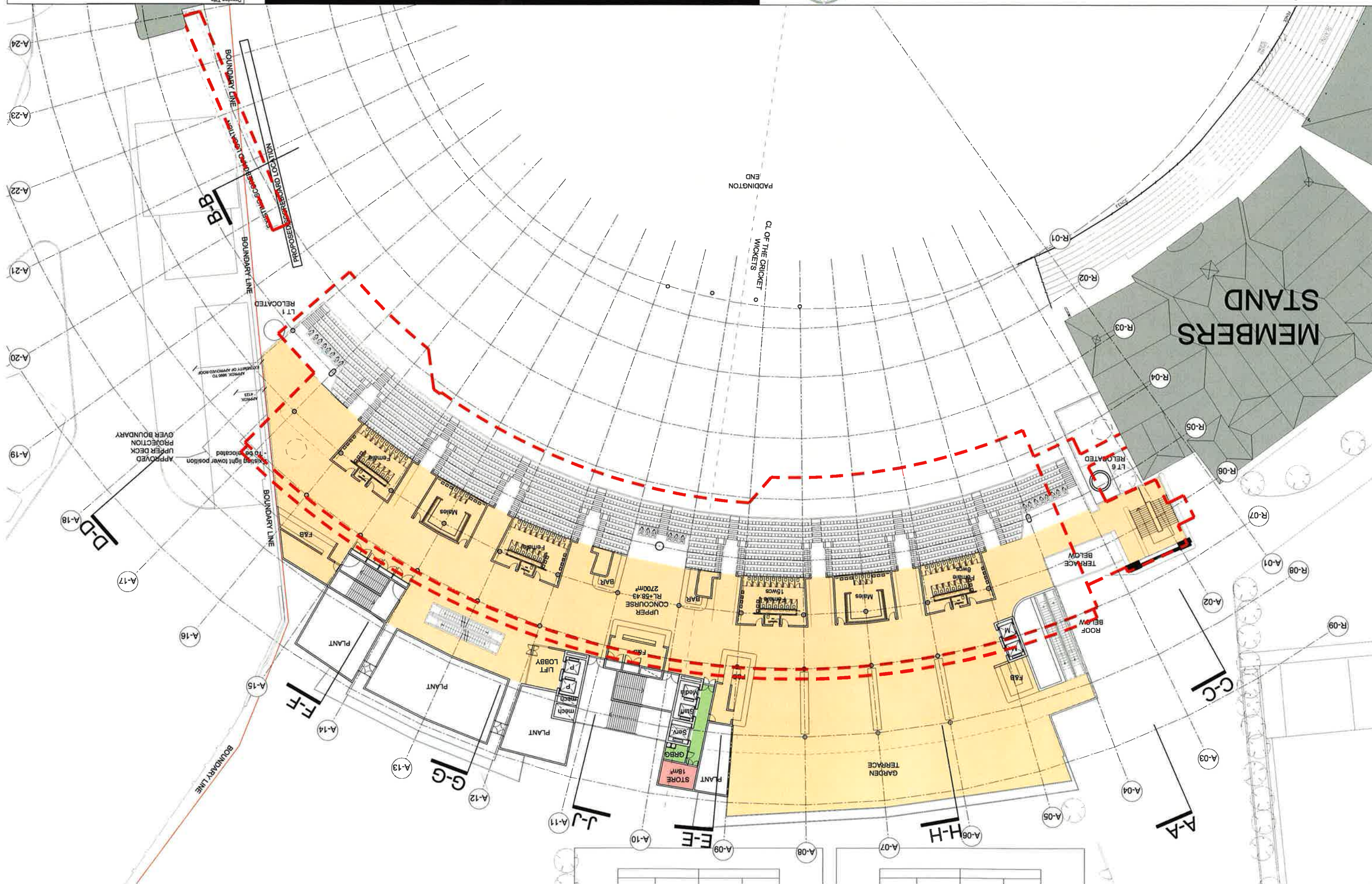

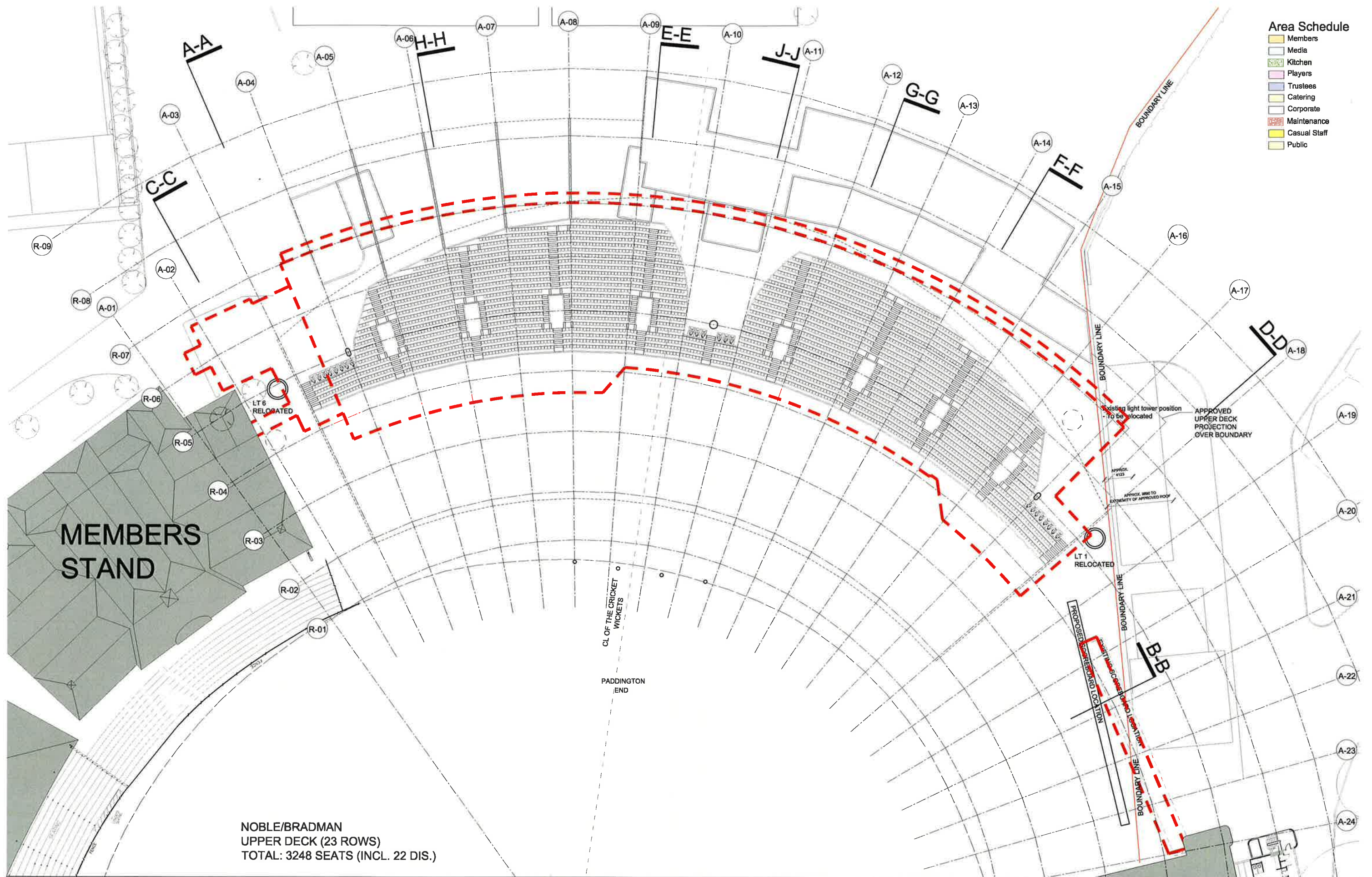

NOBLE/BRADMAN
UPPER DECK (23 ROWS)
TOTAL: 3248 SEATS (INCL. 22 DIS.)

Cox Richardson

Level 2, 204 Clarence Street, Sydney 2000 Australia
Tel : 612 9287 9599 Fax : 612 9264 5844
Email : sydney@cox.com.au

Architecture Planning Urban design Interior design Health facility design

COX



SCG STAGE 2: NORTHERN STAND

SYDNEY CRICKET GROUND, PADDINGTON

1:250@A1 / 1:500@A3

Drawing Title

LEVEL 4 PLAN

Drawing Number

D-06B - COMPARISON

Date

SEPT-2011



Cox Architecture Pty Ltd ACN 002 535 881



SCG STAGE 2: NORTHERN STAND

Drawing Title
ROOF PLAN
Drawing Number
D-07A - COMPARISON
Date
SEPT-2011

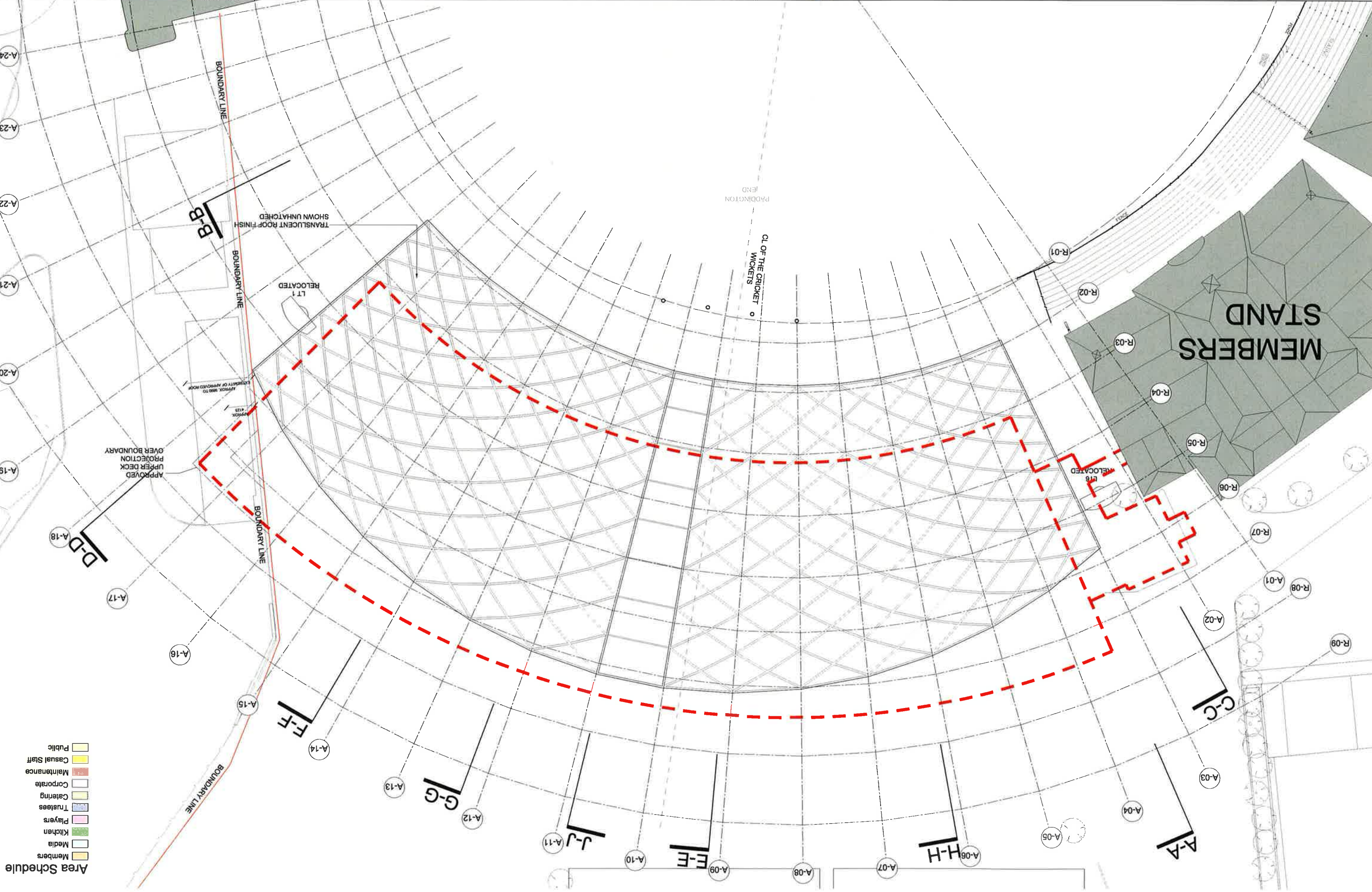
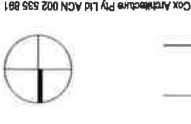

- Area Schedule
- Public
 - Casual Staff
 - Maintenance
 - Corporate
 - Catering
 - Trustees
 - Players
 - Kitchen
 - Media
 - Members