

SM13 AF204 DA02

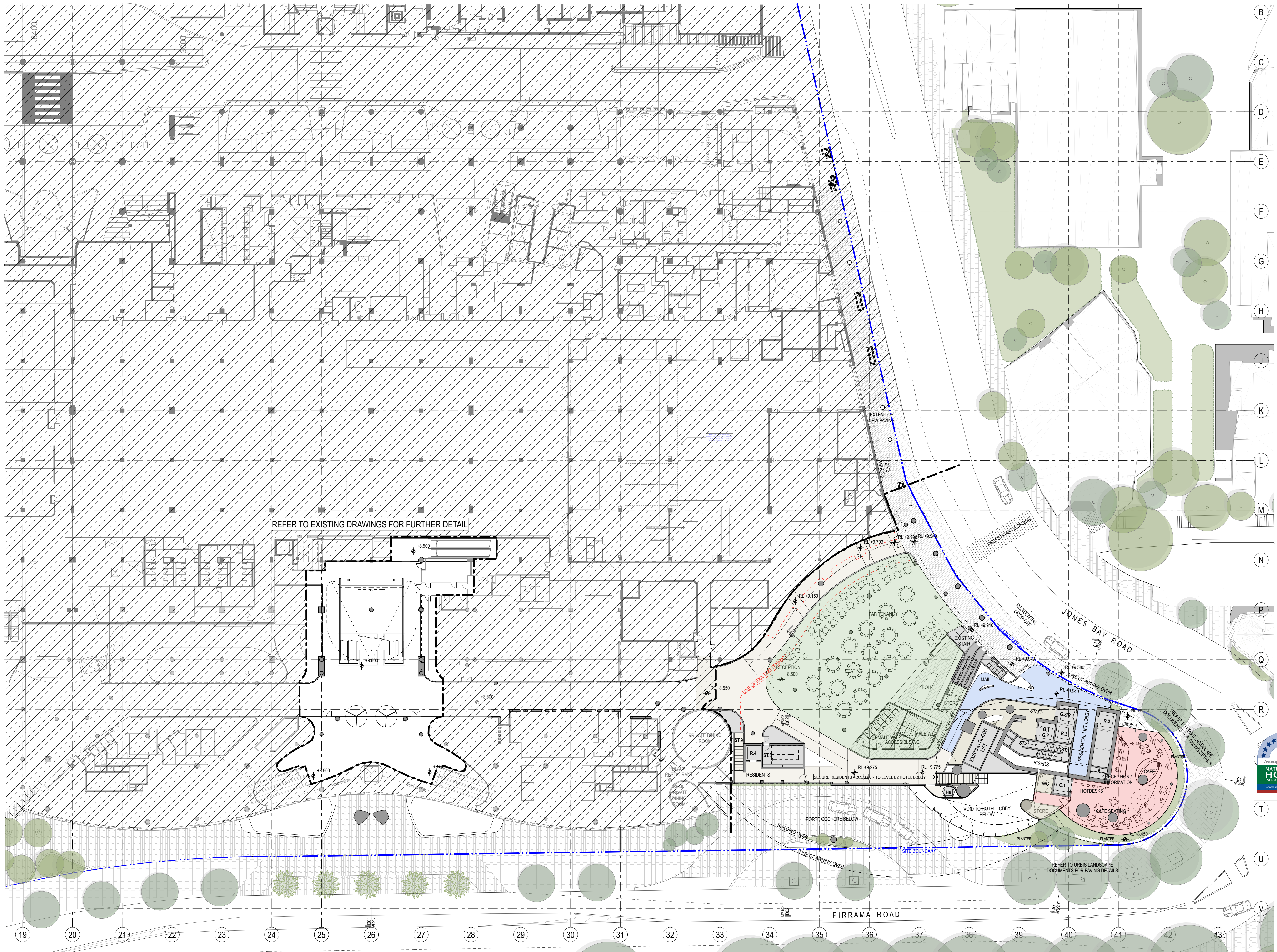



**GENERAL NOTES**

- ALL DIMENSIONS AND EXISTING CONDITIONS SHALL BE CHECKED AND VERIFIED BY THE CONTRACTOR BEFORE PROCEEDING WITH THE WORK
- ALL LEVELS RELATIVE TO 'AUSTRALIAN HEIGHT DATUM'
- DO NOT SCALE DRAWINGS
- USE FIGURED DIMENSIONS ONLY

- Legend
- BUILDING USE**
- HOTEL
  - HOTEL FACILITIES
  - LOADING, PLANT
  - LIFTS, FIRE STAIRS, SERVICES
  - ANCILLARY, BOH
  - CIRCULATION
  - NEIGHBOURHOOD CENTRE
  - RETAIL
  - FOOD & BEVERAGE
  - RESIDENTIAL
  - RESIDENTIAL FACILITIES

**SITE BOUNDARY**

EXISTING BUILT FORM

EXISTING BUILT FORM

EXTENT OF CAR STACKER BELOW

EXTEND OF MODIFICATION 13 WORK AS SHOWN ON FURT DOCUMENT REFER TO DWP DRAWING FOR FULL EXTEND & DEMARCATION OF MODIFICATION 13 WORK.

**NOTE: SPATIAL PROVISION INCLUDED TO ACCOMMODATE AS1428.1. UPDATES AS REQUIRED AT DETAILED DESIGN**

**8.0**  
Average star rating  
**NATIONWIDE HOUSE**  
Ready to move in

Certificate Number: GAD1RM2336  
Assessor Name: Nicholas Asha  
Accreditation number: VIC/BAV161712  
Certificate date: 2 Aug 2018  
Dwelling address: 20-80 Pyrmont St, Pyrmont NSW 2009  
www.nathers.gov.au

REFER TO URBIS LANDSCAPE DOCUMENTS FOR PAVING DETAILS

DA02	2/11/18	Response to Submissions	JRS	SMP
DA01	1/9/17	DEVELOPMENT APPLICATION	NY	SMP
rev	date	name	by	chk

fjmt studio architecture interiors landscape urban community  
sydney melbourne uk  
Level 5, 70 King Street E +61 2 9251 7077 [www.fjmtstudio.com](http://www.fjmtstudio.com)

project  
**Modification 13**  
80 PYRMONT STREET  
PYRMONT NSW 2009

**General Arrangement Plans**  
**Level 00 Residential Entry Ground Floor Plan**

scale	1:300 @ A1	first issued	1/9/17
project code	sheet no.	revision	
SM13	AF1000	DA02	



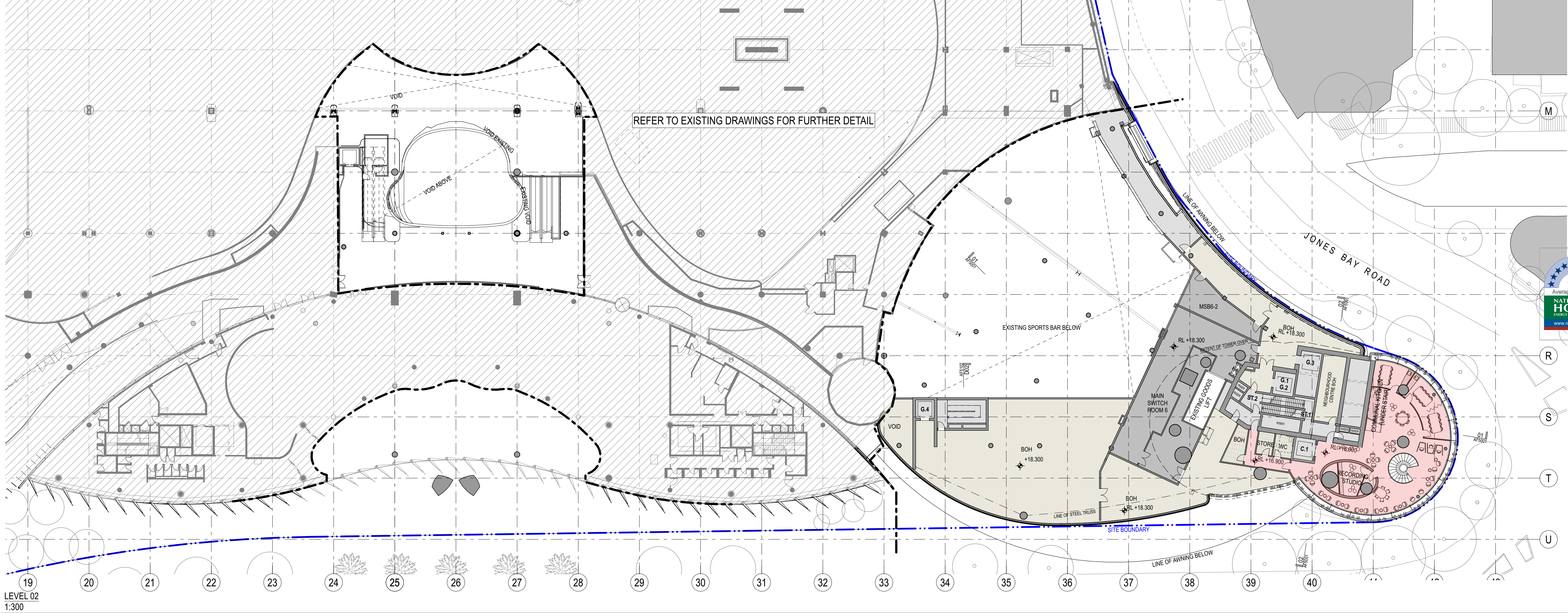
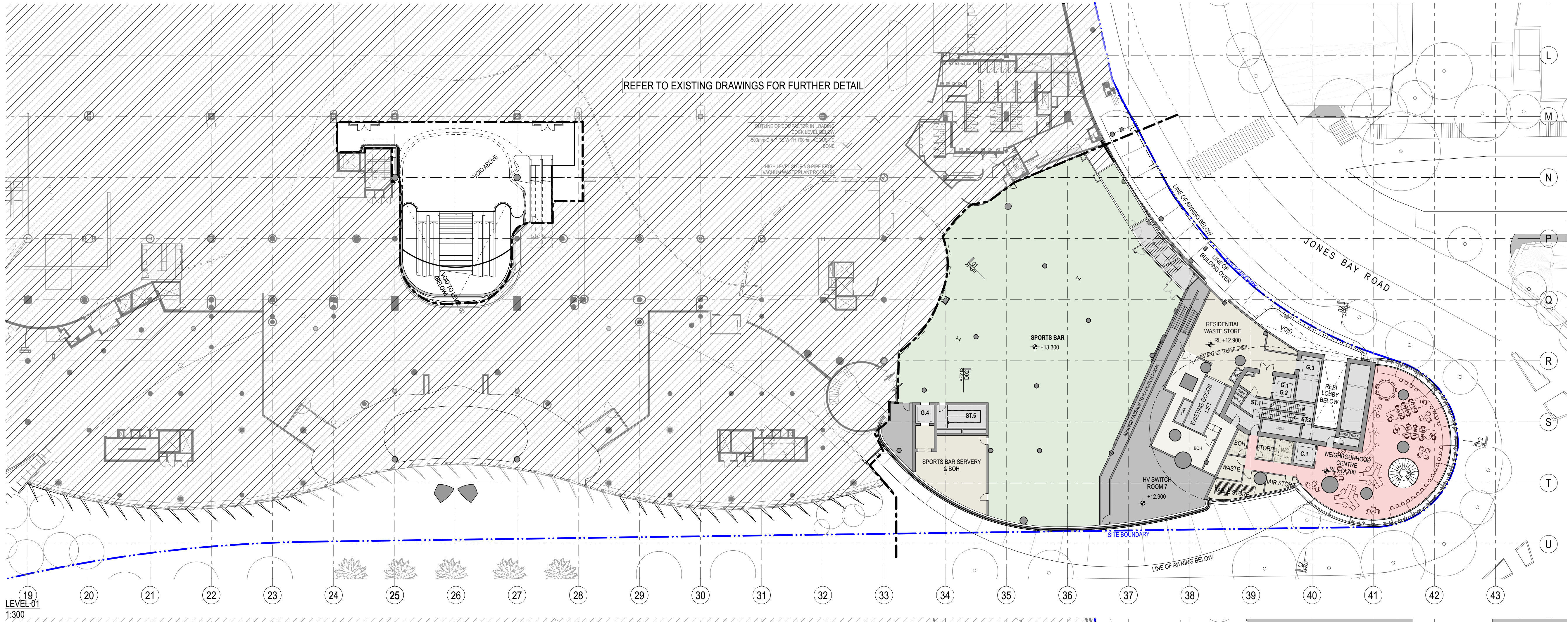

**GENERAL NOTES**

- ALL DIMENSIONS AND EXISTING CONDITIONS SHALL BE CHECKED AND VERIFIED BY THE CONTRACTOR BEFORE PROCEEDING WITH THE WORK
- ALL LEVELS RELATIVE TO 'AUSTRALIAN HEIGHT DATUM'
- DO NOT SCALE DRAWINGS
- USE FIGURED DIMENSIONS ONLY

- legend
- BUILDING USE**
- HOTEL
  - HOTEL FACILITIES
  - LOADING, PLANT
  - LIFTS, FIRE STAIRS, SERVICES
  - ANCILLARY, BOH
  - CIRCULATION
  - NEIGHBOURHOOD CENTRE
  - RETAIL
  - FOOD & BEVERAGE
  - RESIDENTIAL
  - RESIDENTIAL FACILITIES

**SITE BOUNDARY**

EXISTING BUILT FORM

EXISTING BUILT FORM

EXTENT OF CAR STACKER BELOW

EXTEND OF MODIFICATION 13 WORK AS SHOWN ON FURTHER DOCUMENT REFER TO DWP DRAWING FOR FULL EXTEND & DEMARCATION OF MODIFICATION 13 WORK.

**NOTE: SPATIAL PROVISION INCLUDED TO ACCOMMODATE AS1428.1. UPDATES AS REQUIRED AT DETAILED DESIGN**

**8.0**  
Average star rating  
**NATIONWIDE HOUSE**  
www.nathans.gov.au

Certificate Number: GAD1RM2336  
Assessor Name: Nicholas Asha  
Accreditation number: VIC/BAV161712  
Certificate date: 2 Aug 2018  
Dwelling address: 20-80 Pyrmont St, Pyrmont NSW 2009  
www.nathans.gov.au

**QR CODE**  
https://www.fjmt.com.au/GAD1RM2336/QRCode

DA03	2/11/18	Response to Submissions	JRS	SMP
DA02	2/7/18	DEVELOPMENT APPLICATION - Updated	KIK	SMP
DA01	1/9/17	DEVELOPMENT APPLICATION	NY	SMP
rev	date	name		by

**fjmt** studio architecture interiors landscape urban community  
sydney melbourne uk  
Level 5, 70 King Street E +61 2 9251 7077 • [fjmt@studio.com](mailto:fjmt@studio.com)

project  
**Modification 13**  
80 PYRMONT STREET  
PYRMONT NSW 2009

title  
**General Arrangement Plans**  
**Level 01 + 02 Floor Plan**

scale 1:300 @ A1 first issued 1/9/17  
project code SM13 sheet no. AF1001 revision DA03





**GENERAL NOTES**  
ALL DIMENSIONS AND EXISTING CONDITIONS SHALL BE  
CHECKED AND VERIFIED BY THE CONTRACTOR  
BEFORE PROCEEDING WITH THE WORK  
ALL LEVELS RELATIVE TO 'AUSTRALIAN HEIGHT DATUM'  
DO NOT SCALE DRAWINGS  
USE FIGURED DIMENSIONS ONLY

- Legend
- BUILDING USE**
- HOTEL
  - HOTEL FACILITIES
  - LOADING, PLANT
  - LIFTS, FIRE STAIRS, SERVICES
  - ANCILLARY, BOH
  - CIRCULATION
  - NEIGHBOURHOOD CENTRE
  - RETAIL
  - FOOD & BEVERAGE
  - RESIDENTIAL
  - RESIDENTIAL FACILITIES
- SITE BOUNDARY**
- EXISTING BUILT FORM**
- EXISTING BUILT FORM**
- EXTENT OF CAR STACKER BELOW**

EXTEND OF MODIFICATION 13 WORK AS  
SHOWN ON FURT DOCUMENT RIFER TO  
DWP DRAWING FOR FULL EXTEND &  
DEMARCATON OF MODIFICATION 13 WORK.

**NOTE: SPATIAL PROVISION INCLUDED TO ACCOMMODATE  
AS1428.1, UPDATES AS REQUIRED AT DETAILED DESIGN**

**8.0**  
Average star rating  
**NATIONWIDE  
HOUSE**  
Ready to move in  
www.nathers.gov.au

Certificate Number:  
Assessor Name:  
Accreditation number:  
Certificate date:  
Dwelling address:  
20-80 Pyrmont St,  
Pyrmont NSW 2009  
www.nathers.gov.au

GAD1RM2336  
Nicholas Asha  
VIC/BDVH161712  
2 Aug 2018  
www.nathers.gov.au

https://www.fjmt.com.au  
GAD1RM2336/03/01/01

DA02	2/11/18	Response to Submissions	JRS	SMP
DA01	1/9/17	DEVELOPMENT APPLICATION	NY	SMP
rev	date	name	by	chk

fjmt studio architecture interiors landscape urban community  
sydney melbourne uk  
Level 5, 70 King Street E +61 2 9251 7077 www.fjmtstudio.com

project  
**Modification 13**  
80 PYRMONT STREET  
PYRMONT NSW 2009

title  
**General Arrangement Plans**  
**Level 03 Floor Plan**

scale	1:300 @ A1	first issued	1/9/17
project code	sheet no.	revision	
<b>SM13</b>	<b>AF1003</b>	<b>DA02</b>	



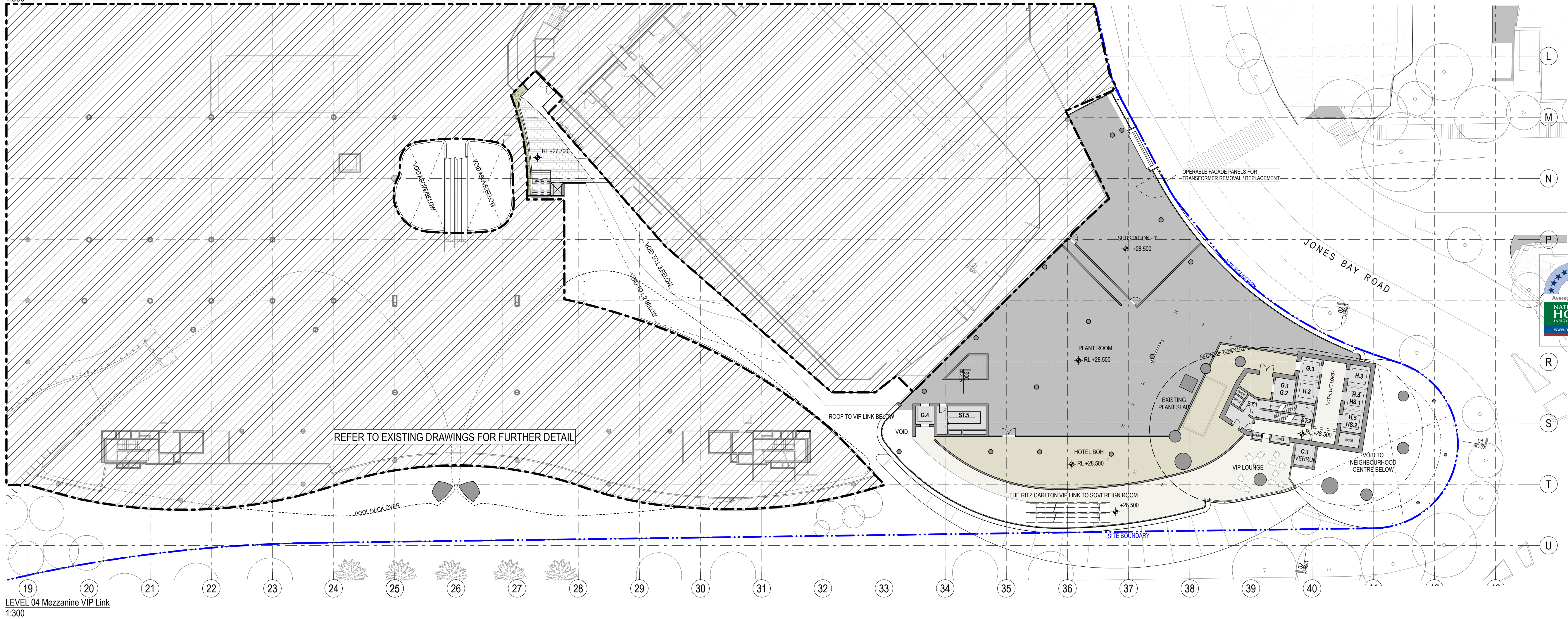
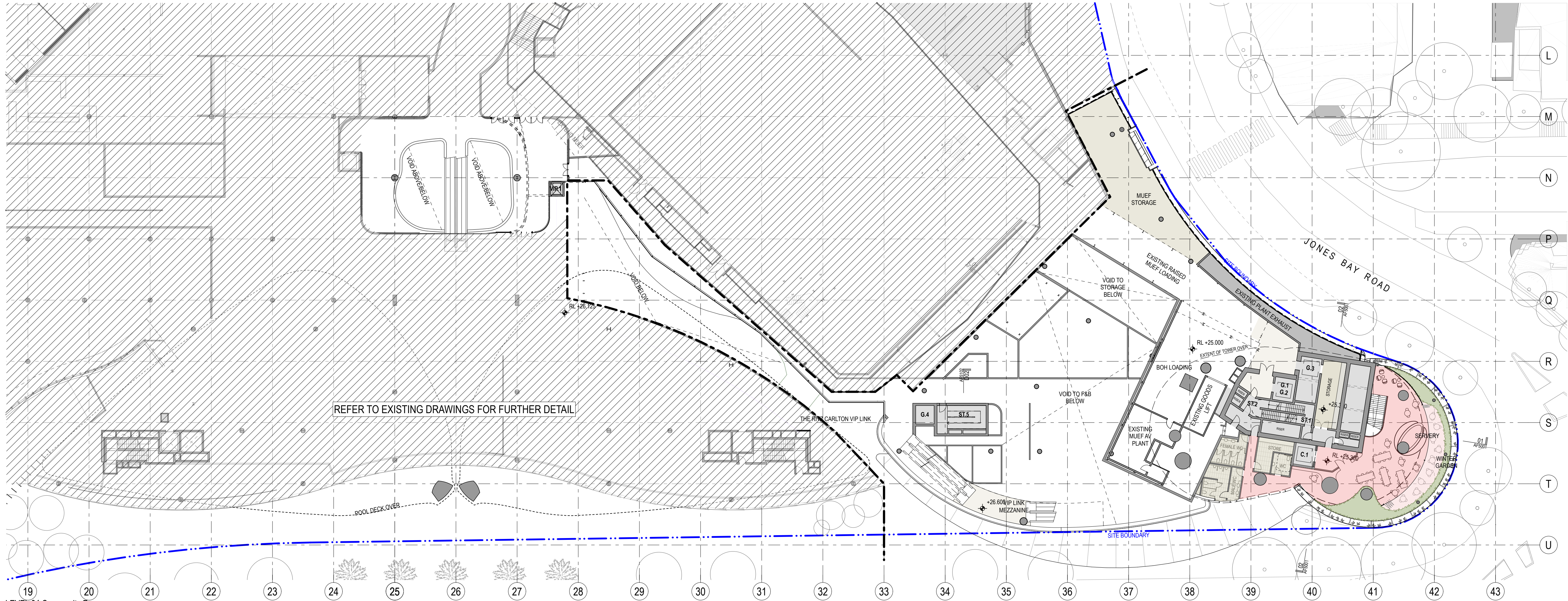

**GENERAL NOTES**  
ALL DIMENSIONS AND EXISTING CONDITIONS SHALL BE  
CHECKED AND VERIFIED BY THE CONTRACTOR  
BEFORE PROCEEDING WITH THE WORK  
ALL LEVELS RELATIVE TO 'AUSTRALIAN HEIGHT DATUM'  
DO NOT SCALE DRAWINGS  
USE FIGURED DIMENSIONS ONLY

- legend
- BUILDING USE**
- HOTEL
  - HOTEL FACILITIES
  - LOADING, PLANT
  - LIFTS, FIRE STAIRS, SERVICES
  - ANCILLARY, BOH
  - CIRCULATION
  - NEIGHBOURHOOD CENTRE
  - RETAIL
  - FOOD & BEVERAGE
  - RESIDENTIAL
  - RESIDENTIAL FACILITIES

**SITE BOUNDARY**

EXISTING BUILT FORM

EXISTING BUILT FORM

EXTENT OF CAR STACKER BELOW

EXTEND OF MODIFICATION 13 WORK AS SHOWN ON FMT DOCUMENT RIFER TO DWP DRAWING FOR FULL EXTEND & DEMARCATION OF MODIFICATION 13 WORK.

**NOTE: SPATIAL PROVISION INCLUDED TO ACCOMMODATE AS1428.1. UPDATES AS REQUIRED AT DETAILED DESIGN**



DA02	2/11/18	Response to	JRS	SMP
DA01	1/9/17	DEVELOPMENT	NY	SMP
rev	date	name	by	chk

fjmt studio architecture interiors landscape urban community  
sydney melbourne uk  
Level 5, 70 King Street E • 61 2 9251 7077 • [www.fjmt.com.au](http://www.fjmt.com.au)

project  
**Modification 13**  
80 PYRMONT STREET  
PYRMONT NSW 2009

title  
**General Arrangement Plans**  
**Level 04 + 04 Mezz Floor Plan**

scale	1:300 @ A1	first issued	1/9/17
project code	SM13	sheet no.	AF1004
		revision	DA02