

**GENERAL NOTES**

- ALL DIMENSIONS AND EXISTING CONDITIONS SHALL BE CHECKED AND VERIFIED BY THE CONTRACTOR BEFORE PROCEEDING WITH THE WORK
- ALL LEVELS RELATIVE TO 'AUSTRALIAN HEIGHT DATUM'
- DO NOT SCALE DRAWINGS
- USE FIGURED DIMENSIONS ONLY

- legend
- BUILDING USE**
- HOTEL
  - HOTEL FACILITIES
  - LOADING, PLANT
  - LIFTS, FIRE STAIRS, SERVICES
  - ANCILLARY, BOH
  - CIRCULATION
  - NEIGHBOURHOOD CENTRE
  - RETAIL
  - FOOD & BEVERAGE
  - RESIDENTIAL
  - RESIDENTIAL FACILITIES

**SITE BOUNDARY**

**EXISTING BUILT FORM**

**EXISTING BUILT FORM**

**EXTENT OF CAR STACKER BELOW**

EXTEND OF MODIFICATION 13 WORK AS SHOWN ON FJMT DOCUMENT REFER TO DWP DRAWING FOR FULL EXTEND & DEMARCATION OF MODIFICATION 13 WORK.

**NOTE: SPATIAL PROVISION INCLUDED TO ACCOMMODATE AS1428.1, UPDATES AS REQUIRED AT DETAILED DESIGN**

**8.0**  
Average star rating  
**NATIONWIDE HOUSE**  
Quality Standard  
www.nathers.gov.au

Certificate Number: GAD1RM2336  
Assessor Name: Nicholas Asha  
Accreditation number: VIC/BDAY161712  
Certificate date: 2 Aug 2018  
Dwelling address: 20-80 Pyrmont St, Pyrmont NSW 2009  
www.nathers.gov.au

QR code linking to the certificate details.

DA02	2/11/18	Response to Submissions	JRS	SMP
DA01	1/9/17	DEVELOPMENT APPLICATION	NY	SMP
rev	date	name	by	chk

fjmt studio architecture interiors landscape urban community  
sydney melbourne uk  
Level 5, 70 King Street • +61 2 9251 7077 • www.fjmtstudio.com

project  
**Modification 13**  
80 PYRMONT STREET  
PYRMONT NSW 2009

title  
**General Arrangement Plans**  
**Level 01 Floor Plan**

scale	1:150 @ A1	first issued	1/9/17
project code	sheet no.	revision	
SM13	AF2001	DA02	



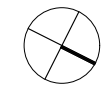
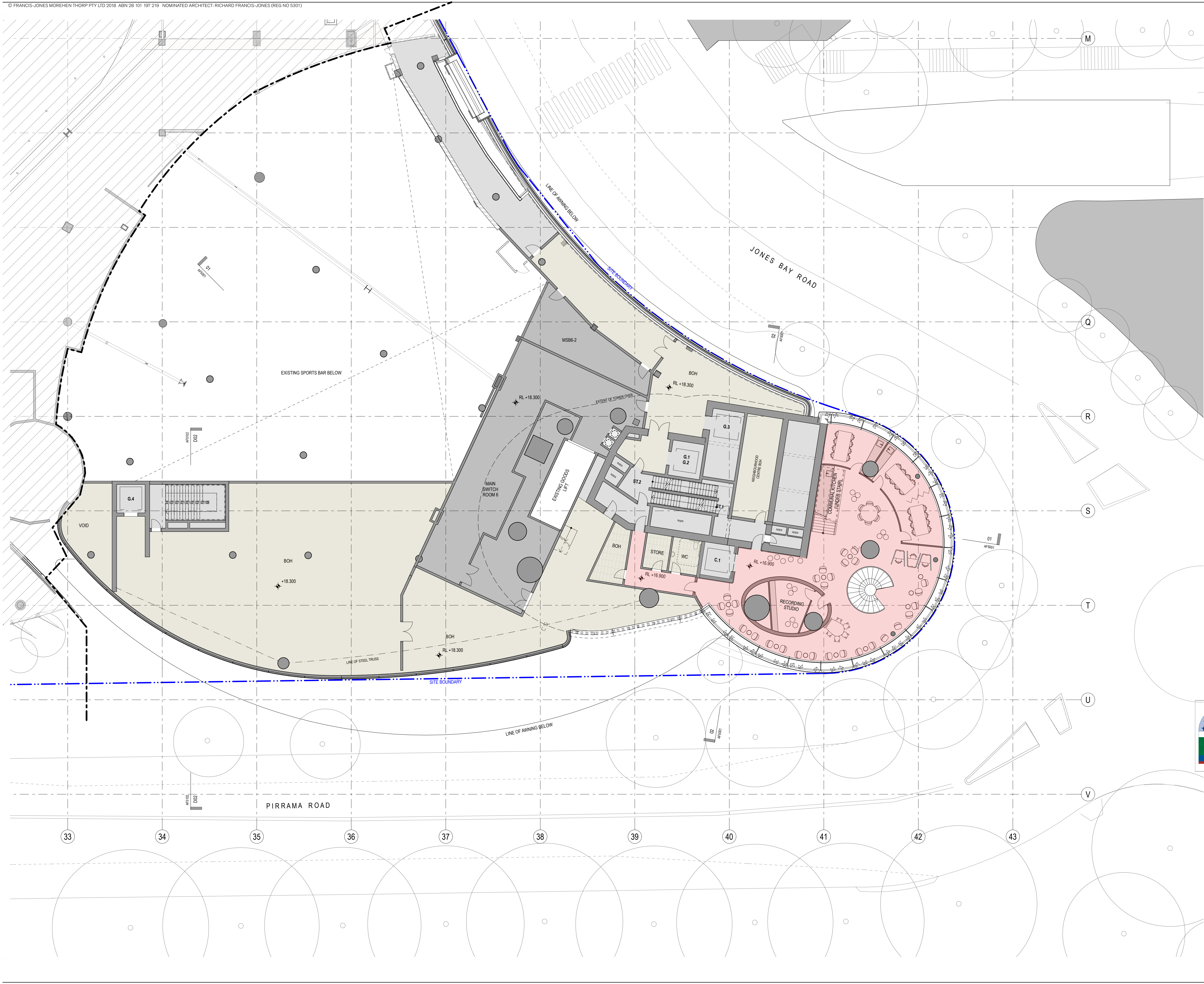

- GENERAL NOTES**
- ALL DIMENSIONS AND EXISTING CONDITIONS SHALL BE CHECKED AND VERIFIED BY THE CONTRACTOR BEFORE PROCEEDING WITH THE WORK
  - ALL LEVELS RELATIVE TO 'AUSTRALIAN HEIGHT DATUM'
  - DO NOT SCALE DRAWINGS
  - USE FIGURED DIMENSIONS ONLY

- legend**
- BUILDING USE**
- HOTEL
  - HOTEL FACILITIES
  - LOADING, PLANT
  - LIFTS, FIRE STAIRS, SERVICES
  - ANCILLARY, BOH
  - CIRCULATION
  - NEIGHBOURHOOD CENTRE
  - RETAIL
  - FOOD & BEVERAGE
  - RESIDENTIAL
  - RESIDENTIAL FACILITIES

- SITE BOUNDARY**
- EXISTING BUILT FORM**
- EXISTING BUILT FORM**
- EXTENT OF CAR STACKER BELOW**
- EXTEND OF MODIFICATION 13 WORK AS SHOWN ON FJMT DOCUMENT REFER TO DWP DRAWING FOR FULL EXTEND & DEMARCATION OF MODIFICATION 13 WORK.
- NOTE: SPATIAL PROVISION INCLUDED TO ACCOMMODATE AS1428.1. UPDATES AS REQUIRED AT DETAILED DESIGN**



DA02	2/11/18	Response to Submissions	JRS	SMP
DA01	1/9/17	DEVELOPMENT APPLICATION	NY	SMP
rev	date	name	by	chk

fjmt studio architecture interiors landscape urban community  
sydney melbourne uk  
Level 5, 70 King Street • +61 2 9251 7077 • [fjmtstudio.com](http://fjmtstudio.com)



project  
**Modification 13**  
80 PYRMONT STREET  
PYRMONT NSW 2009

title  
**General Arrangement Plans**  
**Level 02 Floor Plan**

scale	1:150 @ A1	first issued	1/9/17
project code	sheet no.	revision	
<b>SM13</b>	<b>AF2002</b>	<b>DA02</b>	



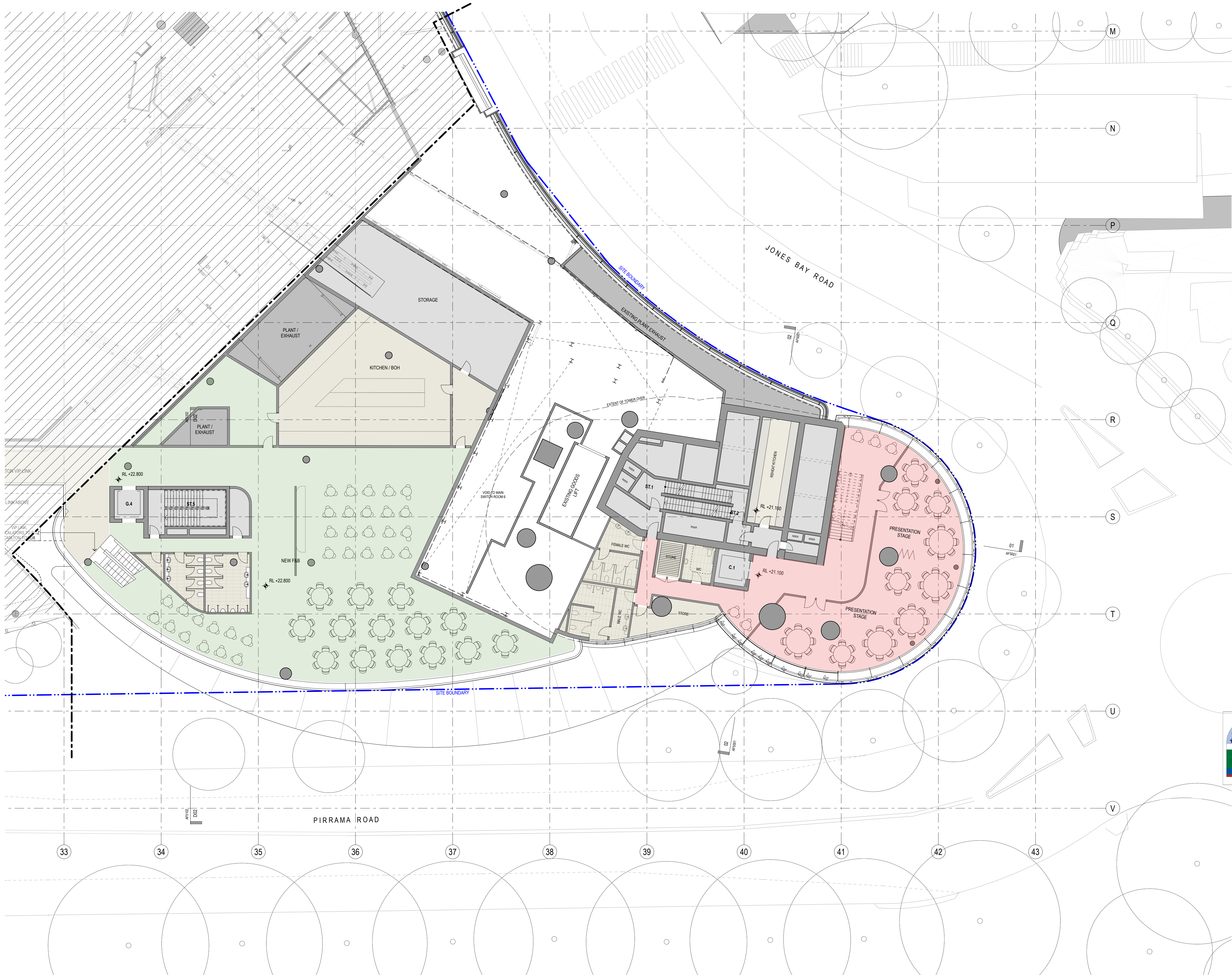

**GENERAL NOTES**

- ALL DIMENSIONS AND EXISTING CONDITIONS SHALL BE CHECKED AND VERIFIED BY THE CONTRACTOR BEFORE PROCEEDING WITH THE WORK
- ALL LEVELS RELATIVE TO 'AUSTRALIAN HEIGHT DATUM'
- DO NOT SCALE DRAWINGS
- USE FIGURED DIMENSIONS ONLY

Legend

**BUILDING USE**

- HOTEL
- HOTEL FACILITIES
- LOADING, PLANT
- LIFTS, FIRE STAIRS, SERVICES
- ANCILLARY, BOH
- CIRCULATION
- NEIGHBOURHOOD CENTRE
- RETAIL
- FOOD & BEVERAGE
- RESIDENTIAL
- RESIDENTIAL FACILITIES

**SITE BOUNDARY**

**EXISTING BUILT FORM**

**EXTENT OF CAR STACKER BELOW**

EXTEND OF MODIFICATION 13 WORK AS SHOWN ON FURTHER DOCUMENT REFER TO DWP DRAWING FOR FULL EXTEND & DEMARCATION OF MODIFICATION 13 WORK.

**NOTE: SPATIAL PROVISION INCLUDED TO ACCOMMODATE AS1428.1, UPDATES AS REQUIRED AT DETAILED DESIGN**

**8.0**  
Average star rating  
**NATIONWIDE HOUSE**  
Quality Standard  
www.nathers.gov.au

Certificate Number: GAD1RM2336  
Assessor Name: Nicholas Asha  
Accreditation number: VIC/BDVH161712  
Certificate date: 2 Aug 2018  
Dwelling address: 20-80 Pyrmont St, Pyrmont NSW 2009  
www.nathers.gov.au

QR Code: https://www.fjmt.com.au/q/GAD1RM2336/0301

DA02	2/11/18	Response to Submissions	JRS	SMP
DA01	1/9/17	DEVELOPMENT APPLICATION	NY	SMP
rev	date	name	by	chk

fjmt studio architecture interiors landscape urban community  
sydney melbourne uk  
Level 5, 70 King Street • +61 2 9251 7077 • [fjmtstudio.com](http://fjmtstudio.com)

**project**  
**Modification 13**  
80 PYRMONT STREET  
PYRMONT NSW 2009

**title**  
**General Arrangement Plans**  
**Level 03 Floor Plan**

scale	1:150 @ A1	first issued	1/9/17
project code	sheet no.	revision	
<b>SM13</b>	<b>AF2003</b>	<b>DA02</b>	