

NOTE: PROPOSED STORMWATER PITS
IN SWALE TO BE SURFACE INLET TYPE
WITH DEPRESSED LIDS

- LEGEND
- CATCHMENT AREA BOUNDARY
 - STORMWATER PIT & PIPES
 - (A/7) DENOTES PIT NUMBER
 - A/7 DENOTES CATCHMENT AREA

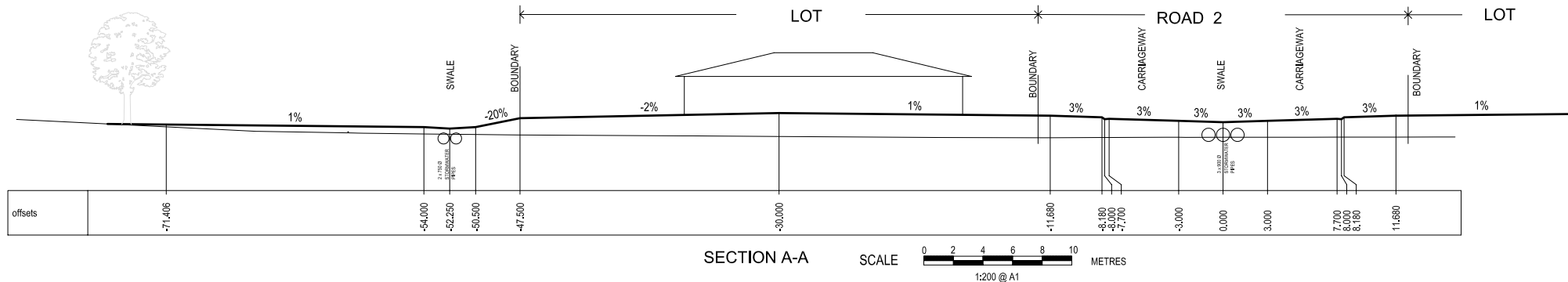

KING + CAMPBELL
with
craig teasdale
architect

1st Floor, Colonial Arcade
25-27 Hay Street
Port Macquarie NSW 2444

PO Box 243
Port Macquarie 2444

T: 02 6586 2555
F: 02 6583 4064

E: info@kingcampbell.com.au

Rev A
Date 13.07.06
Description Issued for Approval

Scale AS SHOWN
Datum AHD

Caution: The stated scale of this drawing may have been altered by copying or other means. The scale should be verified prior to using the drawing to derive measurements.

Copyright King & Campbell Pty Ltd

Project Number 14777
Drawing Number 14777SMP2.DWG
DA Number
Drawn ES
Checked PJR
Date Created JUNE 2006

Drawing Title DETAILED STORMWATER MANAGEMENT PLAN

Project LOT 124 DP 1097510 AND LOT 22 DP 1071657 SEASCAPE GROVE SOUTH WEST ROCKS

Client WALDEL PARK PTY LTD