

K:\C REF: L:\14777_SEASCAPE GROVE\AutoCad\14777P_Plan.dwg - A3(L)- SECTION PLAN, 09-Sep-2008, danielv

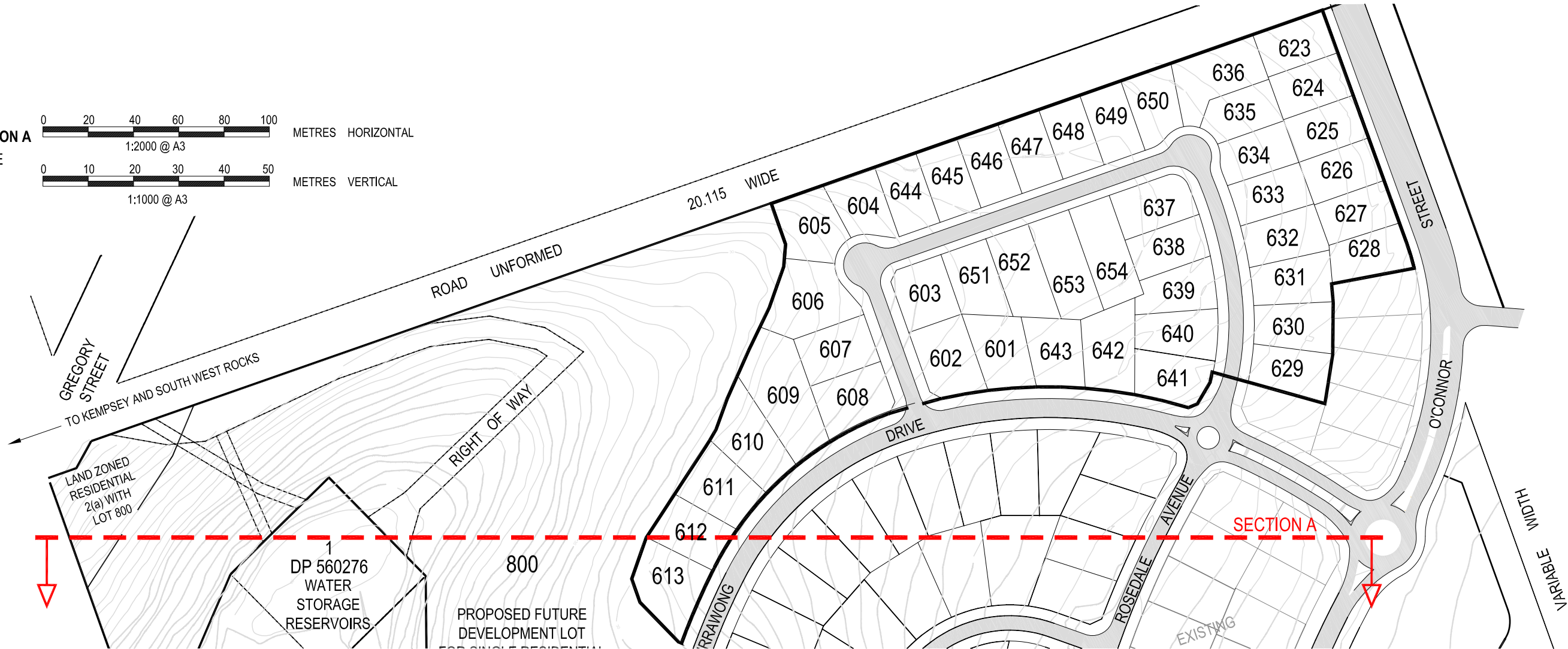
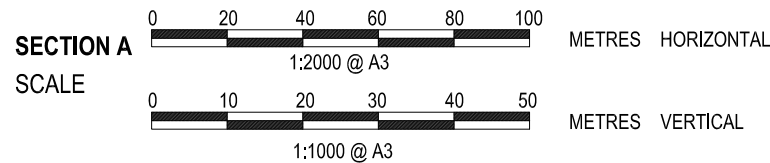
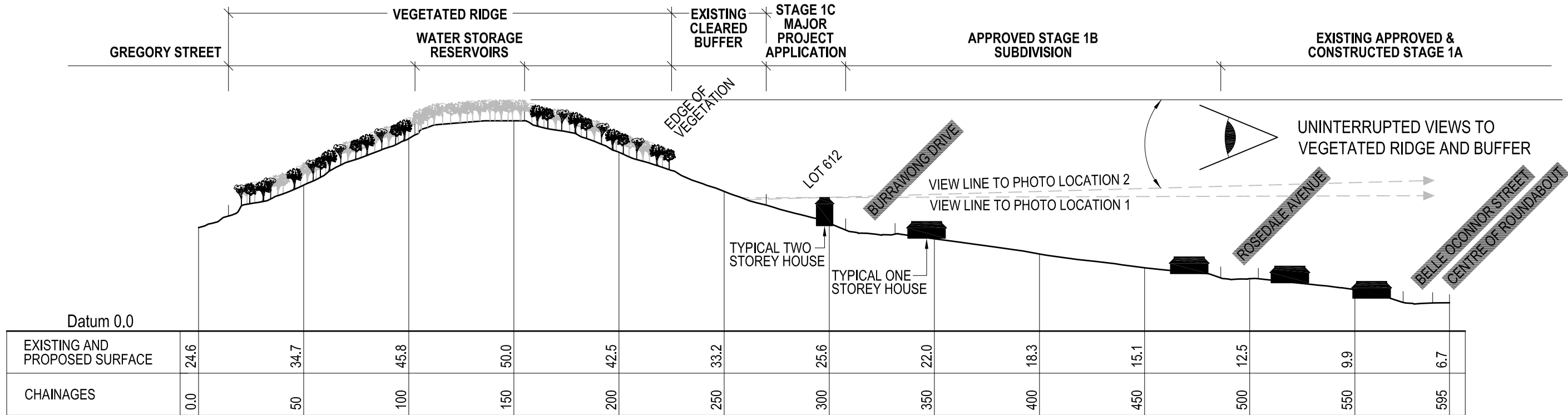

KING + CAMPBELL

King & Campbell Pty Ltd
www.kingcampbell.com.au
A: PO Box 243 Port Macquarie NSW 2444
T: 02 6586 2555
F: 02 6583 4064
E: info@kingcampbell.com.au

REV.	DATE	DESCRIPTION
A	01.08.08	ISSUED FOR INFORMATION

DATUM: AHD SCALE: 1:2000 @ A3

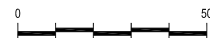

NOTE: DO NOT SCALE OFF DRAWINGS. USE FIGURED DIMENSIONS ONLY. REPORT ANY DISCREPANCIES TO THE AUTHOR. THIS DRAWING, BEING THE PROPERTY OF KING & CAMPBELL PTY LTD, IS PROTECTED BY COPYRIGHT AND MUST NOT BE USED, REPRODUCED OR COPIED WHOLLY OR IN PART WITHOUT THE WRITTEN PERMISSION OF KING & CAMPBELL PTY LTD.

© King & Campbell Pty Ltd

PROJECT NO:	14777	DRAWING TITLE:	EXHIBIT 14 - VISUAL ASSESSMENT SECTION		
DA NO:		PROJECT:	SEASCAPE GROVE STAGE 1C PROJECT APPLICATION SOUTH WEST ROCKS		
DESIGNED BY:		CLIENT:	WALDEL PARK PTY LTD		
DRAWN BY:	DV				
CHECKED BY:	TS				
DATE CREATED:	JULY 2008				
			DRAWING NO:	SHEET:	REVISION:
			14777P_Plan.dwg	1	A