

SECTION 8 – SITE PHOTOGRAPHS



Photograph No. 1 – Looking northwest from western boundary of Estate to adjoining residential development.



Photograph No. 2 – Looking along the rear of Lots 605 – 613 showing the managed grassland within 7(d) land on Residue Lot 800 [Asset Protection Zone] & Forest vegetation on the higher ridgeline in the south-western corner of the Estate.



Photograph No. 3 – Looking along the rear of Lot 613 showing managed grassland within 7(d) zoned land on Residue Lot 800 [APZ] and Forest vegetation on the ridgeline.



Photograph No. 4 – Looking southwest from the rear of Lots 614 – 616 to Forest vegetation and Water Reservoir.



Photograph No 5 – Looking west from Lot 615, showing extent of managed Asset Protection Zone to the rear of the lots.



Photograph No. 6 – Looking south along the rear boundary of Lots 614 – 617 showing extent of Asset Protection Zone to these lots, including to the southwest of Lots 617 & 618. Dwelling on the adjoining property is shown in the background.



Photograph No. 7 – Looking southeast across spur to the south of Lots 618 – 622 showing Forest vegetation that will be retained in the 7(d) zoned land [Lot 800]. Proposed lots will be located to the left of the vegetation, within the cleared portion of the Estate.



Photograph No. 8 – Looking northeast from Lot 622, across the approved Estate lands to the managed lands on the adjoining property.



Photograph No. 9 – Looking east from Lot 622, along the southern boundary, showing Forest vegetation on the adjoining rural residential land to the south.



Photograph No. 10 – Looking northeast from the Integrated Development Site [Lot 700], across the adjoining land showing Coastal Heath vegetation.

SECTION 9

ATTACHMENT A – APPROVED PROJECT APPROVAL LAYOUT.



PRELIMINARY ONLY - NOT TO BE USED FOR CONSTRUCTION

SECTION B-B

LEGEND

- TREE TO BE RETAINED
- TREE TO BE REMOVED
- ROCK TREE PROTECTION
- REFER TO SEPARATE SCHEDULE FOR TREE SIZE & SPECIES

WATER SUPPLY NOTES

WATER SUPPLY FOR FIRE FIGHTING WILL BE PROVIDED THROUGH THE POTABLE MAINS SUPPLY. ADDITIONAL ACCESS IF POSSIBLE TO THE COOL WATER RESERVOIR STORMWATER DETENTION POND IN THE NORTH. ALL DWELLINGS WITHIN 100 METRES OF THE HAZARDOUS GAS CANYON APPLICABLE FOR POTENTIAL USE IN REDUCING RISK OF DAMAGE TO PROPERTY IN A BLUSH-FIRE HYDRANTS SHOULD BE LOCATED THROUGHOUT THE SITE AND UTILISE A 60 METRE HOSE WITH A 10 METRE WATER JET IN ACCORDANCE WITH NSW RIS AND BUILDING CODE REQUIREMENTS.

CONSTRUCTION REQUIREMENTS

THE FOLLOWING LEVEL OF CONSTRUCTION IN ACCORDANCE WITH AS/NZS 3958:1989 APPLIES TO DWELLINGS WITHIN LEVEL 2 ANY DWELLINGS BETWEEN 20M AND 30M OF THE FOREST IN THE SOUTH OF THE SITE OR THE HEATH TO THE NORTH OF THE SITE AND 60M FROM THE FOREST IN THE SOUTH OF THE SITE OR THE HEATH TO THE NORTH OF THE SITE. DUE TO VARYING REQUIREMENTS NO DWELLINGS ARE TO BE PLACED WITHIN 100M OF THE EASTERN BOUNDARY WALL. SETBACK REQUIREMENT FOR LEVEL DWELLINGS IN THE REMAINING AREAS OF THE SITE DO NOT REQUIRE BUSHFIRE MEASURES TO BE IMPLEMENTED DURING CONSTRUCTION.

Bushfire Protection Measures & Asset Protection Zones

LOT 124 DP 1087510 AND LOT 22 DP 1071657 SEASCAPE GROVE SOUTH WEST ROCKS

Client: WALTON PARTNERS PTY LTD

Drawing Title: Bushfire Protection Measures & Asset Protection Zones

Project: LOT 124 DP 1087510 AND LOT 22 DP 1071657 SEASCAPE GROVE

Sheet: 18 of 18 Rev: A

ATTACHMENT C – PROPOSED PROJECT LAYOUT – STAGE 1C.

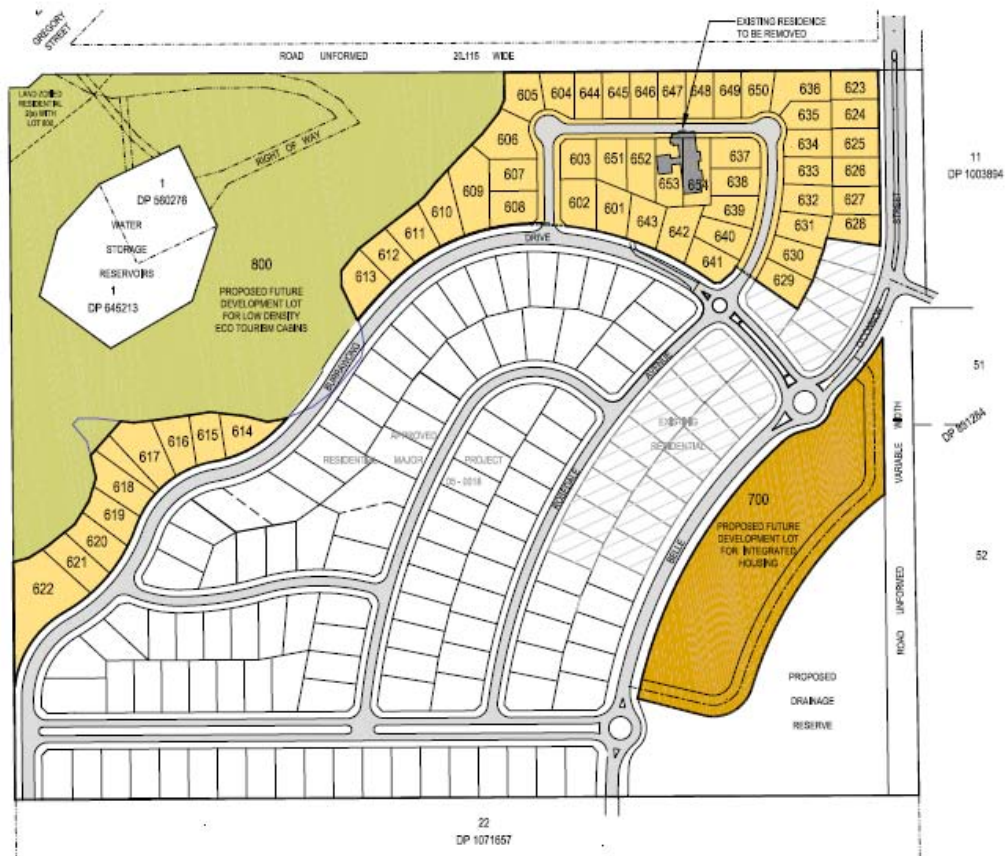

ATTACHMENT D – PLAN OF BUSHFIRE PROTECTION MEASURES



- LEGEND**
- T651 TREE TO BE RETAINED - STAGE 1B (APPROVED)
 - T415 TREE TO BE REMOVED - STAGE 1B (APPROVED)
 - T651 TREE TO BE RETAINED - STAGE 1C
 - T415 TREE TO BE REMOVED - STAGE 1C
 - EDGE OF VEGETATION
 - APPROVED SUBDIVISION MP 05-0018
 - EXISTING STAGE 1 CONSTRUCTED T6-03-593
 - STAGE 1C
 - PARKLAND BUSHFIRE CLEARING BUFFER
 - EDGE OF EXISTING VEGETATION
 - ASSET PROTECTION ZONE - APZ

KING + CAMPBELL

1st Floor, Colonial Arcade
25-27 Hay Street
Port Macquarie NSW 2444

PO Box 243
Port Macquarie NSW 2444

T: 02 6586 2555
F: 02 6583 4064

E: info@kingcampbell.com.au

Rev
A
B

Date
04.10.2007
18.12.2008

Description
ISSUED FOR INFORMATION
APZ AND ANNOTATION AMENDMENTS

Scale 1:1000 @ A1

Datum AHD

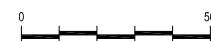

Caution: The stated scale of this drawing may have been altered by copying or other means. The scale should be verified prior to using the drawing to derive measurements.

Copyright King & Campbell Pty Ltd

Project Number 14777
DA Number
Designed PJR
Drawn AB
Checked PJR
Date Created SEPT 2007

Drawing Title EXHIBIT 8: STAGE 1C TREE RETENTION PLAN
AND SE BUSHFIRE ASSETT PROTECTION
Project LOT 124 DP 1097510 SEASCAPE GROVE
STAGE 1C

Client WALDEL PARK PTY LTD Sheet 1 Drawing No. 14777P_TREE

Rev B