

STAGING & LOT TABLE			
STAGE	LOTS	TOTAL	SUPER LOTS
1	DP 280005	COMPLETED - 105	
2	DP 280008	COMPLETED - 44	
3	DP 280021	COMPLETED - 33	
4	DP 280033	COMPLETED - 51	
5	53-103	51	
6	104-140	37	1 Commercial LOT (2299m²) LOT 155
7	141-171	31	
8A	172-218	47	
8B	219-235	17	
9	236-263	28	
10	264	1	1 LOT (12418m²) LOT 264
11			
12	DP 280037	COMPLETED - 50	
13	311-322	12	4 LOTS (16876m²) LOTS 311, 312, 321 & 322
14	323-344	22	2 LOTS (14420m²) LOTS 343 & 344
15	345-376	32	1 LOT (2277m²) LOT 370
16	377-390	14	5 LOTS (23068m²) LOTS 377, 378, 379, 389 & 390
17	391-429	39	
18	430-445	16	4 LOTS (7687m²) LOTS 430, 434, 438 & 442
19	446-456	11	5 LOTS (7852m²) LOTS 447, 448, 454, 455 & 456, 1 Commercial (1166m²) LOT 446
20	457-474	18	6 LOTS (24477m²) LOTS 457, 458, 459, 467, 468 & 469
TOTAL (STAGES 4-20)		376	

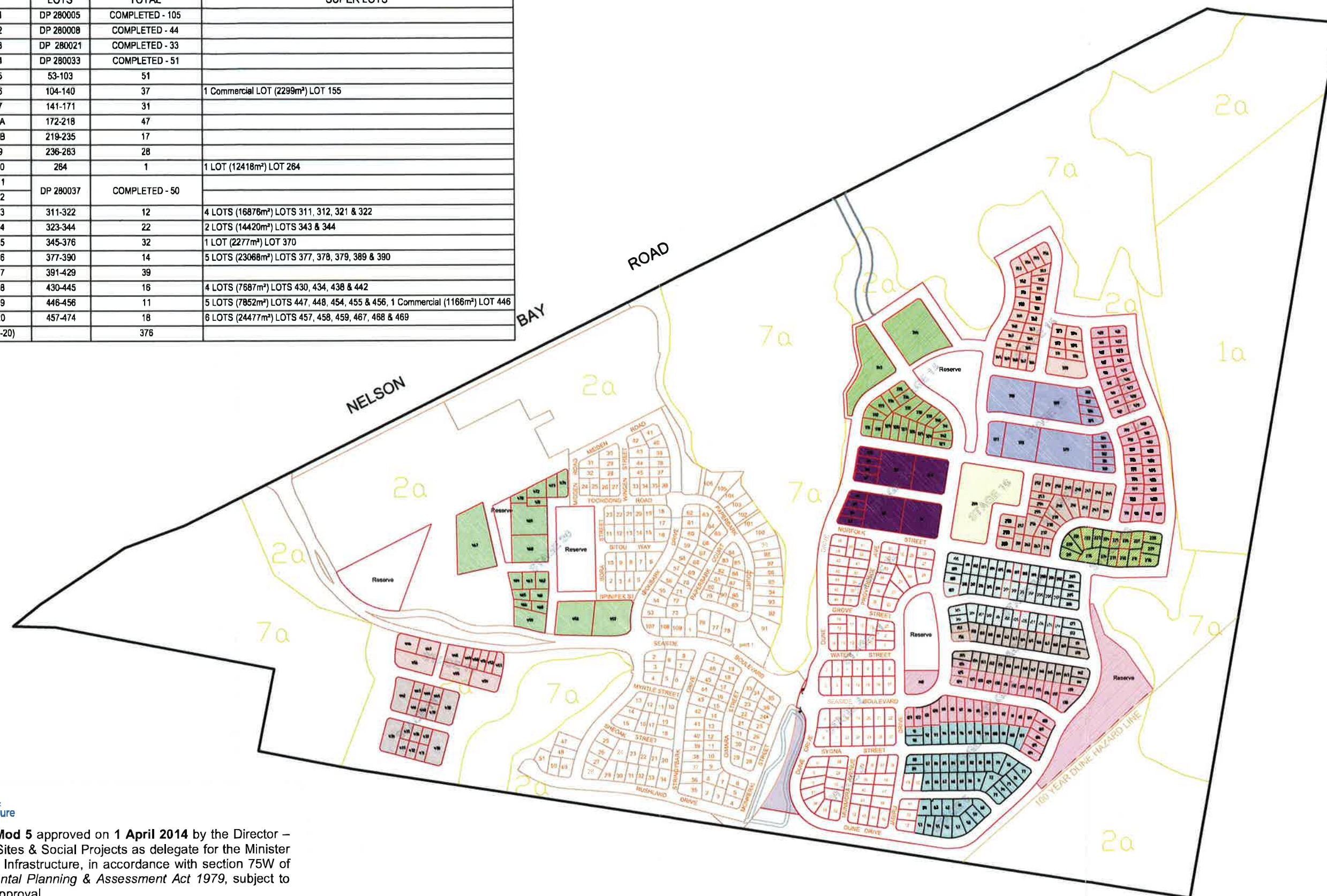

MP 06_0250 Mod 5 approved on 1 April 2014 by the Director – Industry, Key Sites & Social Projects as delegate for the Minister for Planning & Infrastructure, in accordance with section 75W of the *Environmental Planning & Assessment Act 1979*, subject to conditions of approval.

Signed:

COPYRIGHT NOTICE
THE DRAWING & THE INTELLECTUAL PROPERTY CONTAINED HEREIN ALWAYS REMAINS THE PROPERTY OF **NORTH POINT SURVEYS (NSW) P/L** AND SHALL NOT BE COPIED OR REPRODUCED WITHOUT THE WRITTEN PERMISSION OF **NORTH POINT SURVEYS (NSW) P/L** AND SHALL BE USED ONLY BY THE CLIENT OF **NORTH POINT SURVEYS (NSW) P/L** FOR THE PROJECT FOR WHICH IT WAS PROVIDED.

SCALE
1: 5000
REVISION DATE
21/01/2014
PLOT DATE
21/01/2014
DA NUMBER

DRAWN/CHKD BY
IMC / AED
CC NUMBER

DRAWING TITLE
STAGING & LOT LAYOUT REV-F
DEVELOPMENT
PROJECT PLAN F
FERN BAY SEASIDE VILLAGE
NELSON BAY ROAD, FERN BAY
CLIENT
RAWSON COMMUNITIES PTY LIMITED

NORTH POINT SURVEYS (NSW) PTY LTD
ATF NORTH POINT SURVEYS TRUST ABN 52 041 968 075
SURVEYING AND LAND DEVELOPMENT CONSULTANTS
5 KOALA PLACE, ONE MILE BEACH
PH: 0249 842606
PO BOX 378 NELSON BAY, NSW, 2315
EMAIL: admin@northpointsurveys.com.au

29850 F

1 OF 23

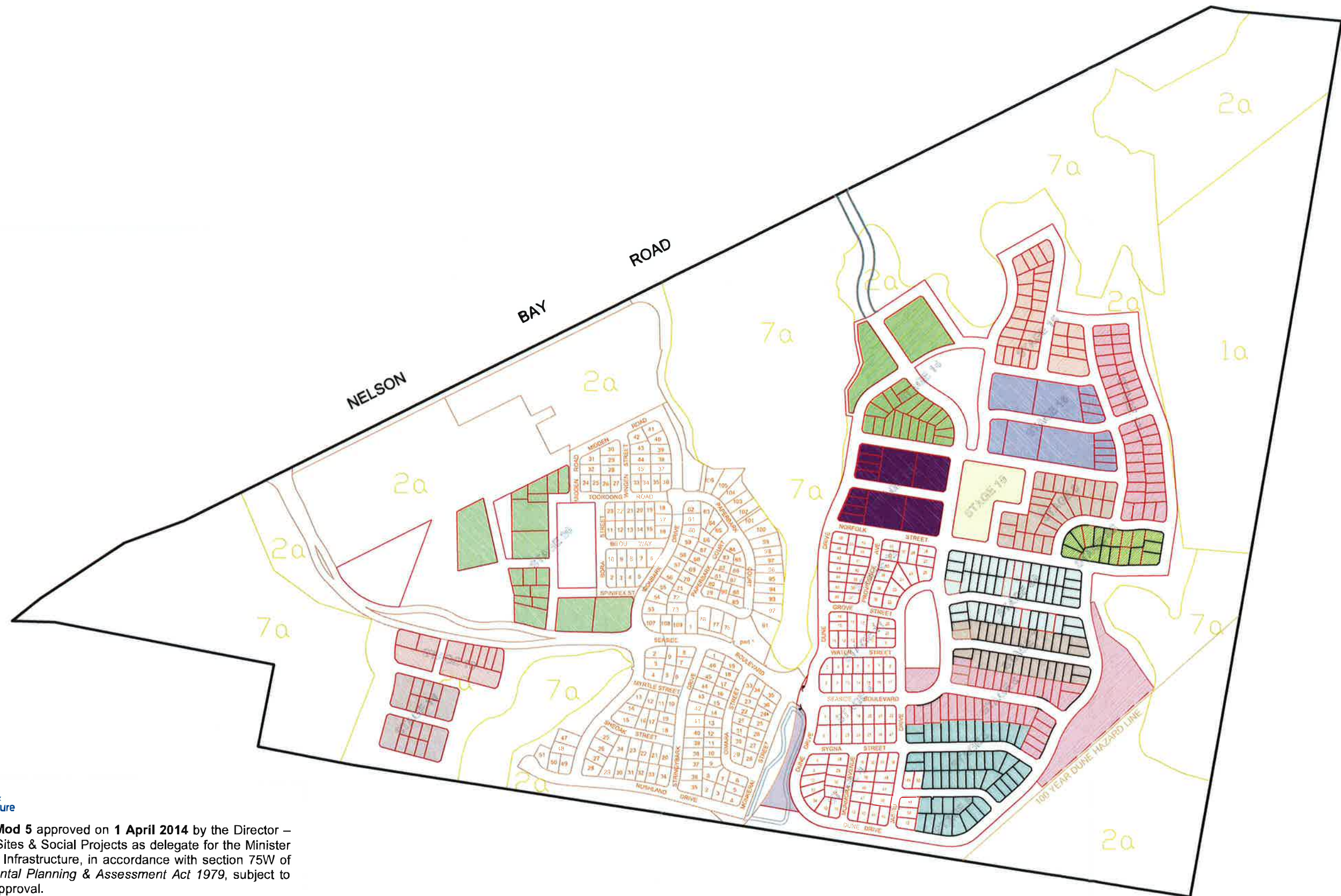

MP 06_0250 Mod 5 approved on 1 April 2014 by the Director – Industry, Key Sites & Social Projects as delegate for the Minister for Planning & Infrastructure, in accordance with section 75W of the *Environmental Planning & Assessment Act 1979*, subject to conditions of approval.

Signed:

COPYRIGHT NOTICE
THE DRAWING & THE INTELLECTUAL PROPERTY CONTAINED HEREIN ALWAYS REMAINS THE PROPERTY OF **NORTH POINT SURVEYS (NSW) P/L** AND SHALL NOT BE COPIED OR REPRODUCED WITHOUT THE WRITTEN PERMISSION OF **NORTH POINT SURVEYS (NSW) P/L** AND SHALL BE USED ONLY BY THE CLIENT OF **NORTH POINT SURVEYS (NSW) P/L** FOR THE PROJECT FOR WHICH IT WAS PROVIDED.

SCALE
1: 5000
REVISION DATE
21/01/2014
PLOT DATE
21/01/2014
DA NUMBER

DATUM
AHD
CONTOURS
N/A
DRAWN/CHKD BY
IMc / AED
CC NUMBER

DRAWING TITLE
STAGING PLAN
DEVELOPMENT
PROJECT PLAN F
FERN BAY SEASIDE VILLAGE
NELSON BAY ROAD, FERN BAY
CLIENT
RAWSON COMMUNITIES PTY LIMITED



NORTH POINT SURVEYS (NSW) PTY LTD
A/F NORTH POINT SURVEYS TRUST AEN 52 041 969 075
SURVEYING AND LAND DEVELOPMENT CONSULTANTS
5 KOALA PLACE, ONE MILE BEACH
PH: 0249 842606
PO BOX 378 NELSON BAY, NSW, 2315
EMAIL: admin@northpointsurveys.com.au

29850 F
2 OF 23

A2

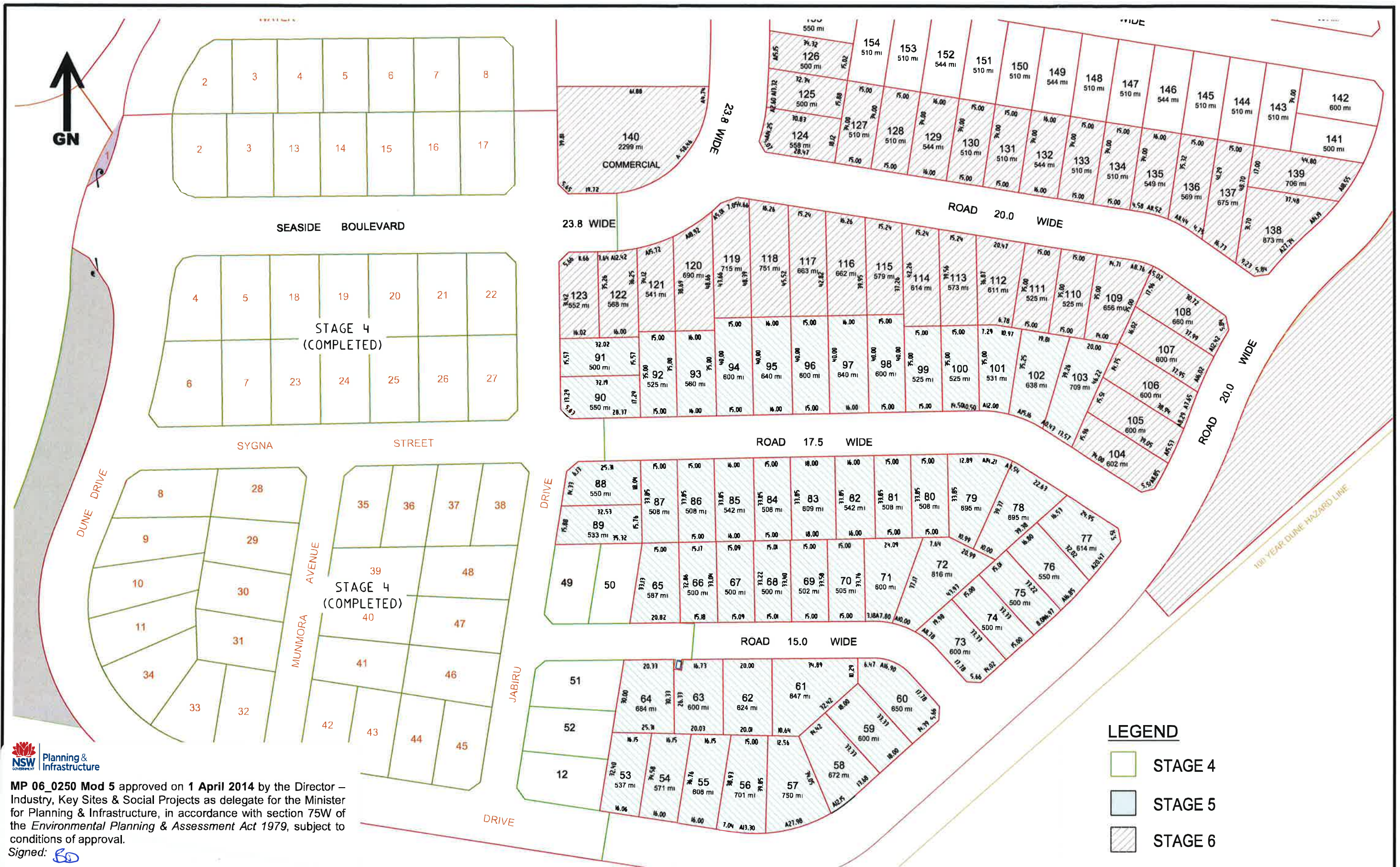

MP 06_0250 Mod 5 approved on **1 April 2014** by the Director – Industry, Key Sites & Social Projects as delegate for the Minister for Planning & Infrastructure, in accordance with section 75W of the *Environmental Planning & Assessment Act 1979*, subject to conditions of approval.

Signed: 

COPYRIGHT NOTICE
THE DRAWING & THE INTELLECTUAL PROPERTY CONTAINED
HEREIN ALWAYS REMAINS THE PROPERTY OF **NORTH
POINT SURVEYS (NSW) P/L** AND SHALL NOT BE COPIED
OR REPRODUCED WITHOUT THE WRITTEN PERMISSION OF
NORTH POINT SURVEYS (NSW) P/L AND SHALL BE
USED ONLY BY THE CLIENT OF **NORTH POINT SURVEYS
(NSW) P/L** FOR THE PROJECT FOR WHICH IT WAS PROVIDED.

SCALE
1: 1000

REVISION DATE	21/01/2014
---------------	------------

PLOT DATE
21/01/2014

DA NUMBER

DRAWING TITLE

STAGES 4 - 6 DETAIL PLAN REV-F

DEVELOPMENT	
-------------	--

PROJECT PLAN F
FERN BAY SEASIDE VILLAGE
NELSON BAY ROAD, FERN BAY

CLIENT	
--------	--

ASPEN GROUP LIMITED

LEGEND

STAGE 4

STAGE 5

STAGE 6

NORTH POINT SURVEYS (NSW) PTY LTD
ATF NORTH POINT SURVEYS TRUST ABN 52 041 968 075

SURVEYING AND LAND DEVELOPMENT CONSULTANTS
5 KOALA PLACE, ONE MILE BEACH
PH: 0249 842606
PO BOX 378 NELSON BAY, NSW, 2315
EMAIL: admin@northpointsurveys.com.au

29850 F

3 OF 23



Community/
Recreational
Facility

BOULEVARD

23.8 WIDE

140
2299 m

COMMERCIAL

13.8 WIDE

ROAD 17.5 WIDE

ROAD 17.5 WIDE

ROAD 20.0 WIDE

ROAD 17.5 WIDE

ROAD 20.0 WIDE

Reserve

100 YEAR DUNE HAZARD LINE



MP 06_0250 Mod 5 approved on 1 April 2014 by the Director – Industry, Key Sites & Social Projects as delegate for the Minister for Planning & Infrastructure, in accordance with section 75W of the *Environmental Planning & Assessment Act 1979*, subject to conditions of approval.

Signed:

COPYRIGHT NOTICE
THE DRAWING & THE INTELLECTUAL PROPERTY CONTAINED HEREIN ALWAYS REMAINS THE PROPERTY OF **NORTH POINT SURVEYS (NSW) P/L** AND SHALL NOT BE COPIED OR REPRODUCED WITHOUT THE WRITTEN PERMISSION OF **NORTH POINT SURVEYS (NSW) P/L** AND SHALL BE USED ONLY BY THE CLIENT OF **NORTH POINT SURVEYS (NSW) P/L** FOR THE PROJECT FOR WHICH IT WAS PROVIDED.

SCALE
1: 1000
REVISION DATE
21/01/2014
PLOT DATE
21/01/2014
DA NUMBER

DRAWN/CHKD BY
IMC / AED
CC NUMBER

DRAWING TITLE
STAGE 7 DETAIL PLAN REV-F
DEVELOPMENT
PROJECT PLAN F
FERN BAY SEASIDE VILLAGE
NELSON BAY ROAD, FERN BAY
CLIENT
RAWSON COMMUNITIES PTY LIMITED

NORTH POINT SURVEYS (NSW) PTY LTD
ATF NORTH POINT SURVEYS TRUST ABN 52 041 168 075
SURVEYING AND LAND DEVELOPMENT CONSULTANTS
5 KOALA PLACE, ONE MILE BEACH
PH: 0249 842606
PO BOX 378 NELSON BAY, NSW, 2315
EMAIL: admin@northpointsurveys.com.au

29850 F

4 OF 23

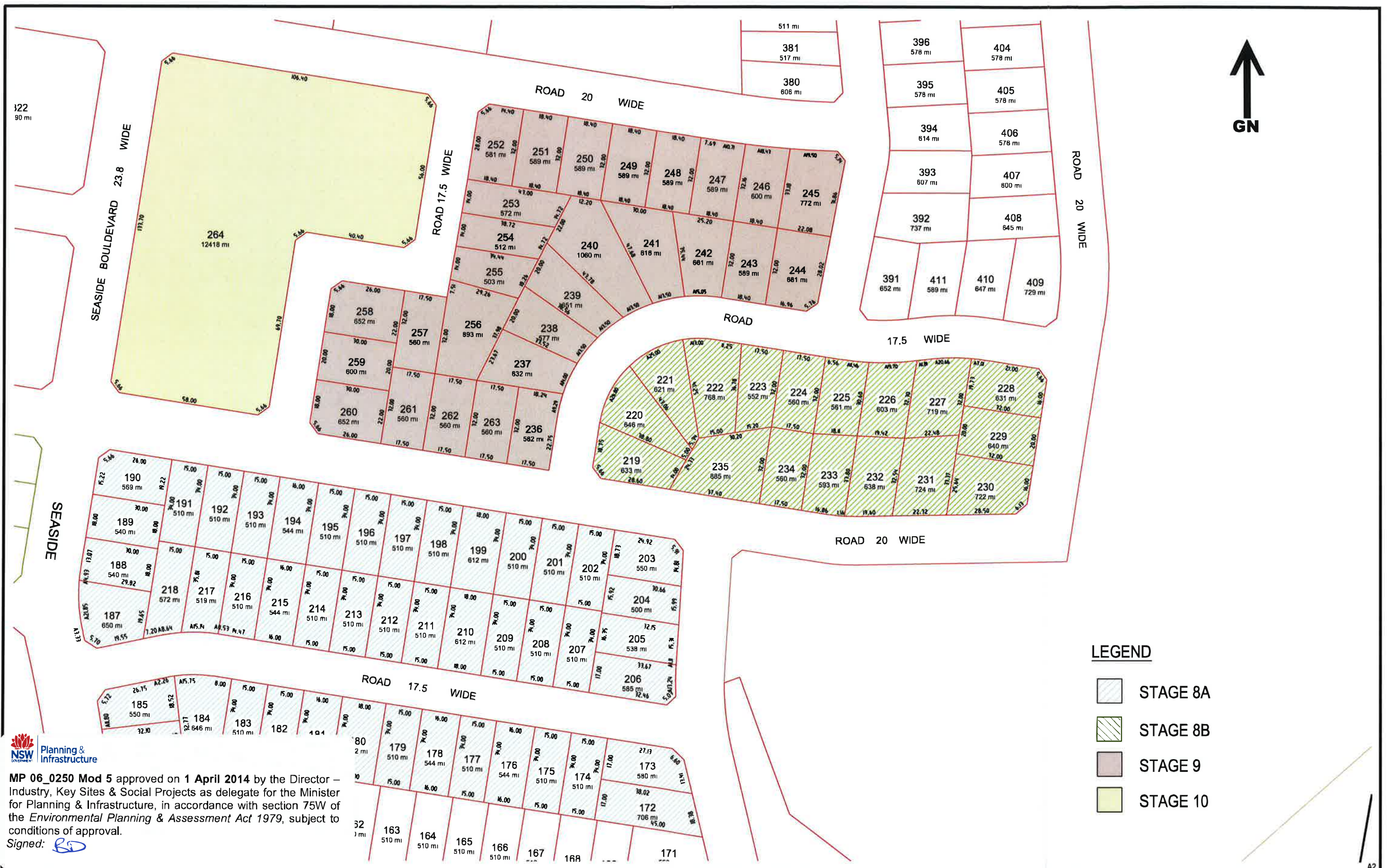

LEGEND

- STAGE 8A
- STAGE 8B
- STAGE 9
- STAGE 10



MP 06_0250 Mod 5 approved on 1 April 2014 by the Director – Industry, Key Sites & Social Projects as delegate for the Minister for Planning & Infrastructure, in accordance with section 75W of the *Environmental Planning & Assessment Act 1979*, subject to conditions of approval.
Signed: *RD*

COPYRIGHT NOTICE
THE DRAWING & THE INTELLECTUAL PROPERTY CONTAINED HEREIN ALWAYS REMAINS THE PROPERTY OF **NORTH POINT SURVEYS (NSW) P/L** AND SHALL NOT BE COPIED OR REPRODUCED WITHOUT THE WRITTEN PERMISSION OF **NORTH POINT SURVEYS (NSW) P/L** AND SHALL BE USED ONLY BY THE CLIENT OF **NORTH POINT SURVEYS (NSW) P/L** FOR THE PROJECT FOR WHICH IT WAS PROVIDED.

SCALE
1: 1000
REVISION DATE
21/01/2014
PLOT DATE
21/01/2014
DA NUMBER

DRAWN/CHKD BY
IMC / AED
CC NUMBER

DRAWING TITLE
STAGES 8 - 10 DETAIL PLAN REV-F
DEVELOPMENT
PROJECT PLAN F
FERN BAY SEASIDE VILLAGE
NELSON BAY ROAD, FERN BAY
CLIENT
RAWSON COMMUNITIES PTY LIMITED

NORTH POINT SURVEYS (NSW) PTY LTD
ATF NORTH POINT SURVEYS TRUST AEN 52 041 968 075
SURVEYING AND LAND DEVELOPMENT CONSULTANTS
5 KOALA PLACE, ONE MILE BEACH
PH: 0249 842606
PO BOX 378 NELSON BAY, NSW, 2315
EMAIL: admin@northpointsurveys.com.au

29850 F

5 OF 23



LEGEND

- STAGE 11
- STAGE 12



MP 06_0250 Mod 5 approved on 1 April 2014 by the Director – Industry, Key Sites & Social Projects as delegate for the Minister for Planning & Infrastructure, in accordance with section 75W of the *Environmental Planning & Assessment Act 1979*, subject to conditions of approval.

Signed:

COPYRIGHT NOTICE
THE DRAWING & THE INTELLECTUAL PROPERTY CONTAINED HEREIN ALWAYS REMAINS THE PROPERTY OF **NORTH POINT SURVEYS (NSW) P/L** AND SHALL NOT BE COPIED OR REPRODUCED WITHOUT THE WRITTEN PERMISSION OF **NORTH POINT SURVEYS (NSW) P/L** AND SHALL BE USED ONLY BY THE CLIENT OF **NORTH POINT SURVEYS (NSW) P/L** FOR THE PROJECT FOR WHICH IT WAS PROVIDED.

SCALE
1: 1000

REVISION DATE
19/12/2013

PLOT DATE
21/01/2014

DA NUMBER

DRAWN/CHKD BY
IMc / AED

CC NUMBER

DRAWING TITLE

STAGES 11 & 12 DETAIL PLAN REV-F

DEVELOPMENT

PROJECT PLAN F
FERN BAY SEASIDE VILLAGE
NELSON BAY ROAD, FERN BAY

CLIENT

RAWSON COMMUNITIES PTY LIMITED



NORTH POINT SURVEYS (NSW) PTY LTD
ATF NORTH POINT SURVEYS TRUST AEN 52 041 969 075
SURVEYING AND LAND DEVELOPMENT CONSULTANTS
5 KOALA PLACE, ONE MILE BEACH
PH: 0249 842808
PO BOX 378 NELSON BAY, NSW, 2315
EMAIL: admin@northpointsurveys.com.au

29850 F

6 OF 23



CONTINUATION SEE RIGHT

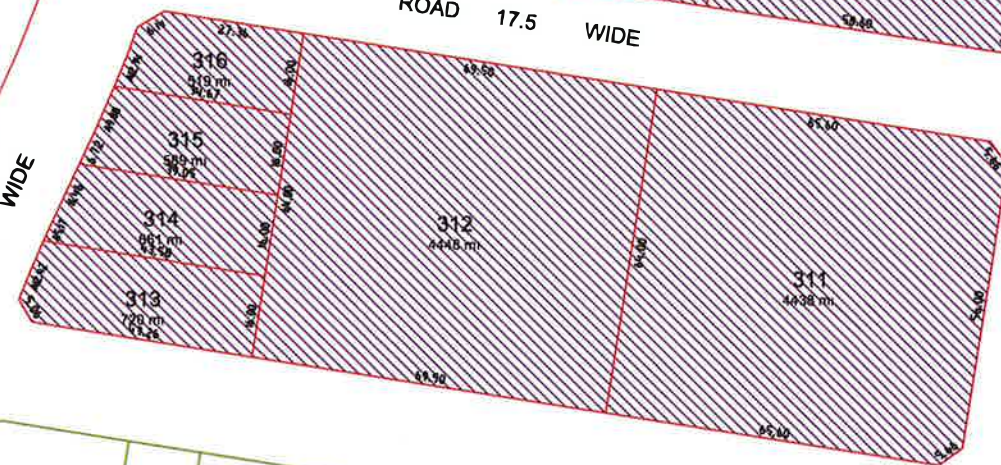
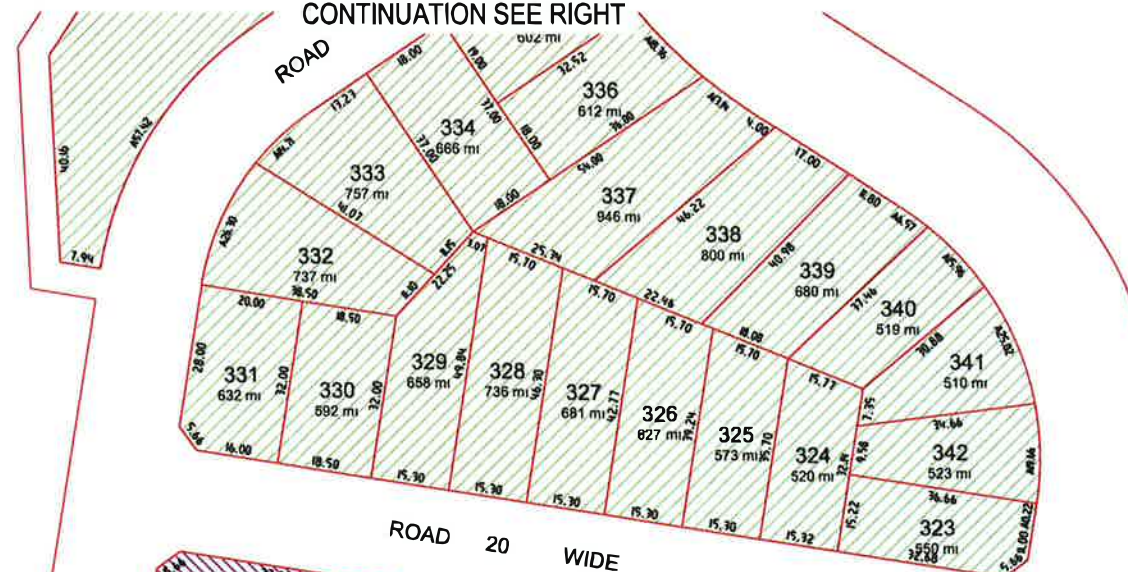

MP 06_0250 Mod 5 approved on 1 April 2014 by the Director – Industry, Key Sites & Social Projects as delegate for the Minister for Planning & Infrastructure, in accordance section 75W of the Environmental Planning & Assessment Act 1979, subject to conditions of approval.

Signed:

STAGE 12
COMPLETED

SEASIDE



LEGEND

- STAGE 13
- STAGE 14

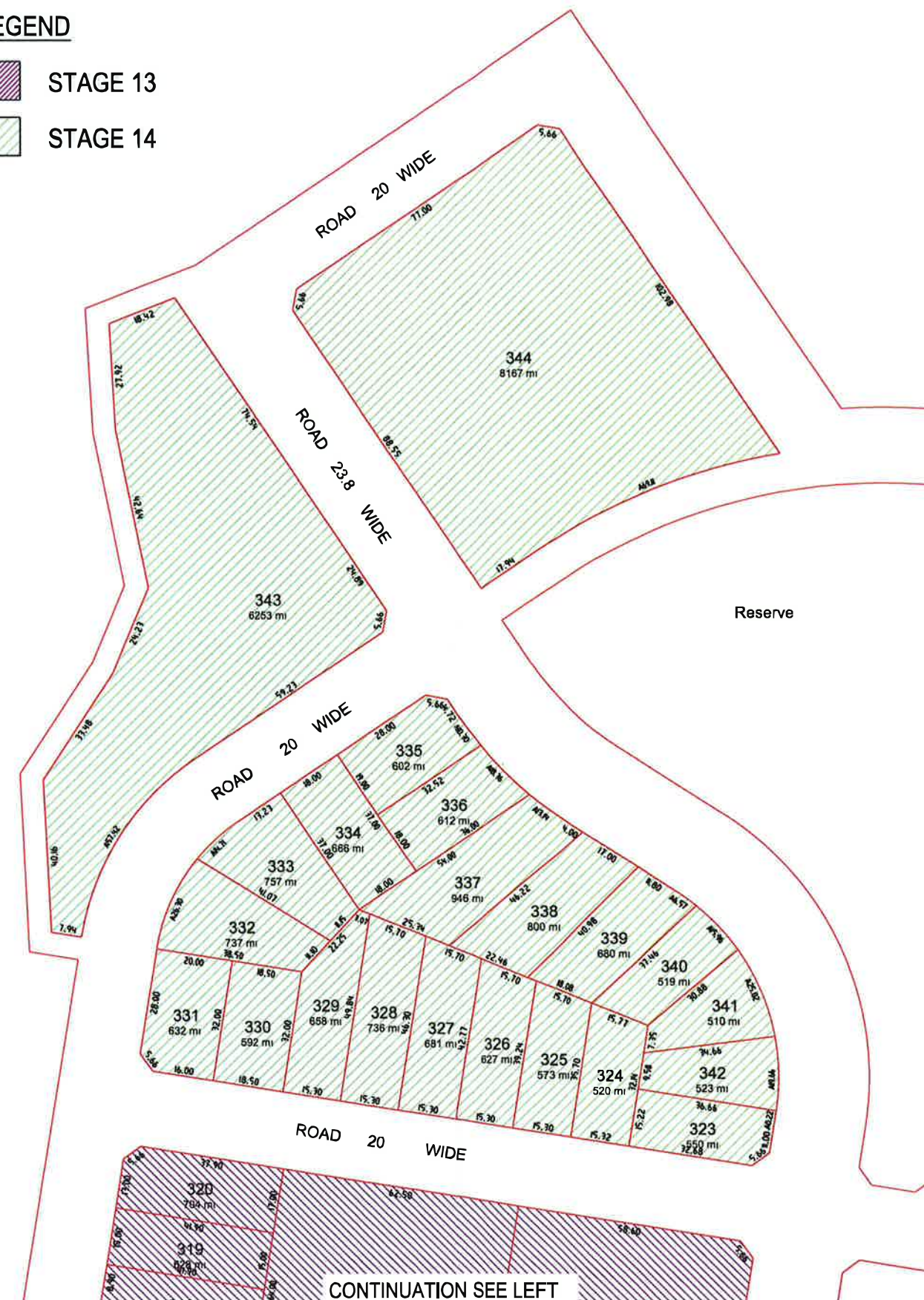

Reserve

CONTINUATION SEE LEFT

COPYRIGHT NOTICE
THE DRAWING & THE INTELLECTUAL PROPERTY CONTAINED HEREIN ALWAYS REMAINS THE PROPERTY OF **NORTH POINT SURVEYS (NSW) P/L** AND SHALL NOT BE COPIED OR REPRODUCED WITHOUT THE WRITTEN PERMISSION OF **NORTH POINT SURVEYS (NSW) P/L** AND SHALL BE USED ONLY BY THE CLIENT OF **NORTH POINT SURVEYS (NSW) P/L** FOR THE PROJECT FOR WHICH IT WAS PROVIDED.

SCALE	1: 1000
REVISION DATE	21/01/2014
PLOT DATE	21/01/2014
DA NUMBER	CC NUMBER
DRAWN/CHKD BY	IMC / AED

DRAWING TITLE	STAGES 13 & 14 DETAIL PLAN REV-F
DEVELOPMENT	PROJECT PLAN F FERN BAY SEASIDE VILLAGE NELSON BAY ROAD, FERN BAY
CLIENT	RAWSON COMMUNITIES PTY LIMITED



NORTH POINT SURVEYS (NSW) PTY LTD
ATF NORTH POINT SURVEYS TRUST AEN 52 041 968 075
SURVEYING AND LAND DEVELOPMENT CONSULTANTS
5 KOALA PLACE, ONE MILE BEACH
PH: 0249 842606
PO BOX 378 NELSON BAY, NSW, 2315
EMAIL: admin@northpointsurveys.com.au

29850 F

7 OF 23



LEGEND

- STAGE 15
- STAGE 16

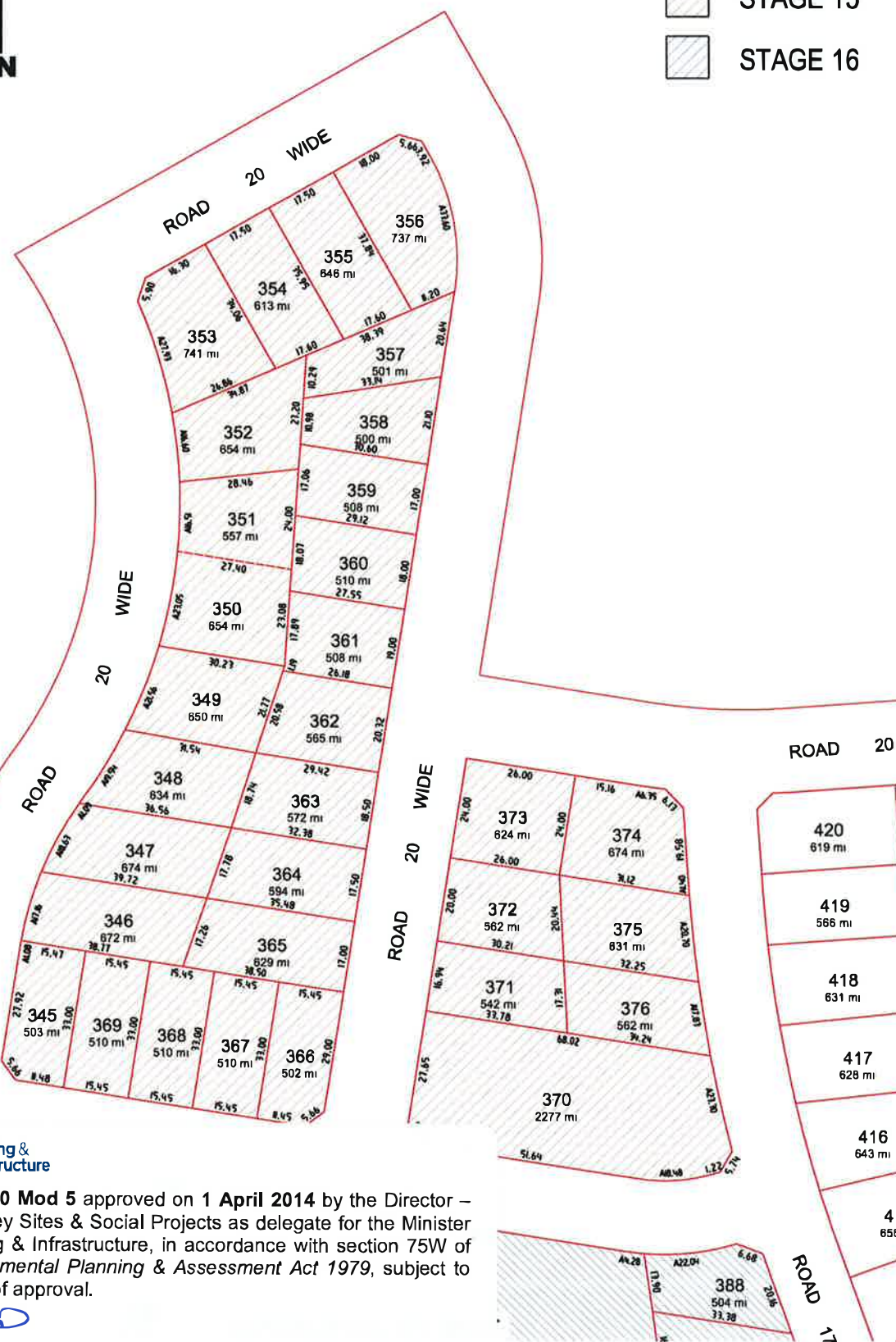

MP 06_0250 Mod 5 approved on 1 April 2014 by the Director – Industry, Key Sites & Social Projects as delegate for the Minister for Planning & Infrastructure, in accordance with section 75W of the *Environmental Planning & Assessment Act 1979*, subject to conditions of approval.

Signed:



COPYRIGHT NOTICE
THE DRAWING & THE INTELLECTUAL PROPERTY CONTAINED HEREIN ALWAYS REMAINS THE PROPERTY OF **NORTH POINT SURVEYS (NSW) P/L** AND SHALL NOT BE COPIED OR REPRODUCED WITHOUT THE WRITTEN PERMISSION OF **NORTH POINT SURVEYS (NSW) P/L** AND SHALL BE USED ONLY BY THE CLIENT OF **NORTH POINT SURVEYS (NSW) P/L** FOR THE PROJECT FOR WHICH IT WAS PROVIDED.

SCALE
1: 1000
REVISION DATE
19/12/2013
PLOT DATE
21/01/2014
DA NUMBER
DRAWN/CHKD BY
IMC / AED
CC NUMBER

DRAWING TITLE
STAGES 15 & 16 DETAIL PLAN REV-F
DEVELOPMENT
PROJECT PLAN F
FERN BAY SEASIDE VILLAGE
NELSON BAY ROAD, FERN BAY
CLIENT
RAWSON COMMUNITIES PTY LIMITED

NORTH POINT SURVEYS (NSW) PTY LTD
ATF NORTH POINT SURVEYS TRUST AEN 52 041 968 075
SURVEYING AND LAND DEVELOPMENT CONSULTANTS
5 KOALA PLACE, ONE MILE BEACH
PH: 0249 842606
PO BOX 378 NELSON BAY, NSW, 2315
EMAIL: admin@northpointsurveys.com.au

29850 F
8 OF 23

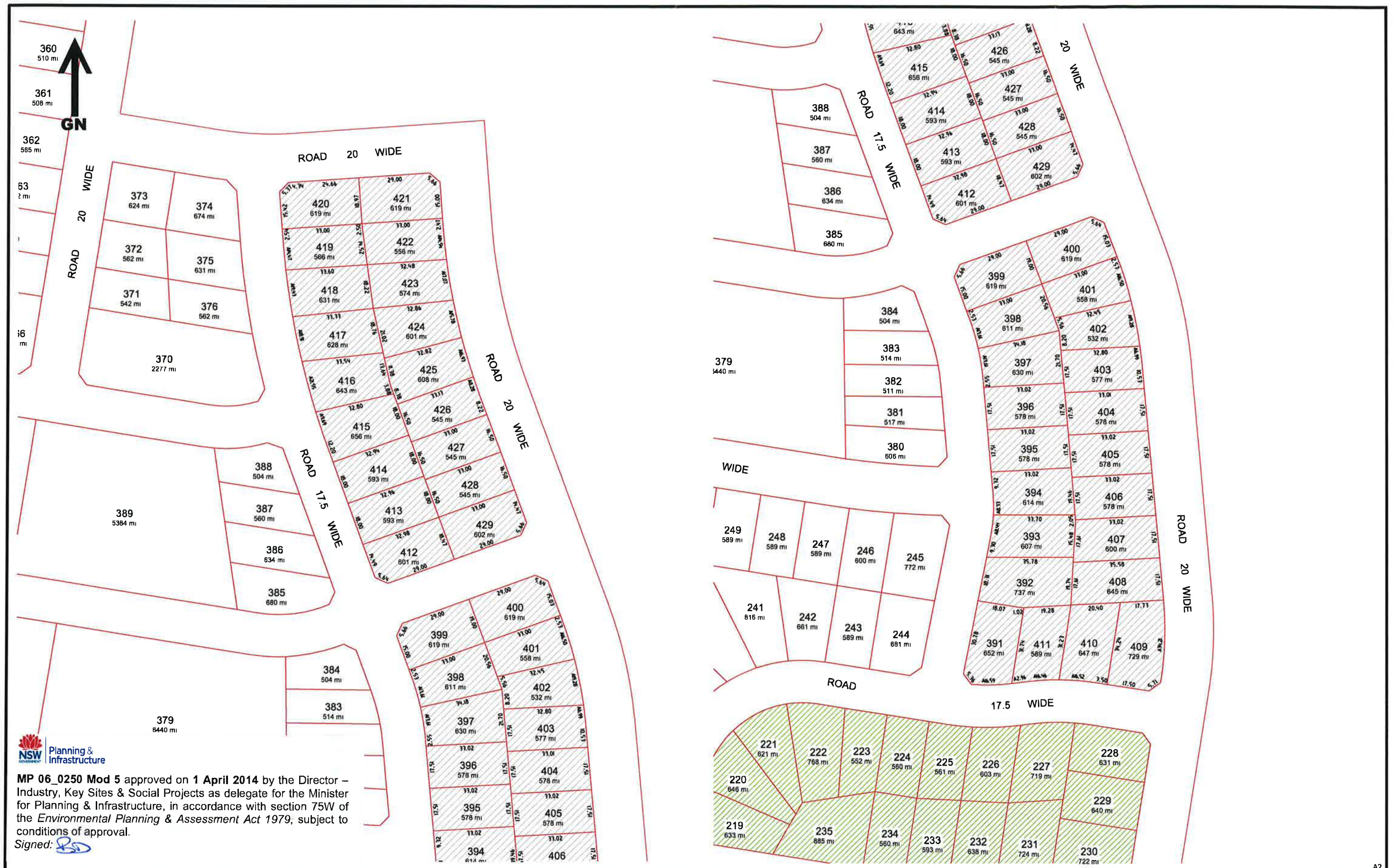

MP 06_0250 Mod 5 approved on 1 April 2014 by the Director – Industry, Key Sites & Social Projects as delegate for the Minister for Planning & Infrastructure, in accordance with section 75W of the *Environmental Planning & Assessment Act 1979*, subject to conditions of approval.
Signed:

COPYRIGHT NOTICE
THE DRAWING & THE INTELLECTUAL PROPERTY CONTAINED HEREIN ALWAYS REMAINS THE PROPERTY OF **NORTH POINT SURVEYS (NSW) P/L** AND SHALL NOT BE COPIED OR REPRODUCED WITHOUT THE WRITTEN PERMISSION OF **NORTH POINT SURVEYS (NSW) P/L** AND SHALL BE USED ONLY BY THE CLIENT OF **NORTH POINT SURVEYS (NSW) P/L** FOR THE PROJECT FOR WHICH IT WAS PROVIDED.

SCALE
1: 1000
REVISION DATE
19/12/2013
PLOT DATE
21/01/2014
DA NUMBER
CC NUMBER

DRAWN/CHKD BY
IMc / AED
CLIENT
RAWSON COMMUNITIES PTY LIMITED

DRAWING TITLE
STAGE 17 DETAIL PLAN REV-F
DEVELOPMENT
PROJECT PLAN F
FERN BAY SEASIDE VILLAGE
NELSON BAY ROAD, FERN BAY
CLIENT
RAWSON COMMUNITIES PTY LIMITED

NORTH POINT SURVEYS (NSW) PTY LTD
ATF NORTH POINT SURVEYS TRUST AEN 52 041 968 075
SURVEYING AND LAND DEVELOPMENT CONSULTANTS
5 KOALA PLACE, ONE MILE BEACH
PH: 0249 842608
PO BOX 378 NELSON BAY, NSW, 2315
EMAIL: admin@northpointsurveys.com.au

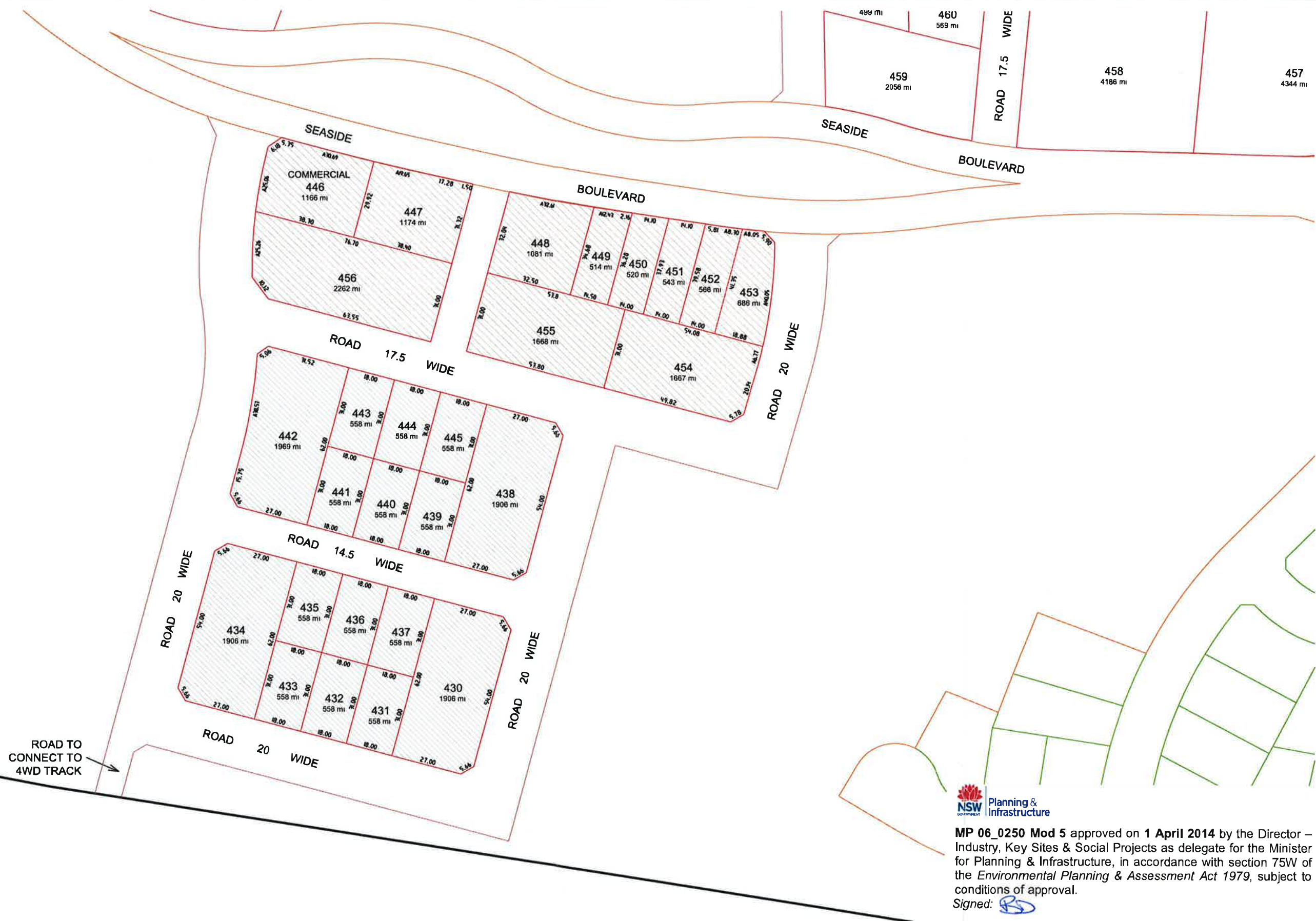

MP 06_0250 Mod 5 approved on 1 April 2014 by the Director – Industry, Key Sites & Social Projects as delegate for the Minister for Planning & Infrastructure, in accordance with section 75W of the *Environmental Planning & Assessment Act 1979*, subject to conditions of approval.
Signed:

COPYRIGHT NOTICE
THE DRAWING & THE INTELLECTUAL PROPERTY CONTAINED HEREIN ALWAYS REMAINS THE PROPERTY OF **NORTH POINT SURVEYS (NSW) P/L** AND SHALL NOT BE COPIED OR REPRODUCED WITHOUT THE WRITTEN PERMISSION OF **NORTH POINT SURVEYS (NSW) P/L** AND SHALL BE USED ONLY BY THE CLIENT OF **NORTH POINT SURVEYS (NSW) P/L** FOR THE PROJECT FOR WHICH IT WAS PROVIDED.

SCALE
1: 1000
REVISION DATE
19/12/2013
PLOT DATE
21/01/2014
DA NUMBER

DRAWN/CHKD BY
IMc / AED
CC NUMBER

DRAWING TITLE
STAGES 18 & 19 DETAIL PLAN REV F
DEVELOPMENT
PROJECT PLAN F
FERN BAY SEASIDE VILLAGE
NELSON BAY ROAD, FERN BAY
CLIENT
RAWSON COMMUNITIES PTY LIMITED

NORTH POINT SURVEYS (NSW) PTY LTD
ATF NORTH POINT SURVEYS TRUST AEN 52 041 968 075
SURVEYING AND LAND DEVELOPMENT CONSULTANTS
5 KOALA PLACE, ONE MILE BEACH
PH: 0249 842606
PO BOX 378 NELSON BAY, NSW, 2315
EMAIL: admin@northpointsurveys.com.au

29850 F
10 OF 23



MP 06_0250 Mod 5 approved on 1 April 2014 by the Director – Industry, Key Sites & Social Projects as delegate for the Minister for Planning & Infrastructure, in accordance with section 75W of the *Environmental Planning & Assessment Act 1979*, subject to conditions of approval.

Signed:

COPYRIGHT NOTICE
THE DRAWING & THE INTELLECTUAL PROPERTY CONTAINED HEREIN ALWAYS REMAINS THE PROPERTY OF **NORTH POINT SURVEYS (NSW) P/L** AND SHALL NOT BE COPIED OR REPRODUCED WITHOUT THE WRITTEN PERMISSION OF **NORTH POINT SURVEYS (NSW) P/L** AND SHALL BE USED ONLY BY THE CLIENT OF **NORTH POINT SURVEYS (NSW) P/L** FOR THE PROJECT FOR WHICH IT WAS PROVIDED.

SCALE
1: 1000
REVISION DATE
19/12/2013
PLOT DATE
21/01/2014
DA NUMBER

DRAWN/CHKD BY
IMc / AED
CC NUMBER

DRAWING TITLE
STAGE 20 DETAIL PLAN REV-F
DEVELOPMENT
PROJECT PLAN F
FERN BAY SEASIDE VILLAGE
NELSON BAY ROAD, FERN BAY
CLIENT
RAWSON COMMUNITIES PTY LIMITED

NORTH POINT SURVEYS (NSW) PTY LTD
ATF NORTH POINT SURVEYS TRUST AEN 52 041 968 075
SURVEYING AND LAND DEVELOPMENT CONSULTANTS
5 KOALA PLACE, ONE MILE BEACH
PH: 0249 842606
PO BOX 378 NELSON BAY, NSW, 2315
EMAIL: admin@northpointsurveys.com.au

29850 F

11 OF 23