

ANNEXURE 1

**Plans of Proposed Modifications
to approved DDGS Dryers**

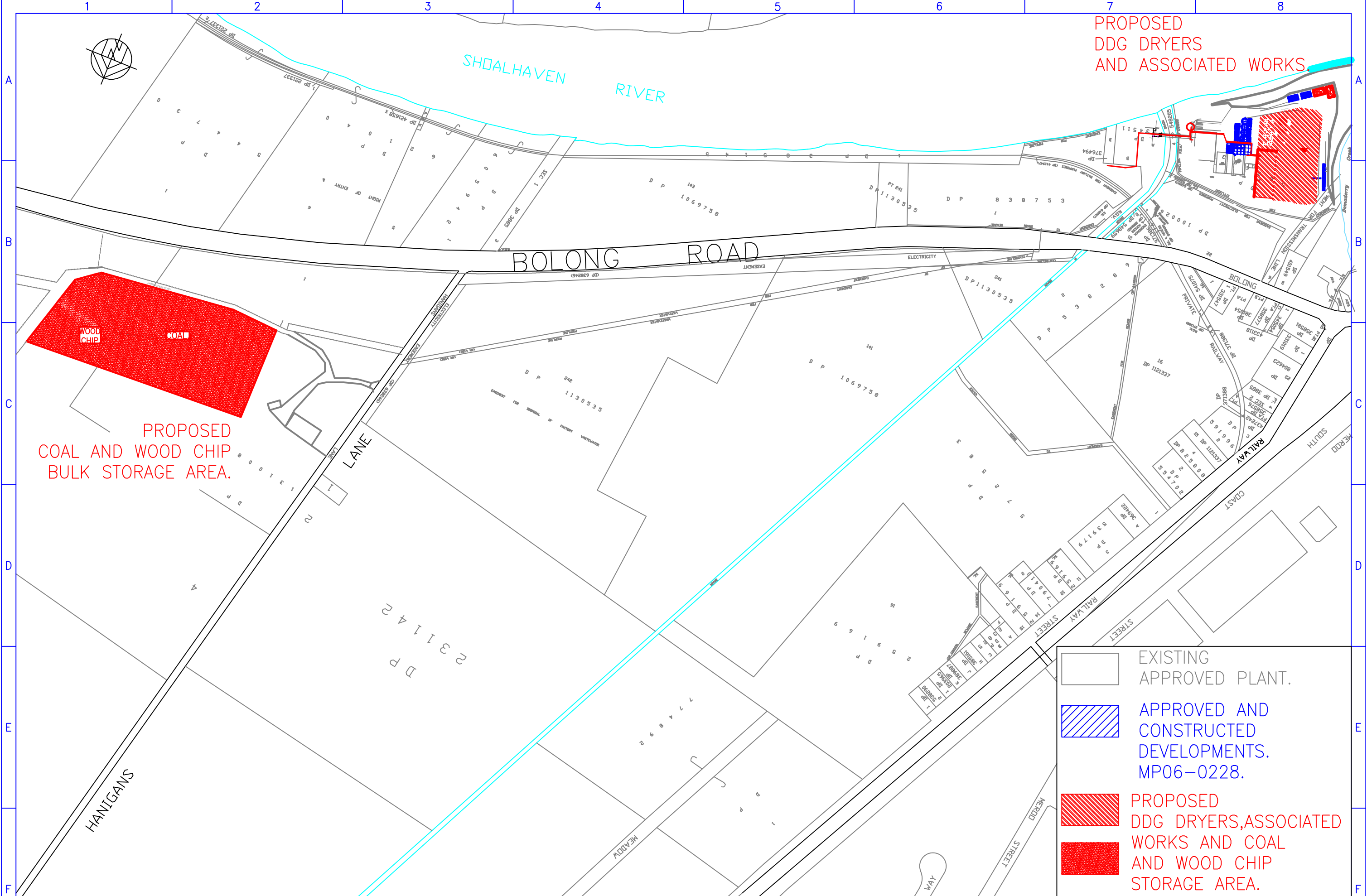

H	26-10-16	ALL	Final layout.	P.C.	S.R.
C	04-09-15	ALL	Silos added, feed to silos added, scale was 1:100.	P.C.	P.G.
B	14-7-15	ALL	Flour mill plan.	P.C.	S.R.
A	2-7-15	ALL	Revised layout.	P.C.	S.R.
I	17-6-15	ALL	Draft.	P.C.	K.L.
ISS	DATE	ZONE	CHANGE	AMENDMENTS	BY CKD

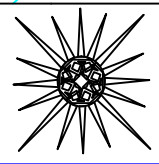

MANILDRA GROUP
Commitment to Excellence

DRAWN P.C.
TRACED
CHECKED/
APPROVED
DRG PRACTICE
AS1100

TITLE:
SHOALHAVEN STARCHES
ADDITIONAL DDG DRYING.
COAL AND WOOD CHIP BULK STORAGE.

SIZE	SCALE:
A3	1:5000
MANILDRA-5765	
DRG. No. MN261-007H	

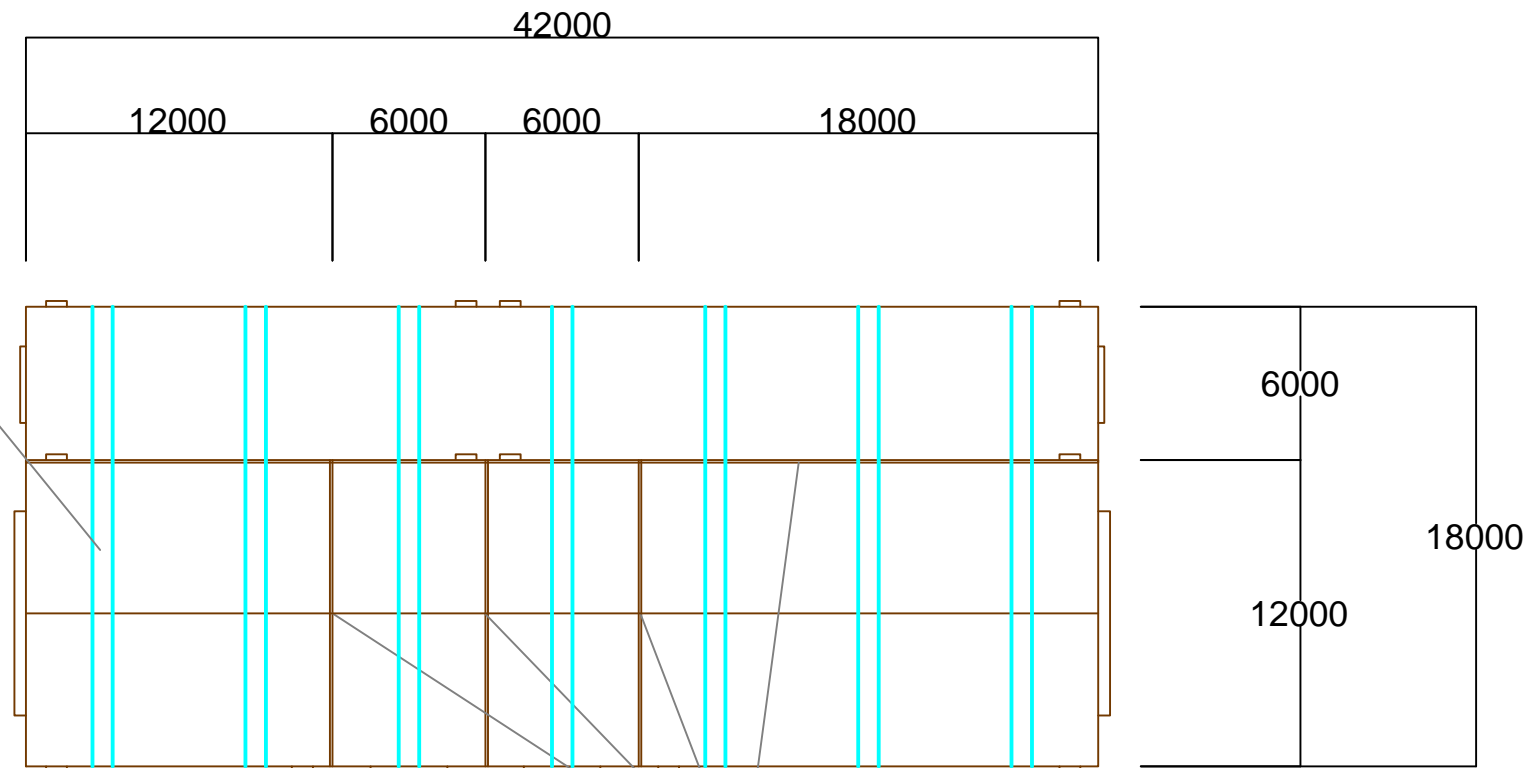

INTERNAL WALLS x 4 REQD.

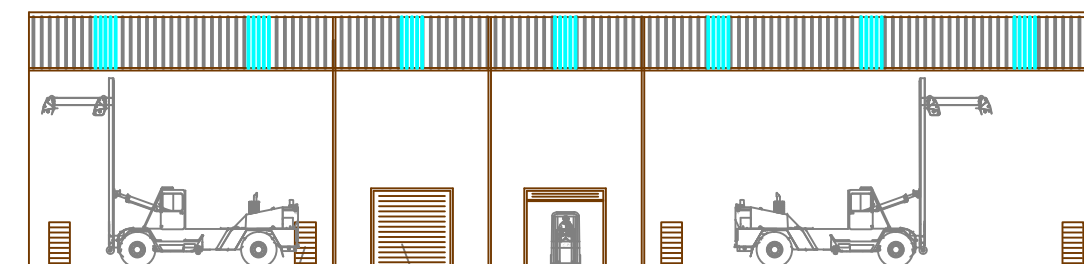

3M x 3M ROLLER DOORS
x 4 REQD.



DRAWN	P.J.C.	TOLERANCES
TRACED	---	
CHECKED		
APPROVED		FINISH
DRG PRACTICE		GAL/C-BOND
AS1100		

	MANILDRA GROUP.NOWRA.
	FORKLIFT MAINTENANCE BUILDING. BUILDING DETAIL.

SIZE A3	SCALES 1:300	SHT
ISSUE	5765	
DRG. NO. MN267-004A		

I	15-9-15	ALL	proposal		P.C.	G.M.	
ISS	DATE	ZONE	CHANGE AMMENDMENTS		BY	CKD	



PC Drafting.
0439 436508
Est. 2001