

WOLLONGONG CENTRAL - SECTION 75W MODIFICATION No. 4 ARCHITECTURAL DRAWINGS

DRAWING LIST

DA-A001 COVERSHEET
DA-A005 OVERALL FLOOR PLANS SITE ANALYSIS PLAN

DA-A100C OVERALL FLOOR PLANS LEVEL B1 BASEMENT CARPARK
DA-A101C OVERALL FLOOR PLANS LEVEL 1 LOWER GROUND RETAIL
DA-A102C OVERALL FLOOR PLANS LEVEL 2 GROUND FLOOR RETAIL
DA-A103C OVERALL FLOOR PLANS LEVEL 3 CROWN CENTRAL FIRST FLOOR RETAIL
DA-A103aC OVERALL FLOOR PLANS LEVEL 3A CROWN CENTRAL MEZZANINE
DA-A104C OVERALL FLOOR PLANS LEVEL 4 RETAIL AND CARPARK LEVEL
DA-A105C OVERALL FLOOR PLANS LEVEL 5 CARPARK LEVEL
DA-A106C OVERALL FLOOR PLANS LEVEL 6 CARPARK LEVEL
DA-A107C OVERALL FLOOR PLANS LEVEL 7 CARPARK AND CINEMA LEVEL
DA-A108C OVERALL FLOOR PLANS LEVEL 8 PLANT LEVEL
DA-A109C OVERALL FLOOR PLANS LEVEL 9 PLANT LEVEL

DA-A210C ELEVATION CROWN STREET MALL
DA-A211C ELEVATION CROWN LANE (WEST KEIRA)
DA-A212C ELEVATION KEIRA STREET (WEST KEIRA)
DA-A213C ELEVATION KEIRA STREET (CROWN CENTRAL)

DA-A216C ELEVATIONS KEIRA STREET BRIDGE
DA-A217C MARKET ST ELEVATION
DA-A219C FACADE DETAILS KEIRA STREET (WEST KEIRA)

DA-A301C OVERALL SECTIONS SHEET 1
DA-A302C OVERALL SECTIONS SHEET 2

DA-A304C SECTIONS AND DETAILS THROUGH TUNNEL

DA-A501 MARKET ST ENTRANCE - NORTH WEST VIEW
DA-A502 MARKET ST ENTRANCE - SOUTH EAST VIEW

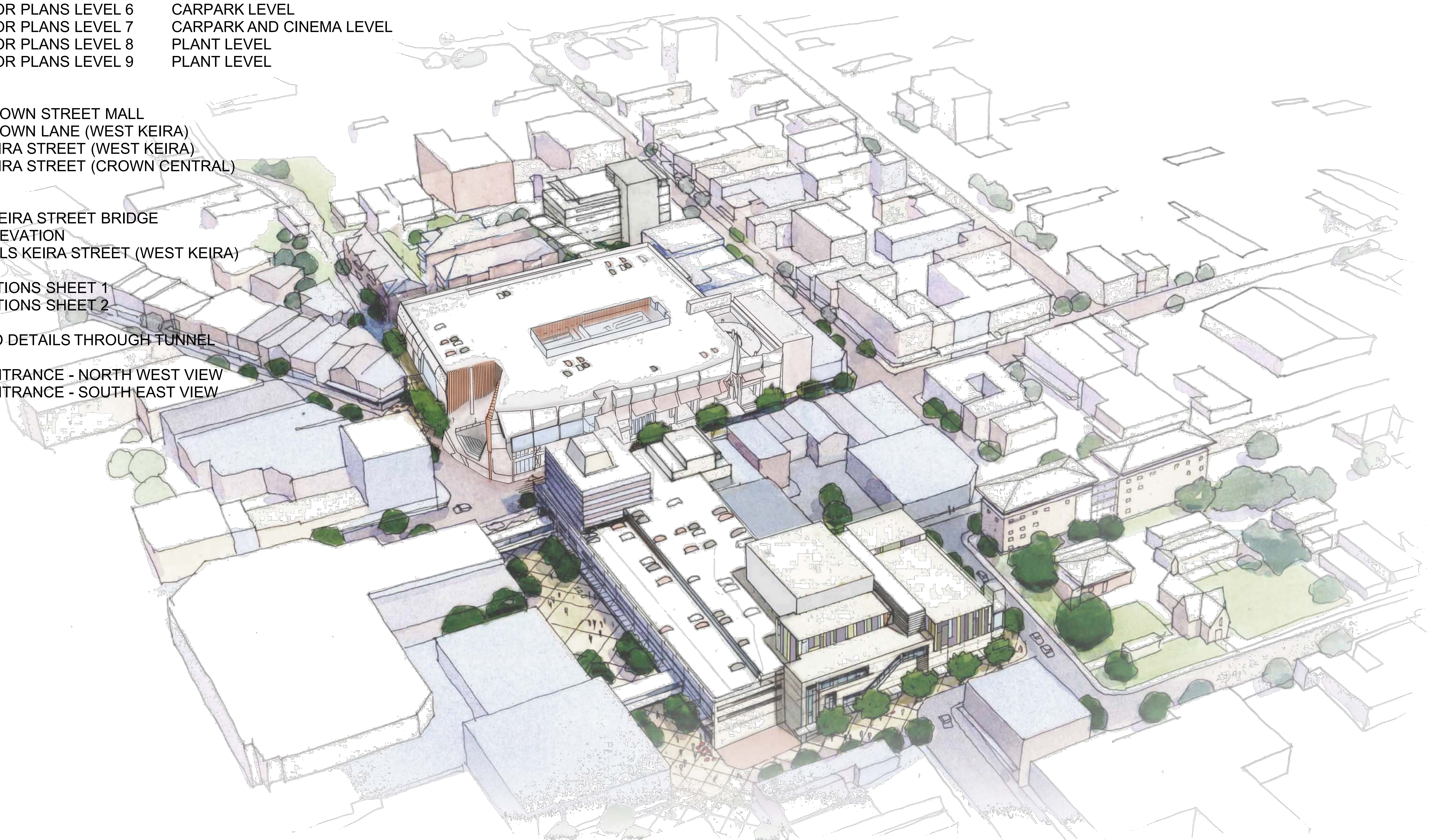

THIS DOCUMENT IS THE COPYRIGHT OF RICE DAUBNEY INTER PTY LTD.
ALL INFORMATION ILLUSTRATED ON THIS DOCUMENT IS TO BE CHECKED AND VERIFIED ON SITE.
IN THE EVENT OF DISCREPANCIES BEING TO ADVERTISE PRIOR TO COMMENCEMENT OF THE WORK,
DO NOT SCALE DRAWINGS MANUALLY OR ELECTRONICALLY.

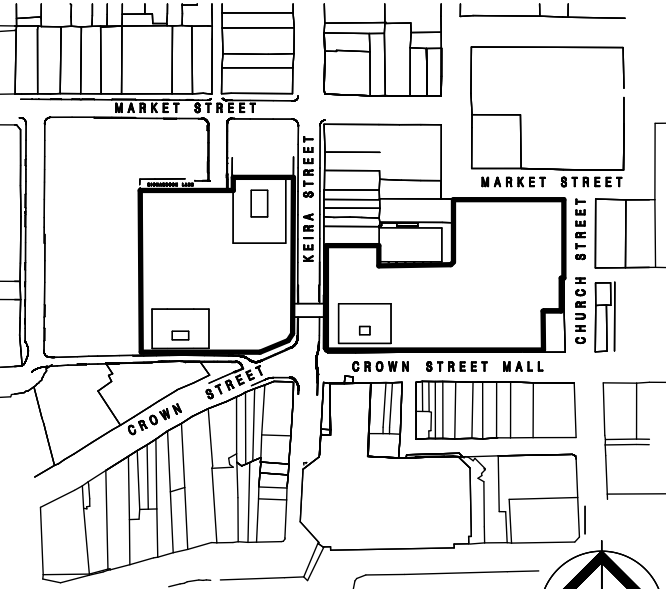

keyplan

ISSUED FOR SECTION 75W MODIFICATION (4)	23.03.12
ISSUED FOR SECTION 75W MODIFICATION (3)	14.07.11

The GPT Group

Level 51, MLC Centre, 19 Martin Place,
Sydney, NSW, 2000
P: 02 8239 3555 F: 02 8863 1759

PROJECT MANAGER

Hansen Yuncken Pty Ltd

Sydney Level 6, 15 Bourke Road,
Mosman, NSW, 2088
P: 02 9770 7000 F: 02 9770 7001

Architects: 22 Lonsdale Street, Sydney NSW 2000
P: 02 445 4451 F: 02 445 4451

Architects: 100 Pitt Street, Sydney NSW 2000
P: 02 9559 2000 F: 02 9559 2015

the rice daubney group (inc) Pty Ltd - abn 77 001 200 700
the rice daubney group (inc) Pty Ltd - abn 77 001 200 700

DRAWING TITLE:

COVER SHEET

SCALE: 1:500 @ B1, 1:1250 @ A3

DRAWN	CHECKED		
-------	---------	--	--

PROJECT NUMBER:	DRAWING NUMBER:	ISSUE:
11002	DA-A001	