

THIS DOCUMENT IS THE COPYRIGHT OF RICE DAUBNEY INTER PTY LTD.
ALL INFORMATION LISTED ON THIS DOCUMENT IS TO BE CHECKED AND VERIFIED ON SITE.
AT THE POINT OF ISSUANCE PRIOR TO COMMENCEMENT OF THE WORK.
DO NOT SCALE DRAWINGS MANUALLY OR ELECTRONICALLY.

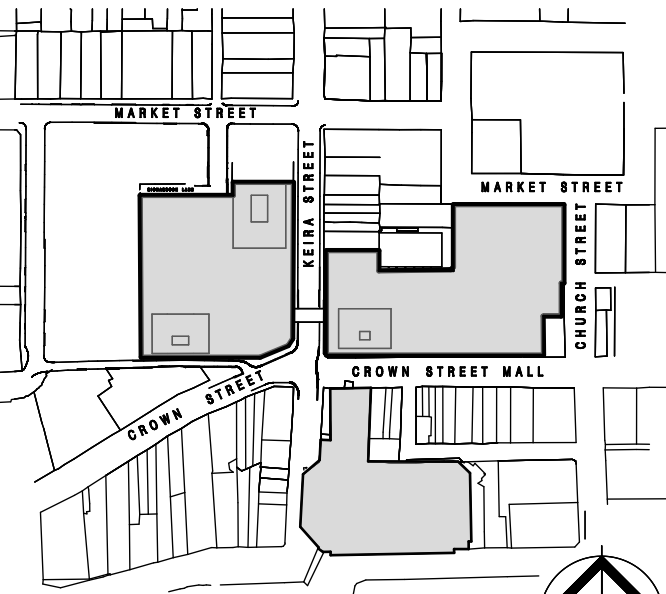

keyplan

THE NOTES AND CLOUDS ON THIS DRAWING IDENTIFY
THE MAIN MODIFICATIONS TO THE DESIGN. MINOR
CHANGES ARE NOT SEPARATELY IDENTIFIED.

ELEVATION AND PLAN FORM AMENDED TO REFLECT
W1 FLOOR PLAN CHANGES AND FAÇADE DETAILING

1 ELEVATION
KEIRA STREET BRIDGE 1:200 @B1

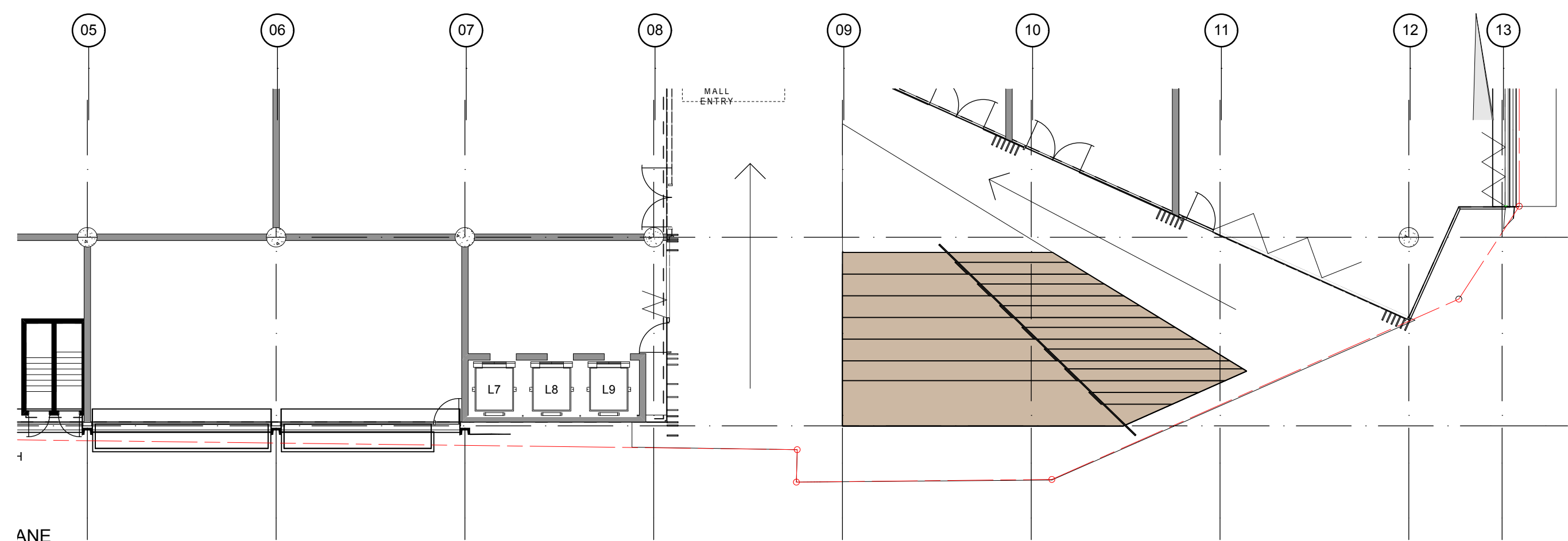

2 ELEVATION
CROWN LANE 1:200 @B1

The GPT Group

Level 51, MLC Centre, 19 Martin Place,
Sydney, NSW, 2000
P: 02 8239 3555 F: 02 8863 1759

PROJECT MANAGER

Hansen Yuncken Pty Ltd

Sydney Level 6, 15 Bourke Road,
Melbourne, VIC, 3000
P: 02 9770 7000 F: 02 9770 7001

Architects: 22 Lonsdale Street, Melbourne, VIC, 3000
P: 02 455 4551 F: 02 455 4551

Architects: 22 Lonsdale Street, Melbourne, VIC, 3000
P: 02 455 4551 F: 02 455 4551

Architects: 22 Lonsdale Street, Melbourne, VIC, 3000
P: 02 455 4551 F: 02 455 4551

Architects: 22 Lonsdale Street, Melbourne, VIC, 3000
P: 02 455 4551 F: 02 455 4551

Architects: 22 Lonsdale Street, Melbourne, VIC, 3000
P: 02 455 4551 F: 02 455 4551

Architects: 22 Lonsdale Street, Melbourne, VIC, 3000
P: 02 455 4551 F: 02 455 4551

Architects: 22 Lonsdale Street, Melbourne, VIC, 3000
P: 02 455 4551 F: 02 455 4551

Architects: 22 Lonsdale Street, Melbourne, VIC, 3000
P: 02 455 4551 F: 02 455 4551

Architects: 22 Lonsdale Street, Melbourne, VIC, 3000
P: 02 455 4551 F: 02 455 4551

Architects: 22 Lonsdale Street, Melbourne, VIC, 3000
P: 02 455 4551 F: 02 455 4551

Architects: 22 Lonsdale Street, Melbourne, VIC, 3000
P: 02 455 4551 F: 02 455 4551

Architects: 22 Lonsdale Street, Melbourne, VIC, 3000
P: 02 455 4551 F: 02 455 4551

Architects: 22 Lonsdale Street, Melbourne, VIC, 3000
P: 02 455 4551 F: 02 455 4551

Architects: 22 Lonsdale Street, Melbourne, VIC, 3000
P: 02 455 4551 F: 02 455 4551

Architects: 22 Lonsdale Street, Melbourne, VIC, 3000
P: 02 455 4551 F: 02 455 4551