

NORTH

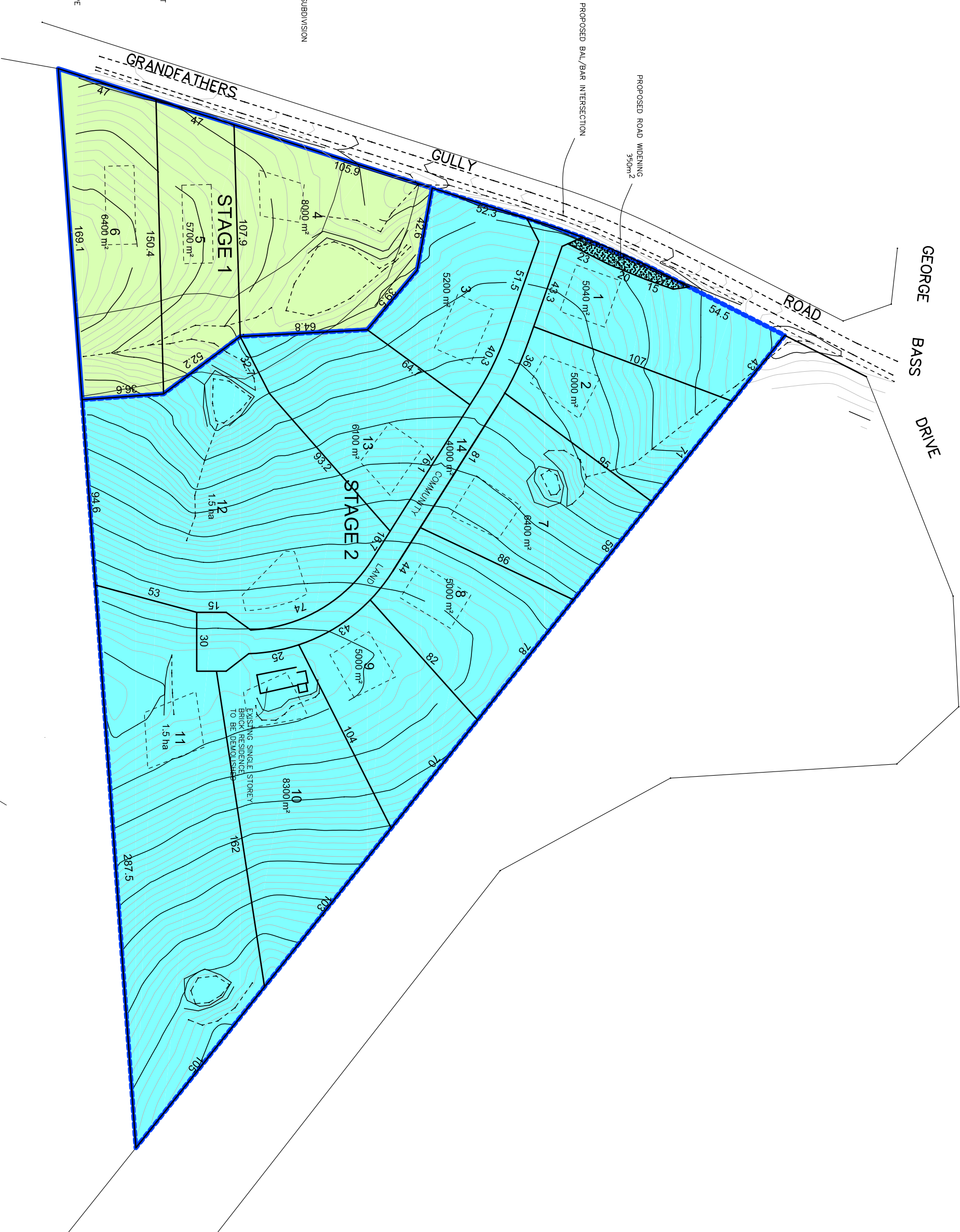

STAGE 1
LOTS 4, 5 & 6 TORRENS TITLE SUBDIVISION

STAGE 2
PROPOSED COMMUNITY TITLE LOTS
LOTS 1, 2, 3 and 7 - 13
(LOTS 4, 5 & 6 DO NOT FORM PART
OF THE COMMUNITY TITLE PLAN)

DENOTES DEVELOPMENT ENVELOPE
AVERAGE AREA 600m2 EXCEPT
LOT 4 (465m2)

AMENDMENT DETAILS		DATE	REDUCTION RATIO		 Conway Burrows + Hancock Consulting Surveyors Civil Engineering Consultants	LOT LAYOUT - PROPOSED SUBDIVISION		FILE: 11869-10
No.		DATE	HORIZONTAL - 1: 1000 (A1) 1: 2000 (A3)			PROPOSED TORRENS/COMMUNITY TITLE SUBDIVISION		
		DRAWN	VERTICAL - 1: OR AS SHOWN			LOT 2 DP 250984		
		DISK				GRANDFATHERS GULLY ROAD LILLI PILLI		
COPYRIGHT OF THIS PLAN BELONGS TO CONWAY BURROWS & HANCOCK REPRODUCTION IN FULL OR PART IS NOT PERMITTED WITHOUT WRITTEN PERMISSION © CBH 2005		JOB No	11869		CLIENT: MR DAVID BREWER		SHEET OF SHEETS 6 14	



Conway Burrows + Hancock
Consulting Surveyors
Civil Engineering Consultants

126 BEACH ROAD
BATMANS BAY NSW 2536
02 4472 5565
COLLIERHOUSE ARCADE
VULCAN STREET
MORUYA NSW 2537
02 4474 2663

Land Development Consultants