

SHOALHAVEN MARKET PLACE - VINCENTIA

Status	Mod. 6 Submission	
RLA	Andrew Turnbull	
Print Date	20 October 2014	
Rev	Description	Date
A	Refer Mod. 5	18.11.13
B	Mod. 6 Submission	08.07.14
C	Mod. 6 Submission	14.10.14
D	Mod. 6 Submission	20.10.14

LANDSCAPE SHEET LIST	
SHEET NAME	SHEET NUMBER
Stage 1A Landscape Design Summary	001
Landscape Planting Palette	002
Typical Section - Moona Road - Development	003
Typical Section - Pond - Carpark	004
Typical Swale Section	005
Typical Bridge - Pedestrian/Cycle Section	006

NSW GOVERNMENT
Planning

Issued under the Environmental Planning and Assessment Act 1979

Approved Section 75W Modification Application

No. MOD 6 granted on the 15/12/14

in respect to MP 06-0025

Signed [Signature]

Sheet No. 1 of 7



Rev	Description	Date
A	Refer Mod. 5	18.11.13
B	Mod. 6 Submission	08.07.14
C	Mod. 6 Submission	14.10.14
D	Mod. 6 Submission	20.10.14

- 1. GATEWAY PLANTING**
Feature entry planting with Doryanthes excelsa and native grasses - Feature Livistona Palm. Tree planting limited by RFS guidelines and high voltage overhead wire setbacks.
- 2. MOONA CREEK ROAD**
Structured planting to bank with native feature tree planting of Eucalyptus sclerophylla with native understorey planting where appropriate.
- 3. PEDESTRIAN - CYCLE BRIDGE**
Bridge to overland flow swale with native grasses to invert. Controlled carpark SW discharge into engineered bioswale. Gabion retaining elements to address level transitions. Integration of Livistona palms at bridge crossing.
- 4. SEDIMENT BASIN & WETLAND**
Grass and reed planting to basin edges, with native feature tree planting of Melaleuca & Casuarina spp. Shade planting provided by hymenosprum spp. with stands of Banksia integrifolia.
- 5. GRASSED SWALE**
Engineered grassed swale profile with feature planting of native grasses to gabion drop structures
- 6. ARBOUR WALK**
Suspended arbour with Hardenbergia violacea (alba), Hibbertia scandens, Pandorea jasminoides and Panorea pandorana.
- 7. BUFFER PLANTING**
Native buffer planting to screen development from Naval College Road - Eucalyptus sclerophylla (used where RFS guidelines permit) with native grass, shrub understorey and integration of Banksia ericifolia to planting areas.
- 8. OVERLAND SWALE BUFFER PLANTING**
Mounded earth forms and integration of native tree selections; Eucalyptus, Angophora, Tristaniopsis & Lophostemon planted in grass.
- 9. CARPARK PLANTING**
Canopy tree planting of Tristaniopsis laurina and Lophostemon confertus with native grass understorey planting. Native tree selections to carpark edge conditions. Native grasses to carpark median.
- 10. TEMPORARY LANDSCAPE**
Revegetated native grassland and select buffer planting. Note: Landscape not to disrupt sight lines & view corridor.
- 11. SHARE BIKE / PEDESTRIAN PATH**
Pedestrian and Cycle accessway to adjoining areas.
- 12. ENVIRONMENTAL BUFFER**
Protective fence installed to environmental buffer interface with sedimentation pond and wetland.
- 13. GATEWAY NODE - PEDESTRIAN**
Introduction of large canopy deciduous tree - Platanus spp. and low scale entry wall element.

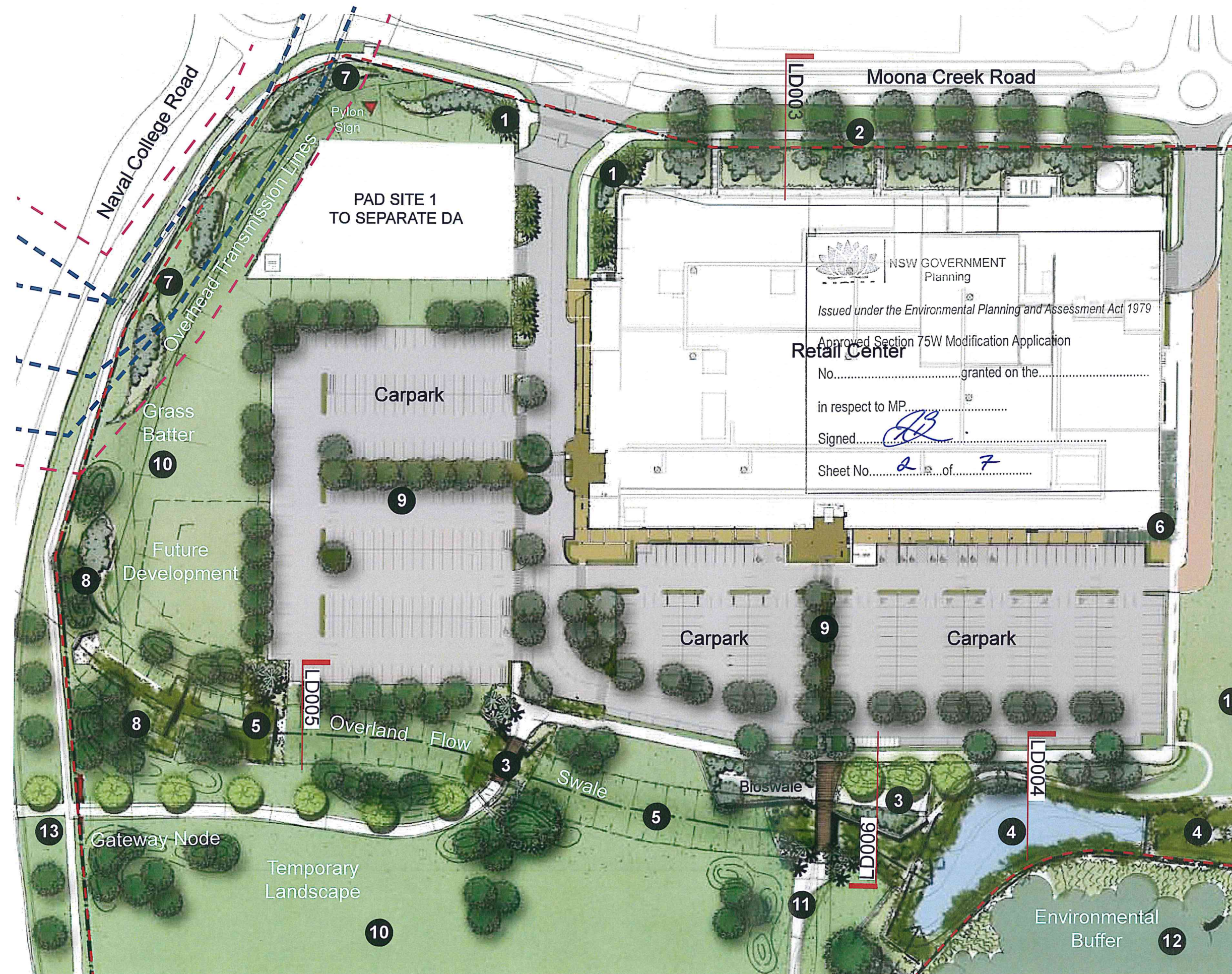

Rev	Description	Date
A	Refer Mod. 5	18.11.13
B	Mod. 6 Submission	08.07.14
C	Mod. 6 Submission	14.10.14
D	Mod. 6 Submission	20.10.14

INDICATIVE PLANT SCHEDULE

BOTANIC NAME	COMMON NAME	MATURE HEIGHT
--------------	-------------	---------------

Gateway Trees / Plants

Angophora hispida	Dwarf Apple	4m
Eucalyptus sclerophylla	Scribbly Gum	8-15m
Doryanthes excelsa	Gymea lily	2-3m

Feature Trees

Tristaniopsis laurina	Water Gum	8m
Eucalyptus sclerophylla	Scribbly Gum	10-15m
Lophostemon conferta	Lophostemon	10m
Livistona australis	Cabbage Palm	10m

Native Buffer Planting Mix

Allocasuarina littoralis	Black She-Oak	8m
Corymbia gummifera	Red Bloodwood	10-15m
Corymbia maculata	Spotted Gum	20-30m
Eucalyptus botryoides	Bangalay	30m
Eucalyptus pilularis	Blackbutt	40m
Eucalyptus racemosa	Narrow-Leave Scribbly gum	15m

Waterfront Park

Angophora hispida	Dwarf Apple	4m
Banksia integrifolia	Coastal Banksia	12m
Hymenosporum flavum	Native Frangipani	10m
Melaleuca styphelioides	Broad Leaved Paperbark	10m

Understorey Planting

Banksia ericifolia	Heath Banksia	5m
Carex appressa	Tall Sedge	1m
Dianella sp	Flax Lily	0.3-1m
Doryanthes excelsa	Gymea Lily	2-3m
Hakea teretifolia	Dagger Hakea	1-3m

Heathland Species

Lomandra longifolia 'Tanika'	Tanika	0.3m
Poa labillardieri 'Eskdale'	Blue Tussock	0.8m
Themeda australis	Kangaroo Grass	1.2m

INDICATIVE PLANT SCHEDULE

BOTANIC NAME	COMMON NAME	MATURE HEIGHT
--------------	-------------	---------------

Bioswale Trees

Eucalyptus sclerophylla	Hard Leaved Scribbly Gum	20m
Melaleuca styphelioides	Broad-Leaved Paperbark	10m

Climbers

Hardenbergia violacea 'Alba'	Purple Coral Pea	2m (spread)
Hibbertia scandens	Climbing Guinea Flower	4m (spread)
Pandorea jasminoides	Bower of Beauty	2-4m (spread)
Pandorea pandorana	Wonga Wonga Vine	2-3m (spread)

Wetland Planting

Baumea articulata	Joined Twig Rush	1-2.5m
Bolboschoenus fluviatilis	Marsh Club Rush	1-2m
Carex appressa	Tall Sedge	1m



NSW GOVERNMENT
Planning

Issued under the Environmental Planning and Assessment Act 1979

Approved Section 75W Modification Application

No. MOD 6 granted on the 15-12-14

in respect to MP 06-0025

Signed [Signature]

Sheet No. 3 of 7

Shoalhaven Market Place - Vincentia

Scott Carver

Scott Carver Pty Ltd
Level 9, 74 Macquarie Street
Sydney NSW 2000 Australia
Telephone +61 2 9957 3988
hello@scottcarver.com.au
www.scottcarver.com.au

Project
Client
Fabcot Pty Ltd



1:50@A3

Landscape Planting Palette

Reference No.	Discipline	Drawing No.	Rev.
20140011	LD	DA002	D

Status **Mod. 6 Submission**

RLA **Andrew Turnbull**

Print Date **20 October 2014**

Rev	Description	Date
A	Refer Mod. 5	18.11.13
B	Mod. 6 Submission	08.07.14
C	Mod. 6 Submission	14.10.14
D	Mod. 6 Submission	20.10.14



NSW GOVERNMENT
Planning

Issued under the Environmental Planning and Assessment Act 1979

Approved Section 75W Modification Application

No. **MOD 6** granted on the **15/12/14**

in respect to MP **06-0025**

Signed **[Signature]**

Sheet No. **4** of **7**

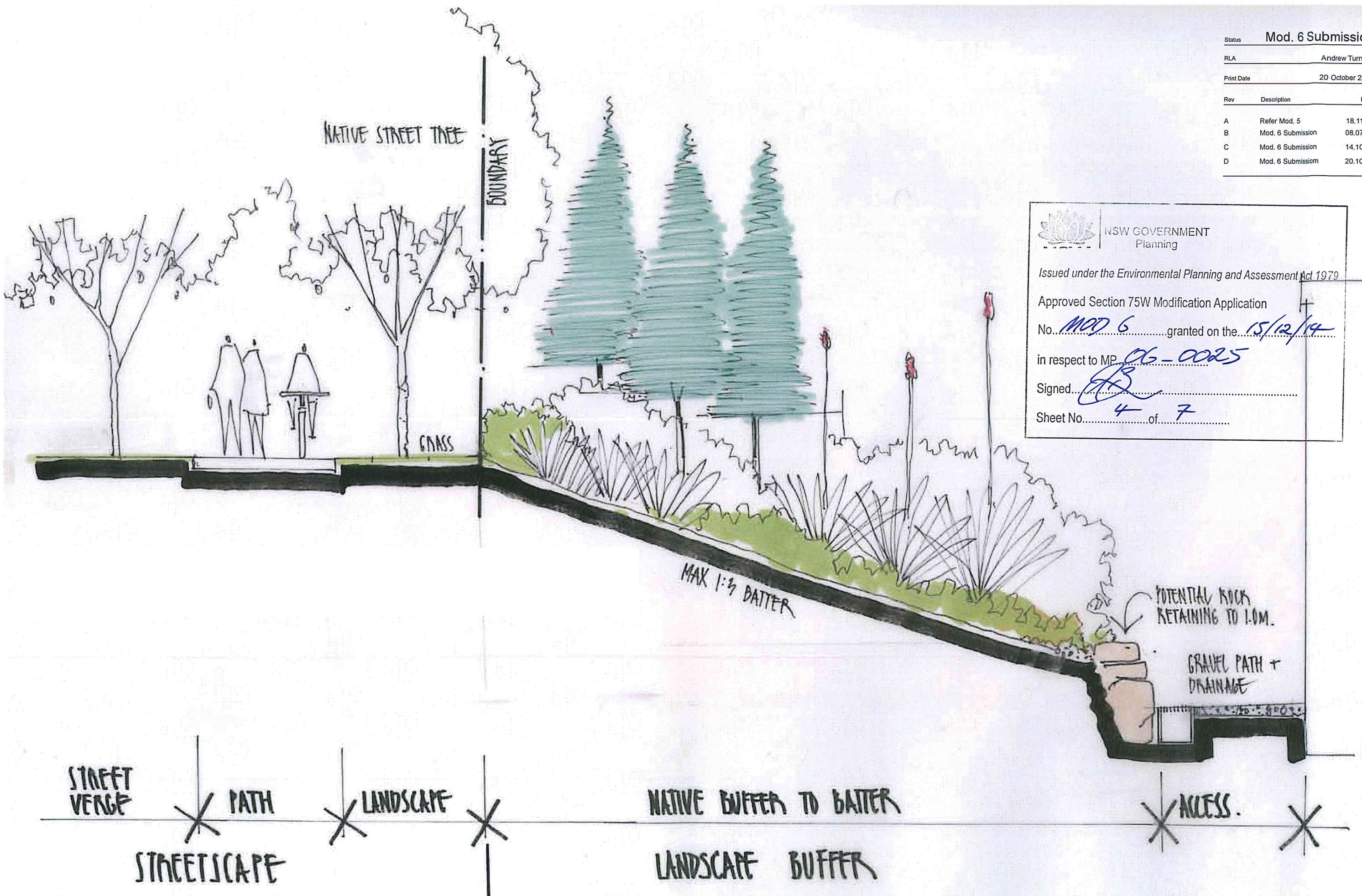

**Scott
Carver**

Scott Carver Pty Ltd
Level 8, 71 Macquarie Street
Sydney NSW 2000 Australia
Telephone +61 2 9957 3988
hello@scottcarver.com.au
www.scottcarver.com.au

Shoalhaven Market Place - Vincentia

Project
Client
Fabcot Pty Ltd



1:50@A3

Typical Section - Moona Road - Development

Reference No.	Discipline	Drawing No.	Rev.
20140011	LD	DA003	D

Rev	Description	Date
A	Refer Mod. 5	18.11.13
B	Mod. 6 Submission	08.07.14
C	Mod. 6 Submission	14.10.14
D	Mod. 6 Submission	20.10.14



Sydney Park aquatic planting at pond edge



Sydney Park grass to water

NSW GOVERNMENT
Planning

Issued under the Environmental Planning and Assessment Act 1979

Approved Section 75W Modification Application
No. **MOD 6** granted on the **15/12/14**
in respect to MP **06-0025**
Signed **[Signature]**
Sheet No. **5** of **7**

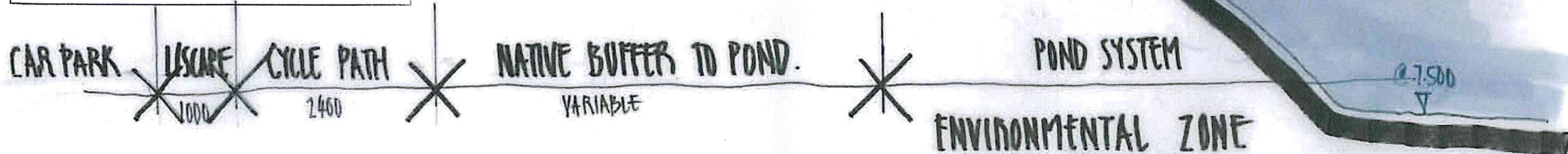

Rev	Description	Date
A	Refer Mod. 5	18.11.13
B	Mod. 6 Submission	08.07.14
C	Mod. 6 Submission	14.10.14
D	Mod. 6 Submission	20.10.14

PRECEDENTS



Sydney Park car park bioswale



Raingarden, Edinburgh Park, VIC



Victoria Park boardwalk



Sydney Park swale

Biofiltration and water harvesting elements previously included in the development are remaining. The boardwalk connection previously buried beneath the retail environment is now opened to a boardwalk for its full length to the wetlands and village green area.

NSW GOVERNMENT
Planning

Issued under the Environmental Planning and Assessment Act 1979

Approved Section 75W Modification Application

No. MOD 6 granted on the 15/12/14

in respect to MP 06-0025

Signed [Signature]

Sheet No. 6 of 7



Rev	Description	Date
A	Refer Mod. 5	18.11.13
B	Mod. 6 Submission	08.07.14
C	Mod. 6 Submission	14.10.14
D	Mod. 6 Submission	20.10.14

PRECEDENTS



Byron on Byron

NSW GOVERNMENT
Planning

Issued under the Environmental Planning and Assessment Act 1979

Approved Section 75W Modification Application

No. **MOD 6** granted on the **15/12/14**

in respect to MP **06-0025**

Signed **[Signature]**

Sheet No. **7** of **7**

NATIVE TREE
PLANTING

GRASSSED MOUND

CONC. PATH

PREFABRICATED BRIDGE
STRUCTURE

RETAINING WALL

SWALE INVERT

BRIDGE APPROACH

OVERLAND SWALE CORRIDOR

BRIDGE ACCESS + NATIVE
PLANTING INTERFACE