

STAGE 1  
GROUND FLOOR

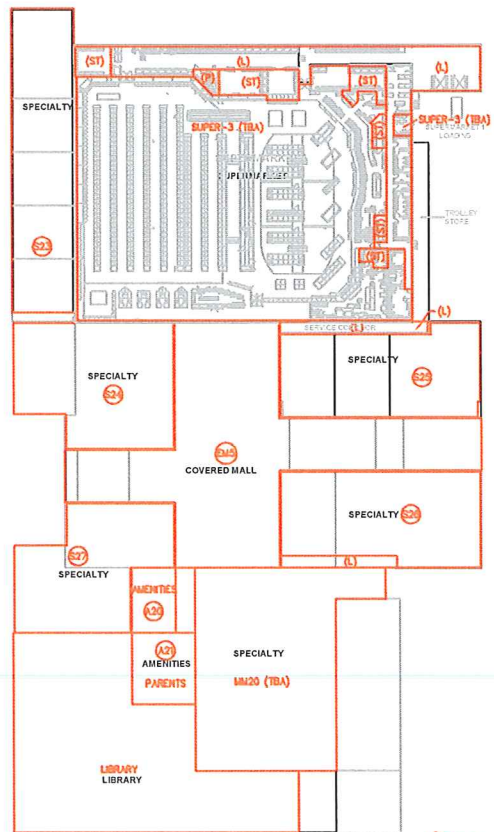

STAGE 2

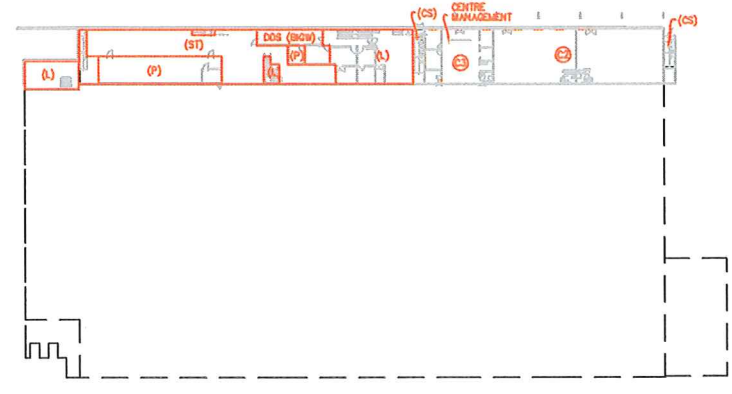

STAGE 1  
FIRST FLOOR

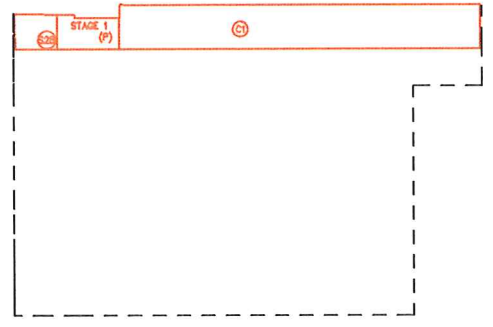

STAGE 2  
UPPER LEVEL  
(ENTRIES AT GROUND)

- NOTES:
- 1) THE TOTAL NUMBER OF CAR SPACES CALCULATED IS 8 LESS THAN ON THE PREVIOUS PLAN REF. 33504 CPC DATED 18-10-10. THE REASON IS:  
- THE PREVIOUS PLAN USED A RATIO OF 1 SPACE PER 24m<sup>2</sup> GFA TO CALCULATE THE NUMBER OF CAR SPACES FOR C1. HOWEVER, THIS RATIO ONLY APPLIES TO COMMERCIAL PREMISES WITHIN LAND ZONED 3(a). ELSEWHERE 1 SPACE PER 40m<sup>2</sup> GFA IS USED, AS THIS LAND IS ZONED B2. A RATIO OF 1:40 WAS USED WHICH REQUIRES 10 LESS CAR SPACES FOR C1.  
- THE AREA AT THE ENTRY TO DOS (BIG W) FROM THE COVERED MALL WAS INCLUDED IN THE CALCULATION IN THIS PLAN REQUIRING 1 EXTRA CAR SPACE.  
- THE RESULTING AREA OF THE RECONFIGURED SPECIALTY SHOPS, STORAGE, MM1 AND MM2 REQUIRES 1 EXTRA CAR SPACE.
  - 2) THE NUMBER OF CAR SPACES HAVE BEEN CALCULATED IN ACCORDANCE WITH SHOALHAVEN CITY COUNCIL DCP No. 18 CAR PARKING CODE.
  - 3) AREAS HAVE BEEN CALCULATED IN ACCORDANCE WITH THE DEFINITION OF "GROSS FLOOR AREA" AND "GROSS LEASABLE FLOOR AREA" AS DEFINED IN SHOALHAVEN CITY COUNCIL DCP No.18 CAR PARKING CODE.

NOT INCLUDED IN GFA AND GLEA AREAS

(L) - LOADING/UNLOADING SPACE, AMENITIES, CORRIDORS, STAIRS  
(CS) - COMMON VERTICAL CIRCULATION (STAIRS)  
(P) - PLANT SPACE

LEGEND

S - SPECIALTY SHOPS  
A - AMENITIES & SERVICES (INCL. CENTRE MAN., SECURITY, PARENTS & FOOD TERRACES)  
C - COMMERCIAL TENANCIES  
ST - STOCK STORAGE AREAS

LOADING AREAS HAVE BEEN CALCULATED TO THE INTERNAL FACE OF TENANCY WALLS

PLANS USED IN PREPARATION OF THESE AREAS

PROJ. NO. 07033 DWG. NO. 21.DR.DD.SK.145 ISSUE A  
PROJ. NO. 07033 DWG. NO. 21.DR.DD.SK.146 ISSUE A  
PROJ. NO. 07033 DWG. NO. 21.DR.DD.SK.147 ISSUE A

STAGE 1A							
TENANCY No.	AREA (m <sup>2</sup> )	CARS/m <sup>2</sup>	No. CARS	TENANCY No.	AREA (m <sup>2</sup> )	CARS/m <sup>2</sup>	No. CARS
SUPER-1 (BOW)	3337m <sup>2</sup>	1/19	175	S11	148m <sup>2</sup>	1/24	6
SUPER-1 (ST)	298m <sup>2</sup>	1/50	6	S12	113m <sup>2</sup>	1/24	5
SUPER-2 (ALD)	688m <sup>2</sup>	1/19	32	S13	643m <sup>2</sup>	1/24	27
SUPER-2 (ST)	353m <sup>2</sup>	1/50	7	S14	18m <sup>2</sup>	1/24	1
DOS (BOW) or	6678m <sup>2</sup>	1/24	278	S15	25m <sup>2</sup>	1/24	1
DOS (BOW) or	401m <sup>2</sup>	1/50	8	S16	18m <sup>2</sup>	1/24	1
DOS (BOW) or	55m <sup>2</sup>	1/24	2	S17	18m <sup>2</sup>	1/24	1
DOS (BOW) or	259m <sup>2</sup>	1/50	5	S18	26m <sup>2</sup>	1/24	1
MM1 (DOCK SMITH)	578m <sup>2</sup>	1/24	24	S19	137m <sup>2</sup>	1/24	6
MM2 (TBA)	601m <sup>2</sup>	1/24	25	S20	457m <sup>2</sup>	1/24	19
S1	135m <sup>2</sup>	1/24	6	C2 Upper	338m <sup>2</sup>	1/40	9
S2	730m <sup>2</sup>	1/24	30	C3 Upper	129m <sup>2</sup>	1/40	3
S3	1451m <sup>2</sup>	1/24	61	PUBLIC DINING (A)	343m <sup>2</sup>	1/8.5	53
S4	175m <sup>2</sup>	1/24	7	A1	120m <sup>2</sup>	0	0
S5	242m <sup>2</sup>	1/24	10	A2	137m <sup>2</sup>	0	0
S6	850m <sup>2</sup>	1/24	35	A3	6m <sup>2</sup>	0	0
S7	113m <sup>2</sup>	1/24	5	STORAGE 1 AND 2	72m <sup>2</sup>	1/50	1
S8	79m <sup>2</sup>	1/24	3	TOTAL STAGE 1A			877
S9	25m <sup>2</sup>	1/24	1				
S10	25m <sup>2</sup>	1/24	1				

STAGE 1B			
TENANCY No.	AREA (m <sup>2</sup> )	CARS/m <sup>2</sup>	No. CARS
S21	728m <sup>2</sup>	1/24	29
S22	628m <sup>2</sup>	1/24	26
S19	137m <sup>2</sup>	1/24	-6
TOTAL STAGE 1B			49

STAGE 2			
TENANCY No.	AREA (m <sup>2</sup> )	CARS/m <sup>2</sup>	No. CARS
SUPER-3 (TBA)	2705m <sup>2</sup>	1/19	142
SUPER-3 (ST)	211m <sup>2</sup>	1/50	4
LIBRARY	1400m <sup>2</sup>	1/24	58
MM20 (TBA)	1107m <sup>2</sup>	1/24	46
S23	699m <sup>2</sup>	1/24	29
S24	873m <sup>2</sup>	1/24	36
S25	629m <sup>2</sup>	1/24	26
S26	654m <sup>2</sup>	1/24	27
S27	573m <sup>2</sup>	1/24	24
S28 Upper	55m <sup>2</sup>	1/24	2
C1 Upper	583m <sup>2</sup>	1/40	14
A25	104m <sup>2</sup>	0	0
A21	166m <sup>2</sup>	0	0
TOTAL STAGE 2			400

TOTAL STAGE 1A	877
TOTAL STAGE 1B	49
TOTAL STAGES 1A AND 1B	926
TOTAL STAGE 2	400
TOTAL CARSPACES (STAGES 1A, 1B AND 2)	1326
(SEE NOTE 1)	

SCHEDULE OF FLOOR AREAS FOR CARPARKING CALCULATION

STAGE 1A							
TENANCY No.	AREA (m <sup>2</sup> )	CARS/m <sup>2</sup>	No. CARS	TENANCY No.	AREA (m <sup>2</sup> )	CARS/m <sup>2</sup>	No. CARS
SUPER-1 (WOW)	3337 m <sup>2</sup>	1/19	175	S11	148 m <sup>2</sup>	1/24	6
SUPER-1 (ST)	298 m <sup>2</sup>	1/50	6	S12	113 m <sup>2</sup>	1/24	5
SUPER-2 (ALDI)	988 m <sup>2</sup>	1/19	52	S13	643 m <sup>2</sup>	1/24	27
SUPER-2 (ST)	353 m <sup>2</sup>	1/50	7	S14	18 m <sup>2</sup>	1/24	1
DDS (BIGW) Gr	6676 m <sup>2</sup>	1/24	278	S15	25 m <sup>2</sup>	1/24	1
DDS (BIGW) Gr-ST	401 m <sup>2</sup>	1/50	8	S16	18 m <sup>2</sup>	1/24	1
DDS (BIGW) 1ST	55 m <sup>2</sup>	1/24	2	S17	18 m <sup>2</sup>	1/24	1
DDS (BIGW) 1ST-ST	259 m <sup>2</sup>	1/50	5	S18	26 m <sup>2</sup>	1/24	1
MM1 (DICK SMITH)	576 m <sup>2</sup>	1/24	24	S19	137 m <sup>2</sup>	1/24	8
MM2 (TBA)	601 m <sup>2</sup>	1/24	25	S20	457 m <sup>2</sup>	1/24	19
S1	135 m <sup>2</sup>	1/24	6	C2 Upper	338 m <sup>2</sup>	1/40	9
S2	730 m <sup>2</sup>	1/24	30	C3 Upper	129 m <sup>2</sup>	1/40	3
S3	1454 m <sup>2</sup>	1/24	61	PUBLIC DINING(A4)	343 m <sup>2</sup>	1/6.5	53
S4	175 m <sup>2</sup>	1/24	7	A1	120 m <sup>2</sup>	0	0
S5	242 m <sup>2</sup>	1/24	10	A2	137 m <sup>2</sup>	0	0
S6	850 m <sup>2</sup>	1/24	35	A3	6 m <sup>2</sup>	0	0
S7	113 m <sup>2</sup>	1/24	5	STORAGE 1 AND 2	72 m <sup>2</sup>	1/50	1
S8	79 m <sup>2</sup>	1/24	3	TOTAL STAGE 1A			877
S9	25 m <sup>2</sup>	1/24	1				
S10	25 m <sup>2</sup>	1/24	1				

STAGE 1B			
TENANCY No.	AREA (m <sup>2</sup> )	CARS/m <sup>2</sup>	No. CARS
S21	708 m <sup>2</sup>	1/24	29
S22	626 m <sup>2</sup>	1/24	26
S19	137 m <sup>2</sup>	1/24	-6
TOTAL STAGE 1B			49

STAGE 2			
TENANCY No.	AREA (m <sup>2</sup> )	CARS/m <sup>2</sup>	No. CARS
SUPER-3(TBA)	2705 m <sup>2</sup>	1/19	142
SUPER-3 (ST)	211 m <sup>2</sup>	1/50	4
LIBRARY	1400 m <sup>2</sup>	1/24	58
MM20 (TBA)	1107 m <sup>2</sup>	1/24	46
S23	699 m <sup>2</sup>	1/24	29
S24	673 m <sup>2</sup>	1/24	28
S25	629 m <sup>2</sup>	1/24	26
S26	654 m <sup>2</sup>	1/24	27
S27	573 m <sup>2</sup>	1/24	24
S28 Upper	55 m <sup>2</sup>	1/24	2
C1 Upper	583 m <sup>2</sup>	1/40	14
A20	104 m <sup>2</sup>	0	0
A21	166 m <sup>2</sup>	0	0
TOTAL STAGE 2			400

TOTAL STAGE 1A	877
TOTAL STAGE 1B	49
TOTAL STAGES 1A AND 1B	926
TOTAL STAGE 2	400
TOTAL CARSPACES (STAGES 1A,1B AND 2)	1326
(SEE NOTE 1)	

CSM