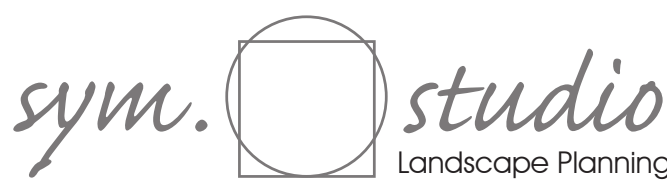



Image Source: Brewster Hjorth Architects

ROSEVILLE COLLEGE - SWELL CENTRE

SSDA LANDSCAPE PACKAGE (AMENDED)
OCTOBER 2020



HERITAGE & ZONING

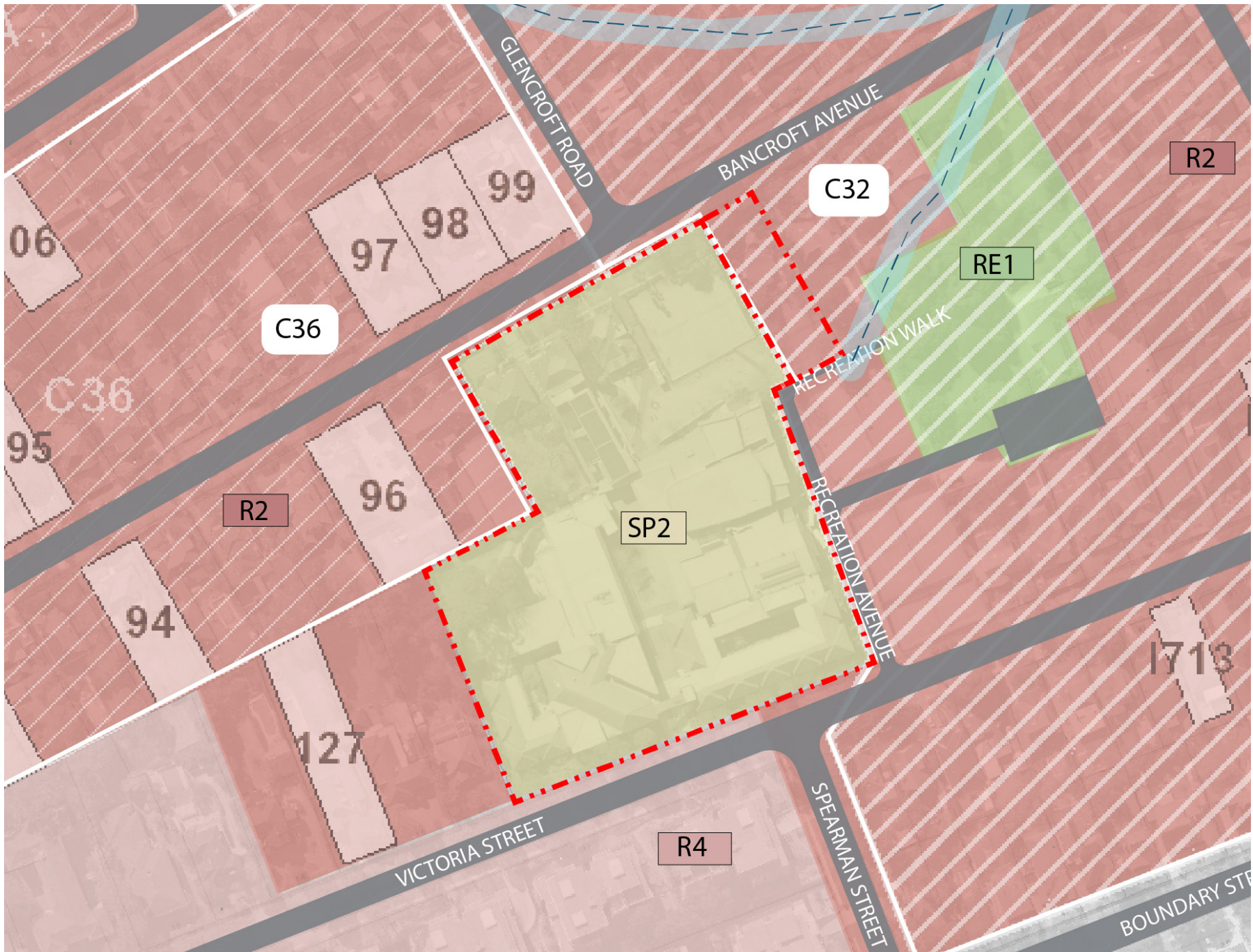

- Site Boundary

RE1 Public Recreation

SP2 Infrastructure

R2 Low Density Residential

R4 High Density Residential
- No. Heritage Items and numbers

Conservation Area (C32 & C36)

Category 3A Riparian

LOCAL ATTRACTORS



1. Roseville Tennis Club
2. Ku-ring-gai Art Centre
3. Bancroft Park

PEDESTRIAN CIRCULATION



- Site Boundary
- Pedestrian Pathways
- School Entry Points

BACKGROUND INFORMATION

HERITAGE

The site is located within Clanville Conservation Area and is zoned as R2 (low residential)

The existing Roseville College does not fall within a conservation area but is however “Within the vicinity of a heritage item” Nos 6,8,9, 10 19, 24, 26 & 28 Bancroft Avenue; and Nos 16, 49, 50, & 52 Victoria Street. The newly aquired dwelling house at No. 37 Bancroft Avenue (Lot 18 DP 5035) is not heritage listed but does fall within the Clanville Heritage Conservation Area (HCA 32)

The Clanville HCA has high historic significance as the David Dering Mathew grant of 400 acres called “Clanville” later subdivided into smaller lots. This layout of farmsteads is today demonstrated by the east/west axis of the roads.

Heritage Conservation of the KLEP details the provisions which relate to heritage items and heritage conservation areas.

The objectives of this clause are as follows:

(a) to conserve the environmental heritage of Ku-ring-gai,

(b) to conserve the heritage significance of heritage items and heritage conservation areas,

including associated fabric, settings and views,

Part 19 applies to any development within a Heritage Conservation Area (HCA) identified on the KLEP 2015.

The heritage controls in this Part of the Ku-ring-gai DCP aim to:

i) retain, conserve and enhance the Heritage Items, HCAs and their associated settings;

ii) ensure the heritage significance, streetscape and landscape character of HCAs are maintained;

iii) ensure alterations and additions to Heritage Items and within HCAs respect those buildings and do not compromise the significance and character of the individual Heritage Items or the HCAs; (Excerpt from Ku-ring-gai Local Environmental Plan 2015 (KLEP 2015))

The southern boundary is adjacent to a public thoroughfare from Recreation Avenue to the Bancroft Park.

CATEGORY 3A RIPARIAN LAND

Category 3 Bed and bank stability/water quality

Riparian zones in this category would provide limited habitat value but provide an important contribution to the overall health of the catchment.

Typically these would be narrow zones along highly modified streams that may have no indigenous vegetation. These streams would be difficult, and in some cases not possible, to rehabilitate to a natural state.(refer to Figure 4). However, these areas will still contribute significantly to downstream water quality maintenance, and if piped or lined with concrete, would cause increased flooding and erosion potential.

Many of the riparian environments that fall into this category are on private property with the streams forming part of the landscape character of the garden. As a consequence the longerterm management of these systems will rely on strong partnerships with private property owners and the community.

(Excerpt from Ku-ring-gai Riparian Policy (2004))

LEGEND

- Property Boundary
- Extent of basement (below)
- Line of SSDA
- (xx.xx)

Existing Levels
- xx.xx

Proposed Levels
- Existing trees to be retained
- +

Proposed Trees
- Existing Planting to be retained
- Mass Planting
- Lawn - Managed
- Lawn - Synthetic Turf
- Retractable Sports Fencing
- Landscape Walling
- Garden Edging
- Integrated Timber Seating
- Paving Type 1, Feature Stone
- Paving Type 2, Feature Concrete
- Paving Type 3, Unit Pavers
- Paving Type 4, Pebbles
- Feature timber Elements
- Proposed Overland Hydrology
(Refer Engineer)

KEY

- 01 Internal Classroom /Learning Rooms
- 02 Internal Food Technology
- 03 Food Tech Garden
- 04 SWELL Centre Primary Pedestrian Entry
- 05 Internal /External Verandah Break out Space
- 06 School 'Green Spine' Lawn Terrace
- 07 Sport Court /Lawn Terrace Connection
- 08 Multifunctional Sports Courts (Synthetic Surfacing)
- 09 School Secondary Pedestrian Entry
- 10 School Secondary Entry Assembly Point
- 11 SWELL Centre Tertiary Pedestrian Exit
- 12 Retain Public Street Trees
- 13 Retained Low Brick Wall & Hedging
- 14 New Low Brick Wall & Hedging - to match existing
- 15 Retain grades as per existing Sloped Lawn
- 16 Slab edge curtin drain, to Engineers Detail Design
- 17 Clumped Hydrangea with Underplanting
- 18 New Substation with hedge planting
- 19 Retained Tree 4 (Qld. Kauri Pine)
- 20 Retained Tree 7 (Himalayan cedar)
- 21 Transplanted Deciduous Pear Tree, qty.6
- 22 Building Green Screen w/ Climbing vines
- 23 SWELL Centre Maintenance Access
- 24 SWELL Pool Roof Skylight
- 25 SWELL Level 3 Rooftop Planter, 0.4M depth
- 26 SWELL Centre Tertiary Pedestrian Exit
- 27 New mid-story Screen Trees
- 28 Existing Timber Fence, 1.8M - repair as required
- 29 New Pedestrian Access Gate, nom. 2.0M high
- 30 New Structure, heat pump
- 31 New Pedestrian Access Gate, nom. 2.0M high
- 32 New Vehicular Access Gate, nom. 2.0M high
- 33 Reconfigure Existing Stair Access
- 34 New street trees to match existing, qty.3

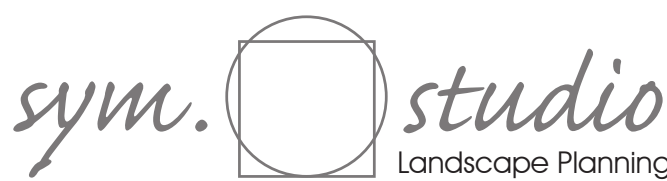
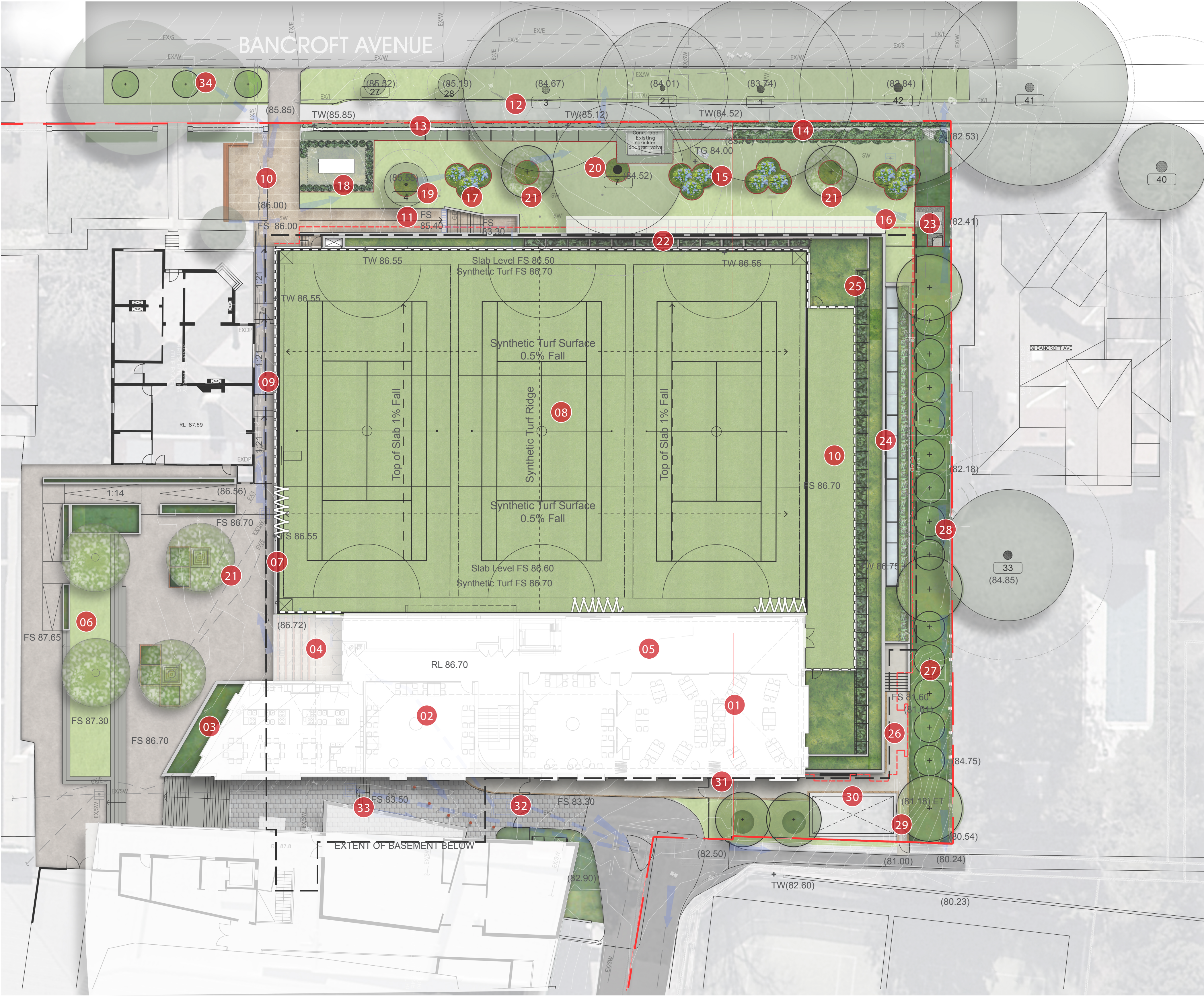

Sheet: EPM05-DA-101

Project: Roseville College SWELL Centre
Client: Brewster Horth Architects
Stage: SSDA, Amended
Prepared: MCG/CG
Date: 29/10/2020

D

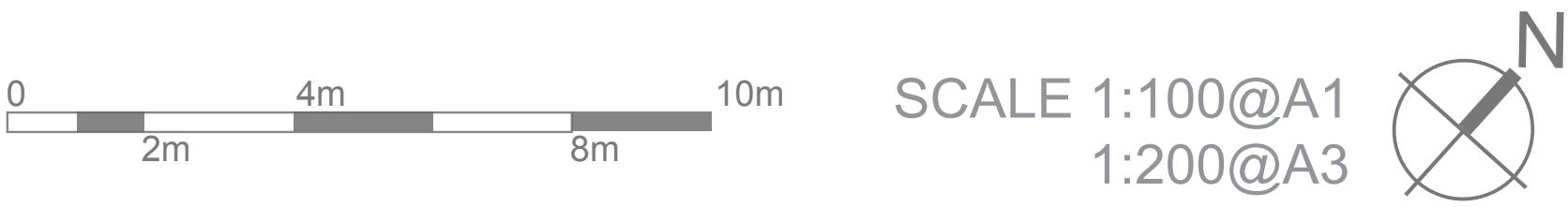
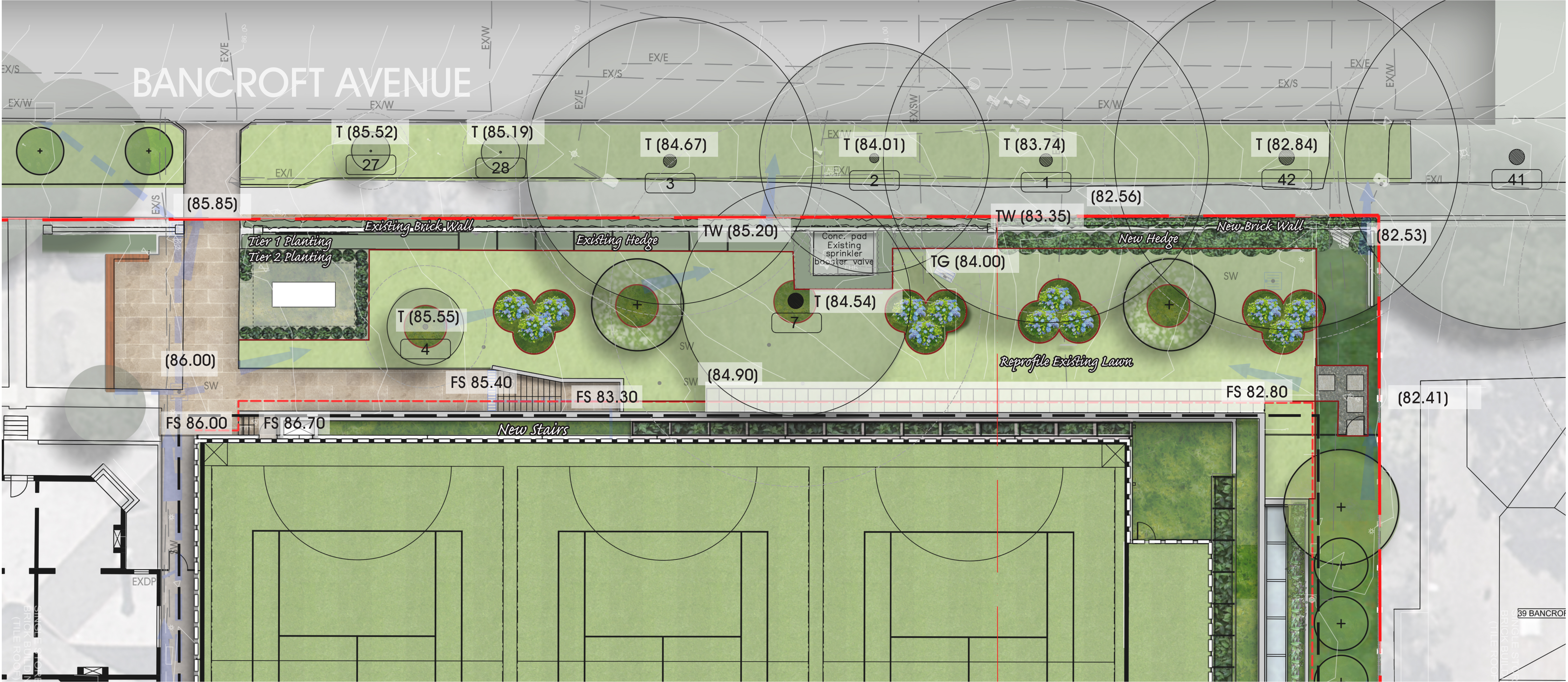

epm
projects pty ltd

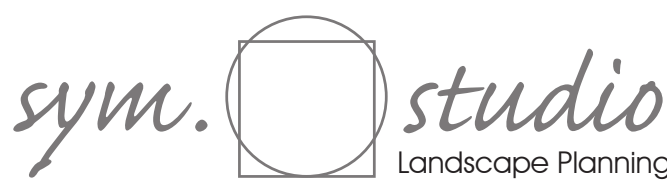

Sheet: EPM05-DA-102

Project: Roseville College SWELL Centre
Client: Brewster Hjorth Architects
Stage: SSDA, Amended
Prepared: MCG/CG
Date: 29/10/2020

D



Roof Level - Green Screen/Steel Trellis.



Elaeocarpus reticulatus



Pyrus calleryana 'Capital'



Lagerstroemia indica natchez



Camellia sasanqua 'Early Pearly'



Michelia figo



Magnolia grandiflora 'Teddy Bear'



Rhapsiolepis indica
'Cosmic White'



Juniperus conferta



Pandorea pandorana

4 x transplanted Pyrus calleryana
(Ornamental Pears). Refer Plant
Schedule 'Trees'



Tracheospermum jasminoides



Brachyscome multifida



Carpobrotus edulis



Lomandra longifolia 'Tanika'



Myoporum parvifolium



Rosmarinus 'Prostratus's'



Frontage Design Intent

Species to Bancroft frontage reflect an informal landscape character, referencing previous lot boundaries (residential street scale) and heritage adjacent location.

Street frontage Infill Planting to match existing (18 Lm) Refer Plant Schedule 'Street Frontage Infill Planting' Continuation of Bancroft Avenue existing streetscape character including brick wall, hedge planting and brick garden edge.

12 x Hydrangea macrophylla (planted in groups of 3) in garden beds. Underplant w/ Ajuga reptans 'Catkins Giant' & Juniperus conferta.

1 x Pyrus calleryana (transplanted)

Roof Level - Mass planting.

Grasses & Groundcovers. Refer below callout for species list. 0.3 - 0.45m soil depth.

1 x Specimen Tree

Pyrus calleryana 'Capital'

Roof Level - Green Screen/Steel Trellis. (50 Lm)

Pre-grown Climbers/Vines for instant impact. Trachelospermum jasminoides (Star Jasmine) and Pandorea pandorana (Wonga Wonga Vine)

13 x Ground Level - Medium Screen Planting (Approx. 3.5m High)

Option 1: Michelia figo (Port Wine Magnolia)

Option 2: Lagerstroemia indica 'Nafray'

Option 3: Magnolia "Teddy Bear"

Level 2 - Low Planting (Approx. 1.5m High)

Planter alongside skylights. Stachys lanta 'Silver Carpet' 0.45m soil depth.

1 x Specimen Tree

Pyrus calleryana 'Capital'

Ground Level - Ground Cover Planting

Low maintenance. Trafficable, easy to access skylights for maintenance. Juniper conferta (Shore Juniper)

Roof Level - Mass planting.

Grasses & Groundcovers
Brachyscome multifida (Cut-Leafed Daisy)
Carpobrotus edulis (Pig face)
Lomandra longifolia 'Tanika' (Tanika Mat Rush)
Myoporum parvifolium (Creeping boobiala)
Rosmarinus 'Prostratus' (Creeping Rosemary)
0.3 - 0.45m soil depth.

1 x Specimen Tree

Pyrus calleryana 'Capital'

2 x Elaeocarpus reticulatus (Blueberry Ash) Trees.

0 4m 8m 16m 20m

SCALE 1:200@A1
1:400@A3

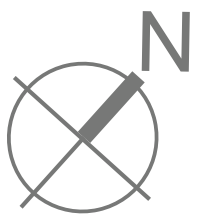

epm
projects pty ltd

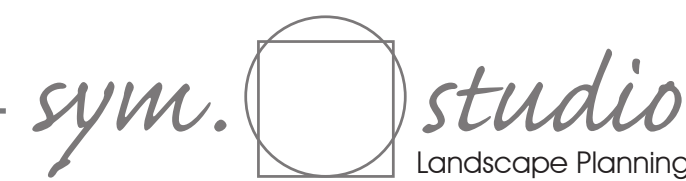

Sheet: EPM05-DA-103

Project: Roseville College SWELL Centre
Client: Brewster Horth Architects
Stage: SSDA, Amended
Prepared: MCG/CG
Date: 29/10/2020

D

EXISTING LANDSCAPE PALETTE



PROPOSED LANDSCAPE PALETTE

Code	Botanical Name	Common Name	Mature size (HxS) (m)	Pot Size	Qty
Trees					
ELA ret	Elaeocarpus reticulatus	Blueberry Ash	9 x 4	200 Lt	2
GOR axi	Gordonia axillaris	Fried Egg Tree	5 x 3	100 Lt	3
PYR cal C	Pyrus calleryana 'Capital'	Ornamental Pear, Upright	10 x 5	75 Lt	3
PYR cal	Pyrus calleryana (Transplant Existing)	Ornamental Pear	6 x 4	Advanced	6
FRONT GARDEN BED/POCKET PLANTING					
Groundcovers & Grasses					
AJU rep CG	Ajuga reptans 'Catkins Giant'	Bugleweed	05 x .04	140mm	4/m2
JUN con	Juniperus conferta	Shore Juniper	0.2 x 1	140mm	4/m2
STREET FRONTAGE INFILL PLANTING					
Climbers					
CAL vin	Callistemon viminalis	weeping bottlebrush	2.0 x 1.0 (hedged)	400mm	-
HYD mac	Hydrangea macrophylla	French Hydrangea	2 x 2.5	200mm	12
MUR pan	Murraya paniculata (To match existing)	Orange Jasmine	2.0 x 1	200mm	-
NAN dom	Nandina domestica (To match existing)	sacred bamboo	0.5 x 0.5	140mm	-
RHA ind SM	Rhaphiolepis indica 'Snow Maiden'	Indian Hawthorn	1.0 x1.0	200mm	-
PRODUCTIVE/EDIBLE PLANTING					
Misc					
ROS off	Rosmarinus officinalis	Rosemary	0.6 x 0.6	200mm	-
SAL off	Salvia officinalis	Sage	0.6 x 0.6	140mm	-
THY x cit	Thymus x citriodorus / vulgaris	Lemon Thyme	0.3 x 0.4	140mm	5/m2
TUL vio	Tulbagia violacea	Society garlic	0.3 x 0.3	200mm	5/m2
BOUNDARY PLANTING					
Shrubs					
-	Option 1: Michelia figo (Port Wine Magnolia) Option 2: Lagerstroemia indica 'Nafray' Option 3: Magnolia 'Teddy Bear'	-	-	-	13
Groundcovers & Grasses					
CAR app	Carex appessa	Capitae sage	0.6 x 0.6	160mm	9/m2
DIC rep	Dichondra repens	Kidney weed	0.2 x 1.5	140mm	6/m2
ISO nod	Isolepis nodosa	Knobby club rush	0.4	V/cell	3 / m2
JUN con	Juniperus conferta	Shore Juniper	0.2 x 1	140mm	4/m2
LOM lon T	Lomandra longifolia 'Tanika'	Tanika Mat Rush	0.6 x 0.6	140mm	6/m2
SCA mau	Scaevola 'Mauve Clusters'	Fairy fan flower	0.5 x 0.3	140mm	5/m2
VIO hed	Viola hederacea 'Monga Magic'	Native Violet	0.5 x 0.3	140mm	5/m2
ROOFTOP PLANTING					
Shrubs					
Groundcovers & Grasses					
BRA mul	Brachyscome multifida	Cut-Leafed Daisy	05 x .04	140mm	-
CAR edu	Carpobrotus edulis	Pig face	0.2 x 1	140 mm	-
LOM lon T	Lomandra longifolia 'Tanika'	Tanika Mat Rush	0.6 x 0.6	140mm	-
MYO par	Myoporum parvifolium	Creeping boobiala	0.2 x 1.5	140mm	-
ROS pro	Rosmarinus 'Prostratus'	Rosemary	0.4 x 1.5	200mm	-
GREEN SCREEN TRELIS & GREEN FACADE					
Climbers					
TRA jas	Trachelospermum jasminoides	Star jasmine	0.2 x 1	Advanced pre grown	-
PAN pan	Pandorea pandorana	Wonga Wonga Vine	0.2 x 1	Advanced pre grown	-



Reinforce Identity Planting +
Introduce Contemporary Colour & texture

semi formal garden style, low maintenance, beauty & colour

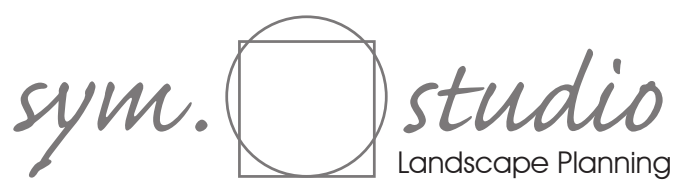

Sheet: EPM05-DA-104

Project: Roseville College SWELL Centre
Client: Brewster Horth Architects
Stage: SSDA, Amended
Prepared: MCG/CG
Date: 29/10/2020

LEGEND

- Trees to be retained
- Trees to be removed
- Trees to be relocated (if suitable alternate location available)

Note: Sym Studio Markup over aerial.

For information purposes only. Refer arborist report.

T7 to be retained. Ground level to remain as per existing. Modify ground level <200mm under site arborist supervision.

Street trees to be retained.

New substation.

T4 to be retained. Ground level to remain as per existing. Modify ground level <200mm under site arborist supervision.

Existing frangipanni to be retained.

Blue line indicates approximate extent of revised design

Sym Studio to assess viability of keeping select trees to existing lawn area with new design. Possible relocation.

T18-26. 9 trees to be removed due to development impact and transplanted on site (where possible.)

Existing concrete pad/ fire booster

T43 Olea europaea africana to be removed

T44 Acer palmatum (lopped around service wires) to be removed.

Trees to be removed due to development impact.

T33 to be retained and protected. Increase to TPZ incursion to be assessed by arborist.

Trees to be removed due to development impact.

Trees to be removed due to development impact and or poor form.

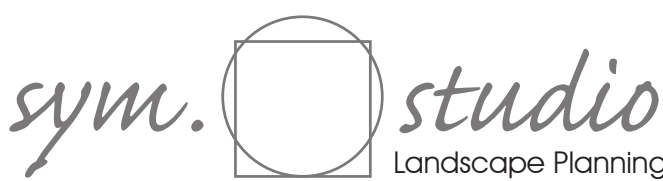
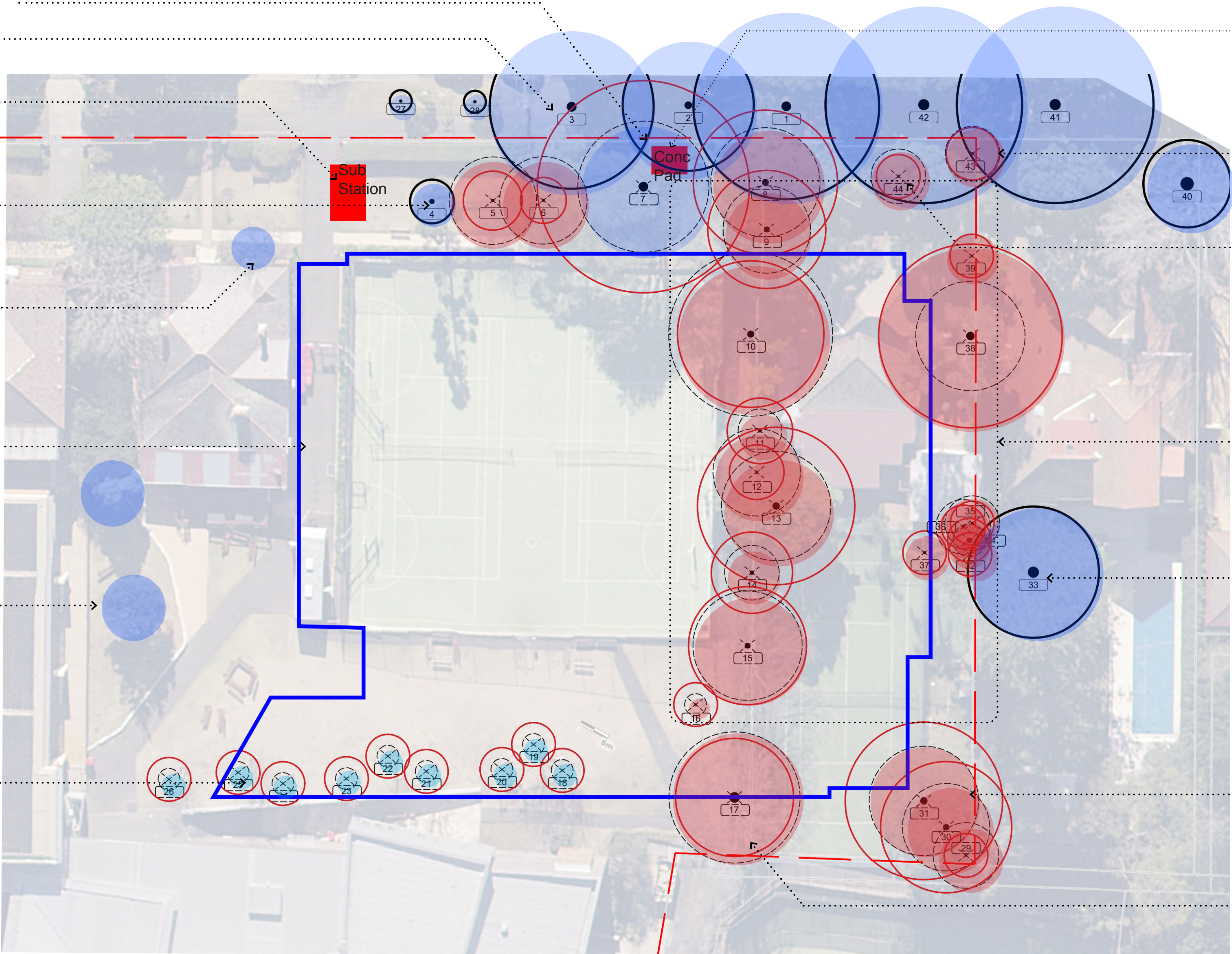

Sheet: EPM05-DA-105

Project: Roseville College SWELL Centre
Client: Brewster Horth Architects
Stage: SSDA, Amended
Prepared: MCG/CG
Date: 29/10/2020

D



1. EXISTING - STREET FRONTAGE CHARACTER



2. DEVELOPMENT IMPACT - STREET FRONTAGE CHARACTER



3. ENHANCEMENT STRATEGY - STREET FRONTAGE CHARACTER