

KEY

- |   |   |
|---|---|
| 1. Central platform with canopy.  | 11. New advanced street tree planting to Anzac Pde.   |
| 2. Signalised pedestrian crossing across Anzac Pde providing access to both ends of the stop. | 12. Signalised and paved pedestrian crossing upgrade. |
| 3. Low WSUD planting (bioswale)   | 13. Shared use catenary /light poles.                 |
| 4. Upgraded footpath materials.   |   |
| 5. All weather bus shelter with seating.  |   |
| 6. Public domain upgrades to UNSW Western Campus.   |   |
| 7. Expanded public domain threshold to College Walk and University Mall.                      |   |
| 8. University scaled precinct markers.  |   |
| 9. Proposed northbound bus lay-by.  |   |
| 10. Proposed southbound bus lay-by with taxi drop off.  |   |

NB. Refer to design statement for detained description of stop configuration and public realm.

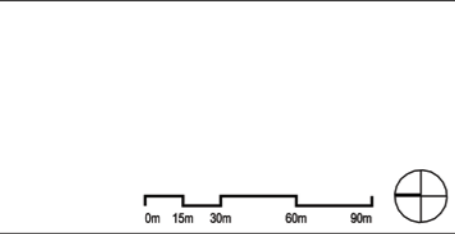

LEGEND

GENERAL

- BUS LANE
- TAXI PICK UP DROP OFF ZONE
- CATENARIES
- BIKE PATH
- VEHICULAR MOVEMENT

FINISHES - PAVING TYPES

- G1 - PEDESTRIAN HIGH QUALITY GRANITE PAVERS
- G2 - TRAFFICABLE HIGH QUALITY GRANITE PAVERS
- G3 - TRAFFICABLE AND PEDESTRIAN HIGH QUALITY GRANITE PAVERS
- UNSW BOUNDARY

FURNITURES AND FIXTURES

- BENCH TYPE 1
- FENCE
- TOTEM
- LIGHT POSTS
- CANOPIES

SOFTWORKS

- PROPOSED TREES
- EXISTING TREES
- MASS PLANTING
- TURF



ASPECT Studios<sup>®</sup>  
Tzannes Associates ARCHITECTURE URBAN DESIGN

SCALE	DRAWN	CHECKED	DATE	PROJECT	DRAWING	REVISION
1:1500 @ A3	TA TH	SC	12/12/13	13040	13	A

CBD & South East Light Rail Project  
EIS Response for UNSW  
UNSW ANZAC PDE STOP  
LANDSCAPE AND GROUNDPLANE PLAN

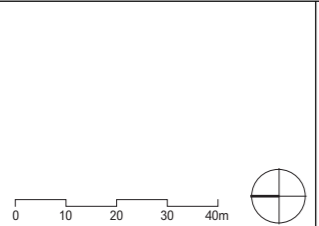
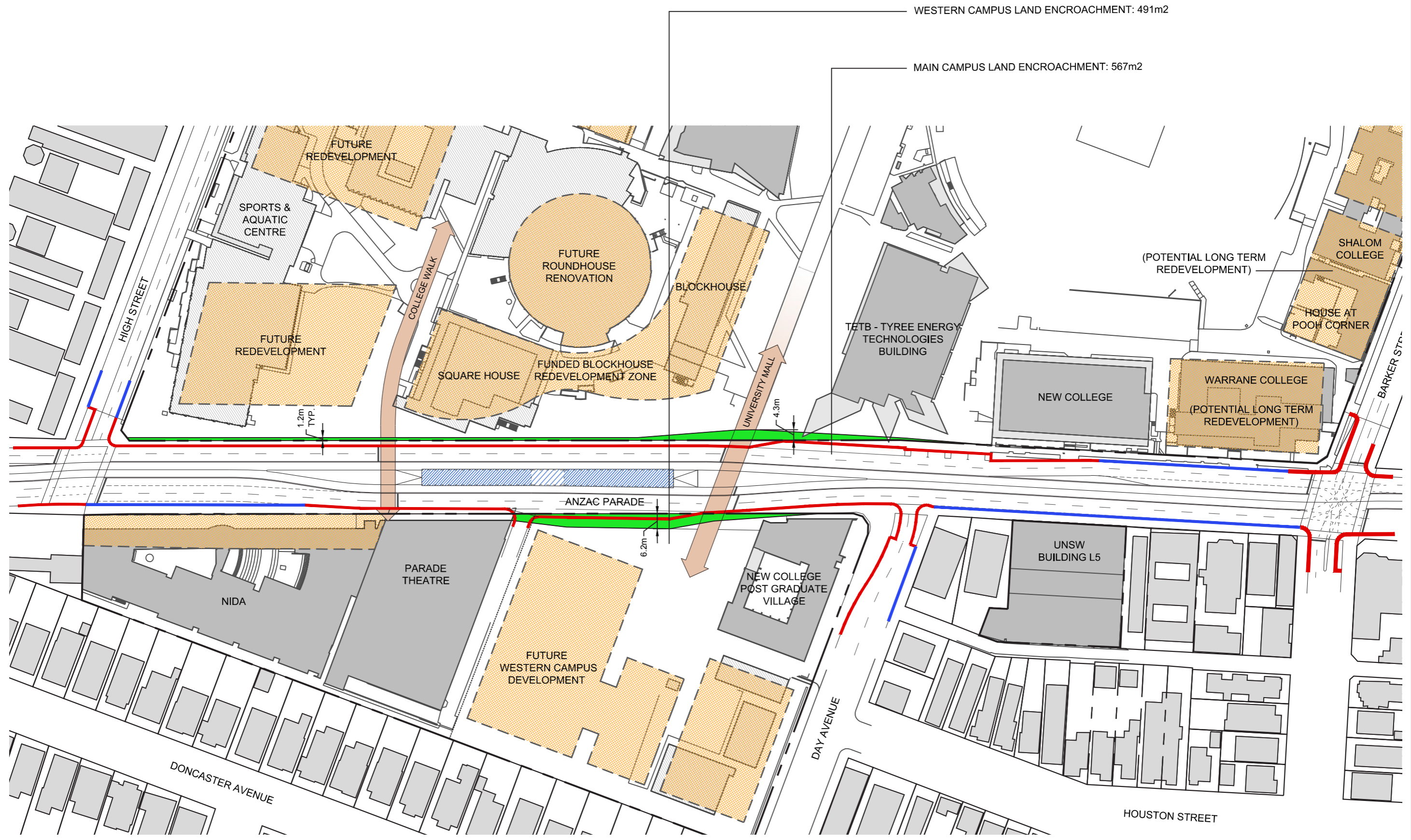

- LEGEND**
- UNSW Impacted Land
  - Existing Kerbs to Remain
  - New Kerbs Understood to be Required

**UNSW**  
AUSTRALIA

**ASPECT Studios**  
Tzannes Associates ARCHITECTURE URBAN DESIGN

CBD & South East Light Rail Project  
EIS Response for UNSW

UNSW Anzac Parade Stop -  
Campus Encroachment

SCALE	DRAWN	CHECKED	DATE	PROJECT	DRAWING	REVISION
1:1500 @A3	NB	AW	06/12/13	13040	14	A

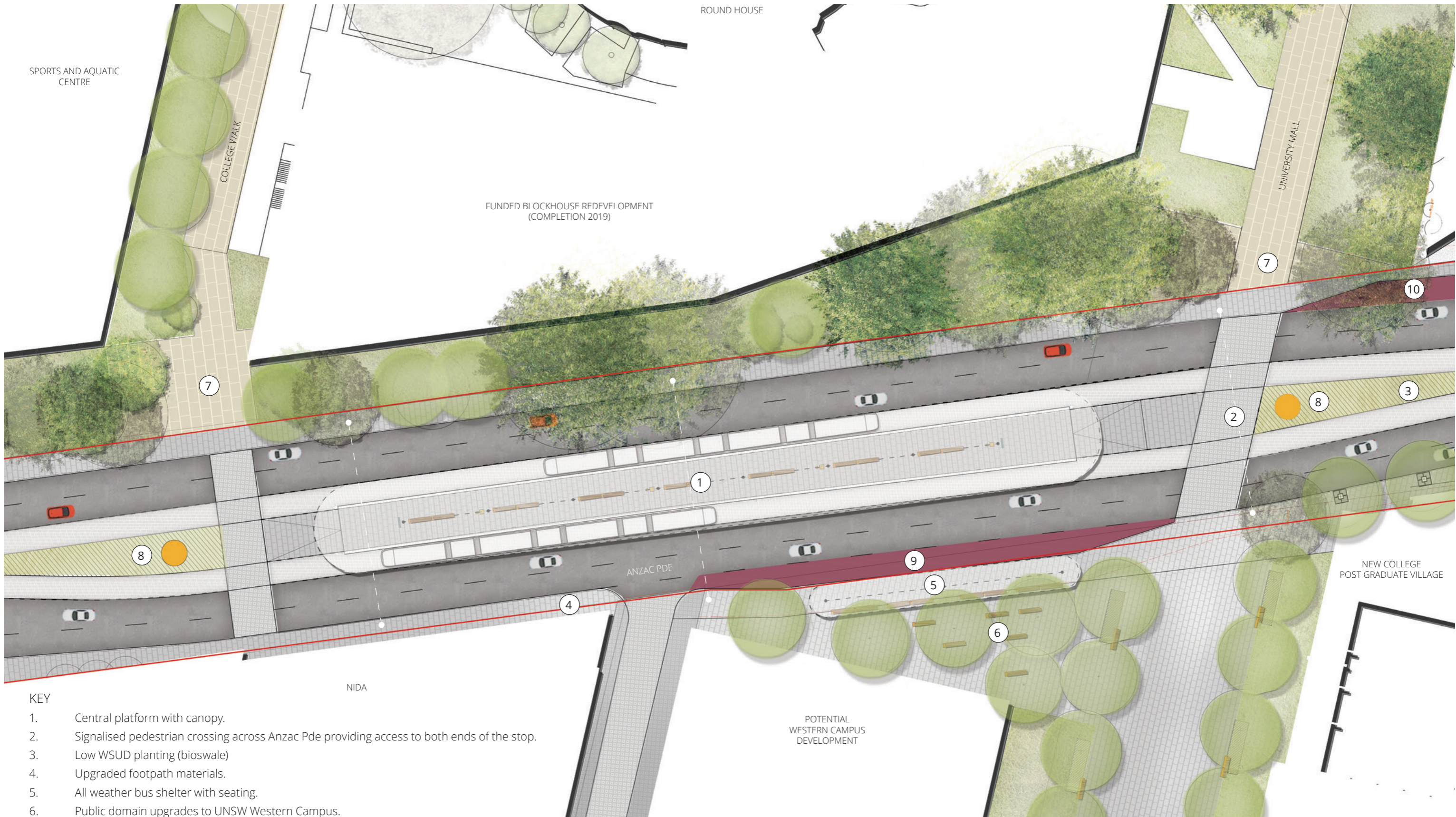

- KEY
- 1. Central platform with canopy.
  - 2. Signalised pedestrian crossing across Anzac Pde providing access to both ends of the stop.
  - 3. Low WSUD planting (bioswale)
  - 4. Upgraded footpath materials.
  - 5. All weather bus shelter with seating.
  - 6. Public domain upgrades to UNSW Western Campus.
  - 7. Expanded public domain threshold to College Walk and University Mall.
  - 8. University scaled precinct markers.
  - 9. Proposed northbound bus lay-by.
  - 10. Proposed southbound bus lay-by.

NB. Refer to design statement for detained description of stop configuration and public realm.

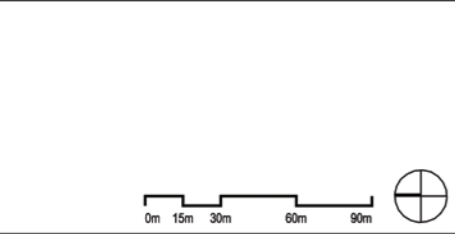

LEGEND	
<strong>GENERAL</strong>	
	BUS LANE
	TAXI PICK UP DROP OFF ZONE
	CATENARIES
	BIKE PATH
	VEHICULAR MOVEMENT
<strong>FINISHES - PAVING TYPES</strong>	
	G1 - PEDESTRIAN HIGH QUALITY GRANITE PAVERS
	G2 - TRAFFICABLE HIGH QUALITY GRANITE PAVERS
	G3 - TRAFFICABLE AND PEDESTRIAN HIGH QUALITY GRANITE PAVERS
	UNSW BOUNDARY
<strong>FURNITURES AND FIXTURES</strong>	
	BENCH TYPE 1
	FENCE
	TOTEM
	LIGHT POSTS
	CANOPIES
<strong>SOFTWORKS</strong>	
	PROPOSED TREES
	EXISTING TREES
	MASS PLANTING
	TURF

		CBD & South East Light Rail Project EIS Response for UNSW			
ASPECT Studios <sup>®</sup>		UNSW ANZAC PDE STOP LANDSCAPE AND GROUNDPLANE PLAN			
Tzannes Associates ARCHITECTURE URBAN DESIGN					
SCALE 1:500 @ A3	DRAWN TA TH	CHECKED SC	DATE 12/12/13	PROJECT 13040	DRAWING 15
				REVISION A	

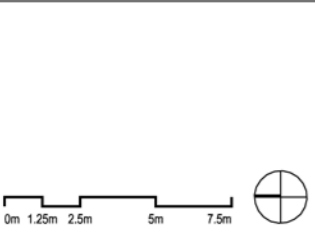
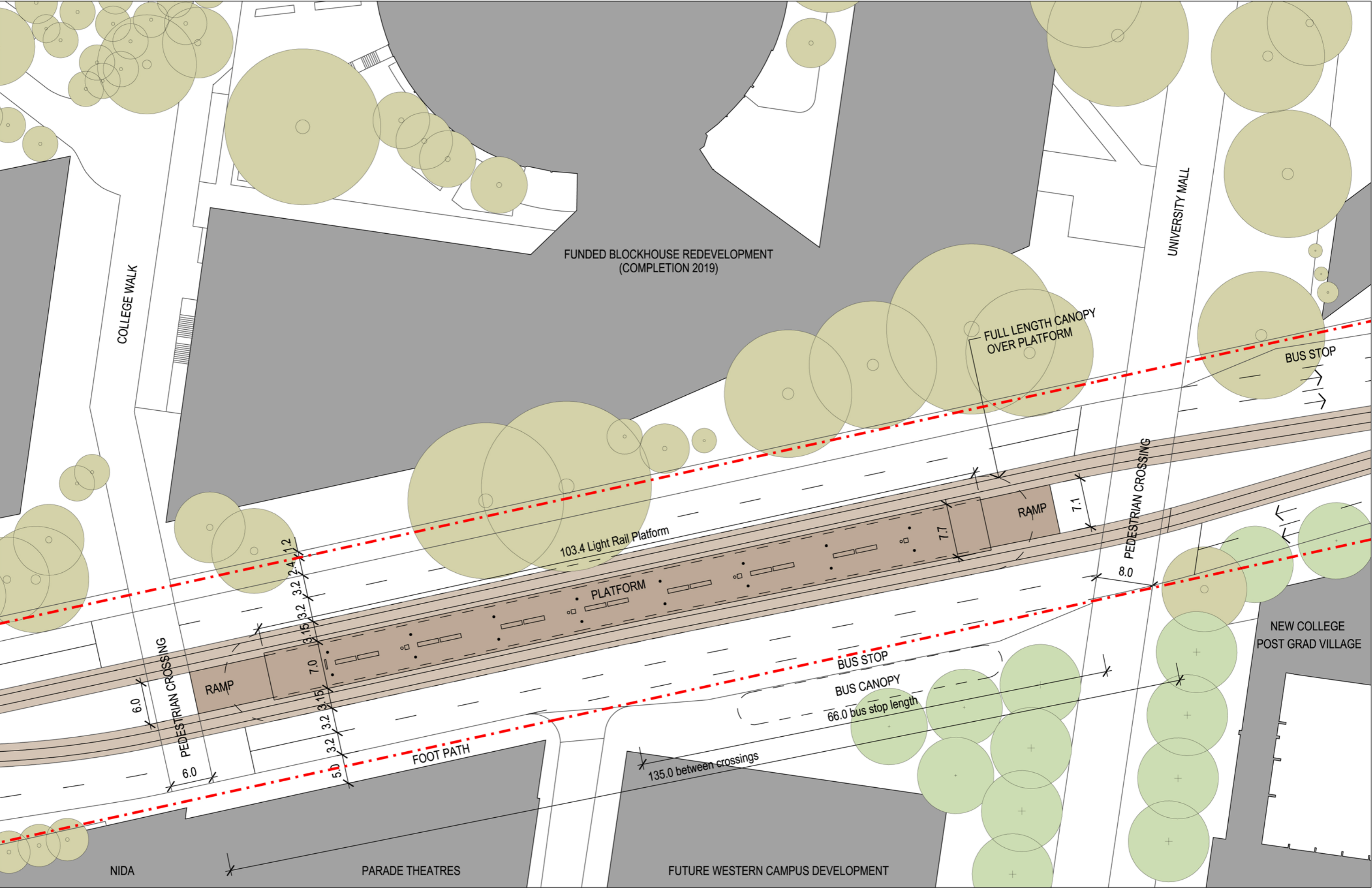

LEGEND

 <b>UNSW</b> AUSTRALIA		CBD & South East Light Rail Project EIS Response for UNSW	
<b>ASPECT Studios™</b> Tzannes Associates ARCHITECTURE URBAN DESIGN			
SCALE 1:500 @ A3	DRAWN AR	CHECKED -	DATE Dec 2013
PROJECT 13040	DRAWING 16	REVISION A	

**UNSW Anzac Pde Stop  
Plan**

