

DIVERT EXISTING UNSW SERVICES AWAY FROM PLATFORM TO PROPOSED CROSSING AND ABANDON THIS CROSSING. EXISTING SERVICES INCLUDE: FIBRE OPTIC COMMUNICATIONS, BOREWATER MAIN & IRRIGATION CONTROLS WIRING.

PROVIDE 2.4M WIDE BURIED SERVICES CORRIDOR ACROSS ANZAC PDE TO ACCOMMODATE EXISTING UNSW SERVICES AND PROVIDE ADDITIONAL 3X225MM CONDUITS FOR FUTURE EXTENSION OF SERVICES.

FOR DETAILS OF ALL KNOWN EXISTING SERVICES WITHIN AND CONNECTING TO THE EXISTING ROAD CROSSINGS, REFER TO UNSW FACILITIES MANAGEMENT HYDRAULIC ENGINEER

A RANGE OF COMMUNICATION CARRIER SERVICES ENTER UNSW VIA ANZAC PARADE.

UNSW REQUESTS DETAILED INFORMATION FOR PROPOSED TREATMENT OF EACH ROUTE, CABLE AND SERVICE FOR EACH CARRIER AND THE FLOW ON IMPLICATIONS FOR THE INTERFACE WITH EXISTING ROUTES WITHIN UNSW AS PART OF THE NEXT DESIGN STAGE.

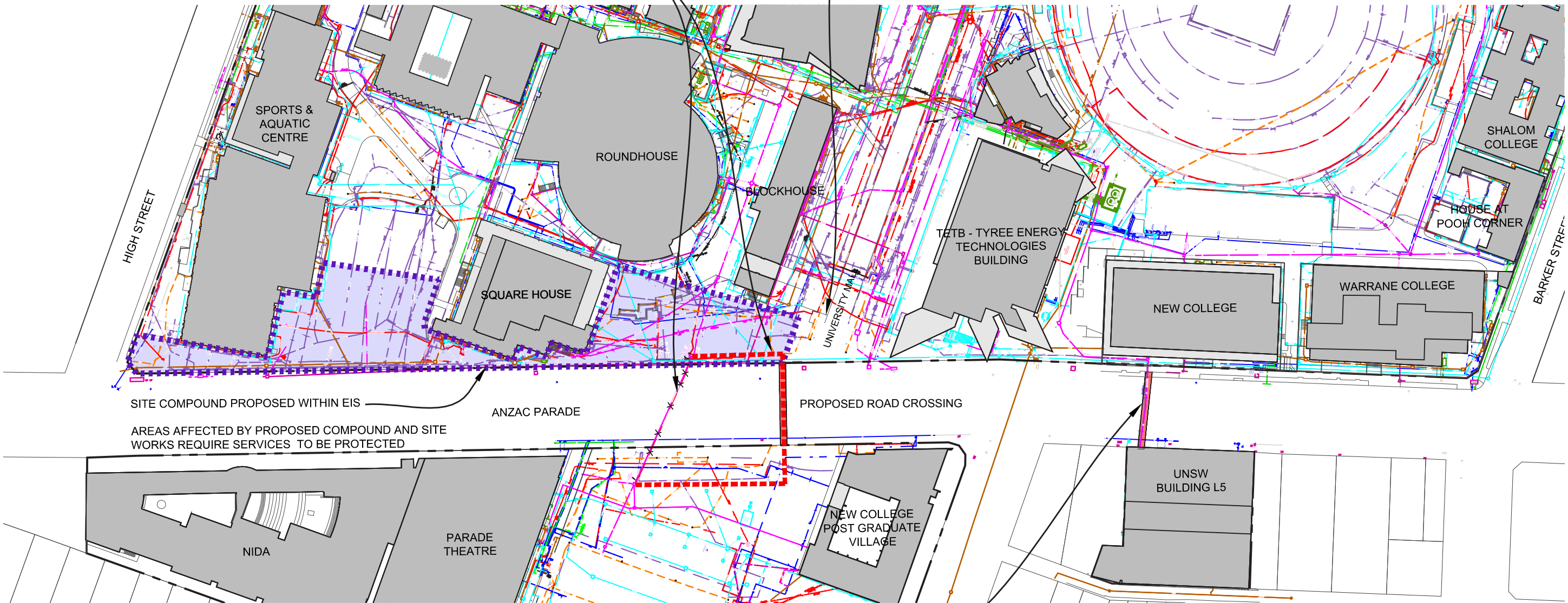

SITE COMPOUND PROPOSED WITHIN EIS

AREAS AFFECTED BY PROPOSED COMPOUND AND SITE WORKS REQUIRE SERVICES TO BE PROTECTED

ANZAC PARADE

PROPOSED ROAD CROSSING

PROVIDE 2.4M WIDE BURIED SERVICES CORRIDORS ACROSS ANZAC PDE TO ACCOMMODATE EXISTING UNSW SERVICES AND FUTURE EXTENSION OF SERVICES.

RETAIN & PROTECT EXISTING UNSW SERVICES & CONDUITS CROSSING ANZAC PARADE. PROVIDE 2X150MM ADDITIONAL CONDUITS WITHIN THE PROPOSED 2.4M WIDE CORRIDOR. EXISTING SERVICES INCLUDE: FIBRE OPTIC COMMUNICATIONS, BOREWATER SERVICE & IRRIGATION CONTROLS WIRING.

FOR DETAILS OF ALL KNOWN EXISTING SERVICES WITHIN AND CONNECTING TO THE EXISTING ROAD CROSSINGS, REFER TO UNSW FACILITIES MANAGEMENT HYDRAULIC ENGINEER.

FOR DETAILS OF ALL KNOWN EXISTING TELECOMMUNICATION CABLING WITHIN AND CONNECTING TO THE EXISTING SERVICES REFER TO UNSW COMMUNICATION SERVICES

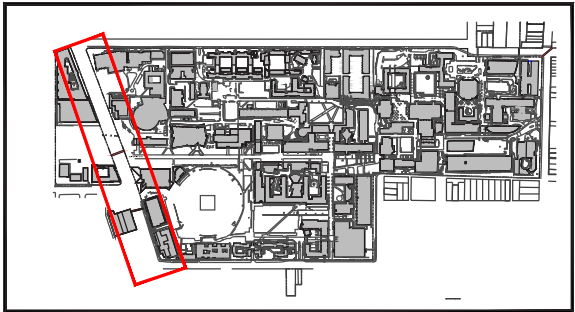

LOCATION PLAN

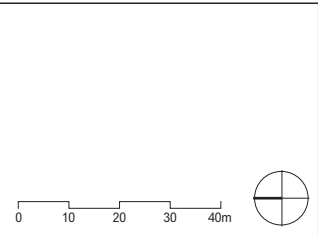

LEGEND

UNSW Anzac Parade Stop - Current and Future Service Provisions (1:1500)

FS

—

FIRE SERVICE WATER PIPE

W

—

WATER PIPE

W(I)

—

WATER PIPE (IRRIGATION)

BW

—

BOREWATER PIPE

BW(I)

—

BOREWATER PIPE (IRRIGATION)

S

—

SEWER PIPE

TW

—

TRADE WASTE

V

—

VENT PIPE

SW

—

STORMWATER PIPE

D

—

SUB-SOIL DRAIN

N

—

NITROGEN PIPE

O

—

OXYGEN PIPE

—\*—\*—\*

—

DISUSED SERVICE

ASPECT Studios<sup>®</sup>  
Tzannes Associates ARCHITECTURE URBAN DESIGN

SCALE	DRAWN	CHECKED	DATE	PROJECT	DRAWING	REVISION
1:1500 @A3	JC	AW	06/12/13	13040	44	A

CBD & South East Light Rail Project  
EIS Response for UNSW

UNSW Anzac Parade Stop -  
Current and Future Service  
Provisions





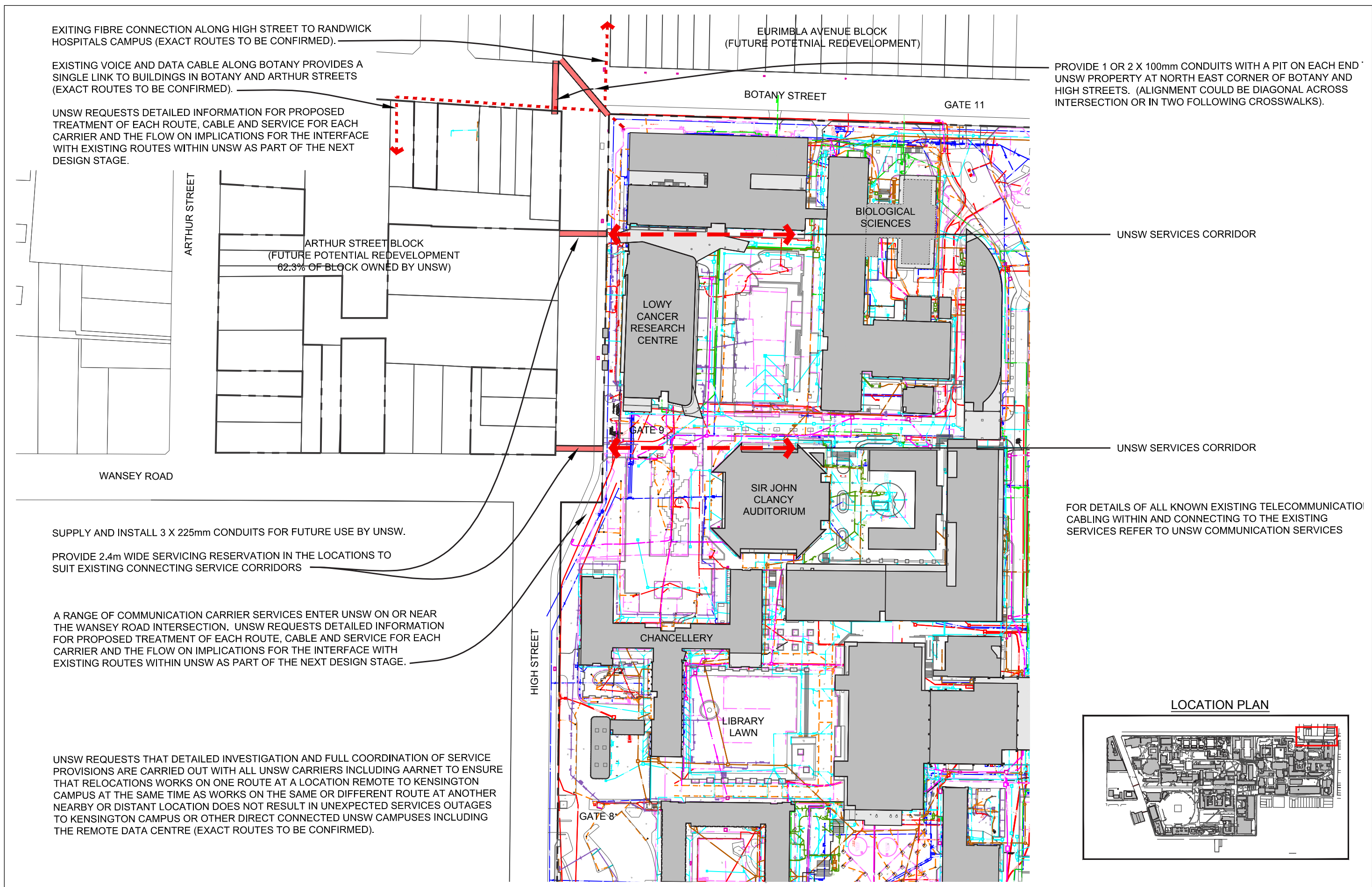

EXITING FIBRE CONNECTION ALONG HIGH STREET TO RANDWICK HOSPITALS CAMPUS (EXACT ROUTES TO BE CONFIRMED).

EXISTING VOICE AND DATA CABLE ALONG BOTANY PROVIDES A SINGLE LINK TO BUILDINGS IN BOTANY AND ARTHUR STREETS (EXACT ROUTES TO BE CONFIRMED).

UNSW REQUESTS DETAILED INFORMATION FOR PROPOSED TREATMENT OF EACH ROUTE, CABLE AND SERVICE FOR EACH CARRIER AND THE FLOW ON IMPLICATIONS FOR THE INTERFACE WITH EXISTING ROUTES WITHIN UNSW AS PART OF THE NEXT DESIGN STAGE.

EURIMBLA AVENUE BLOCK (FUTURE POTETNIAL REDEVELOPMENT)

PROVIDE 1 OR 2 X 100mm CONDUITS WITH A PIT ON EACH END UNSW PROPERTY AT NORTH EAST CORNER OF BOTANY AND HIGH STREETS. (ALIGNMENT COULD BE DIAGONAL ACROSS INTERSECTION OR IN TWO FOLLOWING CROSSWALKS).

ARTHUR STREET BLOCK (FUTURE POTENTIAL REDEVELOPMENT 62.3% OF BLOCK OWNED BY UNSW)

UNSW SERVICES CORRIDOR

UNSW SERVICES CORRIDOR

SUPPLY AND INSTALL 3 X 225mm CONDUITS FOR FUTURE USE BY UNSW.

PROVIDE 2.4m WIDE SERVICING RESERVATION IN THE LOCATIONS TO SUIT EXISTING CONNECTING SERVICE CORRIDORS

A RANGE OF COMMUNICATION CARRIER SERVICES ENTER UNSW ON OR NEAR THE WANSEY ROAD INTERSECTION. UNSW REQUESTS DETAILED INFORMATION FOR PROPOSED TREATMENT OF EACH ROUTE, CABLE AND SERVICE FOR EACH CARRIER AND THE FLOW ON IMPLICATIONS FOR THE INTERFACE WITH EXISTING ROUTES WITHIN UNSW AS PART OF THE NEXT DESIGN STAGE.

FOR DETAILS OF ALL KNOWN EXISTING TELECOMMUNICATION CABLING WITHIN AND CONNECTING TO THE EXISTING SERVICES REFER TO UNSW COMMUNICATION SERVICES

UNSW REQUESTS THAT DETAILED INVESTIGATION AND FULL COORDINATION OF SERVICE PROVISIONS ARE CARRIED OUT WITH ALL UNSW CARRIERS INCLUDING AARNET TO ENSURE THAT RELOCATIONS WORKS ON ONE ROUTE AT A LOCATION REMOTE TO KENSINGTON CAMPUS AT THE SAME TIME AS WORKS ON THE SAME OR DIFFERENT ROUTE AT ANOTHER NEARBY OR DISTANT LOCATION DOES NOT RESULT IN UNEXPECTED SERVICES OUTAGES TO KENSINGTON CAMPUS OR OTHER DIRECT CONNECTED UNSW CAMPUSES INCLUDING THE REMOTE DATA CENTRE (EXACT ROUTES TO BE CONFIRMED).

LOCATION PLAN

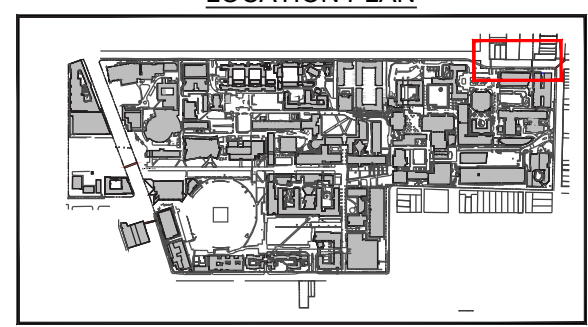

LEGEND

FS	FIRE SERVICE WATER PIPE	S	SEWER PIPE	D	SUB-SOIL DRAIN
W	WATER PIPE	TW	TRADE WASTE	N	NITROGEN PIPE
W(I)	WATER PIPE (IRRIGATION)	V	VENT PIPE	O	OXYGEN PIPE
BW	BOREWATER PIPE	SW	STORMWATER PIPE	—*—*	DISUSED SERVICE
BW(I)	BOREWATER PIPE (IRRIGATION)				

ASPECT Studios<sup>®</sup>

Tzannes Associates ARCHITECTURE URBAN DESIGN

SCALE	DRAWN	CHECKED	DATE	PROJECT	DRAWING	REVISION
1:1500 @A3	JC	AW	06/12/13	13040	46	A

CBD & South East Light Rail Project  
EIS Response for UNSW

UNSW High Street Stop -  
Current and Future Service  
Provisions