

# **OBJECTION TO THE PROPOSAL SSD 5752**

## **The Proposal SSD 5752 Sydney International Convention, Exhibition and Entertainment Precinct - Redevelopment of convention centre, exhibition centre, entertainment facilities and associated public domain works**

I object to the proposal SSD 5752 for the following reasons:

1. Award Winning public buildings being removed;
2. the Goldsbrough being an iconic and heritage part of Darling Harbour will be obscured from the public view;
3. no consideration for aesthetics on the western or rear façade of the International Convention Centre (ICC);
4. removal of current convention centre walkway without a viable alternative public access;
5. Such a development will inevitably lead to developing a hotel accommodation for the users of convention centre – Any new multi-story buildings in the area are grotesque developments that will make the area unusable for locals and visitors.

### **Objection 1: Award Winning public buildings being removed**

Two remarkable award winning public buildings, the Convention Centre and the Exhibition Hall are to be demolished. The cost, noise, dust and general discomfort etc required to demolish the old to make way for the new buildings must be seriously considered.

Does it make sense to pull down \$120 million worth of building that's perfectly all right?

I propose to keep and extend the current Convention Centre to save millions of dollars of taxpayer money.

### **Objection 2: the Goldsbrough being an iconic and heritage part of Darling Harbour will be obscured from the public view**

In regard to the Great Old Wool store, the Goldsbrough Mort building is a proud reminder of the great Australian wool industry. The height of the proposed new ICC convention centre is nearly to the top of the Goldsbrough's current height. The scale of the ICC and the position of the ICC will obscure the view of the Goldsbrough which is a building of iconic and heritage significance in Sydney.

As it stands, the Goldsbrough remains one of the last historic buildings in the Darling Harbour precinct that can be seen from the public areas. It is one of the remaining links to the area's historic past and one that has also been successfully reused as a modern building. The new ICC will obscure the historic façade of the building from public view and one that has been part of the Darling Harbour landscape since Sydney's early days.

Heritage issues so strenuously fought for in the 70s and 80s and were responsible for the current attractive character of Pyrmont and Ultimo, must keep an honoured place in relation to this development.

*See view below of the face of the Goldsbrough being obscured by the proposed ICC.*



*Current view of the Goldsbrough from Darling Harbour*



### **OBJECTION 3: NO CONSIDERATION FOR AESTHETICS ON THE WESTERN OR REAR FAÇADE OF THE ICC**

In the DA plans it shows that the Western (rear) face of the ICC will be a mainly Grey metal panel wall which will just look like a Grey metal barricade. The entire architecturally appealing glass frontage is kept for the Eastern (Darling Harbour facing) face of the building. All the publicity shots show the view of the East face and do not show the view of the ugly utilitarian Western face.

If the new building must be built, it should be of the same height as the exiting convention centre and the western face should be made of glass materials which don't look like a metal barricade. The proposed new ICC should be built such a way that it keeps the exiting view of the Goldsbrough buildings looking at it from the Darling Harbour area.

### **Objection 4: removal of current convention centre walkway without a viable alternative public access**

The vital walkway to Darling Harbour behind the current Convention Centre cannot be taken away as it is one of the major pedestrian traffic ways to the site and into the city, used by large numbers of people at all hours. Removing it will be a huge disaster for pedestrians and traffic in the area alike.

The proposed changes at Darling Harbour seem to take away an extremely important thoroughfare for the residents. From the plans it looks like the current overhead pedestrian walkway next to the Convention monorail station is being removed. Currently it is the easiest and safest walkway to enter the Darling Harbour precinct from the Western side. Currently it is estimated that there are around 7000 pedestrian traffic movements across this walkway on a regular day and many more on busy event days. It is the only safe way to cross the light rail tracks and Darling Drive and is the direct access for 2 major car parks servicing Darling Harbour. This walkway is open 24 hours a day, 7 days a week with continuous public access.

I note that there is no mention of the increased traffic flow within the immediate vicinity of the proposed complex. In particular I refer to the impact that such an increased amount of traffic will have on the ability of people to cross the road and the obvious increase in delays for traffic as people use the ground level pedestrian crossing.

If the walkway is removed it will affect all regular users from the public car parks on the Western side of Darling Harbour, the commercial building at 135 Pyrmont St as well as all the residential buildings on Harris in Pyrmont and the residents and guests of the Goldbrough building.

How are pedestrians especially with children and elderly people meant to cross to and from Darling Harbour in a safe way at all hours?

From the Architectural drawings below it shows how the current walkway is removed in the proposed plan

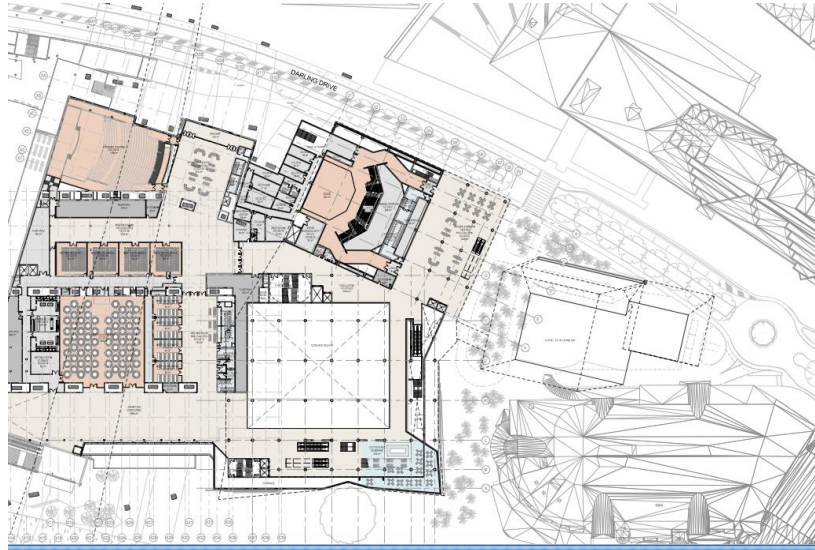

The mentioned walkway



**Objection 5: Such a development will inevitably lead to developing hotel accommodations for the users of the new ICC – Any new multi-storey buildings in the area will make the area unusable for locals and visitors**

According to the briefings given by Land Lease, there are plans to build twin tower hotels and residential blocks next to the new ICC on the grounds that guest need access to the convention

centre. The proposed twin hotel towers are a vast over-development of the available site. The briefings given by Land Lease has indicated that new hotel buildings will create monsters standing on the foreshore blocking views and casting shadows which will make the area dark and depressing. It makes a grotesque and greedy grab for privileged views to the detriment of local population. Multi-storey buildings are totally out of character in the area.

As it is, 'Darling Harbour is so choked with litter, much of it under piers and walkways out of the public eye, that it is one of the most polluted areas in Sydney' (reported by Boomerang Alliance – viewed 28 April 2013 <http://www.smh.com.au/environment/water-issues/darling-harbour-among-most-polluted-20130427-2ilaz.html>), the new over-developed ICC and hotels on a relatively small site at the edge of the water will remove the recreational use for the area for general public and local residents. It will increase the congestion in the area to the point that visit to the area will become unbearable.