



SSDA

Dwg No.	Drawing Title	Scale	Size
General			
LA-DA-01	Cover Page & Drawing Schedule	N/A	A0
LA-DA-02	Landscape Schedules	N/A	A0
LA-DA-03	Tree Protection & Removal Plan	1:300	A0
Plans			
LA-DA-04	Site Plan	1:400	A0
LA-DA-05	Landscape Plan 1 - Lower Ground	1:200	A0
LA-DA-06	Landscape Plan 2 - Upper Ground	1:200	A0

- * FOR DEVELOPMENT APPLICATION ONLY
- * All tree dimensions and RLs in metres. All other dimensions in mm unless stated otherwise.
- * Do not scale from drawings. Use figured dimensions only. Larger scale drawings and written dimensions take preference.
- * All work shall be carried out in accordance with current versions of Australian Standards, BCA and Local Government Regulations.
- * Structural Details are indicative only and are subject to Structural Engineer's Details and Specifications.
- * Drainage details are subject to Hydraulic / Civil Engineer's Detail and Specification.
- * Subbase details including compaction are to Civil and Structural Engineer's Specification.
- * Lighting Plans are subject to detailed design by a qualified Lighting Consultant or Electrical Contractor.
- * Water Feature Details are indicative only and are subject to detailed design by a specialist Water Feature designer.
- * Service location on plans are indicative only. *360 Degrees Landscape Architects Pty Ltd* accepts no responsibility for the accuracy of service locations shown or for services not shown. It is the responsibility of the contractor to determine service locations prior to the commencement of work, including contacting *Dial Before You Dig* and performing on site service locations. Locate and protect all services on site and in adjacent public domain. Any damages to services and associated damages remains the responsibility of the contractor and shall be rectified at no cost to the client or any other party.
- * All adjoining property elements including but not limited to buildings, walls, trees and paving to be protected. Damaged elements remain the responsibility of the contractor and shall be rectified at no cost to the client or any other party. Existing trees to be retained are to be protected to Council and Project Arborist's requirements. No vehicular traffic, stockpiling or storage of materials within Tree Protection Zones (TPZs).
- * No responsibility will be taken by *360 Degrees Landscape Architects Pty Ltd* for any variations in design, construction method, materials specified and general specifications without permission from the Project Landscape Architect.
- * This Drawing is copyright to *360 Degrees Landscape Architects Pty Ltd*.

A map of the study area in the Werrington Creek catchment. The map shows a network of roads including Great Western Hwy, O'Connell St, and Second Ave. A red square indicates the location of the study site, which is situated south of Great Western Hwy and east of O'Connell St. Werrington Creek is shown flowing through the area. The map also includes a scale bar and a north arrow.





 Level 1, 1 Mary's Place
 Surry Hills, 2010
 P 02 9532 3601
 W 360.net.au
 AIN 90 146 501 322

L-DA-01

HARDWORKS		
	Edge Type 1	Flush Steel Edge
	Fence Type 1	1000mm High Palisade Fence
	Handrail	Stainless Steel 316, Satin Finish, 42 OD pipe
	Paving Type 1	Concrete
	Paving Type 2	Permeable Resin Bound Gravel
	Paving Type 3	To Architect's Specification
	Paving Type 4	Permeable Unit Paving
	Timber Deck	Class 1 Hardwood Timber (Tallowood)
	Wall Type 1	Concrete Wall
	Wall Type 2	Retaining Wall to Structural Engineer's Detail
	Tactile Ground Surface Indicators	Stainless Steel with Black Carborundum, Indicatively Shown
	Furniture	Loose / Fixed Furniture
SOFTWORKS		
	Tree to be Retained and Protected	Refer to Arborist Report
	Tree to be Removed	Refer to Arborist Report
	New Tree	Refer to Plant Schedule
	Garden Bed	Garden Bed on Grade
	Turf	Buffalo 'Palmetto', 300mm min Soil Underlay
GENERALS		
	Site Boundary	Refer to Survey's Drawings
	Extent of Works	
	Awning Over	Refer to Architect's Drawigs
LEVELS		
+ ex RL 88.00	Existing Level	To be Retained
+ RL 88.00	Reduced Level	Top of Finish Level
+ ToW 88.00	Top of Wall RL	Top of Finish Level
+ ToE 88.00	Top of Edge RL	Top of Finish Level
+ ToS 88.00	Top of Seat RL	Top of Finish Level
+ ToF 88.00	Top of Fence RL	Top of Finish Level

PLANT SCHEDULE

Botanical Name	Pot Size	Origin
TREES		
<i>Corymbia maculata</i>	400L	Cumberland Plain Native +
<i>Eucalyptus polyanthemos</i>	100L	NSW Native
<i>Eucalyptus tereticornis</i>	400L	Cumberland Plain Native +
<i>Fraxinus pennsylvanica 'Urbanite'</i>	100L	Exotic
<i>Celexia parvifolia</i>	100L	NSW Native
<i>Melaleuca decora</i>	75L	Cumberland Plain Native +
<i>Tristaniopsis laurina</i>	100L	Cumberland Plain Native ^
<i>Waterhousea 'Sweeper'</i>	75L	NSW Native Cultivar
<i>Ulmus parvifolia</i>	400L	Exotic
SHRUBS & PERENNIALS		
<i>Babingtonia virgata dwarf</i>	200mm	NSW Native
<i>Banksia aemula</i>	200mm	NSW Native
<i>Callistemon 'Great Balls of Fire'</i>	200mm	NSW Native Cultivar
<i>Dodonaea viscosa subsp. cuneata</i>	200mm	Cumberland Plain Native +
<i>Euonymus Green Rocket</i>	200mm	Exotic
<i>Grevillea rosmarinifolia</i>	200mm	Grevillea rosmarinifolia
<i>Indigofera australis</i>	200mm	Cumberland Plain Native +
<i>Ozothamnus diosmifolius</i>	200mm	NSW Native
<i>Westringia fruticosa</i>	200mm	NSW Native
GRASSES		
<i>Dianella 'Little Jess'</i>	150mm	NSW Native Cultivar
<i>Lomandra filiformis</i>	150mm	Cumberland Plain Native +
<i>Lomandra longifolia 'Verday'</i>	150mm	Cumberland Plain Native ^ cliv.
<i>Poa labillardieri</i>	150mm	Cumberland Plain Native ^
<i>Themeda australis</i>	150mm	Cumberland Plain Native +
GROUNDCOVERS		
<i>Acacia howittii 'Honey Bun'</i>	150mm	NSW Native Cultivar
<i>Carpobrotus rossii</i>	150mm	NSW Native Cultivar
<i>Casuarina 'Cousin It'</i>	150mm	NSW Native Cultivar
<i>Einadia nutans</i>	150mm	Cumberland Plain Native +
<i>Grevillea 'Poominda Royal Mantle'</i>	150mm	NSW Native Cultivar
<i>Hardenbergia violacea</i>	150mm	Cumberland Plain Native +
<i>Rosmarinus 'Blue Lagoon'</i>	150mm	Exotic
<i>Wahlenbergia gracilis</i>	Tube	Cumberland Plain Native +

Key:
+ *Cumberland Plain Shale Woodland Species*
^ *Sydney Coastal River Flat Species*



KEY

--- SITE BOUNDARY

--- EXTENT OF WORKS

● T# TREE TO BE RETAINED AND PROTECTED

● T# TREE TO BE REMOVED

NOTE

Plan to be read in conjunction with Arborist Report and Architectural Plans. This plan is not for demolition.

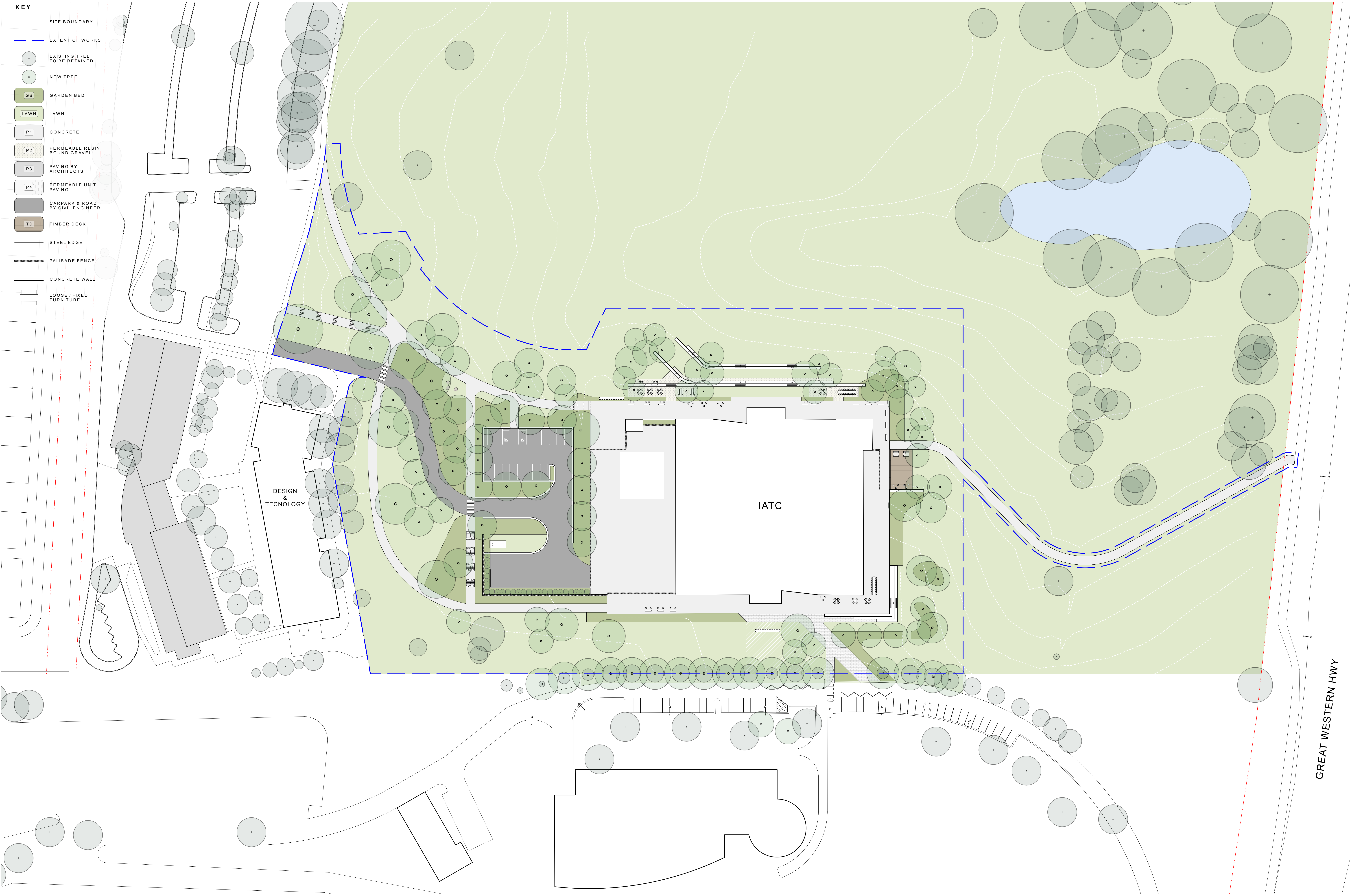



REFER L-DA-06

KEY

- SITE BOUNDARY
- EXTENT OF WORKS
- EXISTING TREE TO BE RETAINED
- NEW TREE
- GARDEN BED
- LAWN
- CONCRETE
- PERMEABLE RESIN BOUND GRAVEL
- PAVING BY ARCHITECTS
- PERMEABLE UNIT PAVING
- CARPARK & ROAD BY CIVIL ENGINEER
- TIMBER DECK
- STEEL EDGE
- PALISADE FENCE
- CONCRETE WALL
- LOOSE / FIXED FURNITURE

- 1 NEW ROAD CONNECTION
- 2 CARPARK WITH ACCESSIBLE PARKING
- 3 LOADING DOCK
- 4 WALKWAY WITH FIRST NATION CULTURAL NARRATIVE INTEGRATION
- 5 SOCIAL SEATING TO COLONNADE
- 6 LAWN TERRACES
- 7 WSUD GARDENS
- 8 PATH CONNECTION TO EASTERN ENTRANCE
- 9 OUTDOOR LEARNING SPACES
- 10 BIKE PATH CONNECTION TO GREAT WESTERN HIGHWAY
- 11 MEETING PLACE - OPPORTUNITY FOR AN AREA FOR REFLECTION AND DISCUSSION (TO BE DEVELOPED WITH FIRST NATION STAKEHOLDER CONSULTATION)

- REFER L-DA-05

PRELIMINARY
NOT FOR CONSTRUCTION

Rev	Amendment	Date	By
C	DRAFT SSDA	09/02/21	GF
D	SSDA	05/03/21	GF
E	SSDA	11/03/21	GF
F	Response to Submission Issue	18/05/21	BHG
G	Revised SSDA	09/06/21	GF

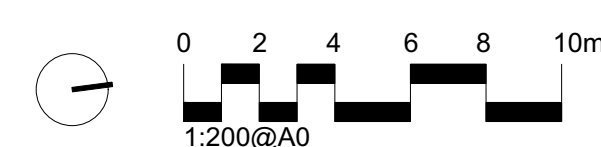

IMPORTANT NOTES:

- Do not erase from drawings.
- All discrepancies to be brought to the attention of the Project Landscape Architect.
- Large scale drawings and winter dimensions take precedence. All dimensions in non-plus otherwise stated.
- All tree dimensions and P&L are to be taken from the ground.
- Use figure dimensions.
- Verify all dimensions on site to ensure the satisfaction of all works.
- Contractors shall be contacted and all services prior to construction.
- All work shall be carried out in accordance with ASIA, BCA and Local Government Regulations.
- Materials details shall be subject to Engineer's Specifications.
- Drawings & Winter Feature Details shall be subject to Engineer's Specifications.
- Work shall be carried out in a professional manner to Qualified Tradesman according to Landscape Drawings.

Be responsible to follow the 200 Degrees Landscape Architects Pty Ltd for any variations in design, construction and general construction details. All drawings shall be subject to Engineer's Specifications. This Drawing is to be kept by 200 Degrees Landscape Architects Pty Ltd.

CLIENT TAFE NSW		CHECKED KR
ARCHITECT Gray Puksand		DRAWN BHC
SCALE 1:200	SIZE A0	STAGE SSDA

DWG. TITLE
Landscape Plan 2 - Upper Ground
PROJECT
INSTITUTE OF APPLIED TECHNOLOGY FOR CONSTRUCTION
12-44 O'Connell St, Kingswood NSW

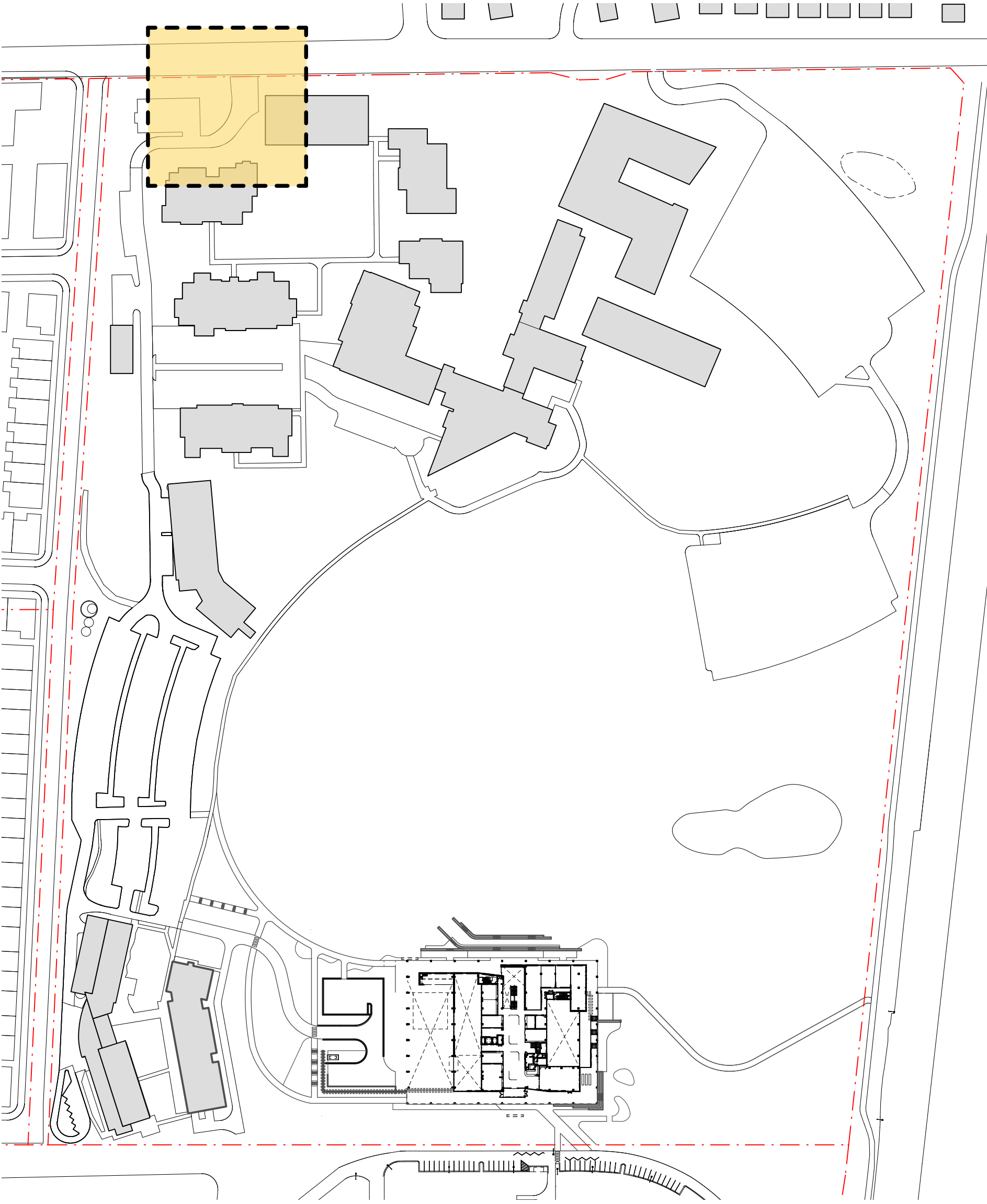
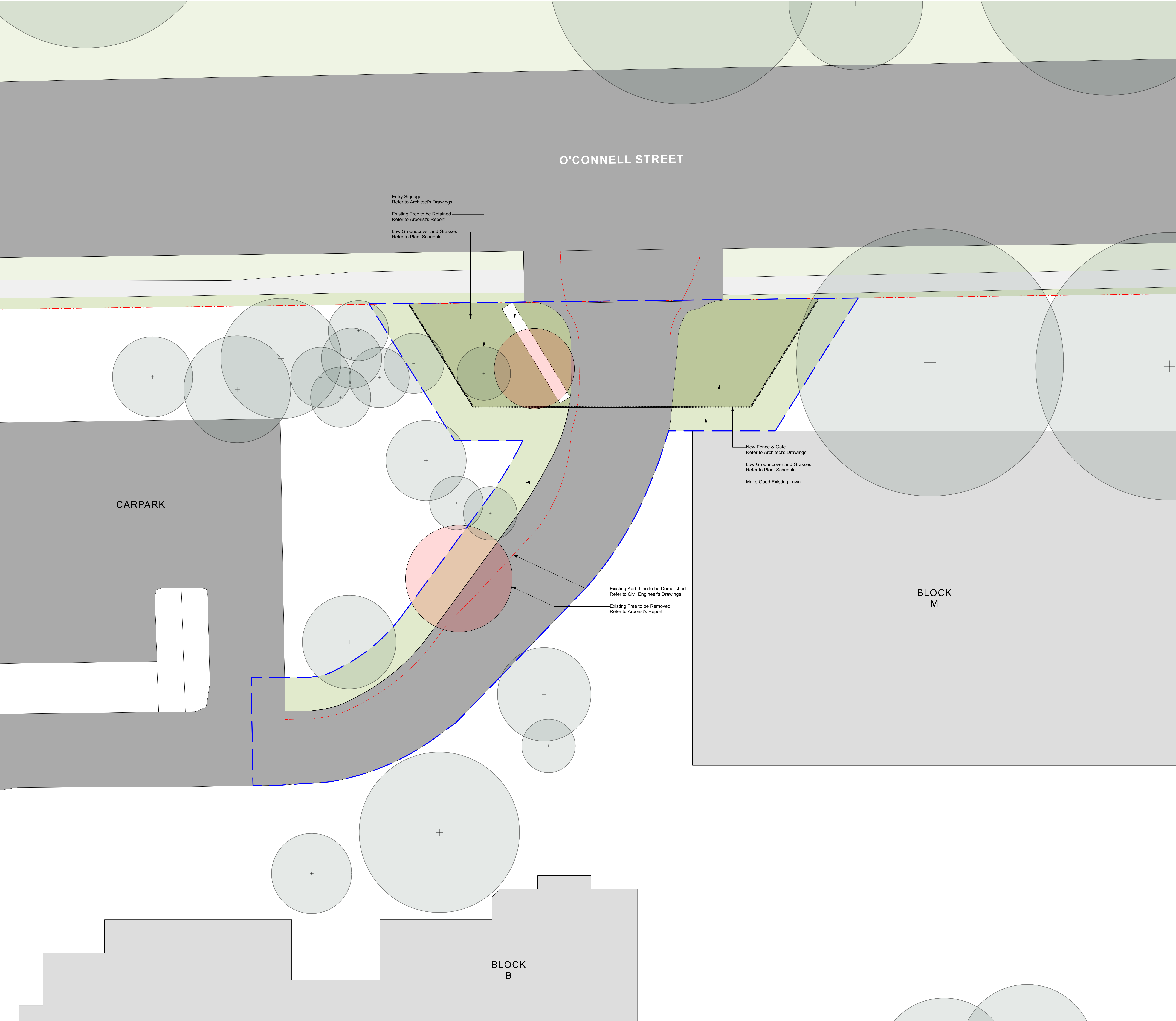

- KEY**
- SITE BOUNDARY
 - EXTENT OF WORKS
 - + EXISTING TREE TO BE RETAINED
 - EXISTING TREE TO BE REMOVED
 - GARDEN BED
 - LAWN
 - EXISTING PATH
 - CARPARK & ROAD BY CIVIL ENGINEER

PRELIMINARY
NOT FOR CONSTRUCTION

Rev	Amendment	Date	By
A	SSDA	11/03/21	GF
B	Response to Submission Issue	18/05/21	BHC
C	Revised SSDA	09/06/21	GF

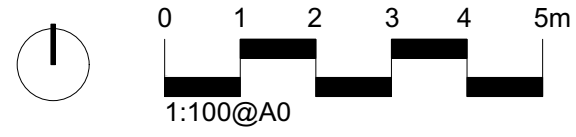

IMPORTANT NOTES:
1. This plan is a preliminary design and is not to be used for construction without the approval of the relevant authorities.
2. The plan is subject to change without notice.
3. The plan is not to be used for any other purpose without the written consent of the relevant authorities.
4. The plan is not to be used for any other purpose without the written consent of the relevant authorities.
5. The plan is not to be used for any other purpose without the written consent of the relevant authorities.

CLIENT TAFE NSW	CHECKED KR
ARCHITECT Gray Puksand	DRAWN BHC
SCALE 1:100	SIZE A0
	STAGE SSDA

DWG. TITLE
Landscape Plan 3 - O'Connell Entry
PROJECT
INSTITUTE OF APPLIED TECHNOLOGY FOR CONSTRUCTION
12-44 O'Connell St, Kingswood NSW