

Appendix E: Revised Traffic Management Within Site



Traffic Stacking and Queuing Procedure Version 2 **September 2020**

This procedure is for the Stacking and Queuing of oncoming Traffic into Bulk Recovery Solutions Pty Ltd (BRS) located at 16 Kerr Road, Ingleburn and it must be adhered to by all truck drivers transporting materials from and/or to the BRS site.

The BRS site is not open for the public in the meaning that no transport from and/or to the site will be accepted on an ad-hoc basis. On the contrary, all jobs are pre-booked through the operations office in coordination with the weighbridge operator prior to arrival to the site for tipping to assist in scheduling and avoid traffic congestion onsite at Kerr Rd.

Despite the pre-booking of all jobs, all drivers must call the weighbridge operator prior to entering the Ingleburn Industrial Estate. This will give the yard staff ample opportunity to provide feedback on whether there is room in the yard for an extra truck.

Based on this practice, there should be no queuing or stacking anywhere within or outside the site boundaries and the traffic flow should be smooth. However, if for unforeseen events such as breakdowns (trucks, machinery or equipment), trucks will be diverted to other lawfully licensed facilities that can accept such wastes.

If the yard is full and arriving trucks cannot be accommodated, truck drivers must wait for further instruction from the Weighbridge operator as to when they can come into the site. Drivers are to be on UHF Channel 10.

Truck drivers will be informed to avoid parking their vehicles in any of the streets in the vicinity of the BRS site and preferable in dedicated trucks parking/stopping bays to assist in smooth traffic flow and avoid traffic congestion within the Ingleburn Industrial Estate.

Note : A copy of this procedure will be sent to all parties as part of booking the jobs with BRS.

Location of BRS Facility within the Ingleburn Industrial Estate

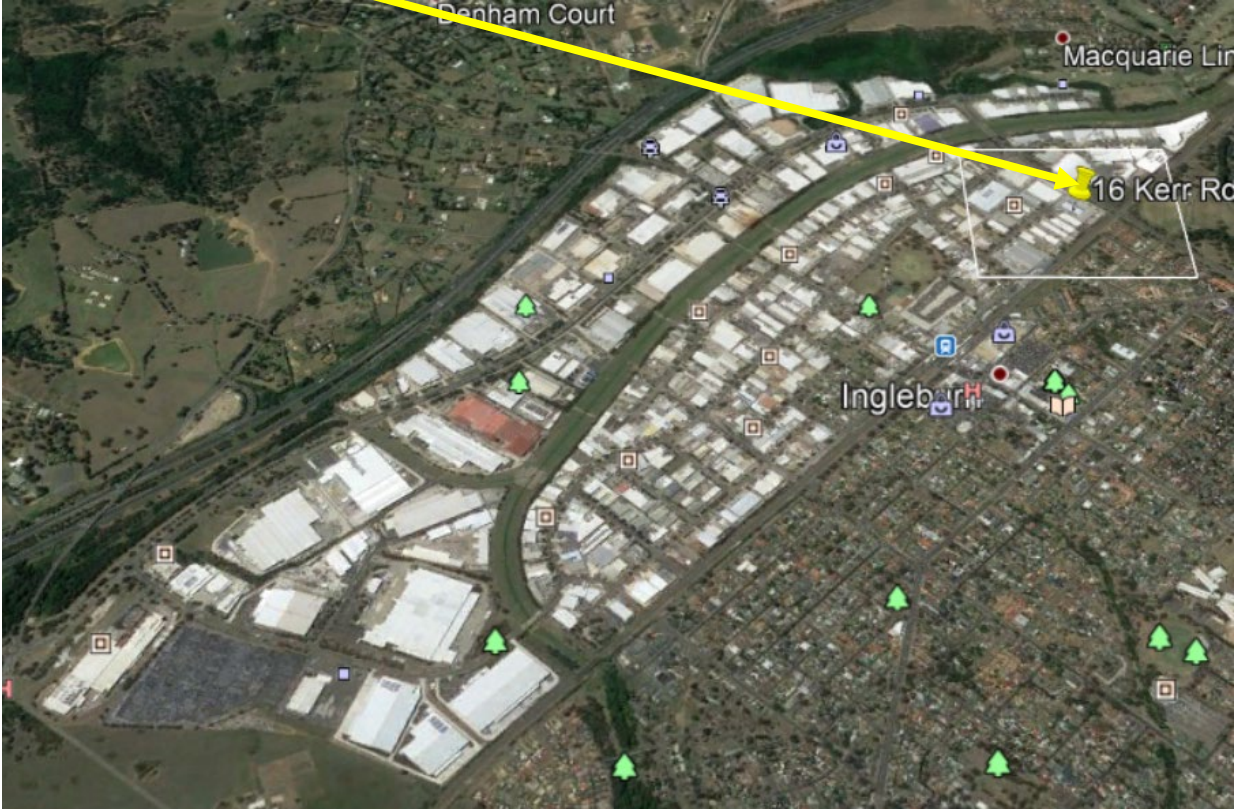

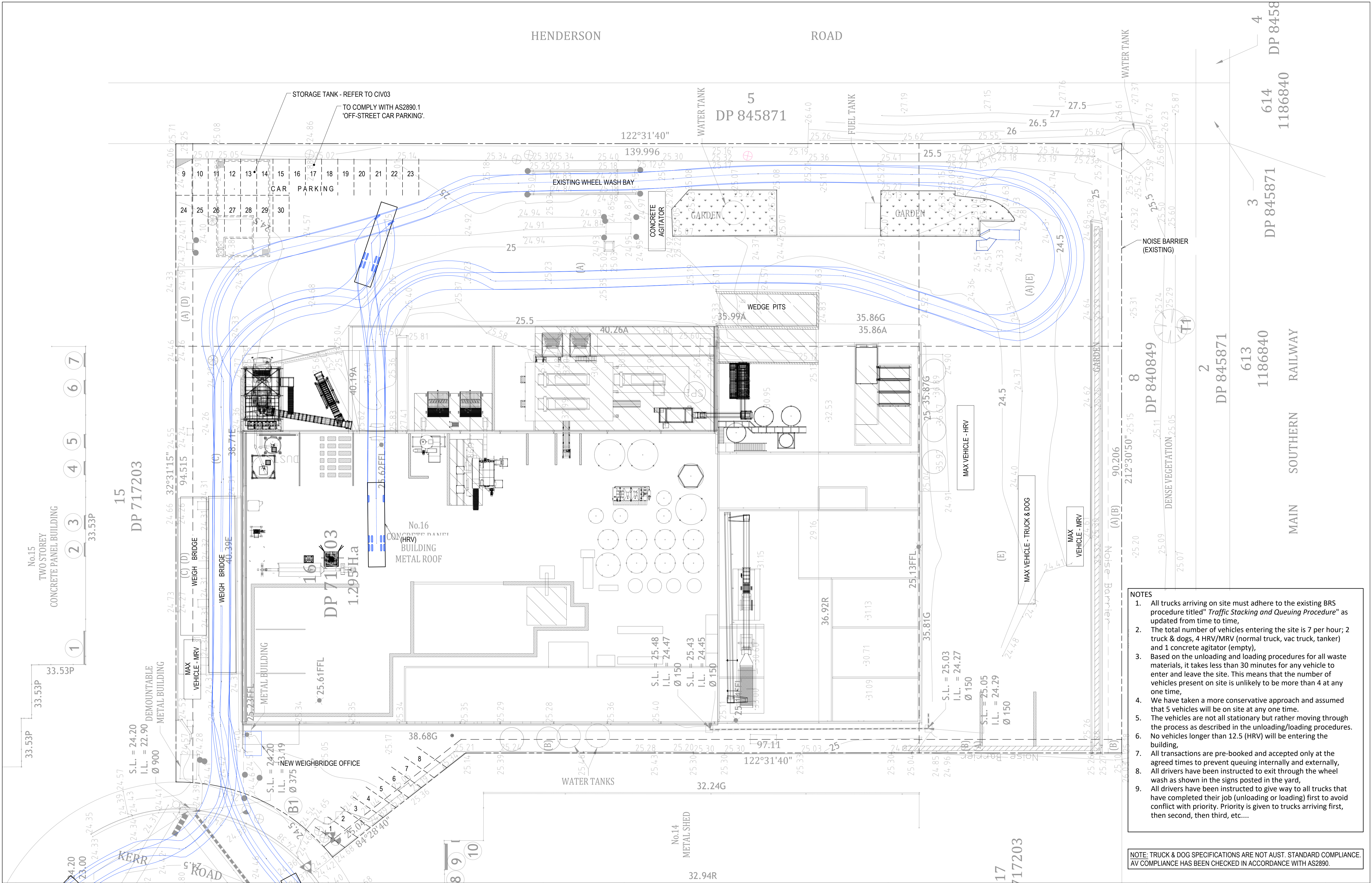

- NOTES
1. All trucks arriving on site must adhere to the existing BRS procedure titled "Traffic Stacking and Queuing Procedure" as updated from time to time.
 2. The total number of vehicles entering the site is 7 per hour; 2 truck & dogs, 4 HRV/MRV (normal truck, vac truck, tanker) and 1 concrete agitator (empty).
 3. Based on the unloading and loading procedures for all waste materials, it takes less than 30 minutes for any vehicle to enter and leave the site. This means that the number of vehicles present on site is unlikely to be more than 4 at any one time.
 4. We have taken a more conservative approach and assumed that 5 vehicles will be on site at any one time.
 5. The vehicles are not all stationary but rather moving through the process as described in the unloading/loading procedures.
 6. No vehicles longer than 12.5 (HRV) will be entering the building.
 7. All transactions are pre-booked and accepted only at the agreed times to prevent queuing internally and externally.
 8. All drivers have been instructed to exit through the wheel wash as shown in the signs posted in the yard.
 9. All drivers have been instructed to give way to all trucks that have completed their job (unloading or loading) first to avoid conflict with priority. Priority is given to trucks arriving first, then second, then third, etc....

NOTE: TRUCK & DOG SPECIFICATIONS ARE NOT AUST. STANDARD COMPLIANCE. AV COMPLIANCE HAS BEEN CHECKED IN ACCORDANCE WITH AS2890.

REV	DATE	DRN	CHK	APP	DRAWING STATUS
K	23.10.20	R.F.	M.M.	M.M.	FINAL ISSUE - AMENDED
J	20.10.20	R.F.	M.M.	M.M.	FINAL ISSUE - AMENDED
I	09.09.20	R.F.	M.M.	M.M.	FINAL ISSUE - AMENDED
H	15.06.20	R.F.	M.M.	M.M.	FINAL ISSUE - FOR APPROVAL
G	01.06.20	R.F.	M.M.	M.M.	FOR APPROVAL
F	22.05.20	R.F.	M.M.	M.M.	CLIENT REVIEW
E	15.11.19	R.F.	M.M.	M.M.	GENERALLY AMENDED

This drawing is not approved for construction unless signed.

Mathew McLennan
BEing (Civil) Hons MIE (Aust)

COPYRIGHT - This drawing and the information provided shall remain the property of DRB Consulting Engineers Pty Ltd (DRB) and may not be used, copied or reproduced, in whole or part, for any purpose other than that for which it was supplied without the prior consent of DRB.

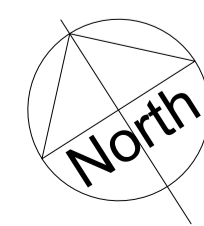

PO BOX 4105 Kotara East 2305
0402 915 549
ABN 64 625 755 482

DRB CONSULTING ENGINEERS

VEHICLE TURNING PATH
HEAVY RIGID VEHICLE (12.5m) INTERNAL DROP OFF
16 KERR ROAD,
INGLEBURN
BRS

DRAWING STATUS		SHEET SIZE
NOT FOR CONSTRUCTION		A1
PROJECT REF No.	DRAWING No.	SCALE
180009	TURN01	1:250
		REVISION
		K

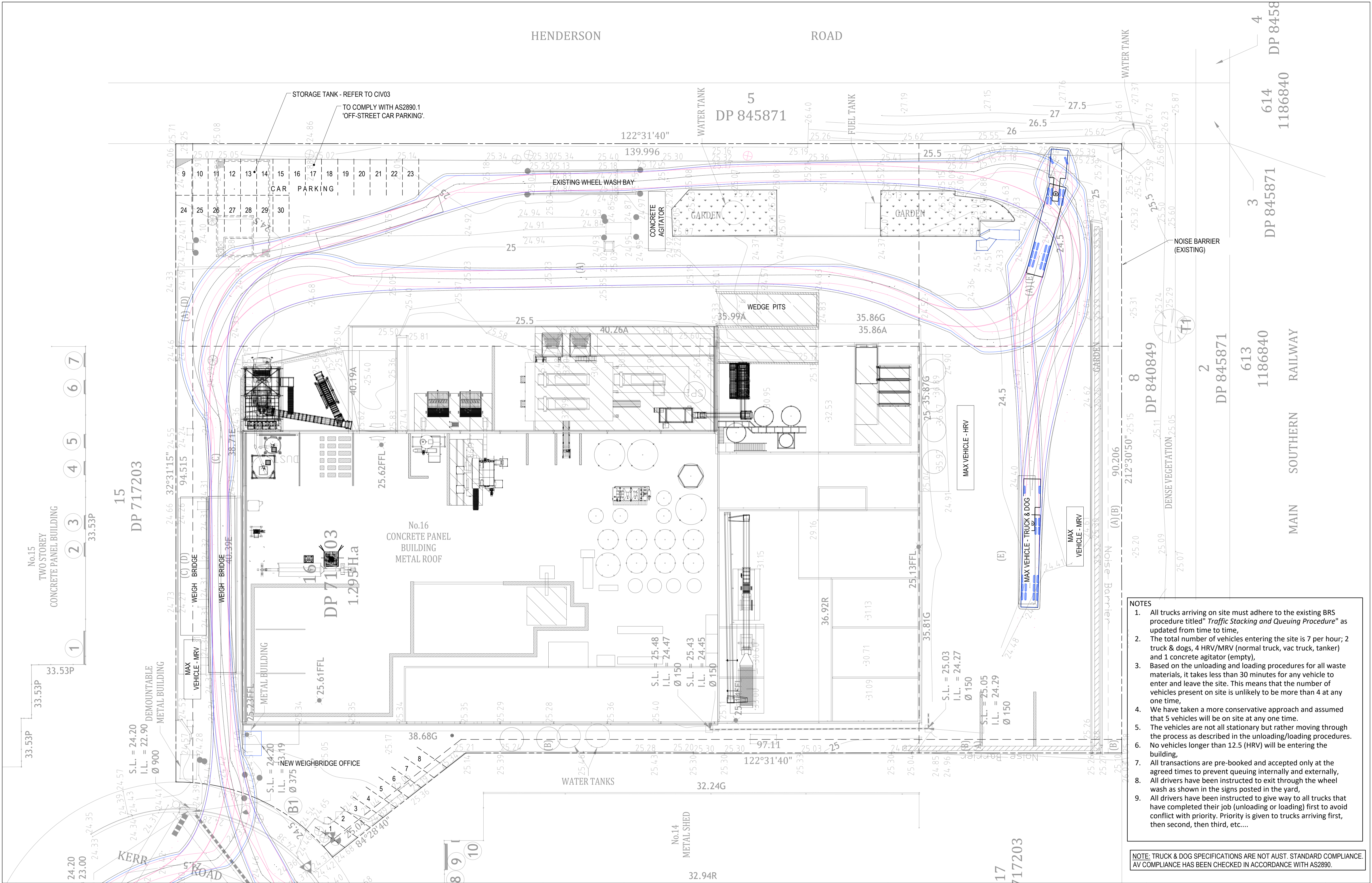

- NOTES
1. All trucks arriving on site must adhere to the existing BRS procedure titled "Traffic Stacking and Queuing Procedure" as updated from time to time,
 2. The total number of vehicles entering the site is 7 per hour; 2 truck & dogs, 4 HRV/MRV (normal truck, vac truck, tanker) and 1 concrete agitator (empty),
 3. Based on the unloading and loading procedures for all waste materials, it takes less than 30 minutes for any vehicle to enter and leave the site. This means that the number of vehicles present on site is unlikely to be more than 4 at any one time,
 4. We have taken a more conservative approach and assumed that 5 vehicles will be on site at any one time.
 5. The vehicles are not all stationary but rather moving through the process as described in the unloading/loading procedures.
 6. No vehicles longer than 12.5 (HRV) will be entering the building,
 7. All transactions are pre-booked and accepted only at the agreed times to prevent queuing internally and externally,
 8. All drivers have been instructed to exit through the wheel wash as shown in the signs posted in the yard,
 9. All drivers have been instructed to give way to all trucks that have completed their job (unloading or loading) first to avoid conflict with priority. Priority is given to trucks arriving first, then second, then third, etc....

NOTE: TRUCK & DOG SPECIFICATIONS ARE NOT AUST. STANDARD COMPLIANCE. AV COMPLIANCE HAS BEEN CHECKED IN ACCORDANCE WITH AS2890.

REV	DATE	DRN	CHK	APP	DRAWING STATUS
K	23.10.20	R.F.	M.M.	M.M.	FINAL ISSUE - AMENDED
J	20.10.20	R.F.	M.M.	M.M.	FINAL ISSUE - AMENDED
I	09.09.20	R.F.	M.M.	M.M.	FINAL ISSUE - AMENDED
H	15.06.20	R.F.	M.M.	M.M.	FINAL ISSUE - FOR APPROVAL
G	01.06.20	R.F.	M.M.	M.M.	FOR APPROVAL
F	22.05.20	R.F.	M.M.	M.M.	CLIENT REVIEW
E	15.11.19	R.F.	M.M.	M.M.	GENERALLY AMENDED

This drawing is not approved for construction unless signed.

Mathew McLennan
BEing (Civil) Hons MIE (Aust)

COPYRIGHT - This drawing and the information provided shall remain the property of DRB Consulting Engineers Pty Ltd (DRB) and may not be used, copied or reproduced, in whole or part, for any purpose other than that for which it was supplied without the prior consent of DRB.

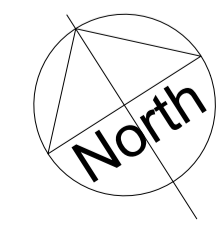

PO BOX 4105 Kotara East 2305
0402 915 549
ABN 64 625 755 482

DRB CONSULTING ENGINEERS

VEHICLE TURNING PATH
TRUCK & DOG: C & D TIP & SPREAD
16 KERR ROAD,
INGLEBURN
BRS

DRAWING STATUS		SHEET SIZE
NOT FOR CONSTRUCTION		A1
PROJECT REF No.	DRAWING No.	REVISION
180009	TURN02	K

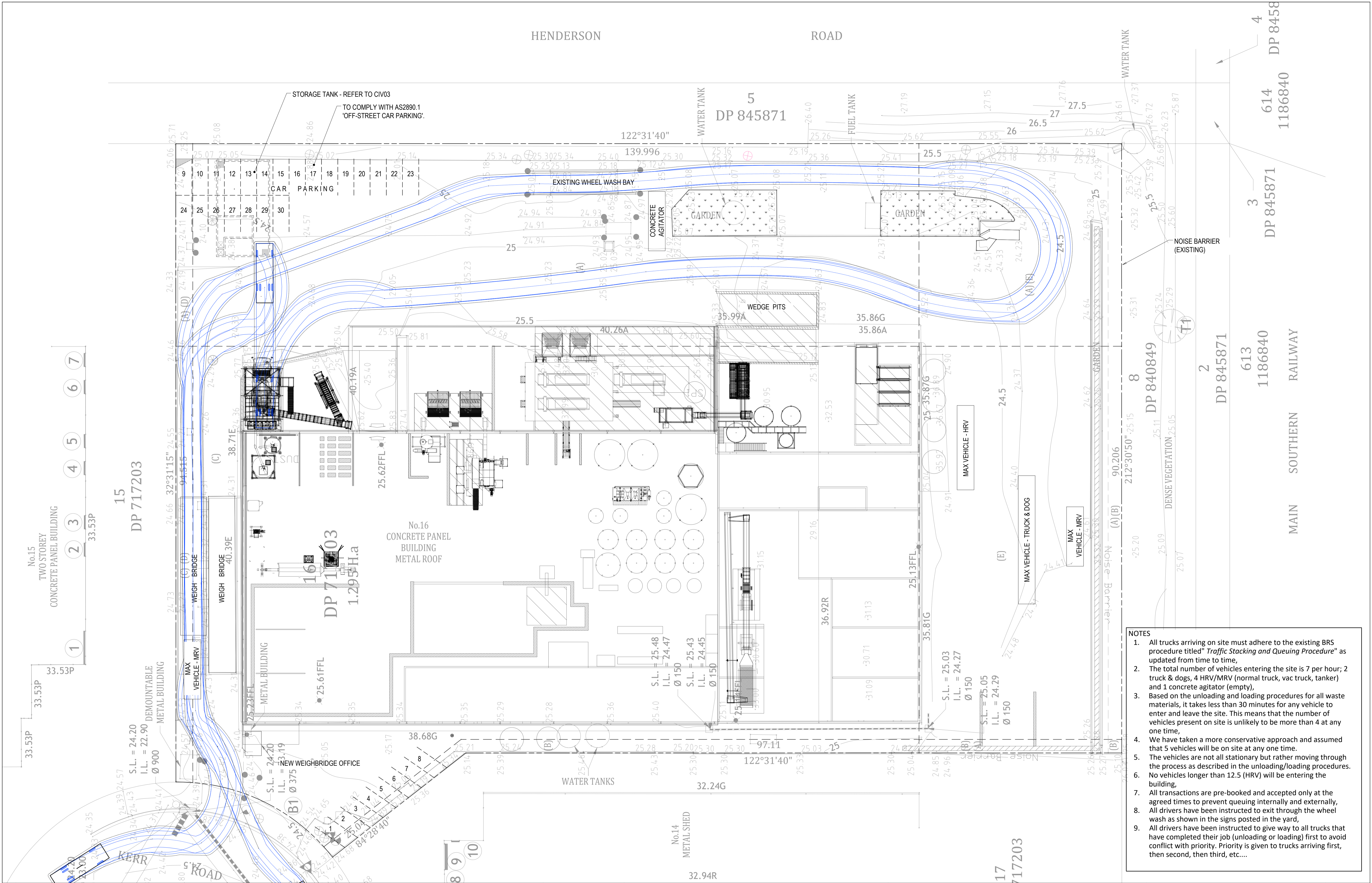

- NOTES
1. All trucks arriving on site must adhere to the existing BRS procedure titled "Traffic Stacking and Queuing Procedure" as updated from time to time,
 2. The total number of vehicles entering the site is 7 per hour; 2 truck & dogs, 4 HRV/MRV (normal truck, vac truck, tanker) and 1 concrete agitator (empty),
 3. Based on the unloading and loading procedures for all waste materials, it takes less than 30 minutes for any vehicle to enter and leave the site. This means that the number of vehicles present on site is unlikely to be more than 4 at any one time,
 4. We have taken a more conservative approach and assumed that 5 vehicles will be on site at any one time.
 5. The vehicles are not all stationary but rather moving through the process as described in the unloading/loading procedures.
 6. No vehicles longer than 12.5 (HRV) will be entering the building,
 7. All transactions are pre-booked and accepted only at the agreed times to prevent queuing internally and externally,
 8. All drivers have been instructed to exit through the wheel wash as shown in the signs posted in the yard,
 9. All drivers have been instructed to give way to all trucks that have completed their job (unloading or loading) first to avoid conflict with priority. Priority is given to trucks arriving first, then second, then third, etc....

REV	DATE	DRN	CHK	APP	DRAWING STATUS
K	23.10.20	R.F.	M.M.	M.M.	FINAL ISSUE - AMENDED
J	20.10.20	R.F.	M.M.	M.M.	FINAL ISSUE - AMENDED
I	09.09.20	R.F.	M.M.	M.M.	FINAL ISSUE - AMENDED
H	15.06.20	R.F.	M.M.	M.M.	FINAL ISSUE - FOR APPROVAL
G	01.06.20	R.F.	M.M.	M.M.	FOR APPROVAL
F	22.05.20	R.F.	M.M.	M.M.	CLIENT REVIEW
E	15.11.19	R.F.	M.M.	M.M.	GENERALLY AMENDED

This drawing is not approved for construction unless signed.

Mathew McLennan
BEing (Civil) Hons MIE (Aust)

COPYRIGHT - This drawing and the information provided shall remain the property of DRB Consulting Engineers Pty Ltd (DRB) and may not be used, copied or reproduced, in whole or part, for any purpose other than that for which it was supplied without the prior consent of DRB.

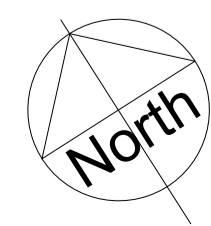

PO BOX 4105 Kotara East 2305
0402 915 549
ABN 64 625 755 482

DRB CONSULTING ENGINEERS

VEHICLE TURNING PATH
CONCRETE AGITATOR (MRV 8.8m)
16 KERR ROAD,
INGLEBURN
BRS

DRAWING STATUS		SHEET SIZE
NOT FOR CONSTRUCTION		A1
PROJECT REF No.	DRAWING No.	SCALE
180009	TURN03	1:250
		REVISION
		K

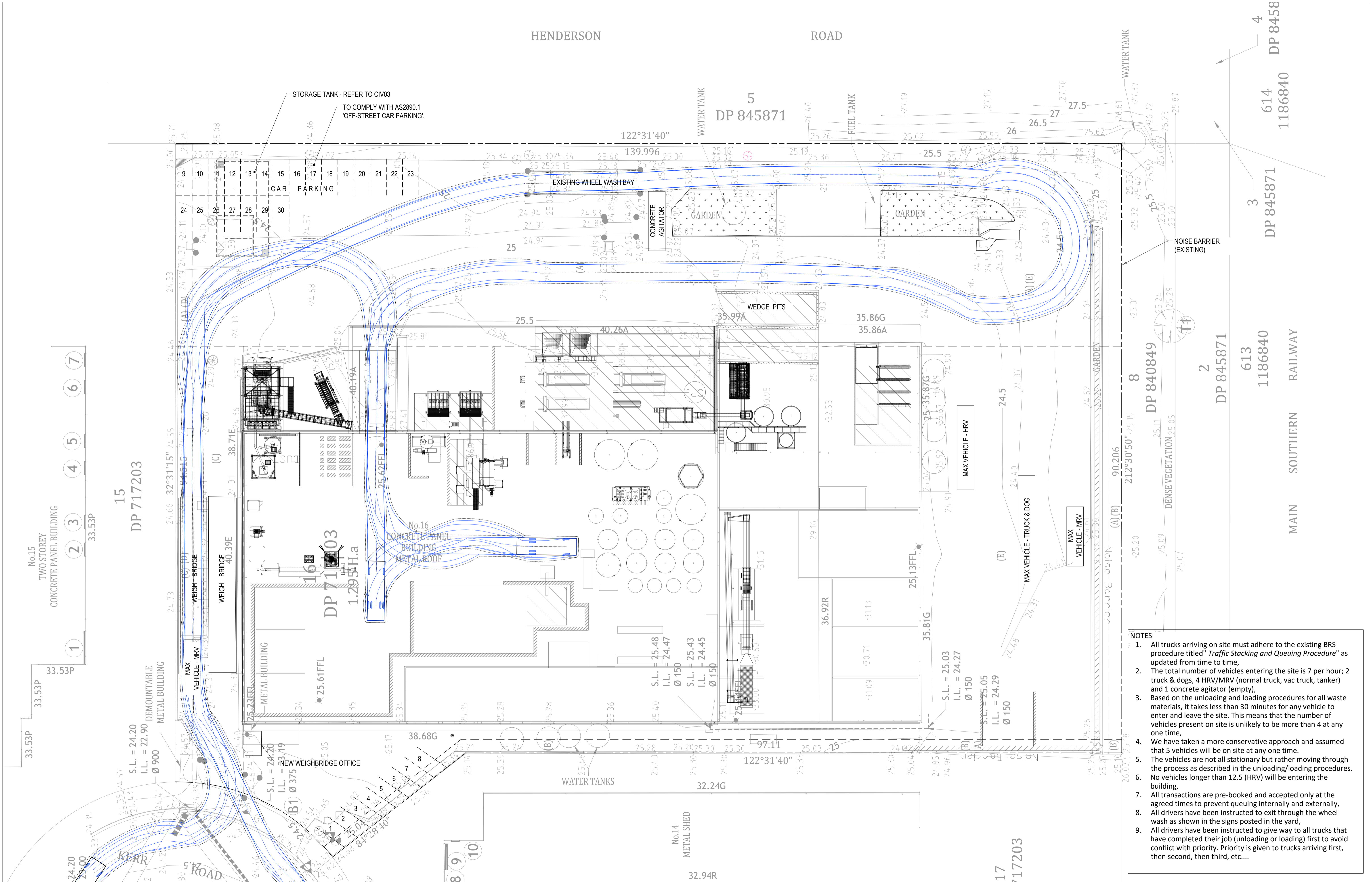

- NOTES
1. All trucks arriving on site must adhere to the existing BRS procedure titled "Traffic Stacking and Queuing Procedure" as updated from time to time,
 2. The total number of vehicles entering the site is 7 per hour; 2 truck & dogs, 4 HRV/MRV (normal truck, vac truck, tanker) and 1 concrete agitator (empty),
 3. Based on the unloading and loading procedures for all waste materials, it takes less than 30 minutes for any vehicle to enter and leave the site. This means that the number of vehicles present on site is unlikely to be more than 4 at any one time,
 4. We have taken a more conservative approach and assumed that 5 vehicles will be on site at any one time.
 5. The vehicles are not all stationary but rather moving through the process as described in the unloading/loading procedures.
 6. No vehicles longer than 12.5 (HRV) will be entering the building,
 7. All transactions are pre-booked and accepted only at the agreed times to prevent queuing internally and externally,
 8. All drivers have been instructed to exit through the wheel wash as shown in the signs posted in the yard,
 9. All drivers have been instructed to give way to all trucks that have completed their job (unloading or loading) first to avoid conflict with priority. Priority is given to trucks arriving first, then second, then third, etc....

REV	DATE	DRN	CHK	APP	DRAWING STATUS

This drawing is not approved for construction unless signed.

Mathew McLennan
BEing (Civil) Hons MIE (Aust)

COPYRIGHT - This drawing and the information provided shall remain the property of DRB Consulting Engineers Pty Ltd (DRB) and may not be used, copied or reproduced, in whole or part, for any purpose other than that for which it was supplied without the prior consent of DRB.

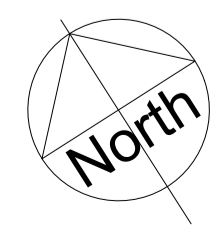

PO BOX 4105 Kotara East 2305
0402 915 549
ABN 64 625 755 482

DRB CONSULTING ENGINEERS

VEHICLE TURNING PATH
MRV 8.8m: INTERNAL DROP OFF
16 KERR ROAD,
INGLEBURN
BRS

DRAWING STATUS		SHEET SIZE	
NOT FOR CONSTRUCTION		A1	
PROJECT REF No.		SCALE	
180009		1:250	
DRAWING No.		REVISION	
TURN04		K	

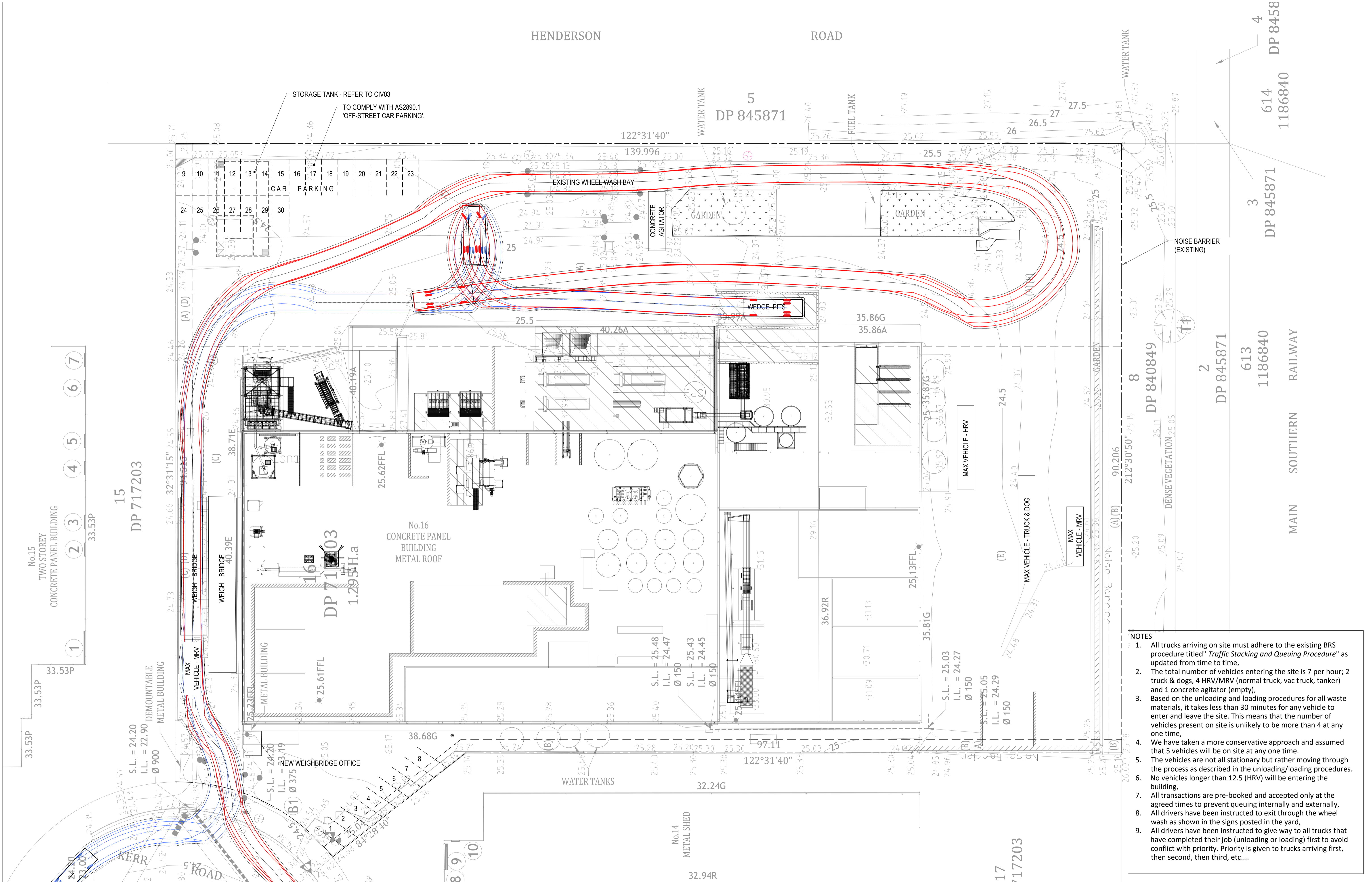

REV	DATE	DRN	CHK	APP	DRAWING STATUS

This drawing is not approved for construction unless signed.

Mathew McLennan
BEing (Civil) Hons MIE (Aust)

COPYRIGHT - This drawing and the information provided shall remain the property of DRB Consulting Engineers Pty Ltd (DRB) and may not be used, copied or reproduced, in whole or part, for any purpose other than that for which it was supplied without the prior consent of DRB.

PO BOX 4105 Kotara East 2305
0402 915 549
ABN 64 625 755 482

VEHICLE TURNING PATH
MRV: EXTERNAL WEDGE PIT
16 KERR ROAD,
INGLEBURN
BRS

DRAWING STATUS		SHEET SIZE
NOT FOR CONSTRUCTION		A1
PROJECT REF No.	DRAWING No.	SCALE
180009	TURN05	1:250
REVISION		I

- NOTES
- All trucks arriving on site must adhere to the existing BRS procedure titled "Traffic Stacking and Queuing Procedure" as updated from time to time,
 - The total number of vehicles entering the site is 7 per hour; 2 truck & dogs, 4 HRV/MRV (normal truck, vac truck, tanker) and 1 concrete agitator (empty),
 - Based on the unloading and loading procedures for all waste materials, it takes less than 30 minutes for any vehicle to enter and leave the site. This means that the number of vehicles present on site is unlikely to be more than 4 at any one time,
 - We have taken a more conservative approach and assumed that 5 vehicles will be on site at any one time.
 - The vehicles are not all stationary but rather moving through the process as described in the unloading/loading procedures.
 - No vehicles longer than 12.5 (HRV) will be entering the building,
 - All transactions are pre-booked and accepted only at the agreed times to prevent queuing internally and externally,
 - All drivers have been instructed to exit through the wheel wash as shown in the signs posted in the yard,
 - All drivers have been instructed to give way to all trucks that have completed their job (unloading or loading) first to avoid conflict with priority. Priority is given to trucks arriving first, then second, then third, etc....

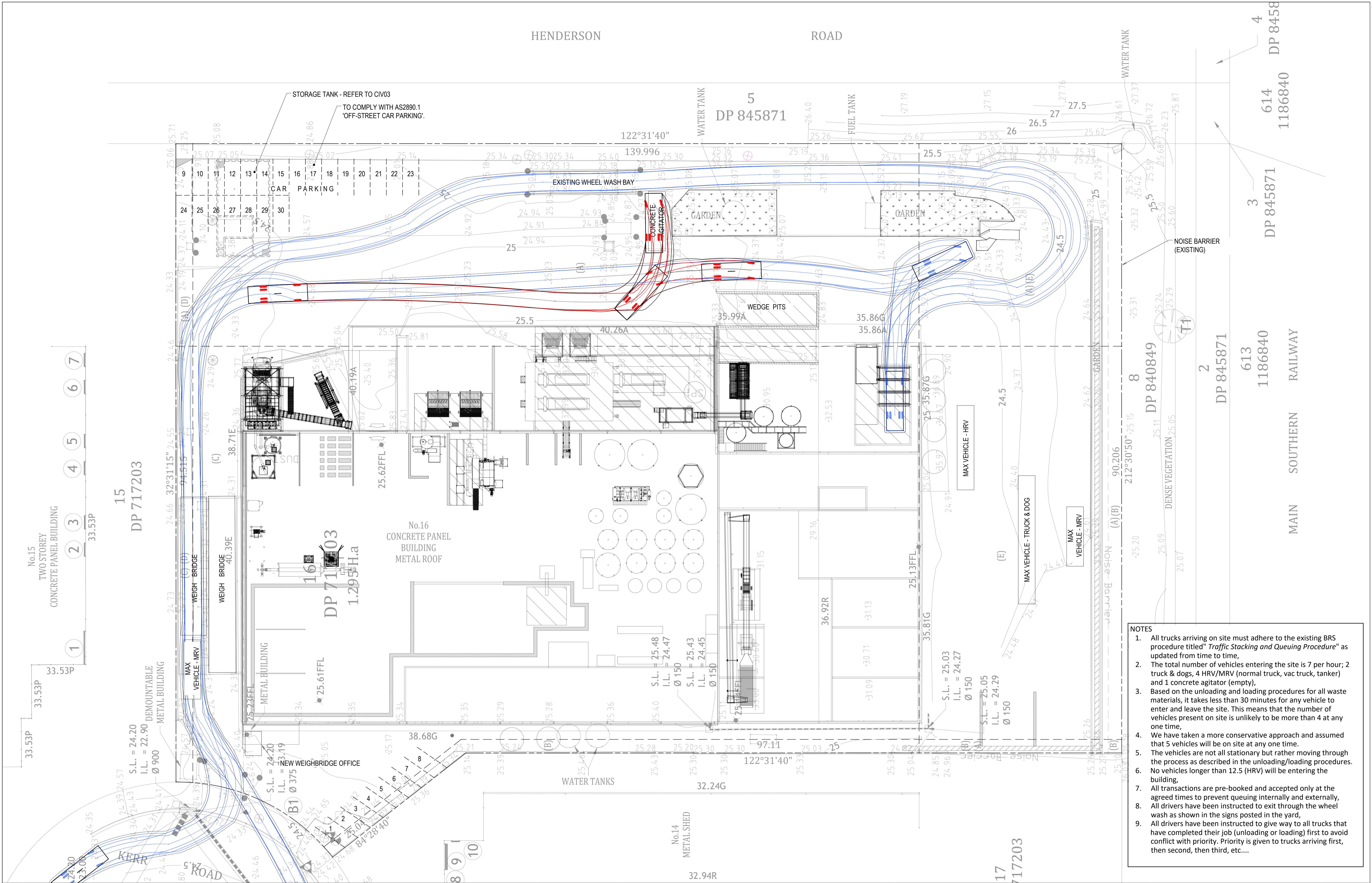

- NOTES
1. All trucks arriving on site must adhere to the existing BRS procedure titled "Traffic Stacking and Queuing Procedure" as updated from time to time,
 2. The total number of vehicles entering the site is 7 per hour; 2 truck & dogs, 4 HRV/MRV (normal truck, vac truck, tanker) and 1 concrete agitator (empty),
 3. Based on the unloading and loading procedures for all waste materials, it takes less than 30 minutes for any vehicle to enter and leave the site. This means that the number of vehicles present on site is unlikely to be more than 4 at any one time,
 4. We have taken a more conservative approach and assumed that 5 vehicles will be on site at any one time.
 5. The vehicles are not all stationary but rather moving through the process as described in the unloading/loading procedures.
 6. No vehicles longer than 12.5 (HRV) will be entering the building,
 7. All transactions are pre-booked and accepted only at the agreed times to prevent queuing internally and externally,
 8. All drivers have been instructed to exit through the wheel wash as shown in the signs posted in the yard,
 9. All drivers have been instructed to give way to all trucks that have completed their job (unloading or loading) first to avoid conflict with priority. Priority is given to trucks arriving first, then second, then third, etc....

REVISIONS	H	23.10.20	R.F.	M.M.	M.M.	FINAL ISSUE - AMENDED
	G	20.10.20	R.F.	M.M.	M.M.	FINAL ISSUE - AMENDED
	F	09.09.20	R.F.	M.M.	M.M.	FINAL ISSUE - AMENDED
	E	15.06.20	R.F.	M.M.	M.M.	FINAL ISSUE - FOR APPROVAL
	D	01.06.20	R.F.	M.M.	M.M.	FOR APPROVAL
	C	22.05.20	R.F.	M.M.	M.M.	CLIENT REVIEW
	B	15.11.19	R.F.	M.M.	M.M.	GENERALLY AMENDED
REV	DATE	DRN	CHK	APP	DRAWING STATUS	

This drawing is not approved for construction unless signed.

Mathew McLennan
BEing (Civil) Hons MIE (Aust)

COPYRIGHT - This drawing and the information provided shall remain the property of DRB Consulting Engineers Pty Ltd (DRB) and may not be used, copied or reproduced, in whole or part, for any purpose other than that for which it was supplied without the prior consent of DRB.

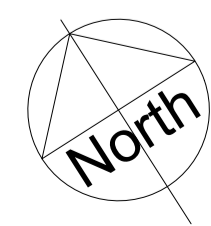

PO BOX 4105 Kotara East 2305
0402 915 549
ABN 64 625 755 482

VEHICLE TURNING PATH
MRV: INTERNAL WEDGE PIT
16 KERR ROAD,
INGLEBURN
BRS

DRAWING STATUS		SHEET SIZE
NOT FOR CONSTRUCTION		A1
PROJECT REF No.	DRAWING No.	SCALE
180009	TURN06	1:250
		REVISION
		H