

# **FLOOD EVACUATION MANAGEMENT PLAN OVERVIEW**

## **BURRILL LAKE TAVERN**

**Lots 212 to 217 DP 15648**

**Princes Highway Burrill Lake**

Prepared by:  
Oceanic Developments Australia Pty. Ltd.  
Suite 5, 350 Port Hacking Road  
Caringbah NSW 2229

Phone: 9524 6864  
Facsimile: 9524 7616

**Revision: Draft 22<sup>nd</sup> June 2006**

This documents sets out the principles to be incorporated, actions to be undertaken and issues to be addressed during the preparation of the Burrill Lake Tavern Flood Evacuation Management Plan (the Plan).

The Plan is to be developed by the Operator and implemented post occupancy of the proposed facility.

The Plan is to be updated from time to time to suit State Government policy changes, future awareness of the catchment/precinct's response to flood events, and other information that is available in the future to mitigate against loss of life and property as related to the Facility during a flood event.

Revised Plans are to be provided to the local contact within the State Emergency Service and other relevant local authorities.

The Plan is to include detail information pertaining to:

- The Standard Flood Event's anticipated characteristics as at the time of the revision of the Plan. Specifically the anticipated flood levels, time frame to reach the Standard Flood event height and flow characteristics as related to the Site.
- The possible impact of a Standard Flood event on the premises with respect to access and egress and the structural integrity of the Facility.
- The potential hazards resulting from such an event and interrelationship of the hazards identified with the Facilities levels, layout and operations.
- Early actions to be undertaken in the event of a Standard Flood, actions to be undertaken during and actions to be undertaken after a Standard Flood event so as to mitigate against the potential for loss of life and property.
- Primary and Secondary evacuation routes and an analysis of a Refuge option whereby the facility is unable to be safely evacuated.
- Additional Information to be included within the Plan includes:

Site Address

Name of Business

Name of Key Contact Person(s):

Primary Contact

Secondary Contact

Key Contact Details:

Primary Contact Details

Secondary Contact Details

Facility Overview:

Use and function overview

Construction type

Flood protection inventory and location of equipment

Authority (SES/Police/Etc) response support required during a Flood Event

*In addition to the above, the Plan is to include the below specific requirements:*

- Reference that the Facility is flood inundation effected, and hence is NOT to be used or promoted as a place of Refuge during a Flood Event.
- The timing for evacuation of the facility of persons is to be established and incorporated into the Plan in consultation with the local SES. Despite the noted consultation, a requirement that when flood levels reach an RL1.80 m AHD (as indicated by the property boundaries being encroached upon by flood waters), that the premises be evacuated.
- That early warning signs be identification for a possible significant flood event and that those signs be monitored during Operations.
- A Risk to Life Hazard Identification and Minimisation Assessment be undertaken in consultation with the local SES. The results of which are to be incorporated into an action plan forming part of the overall Plan.
- Authority key contact details.
- An action plan setting out actions to be undertaken to secure the property generally from such an event, inclusive of:
  - Isolation of non-essential services supplies;
  - Securing of hazardous substances/pollutants (septic, sewer, greases and oils, chemicals and poisons);
  - Securing of external areas re potential debris sources.
- A requirement that the basement car park be evacuated (property, loose plant and equipment, motor vehicles and persons) no later than when the water level encroaches within the property (equating to a water level of approximately RL1.80m AHD) or earlier if so advised by authorities of a pending Standard Flood event.
- An assessment and identification of measures to remove the risk of or mitigate the impact of a person (able or disabled) being located with the basement car park during a flood event.
- That the basement car park be evacuated prior to there being a risk of supply services to the area being disrupted such that the lift service included within the facility is disabled.
- A requirement that the proposed (refer plans) manually operated swinging boom gate at the entrance to the basement car park be closed (not locked) on evacuation of vehicles from the basement car park.
- That appropriate warning signage be fixed to the above referenced gate regarding the risk associated with the use of the basement car park during a Flood Event. Similar signage is to be displayed at both stair entrance/exit points from the basement car park and within the lifts proposed.
- Evacuation routes for the following scenarios (preliminary route attached):

- Primary evacuation route (0 to 200mm depth over route)
- Secondary evacuation route (200 to 400mm depth "wade out" over route)
- An analysis be provided with risks identified and mitigation measures proposed in relation to a Refuge Option where occupants are unable to be evacuated from the facility due to mitigating circumstances. An action plan is to be developed in response to that analysis and incorporated into the Plan.

*Post event actions are to be incorporated into the Plan, including a requirement that:*

- Authorities be contacted and advised of the proposal to occupy the Facility (SES/Police).
- A review of hazards and health risks be undertaken prior to occupation, with outcomes implemented to mitigate against such hazards and health risks.
- Services be inspected by qualified persons and repaired/reconnected as required.

*Attachments:*

1. Preliminary Evacuation Route



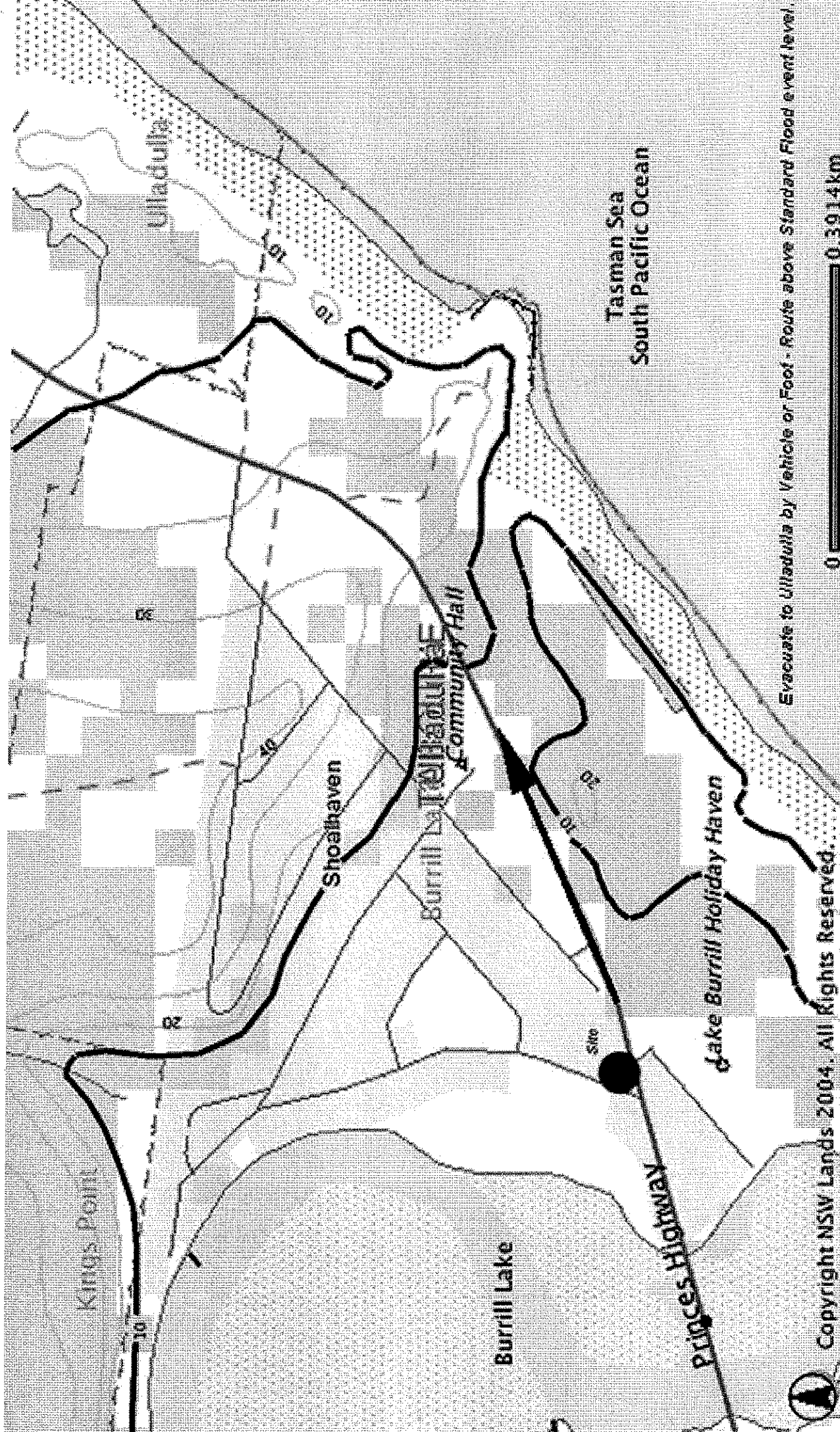

Evacuate to Ulladulla by Vehicle or Foot - Route above Standard Flood event level.



Copyright NSW Lands 2004. All Rights Reserved.



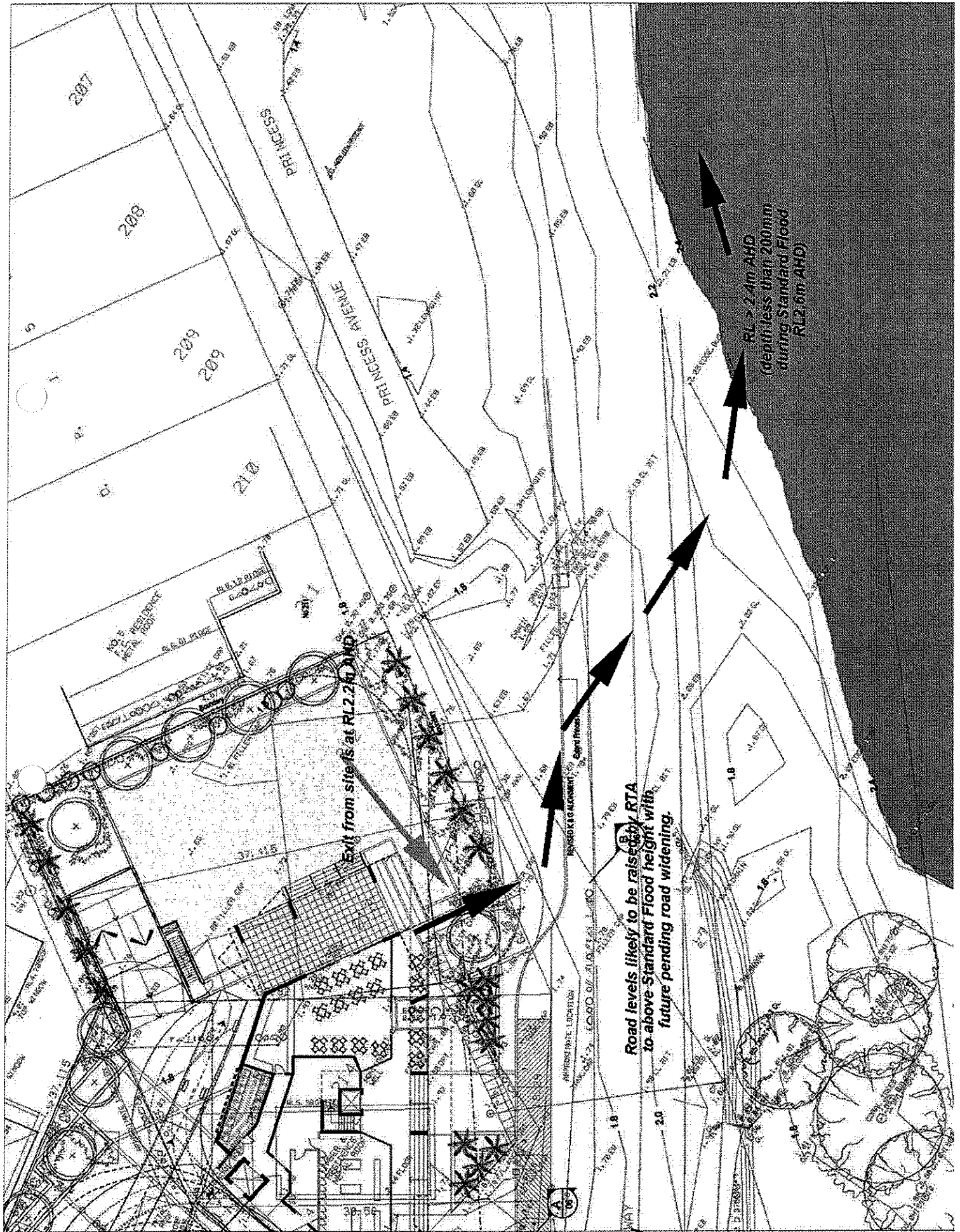

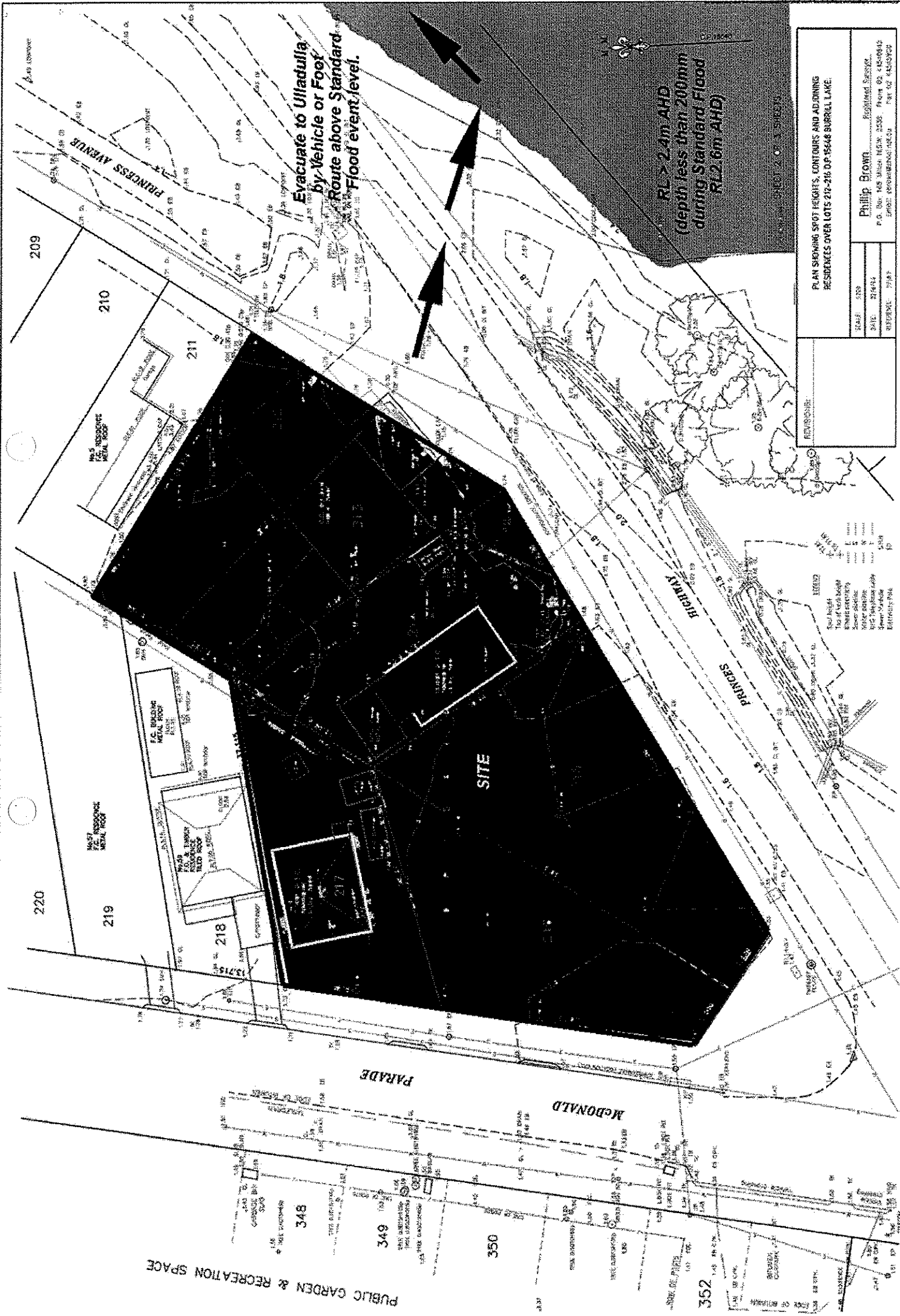



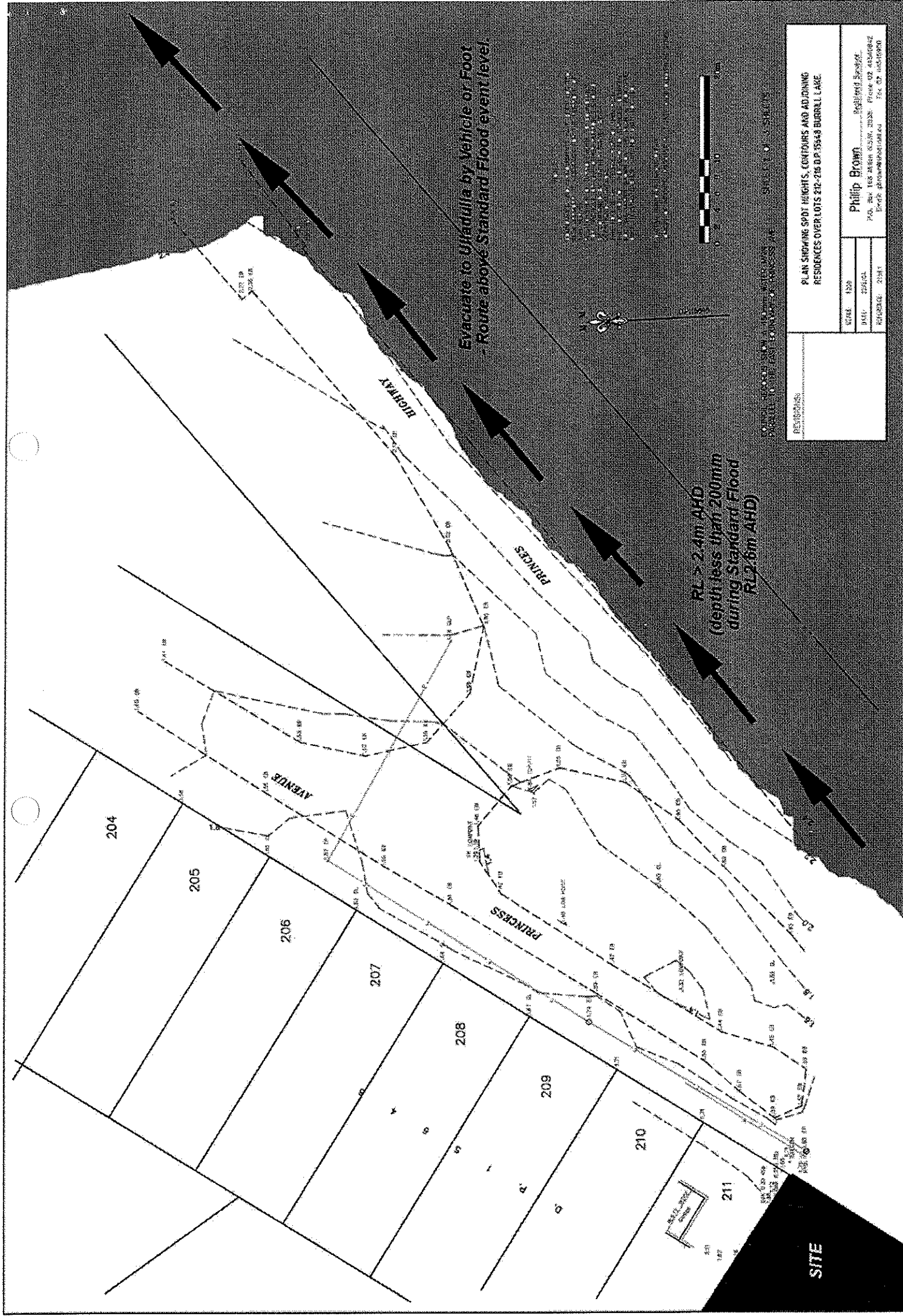

PROJECT: 1500  
 DATE: 20/01/21  
 PROJECT: 21/01/21

PLAN SHOWING SODY HEIGHTS, CONTOURS AND ADDING  
 RESIDENCES OVER LOTS 212-216 DP 15548 BURRELL LAKE.

Philip Brown  
 P.O. Box 108 Burrell NSW 2220 Phone 02 4344042  
 Email philip@brown.com.au Fax 02 4344090