

Plot Date :03-Sep-18 8:36:02 AM

Cad File No : C:\Wiley Revit Local\W21206-30-Arch\_nor.ramli.rvt

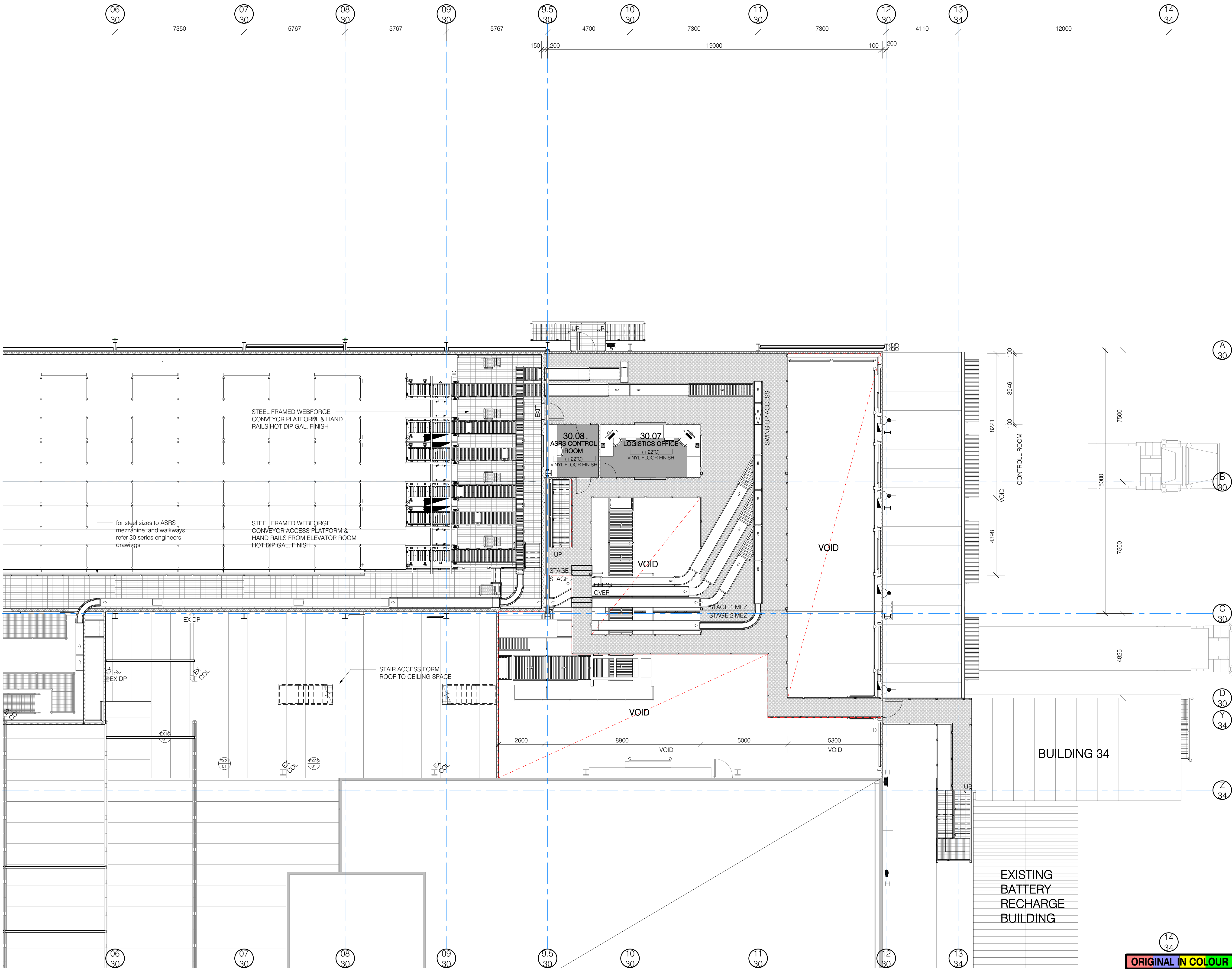

© WILEY & CO PTY LTD  
ABN 40 010 604 869  
This document is the property of Wiley & Co Pty Ltd and is copyright. The subject matter of it is confidential. Do not use, reproduce, copy or disclose except with and only to the extent of the prior written consent of Wiley & Co Pty Ltd. Persons receiving this document are responsible for restricting disclosure as stated above.

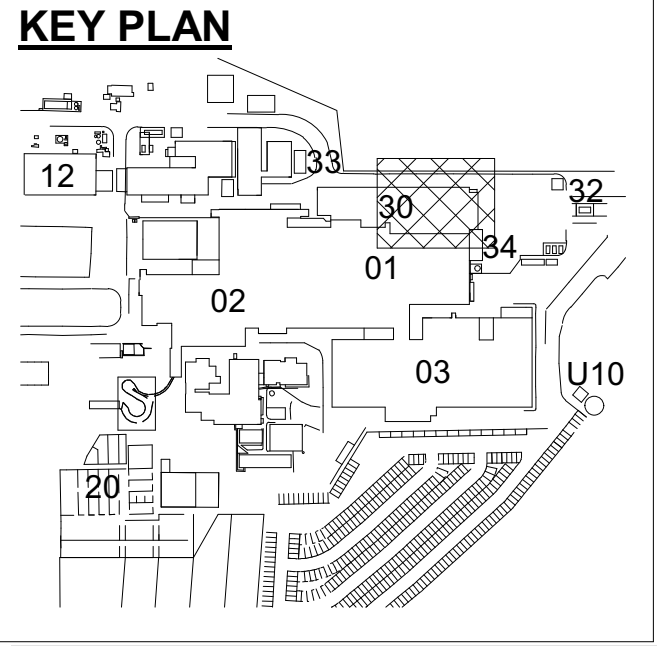

03/09/18	10	ISSUE FOR DA MOD	DT
24/08/18	9	OFFICE LAYOUT FLIPPED, WALKWAYS REVISED.	DT
24/08/18	8	OFFICE LAYOUT REVISED	BM
23/08/18	7	NEW MEZ REDESIGN, NEW STAIRS, DOCK 3 MOVED TO STAGE 1	DT
21/08/18	6	ISSUE FOR CLIENT APPROVAL	DT
20/08/18	5	FRONT BUILDING, REAR EXTENSION AND BLD 34 REDESIGN	DT

Date	Issue	Amendment	Init
Brisbane Kuala Lumpur Melbourne Sydney Toowoomba www.wiley.com.au connect@wiley.com.au 1300 385 988			

WILEY



TEYS AUSTRALIA - STAGE 2  
COLD MEAT PROJECT  
WAGGA WAGGA, NSW  
Drawing Title  
MEZZANINE FLOOR PLAN  
SHEET 2 OF 2

Scale A1 = 1:100 (A3 = 1:200) 0 1000 2000

Drawn DT Date JUN 2018

Project No. W21206 Bldg No. 30

Drawing No. Issue

30A116 - 10  
PRELIMINARY

ADVICE ♦ DESIGN ♦ ENGINEERING ♦ CONSTRUCTION