

ANDREW PHILIP MASON
Andrew Mason
REGISTERED SURVEYOR
REGISTRATION No. 1576

NOTES:
1. DENOTES NO PEDESTRIAN CROSSING

----- OPTION 1 HORIZONTAL DISTANCE 507.5 m
----- OPTION 1 SLOPE DISTANCE 512.4 m

www.1100.com.au

TM DIAL BEFORE YOU DIG SHOULD BE CONTACTED PRIOR TO ANY EXCAVATION ON SITE
TM: trade mark of Association of Australian Dial Before You Dig Services Ltd; used under licence.



COPYRIGHT
THIS DRAWING HAS BEEN PROCESSED ELECTRONICALLY. NEITHER THE PAPER REPRESENTATION NOR THE ELECTRONIC FILE MAY BE COPIED IN PART OR WHOLE WITHOUT THE WRITTEN APPROVAL OF FRANK M MASON & CO. PTY LTD

EMAIL
info@mason.net.au

FRANK M MASON & CO. PTY LTD
LAND AND ENGINEERING SURVEYORS
CONSULTANTS IN LAND DEVELOPMENT
UNIT 402 LEVEL 4 156-158 PACIFIC HIGHWAY
GREENWICH NSW 2065

Tel 02 9929 6233
02 9955 5385
Fax 02 9929 7727

PLAN SHOWING WALKING DISTANCE BETWEEN
No's 40-48 REDAN STREET MOSMAN AND THE REAR OF No. 742
MILITARY ROAD MOSMAN, BEING THE EDGE OF THE
MOSMAN TOWN CENTRE

Drawn	RS	Surveyor	RS	Datum	AHD	Date	26.03.2026
Reduction Ratio	Size	Drawing Name		Sheet			
1:1000	A2	33723-01		1 OF 5			

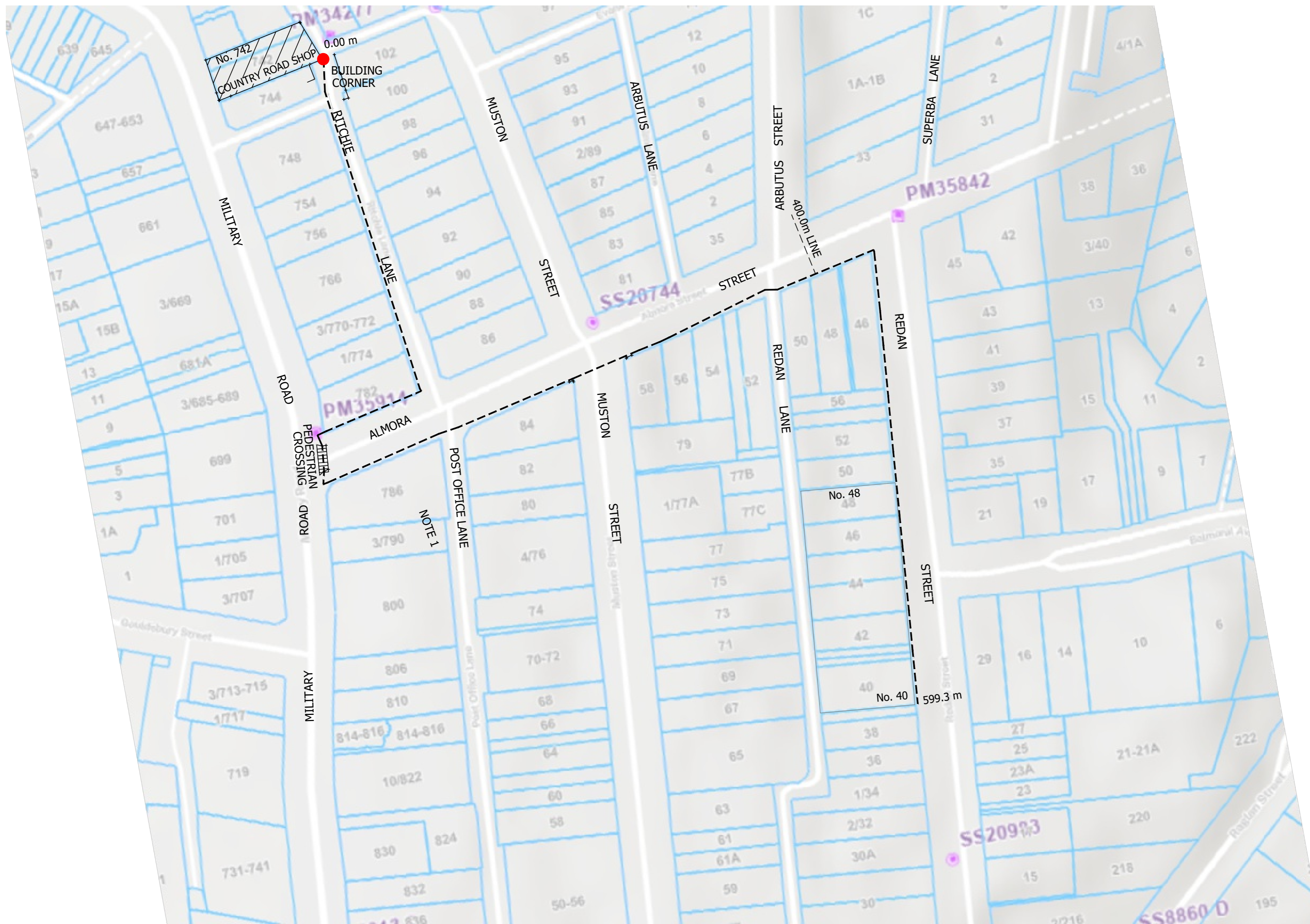

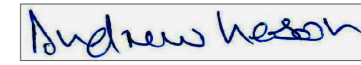
ANDREW PHILIP MASON

 REGISTERED SURVEYOR
 REGISTRATION No. 1576

----- OPTION 2 HORIZONTAL DISTANCE 599.3 m
 ----- OPTION 2 SLOPE DISTANCE 605.4 m

www.1100.com.au

 TM DIAL BEFORE YOU DIG SHOULD BE CONTACTED PRIOR TO ANY EXCAVATION ON SITE
 TM: trade mark of Association of Australian Dial Before You Dig Services Ltd; used under licence.

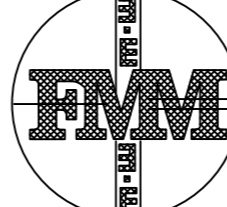

COPYRIGHT
 THIS DRAWING HAS BEEN PROCESSED ELECTRONICALLY. NEITHER THE PAPER REPRESENTATION NOR THE ELECTRONIC FILE MAY BE COPIED IN PART OR WHOLE WITHOUT THE WRITTEN APPROVAL OF FRANK M MASON & CO. PTY LTD

 EMAIL
 info@mason.net.au

FRANK M MASON & CO. PTY LTD
 LAND AND ENGINEERING SURVEYORS
 CONSULTANTS IN LAND DEVELOPMENT
 UNIT 402 LEVEL 4 156-158 PACIFIC HIGHWAY
 GREENWICH NSW 2065

Tel 02 9929 6233
 02 9955 5385
 Fax 02 9929 7727

PLAN SHOWING WALKING DISTANCE BETWEEN No's 40-48 REDAN STREET MOSMAN AND THE REAR OF No. 742 MILITARY ROAD MOSMAN, BEING THE EDGE OF THE MOSMAN TOWN CENTRE

Drawn	RS	Surveyor	RS	Datum	AHD	Date	26.03.2026
Reduction Ratio	Size	Drawing Name		Sheet			
1:1000	A2	33723-01		2 OF 5			

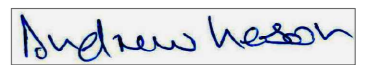

ANDREW PHILIP MASON

 REGISTERED SURVEYOR
 REGISTRATION No. 1576

----- OPTION 3 HORIZONTAL DISTANCE 597.8 m
 ----- OPTION 3 SLOPE DISTANCE 601.2 m

www.1100.com.au

 DIAL BEFORE YOU DIG
 BEFORE YOU DIG
TM: trade mark of Association of Australian Dial Before You Dig Services Ltd; used under licence.

0 20 40 60 80 100
 COPYRIGHT
 THIS DRAWING HAS BEEN PROCESSED ELECTRONICALLY.
 NEITHER THE PAPER REPRESENTATION NOR THE ELECTRONIC
 FILE MAY BE COPIED IN PART OR WHOLE WITHOUT THE
 WRITTEN APPROVAL OF FRANK M MASON & CO. PTY LTD



 EMAIL
 info@mason.net.au

FRANK M MASON & CO. PTY LTD
 LAND AND ENGINEERING SURVEYORS
 CONSULTANTS IN LAND DEVELOPMENT
 UNIT 402 LEVEL 4 156-158 PACIFIC HIGHWAY
 GREENWICH NSW 2065
 Tel 02 9929 6233
 02 9955 5385
 Fax 02 9929 7727

PLAN SHOWING WALKING DISTANCE BETWEEN
 No's 40-48 REDAN STREET MOSMAN AND THE REAR OF No. 742
 MILITARY ROAD MOSMAN, BEING THE EDGE OF THE
 MOSMAN TOWN CENTRE

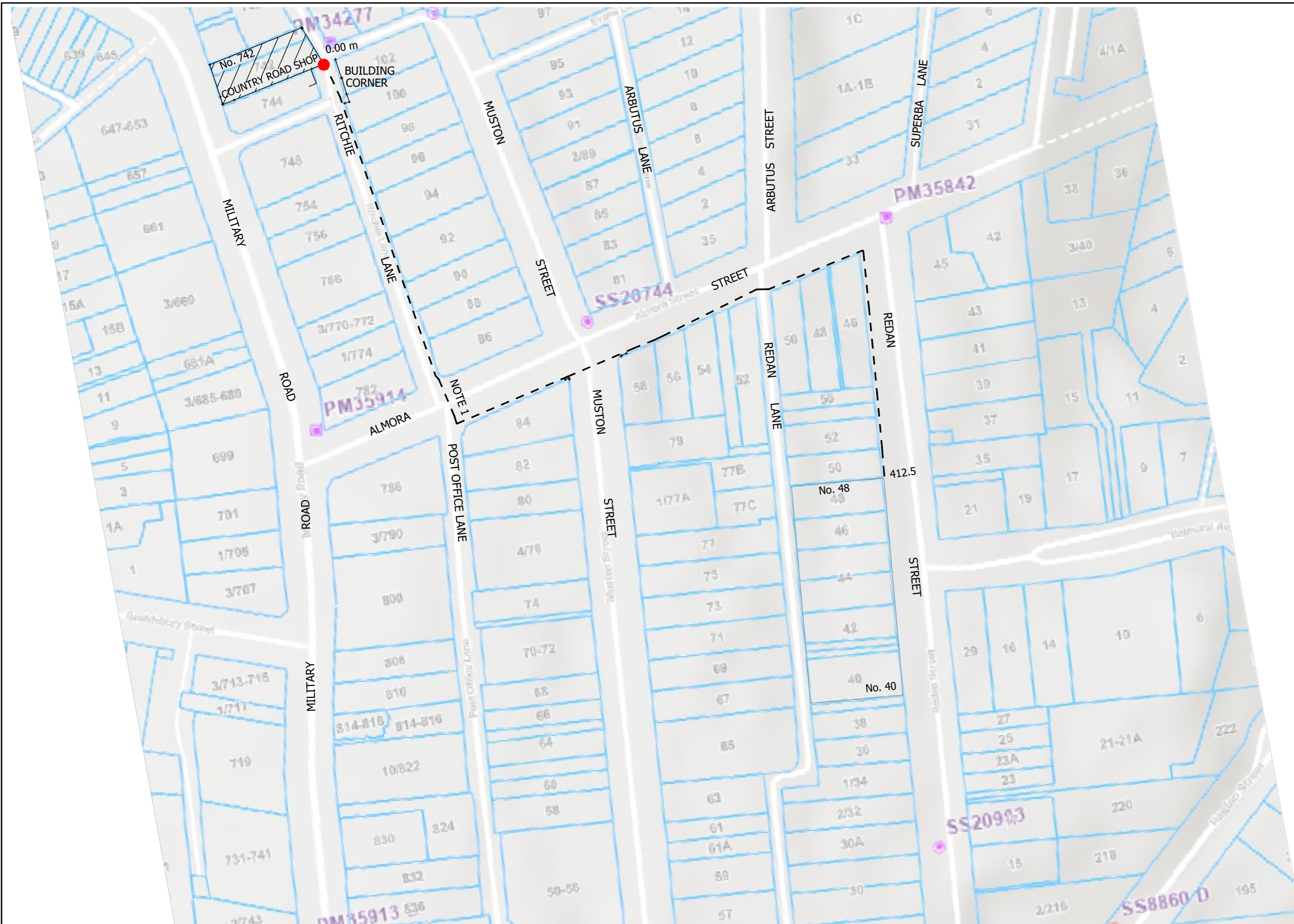
Drawn	RS	Surveyor	RS	Datum	AHD	Date	26.03.2026
Reduction Ratio	Size	Drawing Name		Sheet			
1:1000	A2	33723-01		3 OF 5			



ANDREW PHILIP MASON

 REGISTERED SURVEYOR
 REGISTRATION No. 1576

NOTES:
 1. DENOTES NO PEDESTRIAN CROSSING

----- OPTION 4 HORIZONTAL DISTANCE 412.5m
 ----- OPTION 4 SLOPE DISTANCE 417.2m



TM DIAL BEFORE YOU DIG SHOULD BE CONTACTED PRIOR TO ANY EXCAVATION ON SITE
 TM: trade mark of Association of Australian Dial Before You Dig Services Ltd; used under licence.



COPYRIGHT
 THIS DRAWING HAS BEEN PROCESSED ELECTRONICALLY. NEITHER THE PAPER REPRESENTATION NOR THE ELECTRONIC FILE MAY BE COPIED IN PART OR WHOLE WITHOUT THE WRITTEN APPROVAL OF FRANK M MASON & CO. PTY LTD

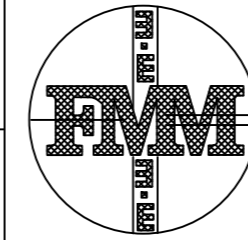

EMAIL
 info@mason.net.au

FRANK M MASON & CO. PTY LTD
 LAND AND ENGINEERING SURVEYORS
 CONSULTANTS IN LAND DEVELOPMENT
 UNIT 402 LEVEL 4 156-158 PACIFIC HIGHWAY
 GREENWICH NSW 2065

Tel 02 9929 6233
 02 9955 5385
 Fax 02 9929 7727

PLAN SHOWING WALKING DISTANCE BETWEEN
 No's 40-48 REDAN STREET MOSMAN AND THE REAR OF No. 742
 MILITARY ROAD MOSMAN, BEING THE EDGE OF THE
 MOSMAN TOWN CENTRE

Drawn	RS	Surveyor	RS	Datum	AHD	Date	26.03.2026
Reduction Ratio	Size	Drawing Name		Sheet			
1:1000	A2	33723-01		4 OF 5			

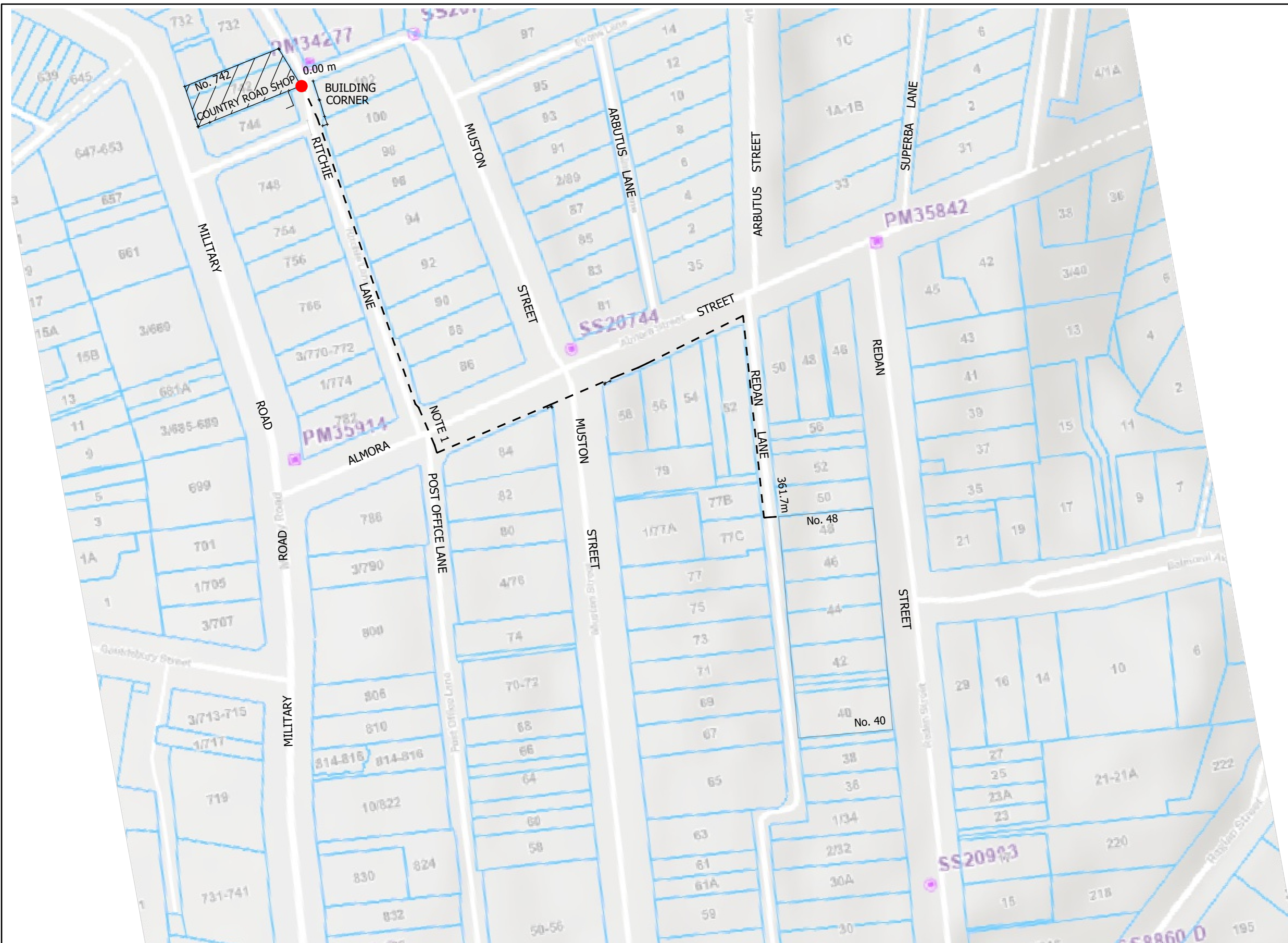

ANDREW PHILIP MASON

 REGISTERED SURVEYOR
 REGISTRATION No. 1576

NOTES:
 1. DENOTES NO PEDESTRIAN CROSSING

----- OPTION 5 HORIZONTAL DISTANCE 361.7m
 ----- OPTION 5 SLOPE DISTANCE 367.4m

www.1100.com.au

 DIAL BEFORE YOU DIG SHOULD BE CONTACTED PRIOR TO ANY EXCAVATION ON SITE
TM: trade mark of Association of Australian Dial Before You Dig Services Ltd; used under licence.

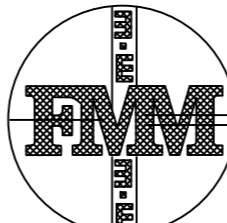

COPYRIGHT
 THIS DRAWING HAS BEEN PROCESSED ELECTRONICALLY. NEITHER THE PAPER REPRESENTATION NOR THE ELECTRONIC FILE MAY BE COPIED IN PART OR WHOLE WITHOUT THE WRITTEN APPROVAL OF FRANK M MASON & CO. PTY LTD

 EMAIL
 info@mason.net.au

FRANK M MASON & CO. PTY LTD
 LAND AND ENGINEERING SURVEYORS
 CONSULTANTS IN LAND DEVELOPMENT
 UNIT 402 LEVEL 4 156-158 PACIFIC HIGHWAY
 GREENWICH NSW 2065

Tel 02 9929 6233
 02 9955 5385
 Fax 02 9929 7727

PLAN SHOWING WALKING DISTANCE BETWEEN No's 40-48 REDAN STREET MOSMAN AND THE REAR OF No. 742 MILITARY ROAD MOSMAN, BEING THE EDGE OF THE MOSMAN TOWN CENTRE

Drawn	RS	Surveyor	RS	Datum	AHD	Date	26.03.2026
Reduction Ratio	Size	Drawing Name		Sheet			
1:1000	A2	33723-01		5 OF 5			