

## 4.0g detention basin - detail plan

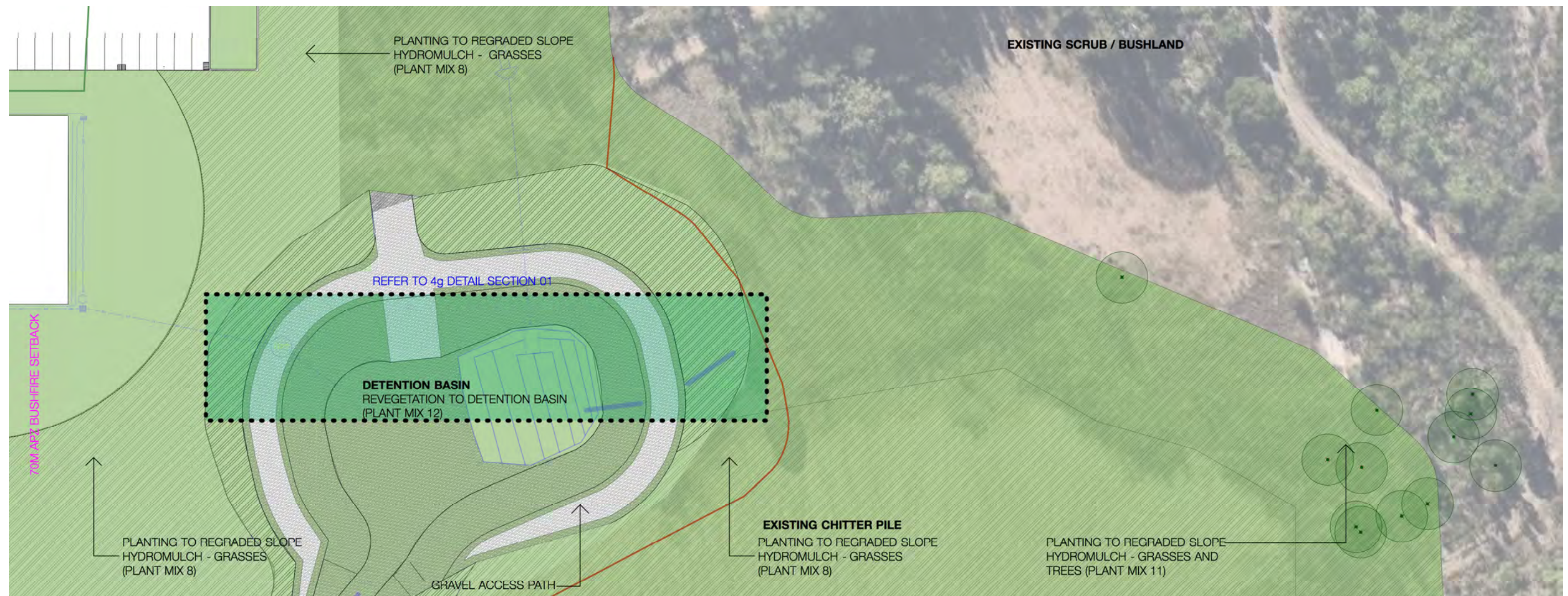

A new detention basin is proposed for the site, the basin will be planted with local wetland species being planted along the perimeter of the pond and the new batters and channel embankments being populated with grasses and low shrubs (due to the proximity of the proposed helipad and bushfire APZ the tree & canopy planting is limited).



scale 1:1600 @ A3



# 4.0g detention basin - detail section 01



scale 1:1250 @ A3



# 4.0h mortuary courtyard - detail plan

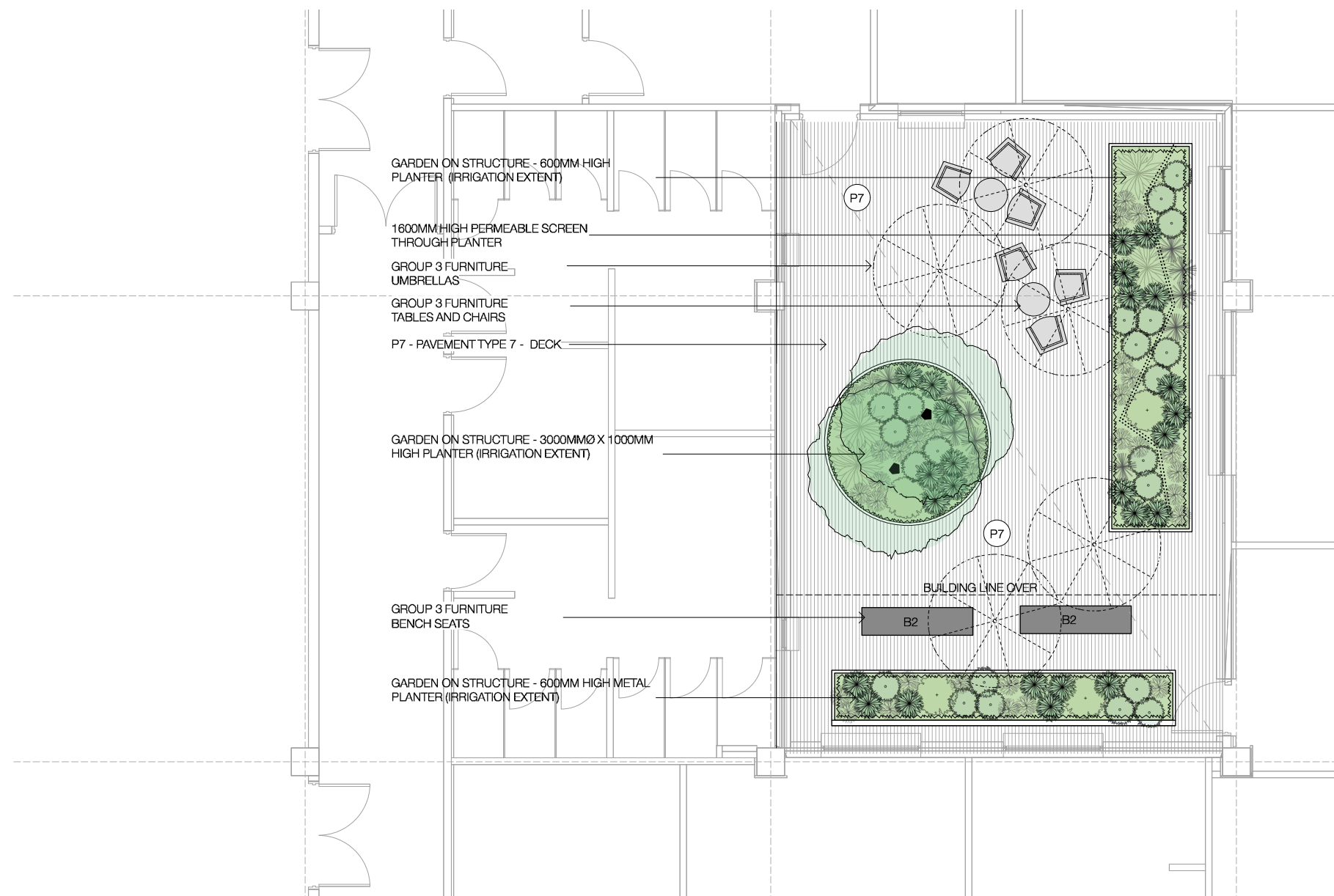

## 4.0i rehabilitation courtyard - detail plan

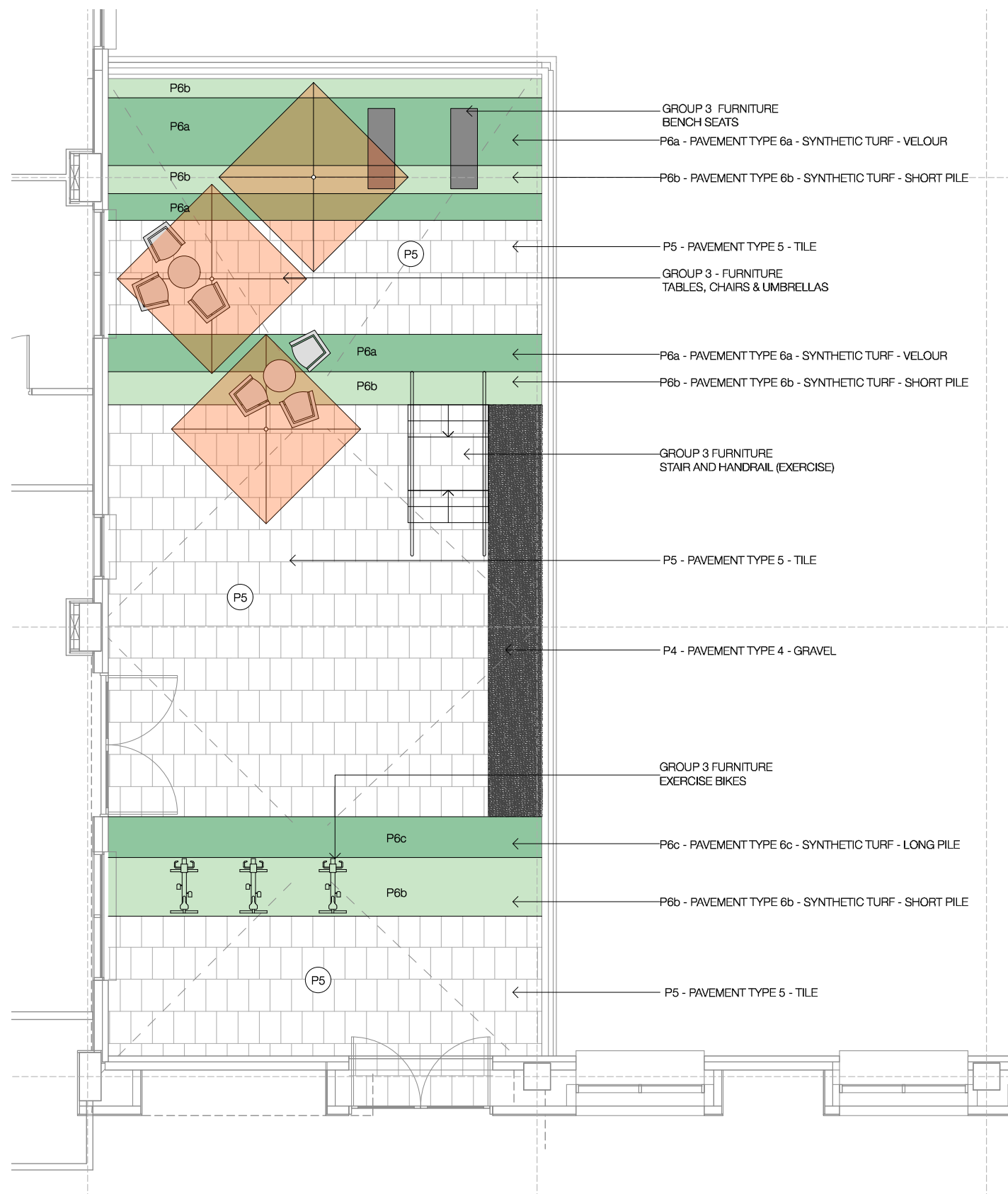

The Rehabilitation courtyard will be primarily for patient care. Offering a number of activity zones for patient rehabilitation incorporating changes in surface treatment.



scale 1:100 @ A3

## 4.0j mental health courtyard - detail plan

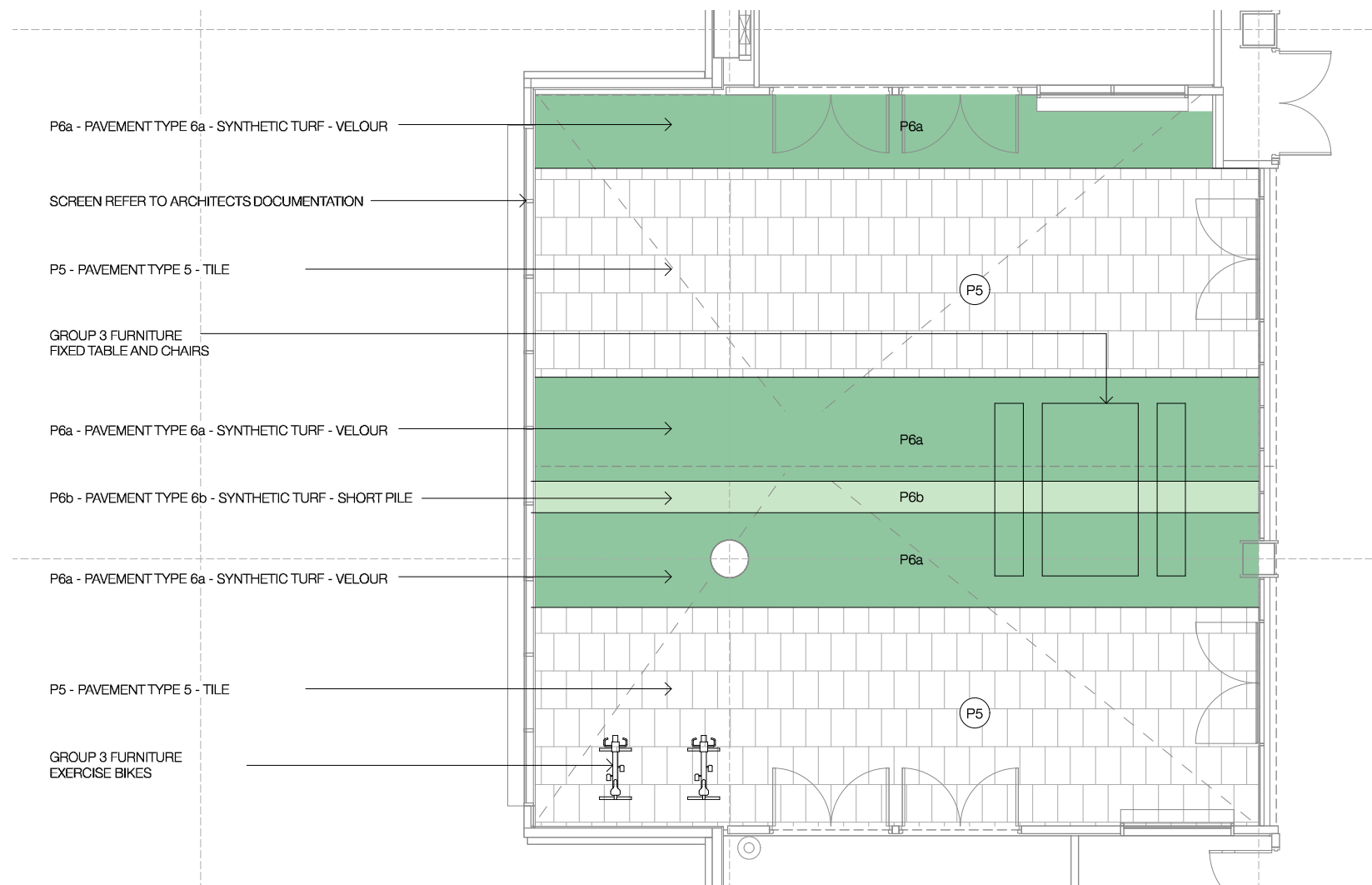

The Mental Health courtyards are designed to provide a link to a more natural setting and an outlook of greenery. The four different courtyards will each function separately with the assumption that different levels of care and supervision will be required for each courtyard. Generally, the courtyards aim to provide a home like environment with areas to relax and reflect, engage in physical activities, and provide locations for group gatherings. Although the courtyards are relatively small the opportunity to provide a green outlook with the use of synthetic turf surfaces will contribute to the greening of these spaces. Further development is required to determine the function of each courtyard and tailor the designs to patient requirements.



scale 1:100 @ A3



black beetle



## 4.1k chitter pile - detail plan

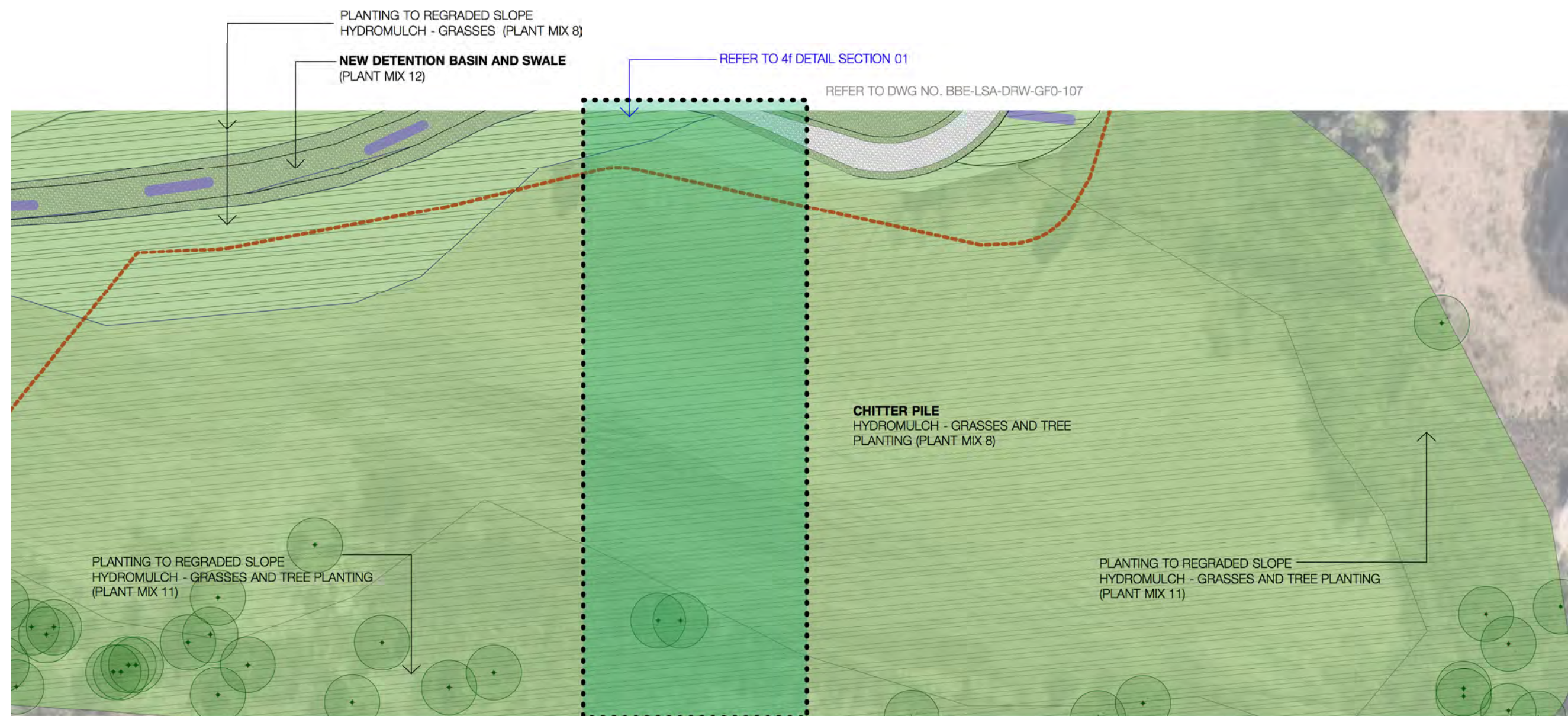

The existing chitter pile will be revegetated with grass and tree planting made up of hardy native species.



scale 1:600 @ A3



# 4.1k chitter pile - detail section 01

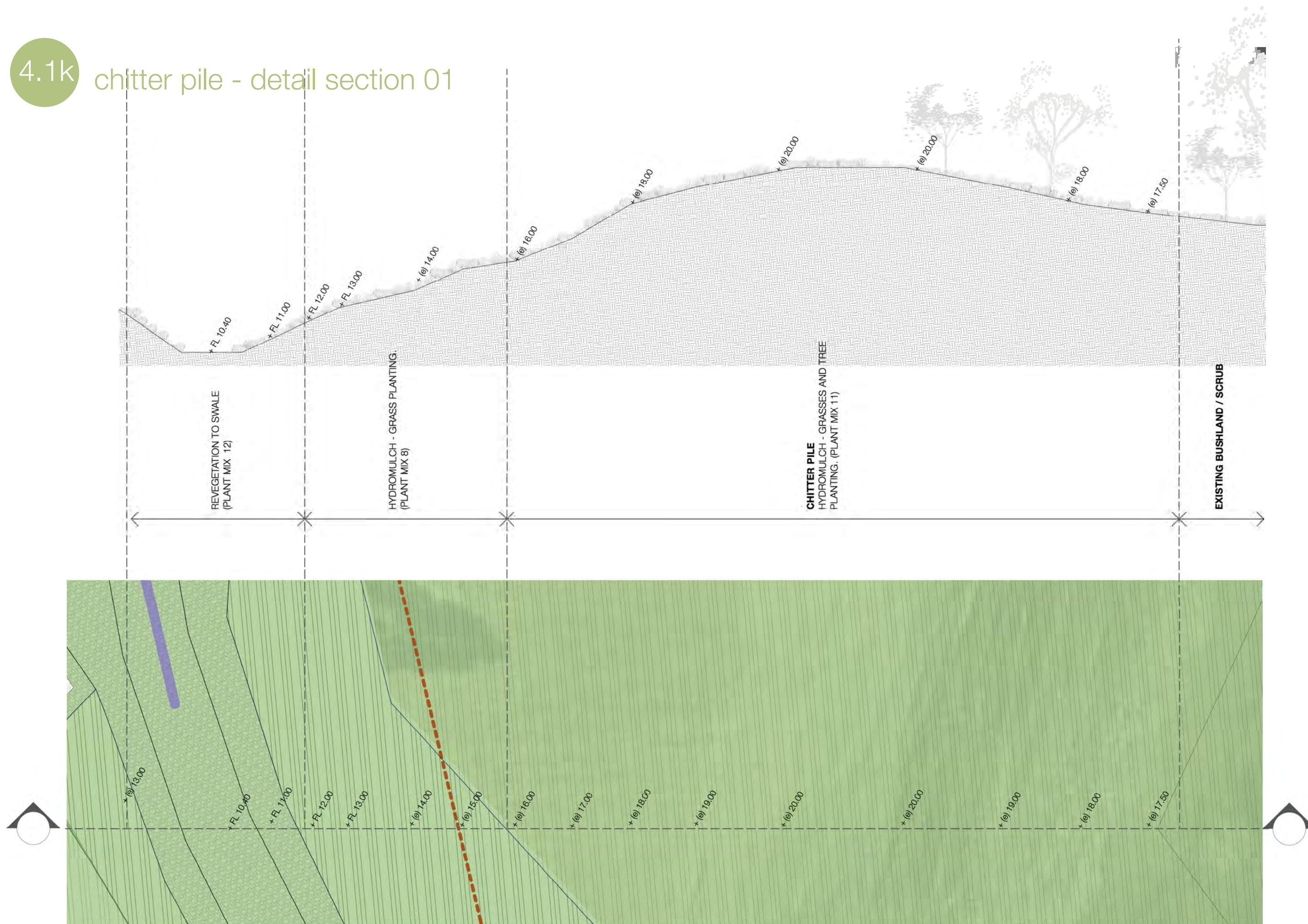

REFER TO DWG NO. BBE-LSA-DRW-GD0-105



scale 1:200 @ A3



5.0 material palette

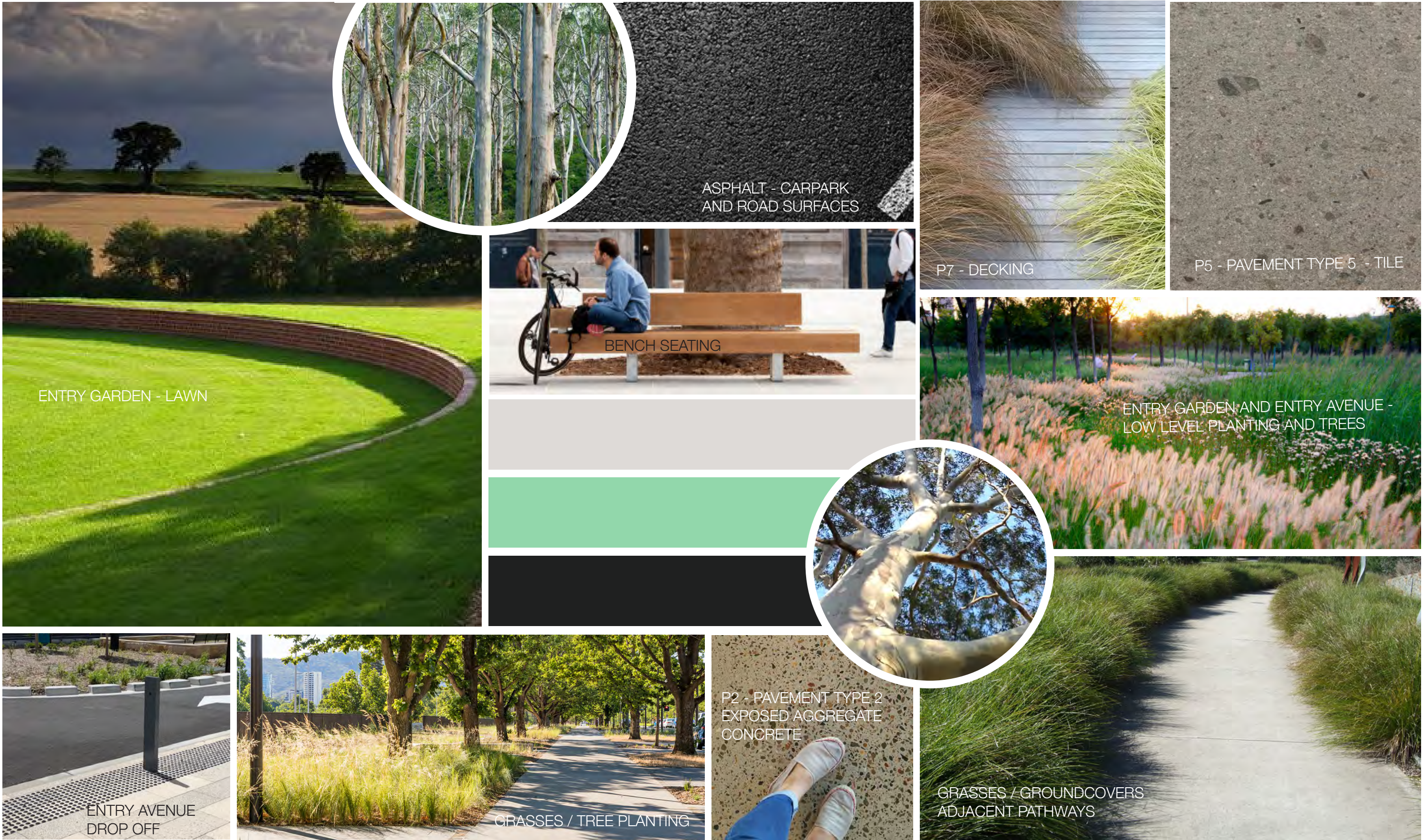



5.1 material palette

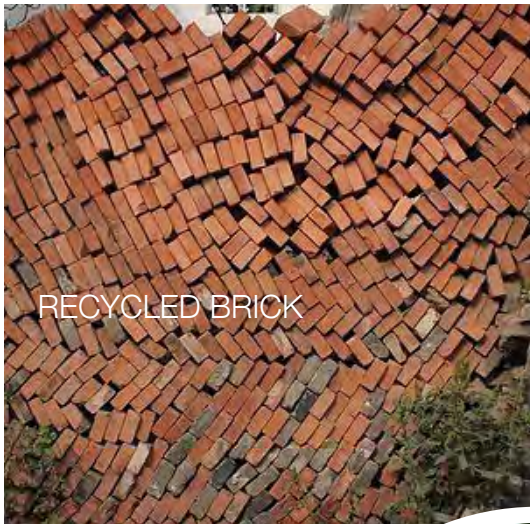
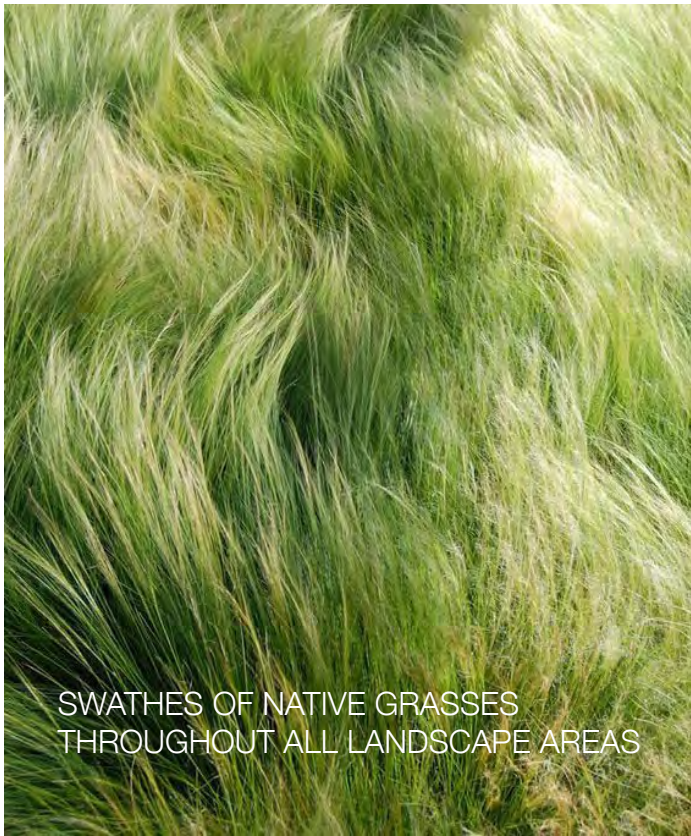



5.2 material palette

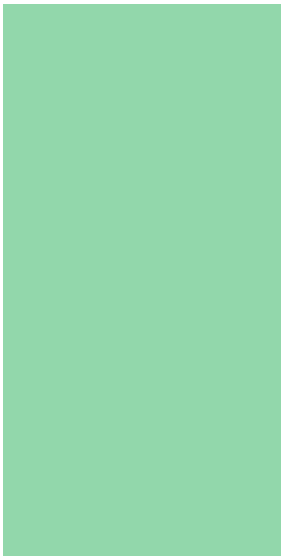
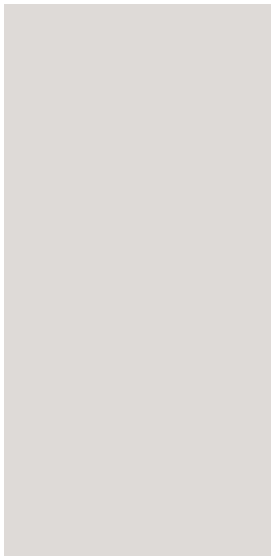
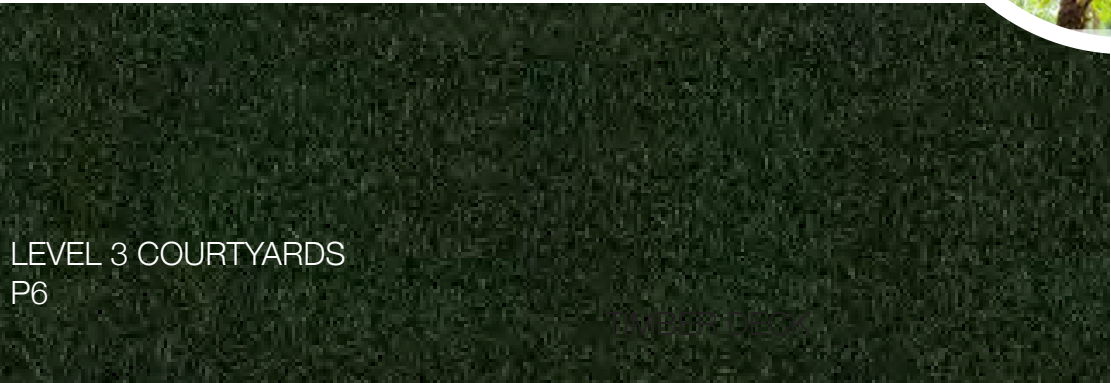



6.0

# plant palette

trees

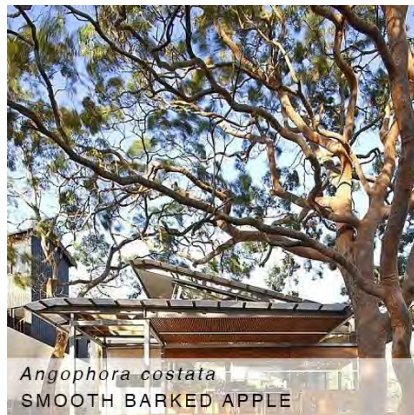

*Angophora costata*  
SMOOTH BARKED APPLE

4. 10. 11.

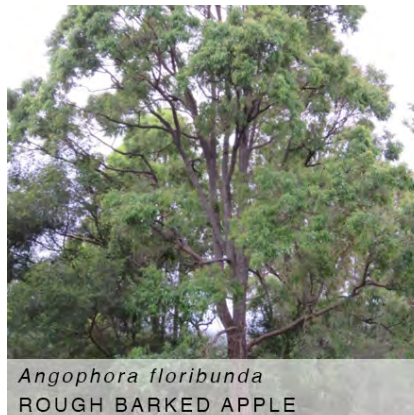

*Angophora floribunda*  
ROUGH BARKED APPLE

4. 10.



*Backhousia citriodora*  
LEMON SCENTED MYRTLE

5.



*Corymbia maculata*  
SPOTTED GUM

1. 4. 10. 11.



*Cupaniopsis anacardioides*  
TUCKEROO

3.

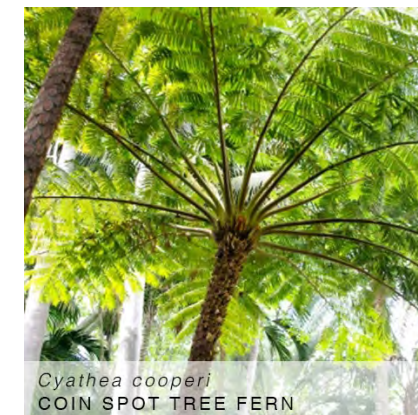

*Cyathea cooperi*  
COIN SPOT TREE FERN

13.



*Elaeocarpus reticulatus*  
BLUEBERRY ASH

5. 7.

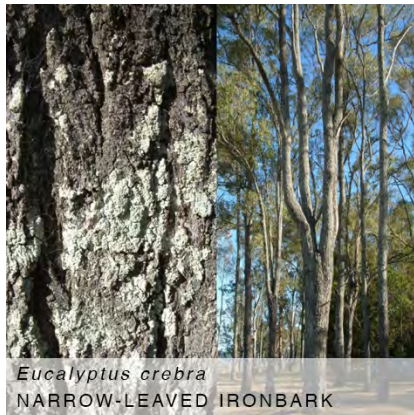

*Eucalyptus crebra*  
NARROW-LEAVED IRONBARK

10.

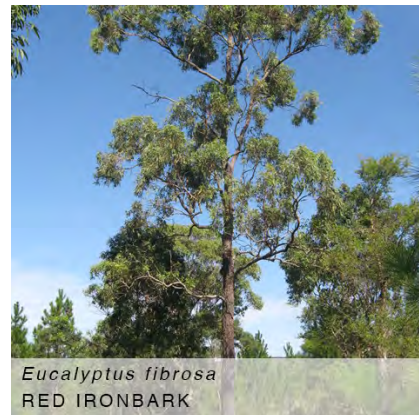

*Eucalyptus fibrosa*  
RED IRONBARK

4. 10. 11.

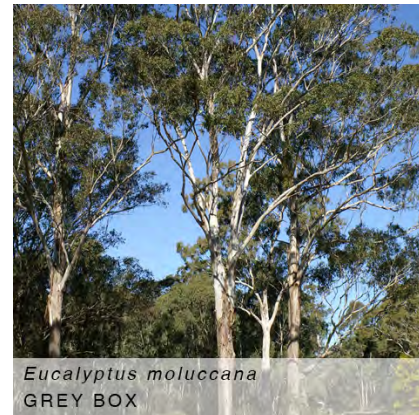

*Eucalyptus moluccana*  
GREY BOX

4. 11.

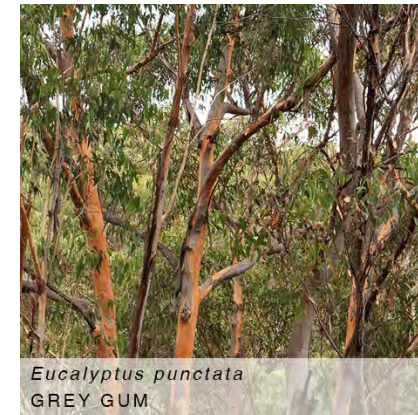

*Eucalyptus punctata*  
GREY GUM

1. 4.

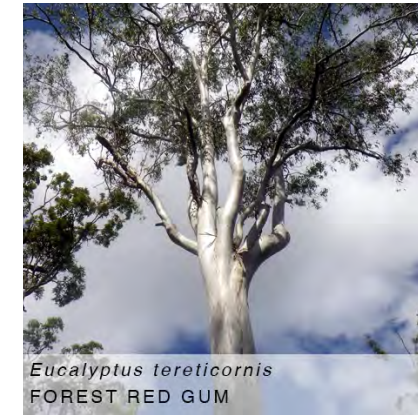

*Eucalyptus tereticornis*  
FOREST RED GUM

1. 10. 11.



*Gordonia axillaris*  
FRIED EGG PLANT

2.



*Magnolia 'Little Gem'*  
MAGNOLIA

2. 13. 14.



*Tristania laurina*  
WATER GUM

1. 3. 14.



*Waterhousea floribunda*  
Weeping Lily Pilly

1. 3.



# 6.1

## plant palette

shrubs, grasses and groundcovers



5. 7.



13.



13. 15.



7.



12.



1.

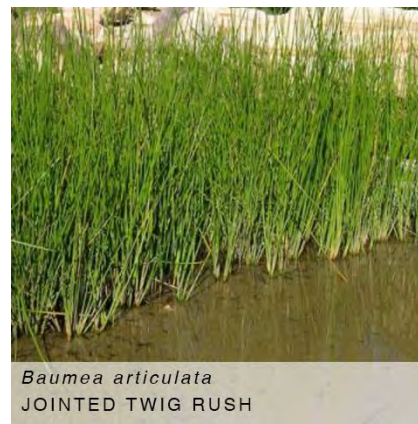

12.



2. 14.



13. 15.



10.



8. 12.



5.



14.



2.



14.



8. 11.



4. 10.



1. 2.



## 6.2

## plant palette

shrubs, grasses and groundcovers



6.



14.



4. 10. 13.



7.



2. 5. 6.



6.



5.



1.



4. 5. 10.



1.



3. 4. 5. 6.

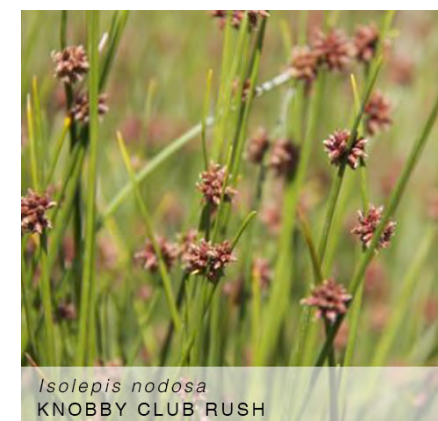

1. 2. 3. 5. 6. 7. 8.  
11. 12. 14.



3. 6. 8. 12.



14.



14.



5.



12.



10.



# 6.3

## plant palette

shrubs, grasses and groundcovers



*Liriope muscari*  
LILY TURF

13. 14.



*Lomandra longifolia*  
SPINY HEADED MAT RUSH

4. 6. 8. 10.



*Lomandra longifolia* 'Nyalla'  
NYALLA MAT RUSH

6. 8. 11.



*Lomandra multiflora* subsp. *multiflora*  
MANY FLOWERED MAT RUSH

1. 4. 5. 10. 11.



*Lomandra* 'Tanika'  
TANIKA MATT RUSH

3.



*Lomandra* 'Verday'  
VERDAY MATT RUSH

1. 2. 7. 11.



*Microlaena stipoides* var. *stipoides*  
WEEPING GRASS

4. 10.



*Myoporum parvifolium* 'Yareena'  
YAREENA CREEPING BOOBIALLA

1. 3. 5. 6.



*Pandorea jasminoides* 'Lady Di'  
LADY DI BOWER OF BEAUTY

2.



*Pelargonium australe*  
AUSTRAL STORK'S BILL

5.



*Persoonia linearis*  
NARROW-LEAVED GEEBUNG

5. 10.



*Philodendron* 'Rojo Congo'  
ROJO CONGO PHILODENDRON

15.



*Philodendron* 'Xanadu'  
XANADU

2. 13.



*Pittosporum* 'Miss Muffet'  
MISS MUFFET

2. 14.



*Poa labillardieri*  
COMMON TUSOCK

1. 3. 5. 8. 11.



*Pratia purpurascens*  
WHITEROOT

4. 6.



*Raphiolepis* 'Oriental Pearl'  
ORIENTAL PEARL

2. 14.

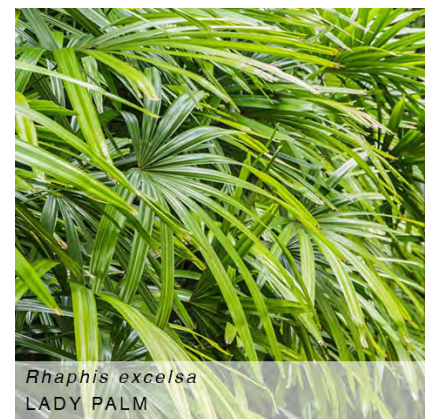

*Rhaphis excelsa*  
LADY PALM

14.



6.4

plant palette

shrubs, grasses and groundcovers



5.



2.



7.



3. 4. 5. 6. 8. 10. 11.



12.



13. 15.



5.

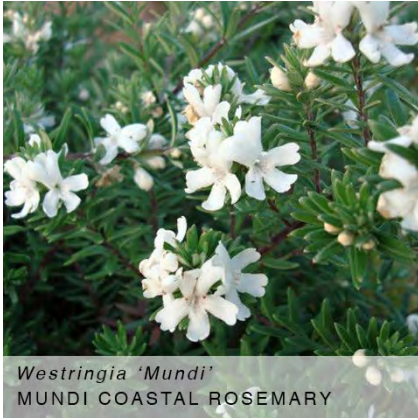

1.



7.



7.



6.5

plant schedule

BOTANICAL NAME	COMMON NAME	APPROX. HEIGHT	POT SIZE	QTY
PM1 - PLANT MIX 1		(@ MATURITY)		
TREES				
<i>Corymbia maculata</i>	Spotted Gum	20M	75L	-
<i>Eucalyptus punctata</i>	Grev Gum	35M	75L	-
<i>Eucalyptus tereticornis</i>	Forest Red Gum	50M	75L	-
<i>Tristaniopsis laurina</i>	Water Gum	8M	100L	-
<i>Waterhousia floribunda</i>	Weeping Lilv Pilv	12M	200L	-
SHRUBS, GRASSES & GROUND COVERS				
<i>Banksia spinulosa</i> 'Birthday Candles'	Banksia Birthday Candles	0.6M	150MM	4/M2
<i>Dianella tasmanica</i>	Tasman Flax Lilv	0.8M	100MM	6/M2
<i>Gazania tomentosa</i>	Treasure Flower	0.3M	100MM	6/M2
<i>Grevillea</i> 'Gold Cluster'	Gold Cluster Grevillea	0.4M	100MM	6/M2
<i>Isolepis nodosa</i>	Knobbv Club Rush	0.8M	100MM	6/M2
<i>Lomandra multiflora</i> subsp. <i>multiflora</i>	Manv Flowered Mat Rush	0.6M	100MM	7/M2
<i>Lomandra</i> 'Verdav'	Verdav Mat Rush	0.6M	100MM	7/M2
<i>Myoporum</i> 'Yareena'	Yareena Creeping Boobialla	0.2M	100MM	6/M2
<i>Poa labillarderi</i>	Tussock arass	0.8M	100MM	7/M2
<i>Westringia fruticosa</i> 'Mundi'	Groundcover Native Rosemarv	0.6M	150MM	4/M2
PM2 - PLANT MIX 2				
TREES				
<i>Gordonia axillaris</i>	Gordonia	5M	400L	-
<i>Magnolia grandiflora</i> 'Little Gem'	Little Gem Magnolia	6M	400L	-
SHRUBS, GRASSES & GROUND COVERS				
<i>Beschorneria vuccoides</i>	Mexican Lilv	1M	200MM	4/M2
<i>Cissus antarctica</i>	Kangaroo Vine	4M	200MM	4/M2
<i>Dianella tasmanica</i>	Tasman Flax Lilv	0.8M	150MM	7/M2
<i>Dorvanthes excelsa</i>	Gvmea Lilv	2M	200MM	2/M2
<i>Isolepis nodosa</i>	Knobbv Club Rush	0.8M	150MM	6/M2
<i>Lomandra</i> 'Verdav'	Verdav Mat Rush	0.6M	150MM	7/M2
<i>Pandorea laminoides</i> 'Lady Di'	Ladv Di Bower Vine	8M	200MM	4/M2
<i>Philodendron</i> 'Xanadu'	Xanadu	0.8M	200MM	4/M2
<i>Pittosporum</i> 'Miss Muffet'	Miss Muffet Pittosporum	1M	200MM	4/M2
<i>Raphiolepis indica</i> 'Oriental Pearl'	Oriental Pearl Indian Hawthorn	1M	200MM	4/M2
<i>Strelitzia reginae</i>	Bird of Paradise	1.5M	200MM	3/M2
PM3 - PLANT MIX 3				
TREES				
<i>Cupaniopsis anacardioides</i>	Tuckeroo	8M	200L	-
<i>Tristaniopsis laurina</i>	Water Gum	8M	100L	-
<i>Waterhousia floribunda</i>	Weeping Lilv Pilv	12M	200L	-
SHRUBS, GRASSES & GROUND COVERS				
<i>Imperata cylindrica</i>	Bladv Grass	0.7M	100MM	7/M2
<i>Isolepis nodosa</i>	Knobbv Club Rush	0.8M	100MM	6/M2
<i>Juncus usitatus</i>	Tussock Rush	0.6M	100MM	7/M2
<i>Lomandra longifolia</i> 'Tanika'	Tanika Mat Rush	0.6M	100MM	7/M2
<i>Myoporum</i> 'Yareena'	Yareena Creeping Boobialla	0.2M	100MM	5/M2
<i>Poa labillarderi</i>	Tussock arass	0.8M	100MM	7/M2
<i>Themeda australis</i>	Kangaroo Grass	1M	100MM	7/M2

BOTANICAL NAME	COMMON NAME	APPROX. HEIGHT	POT SIZE	QTY
PM4 - PLANT MIX 4		(@ MATURITY)		
TREES				
<i>Anacophora costata</i>	Smooth Barked Apple	15M	75L	-
<i>Anacophora floribunda</i>	Rough Barked Apple	20M	75L	-
<i>Corymbia maculata</i>	Spotted Gum	20M	75L	-
<i>Eucalyptus fibrosa</i>	Red Ironbark	30M	75L	-
<i>Eucalyptus moluccana</i>	Grev Box	25M	75L	-
<i>Eucalyptus punctata</i>	Grev Gum	35M	75L	-
SHRUBS, GRASSES & GROUND COVERS (seed)			% per AREA	KG/H
<i>Dianella revoluta</i> var. <i>revoluta</i>	Spreading Flax Lilv	1M	11	0.88
<i>Dichondra repens</i>	Kidnev Weed	0.1M	11	0.88
<i>Glycine clandestina</i>	Love Creeper	1M	11	0.88
<i>Imperata cylindrica</i>	Bladv Grass	0.7M	11	0.88
<i>Lomandra longifolia</i>	Mat Rush	1M	12	0.96
<i>Lomandra multiflora</i> subsp. <i>multiflora</i>	Manv Flowered Mat Rush	0.6M	11	0.88
<i>Microlaena stipoides</i> var. <i>stipoides</i>	Weeping Grass	0.8M	11	0.88
<i>Pratia purpurascens</i>	Whiteroot	0.1M	11	0.88
<i>Themeda australis</i>	Kangaroo Grass	1M	11	0.88
PM5 - PLANT MIX 5				
TREES				
<i>Backhousia citriodora</i>	Lemon Scented Myrtle	8M	400L	-
<i>Elaeocarpus reticulatus</i>	Blueberry Ash	8M	200L	-
SHRUBS, GRASSES & GROUND COVERS				
<i>Acmena smithii</i> 'Sublime'	Sublime Lilv Pilv	4M	300MM	2/M2
<i>Carpobrotus glaucescens</i>	Piaface	0.2M	150MM	5/M2
<i>Dorvanthes excelsa</i>	Gvmea Lilv	2M	200MM	2/M2
<i>Gardenia augusta</i> 'Florida'	Florida Gardenia	1M	200MM	4/M2
<i>Glycine clandestina</i>	Love Creeper	1M	150MM	4/M2
<i>Imperata cylindrica</i>	Bladv Grass	0.7M	150MM	7/M2
<i>Isolepis nodosa</i>	Knobbv Club Rush	0.8M	150MM	6/M2
<i>Lavandula stoechas</i> 'Avonview'	Avonview Lavender	1M	200MM	4/M2
<i>Lomandra multiflora</i> subsp. <i>multiflora</i>	Manv Flowered Mat Rush	0.6M	150MM	7/M2
<i>Myoporum</i> 'Yareena'	Yareena Creeping Boobialla	0.2M	150MM	5/M2
<i>Pelargonium australe</i>	Austral Stork's Bill	0.7M	150MM	5/M2
<i>Persoonia linearis</i>	Narrow-leaved Geebung	3M	200MM	4/M2
<i>Poa labillarderi</i>	Tussock grass	0.8M	150MM	7/M2
<i>Rosmarinus officinalis</i> 'Prostrate'	Prostrate Rosemarv	0.3M	200MM	5/M2
<i>Themeda australis</i>	Kangaroo Grass	1M	150MM	7/M2
<i>Viola odorata</i>	Sweet Violet	0.1M	150MM	7/M2
PM6 - PLANT MIX 6				
SHRUBS, GRASSES & GROUND COVERS				
<i>Dianella tamanica</i> 'Emerald Arch'	Emerald Arch Flax Lilv	0.5M	50MM tube	7/M2
<i>Dichondra repens</i>	Kidnev Weed	0.1M	50MM tube	7/M2
<i>Dorvanthes excelsa</i>	Gvmea Lilv	2M	50MM tube	7/M2
<i>Gahnia aspera</i>	Rough Saw Sedae	0.6M	50MM tube	7/M2
<i>Imperata cylindrica</i>	Bladv Grass	0.7M	50MM tube	7/M2
<i>Isolepis nodosa</i>	Knobbv Club Rush	0.8M	50MM tube	7/M2
<i>Juncus usitatus</i>	Tussock Rush	0.6M	50MM tube	7/M2
<i>Lomandra longifolia</i>	Mat Rush	1M	50MM tube	7/M2
<i>Lomandra longifolia</i> 'Nvalla'	Nvalla Mat Rush	0.9M	50MM tube	7/M2
<i>Myoporum</i> 'Yareena'	Yareena Creeping Boobialla	0.2M	50MM tube	7/M2
<i>Pratia purpurascens</i>	Whiteroot	0.1M	50MM tube	7/M2
<i>Themeda australis</i>	Kangaroo Grass	1M	50MM tube	7/M2



BOTANICAL NAME	COMMON NAME	APPROX. HEIGHT (@ MATURITY)	POT SIZE	QTY
<b>PM7 - PLANT MIX 7</b>				
<b>TREES</b>				
<i>Elaeocarpus reticulatus</i>	Blueberry Ash	8M	75L	-
<b>SHRUBS, GRASSES &amp; GROUND COVERS</b>				
<i>Acmena smithii</i> 'Sublime'	Sublime Lilly Pilliv	4M	300MM	2/m2
<i>Baeckea virgata</i>	Twiggy Heath- Myrtle	0.75M	200MM	4/m2
<i>Dodonaea triquetra</i>	Large Leaf Hop Bush	3M	200MM	2/m2
<i>Dorvanthes excelsa</i>	Gynea Lilly	2M	200MM	2/m2
<i>Isolepis nodosa</i>	Knobby Club Rush	0.8M	150MM	6/m2
<i>Lomandra 'Verdax'</i>	Verdax Mat Rush	0.6M	150MM	7/m2
<i>Syzygium australe</i> 'Select'	Select Form Lilly Pilliv	5M	300MM	2/m2
<i>Xylosma senticosum</i>	Shiny Xylosma	4M	300MM	2/m2
<i>Westringia fruticosa</i> 'Grey Box'	Groundcover Native Rosemary	0.5M	200MM	4m2
<b>PM8 - PLANT MIX 8</b>				
<b>GRASSES (seed)</b>				
			<b>% per AREA</b>	<b>KG/H</b>
<i>Carex appressa</i>	Tall Sedge	0.8M	10	0.8
<i>Dianella careulea</i>	Flax Lilly	0.6M	10	0.8
<i>Isolepis nodosa</i>	Knobby Club Rush	0.8M	15	1.2
<i>Juncus usitatus</i>	Tussock Rush	0.6M	10	0.8
<i>Lomandra longifolia</i>	Mat Rush	1M	15	1.2
<i>Lomandra longifolia</i> 'Nvalla'	Nvalla Mat Rush	0.9M	15	1.2
<i>Poa labillardieri</i>	Tussock grass	0.8M	15	1.2
<i>Themeda australis</i>	Kangaroo Grass	1M	10	0.8
<b>PM9 - PLANT MIX 9</b>				
SPOTTED GUM IRONBARK FOREST ECOLOGICAL COMMUNITY				
HUNTER LOWLAND REDGUM FOREST ECOLOGICAL COMMUNITY				
<b>PM10 - PLANT MIX 10</b>				
<b>TREES</b>				
<i>Anacophora costata</i>	Smooth Barked Apple	15M	200MM	-
<i>Anacophora floribunda</i>	Rough Barked Apple	20M	200MM	-
<i>Corymbia maculata</i>	Spotted Gum	20M	200MM	-
<i>Eucalyptus crebra</i>	Narrow Leafed Ironbark	35M	200MM	-
<i>Eucalyptus fibrosa</i>	Red Ironbark	30M	200MM	-
<i>Eucalyptus tereticornis</i>	Forest Red Gum	50M	200MM	-
<b>SHRUBS, GRASSES &amp; GROUND COVERS (seed)</b>				
			<b>% per AREA</b>	<b>KG/H</b>
<i>Brevia oblongifolia</i>	Coffee Bush	3M	8	
<i>Dichondra repens</i>	Kidney Weed	0.1M	10	0.8
<i>Dianella revoluta</i> var. <i>revoluta</i>	Spreading Flax Lilly	1M	10	0.8
<i>Glycine clandestina</i>	Love Creeper	1M	10	0.8
<i>Leucophaea juniperinus</i>	Prickly Beard-Heath	1M	8	0.64
<i>Lomandra longifolia</i>	Mat Rush	1M	12	0.96
<i>Lomandra multiflora</i> subsp. <i>multiflora</i>	Many Flowered Mat Rush	0.6M	12	0.96
<i>Microlaena stipoides</i> var. <i>stipoides</i>	Weeping Grass	0.8M	10	0.8
<i>Persoonia linearis</i>	Narrow Leafed Geebung	3M	8	0.64
<i>Themeda australis</i>	Kangaroo Grass	1M	12	0.96

BOTANICAL NAME	COMMON NAME	APPROX. HEIGHT (@ MATURITY)	POT SIZE	QTY
<b>PM11 - PLANT MIX 11</b>				
<b>TREES</b>				
<i>Anacophora costata</i>	Smooth Barked Apple	15M	200MM	-
<i>Corymbia maculata</i>	Spotted Gum	20M	200MM	-
<i>Eucalyptus fibrosa</i>	Red Ironbark	30M	200MM	-
<i>Eucalyptus moluccana</i>	Grey Box	25M	200MM	-
<i>Eucalyptus tereticornis</i>	Forest Red Gum	50M	200MM	-
<b>GRASSES (seed)</b>				
			<b>% per AREA</b>	<b>KG/H</b>
<i>Dianella careulea</i>	Flax Lilly	0.6M	15	1.2
<i>Isolepis nodosa</i>	Knobby Club Rush	0.8M	15	1.2
<i>Lomandra longifolia</i> 'Nvalla'	Nvalla Mat Rush	0.9M	15	1.2
<i>Lomandra multiflora</i> subsp. <i>multiflora</i>	Many Flowered Mat Rush	0.6M	15	1.2
<i>Lomandra 'Verdax'</i>	Verdax Mat Rush	0.6M	15	1.2
<i>Poa labillardieri</i>	Tussock grass	0.8M	10	0.8
<i>Themeda australis</i>	Kangaroo Grass	1M	15	1.2
<b>PM12 - PLANT MIX 12</b>				
<b>SHRUBS, GRASSES &amp; GROUND COVERS</b>				
<i>Balioskion tetraphyllum</i>	Tassel Cord Rush	1.2M	100MM tube	7/M2
<i>Baumea articulata</i>	Jointed Twig Rush	2M	100MM tube	7/M2
<i>Carex appressa</i>	Tall Sedge	0.8M	100MM tube	7/M2
<i>Isolepis nodosa</i>	Knobby Club Rush	0.8M	100MM tube	7/M2
<i>Juncus usitatus</i>	Tussock Rush	0.6M	100MM tube	7/M2
<i>Lepironia articulata</i> 'Twizzler'	Twizzler	1.3M	100MM tube	7/M2
<i>Typha orientalis</i>	Broadleaf Cumbungi	4M	100MM tube	7/M2
<b>PM13 - PLANT MIX 13</b>				
<b>TREES</b>				
<i>Cyathea australis</i>	Coin Spot Tree Fern	10M	45L	-
<i>Magnolia grandiflora</i> 'Little Gem'	Little Gem Magnolia	6M	200L	-
<b>SHRUBS, GRASSES &amp; GROUND COVERS</b>				
<i>Aspidistra elatior</i>	Cast Iron Plant	0.8M	200MM	4/M2
<i>Asplenium nidus</i> 'Osaka'	Birds Nest Fern	0.8M	200MM	5/M2
<i>Blechnum nudum</i> 'Silver Lady'	Fishbone Fern	0.6M	200MM	5/M2
<i>Dichondra repens</i>	Kidney Weed	0.1M	150MM	7/M2
<i>Liriope 'Evergreen Giant'</i>	Lily Turf	0.5M	150MM	6/M2
<i>Philodendron 'Conqo'</i>	Conqo Philodendron	0.8M	200MM	4/M2
<i>Philodendron 'Xanadu'</i>	Xanadu	0.8M	200MM	4/M2
<i>Viola hederacea</i>	Native Violet	0.2M	100MM	7/M2



6.7

plant schedule

BOTANICAL NAME	COMMON NAME	APPROX. HEIGHT	POT SIZE	QTY
PM14 - PLANT MIX 14		(@ MATURITY)		
TREES				
<i>Magnolia grandiflora</i> 'Little Gem'	Little Gem Magnolia	6M	200L	-
<i>Tristaniaopsis laurina</i>	Water Gum	8M	200L	-
SHRUBS, GRASSES & GROUND COVERS				
<i>Beschomeria vuccoides</i>	Mexican Lily	1M	200MM	4/M24/M2
<i>Chrysoccephalum apiculatum</i>	Yellow Buttons	0.3M	150MM	7/M2
<i>Crassula ovata</i>	Jade Plant	1M	200MM	4/M24/M2
<i>Dichondra argentea</i> 'Silver Falls'	Silver Falls Kidney Weed	0.1M	150MM	7/M2
<i>Isolepis nodosa</i>	Knobby Club Rush	0.8M	150MM	6/M2
<i>Kalanchoe</i> 'Copper Spoons'	Copper Spoons	1M	200MM	4/M2
<i>Kalanchoe tomentosa</i>	Panda Plant	0.5M	200MM	4/M2
<i>Liriope</i> 'Evergreen Giant'	Lily Turf	0.5M	150MM	4/M2
<i>Pittosporum</i> 'Miss Muffet'	Miss Muffet Pittosporum	1M	200MM	4/M2
<i>Raphiolepis indica</i> 'Oriental Pearl'	Oriental Pearl Indian Hawthorn	1M	200MM	4/M2
PM15 - PLANT MIX 15				
SHRUBS, GRASSES & GROUND COVERS				
<i>Asplenium nidus</i> 'Osaka'	Birds Nest Fern	0.8M	200MM	5/M2
<i>Blechnum nudum</i> 'Silver Lady'	Fishbone Fern	0.6M	200MM	5/M2
<i>Rhapis excelsa</i>	Lady Palm	2M	300MM	4/M24/M2
<i>Viola hederacea</i>	Native Violet	0.2M	100MM	7/M24/M2



## 7.0 contact details

Black Beetle Pty Ltd  
Level 01, 1073 Pittwater Road  
Collaroy NSW 2097  
[www.blackbeetle.com.au](http://www.blackbeetle.com.au)  
e: [blackbeetle@blackbeetle.com.au](mailto:blackbeetle@blackbeetle.com.au)

Ilia Kokalevski  
ph: 0422104416  
e: [ilia@blackbeetle.com.au](mailto:ilia@blackbeetle.com.au)

Giselle Barron  
ph: 0418270382  
e: [giselle@blackbeetle.com.au](mailto:giselle@blackbeetle.com.au)



## 8.0 appendix a - stage 2 state significant infrastructure application - landsape plans