



Level 1/11 Montgomery St, Kogarah NSW 2217  
1300 554 675 | info@geosurv.com.au

FORD CIVIL

DETAIL AND SUBSURFACE UTILITY  
INVESTIGATION SURVEY  
Commercial Road,  
Rouse Hill

TYPICAL SUI LEGEND

GAS		G
COMMUNICATION		C
DRAINAGE		D
UNIDENTIFIED PIPELINE		U
ELECTRICAL		E
WATER		W
SEWER		S
SUBJECT BOUNDARY		
ADJOINING BOUNDARIES		
CONTOUR MINOR		0.25
CONTOUR MAJOR		1.00
DIRECT BURIED		DB
UNABLE TO TRACE		UTT
END OF SERVICE (EOS)		I
END OF TRACE (EOT)		J
SERVICE CODE		TD
"IL" INVERT LEVEL "TC" TOP CENTRE RL		IL2.00
"UNK" SERVICE DEPTH & QUALITY UNKNOWN		[3.00]A
DIAMETER		Ø0.1

DRAWING TITLE

SUI & DETAIL  
SURVEY PLAN

REV.	DESCRIPTION	DATE
A	Survey for Issue	29.07.25
B	Prev. Survey LVLs added	27.08.25
-	-	-
-	-	-
-	-	-

QUALITY ASSURANCE

Surveyor	Kye Murray	Date of Survey	24.07.25
Checked by	Amanda Santos	Date	27.08.25
Approved by	Jordan Palleson	Date	27.08.25
Drafter	Adam Cameron	Date of Plan	27.08.25

The successful completion of quality assurance confirms that the survey work and drawings comply with the requirements outlined in the Quality Plan with special reference to fully completed and approved work. All information contained in these drawings should be considered preliminary and uncheckered.

Datum Origin	SS141886	RL 51.065	Coordinates	MGA2020 256
Sheet Size A1 @ Scale	(AHD71)			1:750

GRAPHIC SCALE:  
1:750

Type of Survey	SUI & DETAIL SURVEY PLAN	Sheet	Page 1 of 31
Job Number	ASP250432-DET-01[B]	Current Revision	B

This document, whether in electronic or hardcopy form, is confidential and remains the property of geosurv. It must not be reproduced or used for any other project without written approval from geosurv.

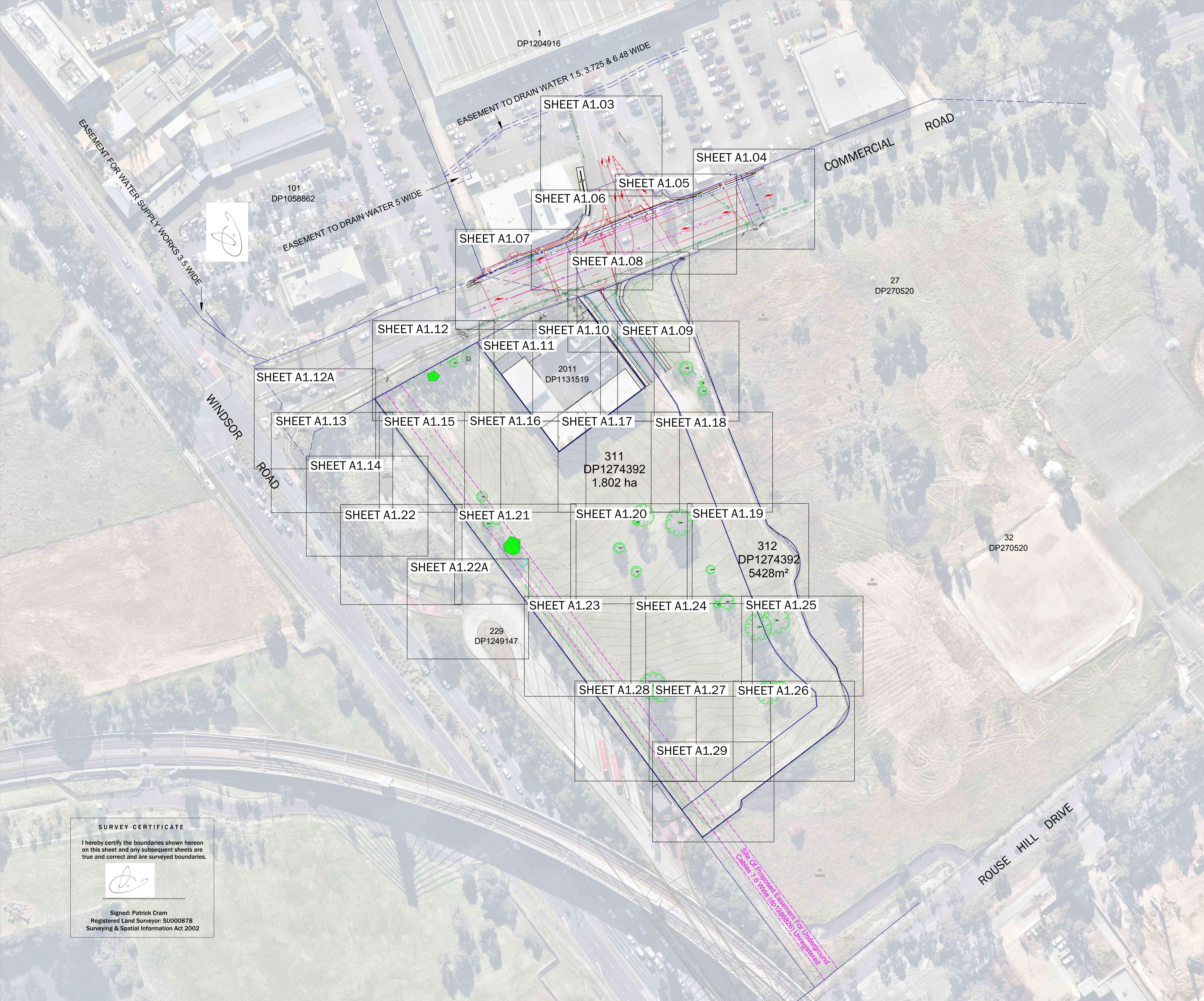

SURVEY CERTIFICATE

I hereby certify the boundaries shown hereon on this sheet and any subsequent sheets are true and correct and are surveyed boundaries.

Signed: Patrick Cram  
Registered Land Surveyor: SU000878  
Surveying & Spatial Information Act 2002

# SURVEY NOTES

## LOCATING QUALITY LEVEL DESCRIPTION

This information helps users understand how data was collected, allowing for appropriate reliance and effective management of project risks related to underground utilities.

### Quality Level A (QLA):

Direct visual confirmation of service, position, and depth. Recommended before construction or excavation.

### Quality Level B (QLB):

Locates services using radio detection with an accuracy range of 300mm for position and 500mm for depth.

### Quality Level C (QLC):

Infers service lines from surface features like hydrants and gas markers, without specific indications of location or depth.

### Quality Level D (QLD):

Services digitized solely from BYDA plans; plan offsets provide rough service indications, but no confirmation of service presence.

## GEOSURV DISCLAIMER:

No boundary survey conducted. Further surveys are recommended for any construction near boundaries or to meet local government requirements. Boundary information is derived from official property plans.

Tree spreads, trunk radii, and heights are approximate and diagrammatic; specific details should be requested if critical to design.

Contours are indicative with 0.25 intervals; spot levels are preferred for accuracy. Refer to digital model for 3d DTM and feature survey.

The plan describes subterranean features based on field techniques and data from utility authorities.

While care has been taken in preparing this survey plan, GeoSurv cannot guarantee its flawlessness and disclaims liability for any errors, omissions, or consequences arising from reliance on this plan. Users are encouraged to verify subterranean feature locations through vacuum excavation techniques.

For additional details, refer to the locate report or CCTV footage.

## WARNING REGARDING SERVICES

This plan displays only those service locations identified by GeoSurv based on ground markings and visible evidence. The services shown are indicative of the underground positions.

Underground services were located according to Class B standards, with depths measured electronically. Pipe sizes and duct configurations are derived from "Before You Dig Australia" (BYDA).

Details and positions of services, including duct sizes and configurations, must be confirmed with relevant authorities and BYDA before design and construction activities.

The represented service routes are diagrammatic and approximate, subject to verification by exposing the service lines.

The survey was conducted using information from BYDA and visible surface evidence. Some companies with underground assets are not part of D.B.Y.D., and their services are not located in this survey.

GeoSurv does not guarantee that all services have been identified. Some underground services may not be locatable by electronic means or visible on site.

It is recommended to perform pot-holing to confirm service locations where potential conflicts with construction or design may occur. Caution is advised during excavation where utilities might be present.



# STANDARD FEATURE NAMES FOR SURVEY AND SUI (RMS LEGEND)

E BDGE (BRIDGE STRUCTURES)	E COMM (COMMUNICATIONS)	E CULT (CULTURAL) Continued	E DRAIN (STORMWATER) Continued	E ELEC	E HERI (HERITAGE)			
<ul style="list-style-type: none"> <li>ABUTMENT BOTTOM (AB)</li> <li>ABUTMENT BOTTOM POINT (PAB)</li> <li>ABUTMENT TOP (AT)</li> <li>ABUTMENT TOP POINT (PAT)</li> <li>CRIP-PILE (PCP)</li> <li>DECK (DC)</li> <li>EXPANSION JOINT (EJ)</li> <li>EXPANSION PLATE (EP)</li> <li>HEADSTOCK (HS)</li> <li>PIER COLLAR (BC)</li> <li>PIER COLLAR POINT (PBC)</li> <li>UNDERNEATH CLEARANCE (UC)</li> <li>WING WALL (WW)</li> </ul>	<ul style="list-style-type: none"> <li>ABOVE GROUND JOINING POST (P1JP)</li> <li>ITS CABLE (IT)</li> <li>OPTICAL FIBRE - ABOVE GROUND (OAG)</li> <li>OPTICAL FIBRE - DIGITISED (OD)</li> <li>OPTICAL FIBRE - UNDERGROUND (OU)</li> <li>OPTICAL FIBRE CABLE MARKER (PFCM)</li> <li>OPTICAL FIBRE COORDINATE (OC)</li> <li>OPTICAL FIBRE JUNCTION BOX (PFCJ)</li> <li>OPTICAL FIBRE PIT (PFCP)</li> <li>STD 1.1m BY 1.1m MAN PIT (P1MP)</li> <li>TELEPHONE - HOUSE CONNECTION (TY)</li> <li>TELEPHONE BOX (P1TB)</li> <li>TELEPHONE CABLE MARKER (P1TCM)</li> <li>TELEPHONE DISTRIBUTION PILLAR (P1TCP)</li> <li>TELEPHONE CONDUIT (T)</li> <li>TELEPHONE LINE (TL)</li> <li>TELEPHONE POLE (P1TL)</li> <li>TELEPHONE SINGLE CONCRETE PIT (P1SP)</li> <li>TELEPHONE SLUMP (TS)</li> <li>TELEPHONE TRANSMITTER - MOBILE (P1TMP)</li> <li>TELEPHONE TRIPLE CONCRETE PIT (P1TCP)</li> <li>TELEPHONE TWIN CONCRETE PIT (P1TCP)</li> </ul>	<ul style="list-style-type: none"> <li>LARGE SIGN (LS)</li> <li>MALIBOX (PMB)</li> <li>PARKING METER (PMB)</li> <li>PEDESTRIAN FENCE-RAIL (PF)</li> <li>PICNIC TABLE (PT)</li> <li>PUMP (PWP)</li> <li>RUBBER BIN (P1RB)</li> <li>SEAT (S)</li> <li>SIGN (PSN)</li> <li>SIGN - DOUBLE SIDED (P1SD)</li> <li>SIGN WITH OUTREACH (S)</li> <li>WINDMILL (W)</li> <li>WINDMILL - POINT (P1WM)</li> </ul>	<ul style="list-style-type: none"> <li>HEADWALL BOTTOM (H)</li> <li>HEADWALL BOTTOM POINT (P1HW)</li> <li>HEADWALL TOP (HT)</li> <li>HEADWALL TOP POINT (P1HT)</li> <li>INLET TO SLUMP (P1SL)</li> <li>INVERT - 225 DA (P1I225)</li> <li>INVERT - 300 DA (P1I300)</li> <li>INVERT - 375 DA (P1I375)</li> <li>INVERT - 450 DA (P1I450)</li> <li>INVERT - 525 DA (P1I525)</li> <li>INVERT - 600 DA (P1I600)</li> <li>INVERT - 750 DA (P1I750)</li> <li>INVERT - 1000 DA (P1I1000)</li> <li>INVERT - 1200 DA (P1I1200)</li> <li>INVERT - 1500 DA (P1I1500)</li> <li>INVERT - 1800 DA (P1I1800)</li> <li>INVERT OF PIPE (P1IP)</li> <li>INVERT OF SUBSOIL DRAIN OUTLET (P1ISDO)</li> <li>KEIRB INLET (KI)</li> <li>OVERFLOW OF PIPE (P1OP)</li> <li>PIPE - 225 DA (P1I225)</li> <li>PIPE - 300 DA (P1I300)</li> <li>PIPE - 375 DA (P1I375)</li> <li>PIPE - 450 DA (P1I450)</li> <li>PIPE - 525 DA (P1I525)</li> <li>PIPE - 600 DA (P1I600)</li> <li>PIPE - 750 DA (P1I750)</li> <li>PIPE - 1000 DA (P1I1000)</li> <li>PIPE - 1200 DA (P1I1200)</li> <li>PIPE - 1500 DA (P1I1500)</li> <li>PIPE - 1800 DA (P1I1800)</li> <li>PIPE - UNSPECIFIED DIAMETER (P1I)</li> <li>SUBSOIL DRAIN FLUSH POINT (P1SDFP)</li> <li>TOP OF CONCRETE JUNCTION BOX (P1TCJ)</li> <li>WATER COURSE (WC)</li> <li>WATER LEVEL POINT (P1WL)</li> </ul>	<ul style="list-style-type: none"> <li>CABLE JUNCTION BOX (P1CB)</li> <li>CABLE MANHOLE (P1CM)</li> <li>CABLE MARKER (P1CA)</li> <li>CONDUIT (C)</li> <li>DISTRIBUTION FUSE POINT (P1DFP)</li> <li>HIGH TENSION P1LON (P1HT)</li> <li>HOUSE CONNECTION (H)</li> <li>GARDEN LIGHT (P1GL)</li> <li>LIGHT WITH OUTREACH (L)</li> <li>LINE - DIGITISED (L)</li> <li>LINE - MAJOR TRANSMISSION (L)</li> <li>LINE - MINOR TRANSMISSION (L)</li> <li>LINE - UNDERGROUND (L)</li> <li>MAN SLUMP (M)</li> <li>POLE - LIGHT (P1PL)</li> <li>POLE - POWER (P1PP)</li> <li>POLE - POWER AND LIGHT (P1PLP)</li> <li>POLE - POWER AND TRANSFORMER (P1PTP)</li> <li>POWER SERVICE PILLAR - UNDERGROUND (P1PSP)</li> <li>P1LON LEG (L)</li> <li>STAY ANCHOR POLE (P1SAP)</li> <li>STAY POLE (P1SP)</li> <li>SUSPENDED LIGHT (P1SL)</li> <li>TRANSFORMER CABINET (C)</li> <li>TRANSFORMER CABINET CENTRE (P1TCC)</li> <li>HORIZONTAL CONTROL POINT (P1HCP)</li> <li>MINOR CONTROL POINT (P1MCP)</li> <li>PHOTO CENTRE (P1PC)</li> <li>VERTICAL CONTROL POINT (P1VCP)</li> <li>HOUSE CONNECTION (H)</li> <li>MAN - DIGITISED (M)</li> <li>MAN - LOW PRESSURE (L)</li> <li>MAN - NYLON (M)</li> <li>MAN - POLYETHYLENE (M)</li> <li>MANHOLE COVER (P1MC)</li> <li>METER (P1M)</li> <li>PIPELINE - ETHANE (M)</li> <li>PIPELINE - HIGH PRESSURE (M)</li> <li>PIPELINE MARKER (P1MP)</li> <li>PIPELINE MARKER - HIGH PRESSURE (P1MHP)</li> <li>REGULATOR BOX (P1RB)</li> <li>TEST POINT (P1TP)</li> <li>VALVE BOX (P1VB)</li> <li>VENT PIPE (P1VP)</li> </ul>	<ul style="list-style-type: none"> <li>ENDANGERED COMMUNITY (P1EC)</li> <li>ENDANGERED ECOLOGICAL COMMUNITY (P1EC)</li> <li>HAZARDOUS SITE (P1HS)</li> <li>INDIGENOUS HERITAGE AREA (P1IA)</li> <li>NON INDIGENOUS HERITAGE SITE (P1NIS)</li> <li>(0.2, 5, 5) TREE (TRUNK &amp; SPREAD, HEIGHT)</li> </ul>			
<ul style="list-style-type: none"> <li>DIGITAL CANTHRE (ACCURACY 1.0m) (DM)</li> <li>DISTURBING EXTENT (P1DTE)</li> <li>DP OVERLAY (ACCURACY 0.1m) (DPO)</li> <li>EASEMENT (E)</li> <li>FIELD COMPLETION BOUNDARY (P1FCB)</li> <li>FIELD SURVEY EXTENT (P1FSE)</li> <li>LOCAL GOVERNMENT (LG)</li> <li>P1RISH (P1R)</li> <li>TITLE (ACCURACY 0.25m) (T)</li> </ul>	<ul style="list-style-type: none"> <li>CONTOUR - ALX (DECIMETRES) (C)</li> <li>CONTOUR - ALX (METRES) (C)</li> <li>CONTOUR - NOISE (C)</li> <li>CONTOUR - INTER DEPRESSION (C)</li> <li>CONTOUR - INTER DEPRESSION (C)</li> <li>CONTOUR - STANDARD WATER (C)</li> </ul>	<ul style="list-style-type: none"> <li>BIN - LARGE (B)</li> <li>BOLLARD (B)</li> <li>BUS SHELTER (BS)</li> <li>BUS STOP (P1BS)</li> <li>FENCE (F)</li> <li>FENCE LINE (L)</li> <li>FENCE MANHOLE (F1M)</li> <li>FENCE OTHER (F)</li> <li>FENCE POST GUIDE POST (P1FPG)</li> <li>FRIDGE (F)</li> <li>FLAG POLE (P1FL)</li> <li>GATE (G)</li> <li>HEADSTONE (P1HS)</li> <li>HISTORICAL POINT OF INTEREST (P1HPI)</li> </ul>	<ul style="list-style-type: none"> <li>BOX GLAUVERT - 1000 HIGH (B)</li> <li>BOX GLAUVERT - 1200 HIGH (B)</li> <li>BOX GLAUVERT - 1500 HIGH (B)</li> <li>BOX GLAUVERT - 1800 HIGH (B)</li> <li>BOX GLAUVERT - 2100 HIGH (B)</li> <li>BOX GLAUVERT - 2400 HIGH (B)</li> <li>BOX GLAUVERT - 2700 HIGH (B)</li> <li>BOX GLAUVERT - 3000 HIGH (B)</li> <li>BOX GLAUVERT - 3300 HIGH (B)</li> <li>BOX GLAUVERT - 3600 HIGH (B)</li> <li>BOX GLAUVERT - 3900 HIGH (B)</li> <li>BOX GLAUVERT - 4200 HIGH (B)</li> <li>BOX GLAUVERT - 4500 HIGH (B)</li> <li>BOX GLAUVERT - 4800 HIGH (B)</li> <li>BOX GLAUVERT - 5100 HIGH (B)</li> <li>BOX GLAUVERT - 5400 HIGH (B)</li> <li>BOX GLAUVERT - 5700 HIGH (B)</li> <li>BOX GLAUVERT - 6000 HIGH (B)</li> <li>BOX GLAUVERT - 6300 HIGH (B)</li> <li>BOX GLAUVERT - 6600 HIGH (B)</li> <li>BOX GLAUVERT - 6900 HIGH (B)</li> <li>BOX GLAUVERT - 7200 HIGH (B)</li> <li>BOX GLAUVERT - 7500 HIGH (B)</li> <li>BOX GLAUVERT - 7800 HIGH (B)</li> <li>BOX GLAUVERT - 8100 HIGH (B)</li> <li>BOX GLAUVERT - 8400 HIGH (B)</li> <li>BOX GLAUVERT - 8700 HIGH (B)</li> <li>BOX GLAUVERT - 9000 HIGH (B)</li> <li>BOX GLAUVERT - 9300 HIGH (B)</li> <li>BOX GLAUVERT - 9600 HIGH (B)</li> <li>BOX GLAUVERT - 9900 HIGH (B)</li> <li>BOX GLAUVERT - 10200 HIGH (B)</li> <li>BOX GLAUVERT - 10500 HIGH (B)</li> <li>BOX GLAUVERT - 10800 HIGH (B)</li> <li>BOX GLAUVERT - 11100 HIGH (B)</li> <li>BOX GLAUVERT - 11400 HIGH (B)</li> <li>BOX GLAUVERT - 11700 HIGH (B)</li> <li>BOX GLAUVERT - 12000 HIGH (B)</li> <li>BOX GLAUVERT - 12300 HIGH (B)</li> <li>BOX GLAUVERT - 12600 HIGH (B)</li> <li>BOX GLAUVERT - 12900 HIGH (B)</li> <li>BOX GLAUVERT - 13200 HIGH (B)</li> <li>BOX GLAUVERT - 13500 HIGH (B)</li> <li>BOX GLAUVERT - 13800 HIGH (B)</li> <li>BOX GLAUVERT - 14100 HIGH (B)</li> <li>BOX GLAUVERT - 14400 HIGH (B)</li> <li>BOX GLAUVERT - 14700 HIGH (B)</li> <li>BOX GLAUVERT - 15000 HIGH (B)</li> <li>BOX GLAUVERT - 15300 HIGH (B)</li> <li>BOX GLAUVERT - 15600 HIGH (B)</li> <li>BOX GLAUVERT - 15900 HIGH (B)</li> <li>BOX GLAUVERT - 16200 HIGH (B)</li> <li>BOX GLAUVERT - 16500 HIGH (B)</li> <li>BOX GLAUVERT - 16800 HIGH (B)</li> <li>BOX GLAUVERT - 17100 HIGH (B)</li> <li>BOX GLAUVERT - 17400 HIGH (B)</li> <li>BOX GLAUVERT - 17700 HIGH (B)</li> <li>BOX GLAUVERT - 18000 HIGH (B)</li> <li>BOX GLAUVERT - 18300 HIGH (B)</li> <li>BOX GLAUVERT - 18600 HIGH (B)</li> <li>BOX GLAUVERT - 18900 HIGH (B)</li> <li>BOX GLAUVERT - 19200 HIGH (B)</li> <li>BOX GLAUVERT - 19500 HIGH (B)</li> <li>BOX GLAUVERT - 19800 HIGH (B)</li> <li>BOX GLAUVERT - 20100 HIGH (B)</li> <li>BOX GLAUVERT - 20400 HIGH (B)</li> <li>BOX GLAUVERT - 20700 HIGH (B)</li> <li>BOX GLAUVERT - 21000 HIGH (B)</li> <li>BOX GLAUVERT - 21300 HIGH (B)</li> <li>BOX GLAUVERT - 21600 HIGH (B)</li> <li>BOX GLAUVERT - 21900 HIGH (B)</li> <li>BOX GLAUVERT - 22200 HIGH (B)</li> <li>BOX GLAUVERT - 22500 HIGH (B)</li> <li>BOX GLAUVERT - 22800 HIGH (B)</li> <li>BOX GLAUVERT - 23100 HIGH (B)</li> <li>BOX GLAUVERT - 23400 HIGH (B)</li> <li>BOX GLAUVERT - 23700 HIGH (B)</li> <li>BOX GLAUVERT - 24000 HIGH (B)</li> <li>BOX GLAUVERT - 24300 HIGH (B)</li> <li>BOX GLAUVERT - 24600 HIGH (B)</li> <li>BOX GLAUVERT - 24900 HIGH (B)</li> <li>BOX GLAUVERT - 25200 HIGH (B)</li> <li>BOX GLAUVERT - 25500 HIGH (B)</li> <li>BOX GLAUVERT - 25800 HIGH (B)</li> <li>BOX GLAUVERT - 26100 HIGH (B)</li> <li>BOX GLAUVERT - 26400 HIGH (B)</li> <li>BOX GLAUVERT - 26700 HIGH (B)</li> <li>BOX GLAUVERT - 27000 HIGH (B)</li> <li>BOX GLAUVERT - 27300 HIGH (B)</li> <li>BOX GLAUVERT - 27600 HIGH (B)</li> <li>BOX GLAUVERT - 27900 HIGH (B)</li> <li>BOX GLAUVERT - 28200 HIGH (B)</li> <li>BOX GLAUVERT - 28500 HIGH (B)</li> <li>BOX GLAUVERT - 28800 HIGH (B)</li> <li>BOX GLAUVERT - 29100 HIGH (B)</li> <li>BOX GLAUVERT - 29400 HIGH (B)</li> <li>BOX GLAUVERT - 29700 HIGH (B)</li> <li>BOX GLAUVERT - 30000 HIGH (B)</li> <li>BOX GLAUVERT - 30300 HIGH (B)</li> <li>BOX GLAUVERT - 30600 HIGH (B)</li> <li>BOX GLAUVERT - 30900 HIGH (B)</li> <li>BOX GLAUVERT - 31200 HIGH (B)</li> <li>BOX GLAUVERT - 31500 HIGH (B)</li> <li>BOX GLAUVERT - 31800 HIGH (B)</li> <li>BOX GLAUVERT - 32100 HIGH (B)</li> <li>BOX GLAUVERT - 32400 HIGH (B)</li> <li>BOX GLAUVERT - 32700 HIGH (B)</li> <li>BOX GLAUVERT - 33000 HIGH (B)</li> <li>BOX GLAUVERT - 33300 HIGH (B)</li> <li>BOX GLAUVERT - 33600 HIGH (B)</li> <li>BOX GLAUVERT - 33900 HIGH (B)</li> <li>BOX GLAUVERT - 34200 HIGH (B)</li> <li>BOX GLAUVERT - 34500 HIGH (B)</li> <li>BOX GLAUVERT - 34800 HIGH (B)</li> <li>BOX GLAUVERT - 35100 HIGH (B)</li> <li>BOX GLAUVERT - 35400 HIGH (B)</li> <li>BOX GLAUVERT - 35700 HIGH (B)</li> <li>BOX GLAUVERT - 36000 HIGH (B)</li> <li>BOX GLAUVERT - 36300 HIGH (B)</li> <li>BOX GLAUVERT - 36600 HIGH (B)</li> <li>BOX GLAUVERT - 36900 HIGH (B)</li> <li>BOX GLAUVERT - 37200 HIGH (B)</li> <li>BOX GLAUVERT - 37500 HIGH (B)</li> <li>BOX GLAUVERT - 37800 HIGH (B)</li> <li>BOX GLAUVERT - 38100 HIGH (B)</li> <li>BOX GLAUVERT - 38400 HIGH (B)</li> <li>BOX GLAUVERT - 38700 HIGH (B)</li> <li>BOX GLAUVERT - 39000 HIGH (B)</li> <li>BOX GLAUVERT - 39300 HIGH (B)</li> <li>BOX GLAUVERT - 39600 HIGH (B)</li> <li>BOX GLAUVERT - 39900 HIGH (B)</li> <li>BOX GLAUVERT - 40200 HIGH (B)</li> <li>BOX GLAUVERT - 40500 HIGH (B)</li> <li>BOX GLAUVERT - 40800 HIGH (B)</li> <li>BOX GLAUVERT - 41100 HIGH (B)</li> <li>BOX GLAUVERT - 41400 HIGH (B)</li> <li>BOX GLAUVERT - 41700 HIGH (B)</li> <li>BOX GLAUVERT - 42000 HIGH (B)</li> <li>BOX GLAUVERT - 42300 HIGH (B)</li> <li>BOX GLAUVERT - 42600 HIGH (B)</li> <li>BOX GLAUVERT - 42900 HIGH (B)</li> <li>BOX GLAUVERT - 43200 HIGH (B)</li> <li>BOX GLAUVERT - 43500 HIGH (B)</li> <li>BOX GLAUVERT - 43800 HIGH (B)</li> <li>BOX GLAUVERT - 44100 HIGH (B)</li> <li>BOX GLAUVERT - 44400 HIGH (B)</li> <li>BOX GLAUVERT - 44700 HIGH (B)</li> <li>BOX GLAUVERT - 45000 HIGH (B)</li> <li>BOX GLAUVERT - 45300 HIGH (B)</li> <li>BOX GLAUVERT - 45600 HIGH (B)</li> <li>BOX GLAUVERT - 45900 HIGH (B)</li> <li>BOX GLAUVERT - 46200 HIGH (B)</li> <li>BOX GLAUVERT - 46500 HIGH (B)</li> <li>BOX GLAUVERT - 46800 HIGH (B)</li> <li>BOX GLAUVERT - 47100 HIGH (B)</li> <li>BOX GLAUVERT - 47400 HIGH (B)</li> <li>BOX GLAUVERT - 47700 HIGH (B)</li> <li>BOX GLAUVERT - 48000 HIGH (B)</li> <li>BOX GLAUVERT - 48300 HIGH (B)</li> <li>BOX GLAUVERT - 48600 HIGH (B)</li> <li>BOX GLAUVERT - 48900 HIGH (B)</li> <li>BOX GLAUVERT - 49200 HIGH (B)</li> <li>BOX GLAUVERT - 49500 HIGH (B)</li> <li>BOX GLAUVERT - 49800 HIGH (B)</li> <li>BOX GLAUVERT - 50100 HIGH (B)</li> <li>BOX GLAUVERT - 50400 HIGH (B)</li> <li>BOX GLAUVERT - 50700 HIGH (B)</li> <li>BOX GLAUVERT - 51000 HIGH (B)</li> <li>BOX GLAUVERT - 51300 HIGH (B)</li> <li>BOX GLAUVERT - 51600 HIGH (B)</li> <li>BOX GLAUVERT - 51900 HIGH (B)</li> <li>BOX GLAUVERT - 52200 HIGH (B)</li> <li>BOX GLAUVERT - 52500 HIGH (B)</li> <li>BOX GLAUVERT - 52800 HIGH (B)</li> <li>BOX GLAUVERT - 53100 HIGH (B)</li> <li>BOX GLAUVERT - 53400 HIGH (B)</li> <li>BOX GLAUVERT - 53700 HIGH (B)</li> <li>BOX GLAUVERT - 54000 HIGH (B)</li> <li>BOX GLAUVERT - 54300 HIGH (B)</li> <li>BOX GLAUVERT - 54600 HIGH (B)</li> <li>BOX GLAUVERT - 54900 HIGH (B)</li> <li>BOX GLAUVERT - 55200 HIGH (B)</li> <li>BOX GLAUVERT - 55500 HIGH (B)</li> <li>BOX GLAUVERT - 55800 HIGH (B)</li> <li>BOX GLAUVERT - 56100 HIGH (B)</li> <li>BOX GLAUVERT - 56400 HIGH (B)</li> <li>BOX GLAUVERT - 56700 HIGH (B)</li> <li>BOX GLAUVERT - 57000 HIGH (B)</li> <li>BOX GLAUVERT - 57300 HIGH (B)</li> <li>BOX GLAUVERT - 57600 HIGH (B)</li> <li>BOX GLAUVERT - 57900 HIGH (B)</li> <li>BOX GLAUVERT - 58200 HIGH (B)</li> <li>BOX GLAUVERT - 58500 HIGH (B)</li> <li>BOX GLAUVERT - 58800 HIGH (B)</li> <li>BOX GLAUVERT - 59100 HIGH (B)</li> <li>BOX GLAUVERT - 59400 HIGH (B)</li> <li>BOX GLAUVERT - 59700 HIGH (B)</li> <li>BOX GLAUVERT - 60000 HIGH (B)</li> <li>BOX GLAUVERT - 60300 HIGH (B)</li> <li>BOX GLAUVERT - 60600 HIGH (B)</li> <li>BOX GLAUVERT - 60900 HIGH (B)</li> <li>BOX GLAUVERT - 61200 HIGH (B)</li> <li>BOX GLAUVERT - 61500 HIGH (B)</li> <li>BOX GLAUVERT - 61800 HIGH (B)</li> <li>BOX GLAUVERT - 62100 HIGH (B)</li> <li>BOX GLAUVERT - 62400 HIGH (B)</li> <li>BOX GLAUVERT - 62700 HIGH (B)</li> <li>BOX GLAUVERT - 63000 HIGH (B)</li> <li>BOX GLAUVERT - 63300 HIGH (B)</li> <li>BOX GLAUVERT - 63600 HIGH (B)</li> <li>BOX GLAUVERT - 63900 HIGH (B)</li> <li>BOX GLAUVERT - 64200 HIGH (B)</li> <li>BOX GLAUVERT - 64500 HIGH (B)</li> <li>BOX GLAUVERT - 64800 HIGH (B)</li> <li>BOX GLAUVERT - 65100 HIGH (B)</li> <li>BOX GLAUVERT - 65400 HIGH (B)</li> <li>BOX GLAUVERT - 65700 HIGH (B)</li> <li>BOX GLAUVERT - 66000 HIGH (B)</li> <li>BOX GLAUVERT - 66300 HIGH (B)</li> <li>BOX GLAUVERT - 66600 HIGH (B)</li> <li>BOX GLAUVERT - 66900 HIGH (B)</li> <li>BOX GLAUVERT - 67200 HIGH (B)</li> <li>BOX GLAUVERT - 67500 HIGH (B)</li> <li>BOX GLAUVERT - 67800 HIGH (B)</li> <li>BOX GLAUVERT - 68100 HIGH (B)</li> <li>BOX GLAUVERT - 68400 HIGH (B)</li> <li>BOX GLAUVERT - 68700 HIGH (B)</li> <li>BOX GLAUVERT - 69000 HIGH (B)</li> <li>BOX GLAUVERT - 69300 HIGH (B)</li> <li>BOX GLAUVERT - 69600 HIGH (B)</li> <li>BOX GLAUVERT - 69900 HIGH (B)</li> <li>BOX GLAUVERT - 70200 HIGH (B)</li> <li>BOX GLAUVERT - 70500 HIGH (B)</li> <li>BOX GLAUVERT - 70800 HIGH (B)</li> <li>BOX GLAUVERT - 71100 HIGH (B)</li> <li>BOX GLAUVERT - 71400 HIGH (B)</li> <li>BOX GLAUVERT - 71700 HIGH (B)</li> <li>BOX GLAUVERT - 72000 HIGH (B)</li> <li>BOX GLAUVERT - 72300 HIGH (B)</li> <li>BOX GLAUVERT - 72600 HIGH (B)</li> <li>BOX GLAUVERT - 72900 HIGH (B)</li> <li>BOX GLAUVERT - 73200 HIGH (B)</li> <li>BOX GLAUVERT - 73500 HIGH (B)</li> <li>BOX GLAUVERT - 73800 HIGH (B)</li> <li>BOX GLAUVERT - 74100 HIGH (B)</li> <li>BOX GLAUVERT - 74400 HIGH (B)</li> <li>BOX GLAUVERT - 74700 HIGH (B)</li> <li>BOX GLAUVERT - 75000 HIGH (B)</li> <li>BOX GLAUVERT - 75300 HIGH (B)</li> <li>BOX GLAUVERT - 75600 HIGH (B)</li> <li>BOX GLAUVERT - 75900 HIGH (B)</li> <li>BOX GLAUVERT - 76200 HIGH (B)</li> <li>BOX GLAUVERT - 76500 HIGH (B)</li> <li>BOX GLAUVERT - 76800 HIGH (B)</li> <li>BOX GLAUVERT - 77100 HIGH (B)</li> <li>BOX GLAUVERT - 77400 HIGH (B)</li> <li>BOX GLAUVERT - 77700 HIGH (B)</li> <li>BOX GLAUVERT - 78000 HIGH (B)</li> <li>BOX GLAUVERT - 78300 HIGH (B)</li> <li>BOX GLAUVERT - 78600 HIGH (B)</li> <li>BOX GLAUVERT - 78900 HIGH (B)</li> <li>BOX GLAUVERT - 79200 HIGH (B)</li> <li>BOX GLAUVERT - 79500 HIGH (B)</li> <li>BOX GLAUVERT - 79800 HIGH (B)</li> <li>BOX GLAUVERT - 80100 HIGH (B)</li> <li>BOX GLAUVERT - 80400 HIGH (B)</li> <li>BOX GLAUVERT - 80700 HIGH (B)</li> <li>BOX GLAUVERT - 81000 HIGH (B)</li> <li>BOX GLAUVERT - 81300 HIGH (B)</li> <li>BOX GLAUVERT - 81600 HIGH (B)</li> <li>BOX GLAUVERT - 81900 HIGH (B)</li> <li>BOX GLAUVERT - 82200 HIGH (B)</li> <li>BOX GLAUVERT - 82500 HIGH (B)</li> <li>BOX GLAUVERT - 82800 HIGH (B)</li> <li>BOX GLAUVERT - 83100 HIGH (B)</li> <li>BOX GLAUVERT - 83400 HIGH (B)</li> <li>BOX GLAUVERT - 83700 HIGH (B)</li> <li>BOX GLAUVERT - 84000 HIGH (B)</li> <li>BOX GLAUVERT - 84300 HIGH (B)</li> <li>BOX GLAUVERT - 84600 HIGH (B)</li> <li>BOX GLAUVERT - 84900 HIGH (B)</li> <li>BOX GLAUVERT - 85200 HIGH (B)</li> <li>BOX GLAUVERT - 85500 HIGH (B)</li> <li>BOX GLAUVERT - 85800 HIGH (B)</li> <li>BOX GLAUVERT - 86100 HIGH (B)</li> <li>BOX GLAUVERT - 86400 HIGH (B)</li> <li>BOX GLAUVERT - 86700 HIGH (B)</li> <li>BOX GLAUVERT - 87000 HIGH (B)</li> <li>BOX GLAUVERT - 87300 HIGH (B)</li> <li>BOX GLAUVERT - 87600 HIGH (B)</li> <li>BOX GLAUVERT - 87900 HIGH (B)</li> <li>BOX GLAUVERT - 88200 HIGH (B)</li> <li>BOX GLAUVERT - 88500 HIGH (B)</li> <li>BOX GLAUVERT - 88800 HIGH (B)</li> <li>BOX GLAUVERT - 89100 HIGH (B)</li> <li>BOX GLAUVERT - 89400 HIGH (B)</li> <li>BOX GLAUVERT - 89700 HIGH (B)</li> <li>BOX GLAUVERT - 90000 HIGH (B)</li> <li>BOX GLAUVERT - 90300 HIGH (B)</li> <li>BOX GLAUVERT - 90600 HIGH (B)</li> <li>BOX GLAUVERT - 90900 HIGH (B)</li> <li>BOX GLAUVERT - 91200 HIGH (B)</li> <li>BOX GLAUVERT - 91500 HIGH (B)</li> <li>BOX GLAUVERT - 91800 HIGH (B)</li> <li>BOX GLAUVERT - 92100 HIGH (B)</li> <li>BOX GLAUVERT - 92400 HIGH (B)</li> <li>BOX GLAUVERT - 92700 HIGH (B)</li> <li>BOX GLAUVERT - 93000 HIGH (B)</li> <li>BOX GLAUVERT - 93300 HIGH (B)</li> <li>BOX GLAUVERT - 93600 HIGH (B)</li> <li>BOX GLAUVERT - 93900 HIGH (B)</li> <li>BOX GLAUVERT - 94200 HIGH (B)</li> <li>BOX GLAUVERT - 94500 HIGH (B)</li> <li>BOX GLAUVERT - 94800 HIGH (B)</li> <li>BOX GLAUVERT - 95100 HIGH (B)</li> <li>BOX GLAUVERT - 95400 HIGH (B)</li> <li>BOX GLAUVERT - 95700 HIGH (B)</li> <li>BOX GLAUVERT - 96000 HIGH (B)</li> <li>BOX GLAUVERT - 96300 HIGH (B)</li> <li>BOX GLAUVERT - 96600 HIGH (B)</li> <li>BOX GLAUVERT - 96900 HIGH (B)</li> <li>BOX GLAUVERT - 97200 HIGH (B)</li> <li>BOX GLAUVERT - 97500 HIGH (B)</li> <li>BOX GLAUVERT - 97800 HIGH (B)</li> <li>BOX GLAUVERT - 98100 HIGH (B)</li> <li>BOX GLAUVERT - 98400 HIGH (B)</li> <li>BOX GLAUVERT - 98700 HIGH (B)</li> <li>BOX GLAUVERT - 99000 HIGH (B)</li> <li>BOX GLAUVERT - 99300 HIGH (B)</li> <li>BOX GLAUVERT - 99600 HIGH (B)</li> <li>BOX GLAUVERT - 99900 HIGH (B)</li> </ul>	<ul style="list-style-type: none"> <li>AP-CH-GI-PIPE OR RIBS (P1SG)</li> <li>BOLT-TYPICAL-SPIKE (P1SB)</li> <li>DEFAULT MK SURVEY MARK (P1SM)</li> <li>PEB (P1SB)</li> <li>PM SSM OR CONTROL MARK (P1SSM)</li> <li>TROD STATION (P1ST)</li> <li>SIGNAL DETECTOR (SD)</li> <li>TRAFFIC CONTROL SIGNAL (P1TCS)</li> <li>TRAFFIC LIGHT WITH OUTREACH (T)</li> <li>TRAFFIC SIGNAL CONTROLLER (P1TSC)</li> <li>TRAFFIC SIGNAL DETECTOR (P1TSD)</li> <li>TRAFFIC SIGNAL JUNCTION BOX (P1TSJ)</li> </ul>	<ul style="list-style-type: none"> <li>AP-CH-GI-PIPE OR RIBS (P1SG)</li> <li>BOLT-TYPICAL-SPIKE (P1SB)</li> <li>DEFAULT MK SURVEY MARK (P1SM)</li> <li>PEB (P1SB)</li> <li>PM SSM OR CONTROL MARK (P1SSM)</li> <li>TROD STATION (P1ST)</li> <li>SIGNAL DETECTOR (SD)</li> <li>TRAFFIC CONTROL SIGNAL (P1TCS)</li> <li>TRAFFIC LIGHT WITH OUTREACH (T)</li> <li>TRAFFIC SIGNAL CONTROLLER (P1TSC)</li> <li>TRAFFIC SIGNAL DETECTOR (P1TSD)</li> <li>TRAFFIC SIGNAL JUNCTION BOX (P1TSJ)</li> </ul>	<ul style="list-style-type: none"> <li>1 ORANGE (O)</li> <li>2 BLACK (B)</li> <li>3 RED (R)</li> <li>4 BLUE (L)</li> <li>5 GREEN (G)</li> <li>7 CROWN (C)</li> </ul>	<ul style="list-style-type: none"> <li>AIR VALVE (P1AV)</li> <li>AIR VALVE - RECYCLED (P1AVR)</li> <li>EARTH TERMINAL (P1ET)</li> <li>EARTH TERMINAL - RECYCLED (P1ETR)</li> <li>FIRE HYDRANT (P1FH)</li> <li>HOUSE CONNECTION (P1HT)</li> <li>HYDRANT (P1HT)</li> <li>HYDRANT - RECYCLED (P1HTR)</li> <li>MAN (P1M)</li> <li>MAN - DIGITISED (M)</li> <li>MAN - RECYCLED (MR)</li> <li>MAN MARKER (P1MM)</li> <li>MAN MARKER - RECYCLED (P1MMR)</li> <li>METER (P1M)</li> <li>METER - RECYCLED (P1MR)</li> <li>OVERHEAD PIPELINE (M)</li> <li>STOP VALVE (P1SV)</li> <li>STOP VALVE - RECYCLED (P1SVR)</li> <li>TAP (P1TP)</li> <li>TAP - RECYCLED (P1TPR)</li> </ul>	<ul style="list-style-type: none"> <li>TOP OF POTHOLE TRENCH (P1T)</li> <li>BREAKLINE OR RIDGE (P1B)</li> <li>BOTTOM OF POTHOLE TRENCH (P1BT)</li> </ul>
<ul style="list-style-type: none"> <li>SEPARATION (S)</li> <li>SPEED ZONE - 40KPH (S)</li> <li>SPEED ZONE - 50KPH (S)</li> <li>SPEED ZONE - 60KPH (S)</li> <li>SPEED ZONE - 70KPH (S)</li> <li>SPEED ZONE - 80KPH (S)</li> <li>SPEED ZONE - 90KPH (S)</li> <li>SPEED ZONE - 100KPH (S)</li> <li>SPEED ZONE - 110KPH (S)</li> <li>SPEED ZONE - 120KPH (S)</li> <li>TRAFFIC MARKER (SILENT COPY) (P1TM)</li> <li>UNKNOWN (U)</li> </ul>	<ul style="list-style-type: none"> <li>BONE HOLE (P1BH)</li> <li>CAMERA - FLASH UNIT (P1CFU)</li> <li>CHECK STRIPS (CS)</li> <li>GOLF COVER LID (P1GCL)</li> <li>GOLF COURSE (G)</li> <li>HIGH PRESSURE OIL PIPELINE (P1HPO)</li> <li>HIGH PRESSURE OIL PIPELINE MARK (P1HPOM)</li> <li>HOTSPOT (P1H)</li> <li>JOIN LINE (BOUNDARY) (L)</li> <li>MX BREAK STRINGS (P1MBS)</li> <li>PARK OR OPEN SPACE (P1POS)</li> <li>PETROL PUMP (P1PP)</li> <li>POT HOLE - NULL LEVEL (P1PHL)</li> <li>POT HOLE - WITH RL (P1PHL)</li> <li>RED LIGHT-SPEED-TRAFFIC CAMERA (P1RLSC)</li> <li>SEISMIC (S)</li> <li>SEISMIC TEST SHOT (P1STS)</li> <li>SERVICE JUNCTION BOX (P1SJB)</li> <li>STOCK GRID (SG)</li></ul>							



Level 1/11 Montgomery St, Kogarah NSW 2217  
1300 554 675 | info@geosurv.com.au

FORD CIVIL

DETAIL AND SUBSURFACE UTILITY INVESTIGATION SURVEY

Commercial Road,  
Rouse Hill

TYPICAL SUI LEGEND

GAS		G
COMMUNICATION		C
DRAINAGE		D
UNIDENTIFIED PIPELINE		U
ELECTRICAL		E
WATER		W
SEWER		S
SUBJECT BOUNDARY		
ADJOINING BOUNDARIES		
CONTOUR MINOR		-0.25-
CONTOUR MAJOR		-1.00-
DIRECT BURIED		DB
UNABLE TO TRACE		UTT
END OF SERVICE (EOS)		
END OF TRACE (EOT)		]
SERVICE CODE		TD
"IL" INVERT LEVEL "TC" TOP CENTRE RL		IL2.00
"UNK" SERVICE DEPTH & QUALITY UNKNOWN		{3.00}A
DIAMETER		Ø0.1

SUI & DETAIL SURVEY PLAN

REV.	DESCRIPTION	DATE
A	Survey for Issue	29.07.25
B	Prev. Survey LVLs added	27.08.25
-	-	-
-	-	-
-	-	-

QUALITY ASSURANCE

Surveyor	Kye Murray	Date of Survey	24.07.25
Checked by	Amanda Santos	Date	27.08.25
Approved by	Jordan Palleson	Date	27.08.25
Drafter	Adam Cameron	Date of Plan	27.08.25

The successful completion of quality assurance confirms that the survey work and drawings comply with the requirements outlined in the Quality Plan with special reference to fully completed and approved work. All information contained in these drawings should be considered preliminary and unchecked.

Datum Origin SS141886 RL 51.065 Coordinates MGA2020 256 (AHD71) Sheet Size A1 @ Scale 1:75

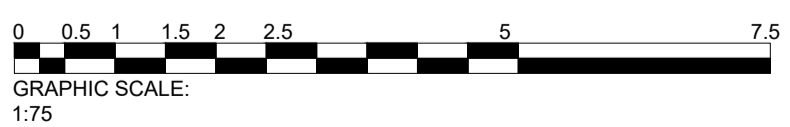

Type of Survey SUI & DETAIL SURVEY PLAN Sheet Page 3 of 31

Job Number Current Revision

ASP250432-DET-01[B] B

This document, whether in electronic or hardcopy form, is confidential, and remains the property of geosurv. It must not be reproduced or used for any other project without written approval from geosurv.



ADJOINING SHEET A1.06





Level 1/11 Montgomery St, Kogarah NSW 2217  
1300 554 675 | info@geosurv.com.au

FORD CIVIL

DETAIL AND SUBSURFACE UTILITY  
INVESTIGATION SURVEY  
Commercial Road,  
Rouse Hill

TYPICAL SUI LEGEND

GAS	— G —
COMMUNICATION	— C —
DRAINAGE	— D —
UNIDENTIFIED PIPELINE	— I —
ELECTRICAL	— E —
WATER	— W —
SEWER	— S —
SUBJECT BOUNDARY	— B —
ADJOINING BOUNDARIES	— A —
CONTOUR MINOR	— 0.25 —
CONTOUR MAJOR	— 1.00 —
DIRECT BURIED	— DB —
UNABLE TO TRACE	— UT —
END OF SERVICE (EOS)	—   —
END OF TRACE (EOT)	—   —
SERVICE CODE	— TD —
"IL" INVERT LEVEL "TC" TOP CENTRE RL	— IL2.00 —
"UNK" SERVICE DEPTH & QUALITY UNKNOWN	— [3.00]A —
DIAMETER	— Ø0.1 —

SUI & DETAIL  
SURVEY PLAN

REV.	DESCRIPTION	DATE
A	Survey for Issue	29.07.25
B	Prev. Survey LVLs added	27.08.25
-	-	-
-	-	-
-	-	-

QUALITY ASSURANCE

Surveyor	Kyle Murray	Date of Survey	24.07.25
Checked by	Amans Santos	Date	27.08.25
Approved by	Jordan Palleson	Date	27.08.25
Drafter	Adam Cameron	Date of Plan	27.08.25

Datum Origin SS141886 RL 51.065 Coordinates MGA2020 256 (AHDT1)  
Sheet Size A1 @ Scale 1:75



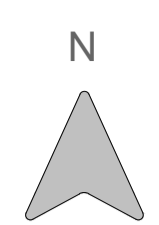
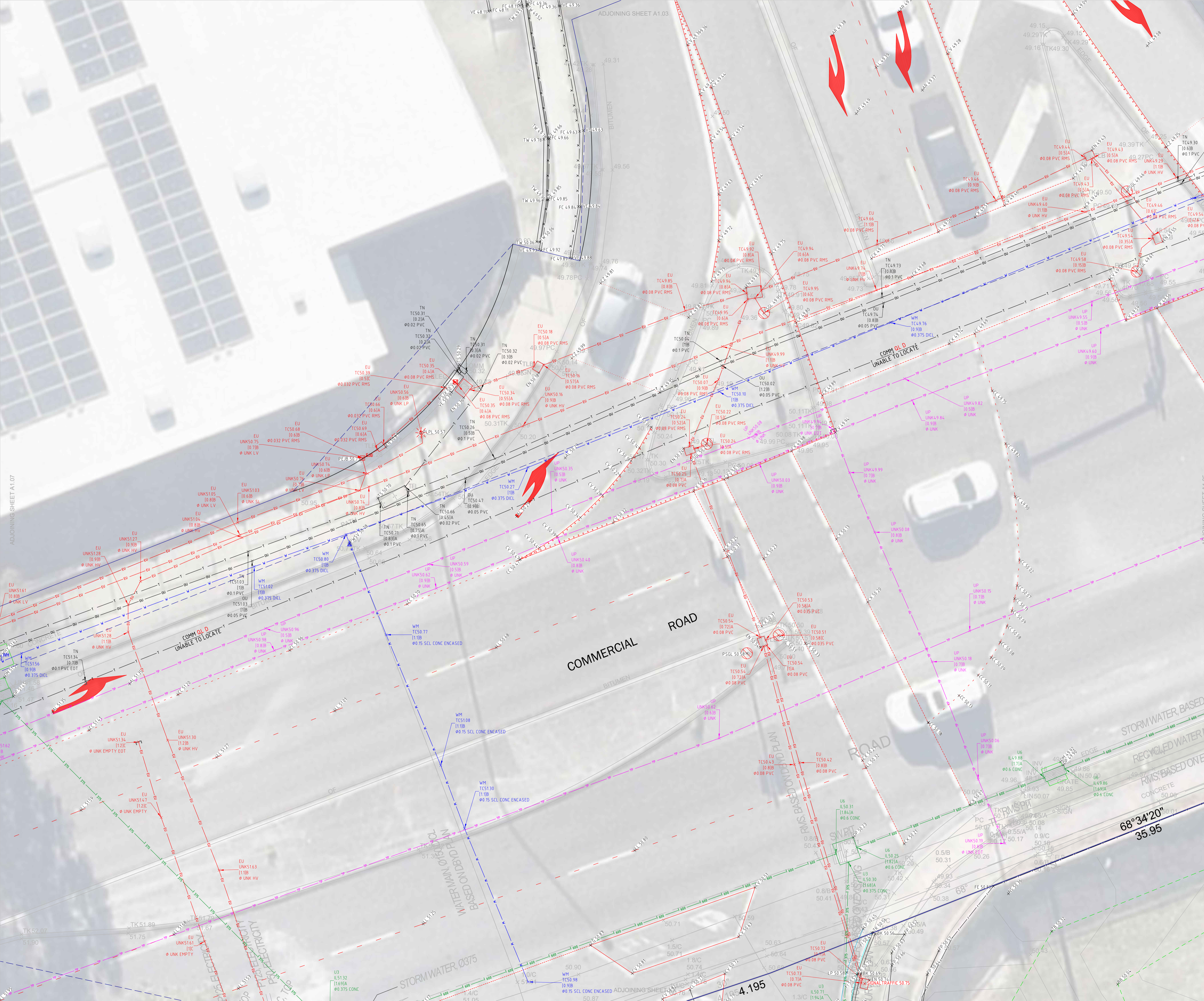

Level 1/11 Montgomery St, Kogarah NSW 2217  
1300 554 675 | info@geosurv.com.au

FORD CIVIL

DETAIL AND SUBSURFACE UTILITY INVESTIGATION SURVEY  
Commercial Road,  
Rouse Hill

TYPICAL SUI LEGEND

GAS	G
COMMUNICATION	C
DRAINAGE	D
UNIDENTIFIED PIPELINE	U
ELECTRICAL	E
WATER	W
SEWER	S
SUBJECT BOUNDARY	DB
ADJOINING BOUNDARIES	UTT
CONTOUR MINOR	-0.25
CONTOUR MAJOR	-1.00
DIRECT BURIED	DB
UNABLE TO TRACE	UTT
END OF SERVICE (EOS)	
END OF TRACE (EOT)	TD
SERVICE CODE	IL2.00
"IL" INVERT LEVEL "TC" TOP CENTRE RL	{3.00}A
"UNK" SERVICE DEPTH & QUALITY UNKNOWN	{0.1}
DIAMETER	{0.1}

SUI & DETAIL SURVEY PLAN

REV.	DESCRIPTION	DATE
A	Survey for Issue	29.07.25
B	Prev. Survey LVLs added	27.08.25
-	-	-
-	-	-
-	-	-

QUALITY ASSURANCE

Surveyor	Kyle Murray	Date of Survey	24.07.25
Checked by	Amanda Santos	Date	27.08.25
Approved by	Jordan Palleson	Date	27.08.25
Drafter	Adam Cameron	Date of Plan	27.08.25

The successful completion of quality assurance confirms that the survey work was performed in accordance with the requirements outlined in the Quality Plan. Any quality assurance failures are noted on this drawing. All information contained in these drawings should be considered preliminary and checked.

Datum Origin: SS141886 RL 51.065 Coordinates: MGA2020 256 (AHDT1)  
Sheet Size A1 @ Scale: 1:75

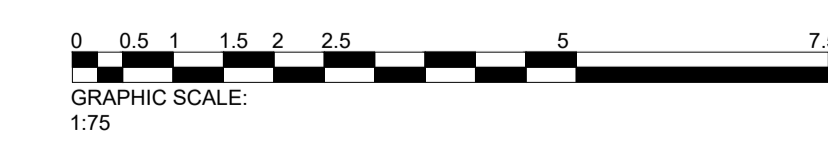

Type of Survey: SUI & DETAIL SURVEY PLAN Sheet Page 6 of 31  
Job Number: Current Revision

ASP250432-DET-01[B] B

This document, whether in its electronic or hardcopy form, is confidential, and remains the property of geosurv. It is not to be reproduced or used for any other project without written approval from geosurv.



Level 1/11 Montgomery St, Kogarah NSW 2217  
1300 554 675 | info@geosurv.com.au

FORD CIVIL

DETAIL AND SUBSURFACE UTILITY INVESTIGATION SURVEY

Commercial Road,  
Rouse Hill

TYPICAL SUI LEGEND

GAS	— G —
COMMUNICATION	— C —
DRAINAGE	— D —
UNIDENTIFIED PIPELINE	— I —
ELECTRICAL	— E —
WATER	— W —
SEWER	— S —
SUBJECT BOUNDARY	— DB —
ADJOINING BOUNDARIES	— DB —
CONTOUR MINOR	— 0.25 —
CONTOUR MAJOR	— 1.00 —
DIRECT BURIED	— DB —
UNABLE TO TRACE	— UT —
END OF SERVICE (EOS)	— I —
END OF TRACE (EOT)	— I —
SERVICE CODE	— TD —
"IL" INVERT LEVEL "TC" TOP CENTRE RL	— IL2.00 —
"UNK" SERVICE DEPTH & QUALITY UNKNOWN	— [3.00]A —
DIAMETER	— Ø0.1 —

SUI & DETAIL SURVEY PLAN

REV.	DESCRIPTION	DATE
A	Survey for Issue	29.07.25
B	Prev. Survey Lvl's added	27.08.25
-	-	-
-	-	-

QUALITY ASSURANCE

Surveyor	Kyle Murray	Date of Survey	24.07.25
Checked by	Amanda Santos	Date	27.08.25
Approved by	Jordan Palleson	Date	27.08.25
Drafter	Adam Cameron	Date of Plan	27.08.25

The successful completion of quality assurance confirms that the survey work was performed in accordance with the requirements outlined in the Quality Plan. This survey was conducted in full compliance with all applicable standards. These drawings should be considered preliminary and checked.

Datum Origin	SS141886 RL 51.065	Coordinates	MGA2020 256 (AHD71)
Sheet Size A1 @ Scale	1:75		



GRAPHIC SCALE: 1:75



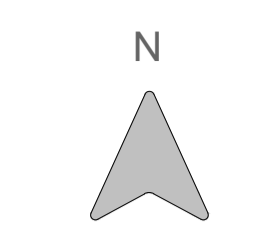
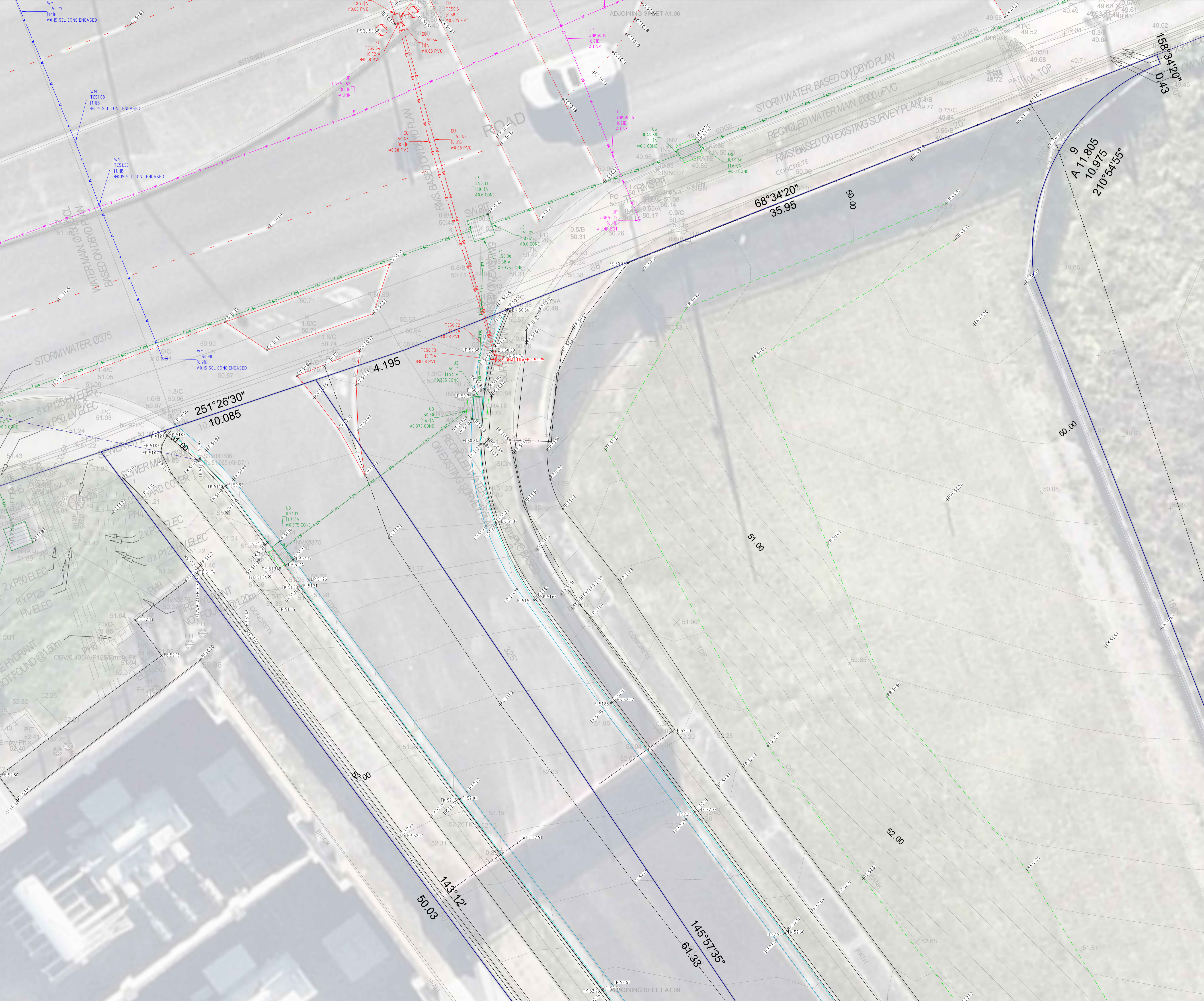

Level 1/11 Montgomery St, Kogarah NSW 2217  
1300 554 675 | info@geosurv.com.au

FORD CIVIL

DETAIL AND SUBSURFACE UTILITY INVESTIGATION SURVEY  
Commercial Road,  
Rouse Hill

TYPICAL SUI LEGEND

- GAS — G —
- COMMUNICATION — C —
- DRAINAGE — D —
- UNIDENTIFIED PIPELINE — I —
- ELECTRICAL — E —
- WATER — W —
- SEWER — S —
- SUBJECT BOUNDARY — B —
- ADJOINING BOUNDARIES — B —
- CONTOUR MINOR - - - 0.25 - - -
- CONTOUR MAJOR - - - 1.00 - - -
- DIRECT BURIED — DB —
- UNABLE TO TRACE — UT —
- END OF SERVICE (EOS) — I —
- END OF TRACE (EOT) — J —
- SERVICE CODE — TD —
- "IL" INVERT LEVEL "TC" TOP CENTRE RL — IL2.00 —
- "UNK" SERVICE DEPTH & QUALITY UNKNOWN — [3.00]A —
- DIAMETER — Ø0.1 —

SUI & DETAIL SURVEY PLAN

REV.	DESCRIPTION	DATE
A	Survey for Issue	29.07.25
B	Prev. Survey LVLs added	27.08.25
-	-	-
-	-	-
-	-	-

QUALITY ASSURANCE

Surveyor	Kye Murray	Date of Survey	24.07.25
Checked by	Amanda Santos	Date	27.08.25
Approved by	Jordan Palleson	Date	27.08.25
Drafter	Adam Cameron	Date of Plan	27.08.25

The successful completion of quality assurance confirms that the survey work was completed in accordance with the requirements outlined in the quality plan. With special reference to fully completed, all information contained in these drawings should be considered preliminary and unchecked.

Datum Origin SS141886 RL 51.065 Coordinates MGA2020 256 (AHD71)  
Sheet Size A1 @ Scale 1:75

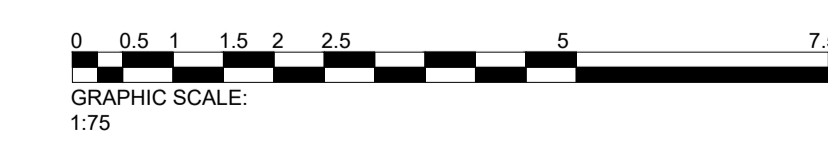

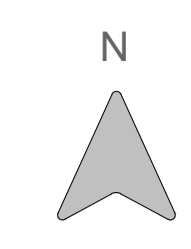

Level 1/11 Montgomery St, Kogarah NSW 2217  
1300 554 675 | info@geosurv.com.au

FORD CIVIL

DETAIL AND SUBSURFACE UTILITY  
INVESTIGATION SURVEY  
Commercial Road,  
Rouse Hill

TYPICAL SUI LEGEND

GAS		G
COMMUNICATION		C
DRAINAGE		D
UNIDENTIFIED PIPELINE		U
ELECTRICAL		E
WATER		W
SEWER		S
SUBJECT BOUNDARY		
ADJOINING BOUNDARIES		
CONTOUR MINOR		-0.25
CONTOUR MAJOR		-1.00
DIRECT BURIED		DB
UNABLE TO TRACE		UTT
END OF SERVICE (EOS)		E
END OF TRACE (EOT)		I
SERVICE CODE		TD
"IL" INVERT LEVEL "TC" TOP CENTRE RL		IL2.00
"UNK" SERVICE DEPTH & QUALITY UNKNOWN		[3.00]A
DIAMETER		Ø0.1

DRAWING TITLE

SUI & DETAIL  
SURVEY PLAN

REV.	DESCRIPTION	DATE
A	Survey for Issue	29.07.25
B	Prev. Survey LVLs added	27.08.25
-	-	-
-	-	-
-	-	-

QUALITY ASSURANCE

Surveyor	Kye Murray	Date of Survey	24.07.25
Checked by	Amanda Santos	Date	27.08.25
Approved by	Jordan Palleson	Date	27.08.25
Drafter	Adam Cameron	Date of Plan	27.08.25

The successful completion of quality assurance confirms that the survey work and drawings comply with the requirements outlined in the quality plan with special reference to fully completed and information contained in these drawings should be considered preliminary and uncheckered.

Datum Origin	SS141886	RL 51.065	Coordinates	MGA2020 256
Sheet Size A1 @ Scale	(AHD71)			1:75

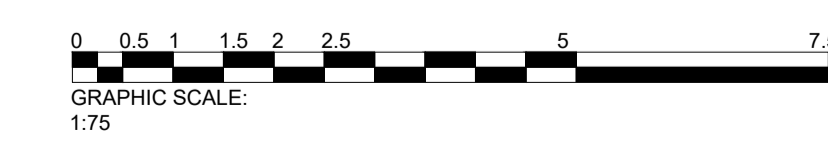

Type of Survey SUI & DETAIL SURVEY PLAN Sheet Page 9 of 31

Job Number ASP250432-DET-01[B] Current Revision B

This document, whether in its electronic or hardcopy form, is confidential, and remains the property of geosurv. It is not to be reproduced or used for any other project without written approval from geosurv.



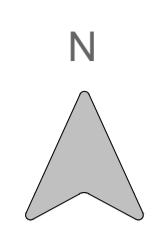

Level 1/11 Montgomery St, Kogarah NSW 2217  
1300 554 675 | info@geosurv.com.au

FORD CIVIL

DETAIL AND SUBSURFACE UTILITY  
INVESTIGATION SURVEY  
Commercial Road,  
Rouse Hill

TYPICAL SUI LEGEND

GAS		G
COMMUNICATION		C
DRAINAGE		D
UNIDENTIFIED PIPELINE		U
ELECTRICAL		E
WATER		W
SEWER		S
SUBJECT BOUNDARY		
ADJOINING BOUNDARIES		
CONTOUR MINOR		-0.25
CONTOUR MAJOR		-1.00
DIRECT BURIED		DB
UNABLE TO TRACE		UTT
END OF SERVICE (EOS)		I
END OF TRACE (EOT)		J
SERVICE CODE		TD
"IL" INVERT LEVEL "TC" TOP CENTRE RL		IL2.00
"UNK" SERVICE DEPTH & QUALITY UNKNOWN		[3.00]A
DIAMETER		Ø0.1

SUI & DETAIL  
SURVEY PLAN

REV.	DESCRIPTION	DATE
A	Survey for Issue	29.07.25
B	Prev. Survey LVLs added	27.08.25
-	-	-
-	-	-
-	-	-

QUALITY ASSURANCE

Surveyor	Kye Murray	Date of Survey	24.07.25
Checked by	Amanda Santos	Date	27.08.25
Approved by	Jordan Palleson	Date	27.08.25
Drafter	Adam Cameron	Date of Plan	27.08.25

The successful completion of quality assurance confirms that the survey work and drawings comply with the requirements outlined in the Quality Plan with special reference to fully completed. All information contained in these drawings should be considered preliminary and uncheckered.

Datum Origin: SS141886 RL 51.065 Coordinates: MGA2020 256  
Sheet Size A1 @ Scale: 1:75

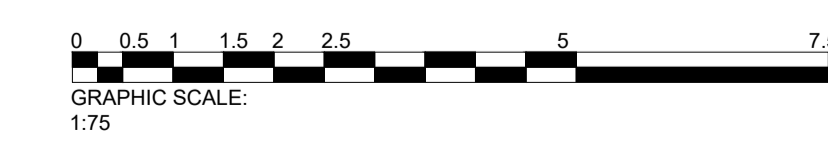

This document, whether in electronic or hardcopy form, is confidential and remains the property of geosurv. It must not be reproduced or used for any other project without written approval from geosurv.

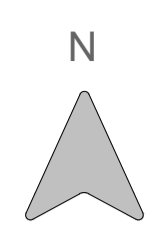

Level 1/11 Montgomery St, Kogarah NSW 2217  
1300 554 675 | info@geosurv.com.au

FORD CIVIL

DETAIL AND SUBSURFACE UTILITY INVESTIGATION SURVEY  
Commercial Road, Rouse Hill

TYPICAL SUI LEGEND

- GAS — G —
- COMMUNICATION — C —
- DRAINAGE — D —
- UNIDENTIFIED PIPELINE — U —
- ELECTRICAL — E —
- WATER — W —
- SEWER — S —
- SUBJECT BOUNDARY — S —
- ADJOINING BOUNDARIES — A —
- CONTOUR MINOR --- M —
- CONTOUR MAJOR --- M —
- DIRECT BURIED — DB —
- UNABLE TO TRACE — UT —
- END OF SERVICE (EOS) — I —
- END OF TRACE (EOT) — J —
- SERVICE CODE — TD —
- "I" INVERT LEVEL "TC" TOP CENTRE RL — IL2.00 —
- "UNK" SERVICE DEPTH & QUALITY UNKNOWN — [3.00]A —
- DIAMETER — Ø0.1 —

SUI & DETAIL SURVEY PLAN

REV.	DESCRIPTION	DATE
A	Survey for Issue	29.07.25
B	Prev. Survey LVLs added	27.08.25
-	-	-
-	-	-
-	-	-

QUALITY ASSURANCE

Role	Name	Date
Surveyor	Kyle Murray	24.07.25
Checked by	Amanda Santos	27.08.25
Approved by	Jordan Palleson	27.08.25
Drafter	Adam Cameron	27.08.25

Datum Origin: SS141886 RL 51.065 Coordinates: MGA2020 256 (AHD71)  
Sheet Size A1 @ Scale: 1:75

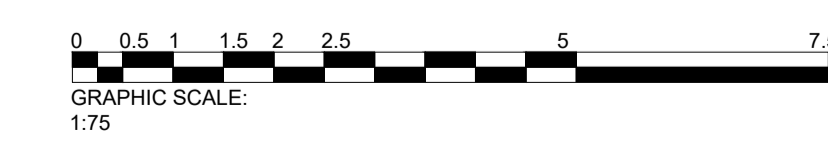

This document, whether in its electronic or hardcopy form, is confidential and remains the property of Geosurv. It must not be reproduced or used for any other project without written approval from Geosurv.



Level 1/11 Montgomery St, Kogarah NSW 2217  
1300 554 675 | info@geosurv.com.au

FORD CIVIL

DETAIL AND SUBSURFACE UTILITY  
INVESTIGATION SURVEY

Commercial Road,  
Rouse Hill

TYPICAL SUI LEGEND

GAS		G
COMMUNICATION		C
DRAINAGE		D
UNIDENTIFIED PIPELINE		
ELECTRICAL		E
WATER		W
SEWER		S
SUBJECT BOUNDARY		
ADJOINING BOUNDARIES		
CONTOUR MINOR		-0.25
CONTOUR MAJOR		-1.00
DIRECT BURIED		DB
UNABLE TO TRACE		UTT
END OF SERVICE (EOS)		I
END OF TRACE (EOT)		J
SERVICE CODE		TD
"IL" INVERT LEVEL "TC" TOP CENTRE RL		IL2.00
"UNK" SERVICE DEPTH & QUALITY UNKNOWN		{3.00}A
DIAMETER		Ø0.1

SUI & DETAIL  
SURVEY PLAN

REV.	DESCRIPTION	DATE
A	Survey for Issue	29.07.25
B	Prev. Survey LVLs added	27.08.25
-	-	-
-	-	-
-	-	-

QUALITY ASSURANCE

Surveyor	Kye Murray	Date of Survey	24.07.25
Checked by	Amanda Santos	Date	27.08.25
Approved by	Jordan Palleson	Date	27.08.25
Drafter	Adam Cameron	Date of Plan	27.08.25

The successful completion of quality assurance confirms that the survey work and drawings comply with the requirements outlined in the Quality Plan with special reference to fully completed and approved work. All information contained in these drawings should be considered preliminary and uncheckered.

Datum Origin	SS141886	RL 51.065	Coordinates	MGA2020 256
Sheet Size A1 @ Scale		(AHD71)		1:75



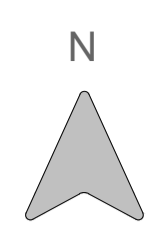

Level 1/11 Montgomery St, Kogarah NSW 2217  
1300 554 675 | info@geosurv.com.au

FORD CIVIL

DETAIL AND SUBSURFACE UTILITY INVESTIGATION SURVEY  
Commercial Road,  
Rouse Hill

**TYPICAL SUI LEGEND**

GAS		G
COMMUNICATION		C
DRAINAGE		D
UNIDENTIFIED PIPELINE		U
ELECTRICAL		E
WATER		W
SEWER		S
SUBJECT BOUNDARY		
ADJOINING BOUNDARIES		
CONTOUR MINOR		-0.25-
CONTOUR MAJOR		-1.00-
DIRECT BURIED		DB
UNABLE TO TRACE		UT
END OF SERVICE (EOS)		I
END OF TRACE (EOT)		J
SERVICE CODE		TD
"I" INVERT LEVEL "TC" TOP CENTRE RL		IL2.00
"UNK" SERVICE DEPTH & QUALITY UNKNOWN		[3.00]A
DIAMETER		Ø0.1

SUI & DETAIL SURVEY PLAN

REV.	DESCRIPTION	DATE
A	Survey for Issue	29.07.25
B	Prev. Survey LVLs added	27.08.25
-	-	-
-	-	-
-	-	-

**QUALITY ASSURANCE**

Surveyor	Kye Murray	Date of Survey	24.07.25
Checked by	Amanda Santos	Date	27.08.25
Approved by	Jordan Palleson	Date	27.08.25
Drafter	Adam Cameron	Date of Plan	27.08.25

Datum Origin SS141886 RL 51.065 Coordinates MGA2020 256 (AHD71)  
Sheet Size A1 @ Scale 1:75

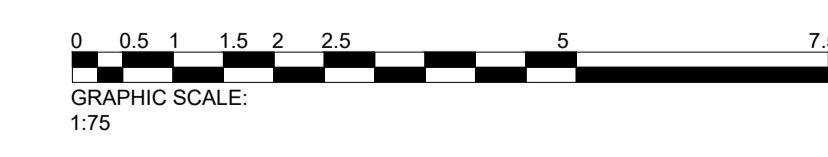



CONSULTANT



Level 1/11 Montgomery St, Kogarah NSW 2217  
1300 554 675 | info@geosurv.com.au

CLIENT

FORD CIVIL

PROJECT

DETAIL AND SUBSURFACE UTILITY INVESTIGATION SURVEY

Commercial Road,  
Rouse Hill

TYPICAL SUI LEGEND

GAS		G
COMMUNICATION		C
DRAINAGE		D
UNIDENTIFIED PIPELINE		U
ELECTRICAL		E
WATER		W
SEWER		S
SUBJECT BOUNDARY		
ADJOINING BOUNDARIES		
CONTOUR MINOR		-0.25-
CONTOUR MAJOR		-1.00-
DIRECT BURIED		DB
UNABLE TO TRACE		UTT
END OF SERVICE (EOS)		I
END OF TRACE (EOT)		J
SERVICE CODE		TD
"IL" INVERT LEVEL "TC" TOP CENTRE RL		IL2.00
"UNK" SERVICE DEPTH & QUALITY UNKNOWN		{3.00}A
DIAMETER		Ø0.1

DRAWING TITLE

SUI & DETAIL SURVEY PLAN

REV.	DESCRIPTION	DATE
A	Survey for Issue	29.07.25
B	Prev. Survey LVLs added	27.08.25
-	-	-
-	-	-
-	-	-

QUALITY ASSURANCE

Role	Name	Date
Surveyor	Kye Murray	24.07.25
Checked by	Amanda Santos	27.08.25
Approved by	Jordan Palleson	27.08.25
Drafter	Adam Cameron	27.08.25

The successful completion of quality assurance confirms that the survey work and drawings comply with the requirements outlined in the Quality Plan with special reference to fully completed. All information contained in these drawings should be considered preliminary and uncheckered.

Datum Origin: SS141886 RL 51.065 Coordinates: MGA2020 256 (AHD71)  
Sheet Size A1 @ Scale: 1:75



Type of Survey: SUI & DETAIL SURVEY PLAN Sheet Page 15 of 31

Job Number: ASP250432-DET-01[B] Current Revision: B

Copyright © 2024

This document, whether in its electronic or hardcopy form, is confidential, and remains the property of Geosurv. It must not be reproduced or used for any other project without written approval from Geosurv.

HIGH VOLTAGE CABLE  
ASBUILT DATA WITH POSITION ONLY  
BY LANDPARTNERS

229  
DP1249147



ADJOINING SHEET A1.15

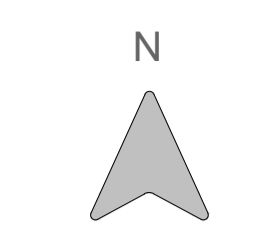
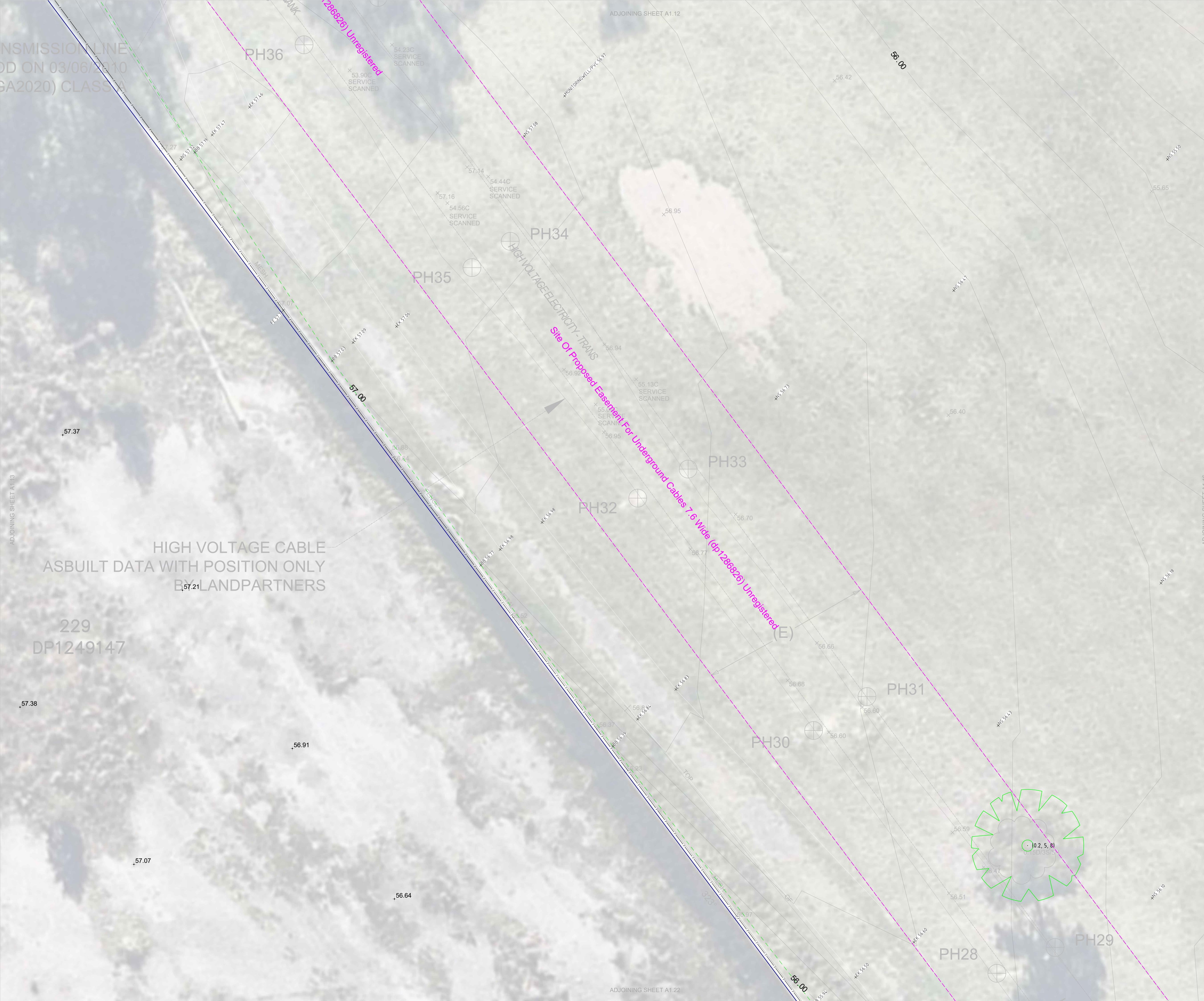

Level 1/11 Montgomery St, Kogarah NSW 2217  
1300 554 675 | info@geosurv.com.au

FORD CIVIL

DETAIL AND SUBSURFACE UTILITY INVESTIGATION SURVEY  
Commercial Road,  
Rouse Hill

TYPICAL SUI LEGEND

GAS	G
COMMUNICATION	C
DRAINAGE	D
UNIDENTIFIED PIPELINE	U
ELECTRICAL	E
WATER	W
SEWER	S
SUBJECT BOUNDARY	—
ADJOINING BOUNDARIES	—
CONTOUR MINOR	-0.25
CONTOUR MAJOR	-1.00
DIRECT BURIED	DB
UNABLE TO TRACE	UTT
END OF SERVICE (EOS)	I
END OF TRACE (EOT)	J
SERVICE CODE	TD
"IL" INVERT LEVEL "TC" TOP CENTRE RL	IL2.00
"UNK" SERVICE DEPTH & QUALITY UNKNOWN	{3.00}A
DIAMETER	Ø0.1

SUI & DETAIL SURVEY PLAN

REV.	DESCRIPTION	DATE
A	Survey for Issue	29.07.25
B	Prev. Survey LVLs added	27.08.25
-	-	-
-	-	-
-	-	-

QUALITY ASSURANCE

Surveyor	Kye Murray	Date of Survey	24.07.25
Checked by	Amanda Santos	Date	27.08.25
Approved by	Jordan Palleson	Date	27.08.25
Drafter	Adam Cameron	Date of Plan	27.08.25

The successful completion of quality assurance confirms that the survey work and drawings comply with the requirements outlined in the quality plan with quality assurance fully completed as information contained in these drawings should be considered preliminary and uncheckered.

Datum Origin SS141886 RL 51.065 Coordinates MGA2020 256 (AHD71)



This document, whether in its electronic or hardcopy form, is confidential, and remains the property of geosurv if not otherwise stated. It is not to be reproduced or used for any other project without written approval from geosurv.



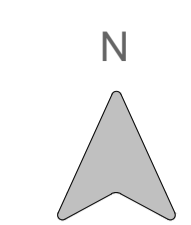
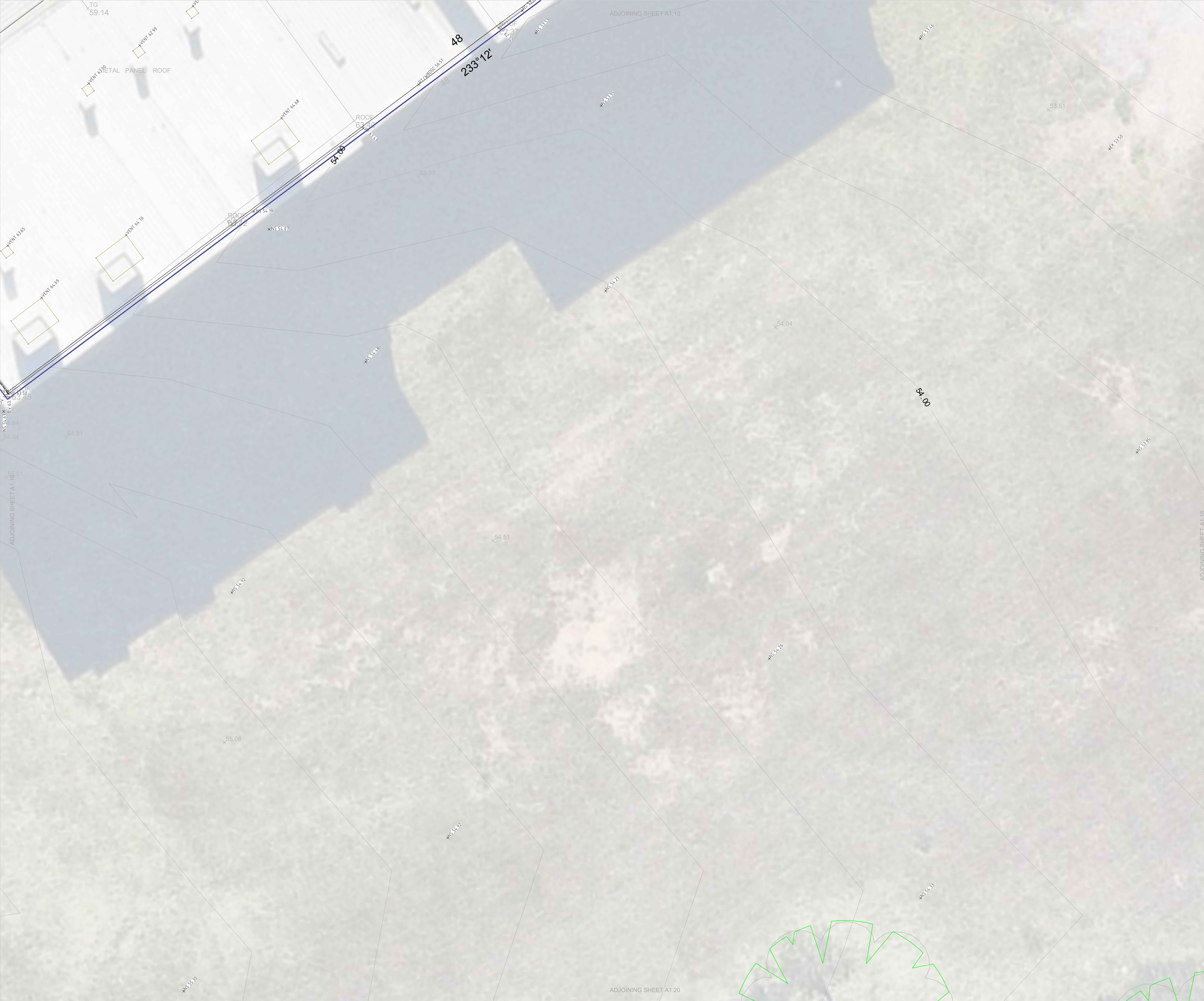

Level 1/11 Montgomery St, Kogarah NSW 2217  
1300 554 675 | info@geosurv.com.au

**FORD CIVIL**

**DETAIL AND SUBSURFACE UTILITY INVESTIGATION SURVEY**  
Commercial Road,  
Rouse Hill

**TYPICAL SUI LEGEND**

GAS		G
COMMUNICATION		C
DRAINAGE		D
UNIDENTIFIED PIPELINE		
ELECTRICAL		E
WATER		W
SEWER		S
SUBJECT BOUNDARY		
ADJOINING BOUNDARIES		
CONTOUR MINOR		0.25
CONTOUR MAJOR		1.00
DIRECT BURIED		DB
UNABLE TO TRACE		UTT
END OF SERVICE (EOS)		I
END OF TRACE (EOT)		J
SERVICE CODE		TD
"I" INVERT LEVEL "TC" TOP CENTRE RL		IL2.00
"UNK" SERVICE DEPTH & QUALITY UNKNOWN		{3.00}A
DIAMETER		Ø0.1

**SUI & DETAIL SURVEY PLAN**

REV.	DESCRIPTION	DATE
A	Survey for Issue	29.07.25
B	Prev. Survey LVLs added	27.08.25
-	-	-
-	-	-
-	-	-

QUALITY ASSURANCE

Surveyor	Kye Murray	Date of Survey	24.07.25
Checked by	Amanda Santos	Date	27.08.25
Approved by	Jordan Palleson	Date	27.08.25
Drafter	Adam Cameron	Date of Plan	27.08.25

The successful completion of quality assurance confirms that the survey work and drawings comply with the requirements outlined in the Quality Plan with special reference to fully completed and approved drawings. These drawings should be considered preliminary and uncheckered.

Datum Origin	SS141886	RL 51.065	Coordinates	MGA2020 256
Sheet Size A1 @ Scale	(AHD71)			1:75

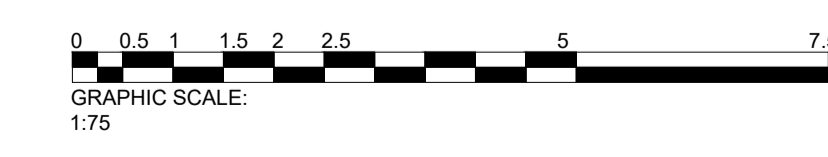

This document, whether in its electronic or hardcopy form, is confidential, and remains the property of geosurv. It must not be reproduced or used for any other project without written approval from geosurv.

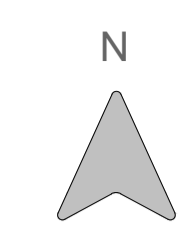

Level 1/11 Montgomery St, Kogarah NSW 2217  
1300 554 675 | info@geosurv.com.au

FORD CIVIL

DETAIL AND SUBSURFACE UTILITY  
INVESTIGATION SURVEY  
Commercial Road,  
Rouse Hill

TYPICAL SUI LEGEND

GAS		G
COMMUNICATION		C
DRAINAGE		D
UNIDENTIFIED PIPELINE		U
ELECTRICAL		E
WATER		W
SEWER		S
SUBJECT BOUNDARY		
ADJOINING BOUNDARIES		
CONTOUR MINOR		0.25
CONTOUR MAJOR		1.00
DIRECT BURIED		DB
UNABLE TO TRACE		UTT
END OF SERVICE (EOS)		I
END OF TRACE (EOT)		J
SERVICE CODE		TD
"IL" INVERT LEVEL "TC" TOP CENTRE RL		IL2.00
"UNK" SERVICE DEPTH & QUALITY UNKNOWN		{3.00}A
DIAMETER		Ø0.1

SUI & DETAIL  
SURVEY PLAN

REV.	DESCRIPTION	DATE
A	Survey for Issue	29.07.25
B	Prev. Survey LVLs added	27.08.25
-	-	-
-	-	-
-	-	-

QUALITY ASSURANCE

Surveyor	Kye Murray	Date of Survey	24.07.25
Checked by	Amanda Santos	Date	27.08.25
Approved by	Jordan Palleson	Date	27.08.25
Drafter	Adam Cameron	Date of Plan	27.08.25

The successful completion of quality assurance confirms that the survey work and drawings comply with the requirements outlined in the Quality Plan. With quality assurance fully completed, all information contained in these drawings should be considered preliminary and uncheckered.

Datum Origin	SS141886	RL 51.065	Coordinates	MGA2020 256
Sheet Size A1 @ Scale	(AHD71)			1:75

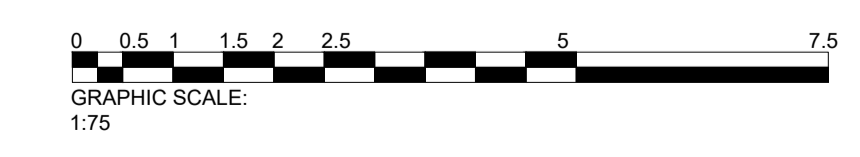

This document, whether in its electronic or hardcopy form, is confidential, and remains the property of geosurv. It must not be reproduced or used for any other project without written approval from geosurv.

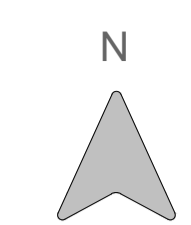

Level 1/11 Montgomery St, Kogarah NSW 2217  
 1300 554 675 | info@geosurv.com.au

FORD CIVIL

DETAIL AND SUBSURFACE UTILITY  
 INVESTIGATION SURVEY  
 Commercial Road,  
 Rouse Hill

TYPICAL SUI LEGEND

GAS		G
COMMUNICATION		C
DRAINAGE		D
UNIDENTIFIED PIPELINE		U
ELECTRICAL		E
WATER		W
SEWER		S
SUBJECT BOUNDARY		
ADJOINING BOUNDARIES		
CONTOUR MINOR		-0.25
CONTOUR MAJOR		-1.00
DIRECT BURIED		DB
UNABLE TO TRACE		UTT
END OF SERVICE (EOS)		E
END OF TRACE (EOT)		I
SERVICE CODE		TD
"IL" INVERT LEVEL "TC" TOP CENTRE RL		IL2.00
"UNK" SERVICE DEPTH & QUALITY UNKNOWN		{3.00}A
DIAMETER		Ø0.1

SUI & DETAIL  
 SURVEY PLAN

REV.	DESCRIPTION	DATE
A	Survey for Issue	29.07.25
B	Prev. Survey LVLs added	27.08.25
-	-	-
-	-	-
-	-	-

QUALITY ASSURANCE

Surveyor	Kye Murray	Date of Survey	24.07.25
Checked by	Amanda Santos	Date	27.08.25
Approved by	Jordan Palleson	Date	27.08.25
Drafter	Adam Cameron	Date of Plan	27.08.25

The successful completion of quality assurance confirms that the survey work and drawings comply with the requirements outlined in the Quality Plan with special reference to fully completed. All information contained in these drawings should be considered preliminary and uncheckered.

Datum Origin SS141886 RL 51.065 Coordinates MGA2020 256 (AHD71)  
 Sheet Size A1 @ Scale 1:75

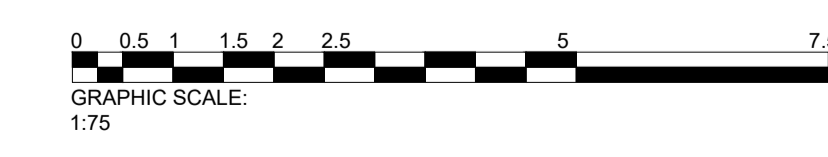

This document, whether in its electronic or hardcopy form, is confidential, and remains the property of geosurv. It must not be reproduced or used for any other project without written approval from geosurv.



MGA NORTH

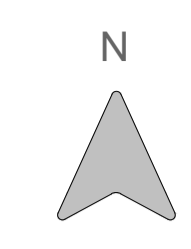

CONSULTANT



Level 1/11 Montgomery St, Kogarah NSW 2217  
1300 554 675 | info@geosurv.com.au

CLIENT

FORD CIVIL

PROJECT

DETAIL AND SUBSURFACE UTILITY  
INVESTIGATION SURVEY  
Commercial Road,  
Rouse Hill

TYPICAL SUI LEGEND

GAS		G
COMMUNICATION		C
DRAINAGE		D
UNIDENTIFIED PIPELINE		I
ELECTRICAL		E
WATER		W
SEWER		S
SUBJECT BOUNDARY		
ADJOINING BOUNDARIES		
CONTOUR MINOR		-0.25
CONTOUR MAJOR		-1.00
DIRECT BURIED		DB
UNABLE TO TRACE		UTT
END OF SERVICE (EOS)		I
END OF TRACE (EOT)		J
SERVICE CODE		TD
"IL" INVERT LEVEL "TC" TOP CENTRE RL		IL2.00
"UNK" SERVICE DEPTH & QUALITY UNKNOWN		{3.00}A
DIAMETER		Ø0.1

DRAWING TITLE

SUI & DETAIL  
SURVEY PLAN

REV.	DESCRIPTION	DATE
A	Survey for Issue	29.07.25
B	Prev. Survey LVLs added	27.08.25
-	-	-
-	-	-
-	-	-

QUALITY ASSURANCE

Surveyor	Kyle Murray	Date of Survey	24.07.25
Checked by	Amanda Santos	Date	27.08.25
Approved by	Jordan Palleson	Date	27.08.25
Drafter	Adam Cameron	Date of Plan	27.08.25

The successful completion of quality assurance confirms that the survey work and drawings comply with the requirements outlined in the Quality Plan. With quality assurance fully completed, all information contained in these drawings should be considered preliminary and uncheckered.

Datum Origin	SS141886	RL 51.065	Coordinates	MGA2020 256
Sheet Size A1 @ Scale	(AHD71)			1:75

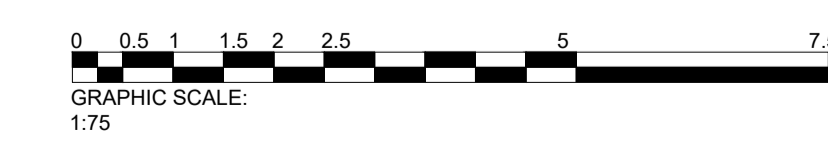

Type of Survey SUI & DETAIL SURVEY PLAN Sheet Page 21 of 31

Job Number ASP250432-DET-01[B] Current Revision B

This document, whether in its electronic or hardcopy form, is confidential, and remains the property of Geosurv. It must not be reproduced or used for any other project without written approval from Geosurv.

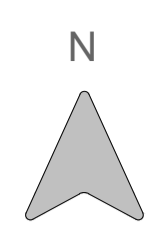
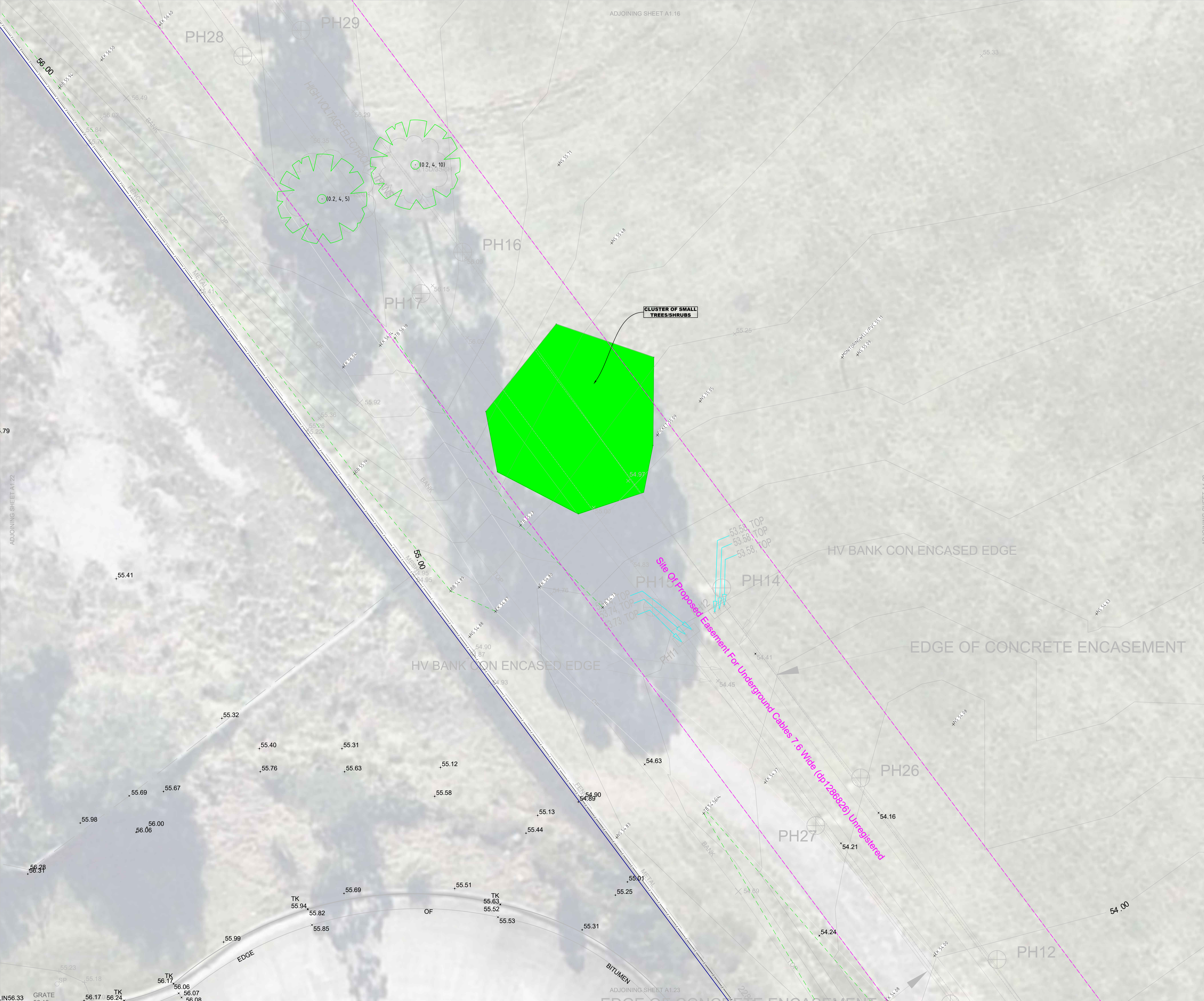

Level 1/11 Montgomery St, Kogarah NSW 2217  
1300 554 675 | info@geosurv.com.au

FORD CIVIL

DETAIL AND SUBSURFACE UTILITY INVESTIGATION SURVEY  
Commercial Road, Rouse Hill

TYPICAL SUI LEGEND

GAS	G
COMMUNICATION	C
DRAINAGE	D
UNIDENTIFIED PIPELINE	U
ELECTRICAL	E
WATER	W
SEWER	S
SUBJECT BOUNDARY	—
ADJOINING BOUNDARIES	—
CONTOUR MINOR	--- 0.25 ---
CONTOUR MAJOR	--- 1.00 ---
DIRECT BURIED	— DB
UNABLE TO TRACE	— UTT
END OF SERVICE (EOS)	— I
END OF TRACE (EOT)	— J
SERVICE CODE	— TD
"IL" INVERT LEVEL "TC" TOP CENTRE RL	— IL2.00
"UNK" SERVICE DEPTH & QUALITY UNKNOWN	— [3.00]A
DIAMETER	— Ø0.1

SUI & DETAIL SURVEY PLAN

REV.	DESCRIPTION	DATE
A	Survey for Issue	29.07.25
B	Prev. Survey LVLs added	27.08.25
-	-	-
-	-	-
-	-	-

QUALITY ASSURANCE

Surveyor	Kye Murray	Date of Survey	24.07.25
Checked by	Amanda Santos	Date	27.08.25
Approved by	Jordan Palleson	Date	27.08.25
Drafter	Adam Cameron	Date of Plan	27.08.25

The successful completion of quality assurance confirms that the survey work and drawings comply with the requirements outlined in the quality plan with special reference to fully completed. All information contained in these drawings should be considered preliminary and unchecked.

Datum Origin SS141886 RL 51.065 Coordinates MGA2020 256 (AHD71)

Sheet Size A1 @ Scale 1:75

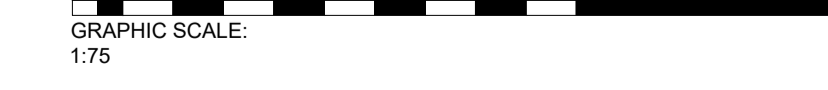

Type of Survey SUI & DETAIL SURVEY PLAN Sheet Page 22 of 31

Job Number ASP250432-DET-01[B] Current Revision B

This document, whether in electronic or hardcopy form, is confidential and remains the property of geosurv. It must not be reproduced or used for any other project without written approval from geosurv.

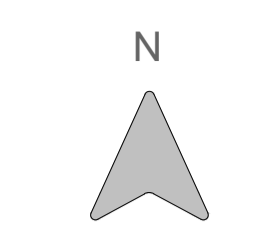

Level 1/11 Montgomery St, Kogarah NSW 2217  
1300 554 675 | info@geosurv.com.au

FORD CIVIL

DETAIL AND SUBSURFACE UTILITY  
INVESTIGATION SURVEY  
Commercial Road,  
Rouse Hill

**TYPICAL SUI LEGEND**

GAS		G
COMMUNICATION		C
DRAINAGE		D
UNIDENTIFIED PIPELINE		U
ELECTRICAL		E
WATER		W
SEWER		S
SUBJECT BOUNDARY		
ADJOINING BOUNDARIES		
CONTOUR MINOR		-0.25-
CONTOUR MAJOR		-1.00-
DIRECT BURIED		DB
UNABLE TO TRACE		UT
END OF SERVICE (EOS)		I
END OF TRACE (EOT)		J
SERVICE CODE		TD
"IL" INVERT LEVEL "TC" TOP CENTRE RL		IL2.00
"UNK" SERVICE DEPTH & QUALITY UNKNOWN		[3.00]A
DIAMETER		Ø0.1

SUI & DETAIL  
SURVEY PLAN

REV.	DESCRIPTION	DATE
A	Survey for Issue	29.07.25
B	Prev. Survey LVLs added	27.08.25
-	-	-
-	-	-
-	-	-

**QUALITY ASSURANCE**

Role	Name	Date
Surveyor	Kye Murray	24.07.25
Checked by	Amanda Santos	27.08.25
Approved by	Jordan Palleson	27.08.25
Drafter	Adam Cameron	27.08.25

Datum Origin SS141886 RL 51.065 Coordinates MGA2020 256 (AHD71)  
Sheet Size A1 @ Scale 1:75

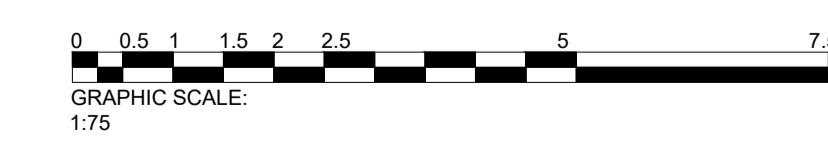

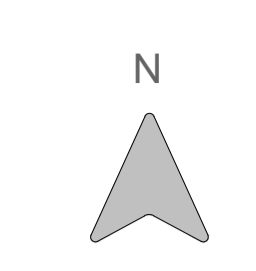
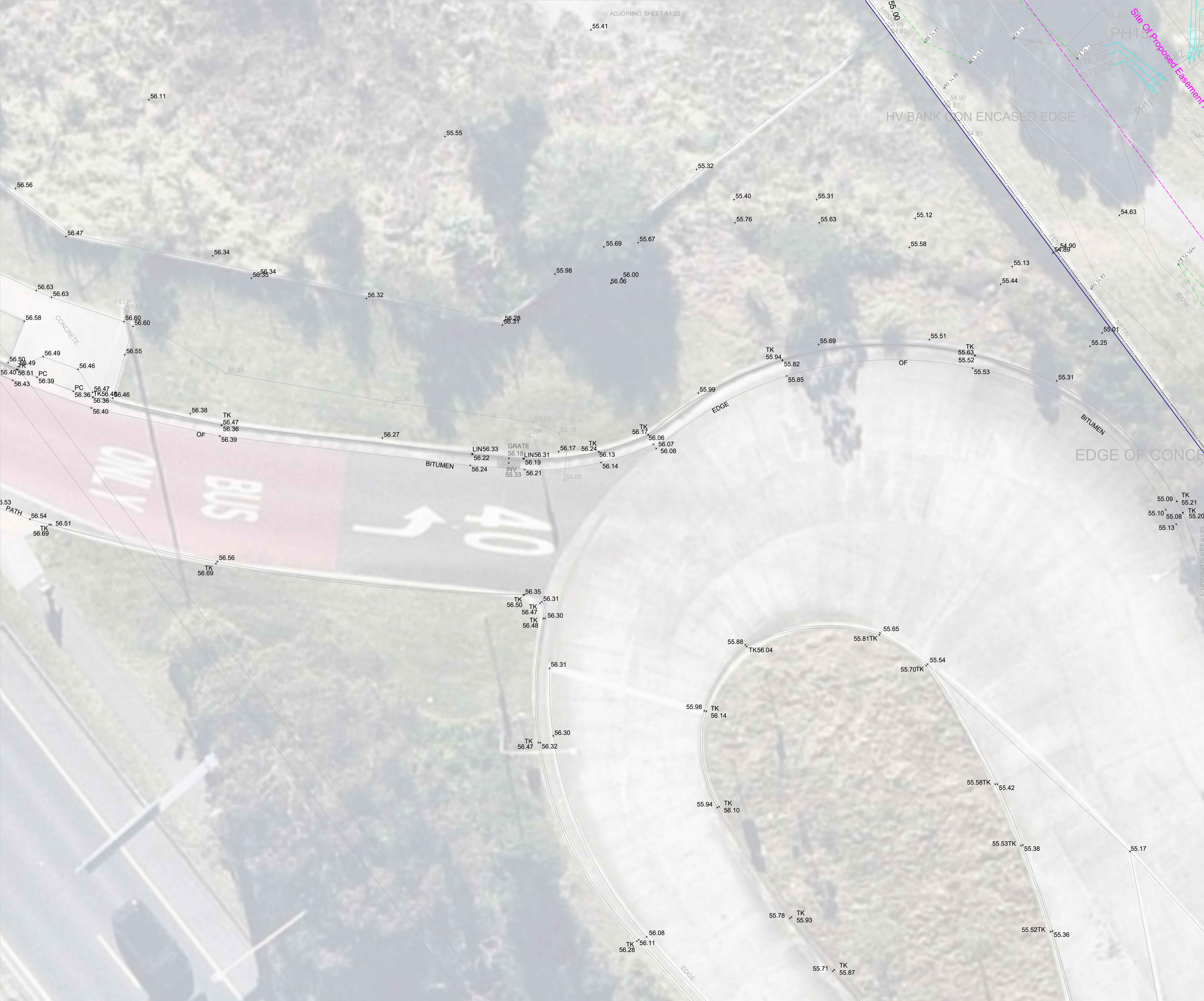

Level 1/11 Montgomery St, Kogarah NSW 2217  
1300 554 675 | info@geosurv.com.au

FORD CIVIL

DETAIL AND SUBSURFACE UTILITY INVESTIGATION SURVEY  
Commercial Road,  
Rouse Hill

TYPICAL SUI LEGEND

GAS		G
COMMUNICATION		C
DRAINAGE		D
UNIDENTIFIED PIPELINE		U
ELECTRICAL		E
WATER		W
SEWER		S
SUBJECT BOUNDARY		
ADJOINING BOUNDARIES		
CONTOUR MINOR		-0.25
CONTOUR MAJOR		-1.00
DIRECT BURIED		DB
UNABLE TO TRACE		UTT
END OF SERVICE (EOS)		
END OF TRACE (EOT)		]
SERVICE CODE		TD
"IL" INVERT LEVEL "TC" TOP CENTRE RL		IL2.00
"UNK" SERVICE DEPTH & QUALITY UNKNOWN		{3.00}A
DIAMETER		Ø0.1

SUI & DETAIL SURVEY PLAN

REV.	DESCRIPTION	DATE
A	Survey for Issue	29.07.25
B	Prev. Survey LVLs added	27.08.25
-	-	-
-	-	-
-	-	-

QUALITY ASSURANCE

Surveyor	Kye Murray	Date of Survey	24.07.25
Checked by	Amanda Santos	Date	27.08.25
Approved by	Jordan Palleson	Date	27.08.25
Drafter	Adam Cameron	Date of Plan	27.08.25

Datum Origin SS141886 RL 51.065 Coordinates MGA2020 256 (AHD71)  
Sheet Size A1 @ Scale 1:75

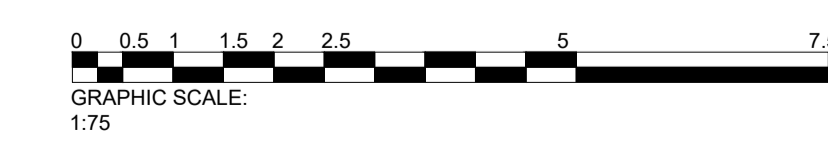

This document, whether in its electronic or hardcopy form, is confidential, and remains the property of Geosurv. It must not be reproduced or used for any other project without written approval from Geosurv.

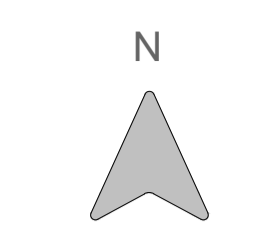

Level 1/11 Montgomery St, Kogarah NSW 2217  
1300 554 675 | info@geosurv.com.au

FORD CIVIL

DETAIL AND SUBSURFACE UTILITY  
INVESTIGATION SURVEY  
Commercial Road,  
Rouse Hill

TYPICAL SUI LEGEND

GAS		G
COMMUNICATION		C
DRAINAGE		D
UNIDENTIFIED PIPELINE		U
ELECTRICAL		E
WATER		W
SEWER		S
SUBJECT BOUNDARY		
ADJOINING BOUNDARIES		
CONTOUR MINOR		-0.25
CONTOUR MAJOR		-1.00
DIRECT BURIED		DB
UNABLE TO TRACE		UTT
END OF SERVICE (EOS)		I
END OF TRACE (EOT)		J
SERVICE CODE		TD
"IL" INVERT LEVEL "TC" TOP CENTRE RL		IL2.00
"UNK" SERVICE DEPTH & QUALITY UNKNOWN		{3.00}A
DIAMETER		Ø0.1

SUI & DETAIL  
SURVEY PLAN

REV.	DESCRIPTION	DATE
A	Survey for Issue	29.07.25
B	Prev. Survey LVLs added	27.08.25
-	-	-
-	-	-
-	-	-

QUALITY ASSURANCE

Surveyor	Kye Murray	Date of Survey	24.07.25
Checked by	Amanda Santos	Date	27.08.25
Approved by	Jordan Palleson	Date	27.08.25
Drafter	Adam Cameron	Date of Plan	27.08.25

Datum Origin SS141886 RL 51.065 Coordinates MGA2020 256 (AHD71)

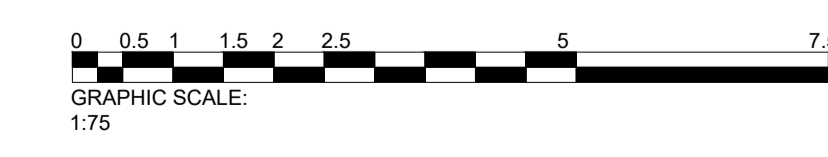

This document, whether in electronic or hardcopy form, is confidential, and remains the property of geosurv. It must not be reproduced or used for any other project without written approval from geosurv.

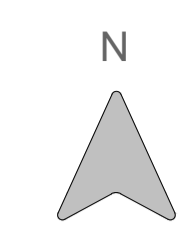
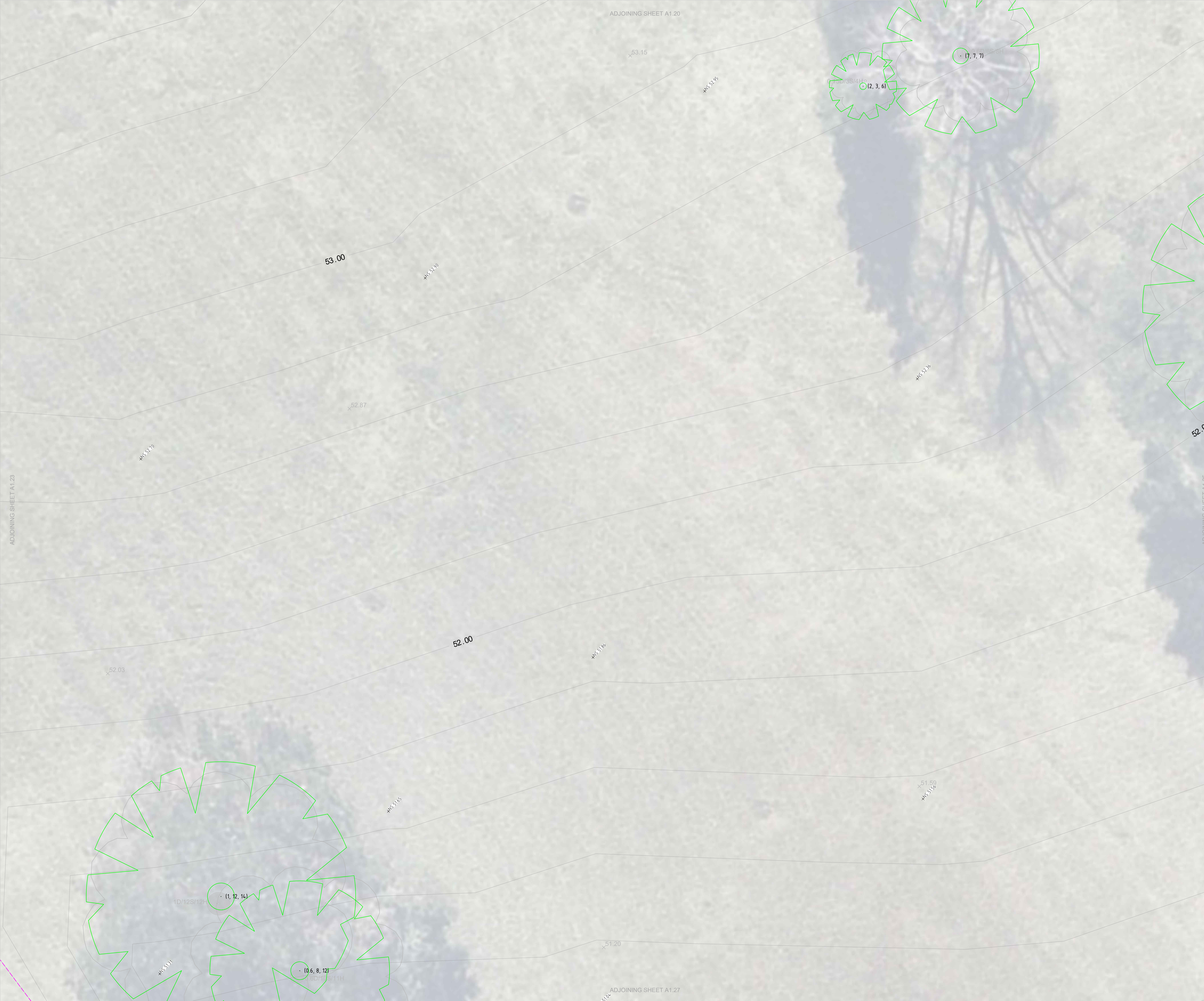

Level 1/11 Montgomery St, Kogarah NSW 2217  
1300 554 675 | info@geosurv.com.au

FORD CIVIL

DETAIL AND SUBSURFACE UTILITY  
INVESTIGATION SURVEY  
Commercial Road,  
Rouse Hill

TYPICAL SUI LEGEND

GAS		G
COMMUNICATION		C
DRAINAGE		D
UNIDENTIFIED PIPELINE		I
ELECTRICAL		E
WATER		W
SEWER		S
SUBJECT BOUNDARY		
ADJOINING BOUNDARIES		
CONTOUR MINOR		-0.25-
CONTOUR MAJOR		-1.00-
DIRECT BURIED		DB
UNABLE TO TRACE		UTT
END OF SERVICE (EOS)		I
END OF TRACE (EOT)		J
SERVICE CODE		TD
"IL" INVERT LEVEL "TC" TOP CENTRE RL		IL2.00
"UNK" SERVICE DEPTH & QUALITY UNKNOWN		{3.00}A
DIAMETER		Ø0.1

SUI & DETAIL  
SURVEY PLAN

REV.	DESCRIPTION	DATE
A	Survey for Issue	29.07.25
B	Prev. Survey LVLs added	27.08.25
-	-	-
-	-	-
-	-	-

QUALITY ASSURANCE

Surveyor	Kye Murray	Date of Survey	24.07.25
Checked by	Amanda Santos	Date	27.08.25
Approved by	Jordan Palleson	Date	27.08.25
Drafter	Adam Cameron	Date of Plan	27.08.25

The successful completion of quality assurance confirms that the survey work and drawings comply with the requirements outlined in the Quality Plan with special reference to fully completed as information contained in these drawings should be considered preliminary and unverified.

Datum Origin	SS141886	RL 51.065	Coordinates	MGA2020 256
Sheet Size A1 @ Scale	(AHD71)			1:75

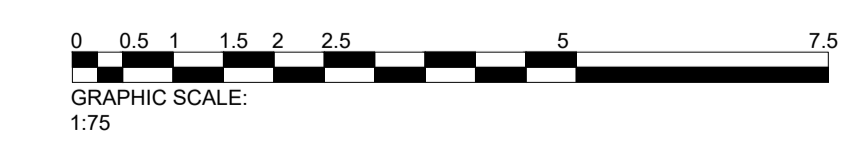



CONSULTANT



Level 1/11 Montgomery St, Kogarah NSW 2217  
1300 554 675 | info@geosurv.com.au

CLIENT

FORD CIVIL

PROJECT

DETAIL AND SUBSURFACE UTILITY INVESTIGATION SURVEY

Commercial Road,  
Rouse Hill

TYPICAL SUI LEGEND

GAS		G
COMMUNICATION		C
DRAINAGE		D
UNIDENTIFIED PIPELINE		U
ELECTRICAL		E
WATER		W
SEWER		S
SUBJECT BOUNDARY		
ADJOINING BOUNDARIES		
CONTOUR MINOR		-0.25-
CONTOUR MAJOR		-1.00-
DIRECT BURIED		DB
UNABLE TO TRACE		UT
END OF SERVICE (EOS)		I
END OF TRACE (EOT)		J
SERVICE CODE		TD
"IL" INVERT LEVEL "TC" TOP CENTRE RL		IL2.00
"UNK" SERVICE DEPTH & QUALITY UNKNOWN		[3.00]A
DIAMETER		Ø0.1

DRAWING TITLE

SUI & DETAIL SURVEY PLAN

REV.	DESCRIPTION	DATE
A	Survey for Issue	29.07.25
B	Prev. Survey LVLs added	27.08.25
-	-	-
-	-	-
-	-	-

QUALITY ASSURANCE

Role	Name	Date
Surveyor	Kye Murray	24.07.25
Checked by	Amanda Santos	27.08.25
Approved by	Jordan Palleson	27.08.25
Drafter	Adam Cameron	27.08.25

The successful completion of quality assurance confirms that the survey work and drawings comply with the requirements outlined in the Quality Plan with special reference to fully completed and approved work. All information contained in these drawings should be considered preliminary and uncheckered.

Datum Origin	SS141886	RL 51.065	Coordinates	MGA2020 256
Sheet Size A1 @ Scale	(AHD71)			1:75

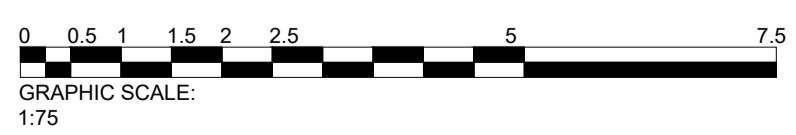

Type of Survey SUI & DETAIL SURVEY PLAN Sheet Page 27 of 31

Job Number Current Revision

ASP250432-DET-01[B] B

This document, whether in its electronic or hardcopy form, is confidential, and remains the property of geosurv. It must not be reproduced or used for any other project without written approval from geosurv.



ADJOINING SHEET A1.26

ADJOINING SHEET A1.24

ADJOINING SHEET A1.19



CONSULTANT



Level 1/11 Montgomery St, Kogarah NSW 2217  
1300 554 675 | info@geosurv.com.au

CLIENT

FORD CIVIL

PROJECT

DETAIL AND SUBSURFACE UTILITY INVESTIGATION SURVEY

Commercial Road,  
Rouse Hill

TYPICAL SUI LEGEND

GAS		G
COMMUNICATION		C
DRAINAGE		D
UNIDENTIFIED PIPELINE		U
ELECTRICAL		E
WATER		W
SEWER		S
SUBJECT BOUNDARY		
ADJOINING BOUNDARIES		
CONTOUR MINOR		-0.25-
CONTOUR MAJOR		-1.00-
DIRECT BURIED		DB
UNABLE TO TRACE		UTT
END OF SERVICE (EOS)		I
END OF TRACE (EOT)		J
SERVICE CODE		TD
"IL" INVERT LEVEL "TC" TOP CENTRE RL		IL2.00
"UNK" SERVICE DEPTH & QUALITY UNKNOWN		{3.00}A
DIAMETER		Ø0.1

DRAWING TITLE

SUI & DETAIL SURVEY PLAN

REV.	DESCRIPTION	DATE
A	Survey for Issue	29.07.25
B	Prev. Survey LVLs added	27.08.25
-	-	-
-	-	-
-	-	-

QUALITY ASSURANCE

Role	Name	Date
Surveyor	Kye Murray	24.07.25
Checked by	Amanda Santos	27.08.25
Approved by	Jordan Palleson	27.08.25
Drafter	Adam Cameron	27.08.25

The successful completion of quality assurance confirms that the survey work and drawings comply with the requirements outlined in the Quality Plan. With quality assurance fully completed, all information contained in these drawings should be considered preliminary and uncheckered.

Datum Origin	SS141886	RL 51.065	Coordinates	MGA2020 256
Sheet Size A1 @ Scale				1:75



GRAPHIC SCALE:  
1:75

Type of Survey SUI & DETAIL SURVEY PLAN Sheet Page 28 of 31

Job Number Current Revision

ASP250432-DET-01[B] B

This document, whether in its electronic or hardcopy form, is confidential and remains the property of geosurv. It must not be reproduced or used for any other project without written approval from geosurv.



ADJOINING SHEET A1.25

ADJOINING SHEET A1.27



CONSULTANT



Level 1/11 Montgomery St, Kogarah NSW 2217  
1300 554 675 | info@geosurv.com.au

CLIENT

FORD CIVIL

PROJECT

DETAIL AND SUBSURFACE UTILITY  
INVESTIGATION SURVEY

Commercial Road,  
Rouse Hill

TYPICAL SUI LEGEND

GAS		G
COMMUNICATION		C
DRAINAGE		D
UNIDENTIFIED PIPELINE		U
ELECTRICAL		E
WATER		W
SEWER		S
SUBJECT BOUNDARY		
ADJOINING BOUNDARIES		
CONTOUR MINOR		-0.25-
CONTOUR MAJOR		-1.00-
DIRECT BURIED		DB
UNABLE TO TRACE		UT
END OF SERVICE (EOS)		I
END OF TRACE (EOT)		J
SERVICE CODE		TD
"IL" INVERT LEVEL "TC" TOP CENTRE RL		IL2.00
"UNK" SERVICE DEPTH & QUALITY UNKNOWN		[3.00]A
DIAMETER		Ø0.1

DRAWING TITLE

SUI & DETAIL  
SURVEY PLAN

REV.	DESCRIPTION	DATE
A	Survey for Issue	29.07.25
B	Prev. Survey LVLs added	27.08.25
-	-	-
-	-	-
-	-	-

QUALITY ASSURANCE

Surveyor	Kye Murray	Date of Survey	24.07.25
Checked by	Amanda Santos	Date	27.08.25
Approved by	Jordan Palleson	Date	27.08.25
Drafter	Adam Cameron	Date of Plan	27.08.25

The successful completion of quality assurance confirms that the survey work and drawings comply with the requirements outlined in the Quality Plan with special reference to fully completed. All information contained in these drawings should be considered preliminary and unchecked.

Datum Origin SS141886 RL 51.065 Coordinates MGA2020 256 (AHD71)  
Sheet Size A1 @ Scale 1:75



GRAPHIC SCALE:  
1:75

Type of Survey SUI & DETAIL SURVEY PLAN Sheet Page 29 of 31

Job Number Current Revision

ASP250432-DET-01[B] B

Copyright 2024  
This document, whether in its electronic or hardcopy form, is confidential, and remains the property of Geosurv. It must not be reproduced or used for any other project without written approval from Geosurv.

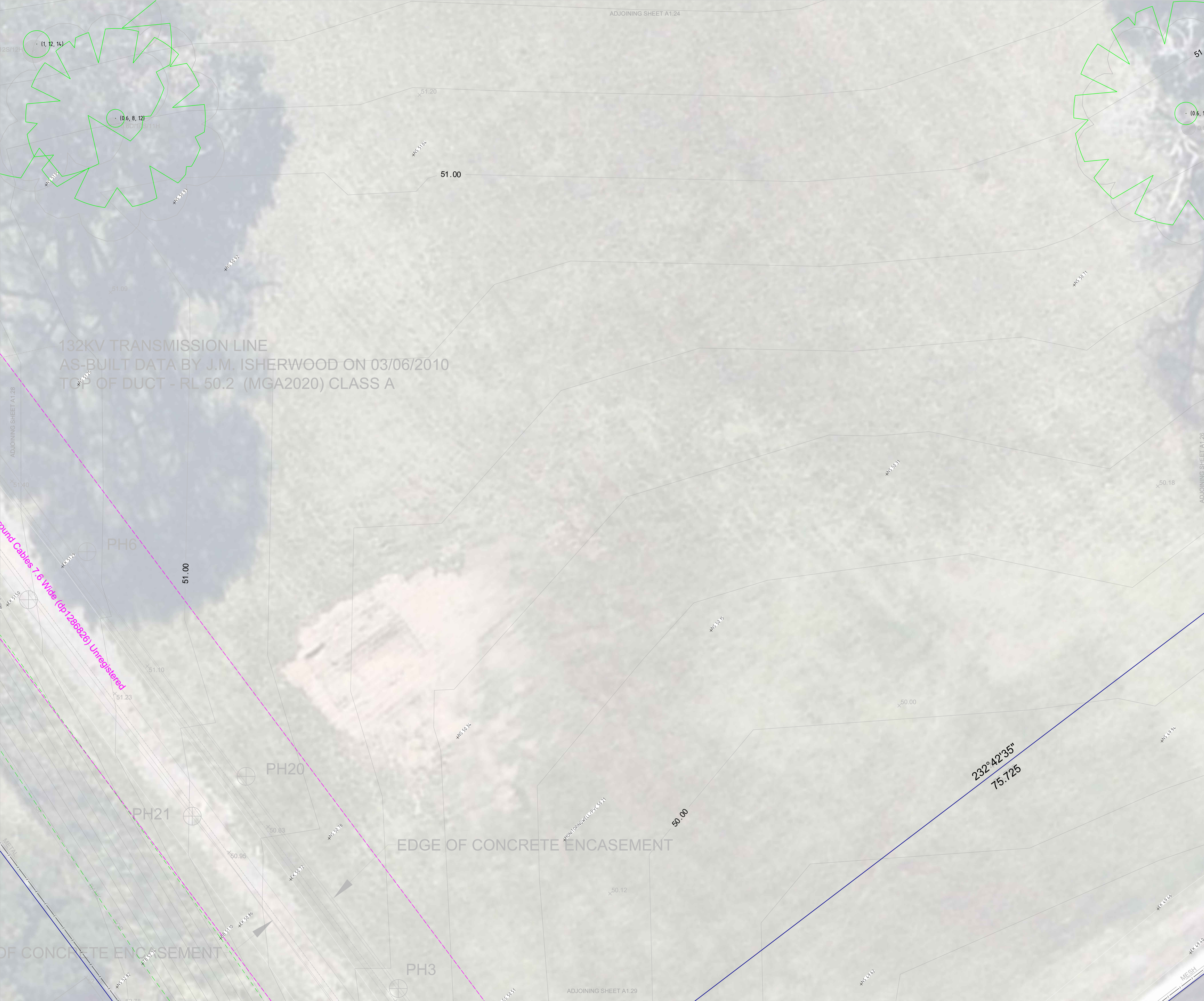

132KV TRANSMISSION LINE  
AS-BUILT DATA BY J.M. ISHERWOOD ON 03/06/2010  
TOP OF DUCT - RL 50.2 (MGA2020) CLASS A

Ground Cables 7.6 Wide (dp1266926) Unregistered

EDGE OF CONCRETE ENCASEMENT

OF CONCRETE ENCASEMENT

MESH

ADJOINING SHEET A1.28

ADJOINING SHEET A1.26

ADJOINING SHEET A1.29

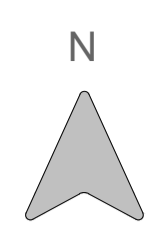

Level 1/11 Montgomery St, Kogarah NSW 2217  
1300 554 675 | info@geosurv.com.au

FORD CIVIL

DETAIL AND SUBSURFACE UTILITY  
INVESTIGATION SURVEY  
Commercial Road,  
Rouse Hill

**TYPICAL SUI LEGEND**

GAS		G
COMMUNICATION		C
DRAINAGE		D
UNIDENTIFIED PIPELINE		U
ELECTRICAL		E
WATER		W
SEWER		S
SUBJECT BOUNDARY		
ADJOINING BOUNDARIES		
CONTOUR MINOR		-0.25
CONTOUR MAJOR		-1.00
DIRECT BURIED		DB
UNABLE TO TRACE		UTT
END OF SERVICE (EOS)		E
END OF TRACE (EOT)		J
SERVICE CODE		TD
"IL" INVERT LEVEL "TC" TOP CENTRE RL		IL2.00
"UNK" SERVICE DEPTH & QUALITY UNKNOWN		{3.00}A
DIAMETER		Ø0.1

SUI & DETAIL  
SURVEY PLAN

REV.	DESCRIPTION	DATE
A	Survey for Issue	29.07.25
B	Prev. Survey LVLs added	27.08.25
-	-	-
-	-	-
-	-	-

**QUALITY ASSURANCE**

Surveyor	Kye Murray	Date of Survey	24.07.25
Checked by	Amanda Santos	Date	27.08.25
Approved by	Jordan Palleson	Date	27.08.25
Drafter	Adam Cameron	Date of Plan	27.08.25

Datum Origin SS141886 RL 51.065 Coordinates MGA2020 256 (AHD71)  
Sheet Size A1 @ Scale 1:75

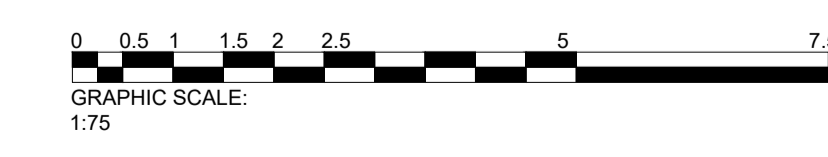

This document, whether in its electronic or hardcopy form, is confidential, and remains the property of geosurv. It must not be reproduced or used for any other project without written approval from geosurv.



ADJOINING SHEET A1.27

MGA NORTH

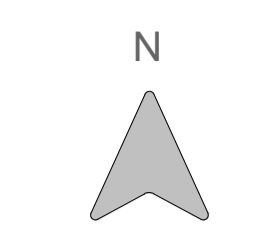

CONSULTANT



Level 1/11 Montgomery St, Kogarah NSW 2217  
1300 554 675 | info@geosurv.com.au

CLIENT

FORD CIVIL

PROJECT

DETAIL AND SUBSURFACE UTILITY  
INVESTIGATION SURVEY  
Commercial Road,  
Rouse Hill

TYPICAL SUI LEGEND

GAS		G
COMMUNICATION		C
DRAINAGE		D
UNIDENTIFIED PIPELINE		U
ELECTRICAL		E
WATER		W
SEWER		S
SUBJECT BOUNDARY		
ADJOINING BOUNDARIES		
CONTOUR MINOR		-0.25
CONTOUR MAJOR		-1.00
DIRECT BURIED		DB
UNABLE TO TRACE		UTT
END OF SERVICE (EOS)		E
END OF TRACE (EOT)		J
SERVICE CODE		TD
"IL" INVERT LEVEL "TC" TOP CENTRE RL		IL2.00
"UNK" SERVICE DEPTH & QUALITY UNKNOWN		{3.00}A
DIAMETER		Ø0.1

DRAWING TITLE

SUI & DETAIL  
SURVEY PLAN

REV.	DESCRIPTION	DATE
A	Survey for Issue	29.07.25
B	Prev. Survey LVLs added	27.08.25
-	-	-
-	-	-
-	-	-

QUALITY ASSURANCE

Surveyor	Kye Murray	Date of Survey	24.07.25
Checked by	Amanda Santos	Date	27.08.25
Approved by	Jordan Palleson	Date	27.08.25
Drafter	Adam Cameron	Date of Plan	27.08.25

The successful completion of quality assurance confirms that the survey work and drawings comply with the requirements outlined in the Quality Plan. With special reference to fully completed, all information contained in these drawings should be considered preliminary and unchecked.

Datum Origin: SS141886 RL 51.065 Coordinates: MGA2020 256 (AHD71)

Sheet Size A1 @ Scale: 1:75

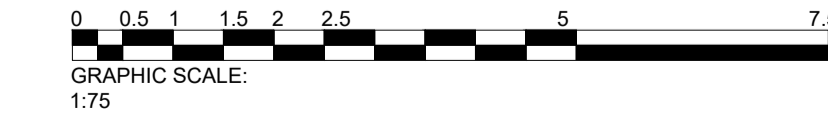

Type of Survey: SUI & DETAIL SURVEY PLAN Sheet Page 31 of 31

Job Number: ASP250432-DET-01[B] Current Revision: B

Copyright © 2025 Geosurv Pty Ltd. All rights reserved. This document, whether in electronic or hardcopy form, is confidential and remains the property of Geosurv. It must not be reproduced or used for any other project without written approval from Geosurv.