

11th May 2022

Peta-Claire Brunel
Senior Planner
Beca

Peta.Brunel@beca.com

RE: PROPOSED DEVELOPMENT WITHIN ENDEAVOUR ENERGYS TRANSMISSION EASEMENT
- LOT 101 DP851785 HN 554-562 RESERVIOR ROAD, PROSPECT.

Reference is made to your recent inquiry to Endeavour Energy regarding the abovementioned property which is affected by the 40m wide Electricity Easement for the 33kv Transmission lines, feeders 434 / 435 / 440 from Blacktown Transmission Station. Consequently, the property is subject to some restrictions within the easement area.

Electricity easements are acquired by Endeavour Energy to provide adequate working space along the route of the line for construction, access, and maintenance work. These easements are also acquired to ensure that no work or other activity is undertaken under or near the line or the structures that could either by accident or otherwise create an unsafe situation for persons or for the security of the line.

It is imperative that the easement area surrounding Endeavour Energy's Asset's is kept clear of all obstructions, encumbrances, and other services in order to provide a safe work area for Endeavour Energy personnel to ensure compliance with Safe Work and the Work, Health & Safety legislation.

With the above in mind Endeavour Energy has **No Objection** to the proposed development works as detailed in the plans supplied to this office, but subject to agreement in writing **within 30 days** of the date of this letter to the following conditions.

- Statutory clearances to the conductors are to be maintained at all times. It should be noted that power lines are designed to allow for sag and swing sideways, consequently allowance for this needs to be considered at all times. The statutory clearance from 0kv to 132kv conductors is 3 metres, in all directions, at all times. This measurement applies to, but is not limited to; persons, vehicles, hand tools and equipment, cranes, lifting gear, plant, and load. Consideration needs to be given and the clearances increased where there is the likelihood of any inadvertent movement or swinging of the plant, crane, load or lifting gear towards the power lines.
- During construction, bunting shall be used to indicate the maximum height clearances and vehicle impact bollards are to be installed around Endeavour Energy's pole structures.
- On the completion of works, a thrie- bream vehicle barrier will be installed around Endeavour Energy's pole structure's and be appropriately earthed.
- The two staircases that have been identified within the easement, must be appropriately earthed if the construction material is deemed to be conductive.

- Should any earthing be disturbed on the pole structures whilst work is being carried out, **all work** should immediately cease, and Endeavour Energy notified so that the earthing can be reinstated.
- Vehicles, plant, or equipment having a height when fully extended that exceeds 4 metres shall not travel through the easement area without the prior written approval of Endeavour Energy. Vehicles with extendable operating equipment i.e., earth moving vehicles, loaders; tip trucks, cranes, etc. are not to be operated within the easement except with that equipment in the travelling position. Aerial boom concrete pumps are not permitted in any overhead easement.
- All personnel are to be advised of the hazards of working in close proximity to high voltage wires. Extreme caution to be observed when working within the easement area and around any poles and structures.
- All machinery or plant within an electricity easement is to be operated by adequately trained and accredited persons.
- Endeavour Energy recommends the use of a suitably trained safety observer when work is being carried out within the easement area.
- A hazard identification and risk assessment should be carried out within the easement area. A safe work method statement should be provided for any work carried out within the easement area. All staff should be briefed regularly, or when there are any changes, as to the contents of the risk assessment and safe work method statement.
- For the attention of staff and visitors to the site and to ensure constant vigilance, Endeavour Energy recommends that clearly visible safety signs be erected, in accordance with the relevant safety standards, alerting attention to the transmission lines and associated hazards.
- The area within the easement is not to be used for the loading or unloading of trucks unless it is directly related to the construction work.
- The area within the easement is not to be used for storage or stacking of goods or materials, especially flammable or explosive material.
- No soil or other material is to be stored, within the easement area.
- The cutting and filling of the surface land must be minimal throughout the easement area. **Electrical Safety Clearances must be maintained.** The area after the development must be clear, accessible and be able to support mobile plant and equipment up to 30 tonnes.
- Unobstructed access to the easement area and associated structures must be available on a 24hr/7day a week basis. Any locked gates are to have an Endeavour Energy lock incorporated in the locking system.

- Any future proposed works incorporating the existing metal fence and stormwater piping augmentation will need to be assessed.
- All approvals granted are subject to the encroachment being removed or relocated at the Owners Expense should Endeavour Energy require this for maintenance, construction or emergency works.
- Endeavour Energy **will not take any responsibility** for any damage occurring to the proposed development within our Transmission Easement, whilst or after any maintenance, construction or emergency work has been carried out by our staff or our associated contractors.

Should you have any further questions regarding this, or any other matter please do not hesitate to contact Endeavour Energy.

Regards



Jeff Smith

Easement Management Officer

Property Services

Endeavour Energy

D: 02 98537139

F: 02 98537100

M: 0408665193

T: 131 081

E: Jeffrey.Smith@endeavourenergy.com.au

43 Glendenning Road, Glendenning. NSW 2761.

www.endeavourenergy.com.au

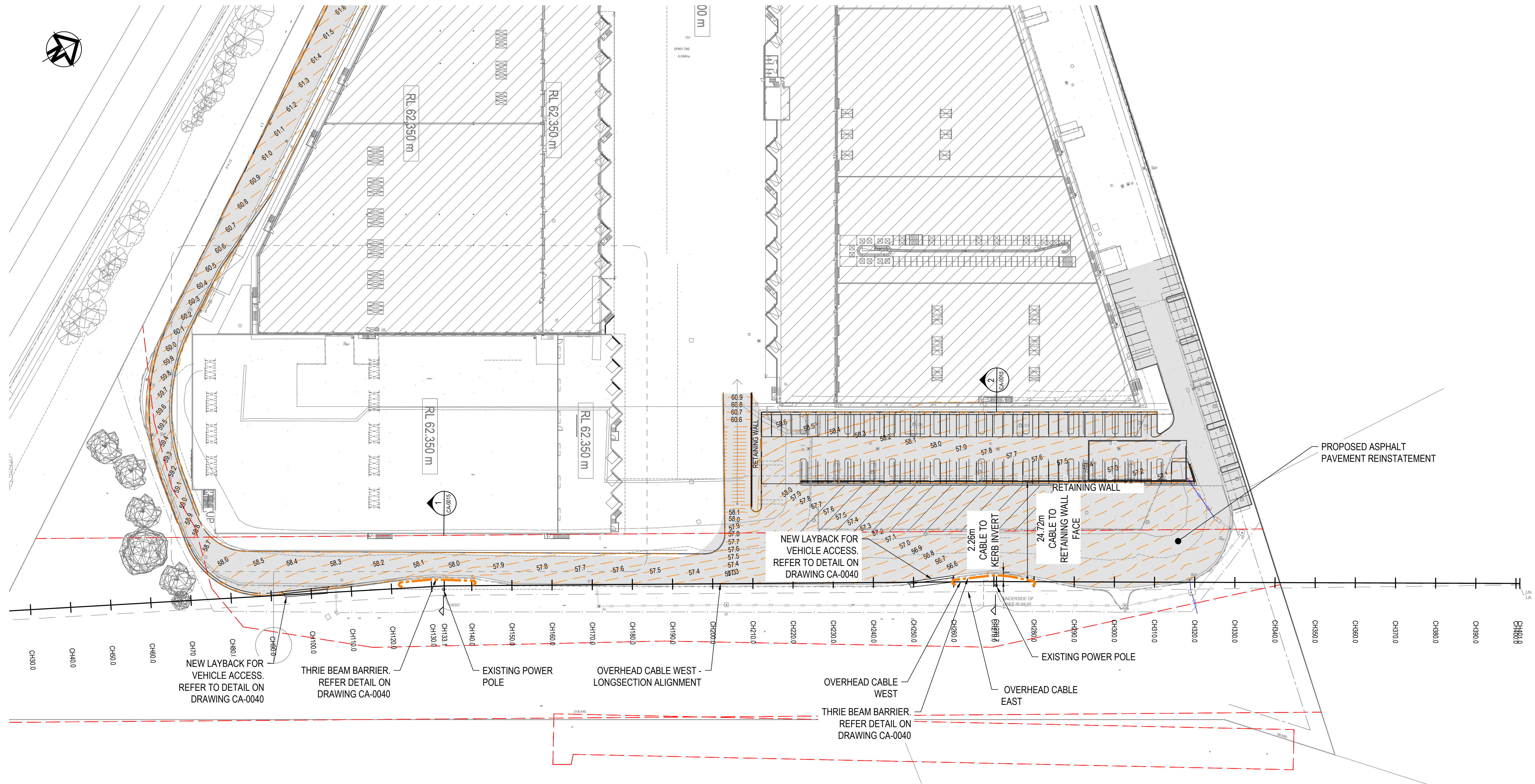

LEGEND

- EASEMENT
- SITE BOUNDARY
- PROPOSED CONTOUR & LEVEL
- PROPOSED RETAINING WALL
- PROPOSED KERB
- EXISTING KERB
- PROPOSED STORMWATER PIPE
- PROPOSED PITS
- EXISTING STORMWATER PIPE
- PROPOSED THRIE BEAM
- PROPOSED ASPHALT PAVEMENT

No.	Revision	By	Chk	Appd	Date
B	ISSUED FOR INFORMATION	CY	EM	B.S	12.04.22
A	ISSUED FOR INFORMATION	CY	EM	B.S	22.03.22

Original Scale (A1)	Design	C.YIP	12.04.22
1:500m	Drawn	C.YIP	12.04.22
Reduced Scale (A3)	Drawn	B.STRANG	12.04.22
1:1000m	Drawn	E.MORATIS	12.04.22



Client: PROJECT SOUTH EXPANSION
560 RESERVOIR ROAD, PROSPECT, NSW,2148
AUSTRALIA

Discipline: CIVIL
Drawing No: 2444390-DWG-CA-0004
Beca Project Number: 2444390-DWG-CA-0004

Rev: B



PRELIMINARY
NOT FOR CONSTRUCTION

LEGEND

- CUT -4.00m+
- CUT -3.75m to -4.00m
- CUT -3.50m to -3.75m
- CUT -3.25m to -3.50m
- CUT -3.00m to -3.25m
- CUT -2.75m to -3.00m
- CUT -2.50m to -2.75m
- CUT -2.25m to -2.50m
- CUT -2.00m to -2.25m
- CUT -1.75m to -2m
- CUT -1.5m to -1.75m
- CUT -1.25m to -1.5m
- CUT -1.0m to -1.25m
- CUT -0.75m to -1.0m
- CUT -0.5m to -0.75m
- CUT -0.25m to -0.5m
- CUT -0.0m to -0.25m
- FILL 0.0m to 0.25m
- FILL 0.25m to 0.5m
- FILL 0.5m to 0.75m
- FILL 0.75m to 1.0m
- FILL 1.0m to 1.25m
- FILL 1.25m to 1.5m
- FILL 1.5m to 1.75m
- FILL 1.75m to 2.0m
- FILL 2.0m to 2.25m
- FILL 2.25m to 2.5m
- FILL 2.5m to 2.75m
- FILL 2.75m to 3.0m
- FILL 3.0m+

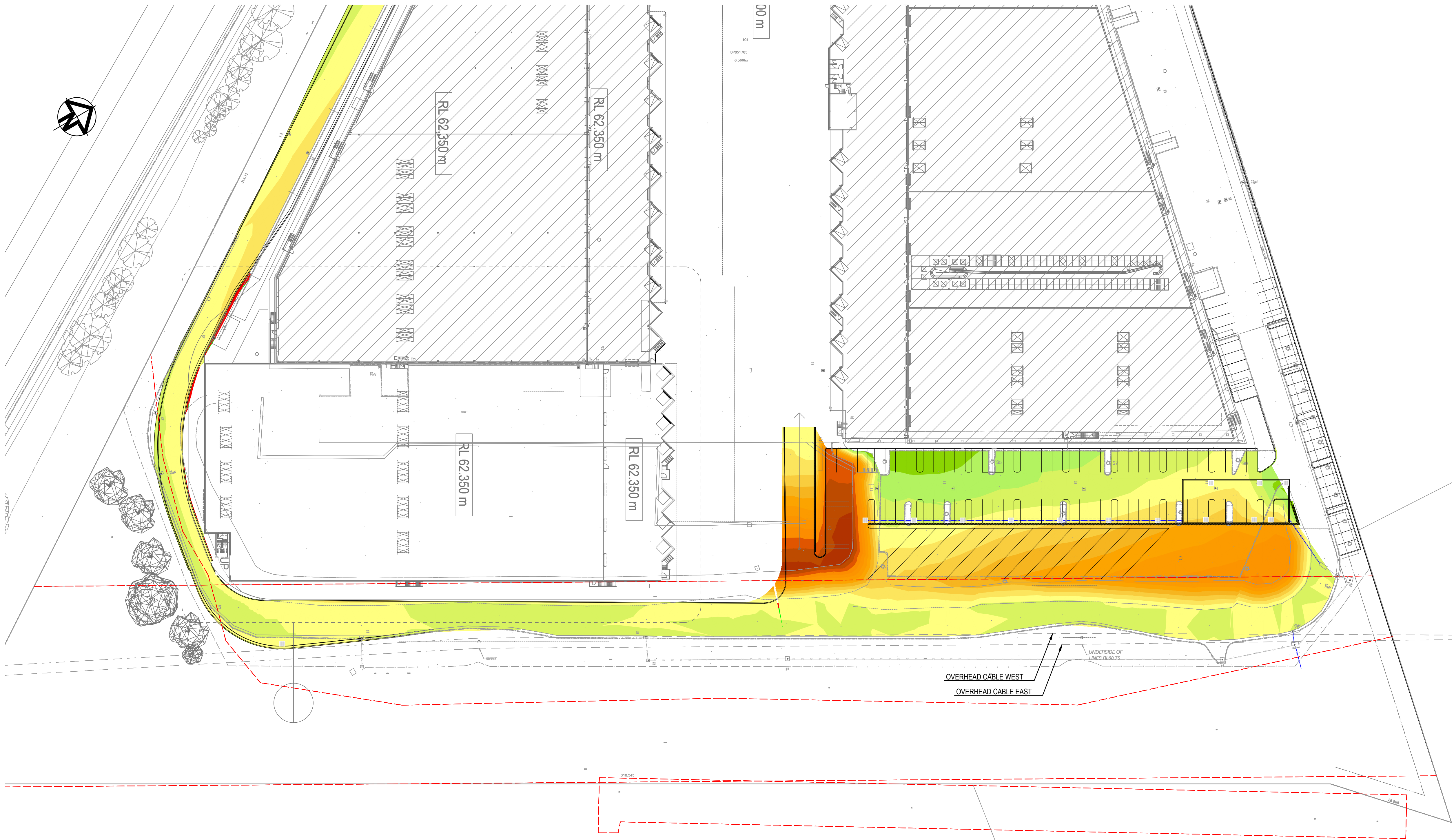

ISSUED FOR INFORMATION		C.Y.	E.M.	B.S.	22.03.22
No.	Revision	By	Chk	Appd	Date

Original Scale (A1)	Design	C.Y.P.	22.03.22	Approved For Construction*
1:500m	Drawn	C.Y.P.	22.03.22	
Reduced Scale (A3)	Design Verifier	B.STRANG	22.03.22	
1:1000m	Design Check	E.MORAITIS	22.03.22	
* Refer to Revision 1 for Original Signature				



Project:	PROJECT SOUTH EXPANSION
	560 RESERVOIR ROAD, PROSPECT, NSW,2148
	AUSTRALIA

Title:	CUT & FILL DEPTH PLAN
--------	-----------------------

Discipline	CIVIL
Drawing No.	2444390-DWG-CA-0005
Beca Project Number:	
Rev.	A



PRELIMINARY
NOT FOR CONSTRUCTION

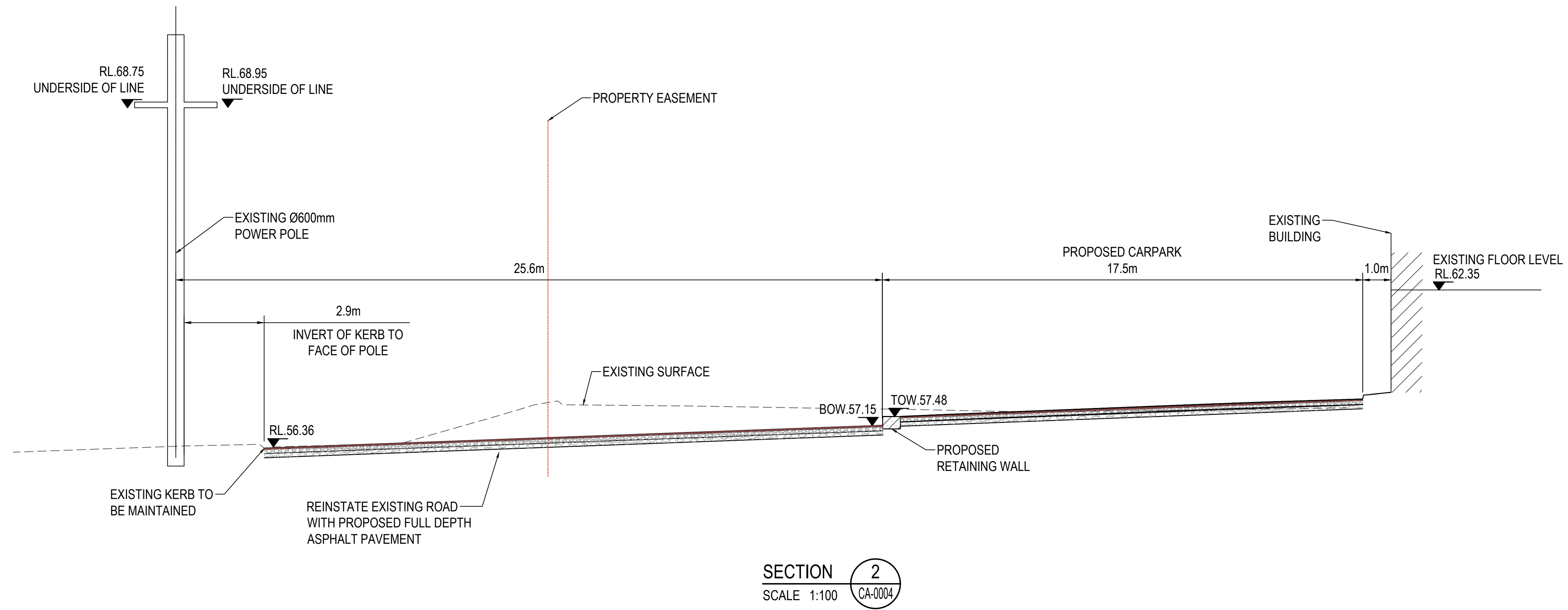
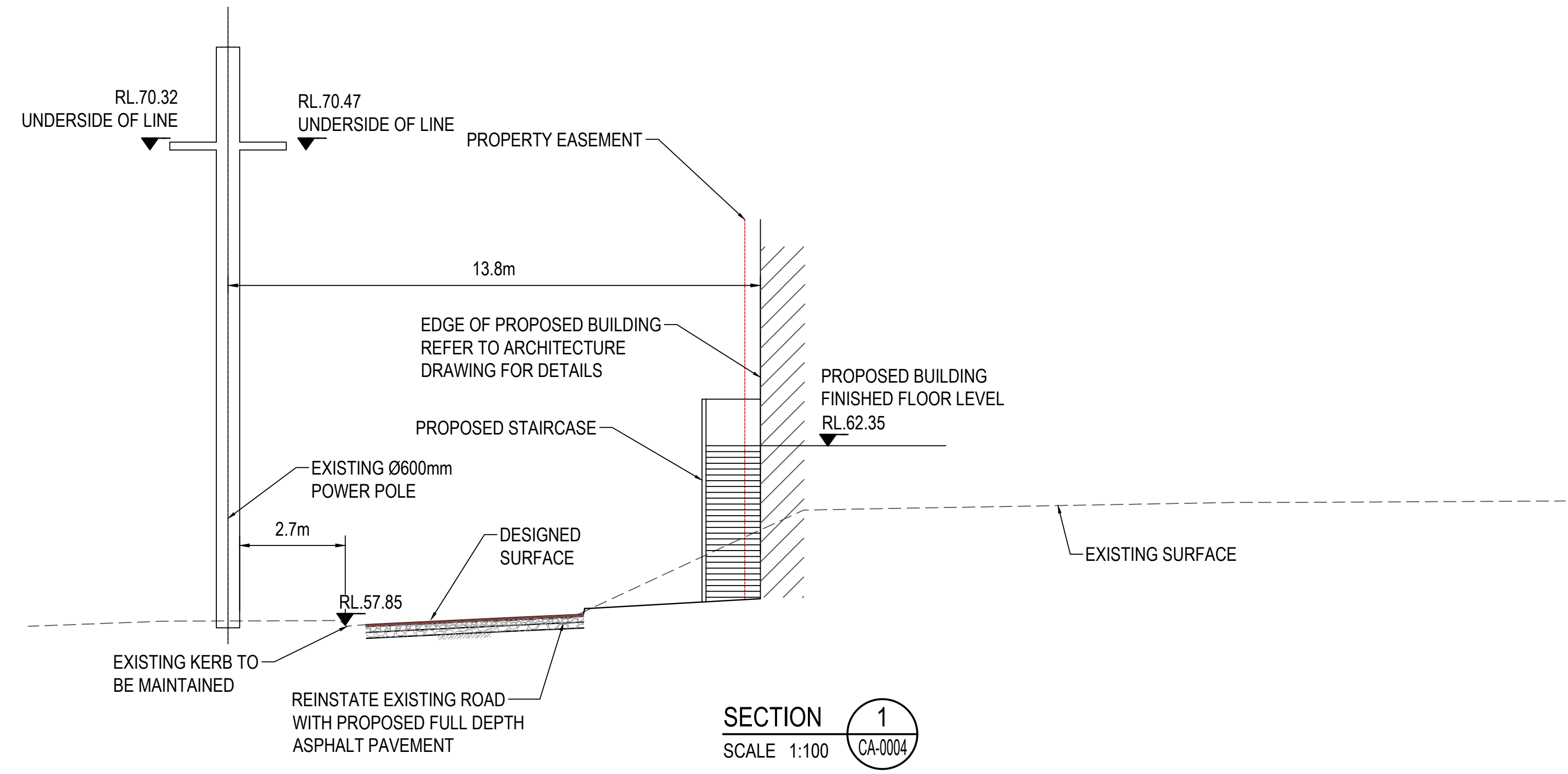

A	ISSUED FOR INFORMATION	C.Y.	E.M.	B.S.	12.04.22
No.	Revision	By	Chk	Appd	Date

Original Scale (A1)	Design	E.MORAITIS	12.04.22
1:500m	Drawn	C.YIP	12.04.22
Reduced Scale (A3)	Drawn	B.STRANG	12.04.22
1:1000m	Check	E.MORAITIS	12.04.22



Project:	PROJECT SOUTH EXPANSION
	560 RESERVOIR ROAD, PROSPECT, NSW,2148
	AUSTRALIA

Title:	STE SECTIONS
--------	--------------

Discipline	CIVIL
Drawing No.	2527456-DWG-CA-0015
Beca Project Number:	
Rev.	A

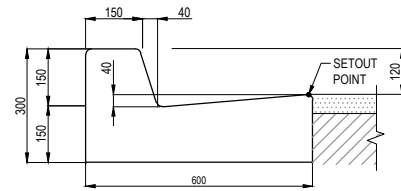

KERB AND GUTTER (K.G)

SCALE 1:10

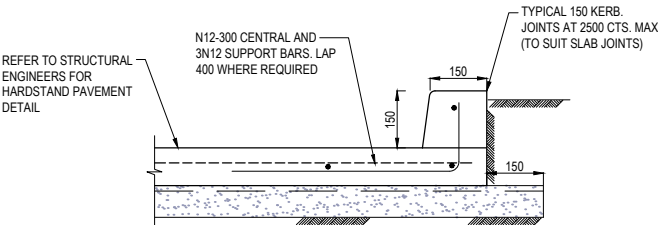

INTEGRAL KERB (I.K)

SCALE 1:10

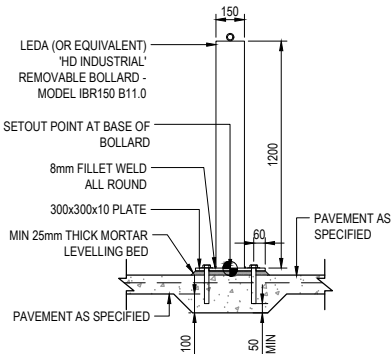

PERMANENT (CONCRETE PAVEMENT)

SCALE 1:20

NOTE:
ALL ELEMENTS TO BE GALVANISED.
CONTRACTOR TO ENSURE BOLLARDS DO NOT CONFLICT
WITH PROPOSED OR EXISTING SERVICES.
BOLLARD TO BE STRICTLY INSTALLED TO MANUFACTURERS
DETAILS AND SPECIFICATIONS

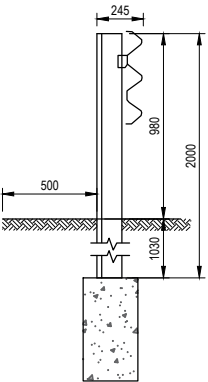

THRIE BEAM BARRIERS

1:20

REFER TO MANUFACTURERS DETAILS

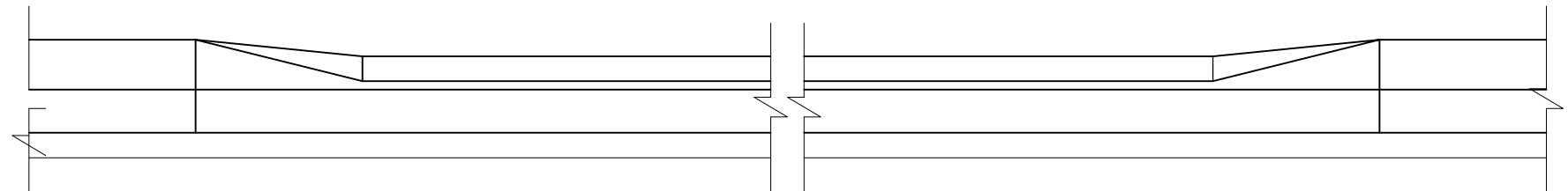

ELEVATION

SCALE 1:20

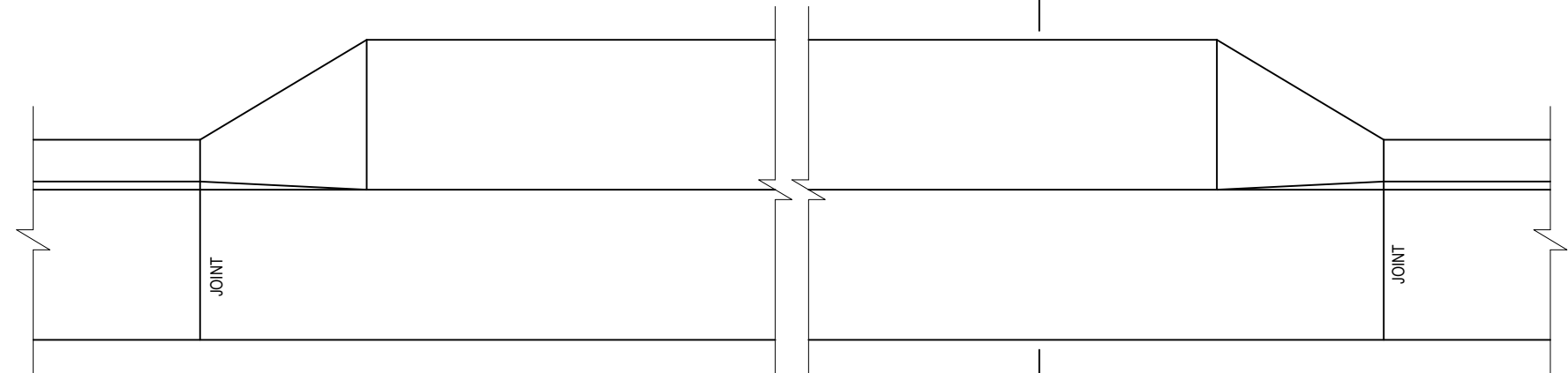
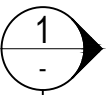

PLAN
SCALE 1:20
VEHICULAR CROSSING

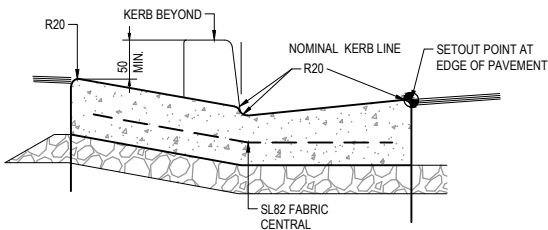

SECTION 1
SCALE 1:10

No.	Revision	By	Chk	Appd	Date
+	UNDER REVISION				

Original Scale (A1)	Design			Approved For Construction*
Reduced Scale (A3)	Drawn			Date
	Design Verifier			
	Design Check			
* Refer to Revision 1 for Original Signature				



Client:		Project:	
---------	--	----------	--

Title:	
--------	--

Discipline	
Drawing No.	Beca Project Number:
Rev.	

PRELIMINARY
NOT FOR CONSTRUCTION

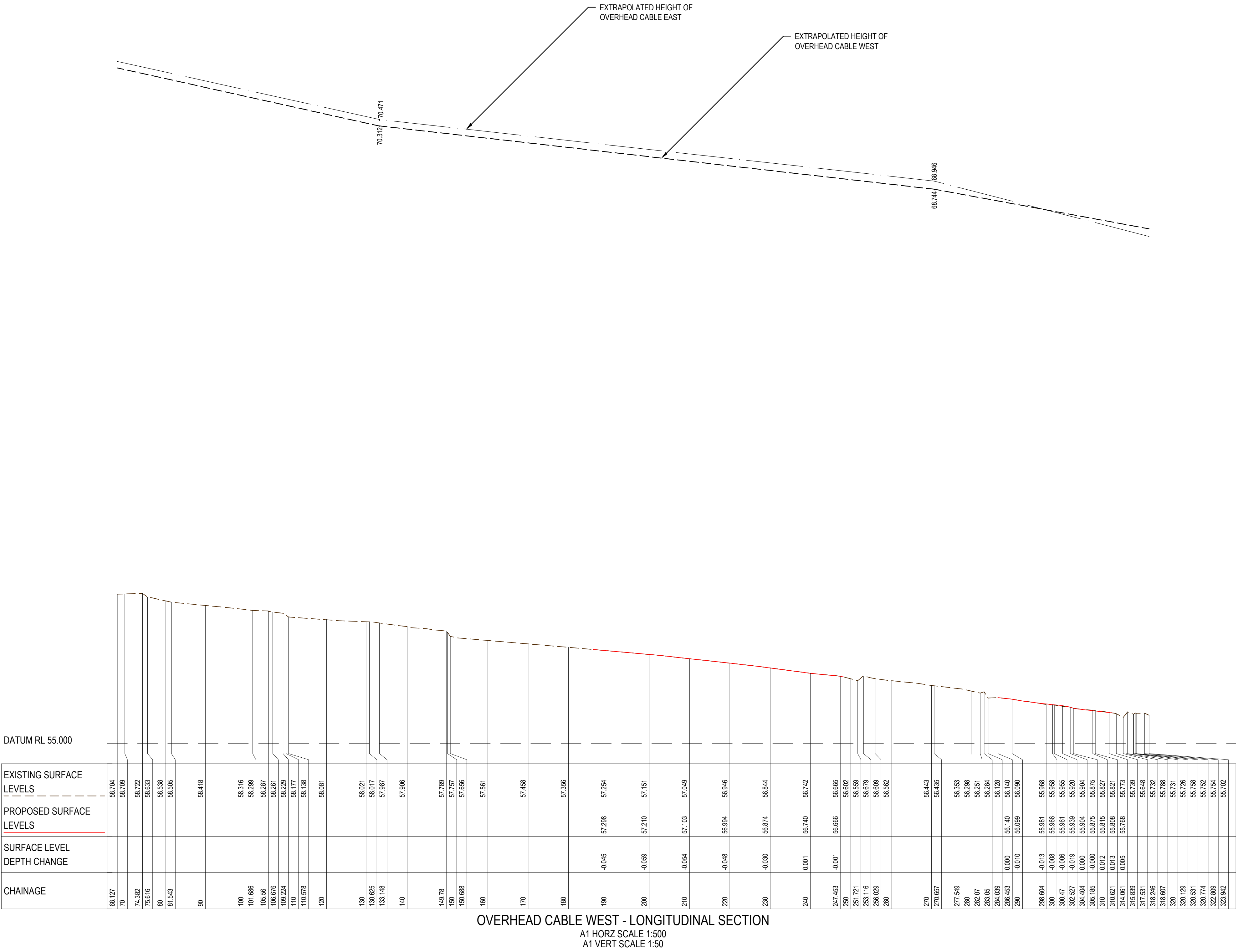

A	ISSUED FOR INFORMATION	C.Y.	E.M.	B.S.	22.03.22
No.	Revision	By	Chk	Appl	Date

Original Scale (A1) 1:500m	Design Drawn Dig. Verifier Dig. Check	C.Y.P. C.Y.P. B.STRANG E.MORAITIS	22.03.22 22.03.22 22.03.22 22.03.22	Approved For Construction* Date
Reduced Scale (A3) 1:1000m	* Refer to Revision 1 for Original Signature			



Client:	Project:
	PROJECT SOUTH EXPANSION 560 RESERVOIR ROAD, PROSPECT, NSW,2148 AUSTRALIA

Title:
OVERHEAD CABLE LONGSECTION EAST

Discipline CIVIL	Rev. A
Drawing No. 2444390-DWG-CA-0003	
Beca Project Number:	



PRELIMINARY
NOT FOR CONSTRUCTION