

TRAFFIC MANAGEMENT PLAN

Bringelly Road Business Hub

Corner of Bringelly Road & Cowpasture Road, Leppington

Issue 4.0 – January 2018

DEVELOPING
RELATIONSHIPS
BUILDING
SUCCESS



TABLE OF CONTENTS

1. INTRODUCTION.....	3
2. SITE ENTRY AND EXIT POINT FOR WORKERS	3
3. PARKING ARRANGEMENTS	4
4. OUT OF HOURS WORKS, MAJOR ACTIVITIES ETC.	4
5. TRAFFIC CONTROLLER COMPETENCIES/QUALIFICATION REFERENCES ..	5
6. ADDITIONAL DOCUMENTATION	6
7. SITE PLAN	7
8. EXTERNAL TRAFFIC LAYOUT PLAN	8
9. INTERNAL TRAFFIC LAYOUT PLAN	12

1. INTRODUCTION

Prepared By (CIP): Madeleine Iles

Reviewed By (CIP): Fred Knox

Qualified Traffic Management Designer (External): LACK Group

The Project Team developed this Traffic Management Plan ("TMP") by considering both the internal and external traffic management issues applicable for this project and the completion of the Traffic Management Risk Assessment Form (C-S-SSMP-055).

Traffic guidance schemes external to the project boundaries must be prepared, approved and modified by a qualified traffic management designer and the implementation, setting out and/or monitoring of the approved traffic guidance scheme must also be undertaken by appropriately qualified personnel (refer Section 5)

Consideration and reference should be made to the local traffic control authority requirements (e.g. RMS) in completing the TMP.

The TMP should be reviewed and amended to reflect specific traffic management controls as the construction progresses.

2. SITE ENTRY AND EXIT POINT FOR WORKERS

(e.g. private vehicles, buses etc.)

The following safety features are in place to ensure that the entry and exit to and from site is undertaken in a safe manner:

- 2.1. Entry and exit signage is located at:
 - Gate 0 (Light Vehicle Entry/Exit)
 - Gate 1 (Truck/Plant Entry/Exit)
- 2.2. Designated pick up and drop off areas for emergency services are located at:
 - Gate 0
- 2.3. Designated pick up and drop off areas for materials and supplies are located at:
 - Alongside Site Shed designated zone
- 2.4. Designated entry and exit paths for heavy vehicles, trucks, plant & equipment, etc. are located at:
 - See attached TMP
- 2.5. Site office and sign in area is clearly marked by:
 - Signage at entry and on site compound
- 2.6. Designated pedestrian walkways/crossings are:
 - Located at Gate 0; and
 - Supervised by CIP
- 2.7. Traffic/crossing controllers utilise the following safety aids and personal protective equipment (PPE):

- “Lollipop” sign;
 - Road signage and bollards; and
 - High visibility jacket
- 2.8. Pedestrian walkways are physically protected from designated barriers/fencing by:
- Bollards
- 2.9. Pedestrian walkways are clearly marked/indicated by:
- TMP signage as per approved LACK Group TMP and CIP internal signage
- 2.10. Speed limit within site is 10km/hr
- 2.11. Speed restriction signage is clearly displayed in the workplace at the following locations:
- Gate 0 and Gate 1
- 2.12. Speed controlling devices are in place to restrict vehicle speed on site:
- Signage and traffic controllers (internal and external)
- 2.13. Specific controls for delivery of fuel/chemicals on site are:
- Designated loading/unloading areas
 - PPE requirements
 - Spill control requirements
 - Exclusion zones
 - Use of Hazchem container when required
- 2.14. Other considerations or risk controls that need to be documented
- Vehicles are prevented from accessing any areas delineated signed as prohibited
 - Spotters required supervising the movement of heavy vehicles, plant, equipment, etc.

3. PARKING ARRANGEMENTS

The following safety arrangements and features are in place to minimise the risks associated with vehicle parking:

- 3.1. There are 10 car parks available for workers, 5 car parks available for visitors and 0 car parks available for people with disabilities.
- 3.2. Car parking areas are clearly designated with signage displayed in the following areas:
- One sign indicating parking at entrance to site shed complex
 - No parking areas are located on Bringelly Road as per Council signage
 - Parking limits on street are: no parking
- 3.3. Signage identifying the whereabouts of the Site Office/Reception is clearly visible from the car park and is located at:
- Gate 0 and Gate 1
- 3.4. Other considerations or risk controls that may need to be documented?
- PPE required outside of site shed complex, as signed
 - Pedestrian only pathways located at Gate 0

4. OUT OF HOURS WORKS, MAJOR ACTIVITIES ETC.

(e.g. extended concrete pours, heavy haulage, crane lifts, etc.)

Traffic control requirements for major activities may vary. Specific control measures will need to be determined through a traffic risk assessment process taking into consideration learning's from previous such activities.

The following broad safety arrangements and features are in place to minimise the risks associated with major activities in conjunction with previously documented control measures:

- 4.1. Appropriate numbers of traffic controllers will be in place for all major activities to restrict/direct traffic to and from the site;
- 4.2. Additional car parking areas are unavailable.
- 4.3. Other considerations or risk controls that need to be documented:
 - Pedestrian only pathways located at Gate 0
 - Lighting required for any works before dawn or after dusk
 - PPE required outside of site shed complex, as signed

5. TRAFFIC CONTROLLER COMPETENCIES/QUALIFICATION REFERENCES

NEW SOUTH WALES (Roads and Maritime Services)					
TRAFFIC CONTROLLER		IMPLEMENT TRAFFIC CONTROL GUIDANCE SCHEME		TRAFFIC MANAGEMENT PLAN PREPARATION	
Personnel performing stop/slow duties only.		All field personnel responsible for setting out, implementing and/or monitoring a TGS (as required by a TMP).		All personnel responsible for preparing, approving, reviewing and/or making modifications to a TMP (including worksite hazard assessment).	
COMPETENCY	QUALIFICATION REFERENCE	COMPETENCY	QUALIFICATION REFERENCE	COMPETENCY	QUALIFICATION REFERENCE
Work safely and follow WHS policies and work procedures.	RIIWHWS201D	Work safely and follow WHS policies and work procedures.	RIIWHWS201D	Work safely and follow WHS policies and work procedures.	RIIWHWS201D
Communicate in the workplace.	RIICOM201D	Communicate in the workplace.	RIICOM201D	Apply risk management processes.	RIIRIS301D
Control traffic with a stop/slow bat.	RIIWHWS205D	Implement traffic management plan.	RIIWHWS302D	Apply, monitor and report on compliance systems.	RIIGOV401D
				Prepare work zone traffic management plan.	RIICWD503D
Course does NOT qualify a participant to set up or work with traffic control plans.		Course does NOT qualify a participant to control traffic with a stop/slow bat, or to modify existing traffic control plans.		Course does NOT qualify a participant to control traffic with a stop/slow bat or set up work with traffic control plans.	

6. ADDITIONAL DOCUMENTATION

Append any additional/relevant documentation.

The map shows the proposed site for the new stadium and arena, located on the eastern side of the city. The stadium is located on the northern side of the site, and the arena is located on the southern side. The map includes a north arrow and a scale bar. The stadium and arena are shown as large, dark, irregular shapes. The surrounding area is shown with contour lines and various labels for roads, parking areas, and other features. The map is oriented with the stadium at the top and the arena at the bottom.

8. EXTERNAL TRAFFIC LAYOUT PLAN

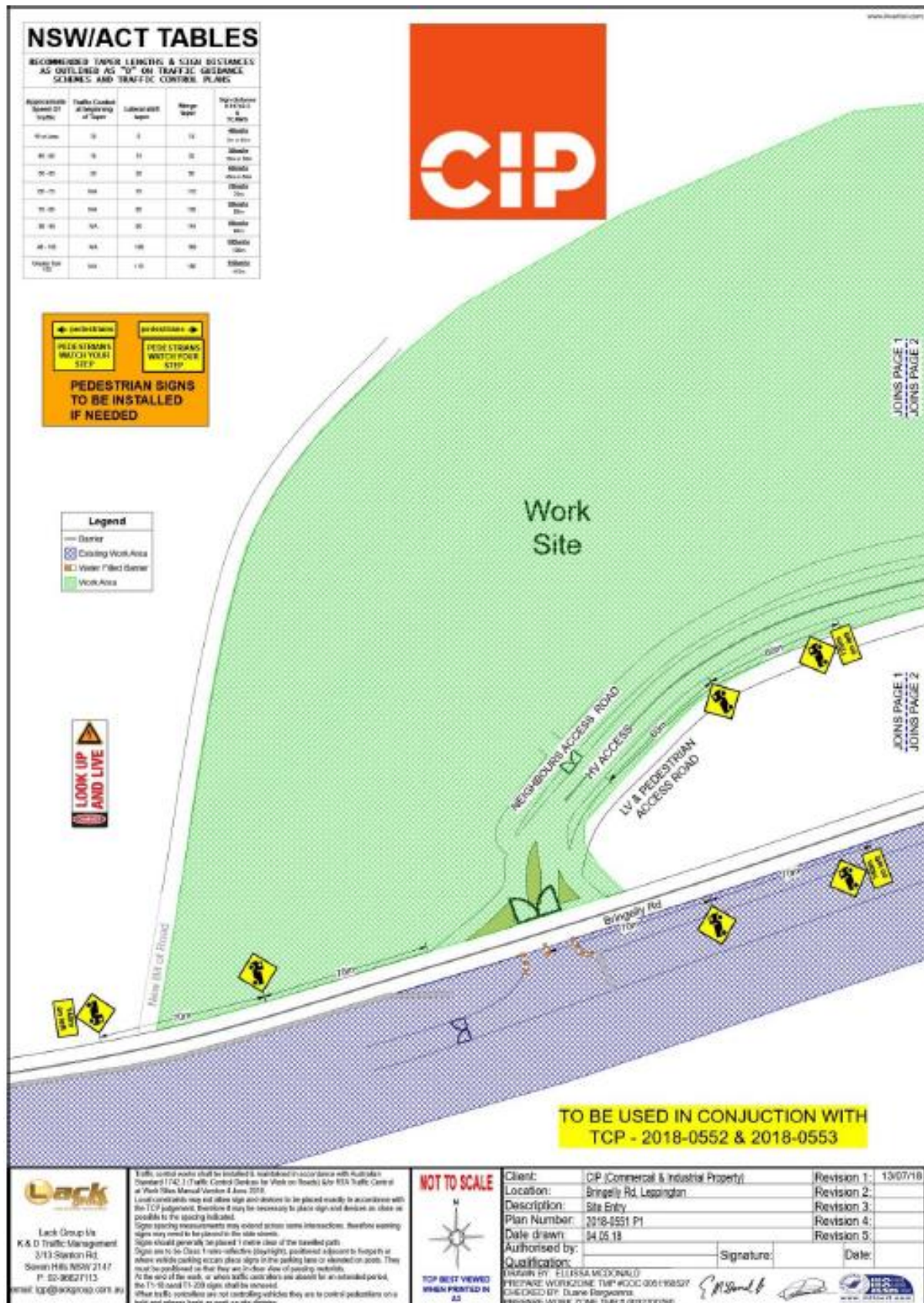



TO BE USED IN CONJUNCTION WITH
TCP - 2018-0551 & 2018-0553

NSW/ACT TABLES

RECOMMENDED TAPER LENGTHS & SIGN DISTANCES
AS OUTLINED AS "T" OR TRAFFIC GUIDE
SCHEMES AND TRAFFIC CONTROL PLANS

Approximate Speed (km/h) at night	Traffic Control at night	Length of taper	Sign distance at night	Sign distance at night
40-49	0	0	0	0
40-49	10	10	10	10
40-49	20	20	20	20
40-49	30	30	30	30
40-49	40	40	40	40
40-49	50	50	50	50
40-49	60	60	60	60
40-49	70	70	70	70
40-49	80	80	80	80
40-49	90	90	90	90
40-49	100	100	100	100
40-49	110	110	110	110
40-49	120	120	120	120
40-49	130	130	130	130
40-49	140	140	140	140
40-49	150	150	150	150
40-49	160	160	160	160
40-49	170	170	170	170
40-49	180	180	180	180
40-49	190	190	190	190
40-49	200	200	200	200

Legend
Barrier
Existing Work Area
Water Filled Barrier
Work Area



JOINS PAGE 1
JOINS PAGE 2

JOINS PAGE 1
JOINS PAGE 2

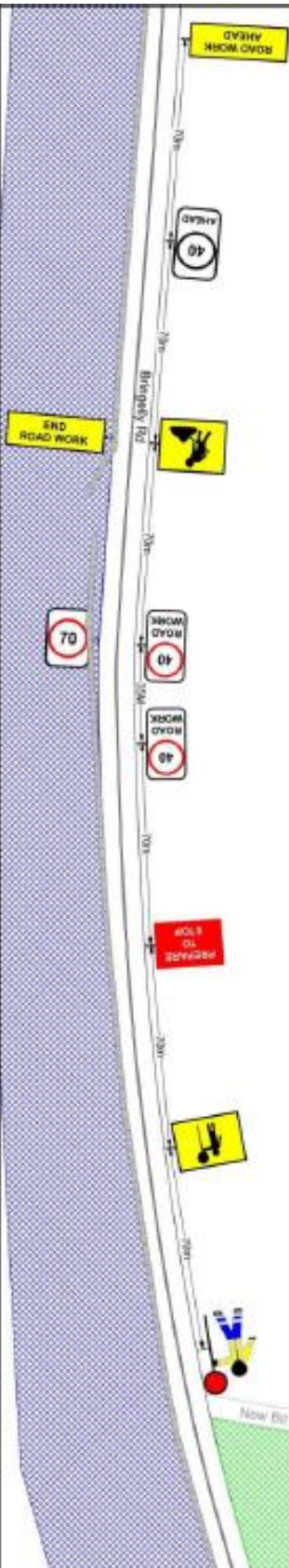

Lack Group Ltd
K & D Traffic Management
213 Stanton Rd.
Seven Hills NSW 2147
P: 02 9662 7113
email: info@lackgroup.com.au

Traffic control signs must be installed & maintained in accordance with Australian Standard 1742.1, Traffic Control Devices by Road or Mobile, last R14 Traffic Control at Road Work Edition Version 6 June 2010.
Local authorities may not allow sign and devices to be placed exactly in accordance with the TCP judgement. Therefore it may be necessary to place sign and devices as close as possible to the spacing recommended.
Signs spacing recommendations may extend across some intersections, therefore warning signs must be placed in the road ahead.
Signs should be placed in the road ahead of the work zone.
Signs are to be Class 1 retro reflective (SRR), positioned adjacent to the road or where vehicle speed is slow, above the line of the road or above the road.
At the end of the work, or when traffic conditions are adverse for an extended period, the T-1, T-1B and T-1B signs shall be removed.
When traffic conditions are not improving vehicles they are to control pedestrians on a road and release buses as work or site deplete.

NOT TO SCALE

TCP BEST VIEWED WHEN PRINTED IN A3

Client: CIP (Commercial & Industrial Property)

Location: Birgely Rd, Leppington

Description: Sign/Slow - Site Entry Signage

Plan Number: 2018-0552 P1

Date drawn: 05.05.18

Authorised by: [Signature]

Signature: [Signature]

Date: [Date]

Qualification: [Qualification]

DRAWN BY: ELISSA McDONALD

PREPARE WORKZONE TAP: AOC 0051168527

CHECKED BY: Duane Bannister

PREPARE WORK ZONE TAP # 0002700780

Revision 1: [Date]

Revision 2: [Date]

Revision 3: [Date]

Revision 4: [Date]

Revision 5: [Date]



TO BE USED IN CONJUNCTION WITH
TCP - 2018-0551 & 2018-0553

Legend	
	Barrier
	Existing Work Area
	Water Filled Barrier
	Work Area

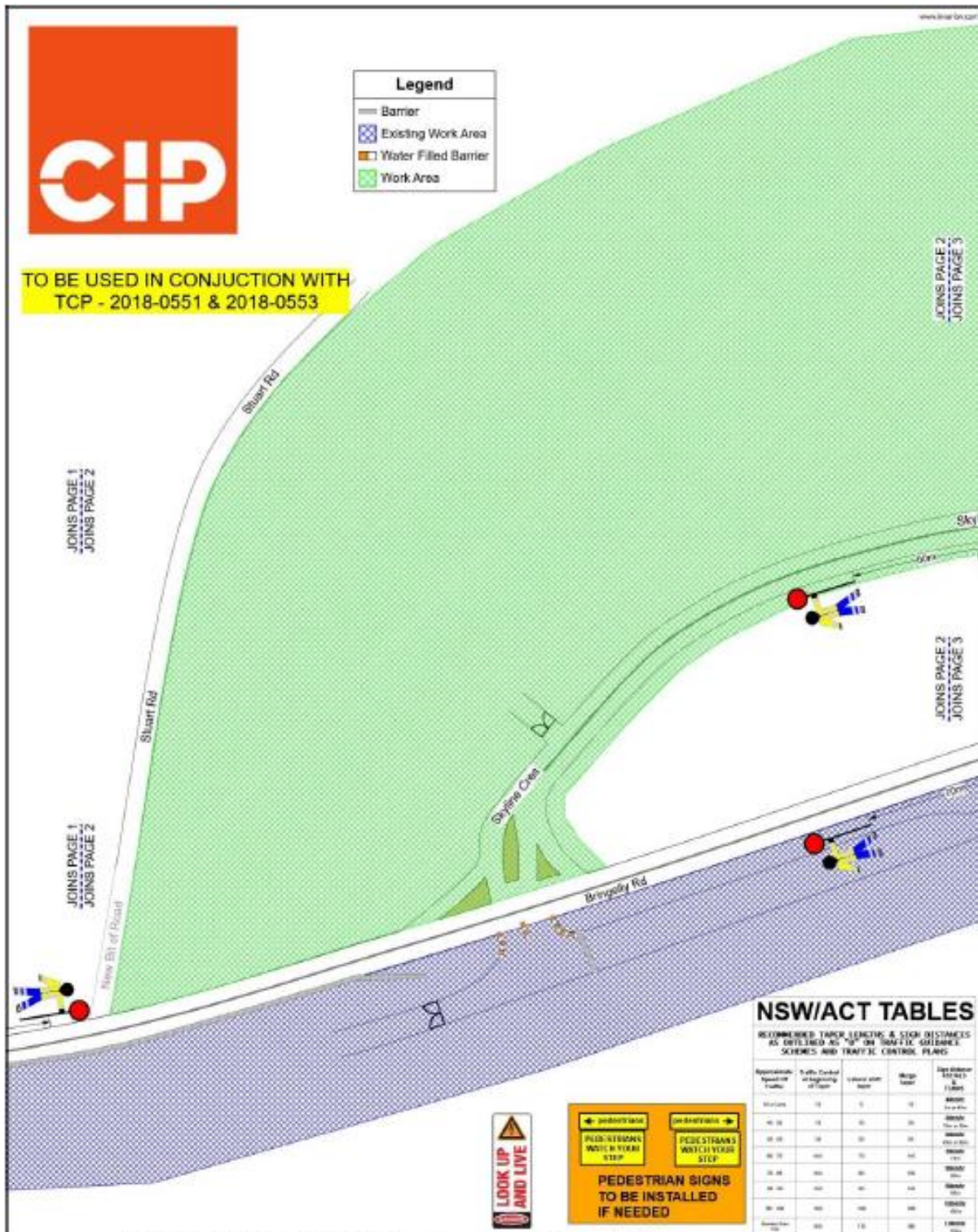

NSW/ACT TABLES

RECOMMENDED TAPOR LENGTHS & SIGN DISTANCES
AS OBTAINED AS "0" ON TRAFFIC GUIDANCE
SCHEMES AND TRAFFIC CONTROL PLANS

Speed Limit (km/h)	Traffic Control at beginning of sign	Vehicle width (m)	Sign width (m)	Sign distance (m) to start of work
40-60	10	2	10	100
60-80	15	3	15	150
80-100	20	4	20	200
100-120	25	5	25	250
120-140	30	6	30	300
140-160	35	7	35	350
160-180	40	8	40	400
180-200	45	9	45	450
200-220	50	10	50	500

Lack
Lack Group Pty
K.A.D. Traffic Management
2/13 Stanton Rd.
Seven Hills NSW 2147
P: 02 95527115
email: lp@lackgroup.com.au

Traffic control units shall be installed & maintained in accordance with Australian Standard 1162.3 (Traffic Control Devices for Work on Roads) and RTA Traffic Control at Work Sites Manual (Version 4, June 2018).
Local authorities may not allow signs and devices to be placed on roads in accordance with the TCP subpart. Roadside it may be necessary to place signs and devices as close as possible to the spacing indicated.
Sign spacing measurements may extend across some intersections. Roadside warning signs may need to be placed on the side street.
Signs should generally be placed 1 metre clear of the kerbside path.
Signs are to be Class 1 reflective (daylight), positioned adjacent to footpaths or where vehicle parking occurs, placed signs on the parking lanes or adjacent to paths. They must be positioned so that they are in clear view of passing motorists.
At the end of the work, or when traffic controllers are absent for an extended period, the T1-18 and T1-281 signs shall be removed.
Other traffic controllers are not controlling vehicles they are to control pedestrians on a hold and release basis as work on the site.



Client: CIP (Commercial & Industrial Property)
Location: Bringley Rd, Leppington
Description: Stop/Slow - Site Entry Signage
Plan Number: 2018-0552 P2
Date drawn: 03.05.18
Authorised by: [Signature]
Qualification: [Signature]
DRAWN BY: ELLISSA McDONALD
CHECKED BY: DORIS ROBERTSON
PREPARED WORK ZONE TMP (2000 00518652)
Revision 1: [Signature]
Revision 2: [Signature]
Revision 3: [Signature]
Revision 4: [Signature]
Revision 5: [Signature]
Date: [Signature]

9. INTERNAL TRAFFIC LAYOUT PLAN

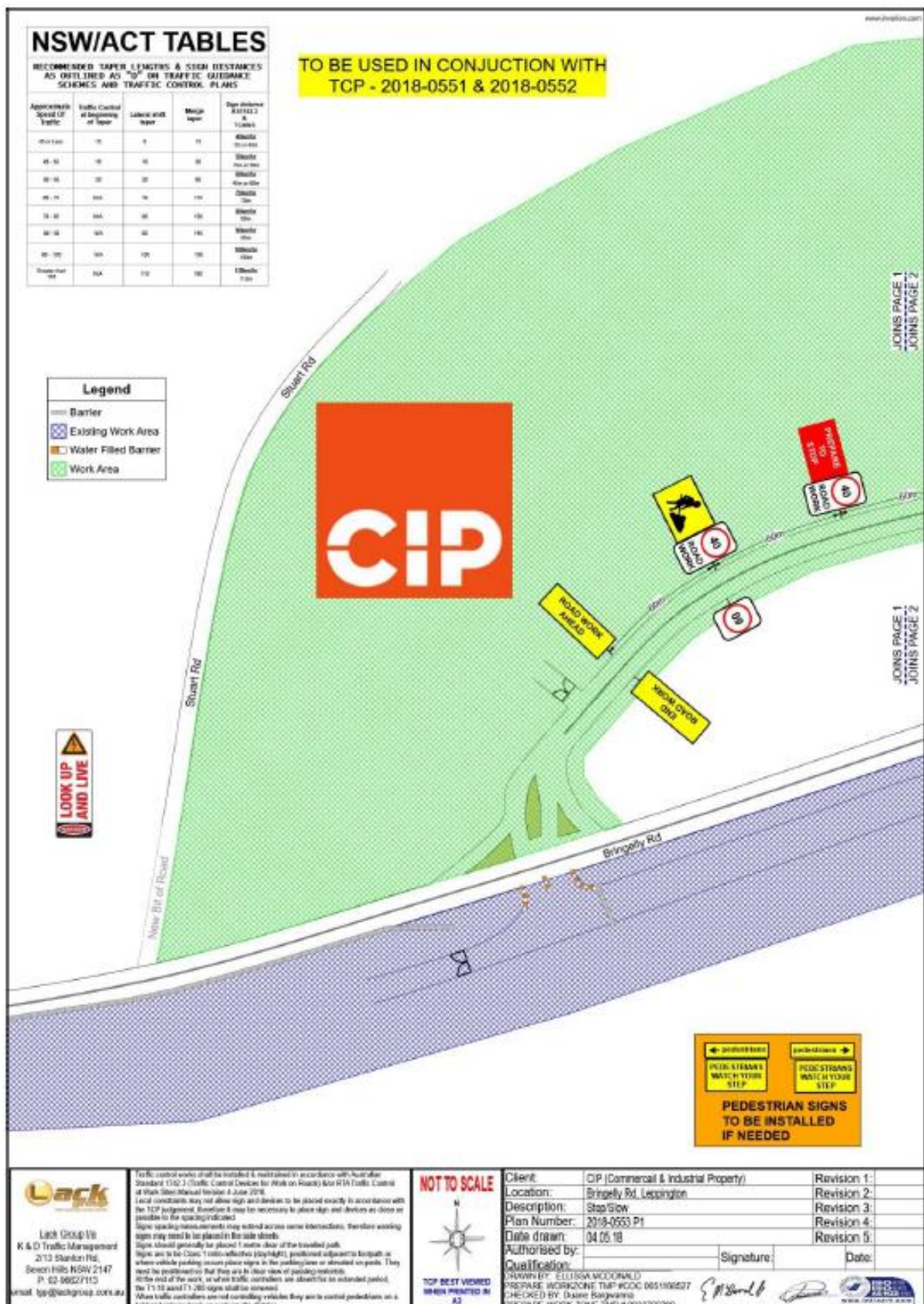

[illegible]

TO BE USED IN CONJUNCTION WITH
TCP - 2018-0551 & 2018-0552

[illegible]

Document Revision History

Issue No.	Date	Sec. No.	Brief Description of Change	Reason	Prepared By	Approved By
1.0	Sep 15	N/A	Original Doc.	Initial setup	RM	RB
2.0	Sep 16	All	Reformat	Company rebranding	KA	RB
3.0	Aug 17	7-8	Traffic Control Plans changed to Internal/External	Document title changes	KA	RM
4.0	Jan 18	1, 5 & 7	Amendments to TM roles, State specific information and minor corrections.	To be in line with company procedures.	KA	RB
5.0	July 18	All	Site specific information	To apply to BRBH	MI	FK