

DOC22/72266

Michael Cassel
Planning Secretary
Department of Planning, Industry and Environment
12 Darcy Street
Parramatta NSW 2150

Attn: Mr Shiraz Ahmed

31 January, 2022

Dear Mr Cassel,

Upgrades to Chatswood Public School and Chatswood High School (SSD 9483): Submission of Variation to Construction Hours in accordance with Condition C6(d).

I refer to the Upgrades to Chatswood Public School and Chatswood High School approved on the 30th November 2020 and the extension to these hours approved on 9th December 2021.

In accordance with condition C6(d) of the Development Consent, approval is now sought to undertake work outside approved Construction Hours noted in Conditions C4 and C5. This work includes completion of the live water cut in connection to the existing Sydney Water main running north-south along the Pacific Highway to allow a potable water feed and fire hydrant feed to Chatswood Public School at the property boundary and is similar to the previous request approved on 9th December 2021.

In detail the planned work includes non-destructive digging to expose services, connection to the authority water main, inspections by authorities, backfilling the excavated area and temporary reinstatement of the road surface.

Willoughby City Council (WCC) and TfNSW have been consulted and approval has been received from WCC and is awaited from TfNSW. Due to the work required to the edge of the Pacific Highway, TfNSW Traffic Management Centre has mandated that these works must be completed after-hours from 9pm - 4am. Currently the Council Road Opening Permit (ROAD) approval and Road Occupancy License (ROL) application permit work any day between 7 February and 11 February 2022. The current Council Road Opening Permit and TfNSW Road Occupancy License application are attached. The approved Road Occupancy License will be forwarded to the Planning Secretary through the Major Projects portal for information as soon as received.

No after-hours work will be undertaken unless consistent with an approved Road Opening Permit or Road Occupancy License.

Resident notification will be provided to adjacent residents 5 days in advance of work commencing and residents will be given contact details for School Infrastructure NSW should they have any concerns.

Traffic control will be in accordance with the previous Traffic Control Plans TW0 1.21 and TW0 2.21 submitted to TfNSW.

All works conducted after 6pm will be managed in accordance with the existing Construction Noise and Vibration Management Plan with noise monitoring undertaken to monitor and manage the works. No high impact noisy works will occur after 6pm as the majority of connection works are low noise generating or relate to authority inspections. If complaints are received, works will cease and noise mitigation measures reviewed and implemented to address the concerns raised.

In support of the above, the following documents are submitted to the Planning Secretary to enable approval:

- SSD 9483 - C6 (d) - Traffic Control Plan TW0 1.21 dated 14 October 2021.
- SSD 9483 - C6 (d) - Traffic Control Plan TW0 2.21 dated 14 October 2021.
- SSD 9483 - C6 (d) - Willoughby City Council Road Opening Permit 2021/199 dated 17 January 2022.
- SSD 9483 - C6 (d) - TfNSW Road Occupancy License application 1763650.

These documents have been reviewed internally by myself and the Compliance Team.

Department of Education therefore submits the above documents and request for a limited variation to construction hours to the Planning Secretary for approval.

Yours sincerely

Angelo Parissis

Angelo Parissis
Senior Project Director
School Infrastructure NSW





Date: 14/10/2021 **Author:** Ali Fayad **Project:** Chatswood Public School
Client: Planet Plumbing **Contact:** Pat Stapleton **Contact Number:** 0414952229
Plan #: FO TW01.21 **PWZTMP #:** 1011477

www.invarion.com

Comments:

This plan has been designed by Ali Fayad of Sydney Traffic Control in accordance with Australian Standards outlined in the RMS's Traffic Control on Worksites Handbook. The plan is designed for the Opening of the footpath in front of Chatswood Public School.

Certified traffic controllers will be on site to implement and monitor this TCP. If you have any questions please contact Ali Fayad on 8068-1844 or 0434 850 166 .

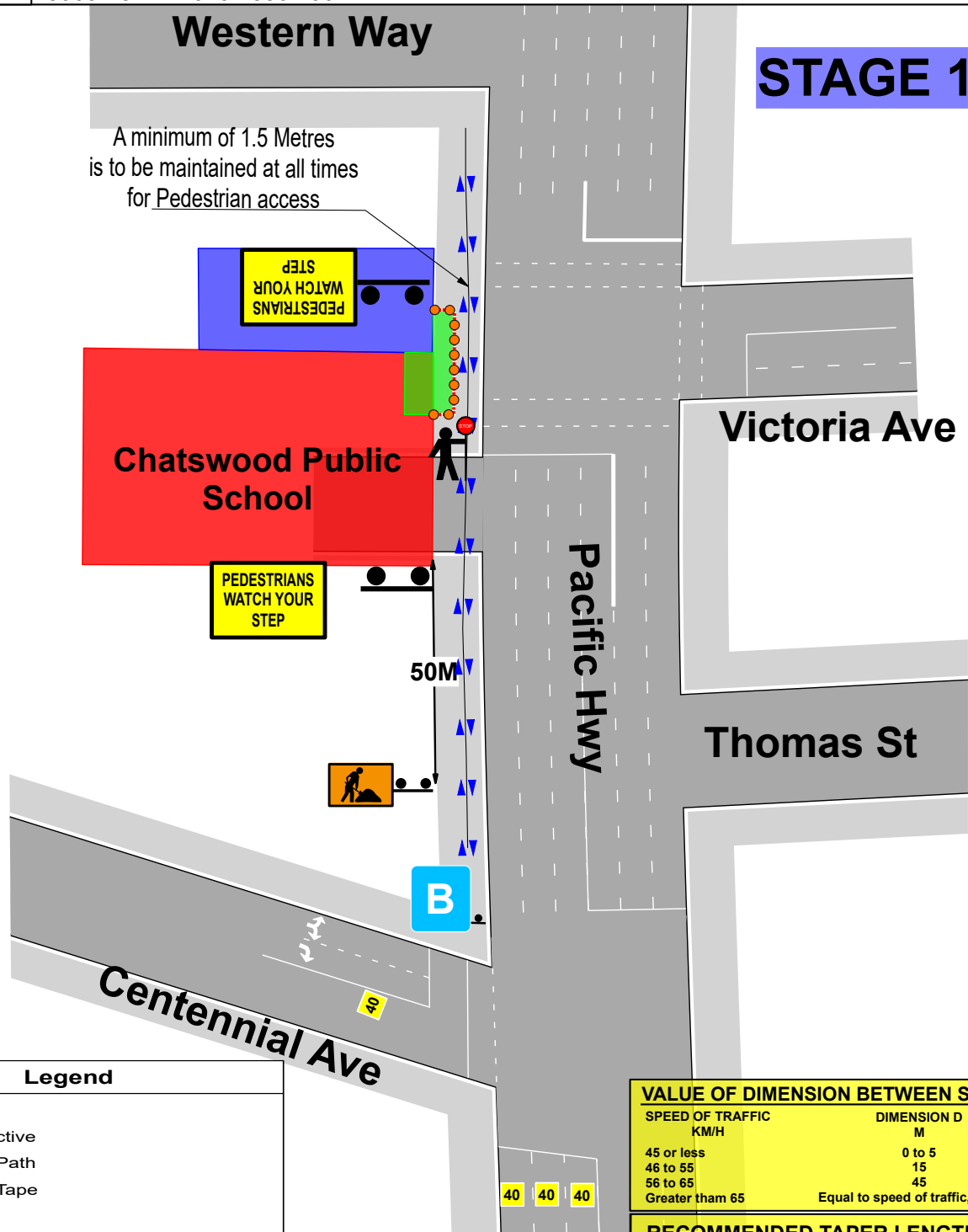

Legend

- Bollard
- Bus stop- active
- Pedestrian Path
- Pedestrian Tape
- sign single
- Site Location
- Surrounding Property's
- T8-1 PEDESTRIANS WATCH YOUR STEP
- Traffic Controller
- Work Area

VALUE OF DIMENSION BETWEEN SIGNS

SPEED OF TRAFFIC KM/H	DIMENSION D M
45 or less	0 to 5
46 to 55	15
56 to 65	45
Greater than 65	Equal to speed of traffic, in km/h

RECOMMENDED TAPER LENGTH (m)

SPEED OF TRAFFIC KM/H	TRAFFIC CONTROL AT THE BEGINNING OF THE TAPER
45 or less	15
46 to 55	15
56 to 65	30
Greater than 65	N/A



Date: 14/10/2021 **Author:** Ali Fayad **Project:** Chatswood Public School
Client: Planet Plumbing **Contact:** Pat Stapleton **Contact Number:** 0414952229
Plan #: FO TW02.21 **PWZTMP #:** 1011477

Comments:

This plan has been designed by Ali Fayad of Sydney Traffic Control in accordance with Australian Standards outlined in the RMS's Traffic Control on Worksites Handbook. The plan is designed for the Opening of the footpath in front of Chatswood Public School.

Certified traffic controllers will be on site to implement and monitor this TCP. If you have any questions please contact Ali Fayad on 8068-1844 or 0434 850 166.

Stage 2

**ALL SIGNS AND SPACING
MUST BE IN ACCORDANCE
WITH AUSTRALIAN
STANDARD 1742-3**

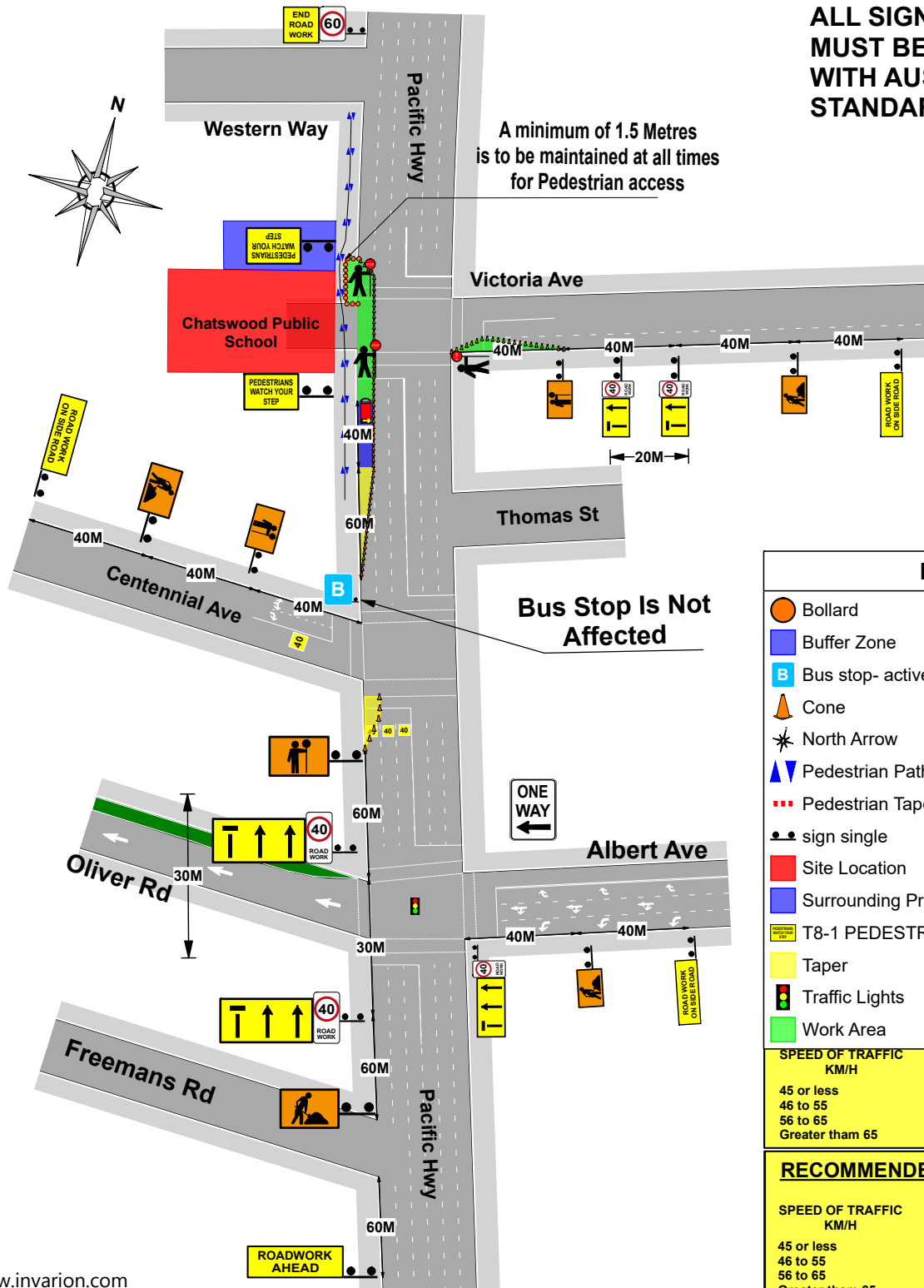

Legend

- Bollard
- Buffer Zone
- Bus stop- active
- Cone
- North Arrow
- Pedestrian Path
- Pedestrian Tape
- sign single
- Site Location
- Surrounding Property's
- T8-1 PEDESTRIANS WATCH YOUR STEP
- Taper
- Traffic Lights
- Work Area

SPEED OF TRAFFIC KM/H	DIMENSION D M
45 or less	0 to 5
46 to 55	15
56 to 65	45
Greater than 65	Equal to speed of traffic, in km/h

RECOMMENDED TAPER LENGTH (m)

SPEED OF TRAFFIC KM/H	TRAFFIC CONTROL AT THE BEGINNING OF THE TAPER
45 or less	15
46 to 55	15
56 to 65	30
Greater than 65	N/A

31 Victor Street, Chatswood NSW 2067
PO Box 57, Chatswood NSW 2057
Ph: 02 9777 1000 Fax: 02 9777 1038
Email: email@willoughby.nsw.gov.au
Web: www.willoughby.nsw.gov.au



Road Opening Permit Permit No: ROAD-2021/199/B

17-Jan-2022

Chatswood Public School
C/- The Principal
Pacific Hwy
CHATSWOOD NSW 2067

Permit Location: 680 Pacific Highway, CHATSWOOD NSW 2067.
Purpose: New water and Fire water connection point to the new buildings for Chatswood Public School

Contact Telephone 0416 770 169

Date Required From 07 -Feb-2022

Date Required To 09-Feb-2022

Area of Road Opening 1.4m2

Traffic Management Plan has been provided
RTA Road Occupancy Licence Provided

Extra Information Additional 3 days required.

Fees

Crane Permit -	\$1,080.00	\$-1,080.00	\$0.00
Additional Lane			

Permit issued under Section 139 of the Roads Act 1993 subject to the following conditions:

1. The Applicant or the Applicant's contractor shall provide adequate traffic control measures during all stages of the work in accordance with Australian Standard AS1742.3. All signage and signage placements must be in accordance with the requirements of AS1742.3 (Traffic Control devices for Works on Roads).
2. The Applicant or the Applicant's contractor shall ensure that all works carried out comply with the submitted Traffic Control Plan (TCP). All conditions and specification of this Permit and the requirements of Work Cover Authority NSW, and NSW Dial 1100 Before You Dig Service applicable to this application are also to be complied with.
3. The Applicant or the Applicant's contractor shall indemnify Council against all loss of or damage to the property of others and injury or death to any persons which may arise out of or in consequence of the carrying out of the work and against all claims, demands, proceedings, costs charges and expenses whatsoever in respect thereof or in relation thereto. In this regard, the Applicant shall take out a public liability policy at the Applicant's own expense during the currency of the works in the sum of not less than twenty million dollars (\$20,000,000).

Reference: ROAD-2021/199/B
Enquiries: German Barragan
Telephone: 02 9777 1000
Availability: Monday to Friday 9am – 5pm

31 Victor Street, Chatswood NSW 2067
PO Box 57, Chatswood NSW 2057
Ph: 02 9777 1000 Fax: 02 9777 1038
Email: email@willoughby.nsw.gov.au
Web: www.willoughby.nsw.gov.au



4. The Applicant or the Applicant's contractor shall ensure that no construction debris is left in Council's road reserve during all stages of work.
5. The Applicant or the Applicant's contractor shall ensure that pedestrian access will not be impeded and is maintained at all times.
6. The Applicant or the Applicant's contractor shall pay for any additional restoration charges if Council's Restoration Supervisor determines that a larger opening has been made.
7. **The Applicant or the Applicant's contractor shall make safe the footpath/roadway after completion of the work and immediately telephone Council's Restoration Officer on 9777 7787 / 9777 7996.**

The applicant requires three additional nights to complete the works. These are 7, 8, 9 February 2022. Below are additional conditions and fee

Additional Conditions:

Validity:

1. Work hours are to be constrained to 9pm-5am Monday to Friday and as per TMC's approved hours of work.
2. Excavation of State Classified Road Assets must be approved by TfNSW
3. Applicant is to obtain an out of work hours permit from the Department of Planning, in accordance with SSDA requirements
4. The permit is valid from 7/02/2022 to 9/02/2022

Traffic

1. Traffic controllers may assist and manage the closure points at both ends via STOP/SLOW.

Pedestrians:

1. The safety of pedestrians is to be prioritised at all times;
2. A 1.5 metres wide clear path for pedestrians must be maintained at all times
3. Traffic controllers may stop pedestrians/cyclists if deemed unsafe

Miscellaneous

- The TCP submitted is to be prepared/implemented by accredited consultants/traffic controllers;
- The TCP submitted is in accordance with the current version of AS1742.3 and its associated handbook; and the RMS's Traffic Control at work site manual
- All roads/footpaths will be reopened to traffic and pedestrians and/or non-slip steel plates be installed as required
- Applicant is required not make noise at a level greater than the level of noise allowed to be made at that time under NSW legislation

The fee breakdown is below:

- Lane occupancy per day: \$360.00 * 3 = **1,080.00**

Reference: ROAD-2021/199/B
Enquiries: German Barragan
Telephone: 02 9777 1000
Availability: Monday to Friday 9am – 5pm

RESTORATION CODE

1. ROAD OPENING PERMIT

Information for Applicants:

- a) Before any road, footpath, public place is opened for any lawful purpose by a plumber, drainer, builder, or any other person, a permit in respect of such opening shall be obtained from the Council and the charge for restoration of this area (calculated in accordance with the Schedule of Charges for Restoration fixed by Council) shall be paid to Council prior to the commencement of any opening.
- b) In the case of an emergency (i.e. where damage or blockage has been caused to a water or sewer service) the work of repairing such services, including the opening of the road, footpath, public reserve or public place for such purpose, may proceed without first obtaining a permit, but in such an emergency one clear working day calculated from the day on which the opening is made will be allowed for the purpose of obtaining a permit and paying the restoration charge.
- c) In any case, where a main traffic route is to be opened, (see schedule main traffic routes) the written approval of the Police Traffic Branch shall be obtained before a permit is issued by Council. If the main traffic route is a classified State Road, the written approval of the Roads and Traffic Authority must also be obtained and the restoration work is to be carried out by the Roads and Traffic Authority and not Council.
- d) The permit shall be produced on demand for inspection by an employee of Council on the site of the opening at any time during which the work is being performed.
- e) All work shall be carried out to the satisfaction of Council's Restoration Officer, and the person to whom the permit is issued shall be liable for the cost of any extra restoration work, in addition to that paid for, to satisfy the conditions specified or to restore adjoining or adjacent failed sections of road subgrade or pavement as a consequence of the opening.
- f) In any case, where an opening is made in excess of that for which the permit has been issued, the person responsible for the opening shall, not later than on the actual completion of the opening, make a further application for an additional permit in respect of the additional area opened. The calculation of the area to be restored, and the payments to be made, shall be in accordance with the specification Calculation of Areas for Restoration Charges (Section 2).
- g) Adequate barriers and warning signs shall be provided around any opening or excavated material and where the opening remains overnight, adequate lighting shall be provided with a minimum of three lamps around such opening and excavated material.
- h) Acceptance by the holder of the permit of the full responsibility for public safety, injury to any person and damage to any property in carrying out or as a consequence of the work under the permit. Contractors must have a current public liability insurance policy prior to the start of any works.
- i) Not more than one-half of the width of any road pavement shall be opened at any one time and where the road width is reduced to only one lane adequate traffic control measures must be in place to allow vehicles to pass safely around the work site. Where the work will impede on the footpath area adequate provision must be made for pedestrians to safely negotiate the work site.
- j) All concrete road openings and all concrete footpath openings, shall be sawn along all edges. The depth of saw cuts shall be 25mm for footpaths and 50mm for road pavement or vehicular crossings.
- k) Cutting of steel reinforcement in concrete pavements is prohibited and as much of the existing reinforcing is to be retained as possible.
- l) All excavated material shall be removed from the site immediately on completion of the work and no excavated material is to be left on a roadway over night.
- m) Backfilling of openings shall be carried out in accordance with the specification for Backfilling of Trenches (Section 3) and Council's Restoration Supervisor (9777 7787) is to be advised prior to backfilling of the trenches so that the work can be inspected
- n) Council will not accept responsibility for any damage caused to any mains or services during restoration of the areas covered by the permit.
- o) The permit will be valid for six (6) months from date of issue.
- p) Any opening within 2 metres of the base of a street tree requires the approval of Council's Tree Preservation Officer.
- q) Underground services may exist in the area that is being opened and the Public Utilities should be contacted for details prior to excavating.

2. CALCULATION OF AREA FOR RESTORATION CHARGES

Areas shall be calculated in accordance with the following procedures: -

General

- a) The minimum payment for areas to be restored shall be one (1) square metre.
- b) The minimum width of an opening for calculation of the restoration charge shall be 300mm unless the opening is in the roadway of a main traffic route (see attached schedule). Then the minimum width of an opening for calculation of the restoration charge shall be 1.0 metres.
- c) Additional special conditions also exist for concrete openings, as specified below.

Concrete

- a) All concrete road openings, and all concrete footpath openings shall be sawn along all edges.
- b) The depth of the saw cut shall be 25mm for footpaths and 50mm for road pavements or vehicular crossings.
- c) The area of concrete road or footpath to be restored shall include, in addition to the actual area opened any concrete road or footpath which is within 300mm of –
 - i) any edge of the concrete slab in which the opening is made;
 - ii) any existing joint in a concrete slab;
 - iii) any edge of a previous restoration.

The restoration charge shall include any additional cost of any concrete road or footpath as specified above.

- d) Cutting of reinforcement in any concrete pavement is prohibited. If reinforcement is cut, Council will remove and restore 300mm of the concrete slab on each side of the opening and this additional area shall be added to the original area for the purpose of calculating the restoration charge.
- e) Subject to prior arrangement, saw cutting will be carried out by the contractor as part of the road opening.
- f) Restoration of a full slab may be adopted as a cheaper alternative to sawcutting.

- g) Should the footpath be considered by the applicant to be in such poor condition as to place in doubt the areas chargeable to the applicant, the applicant should contact Council's Restorations Supervisor in order to organise an on-site inspection to resolve any doubt prior to the work commencing.

3. SPECIFICATION FOR BACKFILLING OF TRENCHES

- a) All excavated material is to be removed from the site and Council's Restoration Supervisor (9777 7784) is to be advised prior to backfilling the trenches so that the work can be inspected.
- b) Excavated material is not to be used for backfilling the trench unless it is of a granular type which has been approved by the Restoration Supervisor. Backfilling of trenches is to be carried out in accordance with the Standard Drawing attached. It should be noted that there are different standards of backfilling for trenches above and below 1.5 metres in depth.
- c) The sand for backfilling shall be washed filling sand and is to be provided by the permit holder and is to be thoroughly damped down and compacted in layers not exceeding 150mm and compacted with a vibrating roller or wacker plate to ensure the sand is fully compacted. The sand is to be compacted to achieve a density of 95% modified in accordance with AS1289.
- d) The fine crushed rock for backfilling is to be placed and thoroughly compacted in layers of 100mm to achieve a density of 98% modified in accordance with AS1289.
- e) The sand cement mix for backfilling is to be placed across the top of the restored trench for a depth of 25mm for footpaths and 50mm for roadways.
- f) Should the backfilling of the trench not be carried out in accordance with this code the permit holder will be liable to any extra costs incurred by the Council in rectifying the work.
- g) Should the trench subside at a future date due to unsatisfactory backfilling, the permit holder will be liable for the cost of the rectification work required.

SPECIFICATIONS FOR BACKFILLING OF TRENCHES

FOOTPATH

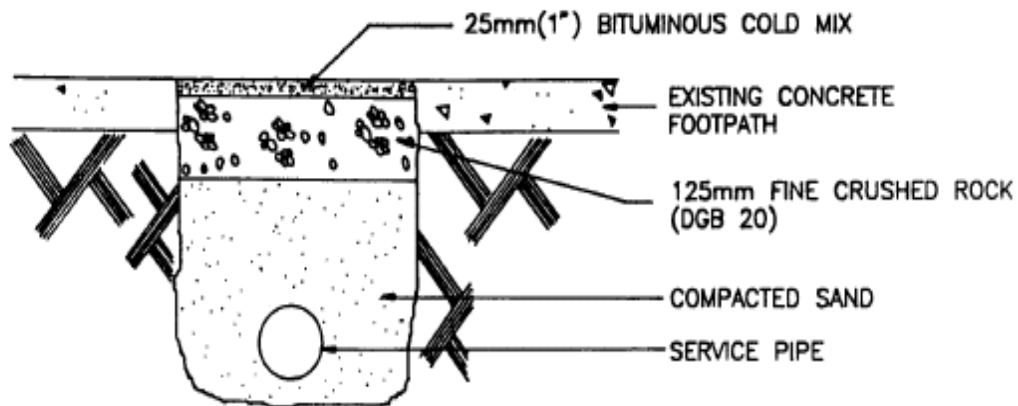

ROADWAY UP TO 1.5 METRES IN DEPTH

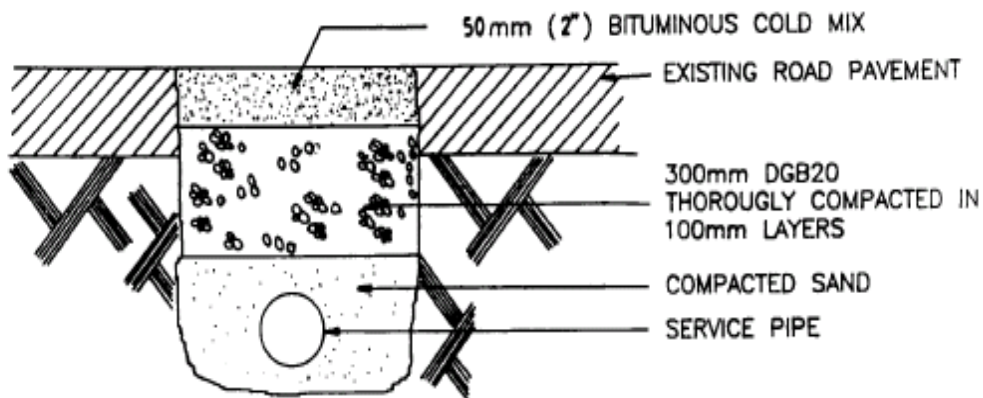

ROADWAY OVER 1.5 METRES IN DEPTH

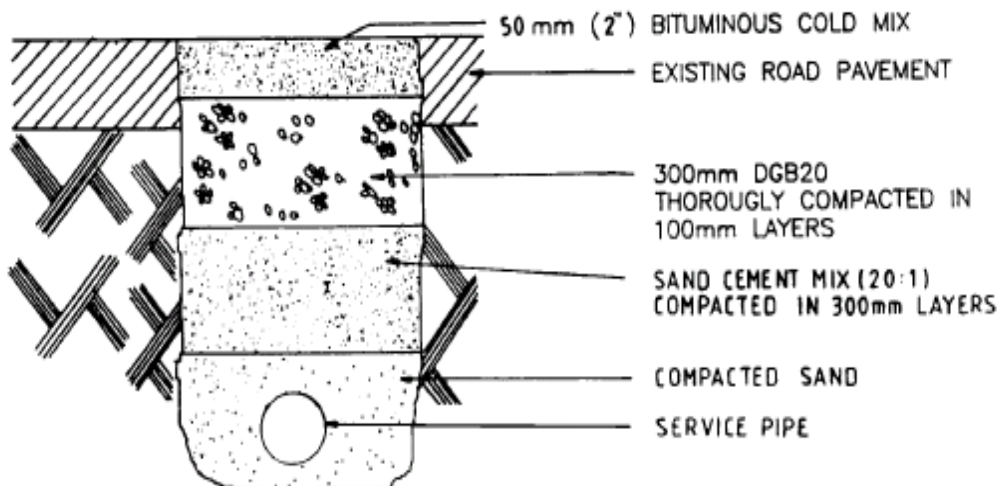

WILLOUGHBY CITY COUNCIL

ROAD CLASSIFICATIONS FOR ROAD OPENINGS ON MAIN TRAFFIC ROUTES

ROAD	FROM	TO	SPECIAL CONDITIONS FOR ROAD
STATE ROADS			
Boundary Street Eastern Valley Way Fullers Road Millwood Avenue Mowbray Road Pacific Highway Penshurst Street Sailors Bay Road Strathallen Avenue Willoughby Road	Pacific Highway Boundary Street Pacific Highway Fullers Road Penshurst Street Boundary Street Boundary Street Eastern Valley Road Sailors Bay Road Mowbray Road	Eastern Valley Way Sailors Bay Road Millwood Avenue Fullers Bridge Willoughby Road Herbert Street Mowbray Road Strathallen Avenue Miller Street Warringah Expressway	The Roads & Traffic Authority must be advised (831 0114) and approval given for any works carried out on these roads. Restorations on the roadway are to be carried out by the RTA and restorations on the footpath will be carried out by Council. Applicants must advise the Police Traffic Branch prior to the commencement of any work.
OTHER ROADS			
Albert Avenue Albert Avenue Alpha Road Anderson Street Archer Street Bertram Street Brook Street Brown Street Chandos Street Dalton Street Edinburgh Road Help Street Flat Rock Drive High Street Mowbray Road Mowbray Road Orchard Road Railway Street Spring Street Thomas Street Victor Street Victoria Avenue Willoughby Road	Pacific Highway Help Street Pacific Highway Edinburgh Road Boundary Street Victoria Avenue Flat Rock Drive Pacific Highway Willoughby Road Albert Avenue Eastern Valley Way Pacific Highway Brook Street Mowbray Road Epping Road Willoughby Road Albert Avenue Victoria Avenue Victoria Avenue Pacific Highway Albert Avenue Pacific Highway Chandos Street	Bertram Street Albert Avenue Stanley Street Flat Rock Drive Mowbray Road Albert Avenue Palmer Street Railway Street Pacific Highway Victoria Avenue High Street Victoria Avenue Alpha Road Short Street Penshurst Street Alpha Road Help Street Help Street Albert Avenue Thomas Lane Victoria Avenue Penshurst Street Warringah Expressway	Work to be carried out on these roads must be done between 10:00am and 3:00pm and in accordance with any parking restrictions. Applications must advise the Police Traffic Branch prior to the commencement of any work,

ROAD OCCUPANCY LICENCE APPLICATION

Development & Road Opening

ROL 1763650

Submitted by Darren Lindsay On 20/01/22 1:55 PM

FORM
D

Is this an extension of an existing license? ☐ No ☒ Yes - License # 1752744

Was this application entered online? ☐ No ☒ Yes - Application # 1763650

CONTACTS

Proponent Organisation: Sydney Traffic Control

Your reference No.:

Proponent Contact Name: Darren Lindsay

On Site Company: Sydney Traffic Control

Phone: 0400441775

On Site Contact Name: Ali Fayad

Project:

On-Site Phone: 0451153044

Email: info@sydneytrafficcontrol.com.au

Contact Fax:

LOCATION

Subject Road: PACIFIC HWY

Map Ref: UBD

From (Cross Street): CENTENNIAL AV

To (Cross Street): WESTERN WAY

1st Cross Street notes:

2nd Cross Street notes:

Suburb: CHATSWOOD

Suburb: CHATSWOOD

Distance: 98

Council:

TIMES

Start Date

Start Time

End Date

End Time

Duration

Mon 7 Feb 2022

Fri 11 Feb 2022

PROPOSED ACTIVITY

Project:

Current Speed Limit: km/h

Project and Work Description for this Application:

​Can we please have ROL #1748576 extended from tonight 17/12.
​My client has requested if he can work again tonight to complete the sucker truck works.

License Type

☐ Not known

☐ Crane

☐ Bridge

☐ Hazard Reduction

☐ Hoardings

☐ Building Work Zone

☐ Utility Maintenance

☐ Police Operations

☐ Abnormal Load/Movement

☐ Line Marking

☐ SRA Works

☐ Landscaping/Mowing

☐ Investigation

☐ Filming

☐ Building Construction

☒ Other : Road Opening

Lane/s or Shoulder/s Closed

☒ Lane 1 (kerb lane/s)

☐ Lane 2 (next after kerb lane)

☐ Lane 3

☐ Lane 4

☐ Lane 5

☐ Lane 6

☐ Lane 7

☐ Lane 8

☐ Lane 9

☐ Median Shoulder

☐ Shoulder

Total no. of lanes to be closed at any one time? (In same direction) 1 Lane of 3

PROPOSED ACTIVITY	Direction		
	<input type="checkbox"/> All Directions	<input type="checkbox"/> Eastbound	<input type="checkbox"/> Eastbound and Westbound
	<input checked="" type="checkbox"/> Northbound	<input type="checkbox"/> Northbound and Southbound	<input type="checkbox"/> Southbound
	<input type="checkbox"/> Westbound		
	Flow Management		
<input checked="" type="checkbox"/> Standard Lane Merge	<input type="checkbox"/> Contra Flow	<input type="checkbox"/> Stop / Slow Control	
<input type="checkbox"/> Detour (other roads)	<input type="checkbox"/> Detour (side track)	<input type="checkbox"/> Portable Signals	
<input type="checkbox"/> Mobile Works	<input type="checkbox"/> Short Term / Intermittent Works	<input type="checkbox"/> Non-Trafficable Area	
MISCELLANEOUS			
Turning Bay/s affected?	Speed Reduction?	Community Notification	
<input checked="" type="checkbox"/> Yes	<input checked="" type="checkbox"/> Yes km/h	<input checked="" type="checkbox"/> Letter drop	
<input type="checkbox"/> No	<input type="checkbox"/> No	<input type="checkbox"/> Newspaper	
	Traffic Control Plan ID: FO TW02.21	<input type="checkbox"/> VMS (Portable / Permanent)	
		<input type="checkbox"/> OTHER:	
SPECIAL EVENTS			
Special Event name: TMC Officer in Charge: TMC Officer Phone No: Event Approved: No			
RMS	If this project is managed by RMS, fill in the following:		
	RMS Branch:	RMS Contact:	
	RMS Office Phone No.:		

SPEED ZONE AUTHORISATION APPLICATION

FORM R

ROL 1763650 Submitted by Darren Lindsay On 20/01/22 1:55 PM

Proponent Organisation: Sydney Traffic Control	Your reference No.:
Proponent Contact Name: Darren Lindsay	On Site Company: Sydney Traffic Control
Phone: 0400441775	On Site Contact Name: Ali Fayad
Project:	On-Site Phone: 0451153044
Email: info@sydneytrafficcontrol.com.au	Contact Fax:

LOCATION	Subject Road: PACIFIC HWY	Map Ref: UBD null
	From(Cross Street): CENTENNIAL AV	To (Cross Street): WESTERN WAY
	Suburb: CHATSWOOD	Council: WILLOUGHBY
	Existing Speed Limit: 60	Requested Speed: 40
	Length(Metres): 98	Reason for SZA: ALLOW WORKERS WITH IN 1.5 METRES OF APPROACHING TRAFFIC
	Previous TMC Road Occ Approval No: 1752744	

Direction		
<input type="checkbox"/> All Directions	<input type="checkbox"/> Eastbound	<input type="checkbox"/> Eastbound and Westbound
<input checked="" type="checkbox"/> Northbound	<input type="checkbox"/> Northbound and Southbound	<input type="checkbox"/> Southbound
<input type="checkbox"/> Westbound		

Requested Speed Zone Times				
Start Date	Start Time	End Date	End Time	Duration
Mon 7 Feb 2022		Fri 11 Feb 2022		

CONTACT

Proponent's Organisation: Sydney Traffic Control

*** Contact Phone:** 80681844

*** Proponent's Name:** Darren Lindsay

*** Contact Mobile:** 0400441775

LOCATION

*** Subject Road:** PACIFIC HWY

*** Suburb:** CHATSWOOD

*** From(Cross Street):** CENTENNIAL AV

*** To (Cross Street):** WESTERN WAY

Has a Site inspection been conducted in the past two weeks?

☒ Yes

Two photographs (one each direction) of site attached,

Any significant features of the site noted **(Tick below those which are applicable)**

☒ Yes

☐ No

- Trafficable Shoulders ☐
- Pedestrian or Cyclist path ☐
- Raised median/ divided carriageway ☐
- Signals within 100m of site and/or signal operation affected ☒
- Roundabouts or pedestrian refuges within 100m of site ☐
- The occupancy is near tidal flow ☐
- Adjacent significant land use such as hospital/supermarkets ☐
- Adjacent significant land use such as schools/school zones ☒
- Enforcement camera (safety, red light, speed camera)/signage within 100m of site ☐
- Other, please specify ☐
- Number of traffic lanes in each direction(insert number) 1 Lane of 3

**Additional information for
Emergency Cameras:**

- Pavement Type
 - Bitumen ☒
 - Concrete ☐
 - Other ☐

Any kerbside restrictions such as (specify appropriate restriction)

☒

- Clearways/bus or transit lanes ☐
- Parking Restrictions ☒
- Bus stops ☒
- Taxi ranks ☐
- Loading Zones ☐

LOCATION	• Other, please specify <input type="checkbox"/>		
	Additional information:		
	Any evidence of concurrent adjacent roadworks / activities / off-road developments IF YES PLEASE SPECIFY:		<input type="checkbox"/> Yes <input checked="" type="checkbox"/> No
	Relevant traffic volume data obtained (Traffic Volume Data Book) • Days/times of lowest traffic volumes noted • Are times occupancy requested consistent with traffic volumes (above) • Does your Traffic Management Plan (TMP) indicate how flow capacity is maintained		<input type="checkbox"/> Yes <input checked="" type="checkbox"/> No
	Estimated traffic flow:		
	Has this Traffic Management Plan been prepared by a person in possession of a current Select/Modify Traffic Plans qualification or higher If YES please supply Name & Licence No: Ali Fayad 1011477		<input checked="" type="checkbox"/> Yes <input type="checkbox"/> No
	Will your organisation be undertaking or supervising the works described in the application.		<input checked="" type="checkbox"/> Yes <input type="checkbox"/> No
	Consideration has been given to construction noise and other environmental impacts on residents (where applicable) and the appropriate measures will be taken to minimise these impacts, particularly noise to residents If YES please supply details: NORMAL CONSTRUCTION NOISE		<input checked="" type="checkbox"/> Yes <input type="checkbox"/> No
SIGN	Comments Please allow us to work from 2230. If not then 2230 if possible.		
	RMS Asset Management (02) 8849 2114 notified for Road opening etc: <input checked="" type="checkbox"/> No <input type="checkbox"/> Yes If YES please supply Reference no.		
Applicant's Name: Darren Lindsay Date: 20/01/2022			