

LEGEND

PROPOSED SITE BOUNDARY

EXTENT OF WORKS

PROPOSED BUILDING

PROPOSED ROOF EXTENT

OVERLAND FLOW



REV	DESCRIPTION	DRAWN	APPD	DATE
E	SSDA ISSUE	CPO	RET	11.03.20
D	DRAFT	CPO	RET	27.02.20
C	DRAFT SSDA	CPO	RET	18.02.20
B	ISSUED FOR SSDA	CPO	RET	11.12.19
A	ISSUED FOR INFORMATION	CPO	RET	29.04.19

DRAWN	CPO
DESIGNED	RET
VERIFIED	J.J.
APPROVED FOR TENDER	J.J.
APPROVED FOR CONSTRUCTION	J.J.

ARCHITECT/CIENT

UPGRADES TO
CHATSWOOD PUBLIC
SCHOOL AND CHATSWOOD
HIGH SCHOOL

STORMWATER CATCHMENT PLAN
- POST DEVELOPMENT

PROJECT TITLE

40623-CI-500-002.dwg

FOR APPROVAL
NOT FOR CONSTRUCTION

AS SHOWN
SCALE @ A1

40623
PROJECT No

CI-500-002
DRAWING No

E
REV

11/03/2020 5:19:43 PM

LEGEND

PROPOSED SITE BOUNDARY

EXTENT OF WORKS

PROPOSED BUILDING

PROPOSED ROOF EXTENT

OVERLAND FLOW



REV	DESCRIPTION	DRAWN	APPD	DATE
D	ISSUED FOR SSQA	CPO	RET	11.03.20
C	DRAFT SSQA	CPO	RET	27.02.20
B	DRAFT SSQA	CPO	RET	18.02.20
A	ISSUED FOR SSQA	CPO	RET	11.12.19

DRAWN	CPO
DESIGNED	RET
VERIFIED	J.J.
APPROVED FOR TENDER	J.J.
APPROVED FOR CONSTRUCTION	J.J.

UPGRADES TO CHATSWOOD PUBLIC SCHOOL AND CHATSWOOD HIGH SCHOOL

STORMWATER CATCHMENT PLAN - POST DEVELOPMENT DETAIL

PROJECT

TITLE

WOOD & GRIEVE ENGINEERS

FOR APPROVAL

NOT FOR CONSTRUCTION

AS SHOWN

40623

CI-500-003

D

SCALE @ A1

PROJECT No

DRAWING No

REV

40623-CI-500-003.dwg

11/03/2020 5:20:15 PM

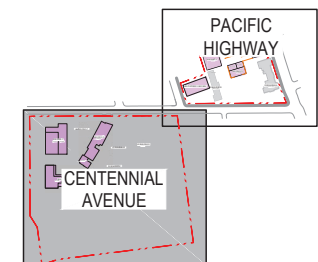
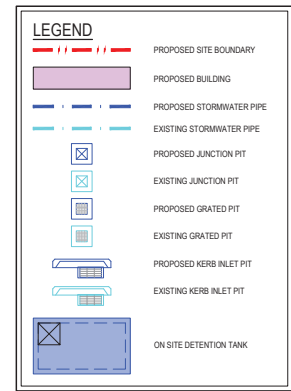

REV	DESCRIPTION	DRAWN	APPD	DATE
F	SSDA ISSUE	CPO	RET	11.03.20
E	DRAFT SSDA	CPO	RET	27.02.20
D	SSDA	CPO	RET	18.02.20
C	ISSUED FOR SSDA	CPO	RET	11.12.19
B	ISSUED FOR INFORMATION	CPO	RET	29.04.19
A	ISSUED FOR INFORMATION	CPO	RET	27.03.19

DRAWN:	CPO
DESIGNED:	RET
VERIFIED:	- J.L.
APPROVED FOR TENDER:	- J.L.
APPROVED FOR CONSTRUCTION:	- J.L.

ARCHITECT/CIENT

UPGRADES TO CHATSWOOD PUBLIC SCHOOL AND CHATSWOOD HIGH SCHOOL	STORMWATER MANAGEMENT PLAN - CENTENNIAL AVENUE
PROJECT	TITLE

40623-CI-526-001.dwg 11/03/2020 5:20:56 PM

WOOD & GRIEVE ENGINEERS	FOR APPROVAL	NOT FOR CONSTRUCTION
AS SHOWN	40623	CI-526-001
SCALE @ A1	PROJECT No	DRAWING No
		F

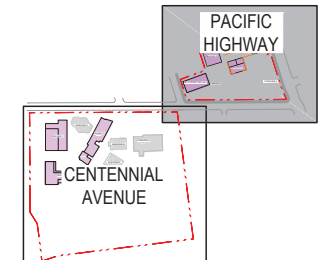
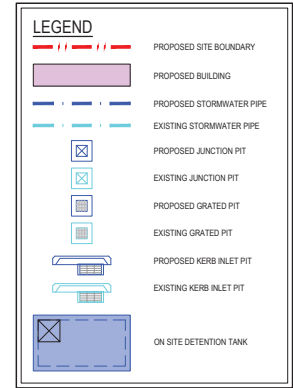
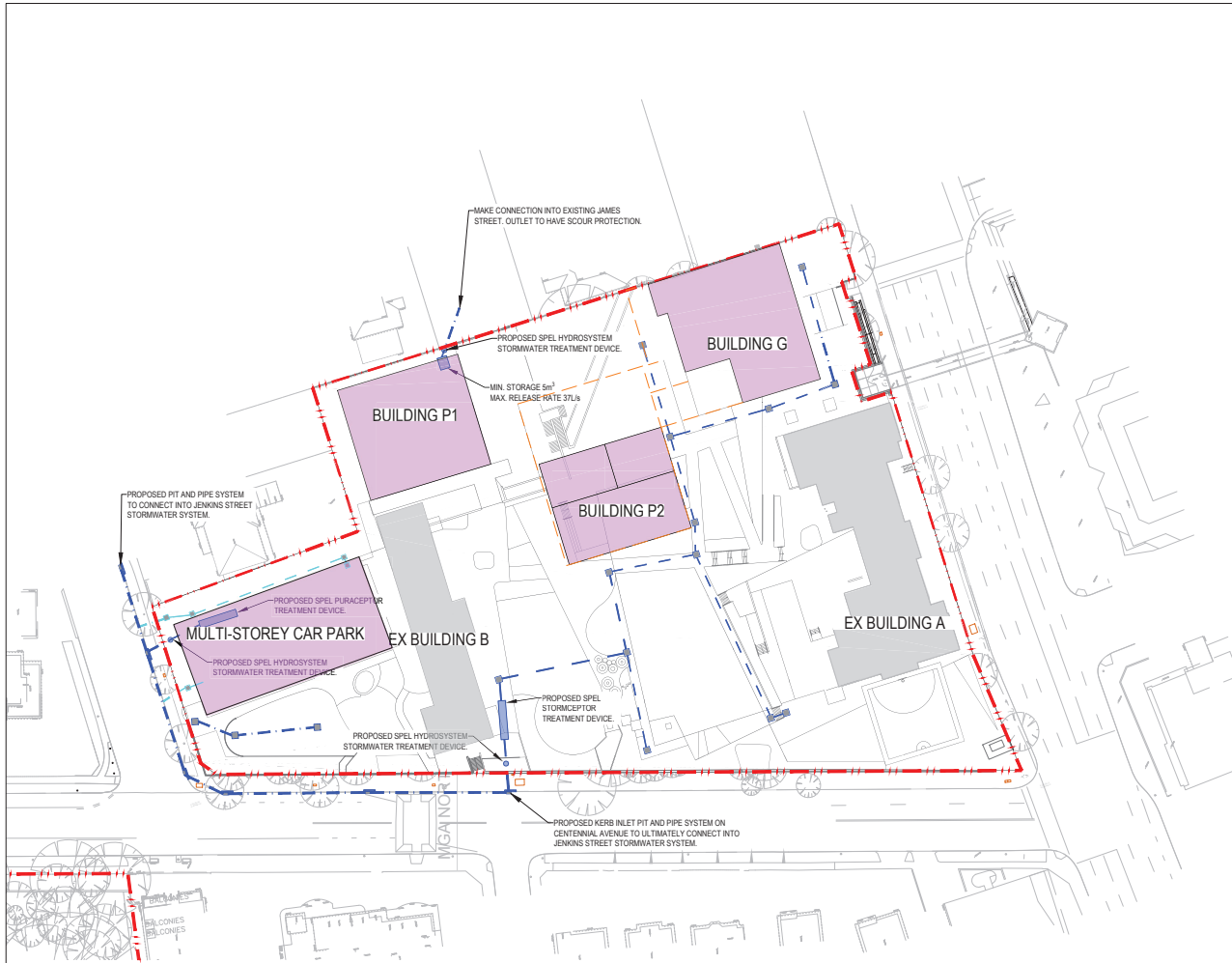

KEY PLAN
N.T.S.

1:500 10 5 0 10 20 A1
1:1000 A3

REV	DESCRIPTION	DRAWN	APPD	DATE
F	SSDA ISSUE	CPO	RET	11.03.20
E	DRAFT SSDA	CPO	RET	27.02.20
D	SSDA	CPO	RET	18.02.20
C	ISSUED FOR SSDA	CPO	RET	11.12.19
B	ISSUED FOR INFORMATION	CPO	RET	29.04.19
A	ISSUED FOR INFORMATION	CPO	RET	27.03.19

DRAWN:	CPO
DESIGNED:	RET
VERIFIED:	- J.L.
APPROVED:	- J.L.
FOR TENDER:	- J.L.
APPROVED FOR CONSTRUCTION:	- J.L.

ARCHITECT/CIENT

UPGRADES TO
CHATSWOOD PUBLIC
SCHOOL AND CHATSWOOD
HIGH SCHOOL

STORMWATER MANAGEMENT
PLAN - PACIFIC HIGHWAY

PROJECT

TITLE

40623-CI-526-011.dwg



FOR APPROVAL
NOT FOR CONSTRUCTION

AS SHOWN	40623	CI-526-011	F
SCALE @ A1	PROJECT No	DRAWING No	REV

11/03/2020 5:21:34 PM