

AUSTRALIAN MUSEUM
PROJECT DISCOVER
Queue and circulation options

ART of FACT

16th January 2018

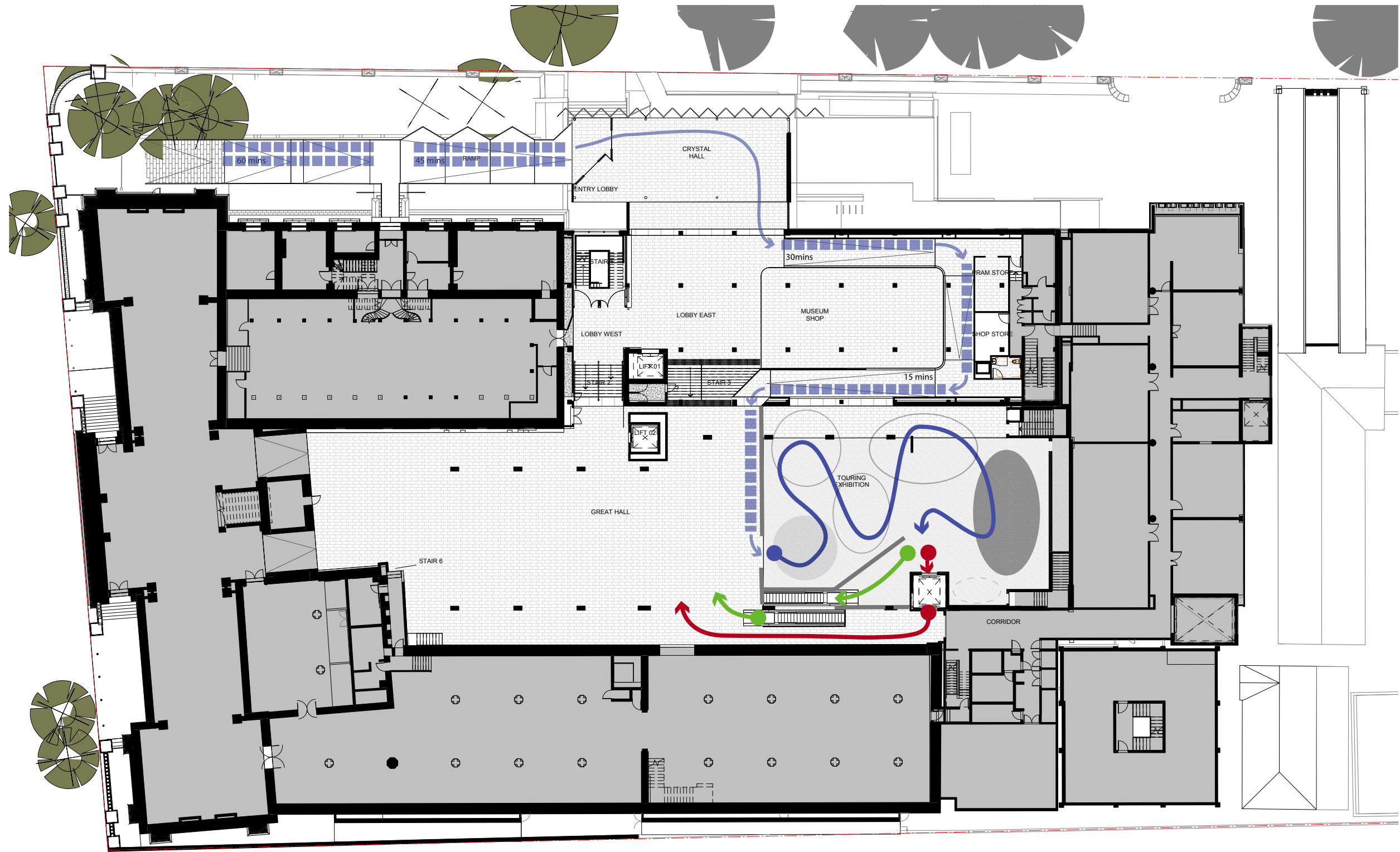

Queue and circulation study 1.
60 minute wait time.
Linear queue with 30 mins on outside ramp.

All visitors together
 Escalators users
 Lift users

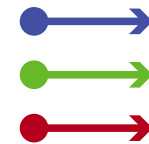

First experience
 Last experience



Approx 65 people
 7.5min wait time based on 5 minute intro film
 with 2.5min empty / fill interval



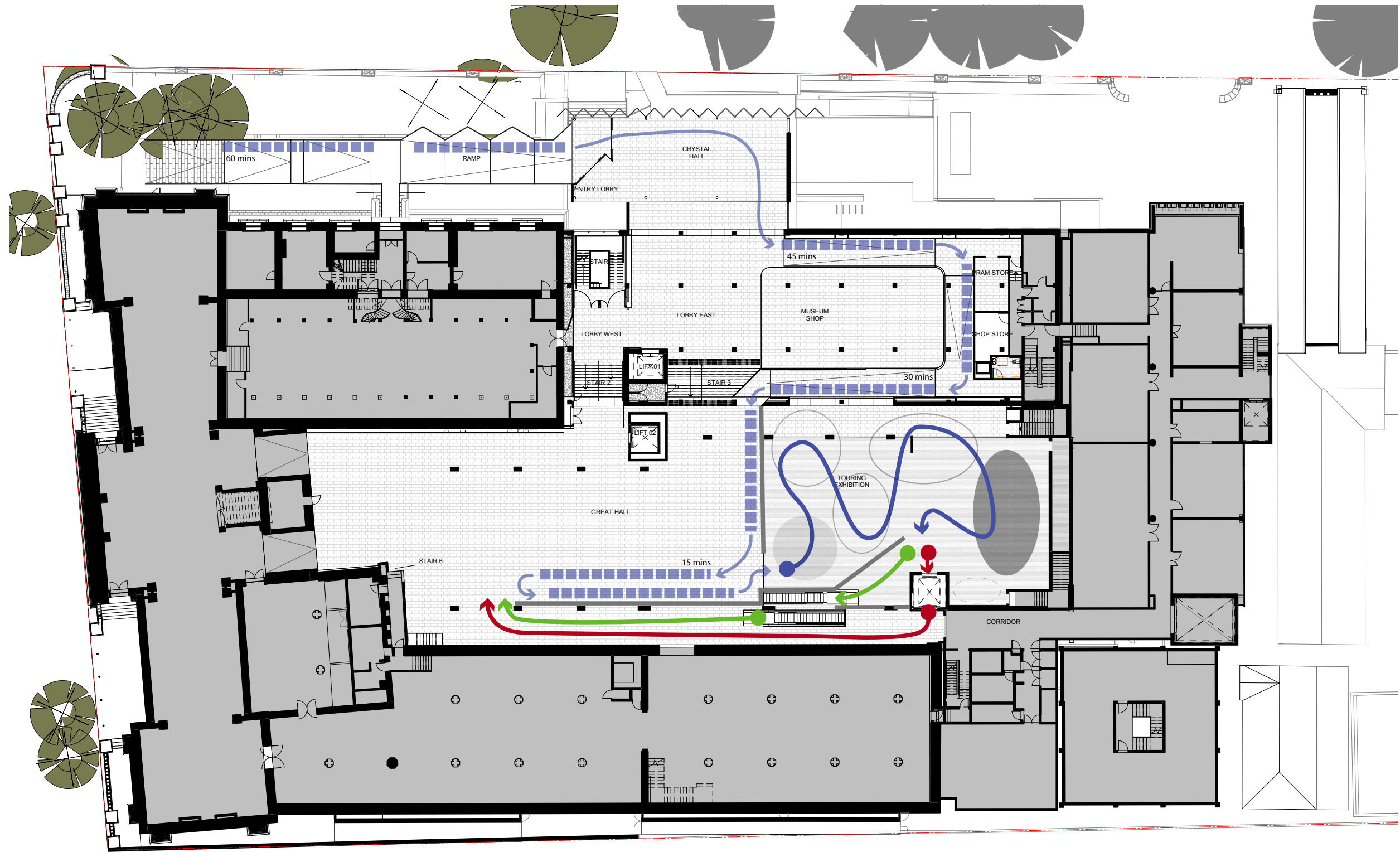

Queue and circulation study 2.
60 minute wait time.
Linear queue with 15 mins on outside ramp
and 15 mins in Great Hall.

All visitors together
 Escalators users
 Lift users

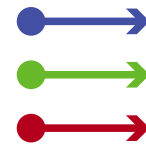

First experience
 Last experience



Approx 65 people
 7.5min wait time based on 5 minute intro film
 with 2.5min empty / fill interval



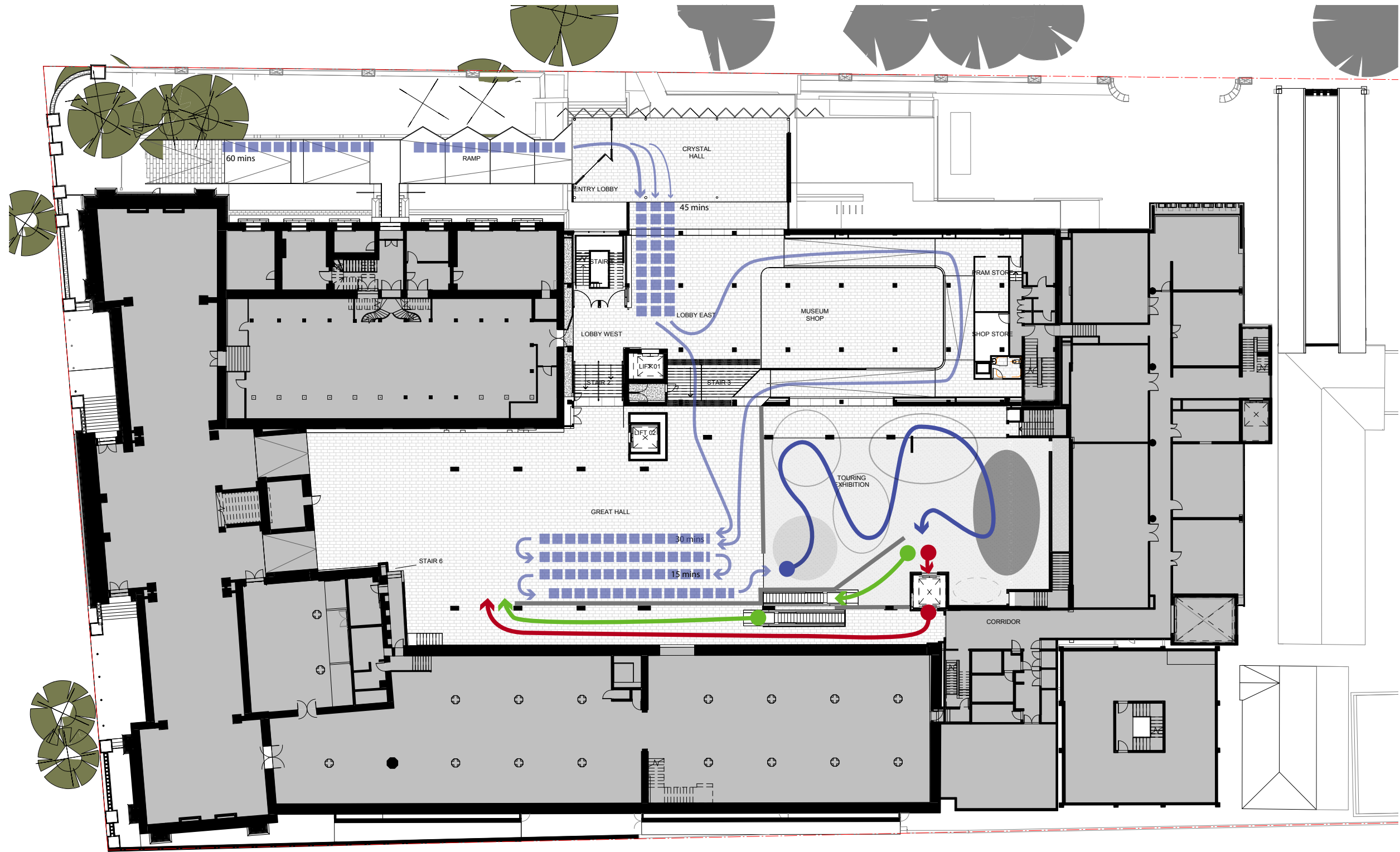

Queue and circulation study 3.
60 minute wait time.
No queue on internal ramp.
15 mins external ramp,
15 mins wait in Lobby and
30 mins in Great Hall.

All visitors together
 Escalators users
 Lift users

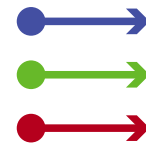

First experience
 Last experience



Approx 65 people
 7.5min wait time based on 5 minute intro film
 with 2.5min empty / fill interval



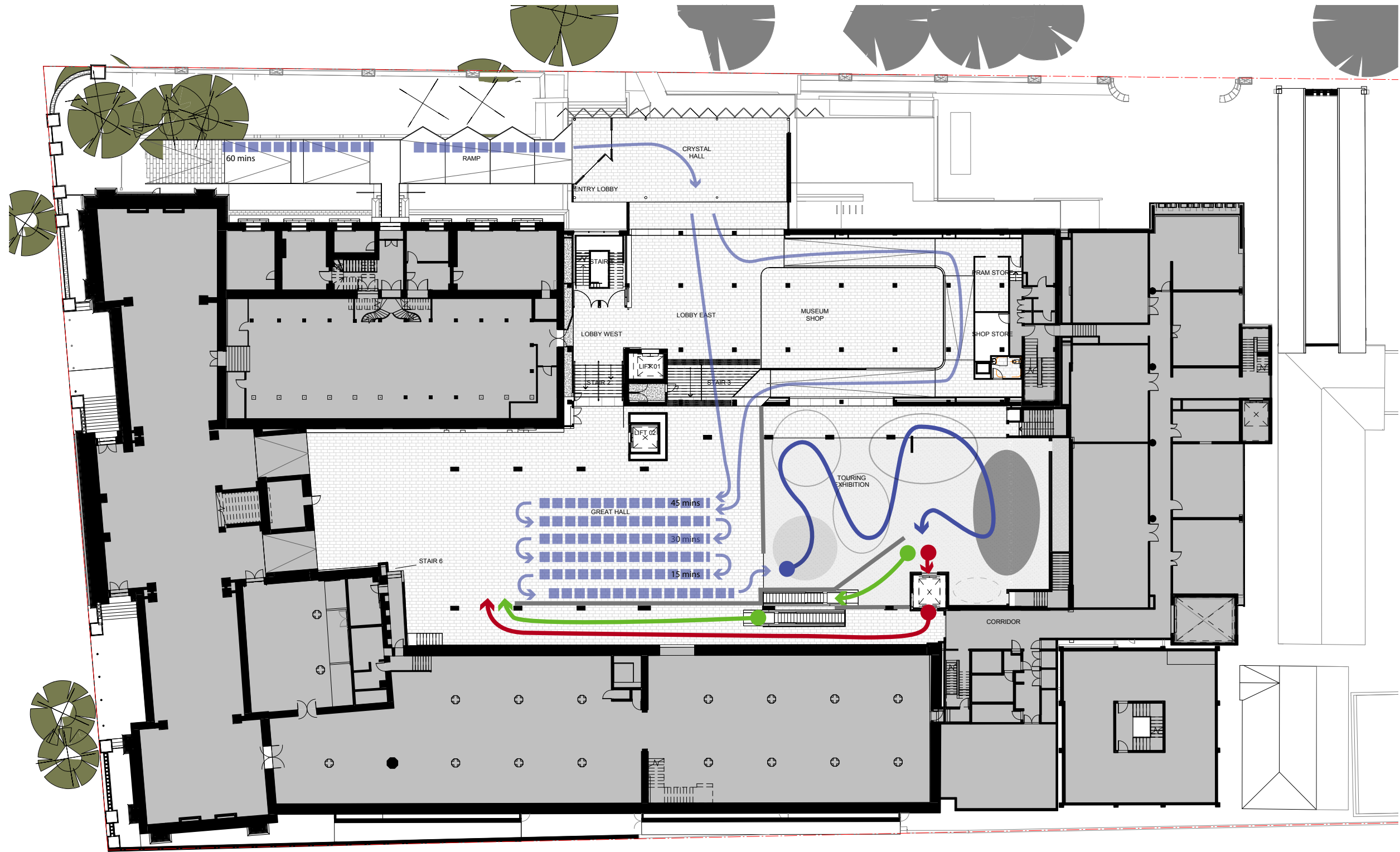

Queue and circulation study 4.
60 minute wait time.
15 mins external ramp. No lobby wait or internal ramp queue.
45 mins in Great Hall.

All visitors together
 Escalators users
 Lift users

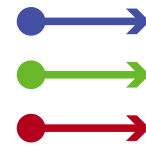







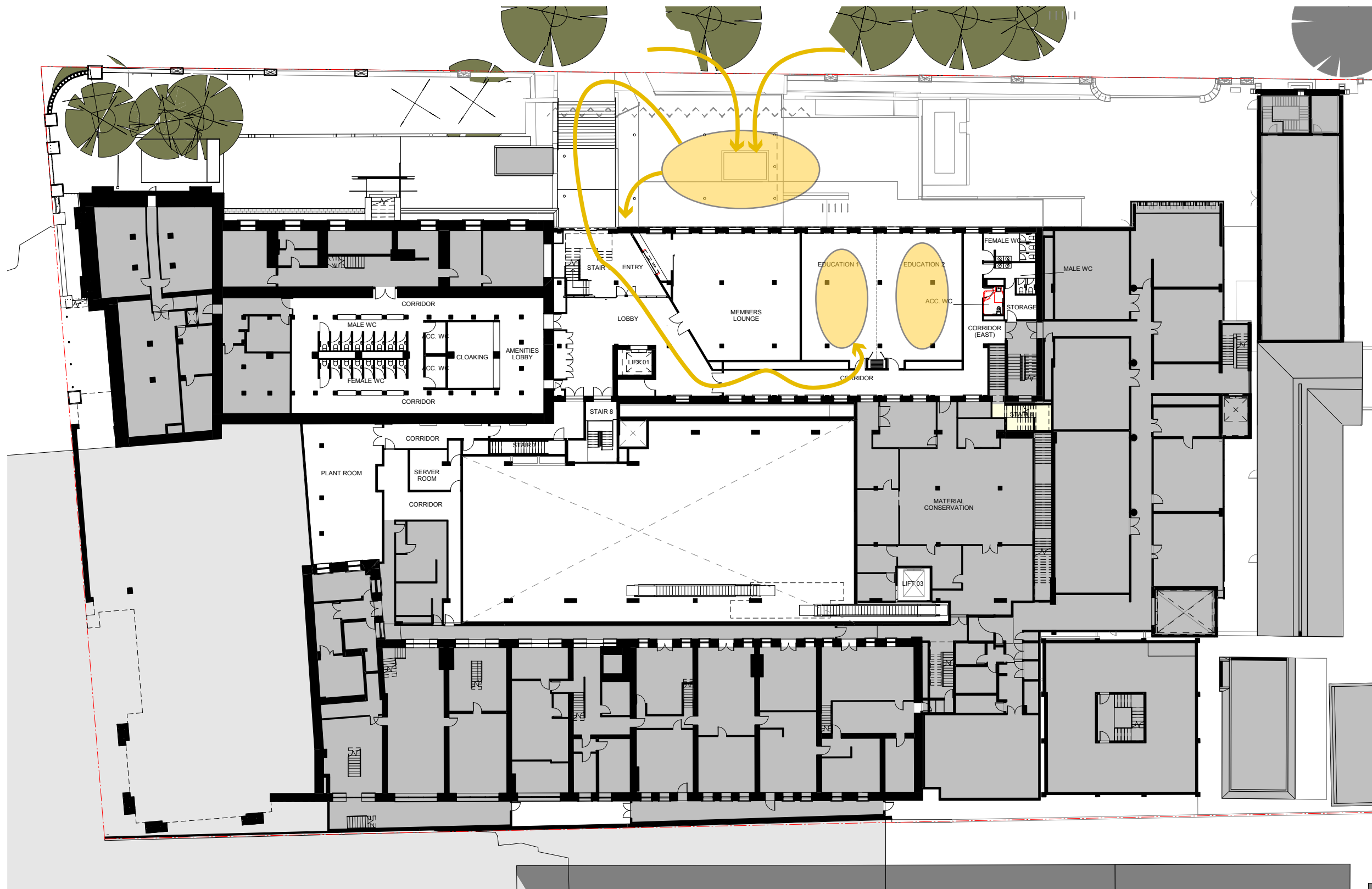

First experience
 Last experience









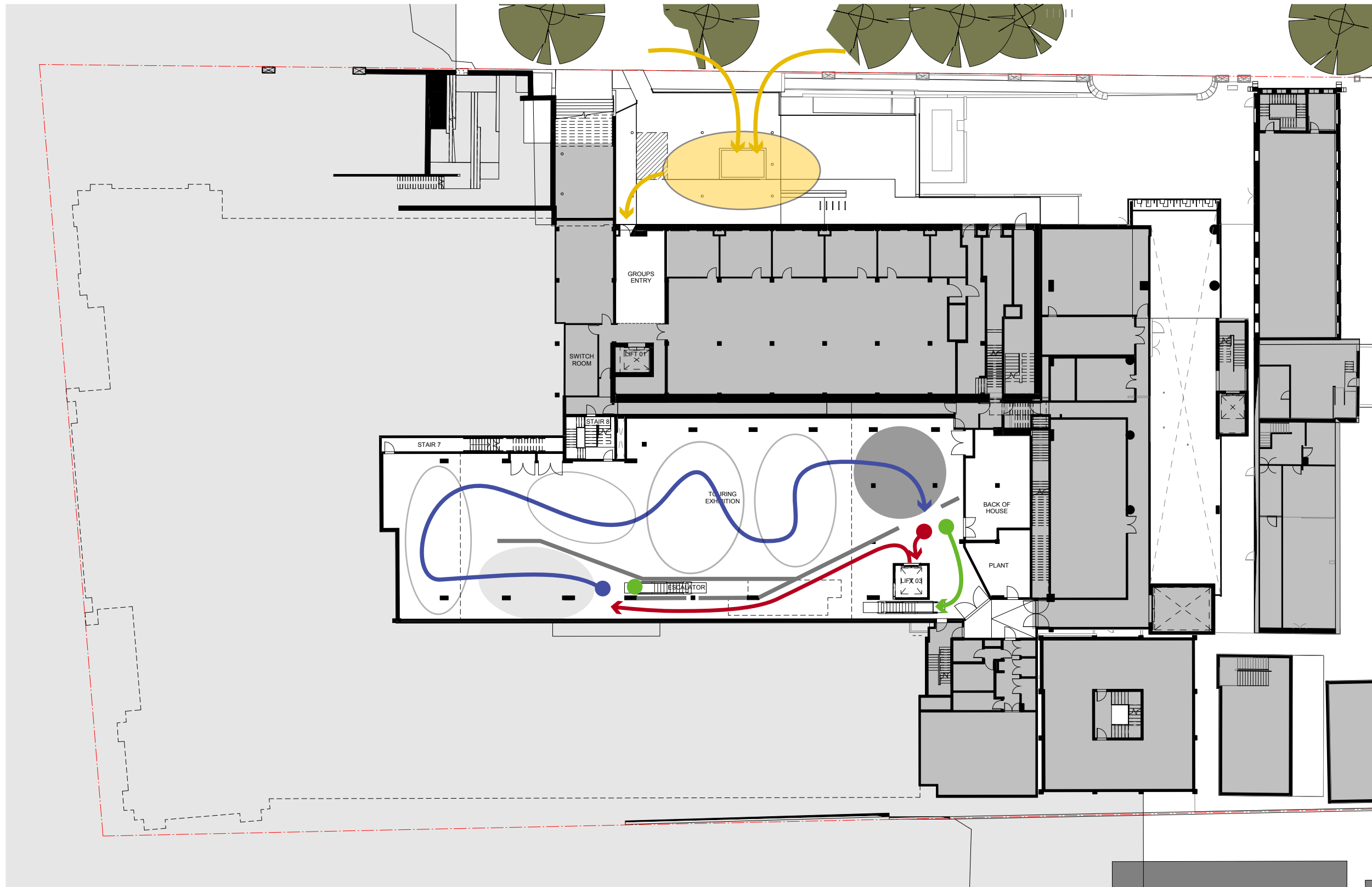

Approx 65 people
 7.5min wait time based on 5 minute intro film with 2.5min empty / fill interval





Group assembly		All visitors together		First experience		Approx 65 people	
Group circulation		Escalators users		Last experience		7.5min wait time based on 5 minute intro film with 2.5min empty / fill interval	
		Lift users					



- | | | | | | | | |
|-------------------|--------------------------------------------------------------------------------------|-----------------------|---------------------------------------------------------------------------------------|------------------|---------------------------------------------------------------------------------------|---------------------------------------------------------------------------------|---------------------------------------------------------------------------------------|
| Group assembly |  | All visitors together |  | First experience |  | Approx 65 people |  |
| Group circulation |  | Escalators users |  | Last experience |  | 7.5min wait time based on 5 minute intro film with 2.5min empty / fill interval | |
| | | Lift users |  | | | | |