

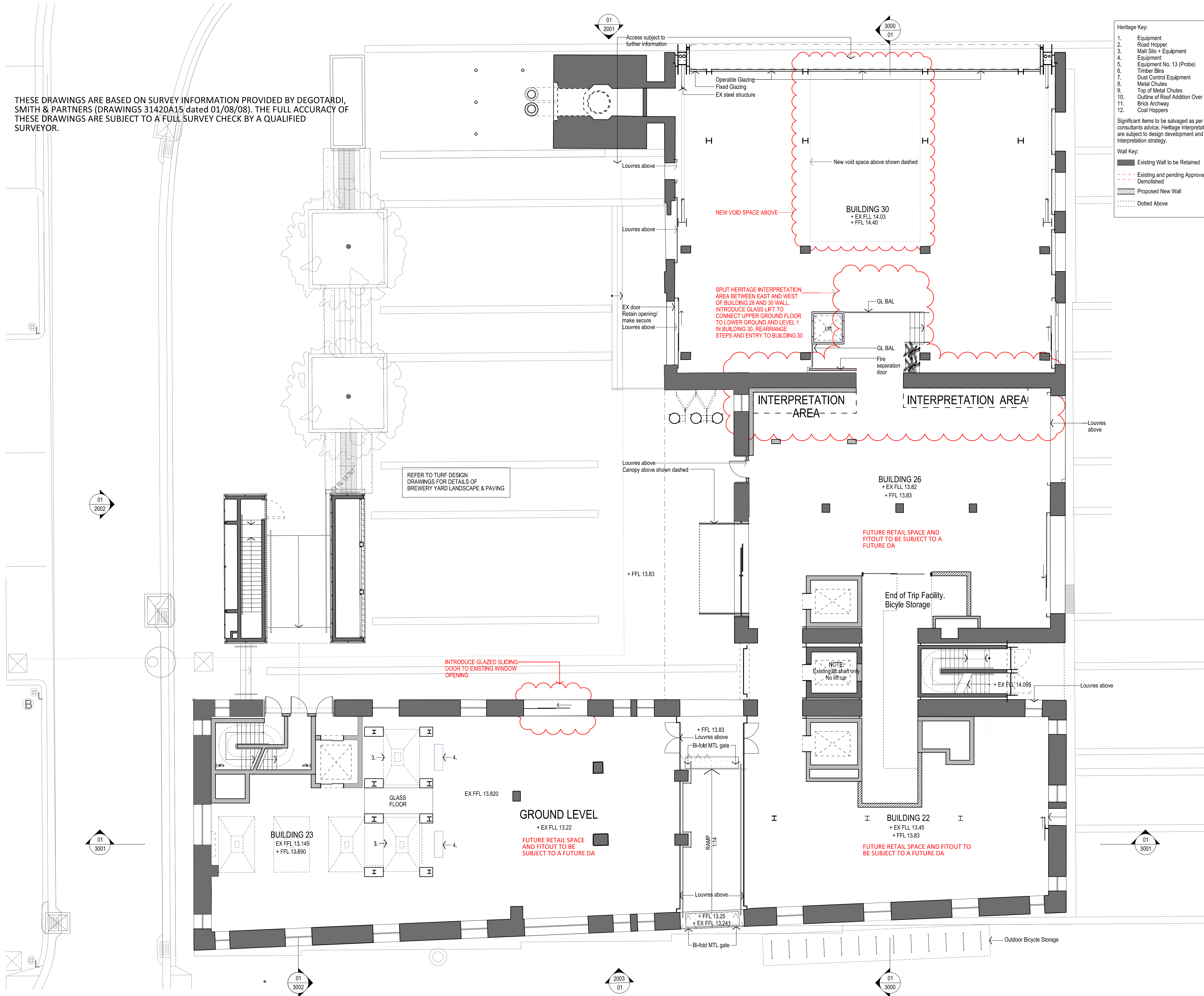



THESE DRAWINGS ARE BASED ON SURVEY INFORMATION PROVIDED BY DEGOTARDI,
SMITH & PARTNERS (DRAWINGS 31420A15 dated 01/08/08). THE FULL ACCURACY OF
THESE DRAWINGS ARE SUBJECT TO A FULL SURVEY CHECK BY A QUALIFIED
SURVEYOR.



- Heritage Key:**
1. Equipment
 2. Road Hopper
 3. Malt Silo + Equipment
 4. Equipment
 5. Equipment No. 13 (Probe)
 6. Timber Bins
 7. Dust Control Equipment
 8. Metal Chutes
 9. Top of Metal Chutes
 10. Outline of Roof Addition Over
 11. Brick Archway
 12. Coal Hoppers
- Significant items are to be salvaged as per heritage consultants advice. Heritage interpretation zones are subject to design development and revised interpretation strategy.
- Wall Key:**
- | | |
|---|--|
|  | Existing Wall to be Retained |
|  | Existing and pending Approval to be Demolished |
|  | Proposed New Wall |
|  | Dotted Above |

Copyright

Copyright owned by Tzannes.
Rights to this document are
subject to payment in full of
all Tzannes Fees. This document
may only be used for the express
purpose for which it has been
created and any unauthorized use
is at the user's sole risk and
without limiting Tzannes rights
the user releases and
indemnifies Tzannes from and
against all loss so arising.

Nominated Architects

Alec Tzannes 4174
Amy Dowse 8926

General Notes

Verify dimensions on site prior to commencing of work. Check existing RL's on site. Advise Architect of any discrepancies before commencement. Allow for adjustments to suit discrepancies. Comply with relevant authorities requirements. Comply with Building Code of Australia requirements. Comply with relevant Australian Standards for materials and construction practice. Comply with Section J. Do not scale from drawings.

Rev	Date	For
J	07.04.22	Issued for Mod. Submission
K	16.05.22	Issued for Mod. Submission
L	25.07.22	Issued for Mod. Submission

Client
Chris Lock, IP Generation
chris@ipgeneration.com.au

Project & Construction Manager
Matt Inch, John Staff
8256 0500 matt.inch@johnstaff.com.au

Heritage
Fiona Binns, Urbis
8233 7610 fbinns@urbis.com.au

Planner
Julia Moiso, Ethos Urban
9956 6962 jmoiso@ethosurban.com

- ### Legend
- | | |
|--------|----------------------|
| BW | Blind Window |
| BWK | Brickwork |
| CON | Concrete |
| EXF | Existing |
| FFL | Finished Floor Level |
| FG | Fixed Glass |
| GL BAL | Glass Balustrade |
| GLD | Glass Door |
| GLF | Glass Fixed Panel |
| LVR | Louvers |
| MW | Metal Window |
| RL | Relative Level |
| SLD | Sliding Door |

Tzannes

Scale North

1:100 @ A1 (Double at A3)

0 1 2 3 4 5m



Project
Brewery Yard

Address
Central Park
Chippendale NSW 2008

Status
For Development Application
Not for Construction

Drawing

Ground Floor Plan

Drawn	Checked
JC	AT

Project No.	Drawing No.	Revision
17007	DA 1102	L