

1 DEC 21, 9:00AM  
SCALE 1:1000

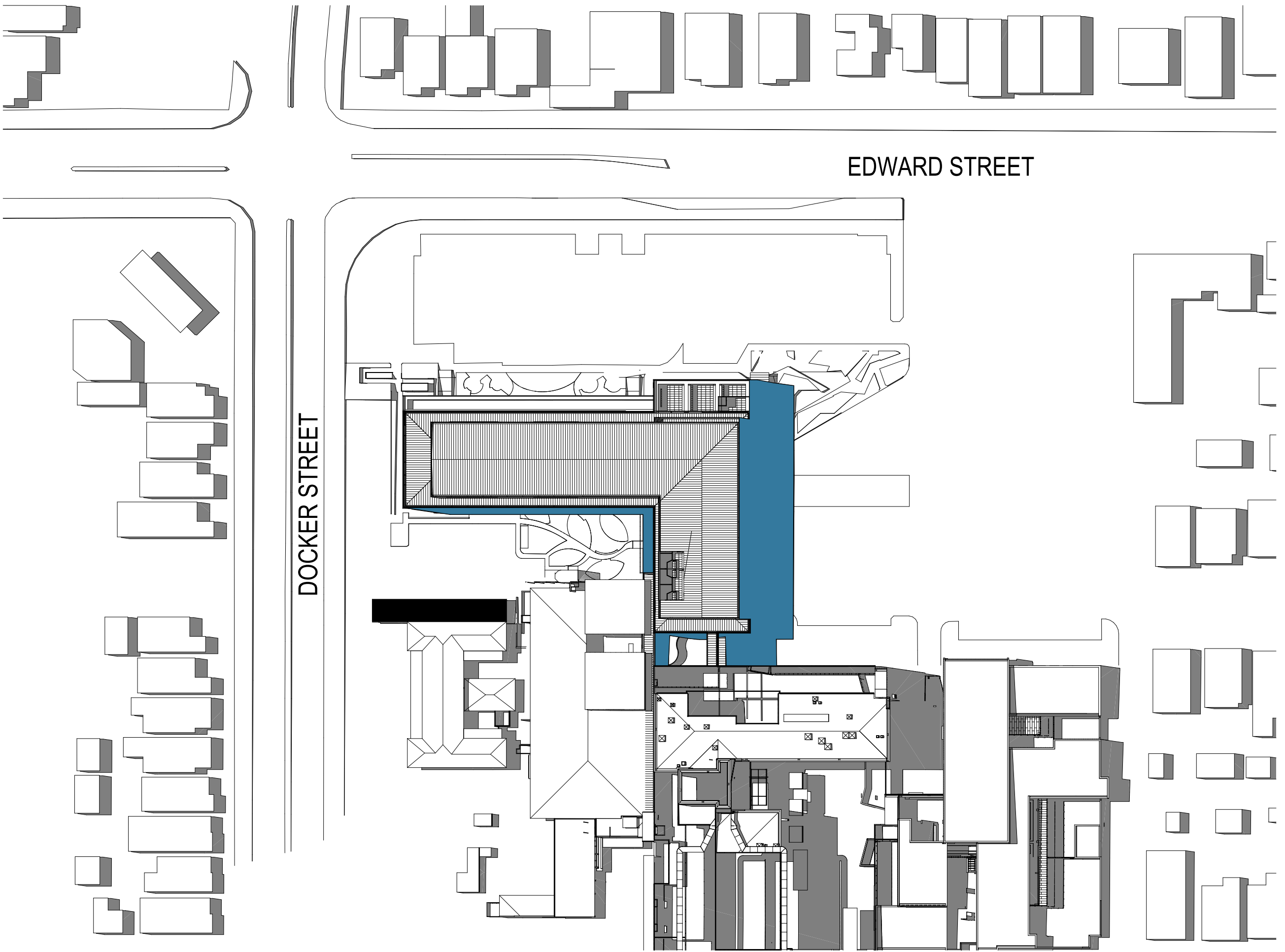

3 DEC 21, 3:00PM  
SCALE 1:1000

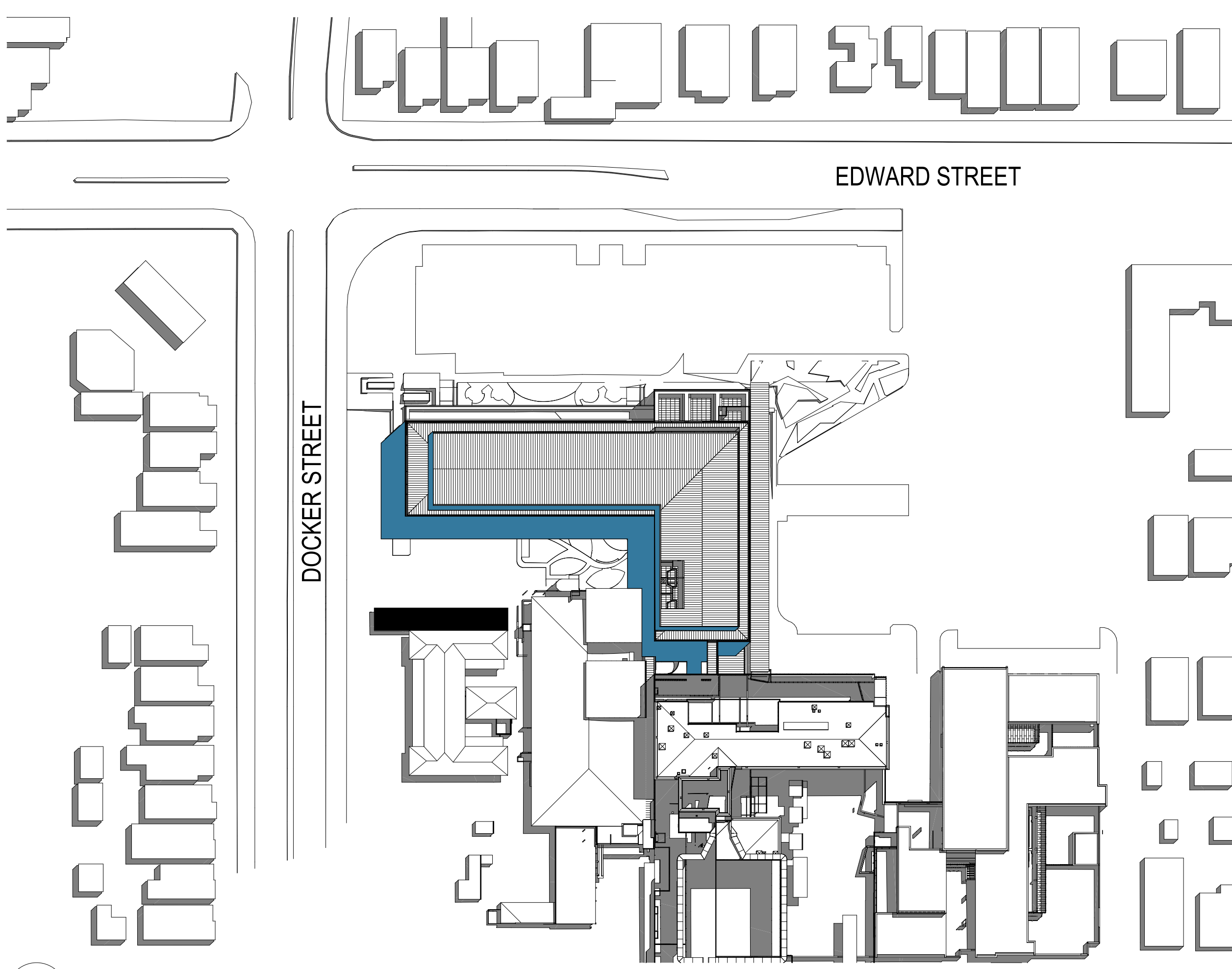

2 DEC 21, 12:00PM  
SCALE 1:1000

NOTES:

COPYRIGHT © ALL RIGHTS RESERVED. THIS DRAWING MAY NOT BE REPRODUCED OR TRANSMITTED IN ANY FORM OR BY ANY MEANS IN PART OR IN WHOLE WITHOUT PERMISSION OF MARTIN & OLLMANN PTY. LTD.

ALL LEVELS AND DIMENSIONS TO BE VERIFIED PRIOR TO COMMENCEMENT OF WORK. USE FIGURED DIMENSIONS ONLY. DO NOT SCALE.

ALL WORK TO COMPLY WITH CURRENT REGULATIONS AND S.A.A. STANDARDS.

NORTH:

N

LEGEND:

01	MRA	16/03/2018	REF DRAFT ISSUE
02	MRA	10/04/2018	SSD ISSUE
03	TK	10/04/2018	ISSUE FOR SSD
04	MRA	20/04/2018	SSD ISSUE - FOR REVIEW
05	MRA	10/05/2018	SSD ISSUE
06	MRA	10/06/2018	SSD ISSUE
No	Initial	DATE	REVISION DETAILS

ARCHITECT

MARTIN & OLLMANN

188 Willoughby Rd  
Crows Nest  
NSW 1585  
NSW Registered Architect: Cameron Martin 9194

T +61 2 9439 8522  
E: info@martin-ollmann.com  
www.martin-ollmann.com  
A.B.N. 20 120 471 051

CIENT

NSW GOVERNMENT

Health Infrastructure

14/77 PACIFIC HIGHWAY  
NORTH SYDNEY NSW 2060

phone : (02) 9978 5402  
email: hi-info@health.nsw.gov.au

PROJECT:

WAGGA WAGGA HEALTH SERVICE REDEVELOPMENT

Changing more than the buildings

STAGE 3 DEVELOPMENT  
CNR EDWARD & DOCKER STREET  
WAGGA WAGGA NSW 2650

DRAWING TITLE:

SHADOW DIAGRAM: DEC 21

SCALE: 1:1000@A1

DRAWN BY: TK

QA: CM

ISSUE DATE: 12/06/2018

PROJECT NUMBER: 17022

DRAWING NUMBER: SSD-ACB-9001

ISSUE: 06

ref: 17022 CH 03  
ref: BM Server: BMSEVER, BM Server: 21/1/2022 20:00:00 Wagga Wagga Stage 3/17022 CH 03 17022 CH 03

NOT FOR CONSTRUCTION 17022 SSD-ACB-9001 06





1 NORTH EAST PERSPECTIVE  
SCALE



2 SOUTH EAST PERSPECTIVE  
SCALE

NOTES:  
COPYRIGHT © ALL RIGHTS RESERVED. THIS DRAWING MAY NOT BE REPRODUCED OR TRANSMITTED IN ANY FORM OR BY ANY MEANS IN PART OR IN WHOLE WITHOUT PERMISSION OF MARTIN & OLLMANN PTY. LTD.  
ALL LEVELS AND DIMENSIONS TO BE VERIFIED PRIOR TO COMMENCEMENT OF WORK.  
USE FIGURED DIMENSIONS ONLY. DO NOT SCALE.  
ALL WORK TO COMPLY WITH CURRENT REGULATIONS AND S.A.A. STANDARDS.

NORTH:

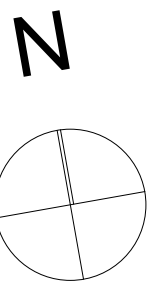

LEGEND:

01	MR	10/03/2018	REF SHAWT ISSUE
02	MR	12/04/2018	SSD ISSUE
03	TR	12/04/2018	ISSUE FOR SSD
04	MR	20/04/2018	SSD ISSUE - FOR REVIEW
05	MR	12/06/2018	SSD ISSUE

ARCHITECT

MARTIN & OLLMANN

188 Willoughby Rd  
Crows Nest  
NSW 2066  
NSW Nominated Architect: Cameron Martin 9194

T +61 2 9439 8522  
E: info@martin-ollmann.com  
www.martin-ollmann.com  
A.B.N. 20 120 071 051

CLIENT

NSW Health Infrastructure  
14/77 PACIFIC HIGHWAY  
NORTH SYDNEY NSW 2060  
phone : (02) 9978 5402  
email: hi-info@health.nsw.gov.au

PROJECT:  
WAGGA WAGGA HEALTH SERVICE  
REDEVELOPMENT  
Changing more than the buildings

STAGE 3 DEVELOPMENT  
CNR EDWARD & DOCKER STREET  
WAGGA WAGGA NSW 2650

DRAWING TITLE:  
MASSING ELEVATION 01

SCALE: DRAWN BY: QA: ISSUE DATE:  
@A1 MR CM 12/06/2018

PROJECT NUMBER: DRAWING NUMBER: ISSUE:

17022 SSD-ACB-9002 05

NOT FOR CONSTRUCTION





1 NORTH WEST PERSPECTIVE  
SCALE



2 SOUTH WEST PERSPECTIVE  
SCALE

NOTES:  
COPYRIGHT © ALL RIGHTS RESERVED. THIS DRAWING MAY NOT BE REPRODUCED OR TRANSMITTED IN ANY FORM OR BY ANY MEANS IN PART OR IN WHOLE WITHOUT PERMISSION OF MARTIN & OLLMANN PTY. LTD.  
ALL LEVELS AND DIMENSIONS TO BE VERIFIED PRIOR TO COMMENCEMENT OF WORK.  
USE FIGURED DIMENSIONS ONLY. DO NOT SCALE.  
ALL WORK TO COMPLY WITH CURRENT REGULATIONS AND S.A.A. STANDARDS.

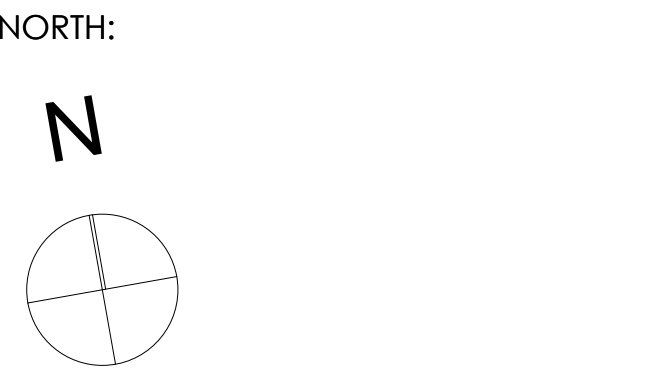

LEGEND:

01	MR	10/03/2018	REF SHAW ISSUE
02	MR	10/04/2018	SSD ISSUE
03	TR	10/04/2018	ISSUE FOR SSD
04	MR	20/04/2018	SSD ISSUE - FOR REVIEW
05	MR	10/06/2018	SSD ISSUE

No	Initial	DATE	REVISION DETAILS
----	---------	------	------------------

ARCHITECT

MARTIN & OLLMANN

188 Willoughby Rd  
Crows Nest  
NSW 1585  
NSW Nominated Architect: Cameron Martin 9194

T +61 2 9439 8522  
E: info@martin-ollmann.com  
www.martin-ollmann.com  
A.B.N. 20 150 071 051

CLIENT

**NSW** **Health**  
GOVERNMENT **Infrastructure**  
14/77 PACIFIC HIGHWAY  
NORTH SYDNEY NSW 2060  
phone : (02) 9978 5402  
email: n-info@health.nsw.gov.au

PROJECT:  
**WAGGA WAGGA HEALTH SERVICE  
REDEVELOPMENT**  
Changing more than the buildings

**STAGE 3 DEVELOPMENT**  
CNR EDWARD & DOCKER STREET  
WAGGA WAGGA NSW 2650

DRAWING TITLE:  
**MASSING ELEVATION 02**

SCALE: DRAWN BY: QA: ISSUE DATE:  
@A1 MR CM 12/06/2018

PROJECT NUMBER: DRAWING NUMBER: ISSUE:  
17022 SSD-ACB-9003 05

NOT FOR CONSTRUCTION