

1 ROOF PLAN - BLOCK A - 01 - WEST - INTERIM
05_0102 SCALE 1:100

REV	DATE	DESCRIPTION	BY	CHK
A	28.09.2018	FOR STAGE 1 RFP	ME	
B	12.07.2018	FOR CONSULTANT COORDINATION	ME	
C	17.09.2018	FOR QA	ME	
D	31.08.2018	FOR ECI	ME	
E	28.09.2018	RESPONSE TO SUBMISSIONS	UK	



webberarchitects
commercial and residential
Suite 3, Level 1 496 Hunter St Newcastle • PO Box 807 The Junction 2291
t +61 2 4922 6178 • f +61 2 4922 6178
newcastle@webberarchitects.com • www.webberarchitects.com

Director: Jon Webber (Chartered Architect) AIA, NEIS ARB NO. 8830
Associate Director: Sandra Mackay, Karen Brooks
Associates: Tim Hayes, Luke Keating

ROOF PLAN - BLOCK A - 01 - INTERIM
HIGH SCHOOL
CATHERINE McAULEY CATHOLIC SCHOOL
507 MEDOWIE ROAD, MEDOWIE, NSW

ISSUED:
PRELIMINARY ONLY
NOT FOR CONSTRUCTION

PROJECT COMMENCEMENT DATE: 01.05.2017

SCALE:
0 1000 2000 3000 4000 5000 mm
SCALE 1:100 @ A1

SHEET NUMBER: **2544_03_0114_E**

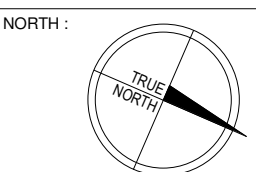

ABBREVIATIONS	
AW2	AWNING - TYPE 2
AW4	AWNING - TYPE 4
COL	COLUMN
CPP1	CONCRETE PRECAST PANEL - TYPE 1
DP1	DOWNPIPE - TYPE 1
EG	EAVES GUTTER
LWC1	LIGHT WEIGHT CLADDING - TYPE 1
LWC2	LIGHT WEIGHT CLADDING - TYPE 2
MRS1	METAL ROOF SHEETING - TYPE 1
MRS2	METAL ROOF SHEETING - TYPE 2
PPB1	PAINTED PLASTERBOARD - TYPE 1
SB1	STEEL BEAM - TYPE 1

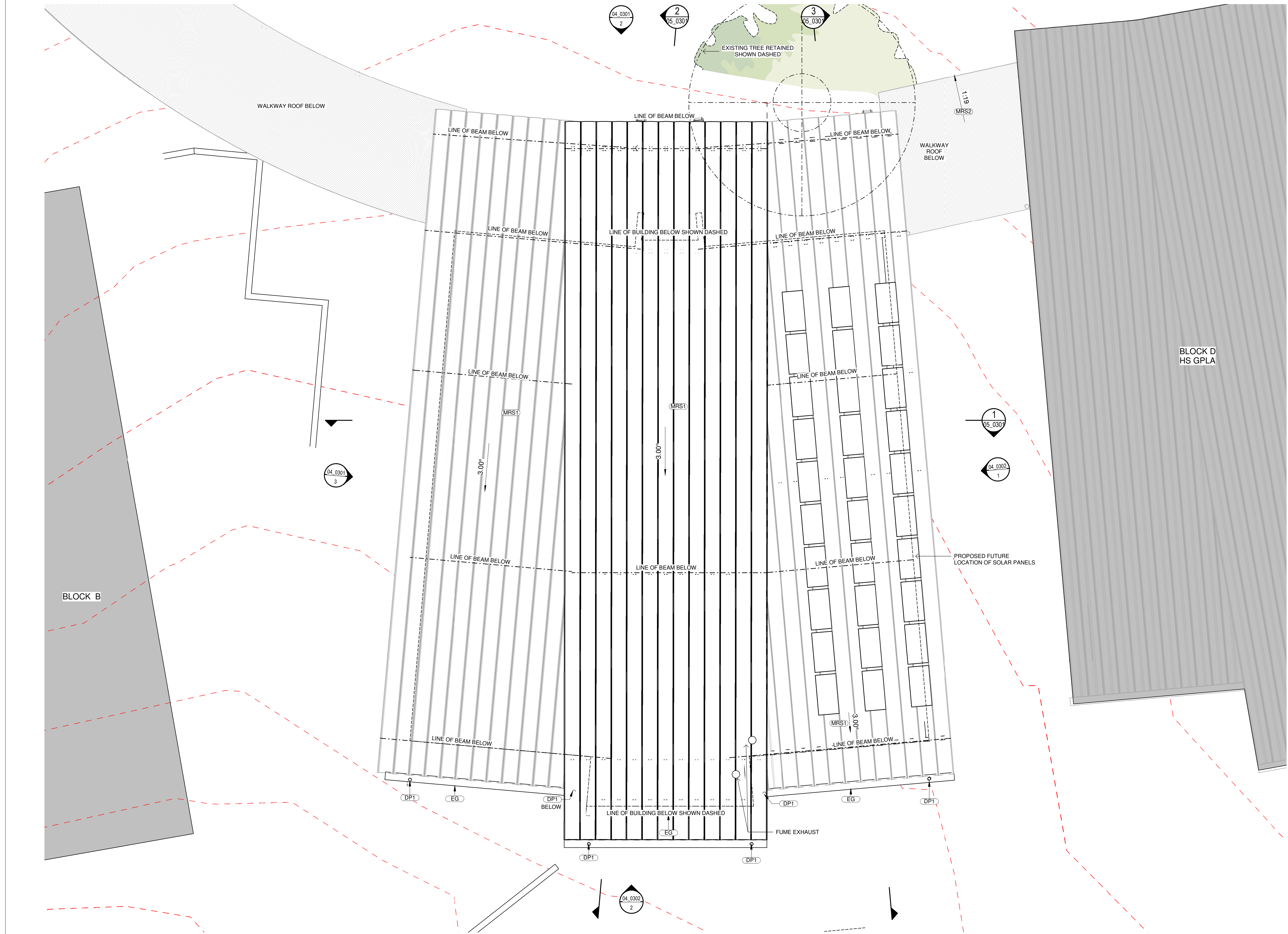

1 ROOF PLAN - BLOCK C
SCALE 1:100

LOCATION PLAN
SCALE 1:5000

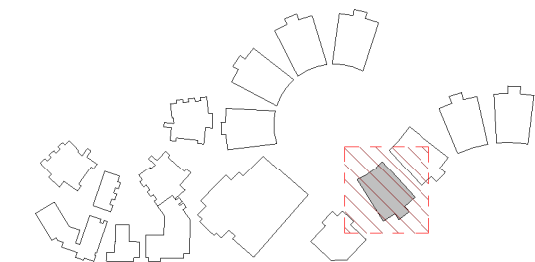

REV	DATE	DESCRIPTION	BY	CHK
A	25.01.2018	FOR DESIGN REVIEW	RH	
B	16.02.2018	DEVELOPED DESIGN - 90% ISSUE	RH	
C	09.03.2018	FOR DA	RH	
D	29.03.2018	FOR CLIENT APPROVAL	RH	TH
E	15.05.2018	FOR DEVELOPMENT APPROVAL	CH	
F	28.09.2018	RESPONSE TO SUBMISSIONS	UK	

BUILDER TO CONFIRM ALL DETAILS, SETOUTS (TILE, ETC.), FALLS & CONNECTIONS ON SITE BEFORE CONSTRUCTION

PRINT DATE: 24/09/2018 5:42:47 PM

FILE PATH: T:\Revit Local\2544 Meadowe High School Block C - Science_LikeH\FJSD.rvt



webberarchitects
commercial and residential

Suite 3, Level 1 496 Hunter St Newcastle
1 x 1 = 612 4 2 2 6 1 0 7 8
newcastle@webberarchitects.com

Director: Jon Webber (International Architect) AIA, NSW AHS NO. 6830
Associate Director: Sandra Hinchey, Karen Brooks
Associates: Tim Hayes, Luke Keating

ROOF PLAN - BLOCK C
HIGH SCHOOL - SCIENCE
CATHERINE MCAULEY CATHOLIC COLLEGE
507 MEDOWIE ROAD, MEDOWIE, NSW

ISSUED:
FOR DA APPROVAL
NOT FOR CONSTRUCTION

PROJECT COMMENCEMENT DATE: 01.05.2017

SCALE:
0 1000 2000 3000 4000 5000 mm
SCALE 1:100 @ A1

SHEET NUMBER: 2544_03_0303_F

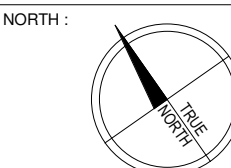

This drawing and the design expressed are copyright and remain the property of Webber Architects. In accordance with the commonwealth copyright act 1968 this drawing and design in whole or part may not be used unless licensed by Webber Architects. Verify all dimensions and falls on site before construction and do not scale from drawing.

ABBREVIATIONS	
AW1	AWNING - TYPE 1
AW2	AWNING - TYPE 2
AW3	AWNING - TYPE 3
AW4	AWNING - TYPE 4
COL1	COLUMN - TYPE 1
COL2	COLUMN - TYPE 2
CON1	CONCRETE - TYPE 1
CPP1	CONCRETE PRECAST PANEL - TYPE 1
DP1	DOWNPIPE - TYPE 1
EG1	EAVES GUTTER - TYPE 1
LWC1	LIGHT WEIGHT CLADDING - TYPE 1
LWC2	LIGHT WEIGHT CLADDING - TYPE 2
MRS1	METAL ROOF SHEETING - TYPE 1
MRS2	METAL ROOF SHEETING - TYPE 2
PAV1	PAVING - TYPE 1
SB1	STEEL BEAM - TYPE 1

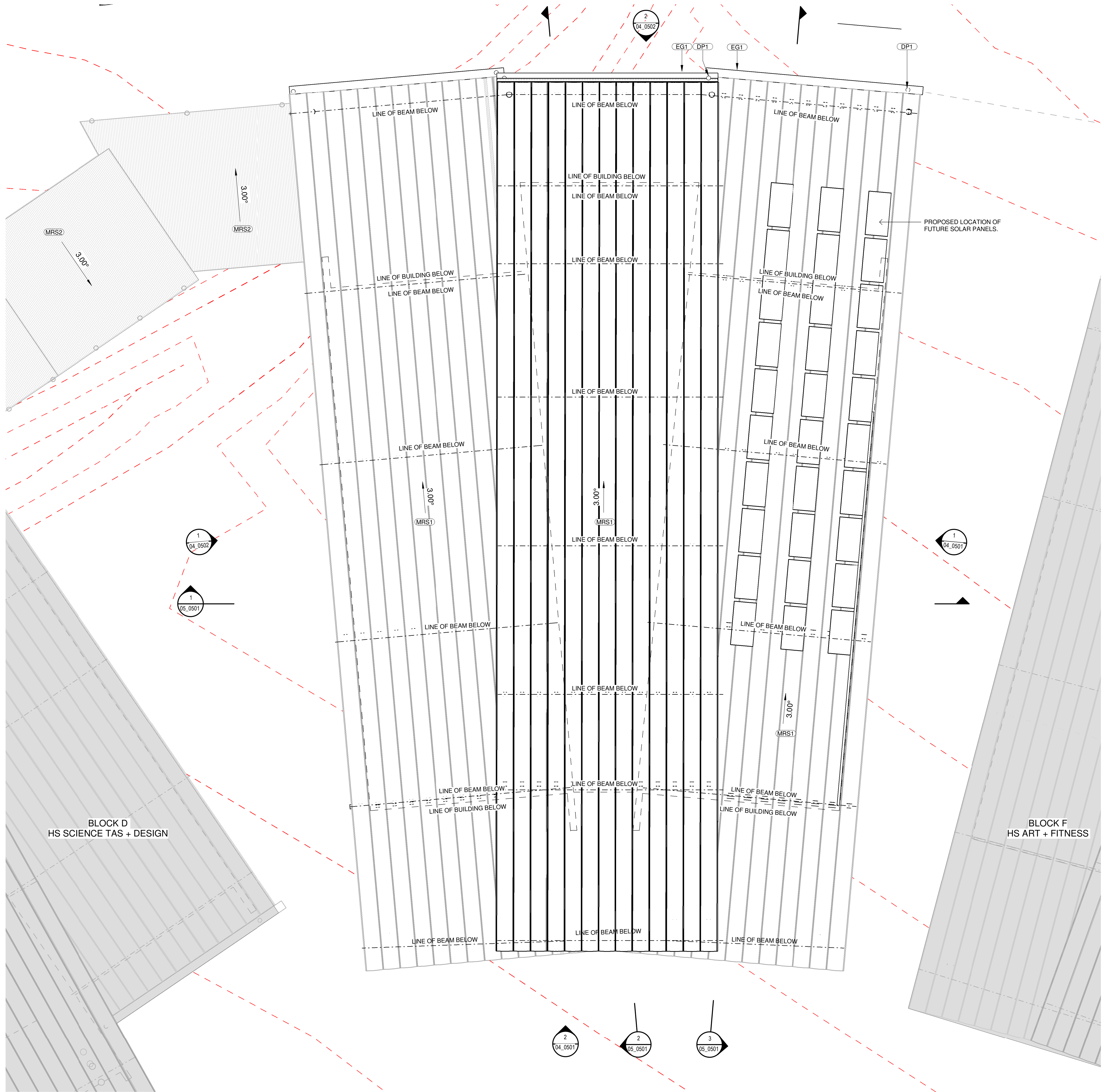

1 ROOF PLAN
04_0501 SCALE 1:100

LOCATION PLAN

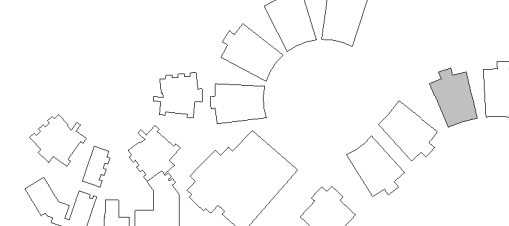

REV	DATE	DESCRIPTION	BY	CHK
A	16.01.2018	FOR STAKEHOLDER MEETING	ME	
B	25.01.2018	DESIGN REVIEW	ME	
C	01.02.2018	CONSULTANT COORDINATION	CA	
D	16.02.2018	DEVELOPED DESIGN - 90%	ME	
E	09.03.2018	FOR DA	ME	
F	29.03.2018	FOR CLIENT APPROVAL	DF	TH
G	15.05.2018	FOR DEVELOPMENT APPROVAL	CH	
H	29.09.2018	RESPONSE TO SUBMISSIONS	LK	

BUILDER TO CONFIRM ALL DETAILS, SETOUTS (TILE, ETC.), FALLS & CONNECTIONS ON SITE BEFORE CONSTRUCTION

PRINT DATE: 24/09/2018 4:26:36 PM

FILE PATH: T:\Revit Local\2544 Meadowe_High School Block E - TAS_kahFJJSO.rvt



webberarchitects
commercial and residential

Suite 3, Level 1 496 Hunter St Newcastle
1 x 1 = 612 4 928 1 978
newcastle@webberarchitects.com

PO Box 807 The Junction 2291
+61 1800 128 400 1800 128 400
www.webberarchitects.com

Director: Jon Webber (International Architect) AIA, NSW AIB NO. 6830
Associate Director: Sandra Winkler, Karen Brooks
Associates: Tim Hayes, Luke Keating

ROOF PLAN - BLOCK E
HIGH SCHOOL TAS & DESIGN
CATHERINE MCAULEY CATHOLIC COLLEGE
507 MEDOWIE ROAD, MEDOWIE, NSW

ISSUED:
FOR DA APPROVAL
NOT FOR CONSTRUCTION

PROJECT COMMENCEMENT DATE: 01.05.2017

SCALE:
0 1000 2000 3000 4000 5000 mm
SCALE 1:100 @ A1

SHEET NUMBER: **2544_03_0503_H**

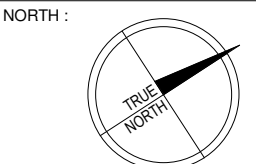

This drawing and the design expressed are copyright and remain the property of Webber Architects. In accordance with the commonwealth copyright act 1968 this drawing and design in whole or part may not be used unless licensed by Webber Architects. Verify all dimensions and falls on site before construction and do not scale from drawing.

ABBREVIATIONS	
AW1	AWNING - TYPE 1
AW3	AWNING - TYPE 3
AW4	AWNING - TYPE 4
COL1	COLUMN - TYPE 1
COL2	COLUMN - TYPE 2
CPP1	CONCRETE PRECAST PANEL - TYPE 1
DP1	DOWNPIPE - TYPE 1
EG1	EAVES GUTTER - TYPE 1
LWC1	LIGHT WEIGHT CLADDING - TYPE 1
LWC2	LIGHT WEIGHT CLADDING - TYPE 2
MRS1	METAL ROOF SHEETING - TYPE 1
SB1	STEEL BEAM - TYPE 1

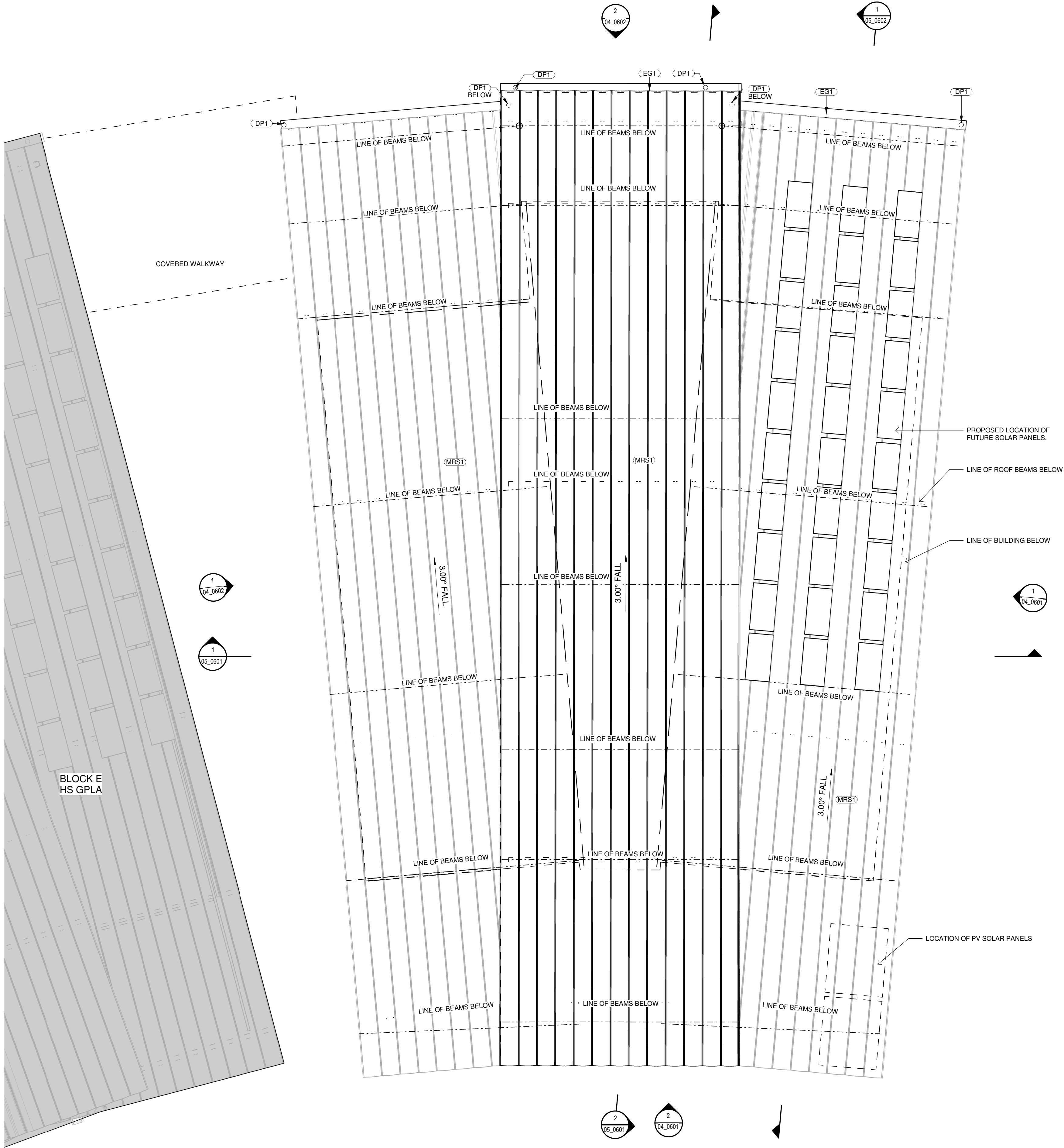

1 ROOF PLAN - BLOCK F
SCALE 1:100

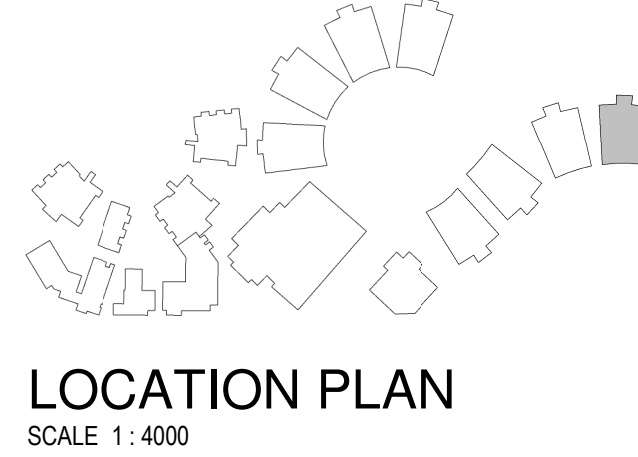

REV	DATE	DESCRIPTION	BY	CHK
A	26.07.2017	FOR REVIEW	FE	
B	02.08.2017	FOR PWE QA	FE	
C	16.01.2018	FOR STAKEHOLDER MEETING	RH	
D	25.01.2018	FOR DESIGN REVIEW	CH	
E	16.02.2018	DEVELOPED DESIGN - 90%	RH	
F	09.03.2018	FOR QA	DF	TH
G	29.03.2018	FOR CLIENT APPROVAL	CH	
H	15.05.2018	FOR DEVELOPMENT APPROVAL	CH	
I	28.09.2018	RESPONSE TO SUBMISSIONS	LK	

BUILDER TO CONFIRM ALL DETAILS, SETOUTS (TILE, ETC.), FALLS & CONNECTIONS ON SITE BEFORE CONSTRUCTION

PRINT DATE: 24/09/2018 4:43:02 PM

FILE PATH: T:\Revit Local\2544 Medowie_High School Block F - Art_Fitness_lukeH\ISQ.rvt



webberarchitects
commercial and residential

Suite 3, Level 1 496 Hunter St Newcastle
1st fl - 812 4 922 8 1 07 8
newcastle@webberarchitects.com

PO Box 807 The Junction 2291
+61 1800 102 100 +61 011 851 851 851
www.webberarchitects.com

Director: Jon Webber (International Architect) AIA, NEIS, AIA, NEIS, AIA
Associate Director: Sarah Hinchey, Karen Brooks
Associates: Tim Hayes, Luke Keating

ROOF PLAN - BLOCK F
HIGH SCHOOL
CATHERINE MCAULEY CATHOLIC COLLEGE
507 MEDOWIE ROAD, MEDOWIE, NSW

ISSUED:
FOR DA APPROVAL
NOT FOR CONSTRUCTION

PROJECT COMMENCEMENT DATE: 01.05.2017

SCALE:
0 1000 2000 3000 4000 5000 mm
SCALE 1:100 @ A1

SHEET NUMBER: 2544_03_0603_I

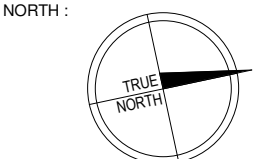

This drawing and the design expressed are copyright and remain the property of Webber Architects. In accordance with the commonwealth copyright act 1968 this drawing and design in whole or part may not be used unless licensed by Webber Architects. Verify all dimensions and falls on site before construction and do not scale from drawing.

ABBREVIATIONS	
AW2	AWNING - TYPE 2
AW3	AWNING - TYPE 3
AW4	AWNING - TYPE 4
B2	BALUSTRADE - TYPE 2
COL1	COLUMN - TYPE 1
CON1	CONCRETE - TYPE 1
CPP1	CONCRETE PRECAST PANEL - TYPE 1
DP1	DOWNPIPE - TYPE 1
EG	EAVES GUTTER
LWC1	LIGHT WEIGHT CLADDING - TYPE 1
LWC2	LIGHT WEIGHT CLADDING - TYPE 2
MRS1	METAL ROOF SHEETING - TYPE 1
S1	SCREEN - TYPE 1

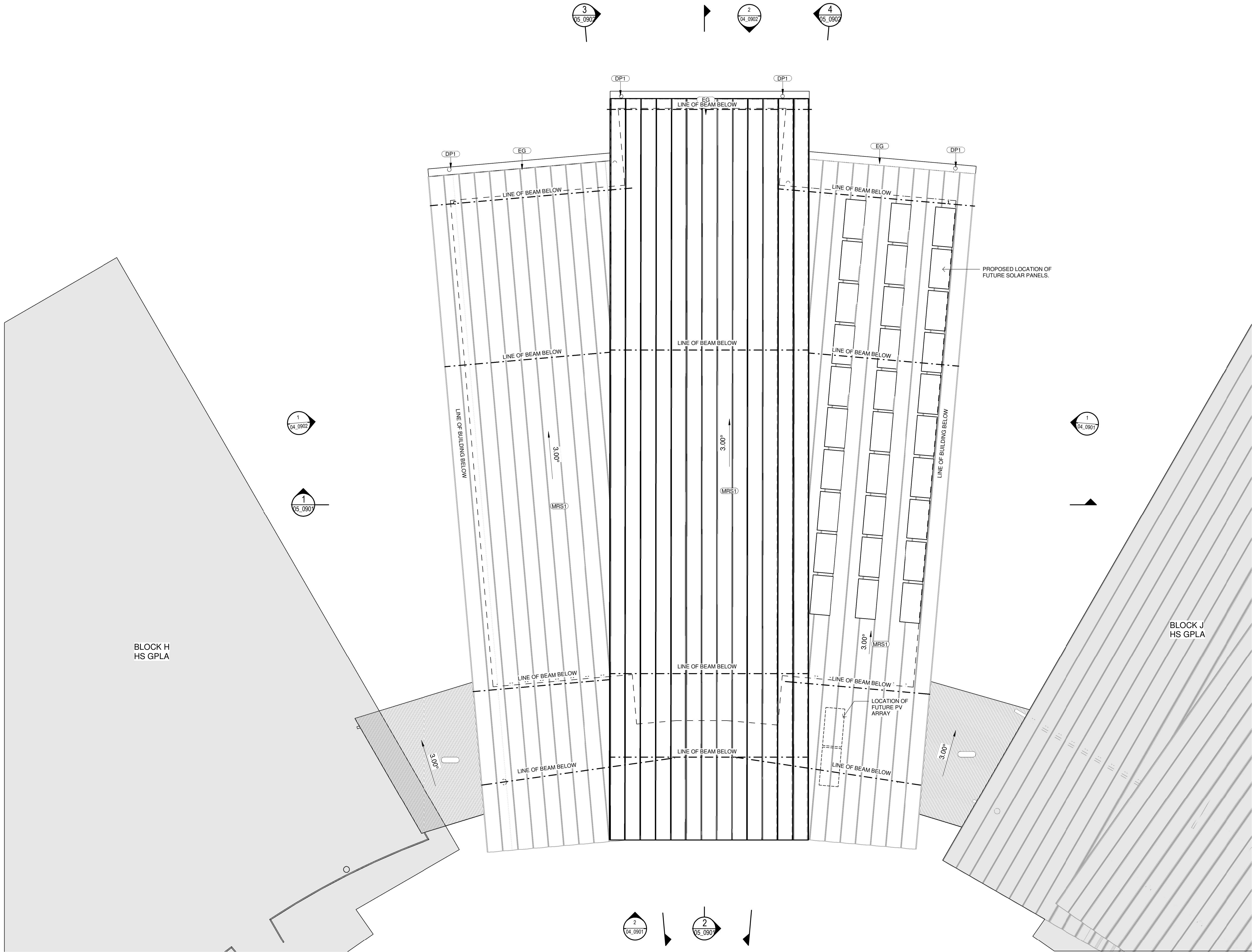

LOCATION PLAN
SCALE 1:5000

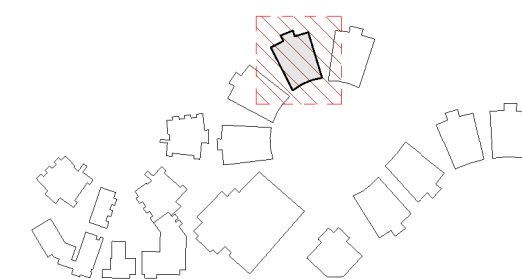

4 ROOF PLAN - BLOCK I
SCALE 1:100

REV	DATE	DESCRIPTION	BY	CHK
A	16.02.2018	DEVELOPED DESIGN - 90%	RH	
B	09.03.2018	FOR GA	CH	
C	29.03.2018	FOR CLIENT APPROVAL	RH	TH
D	15.05.2018	FOR DEVELOPMENT APPROVAL	CH	
E	28.09.2018	RESPONSE TO SUBMISSION	LK	

BUILDER TO CONFIRM ALL DETAILS, SETOUTS (TILE, ETC.), FALLS & CONNECTIONS ON SITE BEFORE CONSTRUCTION

PRINT DATE: 24/09/2018 4:56:32 PM

FILE PATH: T:\Revit Local\2544 Medowie_High School Block I - GPLA_lukeH\FJISQ.rvt



webberarchitects
commercial and residential
Suite 3, Level 1 496 Hunter St Newcastle • PO Box 807 The Junction 2291
t +61 2 492 4 92 2 8 f +61 2 492 4 92 2 8
newcastle@webberarchitects.com • www.webberarchitects.com

Directors: Jon Webber (Chartered Architect) AIA, NSW AIB NO. 6830
Sandra Winchey, Karen Brooks
Associate Directors: Tim Hayes
Associates: Luke Keating

**ROOF PLAN - BLOCK I
HS GPLA**
CATHERINE MCAULEY CATHOLIC COLLEGE
507 MEDOWIE ROAD, MEDOWIE, NSW

ISSUED:
FOR DA APPROVAL
NOT FOR CONSTRUCTION

PROJECT COMMENCEMENT DATE: 01.05.2017

SCALE:
0 1000 2000 3000 4000 5000 mm
SCALE 1:100 @ A1

SHEET NUMBER: **2544_03_0905_E**

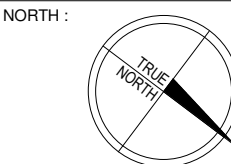

This drawing and the design expressed are copyright and remain the property of Webber Architects. In accordance with the commonwealth copyright act 1968 this drawing and design in whole or part may not be used unless licensed by Webber Architects. Verify all dimensions and falls on site before construction and do not scale from drawing.

ABBREVIATION	
AW5	AWNING - TYPE 5
BW2	BRICK WALL - TYPE 2
COL2	COLUMN - TYPE 2
COL3	COLUMN - TYPE 3
DP2	DOWNPIPE - TYPE 2
DP3	DOWNPIPE - TYPE 3
EG2	EAVES GUTTER - TYPE 2
EG3	EAVES GUTTER - TYPE 3
FHR	FIRE HOSE REEL
GD	GRATED DRAIN
LWC4	LIGHT WEIGHT CLADDING - TYPE 4
LWC5	LIGHT WEIGHT CLADDING - TYPE 5
LWC6	LIGHT WEIGHT CLADDING - TYPE 6
MAT	RECESSED DOOR MAT
MRC	METAL ROOF CAPPING
MRS3	METAL ROOF SHEETING - TYPE 3
MRS4	METAL ROOF SHEETING - TYPE 4

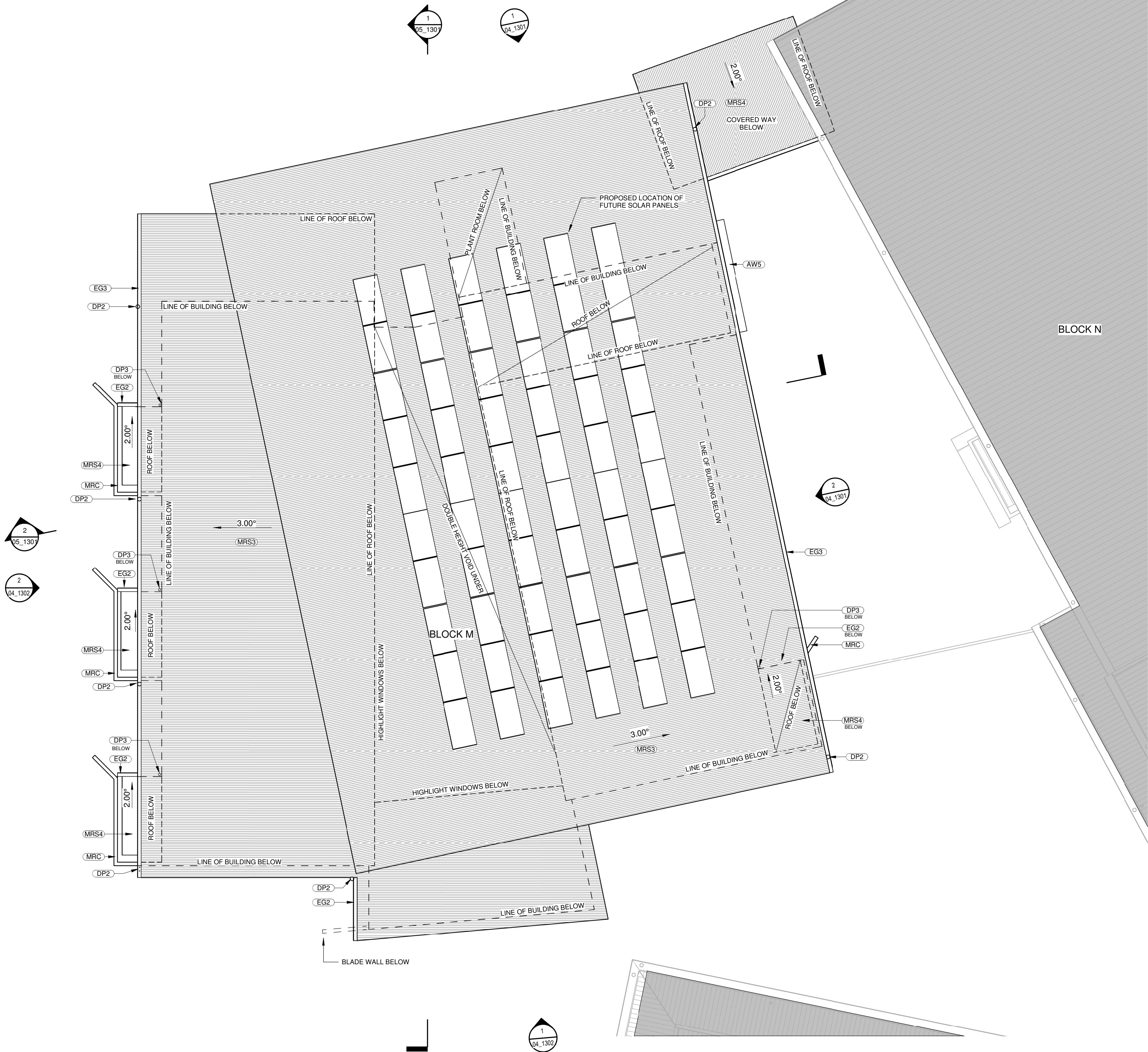

1 ROOF PLAN
SCALE 1:100

LOCATION PLAN

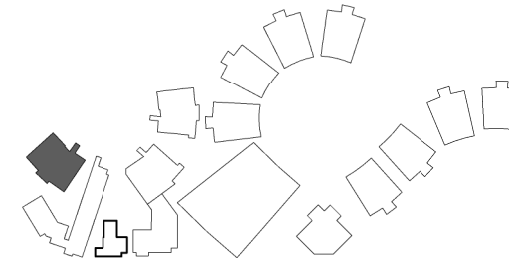

REV	DATE	DESCRIPTION	BY	CHK
A	16.02.2018	DEVELOPED DESIGN - 90%	SWR	
B	09.03.2018	FOR DA	ME	
C	29.03.2018	FOR CLIENT APPROVAL	SWR	LK
D	15.05.2018	FOR DEVELOPMENT APPROVAL	CH	
E	29.09.2018	RESPONSE TO SUBMISSION	LK	

BUILDER TO CONFIRM ALL DETAILS, SETOUTS (TILE, ETC.), FALLS & CONNECTIONS ON SITE BEFORE CONSTRUCTION

PRINT DATE: 24/09/2018 3:14:46 PM

FILE PATH: T:\Revit Local\2544 Medowie Primary School Block M LukeHF.JSQ.rvt



webberarchitects
commercial and residential

Suite 3, Level 1 496 Hunter St Newcastle • PO Box 807 The Junction 2291
t +61 2 49226 1678 • a.n. 0800 128 49226 • a.n. 0149 652 866
newcastle@webberarchitects.com • www.webberarchitects.com

Director: Jon Webber (Principal Architect) AIA, NSW AIB NO. 6830
Associate Director: Sandra Wootley, Karen Brooks
Associates: Tim Hayes, Luke Keating

ROOF PLAN - BLOCK M
PRIMARY SCHOOL
CATHERINE MCAULEY CATHOLIC COLLEGE
507 MEDOWIE ROAD, MEDOWIE, NSW

ISSUED:
FOR DA APPROVAL
NOT FOR CONSTRUCTION

PROJECT COMMENCEMENT DATE: 01.05.2017

SCALE:
0 1000 2000 3000 4000 5000 mm
SCALE 1:100 @ A1

SHEET NUMBER: 2544_03_1305_E

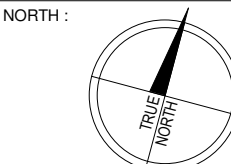

This drawing and the design expressed are copyright and remain the property of Webber Architects. In accordance with the commonwealth copyright act 1968 this drawing and design in whole or part may not be used unless licensed by Webber Architects. Verify all dimensions and falls on site before construction and do not scale from drawing.