

ABBREVIATIONS	
AW2	AWNING - TYPE 2
AW4	AWNING - TYPE 4
COL	COLUMN
CPP1	CONCRETE PRECAST PANEL - TYPE 1
DP1	DOWNPIPE - TYPE 1
EG	EAVES GUTTER
LWC1	LIGHT WEIGHT CLADDING - TYPE 1
LWC2	LIGHT WEIGHT CLADDING - TYPE 2
MRS1	METAL ROOF SHEETING - TYPE 1
MRS2	METAL ROOF SHEETING - TYPE 2
PPB1	PAINTED PLASTERBOARD - TYPE 1
RWT1	RAIN WATER TANK - TYPE 1
SB1	STEEL BEAM - TYPE 1

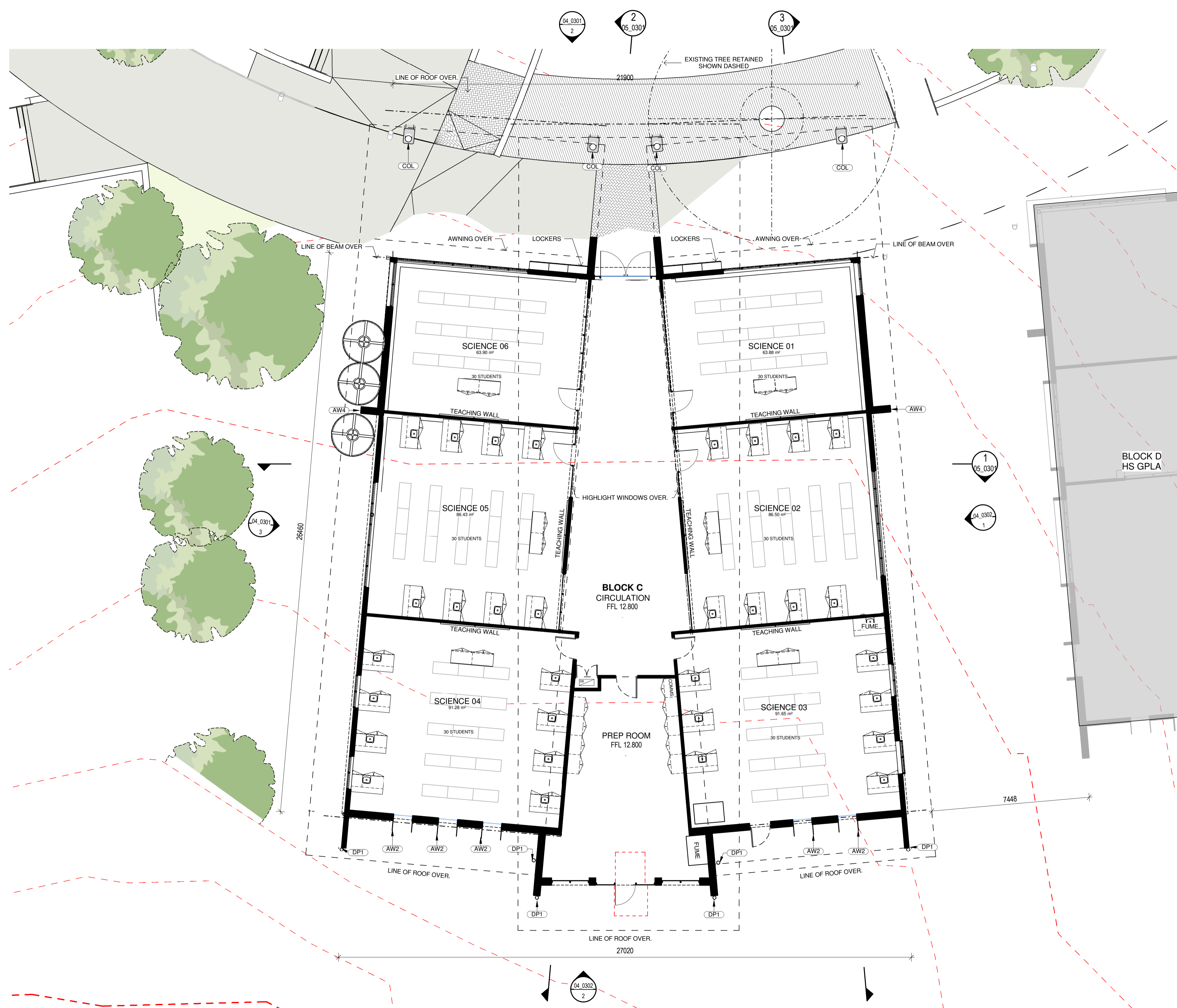

**1 FLOOR PLAN - BLOCK C - GROUND**  
04\_0301 SCALE 1:100

**LOCATION PLAN**

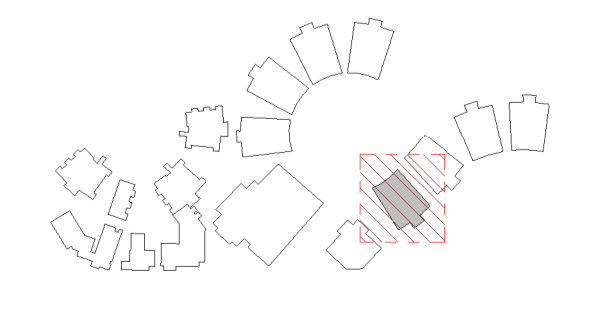

REV	DATE	DESCRIPTION	BY	CHK
A	26.07.2017	FOR REVIEW	FE	
B	02.08.2017	FOR PPE DA	FE	
C	16.01.2018	FOR STAKEHOLDER MEETING	ME	
D	25.01.2018	FOR DESIGN REVIEW	RH	
E	16.02.2018	DEVELOPED DESIGN - 90% ISSUE	RH	
F	09.03.2018	FOR DA	RH	
G	29.03.2018	FOR CLIENT APPROVAL	RH	TH
H	15.05.2018	FOR DEVELOPMENT APPROVAL	CH	



**webberarchitects**  
commercial and residential

141 - 812 4226 1078  
newcastle@webberarchitects.com www.webberarchitects.com

Directors: Jill Webber (International Architect), Alan Nelson (RIBA), 6030  
Sandra Wray, Karen Brooks  
Associate: Luke Keating

**FLOOR PLAN - BLOCK C - GROUND**  
**HIGH SCHOOL - SCIENCE**  
CATHERINE MCAULEY CATHOLIC COLLEGE  
507 MEDOWIE ROAD, MEDOWIE, NSW

ISSUED:  
**FOR DA APPROVAL**  
**NOT FOR CONSTRUCTION**

