

PHYSICAL EDUCATION AND SPORTS PRECINCT PROJECT (PESPP)

HUNTERS HILL, NSW

DRAWING LIST

Drawing Status	Sheet Number	Sheet Name	Scale	Rev
AR.DA.	0000	COVER SHEET AND SITE LOCATION PLAN	As indicated	A
AR.DA.	1001	EXISTING SITE PLAN	1:500	A
AR.DA.	1002	SITE ANALYSIS	As Indicated	A
AR.DA.	1003	EXISTING SITE VIEWS	As indicated	A
AR.DA.	1004	SITE CONTROL PLAN	1:200	A
AR.DA.	1005	SITE DEMOLITION PLAN	1:500	A
AR.DA.	1101	PROPOSED SITE PLAN	1:500	A
AR.DA.	2001	EXISTING LOWER GROUND PLAN	1:200	A
AR.DA.	2002	EXISTING GROUND PLAN	1:200	A
AR.DA.	2003	EXISTING UPPER GROUND PLAN	1:200	A
AR.DA.	2004	EXISTING ROOF PLAN	1:200	A
AR.DA.	2101	PROPOSED LOWER GROUND PLAN	1:200	A
AR.DA.	2102	PROPOSED GROUND FLOOR PLAN	1:200	A
AR.DA.	2103	PROPOSED FIRST FLOOR PLAN	1:200	A
AR.DA.	2104	PROPOSED ROOF PLAN	1:200	A
AR.DA.	2201	PROPOSED HEALY GYM	1:200	A
AR.DA.	2202	PROPOSED HEALY GYM 3D VIEWS	As Indicated	A
AR.DA.	2203	PROPOSED SUBSTATION	1:500	A
AR.DA.	3001	PROPOSED ELEVATIONS	1:200	A
AR.DA.	3101	PROPOSED SECTIONS	1:200	A
AR.DA.	4001	EXISTING SHADOW DIAGRAMS 1_SPRING/SUMMER/AUTUMN	1:1000	A
AR.DA.	4002	PROPOSED SHADOW DIAGRAMS 1_SPRING/SUMMER/AUTUMN	1:1000	A
AR.DA.	4003	EXISTING SHADOW DIAGRAMS 1_WINTER	1:1000	A
AR.DA.	4004	PROPOSED SHADOW DIAGRAMS 1_WINTER	1:1000	A
AR.DA.	4005	COMPARISON OF WINTER SHADOWS ON ELEVATIONS 1	As Indicated	A
AR.DA.	4011	EXISTING SHADOW DIAGRAMS 2_SPRING/SUMMER/AUTUMN	1:500	A
AR.DA.	4012	PROPOSED SHADOW DIAGRAMS 2_SPRING/SUMMER/AUTUMN	1:500	A
AR.DA.	4013	EXISTING SHADOW DIAGRAMS 2_WINTER	1:500	A
AR.DA.	4014	PROPOSED SHADOW DIAGRAMS 2_WINTER	1:500	A
AR.DA.	5001	EXTERNAL MATERIALS AND FINISHES	As indicated	A
AR.DA.	9001	SITE 3D VIEW 1	As Indicated	A
AR.DA.	9002	SITE 3D VIEW 2	As Indicated	A
AR.DA.	9003	SITE 3D VIEW 3	As indicated	A



1 SITE LOCATION PLAN
3001 1:2000

CLIENT
ST JOSEPH'S COLLEGE,
HUNTERS HILL



PROJECT MANAGER
Bloompark Consulting
T+ 61 2 9957 1473

QUANTITY SURVEYOR
Altus Group
T+ 61 2 9283 7311

URBAN PLANNER
Robinson Urban Planning Pty Ltd
T+ 61 2 9130 1483

STRUCTURAL & CIVIL ENGINEER
Northrop Consulting Engineering
Services (Sydney)
T+ 61 2 9241 4188

ELECTRICAL & LIFT ENGINEER
Northrop Consulting Engineering
Services (Sydney)
T+ 61 2 9241 4188

MECHANICAL & ESD ENGINEER
Umow Lal (Sydney)
T+ 61 2 9431 9431

HYDRAULICS & FIRE PROTECTION
Aj Whipps Consulting Group
T+ 61 2 8923 8444

ACOUSTIC ENGINEER
Wilkinson Murray
T+ 61 2 8116 6119

TRAFFIC CONSULTANT
TRAFFIX
T+ 61 2 8324 8700

Abbreviations
(E) EXISTING
(N) PROPOSED
(TME) TO MATCH EXISTING

AW ALUMINIUM WINDOWS
BKF FACE BRICKWORK
EWC 2 EXTERNAL WALL CLADDING 2
EWC 3 EXTERNAL WALL CLADDING 3
EWC 4 EXTERNAL WALL CLADDING 4
EWC 5 EXTERNAL WALL CLADDING 5
GL GLASS LOUVRES
VB VERTICAL BLADES

Rev	Date	Description	Checked	Auth.
A	31.07.18	Issue for SSD	IB	RD

Rev	Date	Description	Checked	Auth.

Proj. Dir	Proj. Arch	Drawn
RD	IB	RT

Job No.	Sheet	Scale
161002	B1	As indicated

NSW Nonnotified Architects:
Robert Dornon Reg. No. 5782
Alex Kibble Reg. No. 6015

Do not scale drawings. Verify all dimensions on site. Notify architect of all discrepancies.

0M 40 80 120 160 200

NOT FOR CONSTRUCTION

Project
PHYSICAL EDUCATION AND SPORTS PRECINCT PROJECT

Drawing Title
COVER SHEET AND SITE LOCATION PLAN

Drawing No.
AR.DA. 0000

Tanner Kibble Denton Architects Pty Ltd
PO Box 660 Darlinghurst NSW 1300 Australia
Level 1, 19 Foster Street, Surry Hills NSW 2010 Australia
T +61 2 9281 4399
F +61 2 9281 4337
www.tkda.com.au



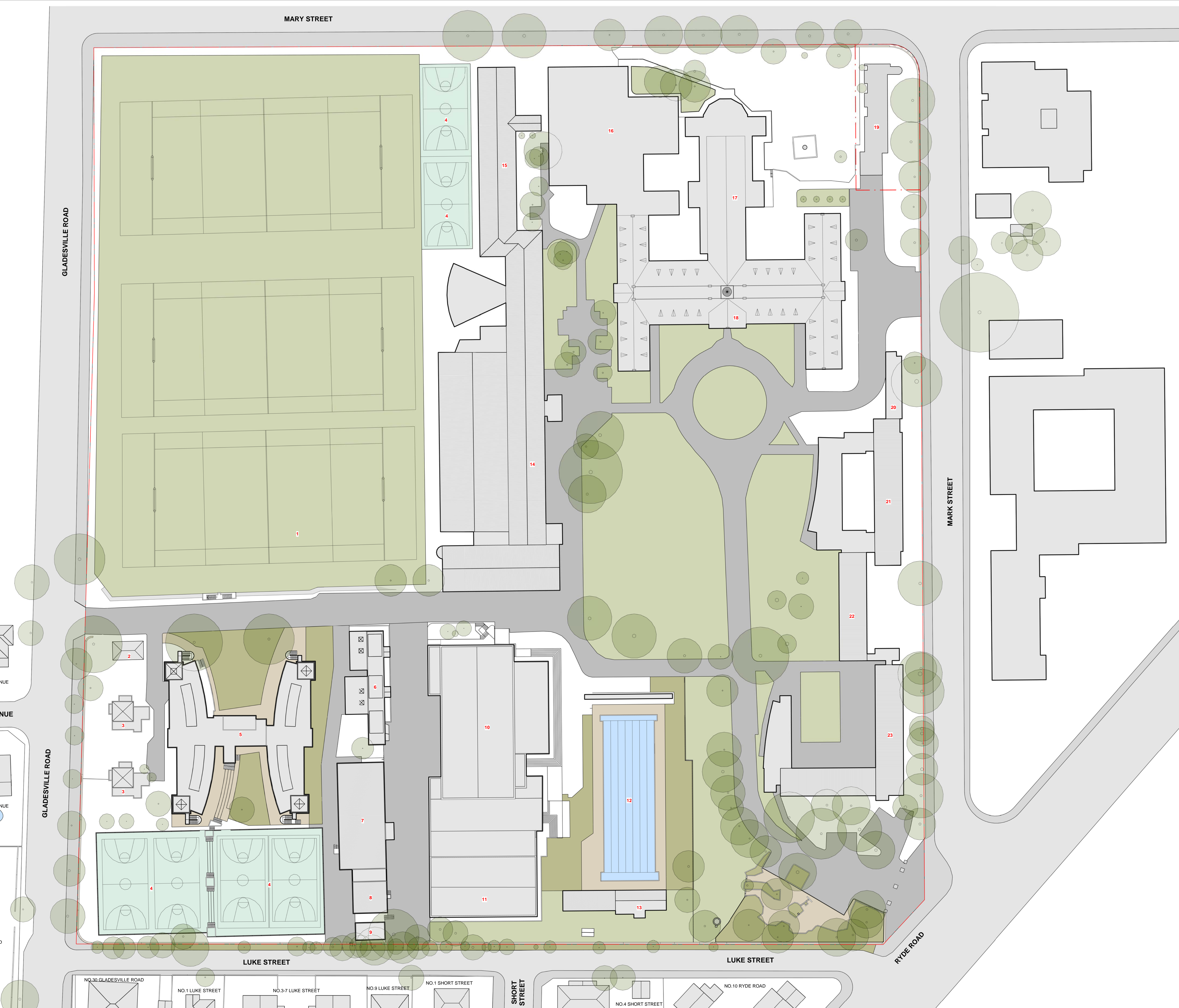

NOTES

1. GRASS SPORTS FIELDS
2. OLD SANDSTONE SHED
3. TEACHERS RESIDENCES
4. OUTDOOR SPORTS COURTS
5. YR 10 DORMITORY
6. VISUAL ARTS CENTRE
7. HEALY GYM / MAINTENANCE & WORKSHOP STORAGE
8. SHED
9. SHED
10. BR. EMBLJAN HALL
11. SPORTS HALL
12. SWIMMING POOL
13. POOL FACILITIES / PLANT
14. CLASS ROOMS
15. 4 STOREY BRICK BUILDING
16. 2 STOREY LIBRARY / ADMIN BUILDING
17. STONE CHAPEL
18. MAIN BUILDING
19. BROTHERS RESIDENCE
20. OLD TOILET BLOCK
21. YR 11 RESIDENCE WING
22. YR 12 RESIDENCE WING
23. YR 12 RESIDENCE WING - EAST

SITE BOUNDARY

CLIENT
**ST JOSEPH'S COLLEGE,
HUNTERS HILL**

T+ 61 2 9816 0900



PROJECT MANAGER
Bloompark Consulting
T+ 61 2 9957 1473

QUANTITY SURVEYOR
Altus Group
T+ 61 2 9283 7311

URBAN PLANNER
Robinson Urban Planning Pty Ltd
T+ 61 2 9130 1483

STRUCTURAL & CIVIL ENGINEER
Northrop Consulting Engineering Services (Sydney)
T+ 61 2 9241 4188

ELECTRICAL & LIFT ENGINEER
Northrop Consulting Engineering Services (Sydney)
T+ 61 2 9241 4188

MECHANICAL & ESD ENGINEER
Umwol Lal (Sydney)
T+ 61 2 9431 9431

HYDRAULICS & FIRE PROTECTION
AJ Whipps Consulting Group
T+ 61 2 8923 8444

ACOUSTIC ENGINEER
Wilkinson Murray
T+ 61 2 8116 6119

TRAFFIC CONSULTANT
TRAFFIX
T+ 61 2 8324 8700

Abbreviations
(E) EXISTING
(P) PROPOSED
(N) TO MATCH EXISTING

AW ALUMINUM WINDOWS
BKF FACE BRICKWORK
EWC 1 EXTERNAL WALL CLADDING 1
EWC 2 EXTERNAL WALL CLADDING 2
EWC 3 EXTERNAL WALL CLADDING 3
EWC 4 EXTERNAL WALL CLADDING 4
EWC 5 EXTERNAL WALL CLADDING 5
GL GLASS LOUVRES
VB VERTICAL BLADES

Rev	Date	Description	Checked	Auth.
A	31.07.18	Issue for SSD	IB	RD

Rev	Date	Description	Checked	Auth.

Proj. Dir. RD
Proj. Arch. IB
Drawn RT

Job No. Sheet Scale

161002 B1 1 : 500

NSW Nonresident Architects:
Robert Duron Reg. No. 5782
Alex Kibble Reg. No. 6015

Do not scale drawings. Verify all dimensions on site. Notify architect of all discrepancies.

Project
**PHYSICAL EDUCATION AND
SPORTS PRECINCT PROJECT**

Drawing Title
EXISTING SITE PLAN

Drawing No. AR.DA. 1001
Revision A

Tanner Kibble Denton Architects Pty Ltd
PO Box 660 Darlinghurst NSW 1300 Australia
Level 1, 19 Foster Street, Surry Hills NSW 2010 Australia
T +61 2 9281 4399
F +61 2 9281 4337
www.tkd.com.au



TKD Architects
Tanner Kibble Denton

NOT FOR CONSTRUCTION

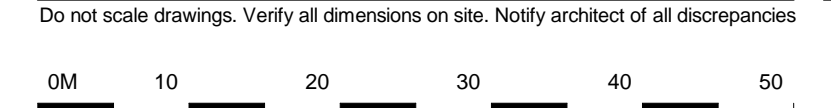

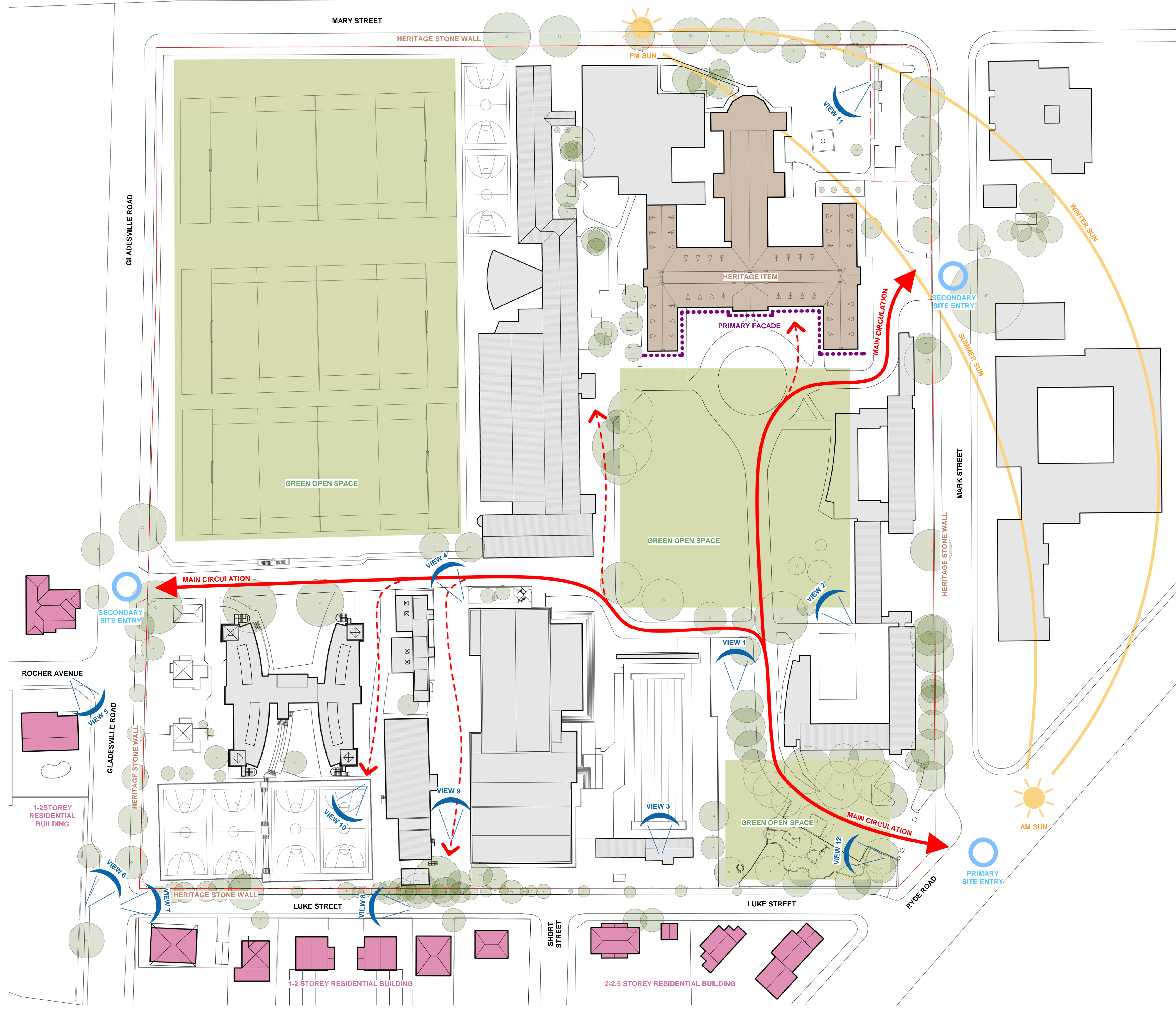

CLIENT
**ST JOSEPH'S COLLEGE,
 HUNTERS HILL**

T+ 61 2 9816 0900



PROJECT MANAGER
Bloompark Consulting
 T+ 61 2 9957 1473

QUANTITY SURVEYOR
Altus Group
 T+ 61 2 9283 7311

URBAN PLANNER
Robinson Urban Planning Pty Ltd
 T+ 61 2 9130 1483

STRUCTURAL & CIVIL ENGINEER
Northrop Consulting Engineering Services (Sydney)
 T+ 61 2 9241 4188

ELECTRICAL & LIFT ENGINEER
Northrop Consulting Engineering Services (Sydney)
 T+ 61 2 9241 4188

MECHANICAL & ESD ENGINEER
Umow Lal (Sydney)
 T+ 61 2 9431 9431

HYDRAULICS & FIRE PROTECTION
AJ Whipps Consulting Group
 T+ 61 2 8923 8444

ACOUSTIC ENGINEER
Wilkinson Murray
 T+ 61 2 8116 6119

TRAFFIC CONSULTANT
TRAFFIX
 T+ 61 2 8324 8700

Abbreviations
 (E) EXISTING
 (P) PROPOSED
 (M) TO MATCH EXISTING

AW ALUMINIUM WINDOWS
 BRKF FACE BRICKWORK
 EWC 1 EXTERNAL WALL CLADDING 1
 EWC 2 EXTERNAL WALL CLADDING 2
 EWC 3 EXTERNAL WALL CLADDING 3
 EWC 4 EXTERNAL WALL CLADDING 4
 EWC 5 EXTERNAL WALL CLADDING 5
 GL GLASS LOUVRES
 VB VERTICAL BLADES

Rev	Date	Description	Checked	Auth.
A	31.07.18	Issue for SSD	IB	RD

Rev	Date	Description	Checked	Auth.

Proj. Dir: RD
 Proj. Arch: IB
 Drawn: RT

Job No. Sheet Scale

161002 B1 As indicated

NSW Notarised Architects:
 Robert Dorton Reg. No. 5782
 Alex Kibble Reg. No. 6015

Do not scale drawings. Verify all dimensions on site. Notify architect of all discrepancies

NOT FOR CONSTRUCTION

Project
**PHYSICAL EDUCATION AND
 SPORTS PRECINCT PROJECT**

Drawing Title
SITE ANALYSIS

Drawing No.
AR.DA. 1002

Revision
A

Tanner Kibble Denton Architects Pty Ltd
 PO Box 660 Darlinghurst NSW 1300 Australia
 Level 1, 19 Foster Street, Surry Hills NSW 2010 Australia
 T +61 2 9281 4399
 F +61 2 9281 4337
 www.tkda.com.au



TKD Architects
 Tanner Kibble Denton



VIEW 1



VIEW 2



VIEW 3



VIEW 4



VIEW 5



VIEW 6



VIEW 7



VIEW 8



VIEW 9



VIEW 10



VIEW 11



VIEW 12

CLIENT
**ST JOSEPH'S COLLEGE,
HUNTERS HILL**



T+ 61 2 9816 0900

PROJECT MANAGER
Bloompark Consulting
Northrop Consulting Engineering
Services (Sydney)
T+ 61 2 9957 1473

QUANTITY SURVEYOR
Altus Group
T+ 61 2 9283 7311

URBAN PLANNER
Robinson Urban Planning Pty Ltd
T+ 61 2 9130 1483

STRUCTURAL & CIVIL ENGINEER
**Northrop Consulting Engineering
Services (Sydney)**
T+ 61 2 9241 4188

ELECTRICAL & LIFT ENGINEER
**Northrop Consulting Engineering
Services (Sydney)**
T+ 61 2 9241 4188

MECHANICAL & ESD ENGINEER
Umwow Lal (Sydney)
T+ 61 2 9431 9431

HYDRAULICS & FIRE PROTECTION
AJ Whipps Consulting Group
T+ 61 2 8923 8444

ACOUSTIC ENGINEER
Wilkinson Murray
T+ 61 2 8116 6119

TRAFFIC CONSULTANT
TRAFFIX
T+ 61 2 8324 8700

Abbreviations
(E) EXISTING
(N) PROPOSED
(TME) TO MATCH EXISTING

AW ALUMINUM WINDOWS
BKF FACE BRICKWORK
EWC 1 EXTERNAL WALL CLADDING 1
EWC 2 EXTERNAL WALL CLADDING 2
EWC 3 EXTERNAL WALL CLADDING 3
EWC 4 EXTERNAL WALL CLADDING 4
EWC 5 EXTERNAL WALL CLADDING 5
GL GLASS LOUVRES
VB VERTICAL BLADES

Rev	Date	Description	Checked	Auth.
A	31.07.18	Issue for SSD	IB	RD

Rev	Date	Description	Checked	Auth.

Proj. Dir	Proj. Arch	Drawn
RD	IB	RT
Job No.	Sheet	Scale
161002	B1	As indicated

NSW Nonnotified Architect:
Robert Dornon Reg. No. 5782
Alex Kibble Reg. No. 6015

Do not scale drawings. Verify all dimensions on site. Notify architect of all discrepancies

Project
**PHYSICAL EDUCATION AND
SPORTS PRECINCT PROJECT**

EXISTING SITE VIEWS

Drawing No.
AR.DA. 1003

Tanner Kibble Denton Architects Pty Ltd
PO Box 660 Darlinghurst NSW 1300 Australia
Level 1, 19 Foster Street, Surry Hills NSW 2010 Australia
T +61 2 9281 4399
F +61 2 9281 4337
www.tkda.com.au



NOT FOR CONSTRUCTION