

LOCALITY: MACQUARIE PARK
LGA: RYDE



Department of Planning
and Environment

STAGE 0

Issued under the Environmental Planning and Assessment Act 1979

Approved Section 4.55 (1A) Modification Application

No: SSD-8903-MOD-5 Granted on 19 December 2022

Signed: R.R. Sheet No: 1 of 15

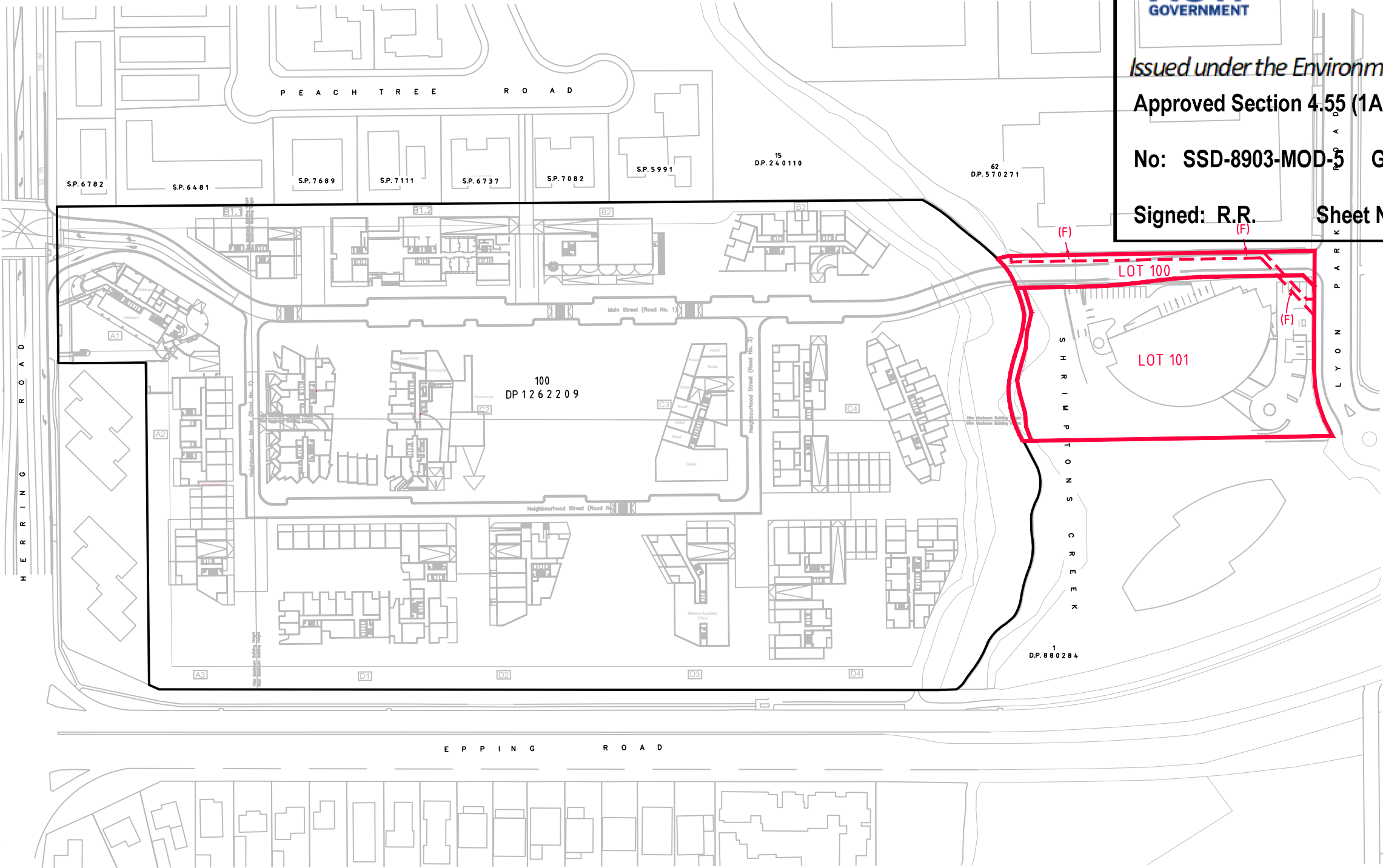

EXISTING EASEMENTS:

(F) EASEMENT FOR DRAINAGE (R507051)

NOTES:

SERVICE EASEMENTS TO BE CREATED TO RELEVANT
UTILITY AUTHORITIES REQUIREMENTS.

AREAS AND DIMENSIONS ARE SUBJECT TO FINAL SURVEY
AND REGISTRATION OF PLAN AT LAND REGISTRY
SERVICES.

BASED ON DRAFT PLAN OF SUBDIVISION DATED: 22.7.19

SHEET 1 OF 15



Beveridge Williams
Development & Environment Consultants
Registered Surveyors

Sydney: (02) 9283 6677

www.beveridgewilliams.com.au

SURVEYORS REF. 1601644
VERSION 13
SURVEYOR: PM
DRAWN: RK
ORIGINAL SHEET SIZE A3
CHECKED: PM
DATE: 12.11.2021

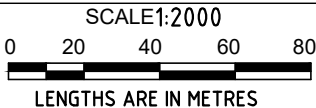

FRASERS PROPERTY AUSTRALIA

PLAN OF PROPOSED SUBDIVISION OF
LOT 1 DP859537, LOTS 6-8, 10-20 DP861433,
LOT 5 DP740753, LOT 100 DP1223787 AND
LOT 101 DP1247443

CAD REFERENCE: 1601644-STAGING-211112.dwg

LOCALITY: MACQUARIE PARK
LGA: RYDE



Department of Planning
and Environment

STAGE 0A

Issued under the Environmental Planning and Assessment Act 1979

Approved Section 4.55 (1A) Modification Application

No: SSD-8903-MOD-5 Granted on 19 December 2022

Signed: R.R. Sheet No: 2 of 15

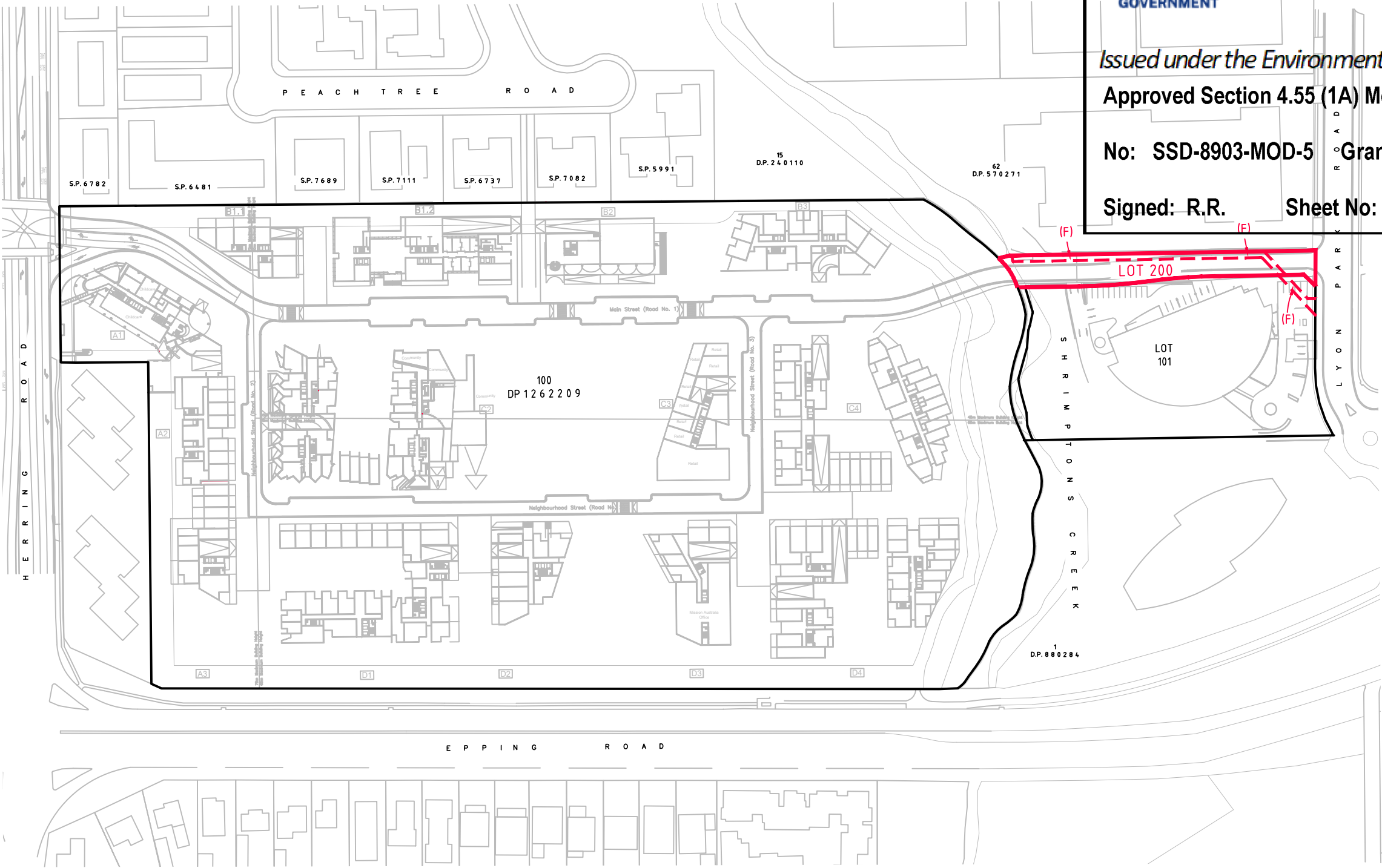

LOT 200 IS A PLAN OF REDEFINITION
CLAIMING AD MEDIUM FILUM AQUAE.

EXISTING EASEMENTS:

(F) EASEMENT FOR DRAINAGE (R507051)

NOTES:

SERVICE EASEMENTS TO BE CREATED TO RELEVANT
UTILITY AUTHORITIES REQUIREMENTS.

AREAS AND DIMENSIONS ARE SUBJECT TO FINAL SURVEY
AND REGISTRATION OF PLAN AT LAND REGISTRY
SERVICES.

BASED ON DRAFT PLAN OF SUBDIVISION DATED: 22.7.19



Beveridge Williams
Development & Environment Consultants
Registered Surveyors

Sydney: (02) 9283 6677

www.beveridgewilliams.com.au

SURVEYORS REF. 1601644
VERSION 13
SURVEYOR: PM
DRAWN: RK
ORIGINAL SHEET SIZE A3
CHECKED: PM
DATE: 12.11.2021

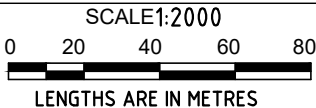

FRASERS PROPERTY AUSTRALIA

PLAN OF PROPOSED SUBDIVISION OF
LOT 1 DP859537, LOTS 6-8, 10-20 DP861433,
LOT 5 DP740753, LOT 100 DP1223787 AND
LOT 101 DP1247443

LOCALITY: MACQUARIE PARK
LGA: RYDE



Department of Planning
and Environment

STAGE 0B

Issued under the *Environmental Planning and Assessment Act 1979*

Approved Section 4.55 (1A) Modification Application

No: SSD-8903-MOD-5 Granted on 19 December 2022

Signed: R.R. Sheet No: 3 of 15

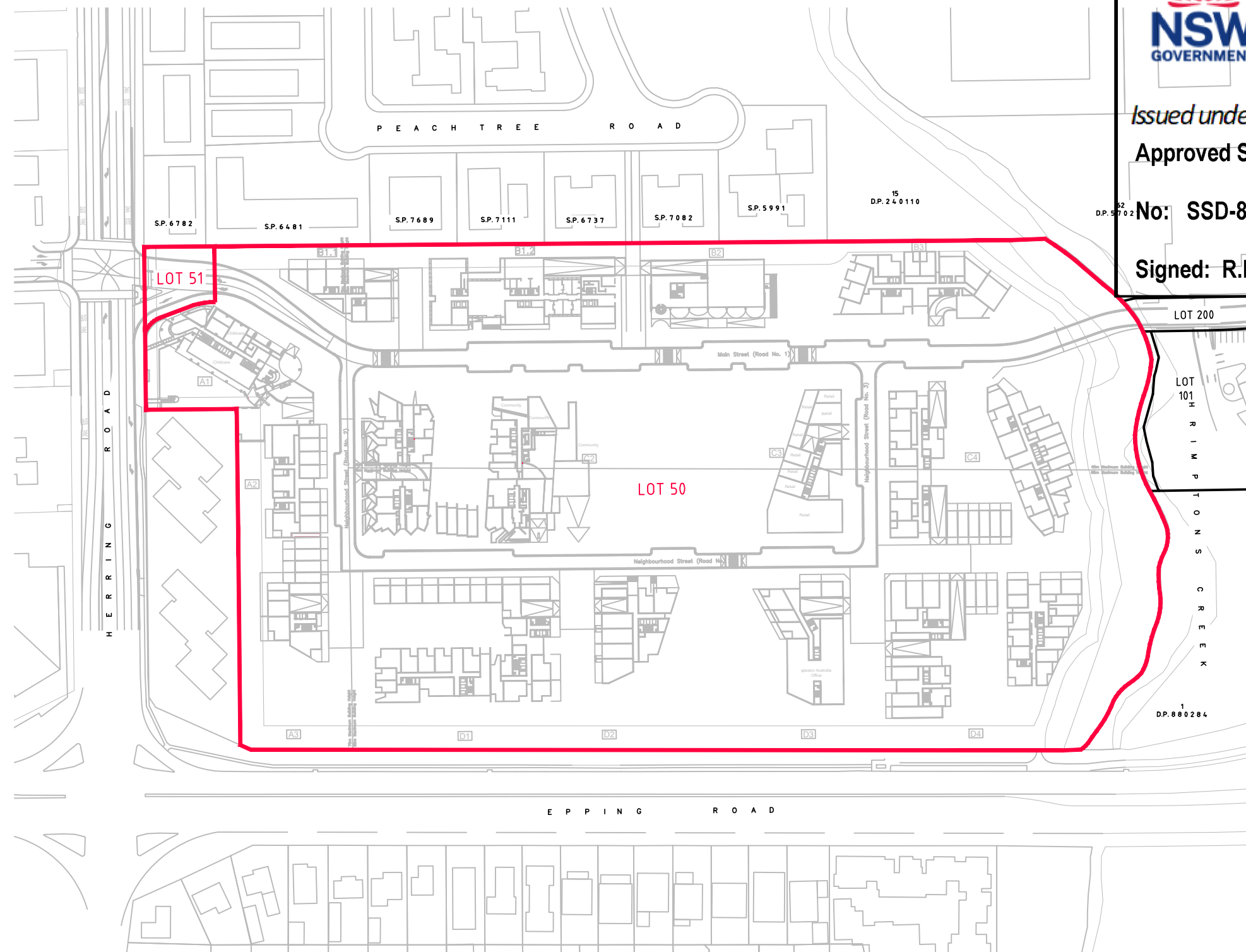

LOT 51 IS TO BE ACQUIRED BY TFNSW

NOTES:

SERVICE EASEMENTS TO BE CREATED TO RELEVANT
UTILITY AUTHORITIES REQUIREMENTS.

AREAS AND DIMENSIONS ARE SUBJECT TO FINAL SURVEY
AND REGISTRATION OF PLAN AT LAND REGISTRY
SERVICES.

BASED ON DRAFT PLAN OF SUBDIVISION DATED: 22.7.19

SHEET 3 OF 15



Beveridge Williams
Development & Environment Consultants
Registered Surveyors

Sydney: (02) 9283 6677

www.beveridgewilliams.com.au

SURVEYORS REF. 1601644
VERSION 13
SURVEYOR: PM
DRAWN: RK
ORIGINAL SHEET SIZE A3
CHECKED: PM
DATE: 12.11.2021

SCALE 1:2000
0 20 40 60 80
LENGTHS ARE IN METRES

FRASERS PROPERTY AUSTRALIA

PLAN OF PROPOSED SUBDIVISION OF
LOT 1 DP859537, LOTS 6-8, 10-20 DP861433,
LOT 5 DP740753, LOT 100 DP1223787 AND
LOT 101 DP1247443

CAD REFERENCE: 1601644-STAGING-211112.dwg

LOCALITY: MACQUARIE PARK
LGA: RYDE



STAGE 1
Department of Planning
and Environment

Issued under the Environmental Planning and Assessment Act 1979

Approved Section 4.55 (1A) Modification Application

No: SSD-8903-MOD-5 Granted on 19 December 2022

Signed: R.R. Sheet No: 4 of 15

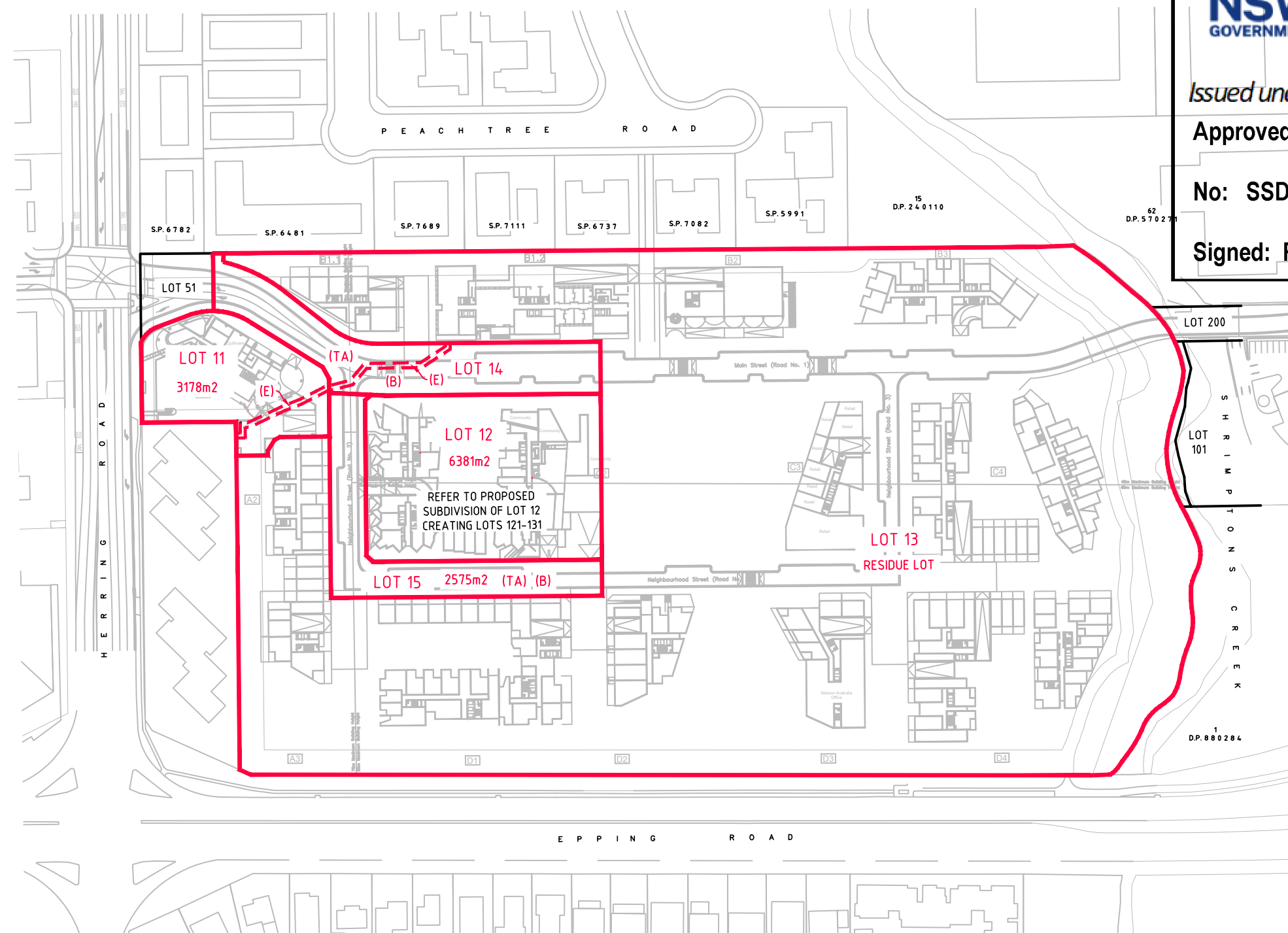

PROPOSED EASEMENTS:

- (A) EASEMENT FOR PUBLIC ACCESS
- (B) TEMPORARY EASEMENT FOR SERVICES
- (TA) TEMPORARY RIGHT OF CARRIAGEWAY

EXISTING EASEMENTS:

- (E) EASEMENT TO DRAIN WATER 2 WIDE & VARIABLE (D.P.1244080)

LOT 13 HAS EXISTING EASEMENTS NOT SHOWN ON THIS PLAN

NOTES:

IT IS INTENDED TO DEDICATE LOT 14 AS PUBLIC ROAD WITHIN 24 MONTHS OF THE COMPLETION OF STAGE 2.
IT IS INTENDED TO DEDICATE LOT 15 AS PUBLIC ROAD AT THE COMPLETION OF THE PROJECT.

AREAS AND DIMENSIONS ARE SUBJECT TO FINAL SURVEY AND REGISTRATION OF PLAN AT LAND REGISTRY SERVICES.

BASED ON ARCHITECTURAL PLAN AS SUPPLIED:
BATES SMART ARCHITECTS
DRAWING No.DA02.MP.000
ISSUE 12 DATED 26.08.19

SHEET 4 OF 15



Beveridge Williams
Development & Environment Consultants
Registered Surveyors

Sydney: (02) 9283 6677

www.beveridgewilliams.com.au

SURVEYORS REF. 1601644
VERSION 13
SURVEYOR: PM
DRAWN: RK
ORIGINAL SHEET SIZE A3
CHECKED: PM
DATE: 12.11.2021

SCALE 1:2000
0 20 40 60 80
LENGTHS ARE IN METRES

FRASERS PROPERTY AUSTRALIA

PLAN OF PROPOSED SUBDIVISION OF
LOT 1 DP859537, LOTS 6-8, 10-20 DP861433,
LOT 5 DP740753, LOT 100 DP1223787 AND
LOT 101 DP1247443

CAD REFERENCE: 1601644-STAGING-211112.dwg

LOCALITY: MACQUARIE PARK
LGA: RYDE



Department of Planning
and Environment

STAGE 1A

Issued under the Environmental Planning and Assessment Act 1979

Approved Section 4.55 (1A) Modification Application

No: SSD-8903-MOD-5 Granted on 19 December 2022

Signed: R.R.

Sheet No: 5 of 15

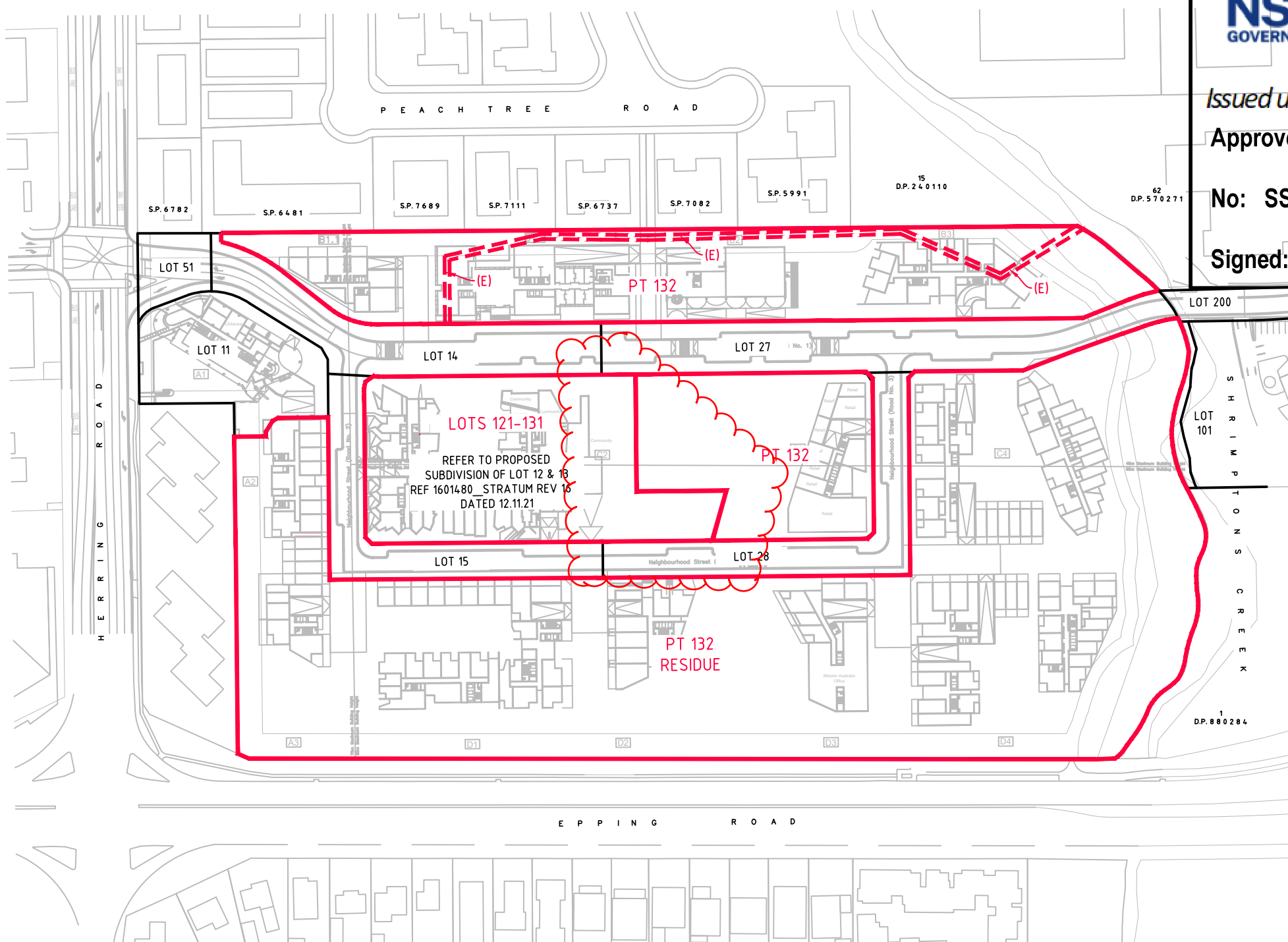

EXISTING EASEMENTS:

(E) EASEMENT TO DRAIN WATER 2 WIDE & VARIABLE
(D.P.1244080)

LOTS 10, 12 DP861433, LOT 100 DP1223787 AND LOT 101
DP1247443 HAVE EXISTING EASEMENTS NOT SHOWN
ON THIS PLAN

NOTES:

EXTENT OF RESIDUE, LOT NUMBERING AND STAGING
SUBJECT TO CHANGE DEPENDING ON SEQUENCING.

SERVICE EASEMENTS TO BE CREATED TO RELEVANT
UTILITY AUTHORITIES REQUIREMENTS.

IT IS INTENDED TO DEDICATE LOT 27 AS PUBLIC ROAD
WITHIN 24 MONTHS OF THE COMPLETION OF STAGE 2.
IT IS INTENDED TO DEDICATE LOT 28 AS PUBLIC ROAD AT
THE COMPLETION OF THE PROJECT.

AREAS AND DIMENSIONS ARE SUBJECT TO FINAL SURVEY
AND REGISTRATION OF PLAN AT LAND REGISTRY
SERVICES.

BASED ON ARCHITECTURAL PLAN AS SUPPLIED:
BATES SMART ARCHITECTS
DRAWING No.DA02.MP.000
ISSUE 12 DATED 26.8.19

SHEET 5 OF 15



Beveridge Williams
Development & Environment Consultants
Registered Surveyors

Sydney: (02) 9283 6677

www.beveridgewilliams.com.au

SURVEYORS REF. ORIGINAL
1601644 SHEET SIZE
VERSION 13 A3
SURVEYOR: PM CHECKED: PM
DRAWN: RK DATE: 12.11.2021

SCALE 1:2000
0 20 40 60 80
LENGTHS ARE IN METRES

FRASERS PROPERTY AUSTRALIA

PLAN OF PROPOSED SUBDIVISION OF
LOT 1 DP859537, LOTS 6-8, 10-20 DP861433,
LOT 5 DP740753, LOT 100 DP1223787 AND
LOT 101 DP1247443

CAD REFERENCE: 1601644-STAGING-211112.dwg

LOCALITY: MACQUARIE PARK
LGA: RYDE



Department of Planning and Environment

Issued under the Environmental Planning and Assessment Act 1979

Approved Section 4.55 (1A) Modification Application

No: SSD-8903-MOD-5 Granted on 19 December 2022

Signed: R.R.

PROPOSED EASEMENTS:
Sheet No: 6 of 15

(B) TEMPORARY EASEMENT FOR SERVICES
(TA) TEMPORARY RIGHT OF CARRIAGEWAY

EXISTING EASEMENTS:

(E) EASEMENT TO DRAIN WATER 2 WIDE & VARIABLE
(D.P.1244080)

LOTS 10, 12 DP861433, LOT 100 DP1223787 AND LOT 101
DP1247443 HAVE EXISTING EASEMENTS NOT SHOWN
ON THIS PLAN

NOTES:

EXTENT OF RESIDUE, LOT NUMBERING AND STAGING
SUBJECT TO CHANGE DEPENDING ON STAGE SEQUENCING.

SERVICE EASEMENTS TO BE CREATED TO RELEVANT UTILITY AUTHORITIES REQUIREMENTS.

IT IS INTENDED TO DEDICATE LOT 27 AS PUBLIC ROAD
WITHIN 24 MONTHS OF THE COMPLETION OF STAGE 2.
IT IS INTENDED TO DEDICATE LOT 28 AS PUBLIC ROAD AT
THE COMPLETION OF THE PROJECT.

AREAS AND DIMENSIONS ARE SUBJECT TO FINAL SURVEY
AND REGISTRATION OF PLAN AT LAND REGISTRY
SERVICES.

BASED ON ARCHITECTURAL PLAN AS SUPPLIED:
BATES SMART ARCHITECTS
DRAWING No.DA02.MP.000
ISSUE 12 DATED 26.8.19



Beveridge Williams
Development & Environment Consultants
Registered Surveyors

Sydney: (02) 9283 6677

www.beveridgewilliams.com.au

SURVEYORS REF. **1601644**
VERSION 13
SURVEYOR: PM
DRAWN: RK

SCALE 1:2000

0 20 40 60 80

LENGTHS ARE IN METRES

FRASERS PROPERTY AUSTRALIA

PLAN OF PROPOSED SUBDIVISION OF
LOT 1 DP859537, LOTS 6-8, 10-20 DP861433,
LOT 5 DP740753, LOT 100 DP1223787 AND
LOT 101 DP1247443

SHEET 6 OF 15

CAD REFERENCE: 1601644-STAGING-211112.dwg

LOCALITY: MACQUARIE PARK
LGA: RYDE



Department of Planning
and Environment

STAGE 2B

Issued under the Environmental Planning and Assessment Act 1979

Approved Section 4.55 (1A) Modification Application

No: SSD-8903-MOD-5 Granted on 19 December 2022

Signed: R.R.

Sheet No: 7 of 15

EXISTING EASEMENTS:

(E) EASEMENT TO DRAIN WATER 2 WIDE & VARIABLE
(D.P.1244080)

LOTS 10, 12 DP861433, LOT 100 DP1223787 AND LOT 101
DP1247443 HAVE EXISTING EASEMENTS NOT SHOWN
ON THIS PLAN

NOTES:

EXTENT OF RESIDUE, LOT NUMBERING AND STAGING
SUBJECT TO CHANGE DEPENDING ON STAGE SEQUENCING.

LOT 21 IS INTENDED TO BE DEDICATED AS PUBLIC RESERVE
AT A LATER DATE.

SERVICE EASEMENTS TO BE CREATED TO RELEVANT
UTILITY AUTHORITIES REQUIREMENTS.

IT IS INTENDED TO DEDICATE LOT 27 AS PUBLIC ROAD
WITHIN 24 MONTHS OF THE COMPLETION OF STAGE 2.
IT IS INTENDED TO DEDICATE LOT 28 AS PUBLIC ROAD AT
THE COMPLETION OF THE PROJECT.

AREAS AND DIMENSIONS ARE SUBJECT TO FINAL SURVEY
AND REGISTRATION OF PLAN AT LAND REGISTRY
SERVICES.

BASED ON ARCHITECTURAL PLAN AS SUPPLIED:
BATES SMART ARCHITECTS
DRAWING No.DA02.MP.000
ISSUE 12 DATED 26.8.19

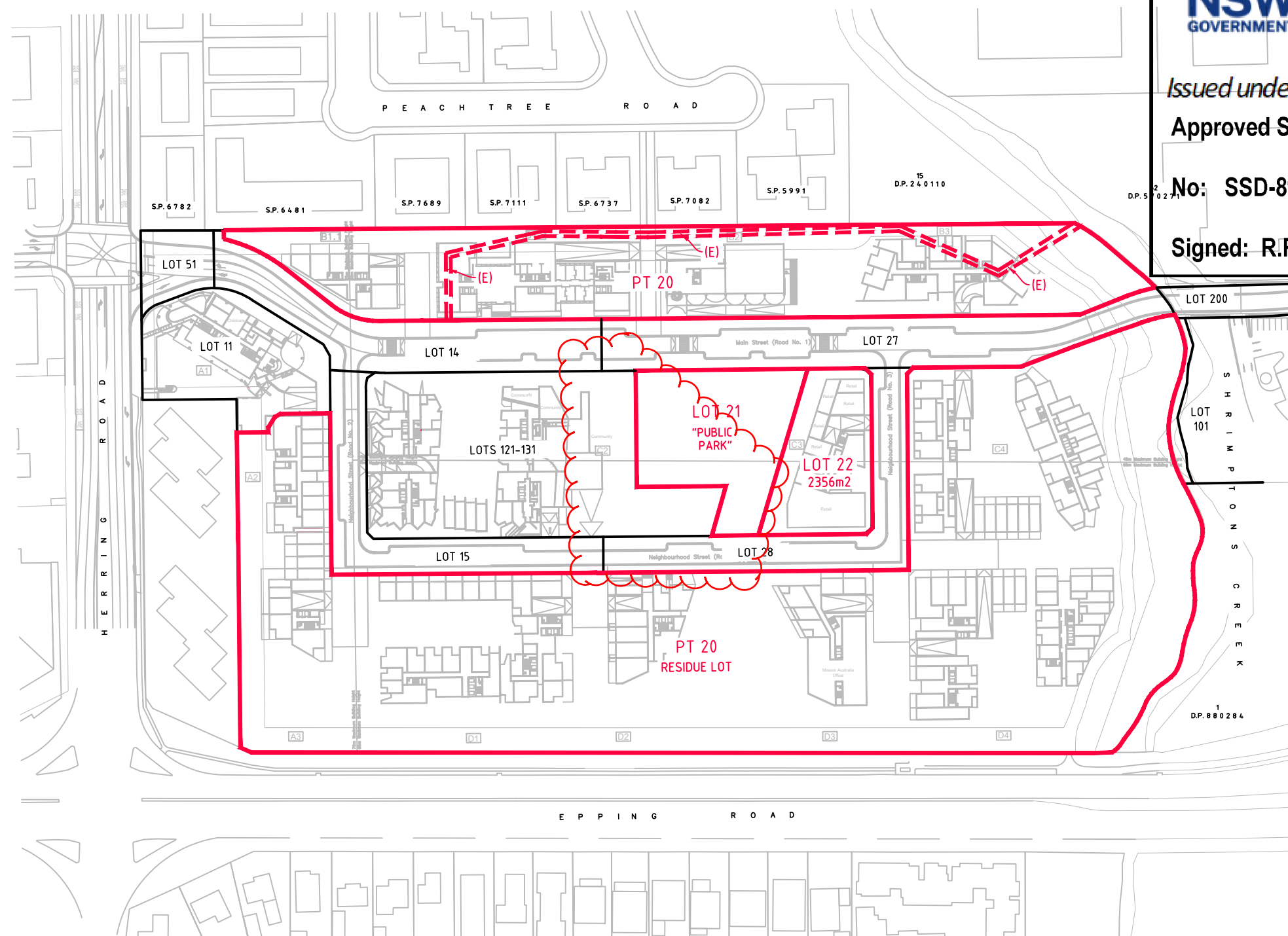

SHEET 7 OF 15



Beveridge Williams
Development & Environment Consultants
Registered Surveyors

Sydney: (02) 9283 6677

www.beveridgewilliams.com.au

SURVEYORS REF. 1601644
VERSION 13
SURVEYOR: PM
DRAWN: RK
ORIGINAL SHEET SIZE A3
CHECKED: PM
DATE: 12.11.2021

SCALE 1:2000
0 20 40 60 80
LENGTHS ARE IN METRES

FRASERS PROPERTY AUSTRALIA

PLAN OF PROPOSED SUBDIVISION OF
LOT 1 DP859537, LOTS 6-8, 10-20 DP861433,
LOT 5 DP740753, LOT 100 DP1223787 AND
LOT 101 DP1247443

CAD REFERENCE: 1601644-STAGING-211112.dwg

LOCALITY: MACQUARIE PARK
LGA: RYDE



Department of Planning
and Environment

STAGE 2C

Issued under the Environmental Planning and Assessment Act 1979
Approved Section 4.55 (1A) Modification Application

No: SSD-8903-MOD-5 Granted on 19 December 2022

Signed: R.R.

Sheet No: 8 of 15

EXISTING EASEMENTS:

(E) EASEMENT TO DRAIN WATER 2 WIDE & VARIABLE
(D.P.1244080)

LOTS 10, 12 DP861433, LOT 100 DP1223787 AND LOT 101
DP1247443 HAVE EXISTING EASEMENTS NOT SHOWN
ON THIS PLAN

NOTES:

EXTENT OF RESIDUE, LOT NUMBERING AND STAGING
SUBJECT TO CHANGE DEPENDING ON STAGE SEQUENCING.

SERVICE EASEMENTS TO BE CREATED TO RELEVANT
UTILITY AUTHORITIES REQUIREMENTS.

IT IS INTENDED TO DEDICATE LOT 27 AS PUBLIC ROAD
WITHIN 24 MONTHS OF THE COMPLETION OF STAGE 2.
IT IS INTENDED TO DEDICATE LOT 28 AS PUBLIC ROAD AT
THE COMPLETION OF THE PROJECT.

AREAS AND DIMENSIONS ARE SUBJECT TO FINAL SURVEY
AND REGISTRATION OF PLAN AT LAND REGISTRY
SERVICES.

BASED ON ARCHITECTURAL PLAN AS SUPPLIED:
BATES SMART ARCHITECTS
DRAWING No.DA02.MP.000
ISSUE 12 DATED 26.8.19

SHEET 8 OF 15



Beveridge Williams
Development & Environment Consultants
Registered Surveyors

Sydney: (02) 9283 6677

www.beveridgewilliams.com.au

SURVEYORS REF. 1601644
VERSION 13
SURVEYOR: PM
DRAWN: RK
ORIGINAL SHEET SIZE A3
CHECKED: PM
DATE: 12.11.2021

SCALE 1:2000
0 20 40 60 80
LENGTHS ARE IN METRES

FRASERS PROPERTY AUSTRALIA

PLAN OF PROPOSED SUBDIVISION OF
LOT 1 DP859537, LOTS 6-8, 10-20 DP861433,
LOT 5 DP740753, LOT 100 DP1223787 AND
LOT 101 DP1247443

CAD REFERENCE: 1601644-STAGING-211112.dwg

LOCALITY: MACQUARIE PARK
LGA: RYDE



STAGE 2D-STAGE 2E
**Department of Planning
and Environment**

Issued under the Environmental Planning and Assessment Act 1979

Approved Section 4.55 (1A) Modification Application

No: SSD-8903-MOD-5 **Granted on 19 December 2022**

Signed: R.R.

Sheet No: 9 of 15

PROPOSED EASEMENTS:

- (B) TEMPORARY EASEMENT FOR SERVICES
- (D) RIGHT OF CARRIAGEWAY
- (TA) TEMPORARY RIGHT OF CARRIAGEWAY

EXISTING EASEMENTS:

- (E) EASEMENT TO DRAIN WATER 2 WIDE & VARIABLE (D.P.1244080)

LOTS 10, 12 DP861433, LOT 100 DP1223787 AND LOT 101 DP1247443 HAVE EXISTING EASEMENTS NOT SHOWN ON THIS PLAN

NOTES:

EXTENT OF RESIDUE, LOT NUMBERING AND STAGING SUBJECT TO CHANGE DEPENDING ON STAGE SEQUENCING.

SERVICE EASEMENTS TO BE CREATED TO RELEVANT UTILITY AUTHORITIES REQUIREMENTS.

IT IS INTENDED TO DEDICATE LOT 27 AS PUBLIC ROAD WITHIN 24 MONTHS OF THE COMPLETION OF STAGE 2.
IT IS INTENDED TO DEDICATE LOT 28 AS PUBLIC ROAD AT THE COMPLETION OF THE PROJECT.

AREAS AND DIMENSIONS ARE SUBJECT TO FINAL SURVEY AND REGISTRATION OF PLAN AT LAND REGISTRY SERVICES.

BASED ON ARCHITECTURAL PLAN AS SUPPLIED:
BATES SMART ARCHITECTS
DRAWING No.DA02.MP.000
ISSUE 12 DATED 26.8.19

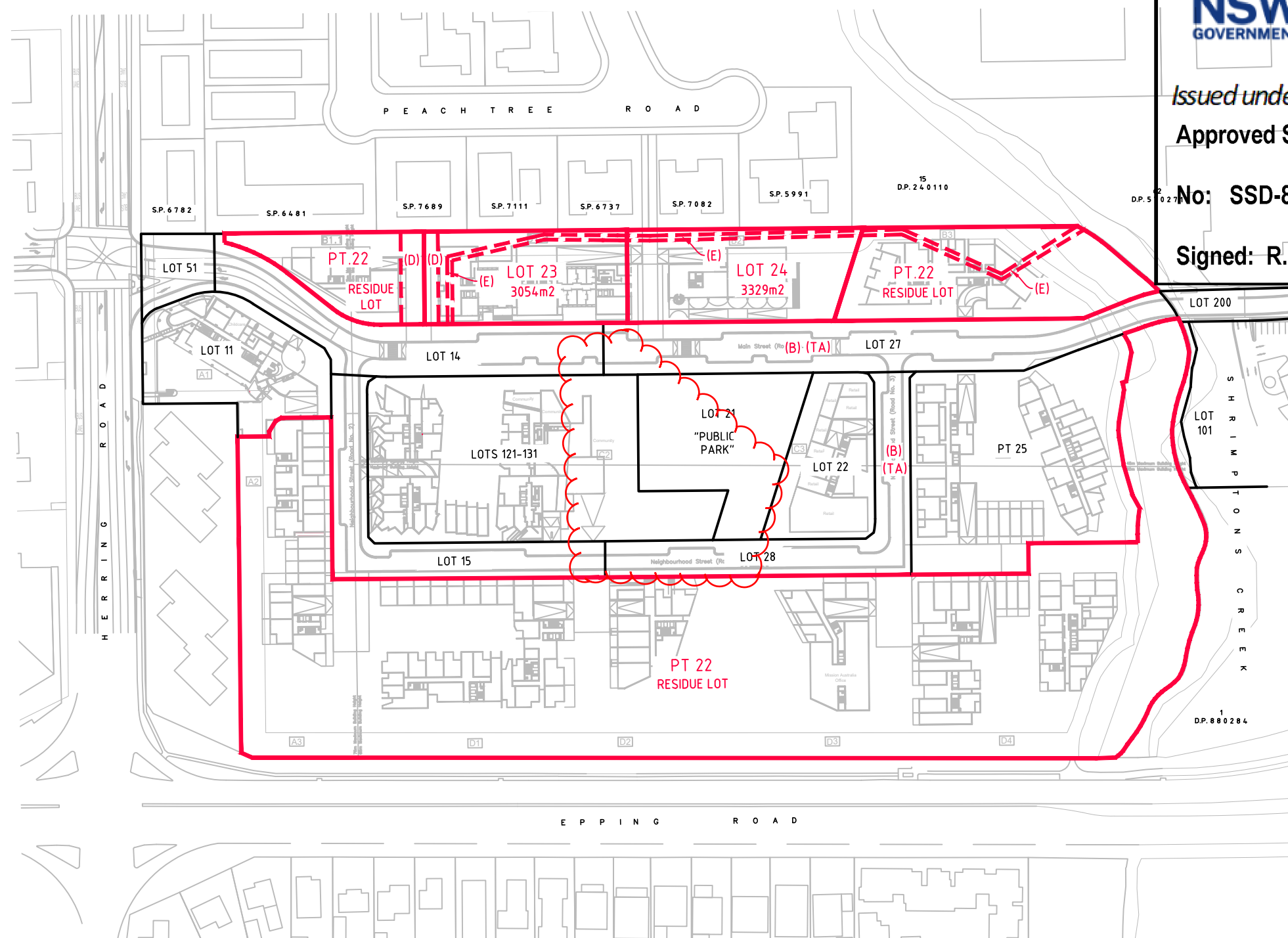

SHEET 9 OF 15



Beveridge Williams
Development & Environment Consultants
Registered Surveyors

Sydney: (02) 9283 6677

www.beveridgewilliams.com.au

SURVEYORS REF. **1601644**
VERSION 13
SURVEYOR: PM
DRAWN: RK
ORIGINAL SHEET SIZE **A3**
CHECKED: PM
DATE: 12.11.2021

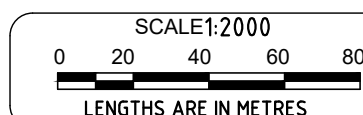

FRASERS PROPERTY AUSTRALIA

**PLAN OF PROPOSED SUBDIVISION OF
LOT 1 DP859537, LOTS 6-8, 10-20 DP861433,
LOT 5 DP740753, LOT 100 DP1223787 AND
LOT 101 DP1247443**

CAD REFERENCE: 1601644-STAGING-211112.dwg

LOCALITY: MACQUARIE PARK
LGA: RYDE



Department of Planning
and Environment

STAGE 3

Issued under the *Environmental Planning and Assessment Act 1979*

Approved Section 4.55 (1A) Modification Application

No: SSD-8903-MOD-5 Granted on 19 December 2022

Signed: R.R.

Sheet No: 10 of 15

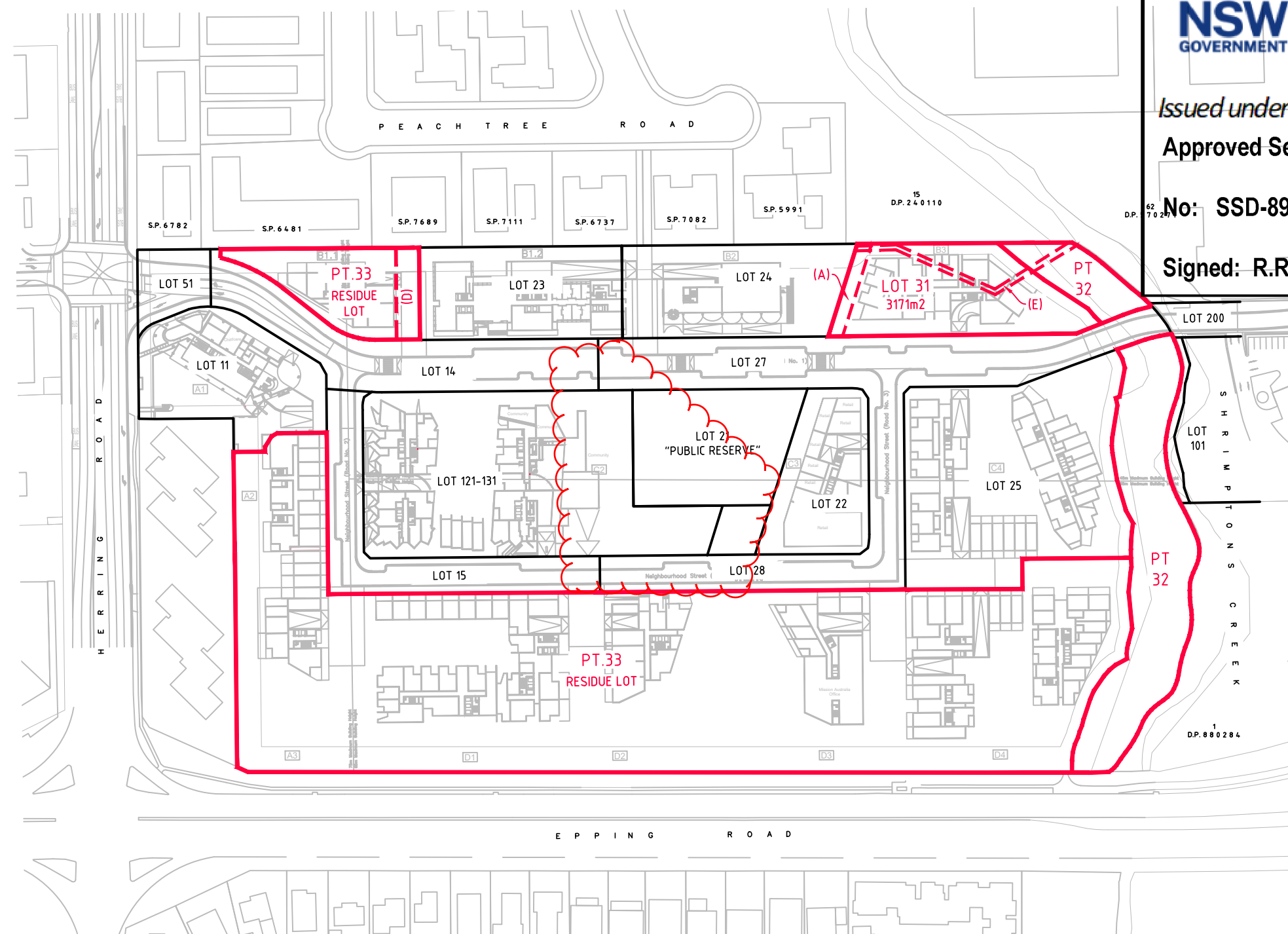

PROPOSED EASEMENTS:

- (A) EASEMENT FOR PUBLIC ACCESS
- (D) RIGHT OF CARRIAGEWAY

EXISTING EASEMENTS:

- (E) EASEMENT TO DRAIN WATER 2 WIDE & VARIABLE (D.P.1244080)

NOTES:

LOT 32 IS INTENDED TO BE DEDICATED AS PUBLIC RESERVE.

EXTENT OF RESIDUE, LOT NUMBERING AND STAGING SUBJECT TO CHANGE DEPENDING ON STAGE SEQUENCING.

AREAS AND DIMENSIONS ARE SUBJECT TO FINAL SURVEY AND REGISTRATION OF PLAN AT LAND REGISTRY SERVICES.

BASED ON ARCHITECTURAL PLAN AS SUPPLIED:
BATES SMART ARCHITECTS
DRAWING No.DA02.MP.000
ISSUE 12 DATED 26.8.19

SHEET 10 OF 15



Beveridge Williams
Development & Environment Consultants
Registered Surveyors

Sydney: (02) 9283 6677

www.beveridgewilliams.com.au

SURVEYORS REF. 1601644
VERSION 13
SURVEYOR: PM
DRAWN: RK
ORIGINAL SHEET SIZE A3
CHECKED: PM
DATE: 12.11.2021

SCALE 1:2000
0 20 40 60 80
LENGTHS ARE IN METRES

FRASERS PROPERTY AUSTRALIA

PLAN OF PROPOSED SUBDIVISION OF
LOT 1 DP859537, LOTS 6-8, 10-20 DP861433,
LOT 5 DP740753, LOT 100 DP1223787 AND
LOT 101 DP1247443

CAD REFERENCE: 1601644-STAGING-211112.dwg

LOCALITY: MACQUARIE PARK
LGA: RYDE



Department of Planning
and Environment

STAGE 4

Issued under the *Environmental Planning and Assessment Act 1979*

Approved Section 4.55 (1A) Modification Application

No: SSD-8903-MOD-5 Granted on 19 December 2022

Signed: R.R.

Sheet No: 11 of 15

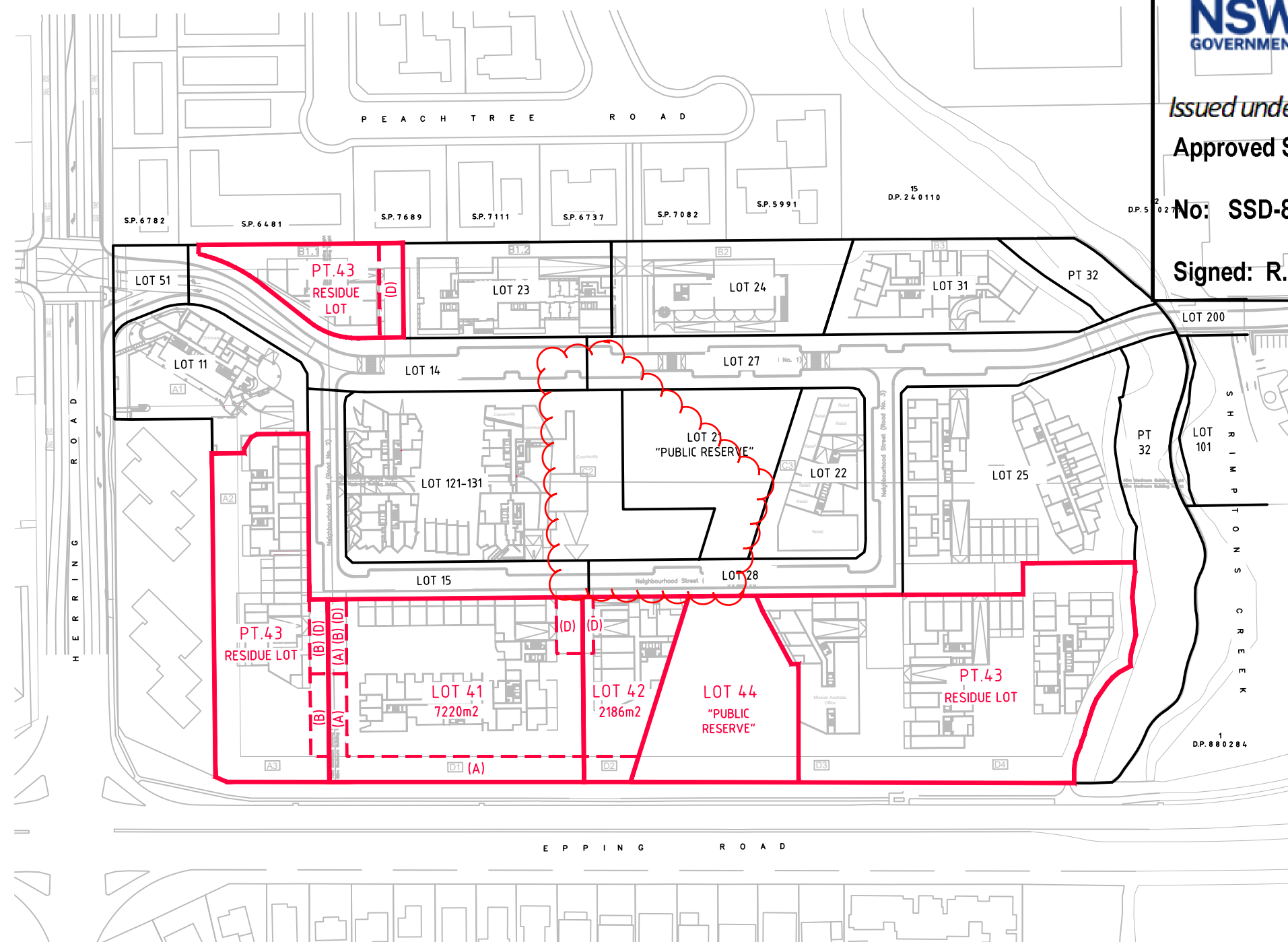

PROPOSED EASEMENTS:

- (A) EASEMENT FOR PUBLIC ACCESS
- (B) EASEMENT FOR SERVICES
- (D) RIGHT OF CARRIAGEWAY

NOTES:

IT IS INTENDED TO DEDICATE LOT 44 AS PUBLIC RESERVE.

EXTENT OF RESIDUE, LOT NUMBERING AND STAGING
SUBJECT TO CHANGE DEPENDING ON STAGE SEQUENCING.

AREAS AND DIMENSIONS ARE SUBJECT TO FINAL SURVEY
AND REGISTRATION OF PLAN AT LAND REGISTRY
SERVICES.

BASED ON ARCHITECTURAL PLAN AS SUPPLIED:
BATES SMART ARCHITECTS
DRAWING No.DA02.MP.000
ISSUE 12 DATED 26.8.19

SHEET 11 OF 15



Beveridge Williams
Development & Environment Consultants
Registered Surveyors

Sydney: (02) 9283 6677

www.beveridgewilliams.com.au

SURVEYORS REF. 1601644
VERSION 13
SURVEYOR: PM
DRAWN: RK
ORIGINAL SHEET SIZE A3
CHECKED: PM
DATE: 12.11.2021

SCALE 1:2000
0 20 40 60 80
LENGTHS ARE IN METRES

FRASERS PROPERTY AUSTRALIA

PLAN OF PROPOSED SUBDIVISION OF
LOT 1 DP859537, LOTS 6-8, 10-20 DP861433,
LOT 5 DP740753, LOT 100 DP1223787 AND
LOT 101 DP1247443

CAD REFERENCE: 1601644-STAGING-211112.dwg

LOCALITY: MACQUARIE PARK
LGA: RYDE

STAGE 5



Department of Planning
and Environment

Issued under the Environmental Planning and Assessment Act 1979

Approved Section 4.55 (1A) Modification Application

No: SSD-8903-MOD-5 Granted on 19 December 2022

Signed: R.R.

Sheet No: 12 of 15

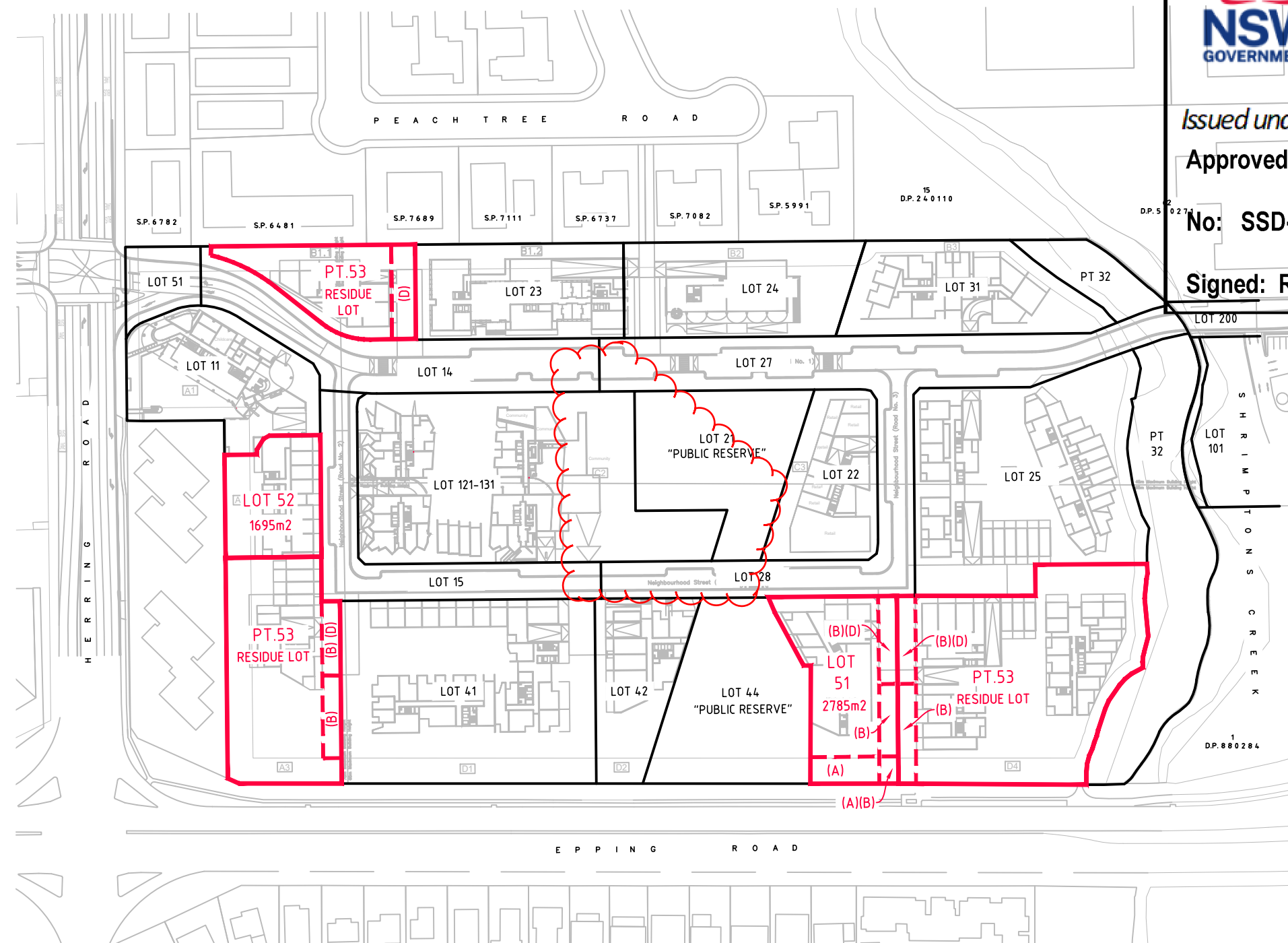

PROPOSED EASEMENTS:

- (A) EASEMENT FOR PUBLIC ACCESS
- (B) EASEMENT FOR SERVICES
- (D) RIGHT OF CARRIAGEWAY

NOTES:

EXTENT OF RESIDUE, LOT NUMBERING AND STAGING
SUBJECT TO CHANGE DEPENDING ON STAGE SEQUENCING.

AREAS AND DIMENSIONS ARE SUBJECT TO FINAL SURVEY
AND REGISTRATION OF PLAN AT LAND REGISTRY
SERVICES.

BASED ON ARCHITECTURAL PLAN AS SUPPLIED:
BATES SMART ARCHITECTS
DRAWING No.DA02.MP.000
ISSUE 12 DATED 26.8.19

SHEET 12 OF 15



Beveridge Williams
Development & Environment Consultants
Registered Surveyors

Sydney: (02) 9283 6677

www.beveridgewilliams.com.au

SURVEYORS REF. 1601644
VERSION 13
SURVEYOR: PM
DRAWN: RK
ORIGINAL SHEET SIZE A3
CHECKED: PM
DATE: 12.11.2021

SCALE 1:2000
0 20 40 60 80
LENGTHS ARE IN METRES

FRASERS PROPERTY AUSTRALIA

PLAN OF PROPOSED SUBDIVISION OF
LOT 1 DP859537, LOTS 6-8, 10-20 DP861433,
LOT 5 DP740753, LOT 100 DP1223787 AND
LOT 101 DP1247443

CAD REFERENCE: 1601644-STAGING-211112.dwg

LOCALITY: MACQUARIE PARK
LGA: RYDE

STAGE 6



Department of Planning
and Environment

Issued under the Environmental Planning and Assessment Act 1979

Approved Section 4.55 (1A) Modification Application

No: SSD-8903-MOD-5 Granted on 19 December 2022

Signed: R.R.

Sheet No: 13 of 15

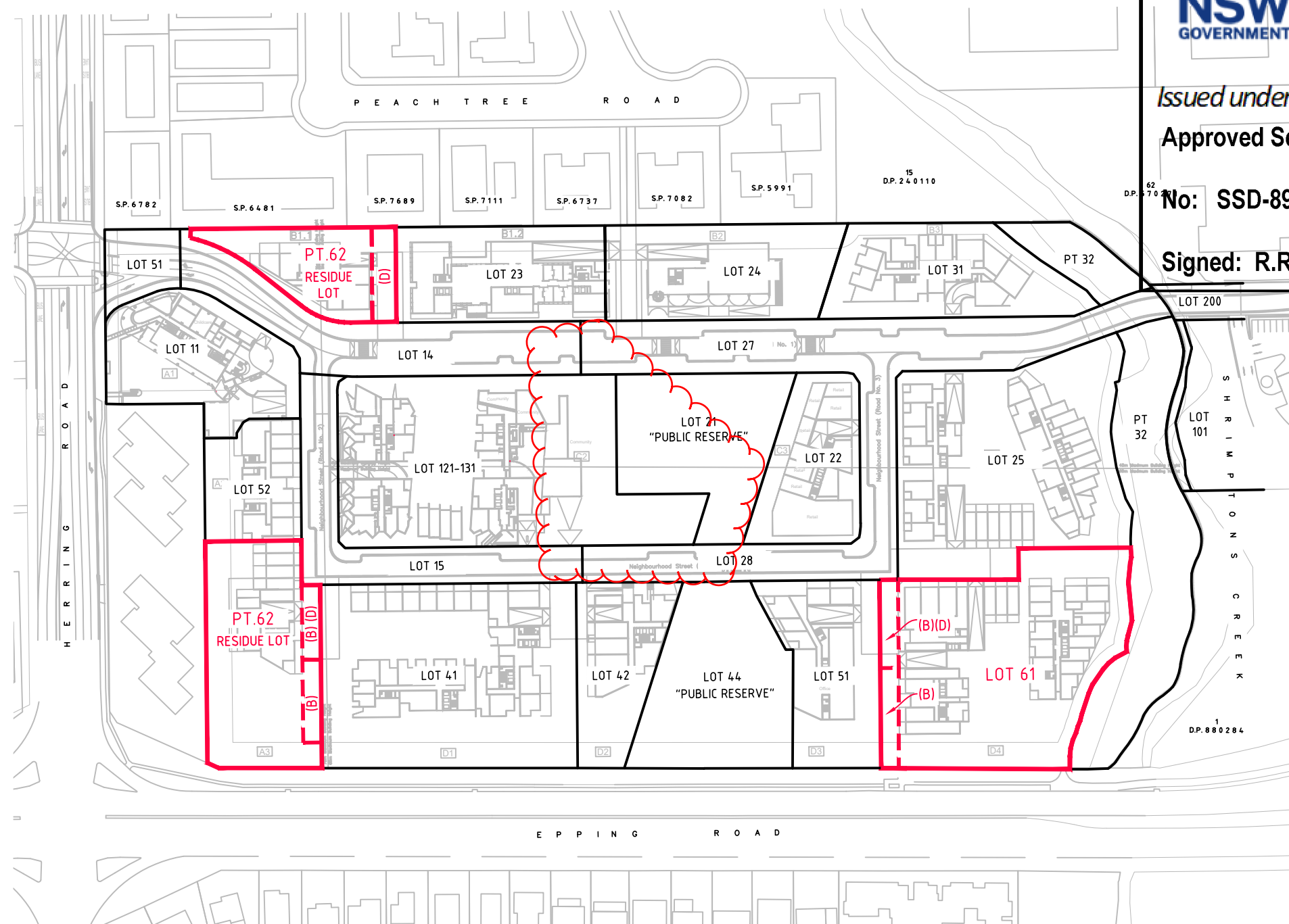

PROPOSED EASEMENTS:

- (A) EASEMENT FOR PUBLIC ACCESS
- (B) EASEMENT FOR SERVICES
- (D) RIGHT OF CARRIAGEWAY

NOTES:

EXTENT OF RESIDUE, LOT NUMBERING AND STAGING
SUBJECT TO CHANGE DEPENDING ON STAGE SEQUENCING.

AREAS AND DIMENSIONS ARE SUBJECT TO FINAL SURVEY
AND REGISTRATION OF PLAN AT LAND REGISTRY
SERVICES.

BASED ON ARCHITECTURAL PLAN AS SUPPLIED:
BATES SMART ARCHITECTS
DRAWING No.DA02.MP.000
ISSUE 12 DATED 26.8.19

SHEET 13 OF 15



Beveridge Williams
Development & Environment Consultants
Registered Surveyors

Sydney: (02) 9283 6677

www.beveridgewilliams.com.au

SURVEYORS REF. ORIGINAL
1601644 SHEET SIZE
VERSION 13 A3
SURVEYOR: PM CHECKED: PM
DRAWN: RK DATE: 12.11.2021

SCALE 1:2000

0 20 40 60 80

LENGTHS ARE IN METRES

FRASERS PROPERTY AUSTRALIA

PLAN OF PROPOSED SUBDIVISION OF
LOT 1 DP859537, LOTS 6-8, 10-20 DP861433,
LOT 5 DP740753, LOT 100 DP1223787 AND
LOT 101 DP1247443

CAD REFERENCE: 1601644-STAGING-211112.dwg

LOCALITY: MACQUARIE PARK
LGA: RYDE

STAGE 7



Department of Planning
and Environment

Issued under the *Environmental Planning and Assessment Act 1979*

Approved Section 4.55 (1A) Modification Application

No: SSD-8903-MOD-5 Granted on 19 December 2022

Signed: R.R. Sheet No: 14 of 15

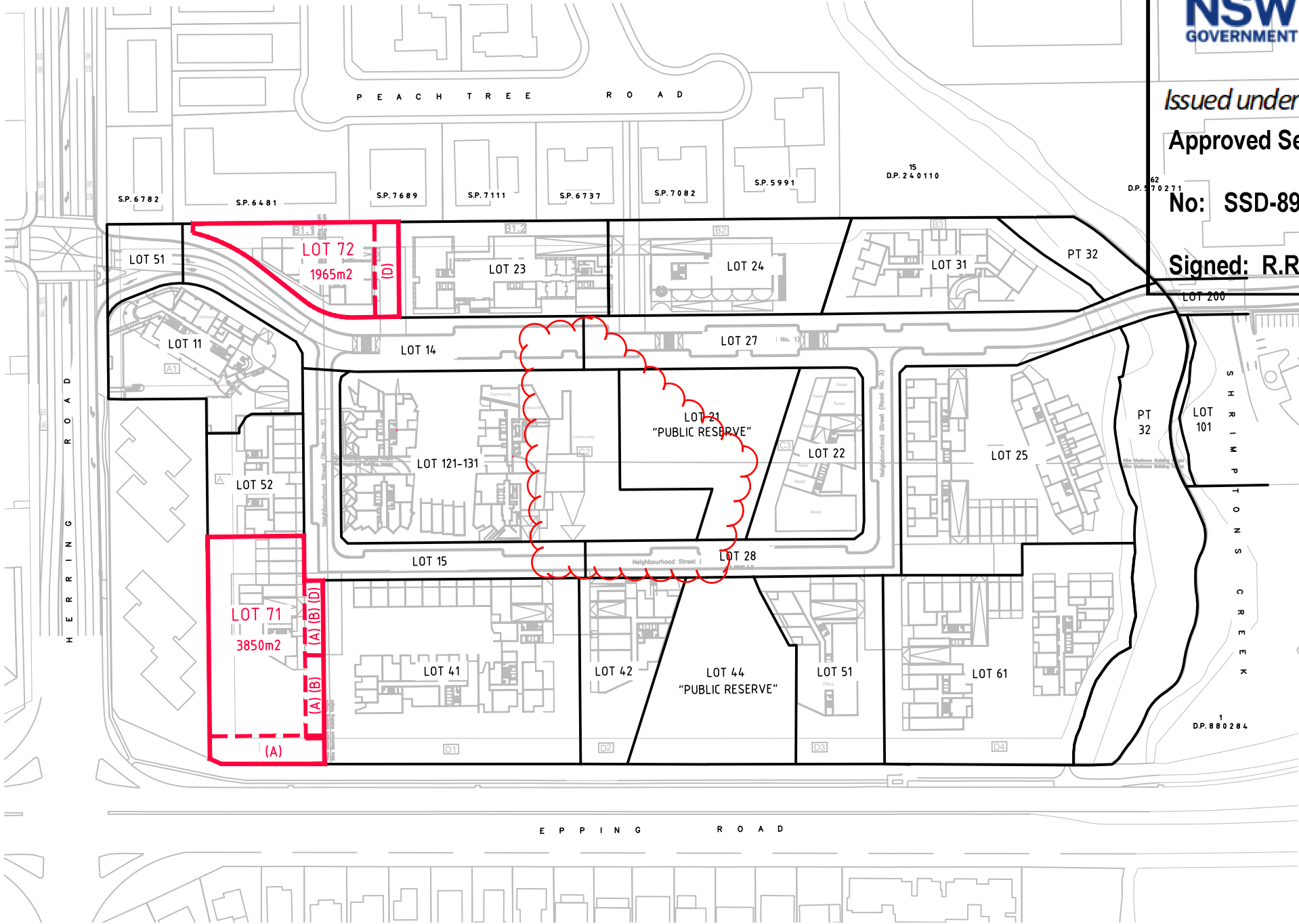

PROPOSED EASEMENTS:

- (A) EASEMENT FOR PUBLIC ACCESS
- (B) EASEMENT FOR SERVICES
- (D) RIGHT OF CARRIAGEWAY

NOTES:

EXTENT OF RESIDUE, LOT NUMBERING AND STAGING
SUBJECT TO CHANGE DEPENDING ON STAGE SEQUENCING.

AREAS AND DIMENSIONS ARE SUBJECT TO FINAL SURVEY
AND REGISTRATION OF PLAN AT LAND REGISTRY
SERVICES.

BASED ON ARCHITECTURAL PLAN AS SUPPLIED:
BATES SMART ARCHITECTS
DRAWING No.DA02.MP.000
ISSUE 12 DATED 26.8.19

SHEET 14 OF 15



Beveridge Williams
Development & Environment Consultants
Registered Surveyors

Sydney: (02) 9283 6677 www.beveridgewilliams.com.au

CAD REFERENCE: 1601644-STAGING-211112.dwg

SURVEYORS REF. 1601644
VERSION 13
SURVEYOR: PM
DRAWN: RK
ORIGINAL SHEET SIZE A3
CHECKED: PM
DATE: 12.11.2021

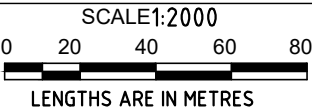

FRASERS PROPERTY AUSTRALIA

PLAN OF PROPOSED SUBDIVISION OF
LOT 1 DP859537, LOTS 6-8, 10-20 DP861433,
LOT 5 DP740753, LOT 100 DP1223787 AND
LOT 101 DP1247443

LOCALITY: MACQUARIE PARK
LGA: RYDE



EASEMENT SUMMARY
& FINAL LOT CONFIGURATION
Department of Planning
and Environment

Issued under the Environmental Planning and Assessment Act 1979
Approved Section 4.55 (1A) Modification Application

No: SSD-8903-MOD-5 Granted on 19 December 2022

Signed: R.R. Sheet No: 15 of 15

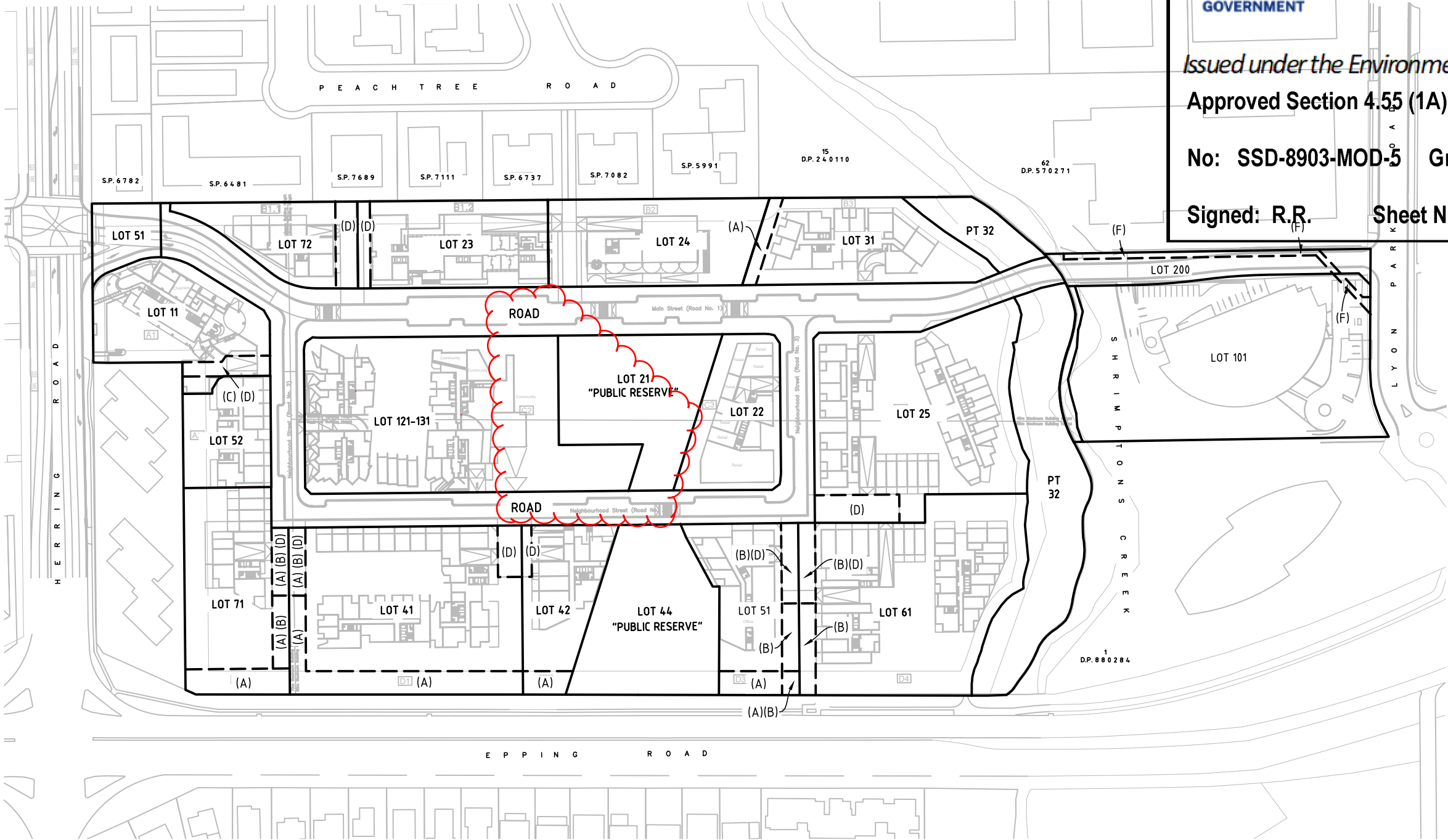

- PROPOSED EASEMENTS:
- (A) EASEMENT FOR PUBLIC ACCESS
 - (B) EASEMENT FOR SERVICES
 - (C) EASEMENT FOR OVERLAND FLOW & EASEMENT TO DRAIN WATER
 - (D) RIGHT OF CARRIAGEWAY

- EXISTING EASEMENTS:
- (F) EASEMENT FOR DRAINAGE (R507051)

NOTES:

AREAS AND DIMENSIONS ARE SUBJECT TO FINAL SURVEY AND REGISTRATION OF PLAN AT LAND REGISTRY SERVICES.

BASED ON ARCHITECTURAL PLAN AS SUPPLIED:
BATES SMART ARCHITECTS
DRAWING No.DA02.MP.000
ISSUE 12 DATED 26.8.19



Beveridge Williams
Development & Environment Consultants
Registered Surveyors

Sydney: (02) 9283 6677 www.beveridgewilliams.com.au

CAD REFERENCE: 1601644-STAGING-211112.dwg

SURVEYORS REF. 1601644
VERSION 13
ORIGINAL SHEET SIZE A3
SURVEYOR: PM CHECKED: PM
DRAWN: RK DATE: 12.11.2021

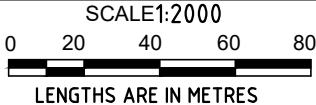

FRASERS PROPERTY AUSTRALIA

PLAN OF PROPOSED SUBDIVISION OF
LOT 1 DP859537, LOTS 6-8, 10-20 DP861433,
LOT 5 DP740753, LOT 100 DP1223787 AND
LOT 101 DP1247443