

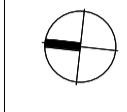

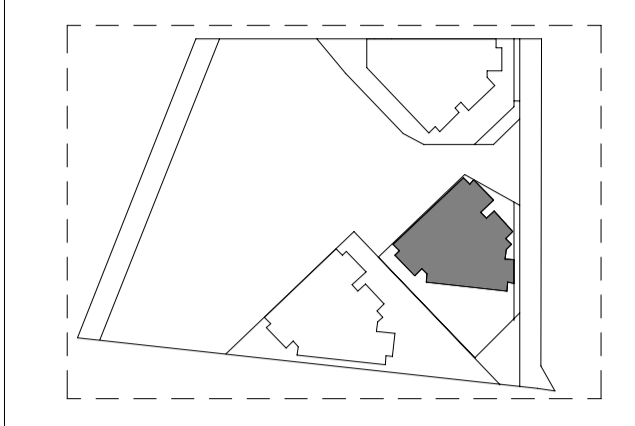







KEY PLAN

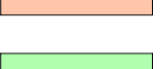
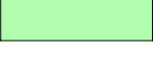

LEGEND

-  VOID
-  CONCRETE IN-SITU STRUCTURAL WALL
-  CARS
-  KWH BICYCLE STORE
-  RESIDENTIAL STORAGE (FITOUT AND USE)
-  RETAIL STORAGE (FITOUT AND USE)
-  EXTENT OF SHARED BASEMENT FACILITIES
-  EXTENT OF RESIDENTIAL TOWER FACILITIES (FITOUT AND USE)
-  PERIMETER RETAINING WALL COVERED UNDER SSD5897

NOTES  
 BASEMENT CONSTRUCTION UNDER SEPARATE DEVELOPMENT APPLICATION SSD 6960

AMENDMENTS ON THIS DRAWING RELATE TO THE KEY AND COLOURING.

 **Department of Planning and Environment**

*Issued under the Environmental Planning and Assessment Act 1979*  
**Approved Section 4.55 (1A) Modification Application**

**No: SSD 8892218 MOD 2**    **Granted on 14 February 2022**



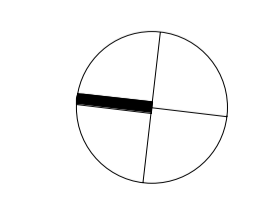

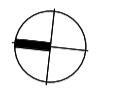
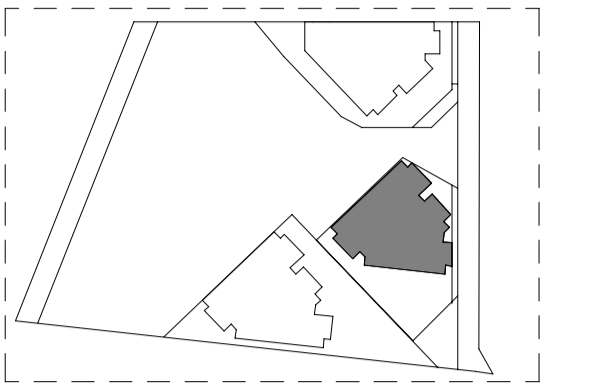

**Signed: AW**    **Sheet No: 1 of 5**



KEY PLAN

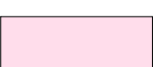

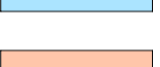
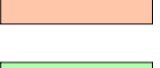
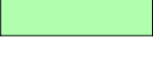
LEGEND

-  VOID
-  CONCRETE IN-SITU STRUCTURAL WALL
-  CARS
-  KWH BICYCLE STORE
-  RESIDENTIAL STORAGE (FITOUT AND USE)
-  RETAIL STORAGE (FITOUT AND USE)
-  EXTENT OF SHARED BASEMENT FACILITIES
-  EXTENT OF RESIDENTIAL TOWER FACILITIES (FITOUT AND USE)
-  PERIMETER RETAINING WALL COVERED UNDER SSD5897

NOTES  
BASEMENT CONSTRUCTION UNDER SEPARATE DEVELOPMENT APPLICATION SSD 6960

AMENDMENTS ON THIS DRAWING RELATE TO THE KEY AND COLOURING.



 **Department of Planning and Environment**

*Issued under the Environmental Planning and Assessment Act 1979*  
**Approved Section 4.55 (1A) Modification Application**

**No: SSD 8892218 MOD 2**    **Granted on 14 February 2022**

**Signed: AW**    **Sheet No: 2 of 5**

**R4B  
SETOUT PLAN BASEMENT LEVEL B3**

Scale 1 : 250 @ A1    Scale 1:500 @ A3

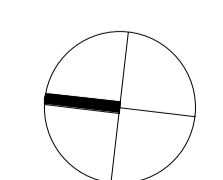
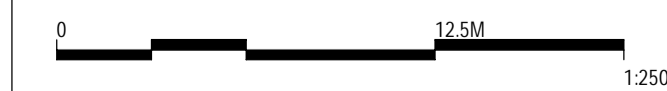

Drawing: BR4B\_ASD\_PA2\_1002  
Date: 21.10.21    Revision: 02  
\$4.55



KEY PLAN

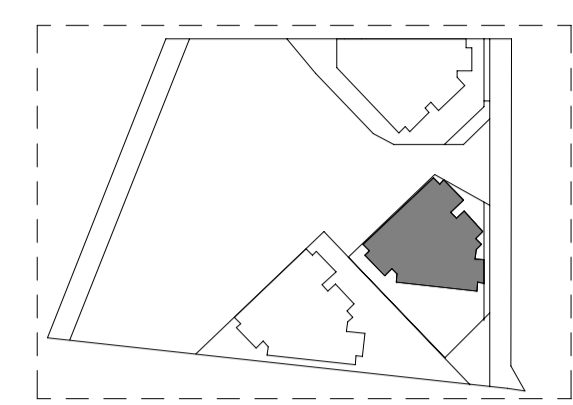

LEGEND

- VOID
- CONCRETE IN-SITU STRUCTURAL WALL
- CARS
- KWH BICYCLE STORE
- RESIDENTIAL STORAGE (FITOUT AND USE)
- RETAIL STORAGE (FITOUT AND USE)
- EXTENT OF SHARED BASEMENT FACILITIES
- EXTENT OF RESIDENTIAL TOWER FACILITIES (FITOUT AND USE)
- PERIMETER RETAINING WALL COVERED UNDER SSD5897

NOTES  
 BASEMENT CONSTRUCTION UNDER SEPARATE DEVELOPMENT APPLICATION SSD 6960

AMENDMENTS ON THIS DRAWING RELATE TO THE KEY AND COLOURING.

**Department of Planning and Environment**

*Issued under the Environmental Planning and Assessment Act 1979*  
**Approved Section 4.55 (1A) Modification Application**

**No: SSD 8892218 MOD 2    Granted on 14 February 2022**

**Signed: AW    Sheet No: 3 of 5**

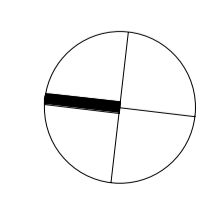

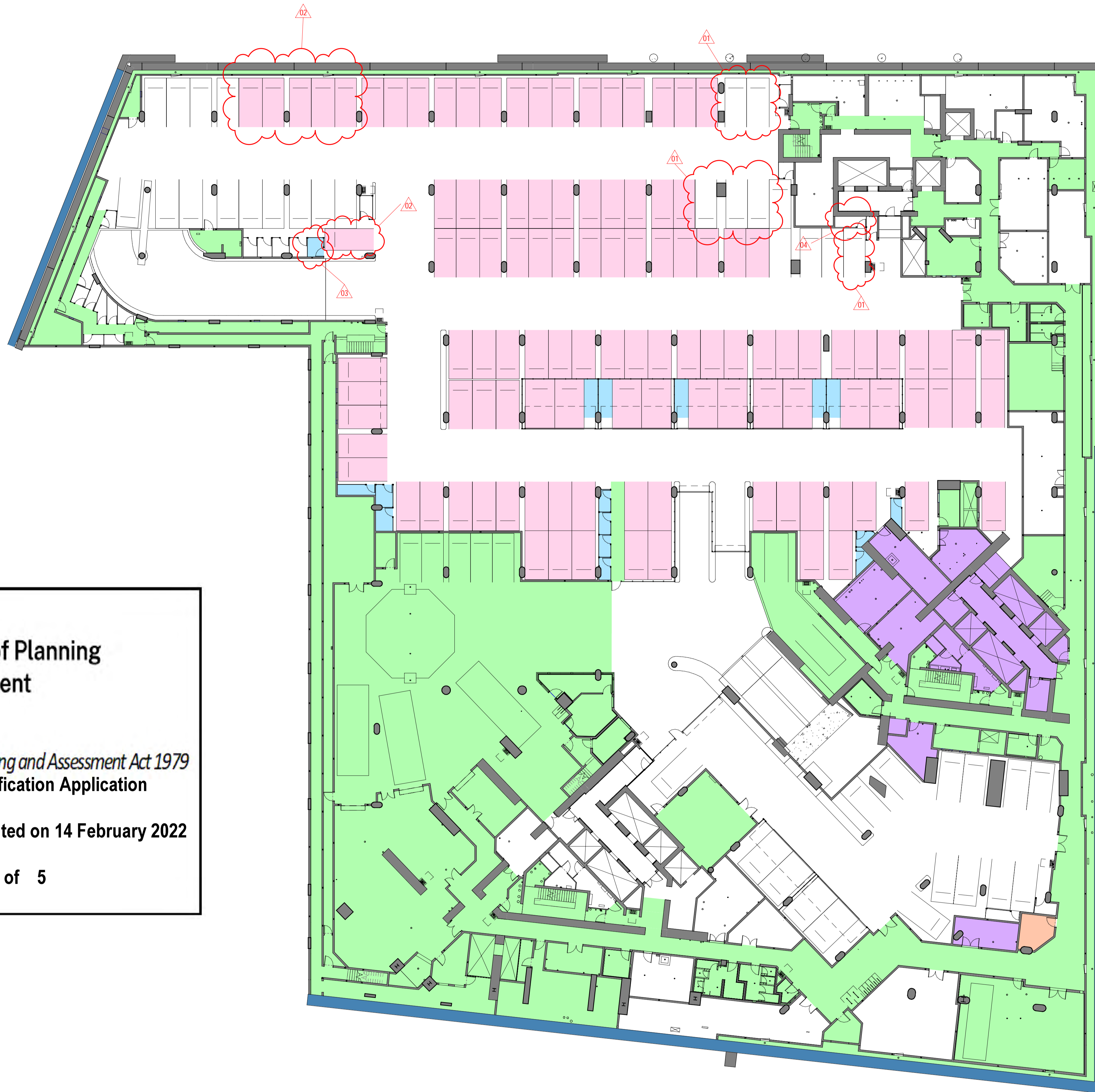



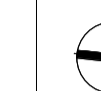
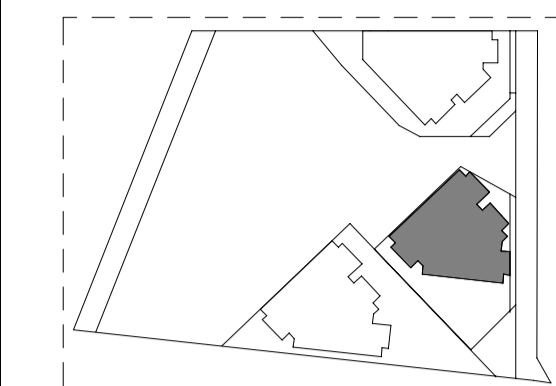





KEY PLAN

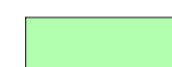

LEGEND

-  VOID
-  CONCRETE IN-SITU STRUCTURAL WALL
-  CARS
-  KWH BICYCLE STORE
-  RESIDENTIAL STORAGE (FITOUT AND USE)
-  RETAIL STORAGE (FITOUT AND USE)
-  EXTENT OF SHARED BASEMENT FACILITIES
-  EXTENT OF RESIDENTIAL TOWER FACILITIES (FITOUT AND USE)
-  PERIMETER RETAINING WALL COVERED UNDER SSD5897

NOTES  
BASEMENT CONSTRUCTION UNDER SEPARATE DEVELOPMENT APPLICATION SSD 6960

AMENDMENTS ON THIS DRAWING RELATE TO THE KEY AND COLOURING.

CLOUDING REFLECTS CHANGES WHICH IMPACTS R5

1. CAR SPACE UNALLOCATED FROM R4B
2. CAR SPACE ALLOCATED TO R4B
3. STORAGE CAGE ALLOCATED TO R4B
4. STORAGE CAGE UNALLOCATED FROM R4B



Department of Planning and Environment

Issued under the Environmental Planning and Assessment Act 1979  
Approved Section 4.55 (1A) Modification Application

No: SSD 8892218 MOD 2 Granted on 14 February 2022

Signed: AW Sheet No: 4 of 5

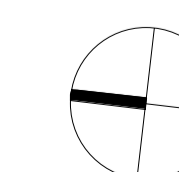



KEY PLAN

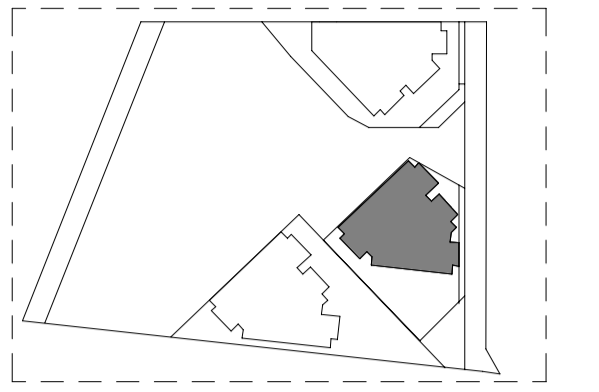

LEGEND

- VOID
- CONCRETE IN-SITU STRUCTURAL WALL
- CARS
- KWH BICYCLE STORE
- RESIDENTIAL STORAGE (FITOUT AND USE)
- RETAIL STORAGE (FITOUT AND USE)
- EXTENT OF SHARED BASEMENT FACILITIES
- EXTENT OF RESIDENTIAL TOWER FACILITIES (FITOUT AND USE)
- PERIMETER RETAINING WALL COVERED UNDER SSD5897

NOTES  
 BASEMENT CONSTRUCTION UNDER SEPARATE DEVELOPMENT APPLICATION SSD 6960

AMENDMENTS ON THIS DRAWING RELATE TO THE KEY AND COLOURING.

**Department of Planning and Environment**

*Issued under the Environmental Planning and Assessment Act 1979*  
**Approved Section 4.55 (1A) Modification Application**

**No: SSD 8892218 MOD 2    Granted on 14 February 2022**

**Signed: AW    Sheet No: 5 of 5**

