

BUDAWANG SCHOOL SCHOOL SP

15 Croobyar Road, Milton, NSW 2538

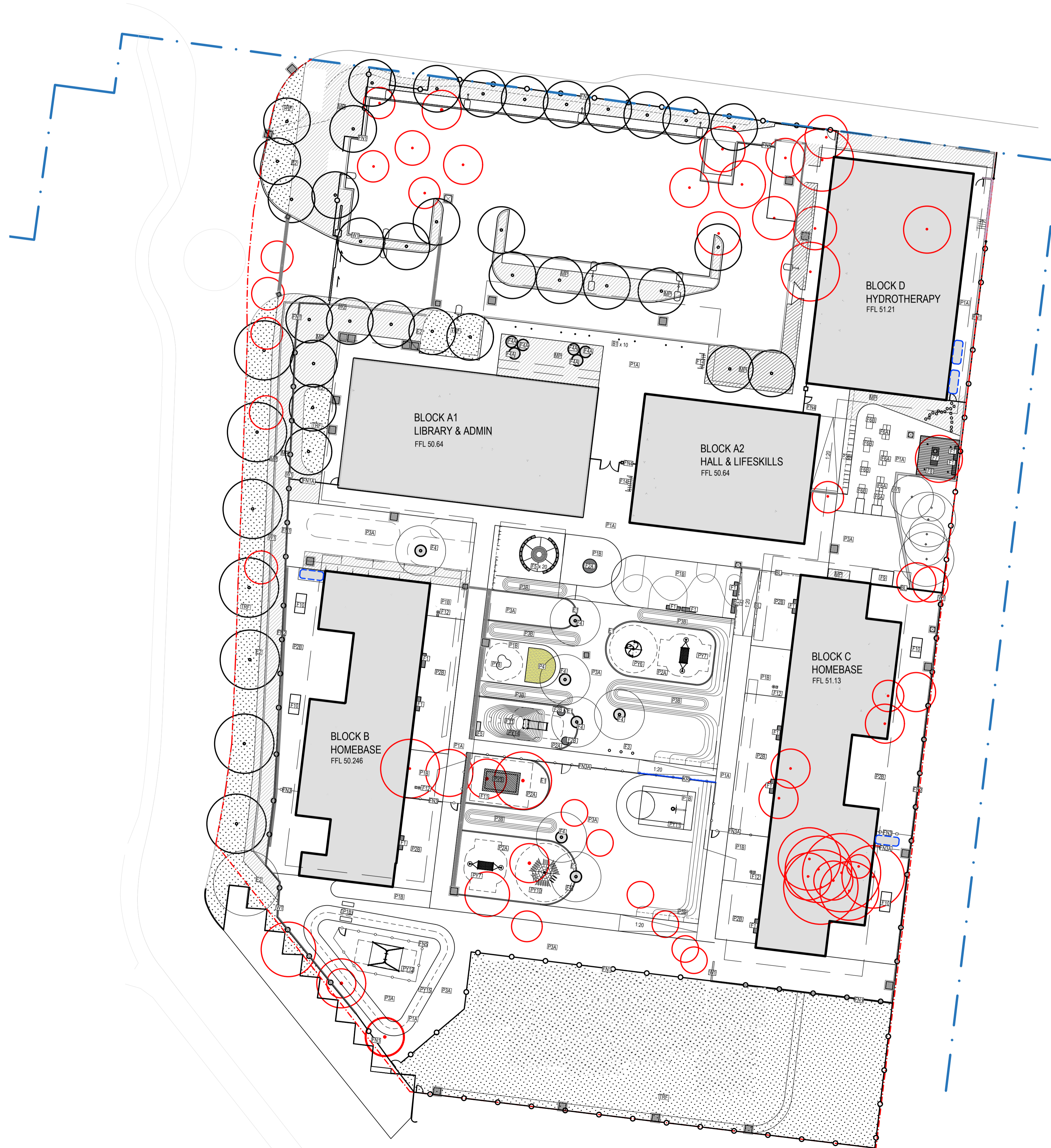

Document Title	Number	Issue Revision
COVER SHEET	L0000	E
TREE MANAGEMENT PLAN	L0002	D
MATERIALS SCHEDULE 01	L1001	D
MATERIALS SCHEDULE 02	L1002	B
GENERAL ARRANGMENT 01	L2001	E
GENERAL ARRANGMENT 02	L2002	E
FENCE AND GATE PLAN	L2100	E
LEVELS AND GRADING 01	L3001	C
LEVELS AND GRADING 02	L3002	C
SET OUT PLAN 01	L4001	B
SET OUT PLAN 02	L4002	B
PLANTING SCHEDULE	L5000	C
PLANTING PLAN 01	L5001	C
PLANTING PLAN 02	L5002	C
IRRIGATION PLAN	L5100	C
SECTIONS	L6001	C
SECTIONS	L6002	C
SECTIONS	L6003	C
DETAILS	L7000	C
DETAILS	L7001	C
DETAILS	L7002	C
DETAILS	L7003	C
DETAILS	L7004	C
DETAILS	L7005	C
DETAILS	L7006	B

Amendments	Issue Description	Date
A	100% DD	26/11/2021
B	100% DD	21/02/2021
C	AFC	14/02/2022
D	ISSUED FOR CONSTRUCTION	09/06/2022
E	ISSUED FOR CONSTRUCTION	12/07/2022

Project Management

SJA
Level 1, 100 Pitt Street, NSW, 2000
02 9228 9500

Structural and Civil

HENRY & HYMAS
Suite 10, 120 Pacific Highway, Gordon, NSW, 2072
02 9417 8400

Building Services

INTELLE BUILDING SERVICES
Level 2, 355 Kent Street, Sydney, NSW, 2000
02 9772 3600

BCA Consultant

ABC | ACCREDITED BUILDING CERTIFIERS
28 AUBURN STREET, WOLLONGONG, NSW, 2500
02 4228 9300

Contractor

ZAUNER CONSTRUCTION
Suite 10, 120 Pacific Highway, Ulladulla, NSW, 2539
PO Box 271
02 6288 6500



Client

SCHOOL INFRASTRUCTURE NSW
Level 8, 259 George Street, Sydney, NSW, 2000
1300 462 651



Group GSA Pty Ltd ABN 76 002 113 779
Level 7, 80 William St East Sydney NSW
Australia 2011 www.groupgsa.com

T +612 9361 4144 F +612 9332 3458
architecture interior design urban design landscape
nom architect M. Sheldon 3990

Project Title

BUDAWANG SCHOOL
15 Croobyar Road, Milton, NSW 2538

Drawing Title

**LANDSCAPE PLAN
COVER SHEET**

Scale 1:200 @A1

Drawing created (date) 12/07/2022

By LG

Plotted and checked by FR

Verified FR

Approved FR

Drawing No Issue

190941 L0000 E

This drawing is the copyright of Group GSA Pty Ltd and may not be altered, reproduced or transmitted in any form or by any means in part or in whole without the written permission of Group GSA Pty Ltd. All levels and dimensions are to be checked and verified on site prior to the commencement of any work, making of shop drawings or fabrication of components. Do not scale drawings. Use figured Dimensions.

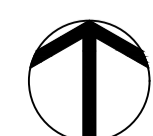

Amendments	Issue Description	Date
A	75% DD	21/10/2021
B	100% DD	23/11/2021
C	100% DD	21/12/2021
D	AFC	14/02/2022
E	ISSUED FOR CONSTRUCTION	06/06/2022

- LEGEND**
- SITE BOUNDARY
 - BUILDING AWNING LINE
- SOFTWORKS**
- + EXISTING TREE TO BE RETAINED AND PROTECTED
 - PROPOSED TREE TRF TURF
 - PROPOSED TREE IN CONCRETE PIPE PLANTER MP
- PAVING**
- P1A CONCRETE - PLAIN
 - P1B COLOURED CONCRETE COLOUR TBC
 - P2A RUBBER SOFTFALL WITH ATTENUATION LAYER
 - P2B RUBBER SOFTFALL
 - P3A ARTIFICIAL TURF TYPE 1
 - P3B ARTIFICIAL TURF TYPE 2
 - P4 SAND PIT
- WALLS AND FENCES**
- W1 BLOCKWORK WALL
 - FN1 FENCE TYPE AND LOCATION REFER L2100
 - FN2 FENCE TYPE AND LOCATION REFER L2100
 - FN3 FENCE TYPE AND LOCATION REFER L2100
 - FN4 FENCE TYPE AND LOCATION REFER L2100
 - FN5 FENCE TYPE AND LOCATION REFER L2100
 - B+H BALUSTRADE AND HANDRAIL
 - BL BALUSTRADE
 - HR HANDRAIL
- FURNITURE**
- F1 BENCH - DDA COMPLIANT
 - F2A CIRCULAR PLATFORM SEAT LARGE
 - F2B CIRCULAR PLATFORM SEAT SMALL
 - F3 FLAGPOLE
 - F4 CONCRETE PIPE PLANTER
 - F5 SANDSTONE BLOCK SEAT
 - F6A RAISED PLANTERS A- PRODUCTIVE GARDEN
 - F6B RAISED PLANTERS B- PRODUCTIVE GARDEN
 - F7 POTTING TABLE WITH SINK
 - F8 ALL WEATHER STRUCTURE
 - F9 CHICKEN COOP
 - F10 CLOTHESLINE
 - F11 SHADE SAIL
- PLAY EQUIPMENT**
- PY6 ROTATING EQUIPMENT
 - PY7 HAMMOCK SWING
 - PY8 SAND TABLE
 - PY9 TRAMPOLINE LARGE
 - PY10 CLIMBING EQUIPMENT
 - PY11 BASKETBALL HOOP
 - PY12 LIBERTY SWING
 - PY14 SLIDE
 - PY15 CYCLE TRACK
- EDGE**
- E1 CONCRETE EDGE
 - E2 STEEL EDGE
- SERVICES**
- LIGHT POLE
- LEGEND (continued)**
- B+H BALUSTRADE AND HANDRAIL
 - BL BALUSTRADE
 - KR KERB RAIL

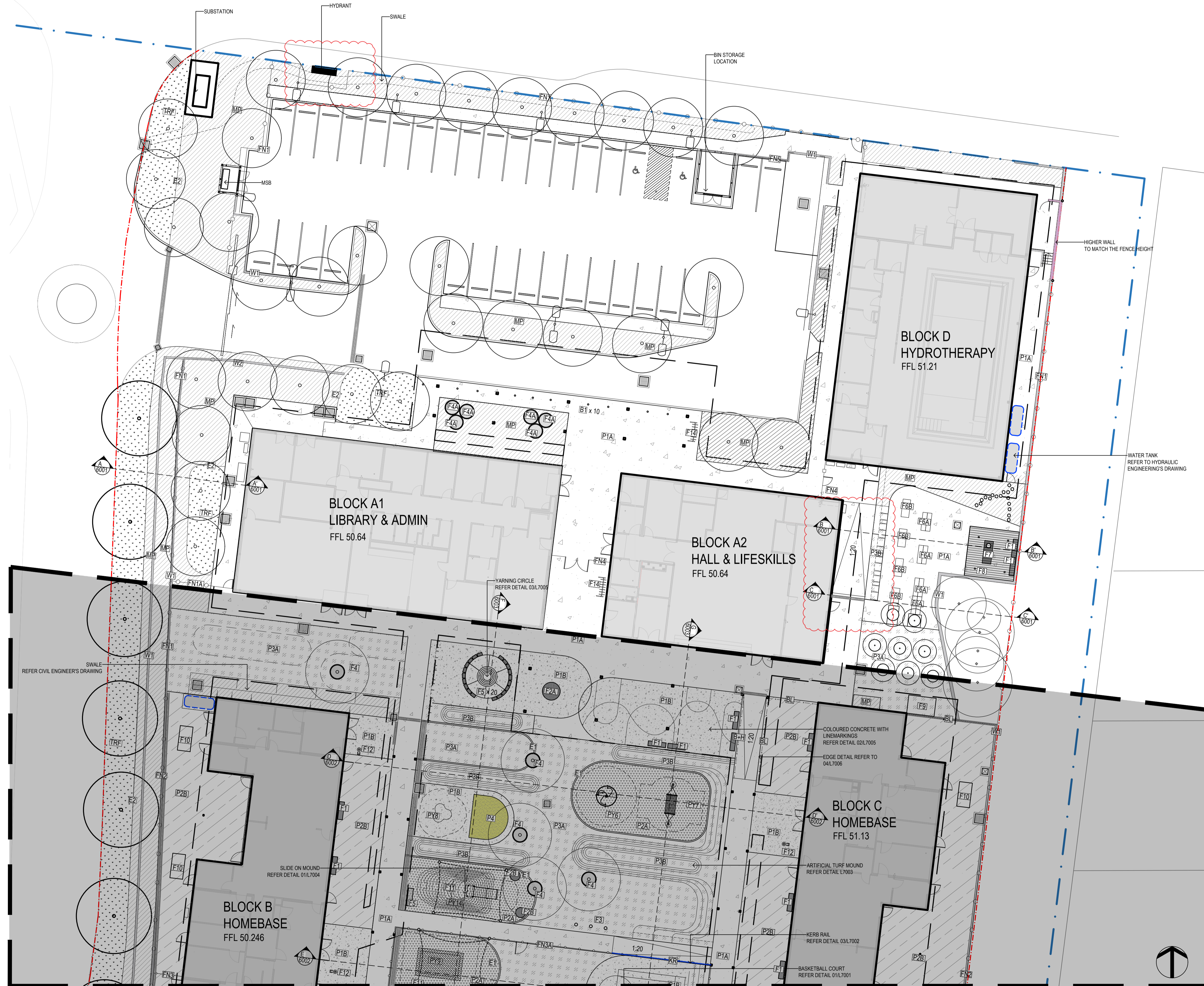

Project Management	
SJA	Level 1, 100 Pitt Street, NSW, 2000 02 9228 9500
Structural and Civil	
HENRY & HYMAS	Level 2, 355 Kent Street, Sydney, NSW, 2000 02 9417 8400
Building Services	
INTELLE BUILDING SERVICES	Level 2, 299 George Street, Sydney, NSW, 2000 02 9772 3600
BCA Consultant	
ABC ACCREDITED BUILDING CERTIFIERS	28 AUBURN STREET, WOLLONGONG, NSW, 2500 02 8228 9300
Contractor	
ZAUNER CONSTRUCTION	Level 10, 152 Princes Highway, Ulladulla, NSW, 2539 PO Box 2715 02 6228 9500
Client	
SCHOOL INFRASTRUCTURE NSW	Level 8, 299 George Street, Sydney, NSW, 2000 1300 462 651
GROUP GSA	
Group GSA Pty Ltd ABN 76 002 113 779 Level 7, 80 William St East Sydney NSW Australia 2011 www.groupgsa.com T +612 9361 4144 F +612 9332 3458 architecture interior design urban design landscape nom architect M. Sheldon 3990	
Project Title	
BUDAWANG SCHOOL	
15 Croobyar Road, Milton, NSW 2538	
Drawing Title	
LANDSCAPE PLAN	
GENERAL ARRAGEMENT 01	
Scale	1:200 @A1
Drawing created (date)	06/06/2022
By	LG
Plotted and checked by	FR
Verified	FR
Approved	FR
Drawing No	Issue
190941	L2001 E

This drawing is the copyright of Group GSA Pty Ltd and may not be altered, reproduced or transmitted in any form or by any means in part or in whole without the written permission of Group GSA Pty Ltd. All levels and dimensions are to be checked and verified on site prior to the commencement of any work, making of shop drawings or fabrication of components. Do not scale drawings. Use figured Dimensions.

LEGEND	
	SITE BOUNDARY
	BUILDING AWNING LINE
SOFTWORKS	
	EXISTING TREE TO BE RETAINED AND PROTECTED
	PROPOSED TREE
	PROPOSED TREE IN CONCRETE PIPE PLANTER
	TURF
	MASS PLANTING
PAVING	
	CONCRETE - PLAIN
	COLOURED CONCRETE COLOUR TBC
	RUBBER SOFTFALL WITH ATTENUATION LAYER
	RUBBER SOFTFALL
	ARTIFICIAL TURF TYPE 1
	ARTIFICIAL TURF TYPE 2
	SAND PIT
WALLS AND FENCES	
	BLOCKWORK WALL
	FENCE TYPE AND LOCATION REFER L2100
	FENCE TYPE AND LOCATION REFER L2100
	FENCE TYPE AND LOCATION REFER L2100
	FENCE TYPE AND LOCATION REFER L2100
	FENCE TYPE AND LOCATION REFER L2100
	BALUSTRADE AND HANDRAIL
	BALUSTRADE
	HANDRAIL
FURNITURE	
	BENCH - DDA COMPLIANT
	CIRCULAR PLATFORM SEAT LARGE
	CIRCULAR PLATFORM SEAT SMALL
	FLAGPOLE
	CONCRETE PIPE PLANTER
	SANDSTONE BLOCK SEAT
	RAISED PLANTERS A- PRODUCTIVE GARDEN
	RAISED PLANTERS B- PRODUCTIVE GARDEN
	POTTING TABLE WITH SINK
	ALL WEATHER STRUCTURE
	CHICKEN COOP
	CLOTHESLINE
	SHADE SAIL
PLAY EQUIPMENT	
	ROTATING EQUIPMENT
	HAMMOCK SWING
	SAND TABLE
	TRAMPOLINE LARGE
	CLIMBING EQUIPMENT
	BASKETBALL HOOP
	LIBERTY SWING
	SLIDE
	CYCLE TRACK
EDGE	
	CONCRETE EDGE
	STEEL EDGE
SERVICES	
	LIGHT POLE
	BALUSTRADE AND HANDRAIL
	BALUSTRADE
	KERB RAIL

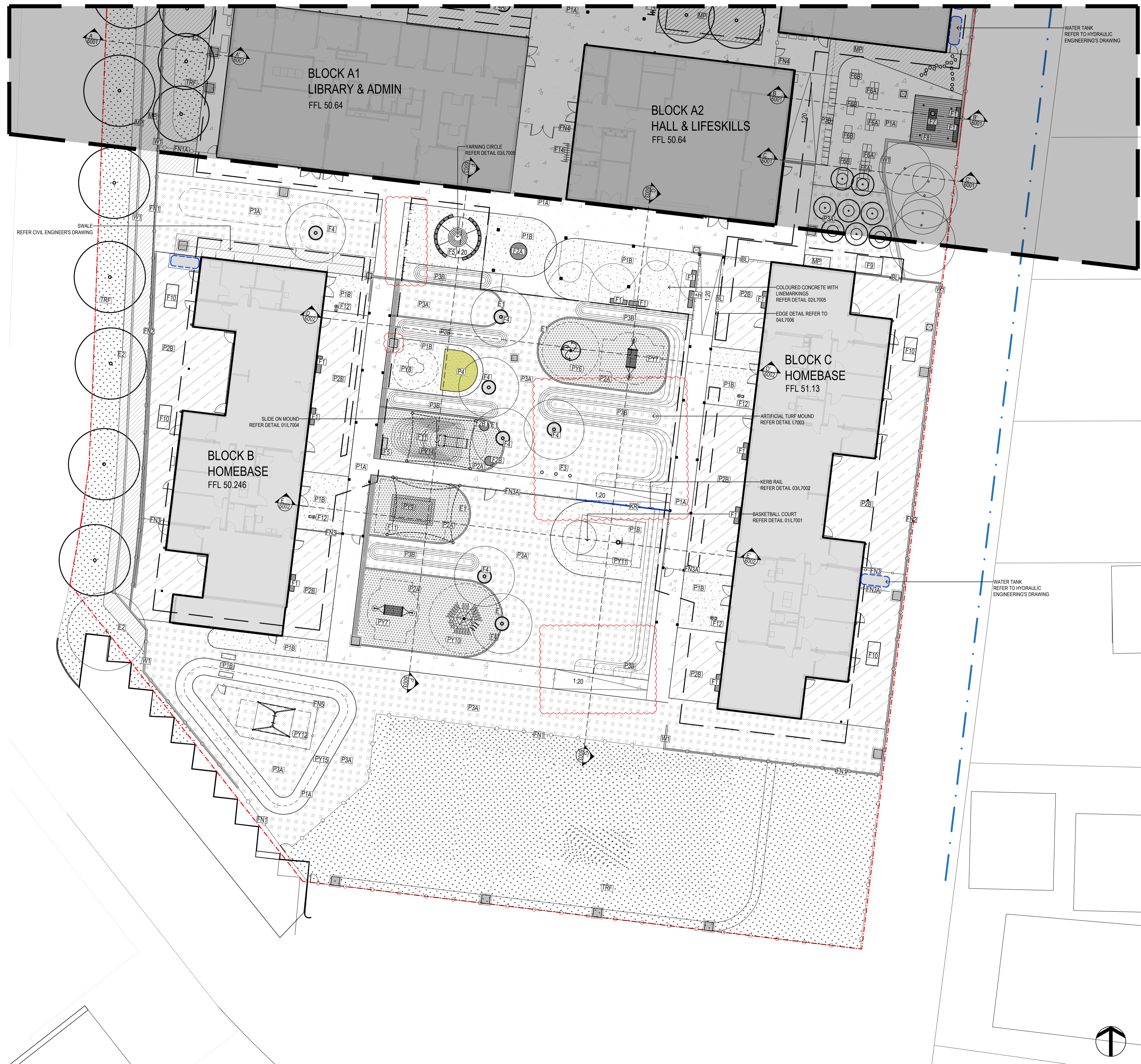

Amendments Issue Description	Date
A 75% DD	21/10/2021
B 100% DD	24/11/2021
C 100% DD	21/12/2021
D AFC	14/02/2022
E ISSUED FOR CONSTRUCTION	06/06/2022

Project Management
SJA
 Level 1, 100 Pitt Street, NSW, 2000
 02 9238 9300

Structural and Civil
HENRY & HYMAS
 Suite 1/1, 120 Pacific Highway, Gordon, NSW, 2072
 02 9417 5400

Building Services
INTELLE BUILDING SERVICES
 Level 2, 355 Kent Street, Sydney, NSW, 2000
 02 9772 3600

BCA Consultant
ABC | ACCREDITED BUILDING CERTIFIERS
 28 AUBURN STREET, WOLLONGONG, NSW, 2500
 02 8208 9300

Contractor
ZAUNER CONSTRUCTION
 Suite 10, 150 Princes Highway, Ulladulla, NSW, 2539
 PO Box 2715
 02 8208 9300

Client
SCHOOL INFRASTRUCTURE NSW
 Level 3, 298 George Street, Sydney, NSW, 2000
 1300 462 651

SCHOOL INFRASTRUCTURE NSW

GROUP GSA

Group GSA Pty Ltd ABN 76 002 113 779
 Level 7, 80 William St East Sydney NSW
 Australia 2011 www.groupgsa.com
 T +612 9361 4144 F +612 9332 3458
 architecture interior design urban design landscape
 nom architect M. Sheldon 3990

Project Title
BUDAWANG SCHOOL
 15 Croobyar Road, Milton, NSW 2538

Drawing Title
**LANDSCAPE PLAN
 GENERAL ARRANGEMENT 02**

Scale 1:200 @A1

Drawing created (date) 06/06/2022

By LG

Plotted and checked by FR

Verified FR

Approved FR

Drawing No Issue
190941 L2002 E

This drawing is the copyright of Group GSA Pty Ltd and may not be altered, reproduced or transmitted in any form or by any means in part or in whole without the written permission of Group GSA Pty Ltd. All levels and dimensions are to be checked and verified on site prior to the commencement of any work, making of shop drawings or fabrication of components. Do not scale drawings. Use figured Dimensions.

LEGEND	
	SITE BOUNDARY
	UNIVERSAL SAFE PRACTICE - BOUNDARY FENCE (2400MM HIGH SCHOOL PALISADE FENCE) - FLAT TOP
	UNIVERSAL SAFE PRACTICE - BOUNDARY FENCE (2100MM HIGH SCHOOL PALISADE FENCE) - FLAT TOP
	UNIVERSAL SAFE PRACTICE - BOUNDARY FENCE WITH VISUAL SCREENING (2400MM HIGH)
	UNIVERSAL SAFE PRACTICE - SECONDARY FENCE (2400MM HIGH) - WELDED MESH FENCE WITH NO TOP
	UNIVERSAL SAFE PRACTICE - SECONDARY FENCE (1800MM HIGH) - WELDED MESH FENCE WITH NO TOP
	UNIVERSAL SAFE PRACTICE - CUSTOM METAL FRAME FENCE WITH PERFORATED MESH PANELS (2100MM HIGH)
	UNIVERSAL SAFE PRACTICE - 'POOL TYPE' VERTICAL OD FENCE (1200MM HIGH)

CODE	DIMENSIONS	TYPE	DESCRIPTION	FINISH	ADDITIONAL COMMENTS
FENCES					
FN1	2400mm H	Metal vertical rod with flat top boundary fence	Site Boundary	Powdercoated Colour: Monument	Fence to comply with EFSG standard and details.
FN1A	2100mm H	Metal vertical rod with flat top boundary fence	Secondary fence	Powdercoated Colour: Monument	Fence to comply with EFSG standard and details.
FN2	2400mm H	Metal vertical slat privacy fence	Site Boundary	Powdercoated Colour: Monument	65mm width slats
FN3	2400mm H	Welded mesh fence with no top/bottom rail non-climbable	Secondary fencing & play space division	Powdercoated Colour: Monument	"358" specification re aperture: 4mm horizontal wires at 75mm centres, on 4mm vertical wires at 13mm centres
FN3A	1800mm H	Welded mesh fence with no top/bottom rail non-climbable	Play space division and outdoor learning area division	Powdercoated Colour: Monument	"358" specification re aperture: 4mm horizontal wires at 75mm centres, on 4mm vertical wires at 13mm centres
FN4	2100mm H	Custom metal frame fence with perforated mesh panels - decorative	Primary pedestrian access	Powdercoated Colour: Monument	Custom made perforated mesh fence and gates
FN5	1200mm H	Vertical rod with flat top pool type fence	Secondary fence	Powdercoated Colour: Monument	Fence to be located to liberty swing and hydrotherapy pool service zone
GATES - VEHICULAR					
G1	2400mm H x width to extend beyond kerbline	Metal vertical rod with flat top gates	Double leaf sliding gates Security arrangements under review.	Powdercoated Colour: Monument	Allow for additional fencing and gate to house motor for main vehicular gate
GATES - PEDESTRIAN					
G2	2400mm H x 1200mm width	Metal vertical rod with flat top gate	Single leaf swing gate security controlled	Powdercoated Colour: Monument	Refer electrical dwgs and spec for all infrastructure requirements
G3	2100mm H x 2000mm width	Metal with flat top - perforated mesh panels	Single leaf, swing gate security controlled	Powdercoated Colour: Monument	Refer electrical dwgs and spec for all infrastructure requirements
G4	2100mm H x 1200mm width	Metal vertical rod with flat top gate	Single leaf swing gate manual lockable	Powdercoated Colour: Monument	Refer Specification
G7	2400mm H x 1200mm width	Welded metal mesh gate	Single leaf swing gate security controlled	Powdercoated Colour: Monument	Refer electrical dwgs and spec for all infrastructure requirements
G8	1800mm H x 1200mm width	Welded metal mesh gate	Single leaf swing gate security controlled	Powdercoated Colour: Monument	Refer electrical dwgs and spec for all infrastructure requirements
G9	2400mm H x 1200mm width	Welded metal mesh gate	Single leaf swing gate security controlled	Powdercoated Colour: Monument	Refer electrical dwgs and spec for all infrastructure requirements
G13	2100mm H x 1200 width	Metal with flat top - perforated mesh panels	Single leaf swing gate security controlled	Powdercoated Colour: Monument	Refer electrical dwgs and spec for all infrastructure requirements
G14	2400mm H x 1200mm width	Metal vertical rod with flat top gate	Single leaf swing gate manual lockable	Powdercoated Colour: Monument	Refer Specification
G15	2100mm H x 1200 width	Metal vertical rod with flat top gate	Single leaf swing gate manual lockable	Powdercoated Colour: Monument	Refer Specification
G16	2400mm H x 1200mm width	Metal vertical rod with flat top gate	Single leaf swing gate manual lockable	Powdercoated Colour: Monument	Refer Specification
G17	1800mm H x 1200mm width	Metal vertical rod with flat top gate	Single leaf swing gate manual lockable	Powdercoated Colour: Monument	Refer Specification
G18	1200mm H x 1200mm width	Metal vertical rod with flat top gate	Single leaf swing gate manual lockable	Powdercoated Colour: Monument	Refer Specification
G19	2400mm H x 1200mm width	Metal vertical rod with flat top gate	Single leaf swing gate security controlled	Powdercoated Colour: Monument	Refer electrical dwgs and spec for all infrastructure requirements
G20	1800mm H x 1200mm width	Metal vertical rod with flat top gate	Single leaf swing gate manual lockable	Powdercoated Colour: Monument	Refer Specification
G21	1200mm H x 1200mm width	Metal vertical rod with flat top gate	Single leaf sliding gate manual lockable	Powdercoated Colour: Monument	Refer Specification
G22	1200mm H x 2100mm width	Metal vertical rod with flat top gate	Single leaf sliding gate manual lockable	Powdercoated Colour: Monument	Refer Specification

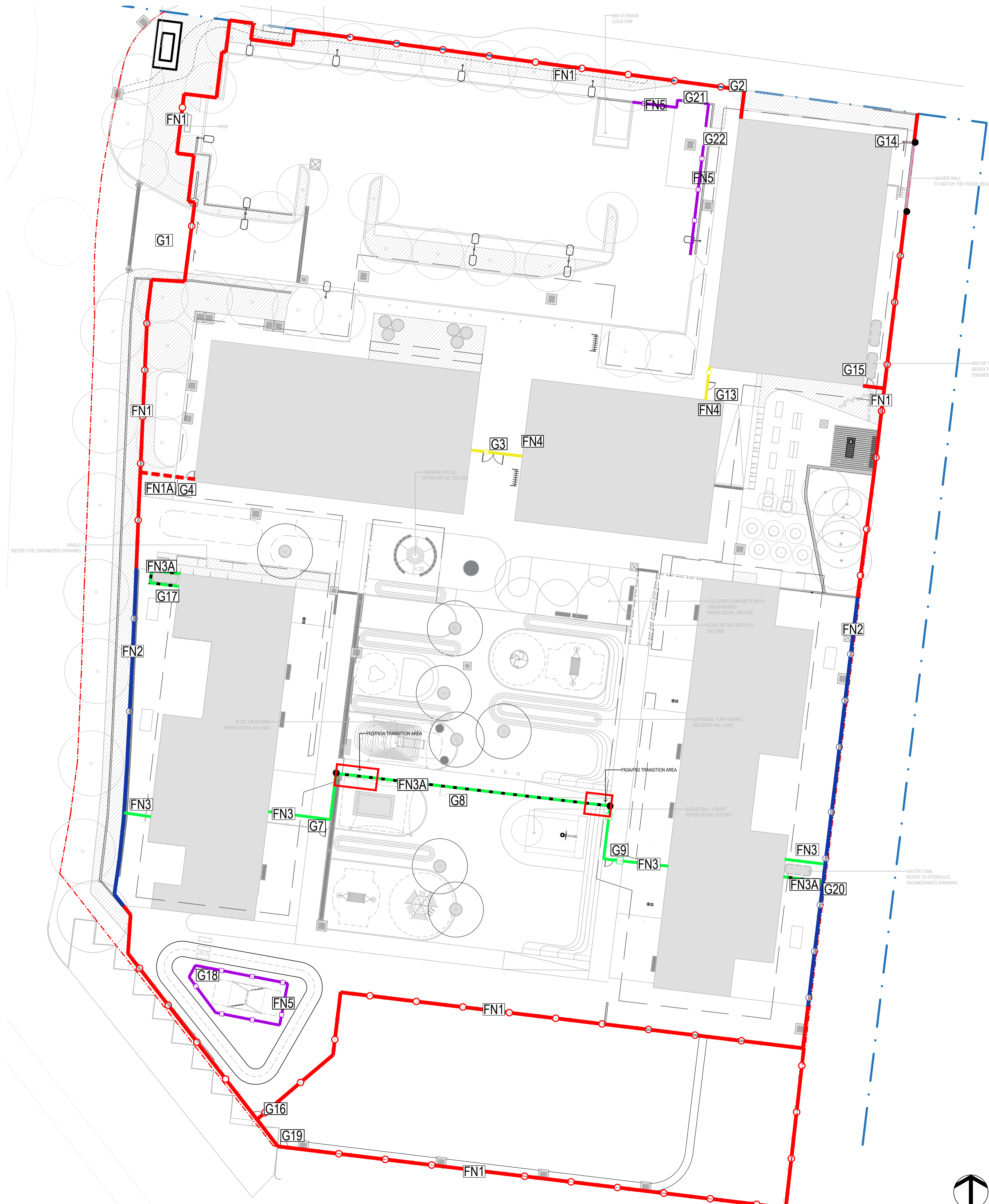
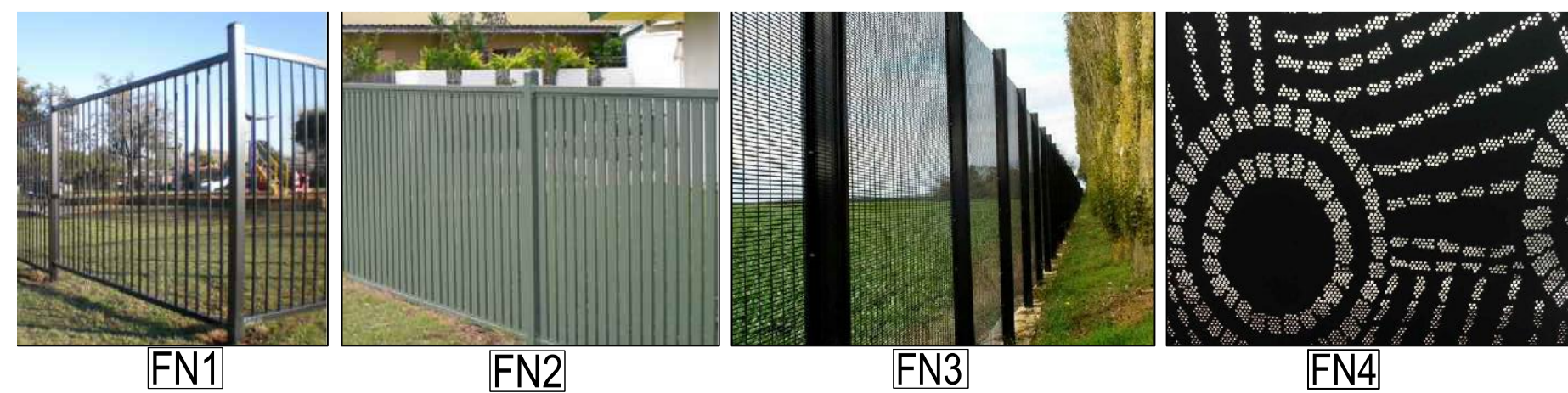

Amendments		
Issue	Description	Date
A	75% DD	17/11/2021
B	100% DD	18/11/2021
C	100% DD	21/12/2021
D	AFC	14/02/2022
E	ISSUED FOR CONSTRUCTION	06/06/2022

Project Management
SJA
 Level 1, 100 Pitt Street, NSW, 2000
 02 9288 9200

Structural and Civil
HENRY & HYMAS
 Suite 10, 102 Pacific Highway, Gordon, NSW, 2072
 02 9417 8400

Building Services
INTELLE BUILDING SERVICES
 Level 2, 355 Kent Street, Sydney, NSW, 2000
 02 9772 3600

BCA Consultant
ABC | ACCREDITED BUILDING CERTIFIERS
 28 AUBURN STREET, WOLLONGONG, NSW, 2500

Contractor
ZAUNER CONSTRUCTION
 Suite 10, 102 Pacific Highway, Ulladulla, NSW, 2539
 PO Box 271, Ulladulla NSW 2539
 02 6288 6000

Client
SCHOOL INFRASTRUCTURE NSW
 Level 8, 259 George Street, Sydney, NSW, 2000
 1300 462 651

SCHOOL INFRASTRUCTURE NSW

GROUP GSA

Group GSA Pty Ltd ABN 76 002 113 779
 Level 7, 80 William St East Sydney NSW
 Australia 2011 www.groupgsa.com
 T +612 9361 4144 F +612 9332 3458

architecture interior design urban design landscape
 nom architect M. Sheldon 3990

Project Title
BUDAWANG SCHOOL
 15 Croobyar Road, Milton, NSW 2538

Drawing Title
FENCE AND GATE PLAN

Scale 1:250 @A1

Drawing created (date) 06/06/2022

By LG

Plotted and checked by LG

Verified FR

Approved FR

Drawing No 190941 Issue L2100 E

This drawing is the copyright of Group GSA Pty Ltd and may not be altered, reproduced or transmitted in any form or by any means in part or in whole without the written permission of Group GSA Pty Ltd. All levels and dimensions are to be checked and verified on site prior to the commencement of any work, making of shop drawings or fabrication of components. Do not scale drawings. Use figured Dimensions.

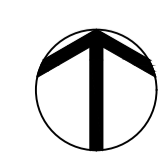

Amendments	Issue Description	Date
A	100% DD	21/12/2021
B	AFC	14/02/2022
C	ISSUED FOR CONSTRUCTION	06/06/2022

LEGEND

--- SITE BOUNDARY

--- BUILDING AWNING LINE

LEVELS

--- EOW EXTENT OF WORKS

+ EX 6.35 EXISTING LEVEL

+ RL 6.35 PROPOSED LEVEL

+ TOW 6.35 TOP OF WALL LEVEL

+ BOW 6.35 BOTTOM OF WALL LEVEL

+ FFL 6.35 FINISHED FLOOR LEVEL

FALL 1:50 FALL DIRECTION

--- 42.00 PROPOSED CONTOURS REFER TO CIVIL ENGINEER

- NOTES:**
- CONTOURS SHOWN SUPPLIED BY CIVIL ENGINEER FOR REFERENCE ONLY. ADDITIONAL SPOT LEVELS ADDED FOR GREATER DETAIL.
 - ALL FOOTPATHS, SOFTFALL AND PLAY MULCH GRADES TO BE IN ACCORDANCE WITH EFGS MAX. AND MIN. GRADES
 - FINISH SURFACE LEVEL AT ALL BUILDING ENTRIES. REFER TO ARCHITECT THRESHOLD DETAILS.

--- BALUSTRADE AND HANDRAIL

--- BALUSTRADE

--- KERB RAIL

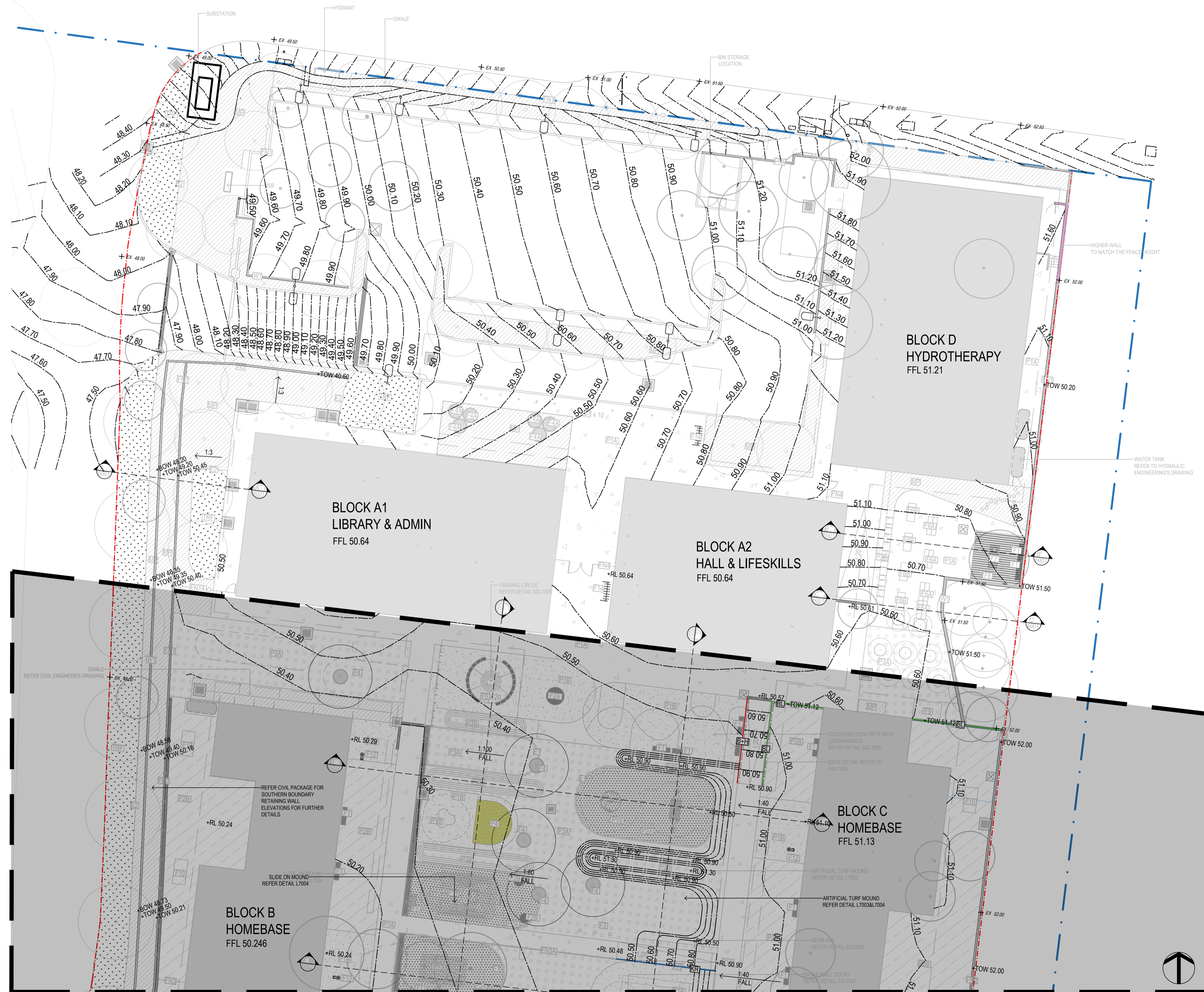

Project Management
SJA
 Level 1, 100 Pitt Street, NSW, 2000
 02 9228 9500

Structural and Civil
HENRY & HYMAS
 Suite 1/1, 129 Pacific Highway, Gordon, NSW, 2072
 02 9417 8400

Building Services
INTELLE BUILDING SERVICES
 Level 2, 355 Kent Street, Sydney, NSW, 2000
 02 9772 3600

BCA Consultant
ABC | ACCREDITED BUILDING CERTIFIERS
 28 AUBURN STREET, WOLLONGONG, NSW, 2500
 02 4228 9300

Contractor
ZAUNER CONSTRUCTION
 Suite 10, 152 Princess Highway, Ulladulla, NSW, 2539
 PO Box 2715
 02 6283 6500

Client
SCHOOL INFRASTRUCTURE NSW
 Level 8, 259 George Street, Sydney, NSW, 2000
 1300 462 651

SCHOOL INFRASTRUCTURE NSW

GROUP GSA
 Group GSA Pty Ltd ABN 76 002 113 779
 Level 7, 80 William St East Sydney NSW
 Australia 2011 www.groupgsa.com
 T +612 9361 4144 F +612 9332 3458
 architecture interior design urban design landscape
 nom architect M. Sheldon 3990

Project Title
BUDAWANG SCHOOL
 15 Croobyar Road, Milton, NSW 2538

Drawing Title
**LANDSCAPE PLAN
 LEVELS AND GRADING 01**

Scale 1:200 @A1
Drawing created (date) 06/06/2022
By LG
Plotted and checked by FR
Verified FR
Approved FR

Drawing No 190941
Issue L3001 C

This drawing is the copyright of Group GSA Pty Ltd and may not be altered, reproduced or transmitted in any form or by any means in part or in whole without the written permission of Group GSA Pty Ltd. All levels and dimensions are to be checked and verified on site prior to the commencement of any work, making of shop drawings or fabrication of components. Do not scale drawings. Use figured Dimensions.

Amendments	Issue Description	Date
A	100% DD	21/12/2021
B	AFC	14/02/2022
C	ISSUED FOR CONSTRUCTION	23/06/2022

LEGEND

LEVELS

- EXTENT OF WORKS
- EXISTING LEVEL
- PROPOSED LEVEL
- TOP OF WALL LEVEL
- BOTTOM OF WALL LEVEL
- FINISHED FLOOR LEVEL
- FALL DIRECTION
- PROPOSED CONTOURS REFER TO CIVIL ENGINEER

NOTES:

- CONTOURS SHOWN SUPPLIED BY CIVIL ENGINEER FOR REFERENCE ONLY. ADDITIONAL SPOT LEVELS ADDED FOR GREATER DETAIL.
- ALL FOOTPATHS, SOFTFALL AND PLAY MULCH GRADES TO BE IN ACCORDANCE WITH EFGS MAX. AND MIN. GRADES
- FINISH SURFACE LEVEL AT ALL BUILDING ENTRIES. REFER TO ARCHITECT THRESHOLD DETAILS.

DETAILS

- BALLUSTRADE AND HANDRAIL
- BALLUSTRADE
- KERB RAIL

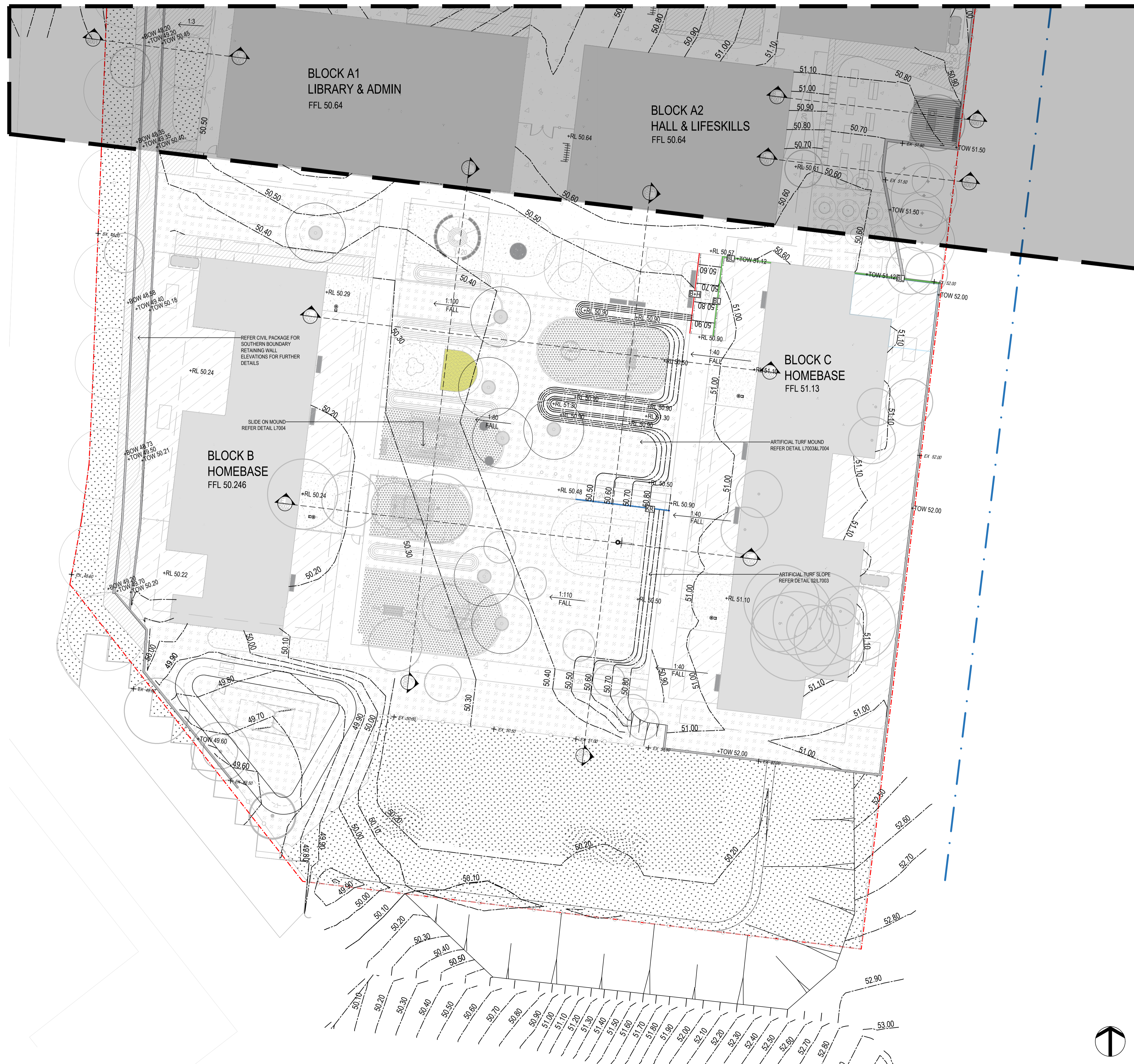

Project Management
SJA
 Level 1, 100 Pitt Street, NSW, 2000
 02 9238 9000

Structural and Civil
HENRY & HYMAS
 Suite 1/1, 120 Pacific Highway, Gosford, NSW, 2252
 02 9477 8400

Building Services
INTELLE BUILDING SERVICES
 Level 2, 355 Kent Street, Sydney, NSW, 2000
 02 9772 3600

BCA Consultant
ABC | ACCREDITED BUILDING CERTIFIERS
 28 AUBURN STREET, WOLLONGONG, NSW, 2500
 02 4228 9300

Contractor
ZAUNER CONSTRUCTION
 Suite 10, 110 Princes Highway, Ulladulla, NSW, 2539
 PO Box 2715
 02 6288 6505

Client
SCHOOL INFRASTRUCTURE NSW
 Level 1, 259 George Street, Sydney, NSW, 2000
 1300 462 651

GROUP GSA
 Group GSA Pty Ltd ABN 76 002 113 779
 Level 7, 80 William St East Sydney NSW
 Australia 2011 www.groupgsa.com
 T +612 9361 4144 F +612 9332 3458
 architecture interior design urban design landscape
 nom architect M. Sheldon 3990

Project Title
BUDAWANG SCHOOL
 15 Croobyar Road, Milton, NSW 2538

Drawing Title
**LANDSCAPE PLAN
 LEVELS AND GRADING 02**

Scale 1:200 @A1

Drawing created (date) 23/06/2022

By LG

Plotted and checked by FR

Verified FR

Approved FR

Drawing No 190941
Issue L3002 C

This drawing is the copyright of Group GSA Pty Ltd and may not be altered, reproduced or transmitted in any form or by any means in part or in whole without the written permission of Group GSA Pty Ltd. All levels and dimensions are to be checked and verified on site prior to the commencement of any work, making of shop drawings or fabrication of components. Do not scale drawings. Use figured Dimensions.

