

FIRE HYDRANT BOOSTER VALVE SET

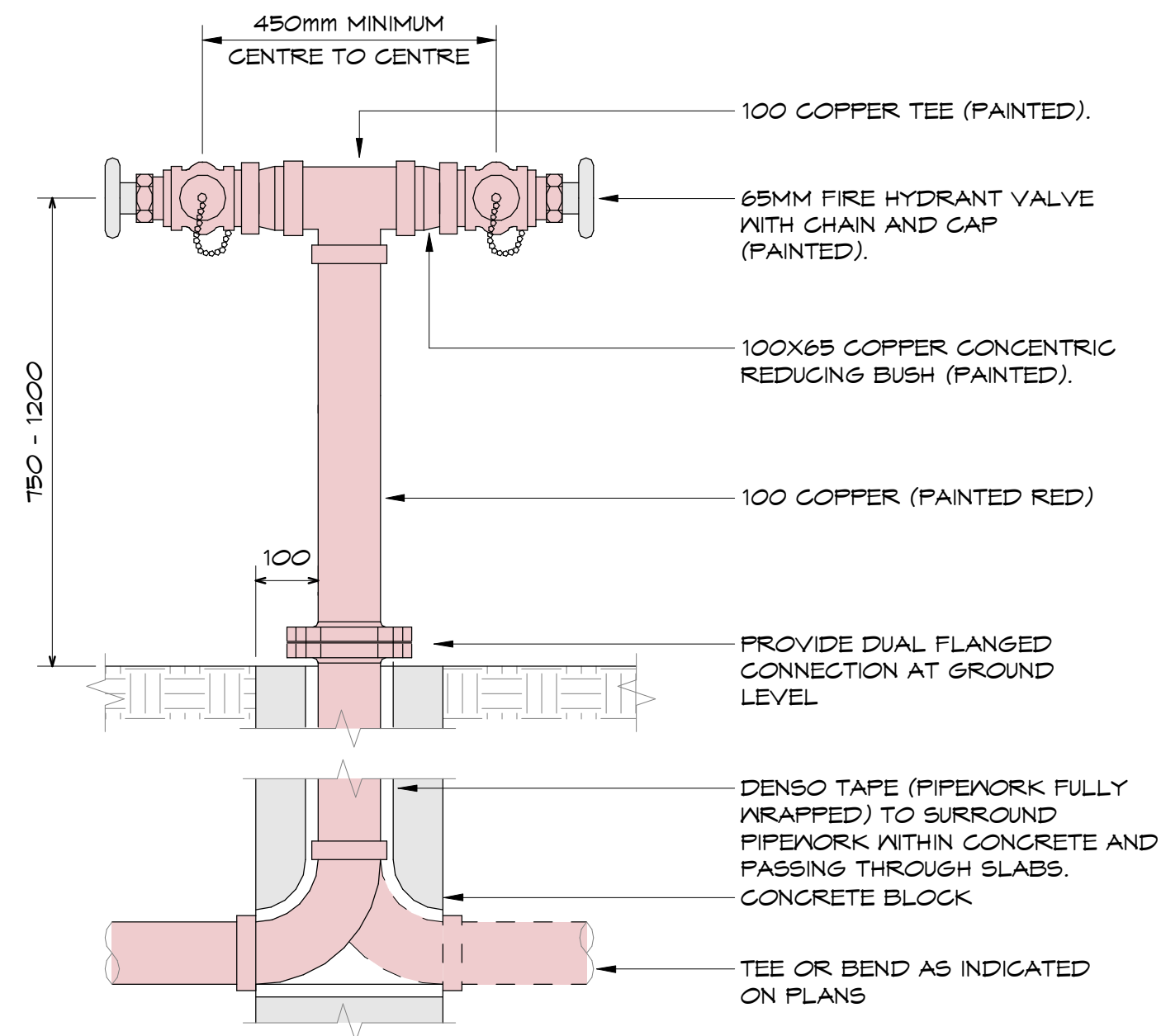

STANDPIPE FIRE HYDRANT (EXTERNAL)

NOTE: HOT & COLD WATER FEED PIPEWORK TO TMV IS NOT TO HAVE ANY BRANCHES WITHIN 1 METRE OF TMV

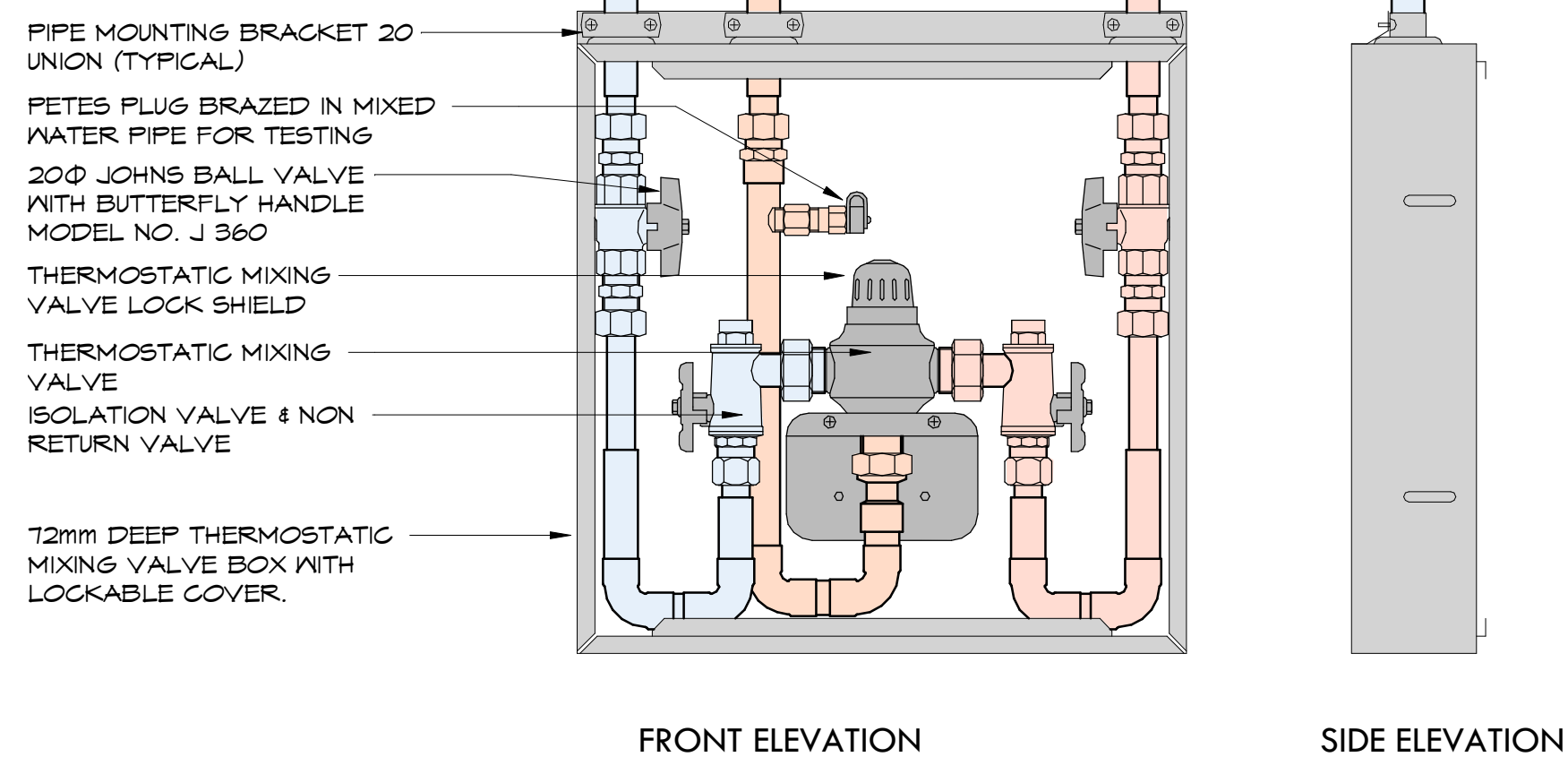

THERMOSTATIC MIXING VALVE ASSEMBLY

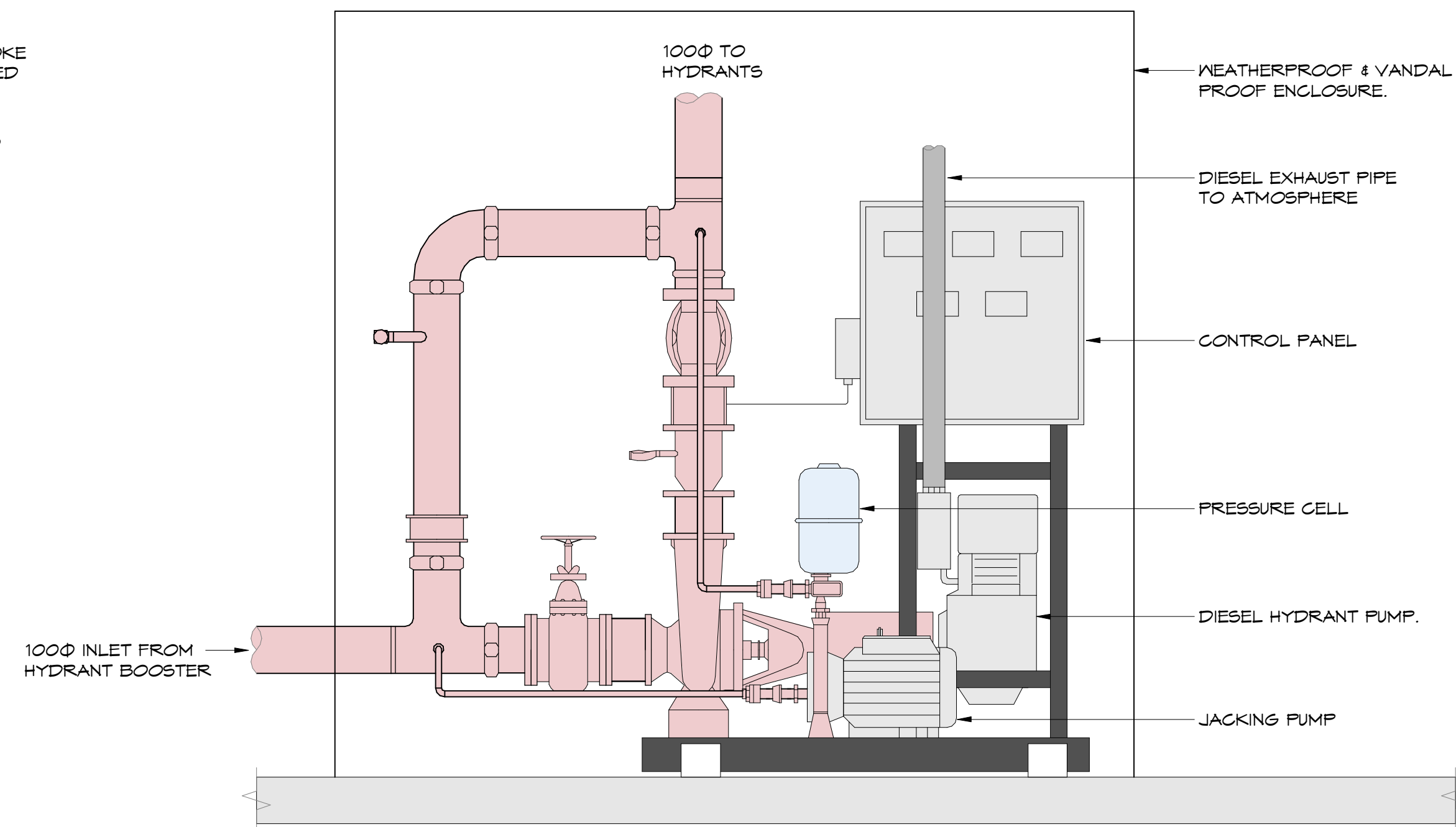

DIESEL HYDRANT PUMP

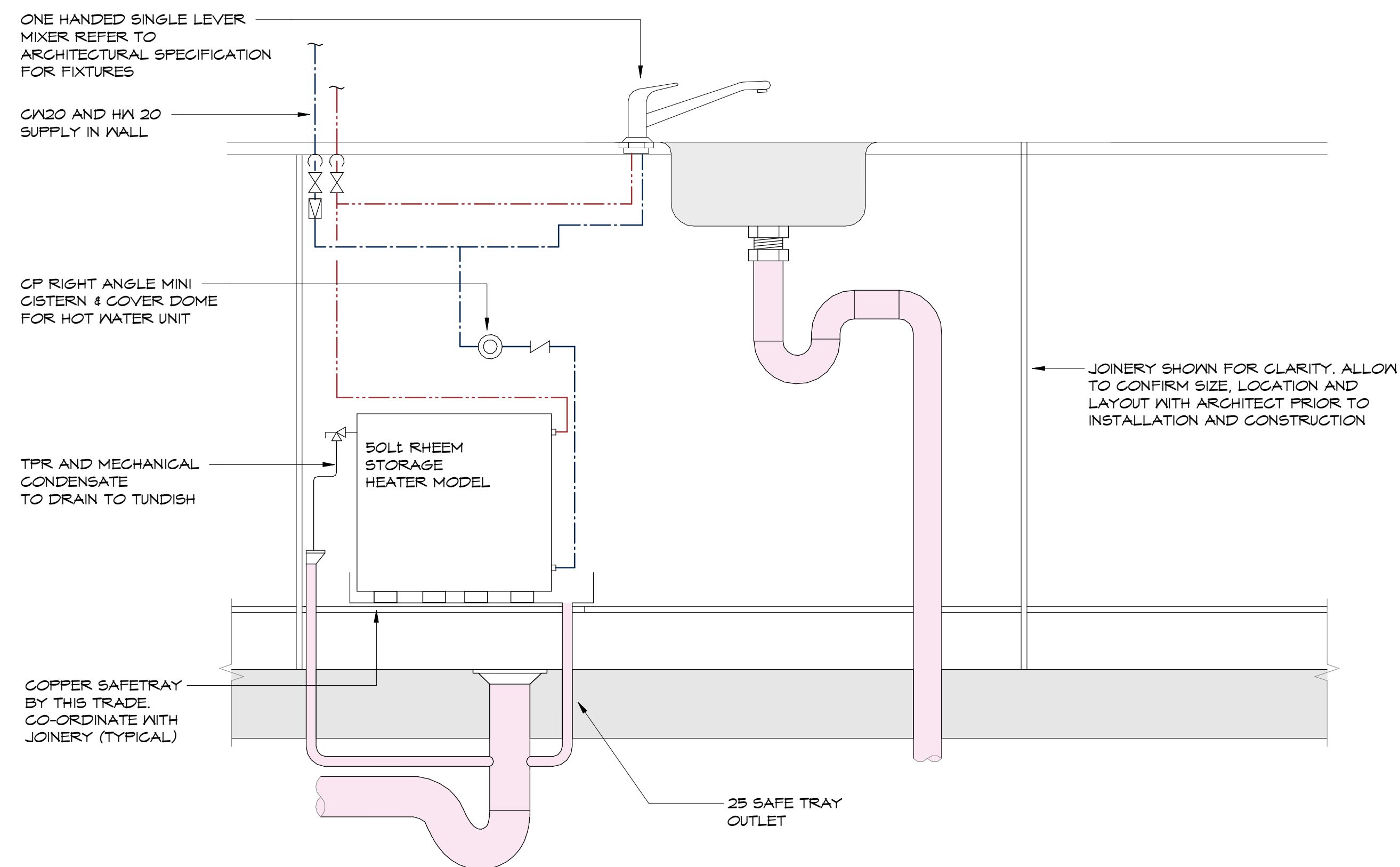

NOTE: DOOR VENTS TO BE INSTALLED IN CUPBOARD

UNDER SINK EQUIPMENT LAYOUT - SINGLE SINK

SCALE 1 : 10

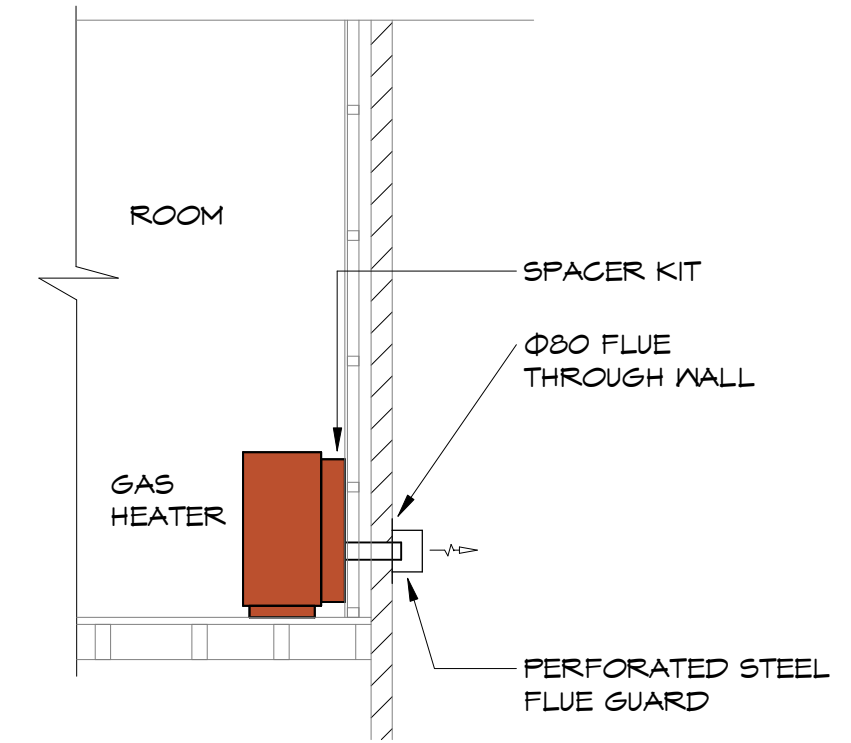

GAS HEATER INSTALLATION

NOT TO BE USED FOR CONSTRUCTION

P R E L I M I N A R Y

1	20.10.17	SAB	FOR SSD SUBMISSION	
AMDT	DATE	BY	DESCRIPTION	

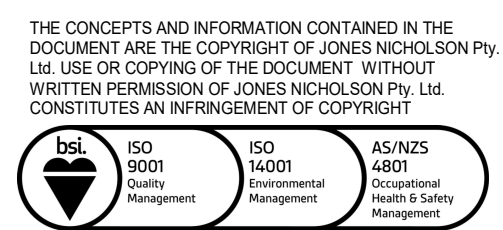

JONES NICHOLSON CONSULTING ENGINEERS

DESIGN : BD
DRAWN : SAB
DATE : OCT 2017
DRG SIZE : A1
SCALE : As indicated
PROJECT MGR : BJ

HYDRAULIC DESIGN
TYPICAL DETAILS

FAIRVALE HIGH SCHOOL
1 THORNEY ROAD FAIRFIELD WEST
NEW 2165
JDH ARCHITECTS

161274
H050 1

CIVIL STRUCTURAL BUILDING SERVICES

WWW.JONESNICHOLSON.COM.AU

ABN: 51 003 316 032