

**SYMBOL LEGEND**

Gas Valve Box	Small Conc. Telecom Pit Cover
Gas Marker Post	Telecom Twin Conc. Pit
Drainage Pit	Sewer Manhole
Light Pole	Sewer Lamp Hole
Power Pole with Light	Water Stop Valve
Power Pole	Water Hydrant
Electricity Pit	Water Tap
Bollard	Water Sprinkler
Sign	Unclass. Water Feature
Unclass. Pit	Water Meter
Flag Pole	

**TREE**

0.10	TRUNK DIAMETER
1 S	TREE SPREAD
1 H	TREE HEIGHT

**LINETYPE LEGEND**

--- (dashed)	FENCELINE
--- (solid)	CONTINUOUS LINE MARKING
--- (dotted)	BROKEN LINE MARKING
--- (thick)	MAJOR CONTOURS
--- (thin)	MINOR CONTOURS
--- (dashed)	DRIVEWAY
--- (dotted)	OH ELECTRICITY
--- (dashed)	DBYD ELECTRICITY
--- (dotted)	DBYD TELSTRA
--- (dashed)	DBYD OPTICAL FIBRE
--- (dotted)	DBYD-G
--- (dashed)	DBYD GAS

**NOTE:**  
THE INFORMATION SHOWN IN GREYSCALE HAS BEEN SUPPLIED TO CARDNO AND NO CHECK HAS BEEN MADE TO THE VERACITY OF THIS INFORMATION.

**NOTE - BOUNDARIES**  
1. ONLY THE EXTERNAL BOUNDARY TO THE HOSPITAL HAS BEEN SHOWN IN THIS DRAWING.  
2. THE BOUNDARIES HAVE BEEN DEFINED USING THE LIMITED SURVEY INFORMATION LOCATED DURING THE DETAIL SURVEY AS WELL AS ADOPTING THE BOUNDARY CORNER AT THE SOUTH-WESTERN CORNER SHOWN IN THE PROVIDED DETAIL PLAN.  
3. THESE BOUNDARIES ARE APPROXIMATE ONLY.  
4. ANY WORKS (DESIGN OR CONSTRUCTION) IN CLOSE PROXIMITY TO THE BOUNDARY WILL REQUIRE A PLAN OF SURVEY BE REGISTERED AT LPI NSW.

**IMPORTANT NOTE:**  
This plan is prepared for HEALTH INFRASTRUCTURE from a combination of field survey and existing records for the purpose of designing new constructions on the land and should not be used for any other purpose.  
The title boundaries shown hereon were not marked by the author at the time of survey and have been determined by plan dimensions only and not by field measurement.

A services search of the area surveyed above has not been undertaken. Visible services shown hereon have been located where possible by field survey. Prior to any demolition, excavation or construction on the site, the relevant authority should be contacted for possible location of further underground services and detailed locations of all services.  
This note is an integral part of this plan.

REVISION	DATE	DESCRIPTION	CCAD REF	APPROVED
01	11.12.2015	EXTRA DETAIL AND CONTOURS ADDED	117806AH	MC
00	7.12.2015	ORIGINAL ISSUE	117806AF	MC

SCALE: HORIZ. 1:100	VERT.
CONTOUR INTERVAL: MAJOR 0.0	MINOR 0.0
HORIZONTAL ORIGIN	
COORD. SYSTEM: MGA	MARK ADOPTED: PM 8838 (ZONE 55)
COORDINATES: E 748 515 204 N 6 151 573.634	
VERTICAL DATUM: BM ADOPTED: PM 8838	
RL: 651.720	

**Cardno**  
Shaping the Future

23-25 Frederick Street  
PO Box 175  
Rockdale NSW 2216  
t: (02) 9597 9700  
f: (02) 9599 2146  
e: surveynsw@cardno.com.au w: www.cardno.com.au

SURVEYED: J.E./R.S.	DRAWN: I.T.	CHECKED: J.E./R.S.	PASSED: M.C.
---------------------	-------------	--------------------	--------------

PROJECT: GOULBURN HOSPITAL

**PLAN SHOWING LEVELS, DETAILS AND CONTOURS**

CLIENT: HEALTH INFRASTRUCTURE

SHEET 9 OF 21	
DRAWING NUMBER	REV
117806501	01

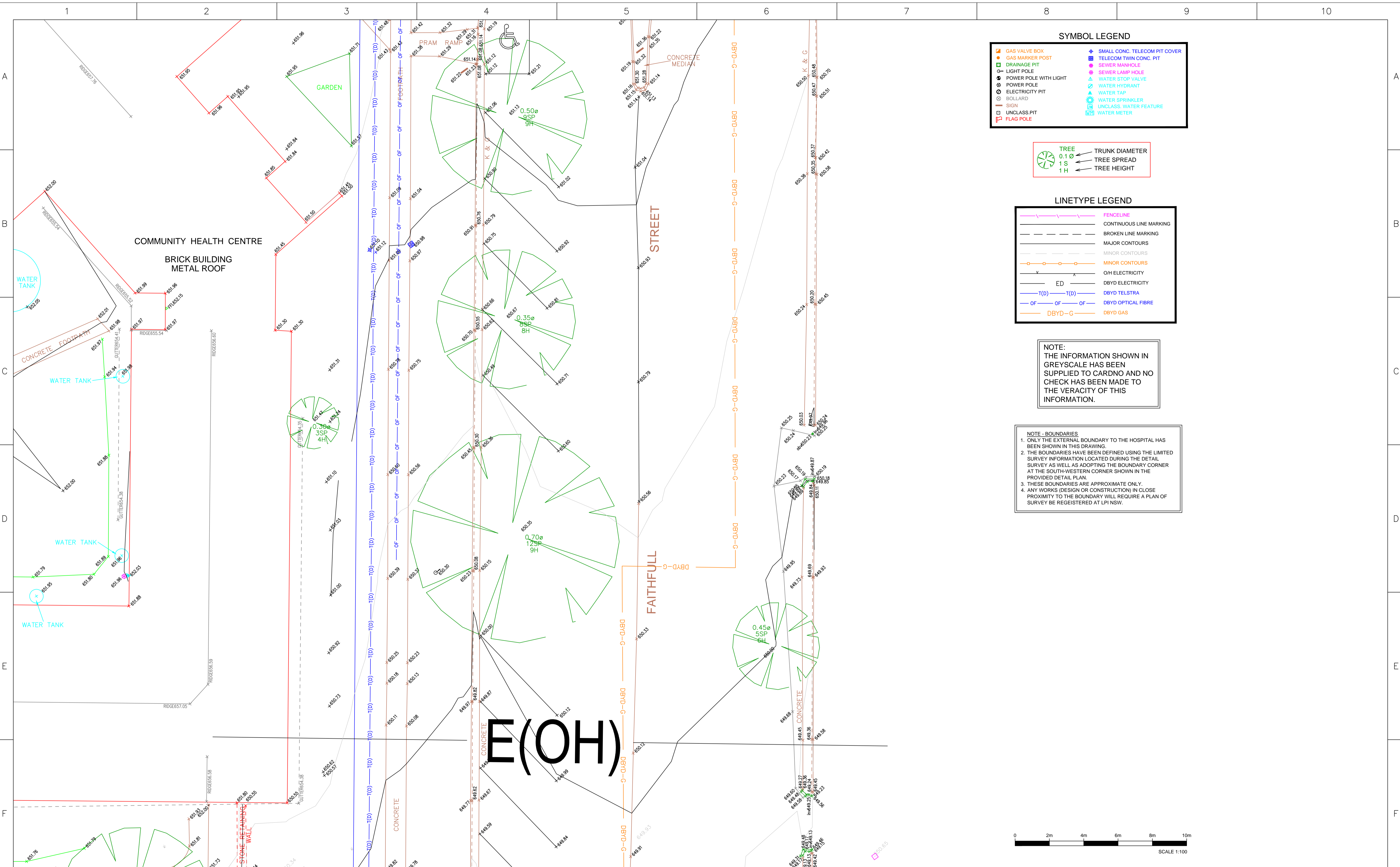

**SYMBOL LEGEND**

	GAS VALVE BOX		SMALL CONC. TELECOM PIT COVER
	GAS MARKER POST		TELECOM TWIN CONC. PIT
	DRAINAGE PIT		SEWER MANHOLE
	LIGHT POLE		SEWER LAMP HOLE
	POWER POLE WITH LIGHT		WATER STOP VALVE
	POWER POLE		WATER HYDRANT
	ELECTRICITY PIT		WATER TAP
	BOLLARD		WATER SPRINKLER
	SIGN		UNCLASS. WATER FEATURE
	UNCLASS. PIT		WATER METER
	FLAG POLE		

**TREE LEGEND**

	TREE	TRUNK DIAMETER
0.1 Ø		TREE SPREAD
1 S		TREE HEIGHT
1 H		

**LINETYPE LEGEND**

	FENCELINE
	CONTINUOUS LINE MARKING
	BROKEN LINE MARKING
	MAJOR CONTOURS
	MINOR CONTOURS
	OH ELECTRICITY
	DBYD ELECTRICITY
	DBYD TELSTRA
	DBYD OPTICAL FIBRE
	DBYD GAS

**NOTE:**  
THE INFORMATION SHOWN IN GREYSCALE HAS BEEN SUPPLIED TO CARDNO AND NO CHECK HAS BEEN MADE TO THE VERACITY OF THIS INFORMATION.

**NOTE - BOUNDARIES**  
1. ONLY THE EXTERNAL BOUNDARY TO THE HOSPITAL HAS BEEN SHOWN IN THIS DRAWING.  
2. THE BOUNDARIES HAVE BEEN DEFINED USING THE LIMITED SURVEY INFORMATION LOCATED DURING THE DETAIL SURVEY AS WELL AS ADOPTING THE BOUNDARY CORNER AT THE SOUTH-WESTERN CORNER SHOWN IN THE PROVIDED DETAIL PLAN.  
3. THESE BOUNDARIES ARE APPROXIMATE ONLY.  
4. ANY WORKS (DESIGN OR CONSTRUCTION) IN CLOSE PROXIMITY TO THE BOUNDARY WILL REQUIRE A PLAN OF SURVEY BE REGISTERED AT LPI NSW.

**IMPORTANT NOTE:**  
This plan is prepared for HEALTH INFRASTRUCTURE from a combination of field survey and existing records for the purpose of designing new constructions on the land and should not be used for any other purpose.  
The title boundaries shown hereon were not marked by the author at the time of survey and have been determined by plan dimensions only and not by field measurement.

A services search of the area surveyed above has not been undertaken. Visible services shown hereon have been located where possible by field survey. Prior to any demolition, excavation or construction on the site, the relevant authority should be contacted for possible location of further underground services and detailed locations of all services.  
This note is an integral part of this plan.

REVISION	DATE	DESCRIPTION	CCAD REF	APPROVED
01	11.12.2015	EXTRA DETAIL AND CONTOURS ADDED	117806AH	MC
00	7.12.2015	ORIGINAL ISSUE	117806AF	MC

SCALE: HORIZ. 1:100	VERT.	A1
CONTOUR INTERVAL: MAJOR 0.0	MINOR 0.0	
HORIZONTAL ORIGIN		
COORD. SYSTEM	MARK ADOPTED: PM 8838 (ZONE 55)	
MGA	COORDINATES: E 748 515 204 N 6 151 573.634	
VERTICAL DATUM		
DATUM: AHD	BM ADOPTED: PM 8838 RL: 651.720	

**Cardno**  
Shaping the Future

23-25 Frederick Street  
PO Box 175  
Rockdale NSW 2216  
t: (02) 9597 9700  
f: (02) 9599 2146  
e: surveynsw@cardno.com.au w: www.cardno.com.au

SURVEYED J.E./R.S.	DRAWN I.T.	CHECKED J.E./R.S.	PASSED M.C.
-----------------------	---------------	----------------------	----------------

PROJECT: GOULBURN HOSPITAL

**PLAN SHOWING LEVELS, DETAILS AND CONTOURS**

CLIENT: HEALTH INFRASTRUCTURE

SHEET 10 OF 21	
DRAWING NUMBER	REV
<b>117806501</b>	<b>01</b>

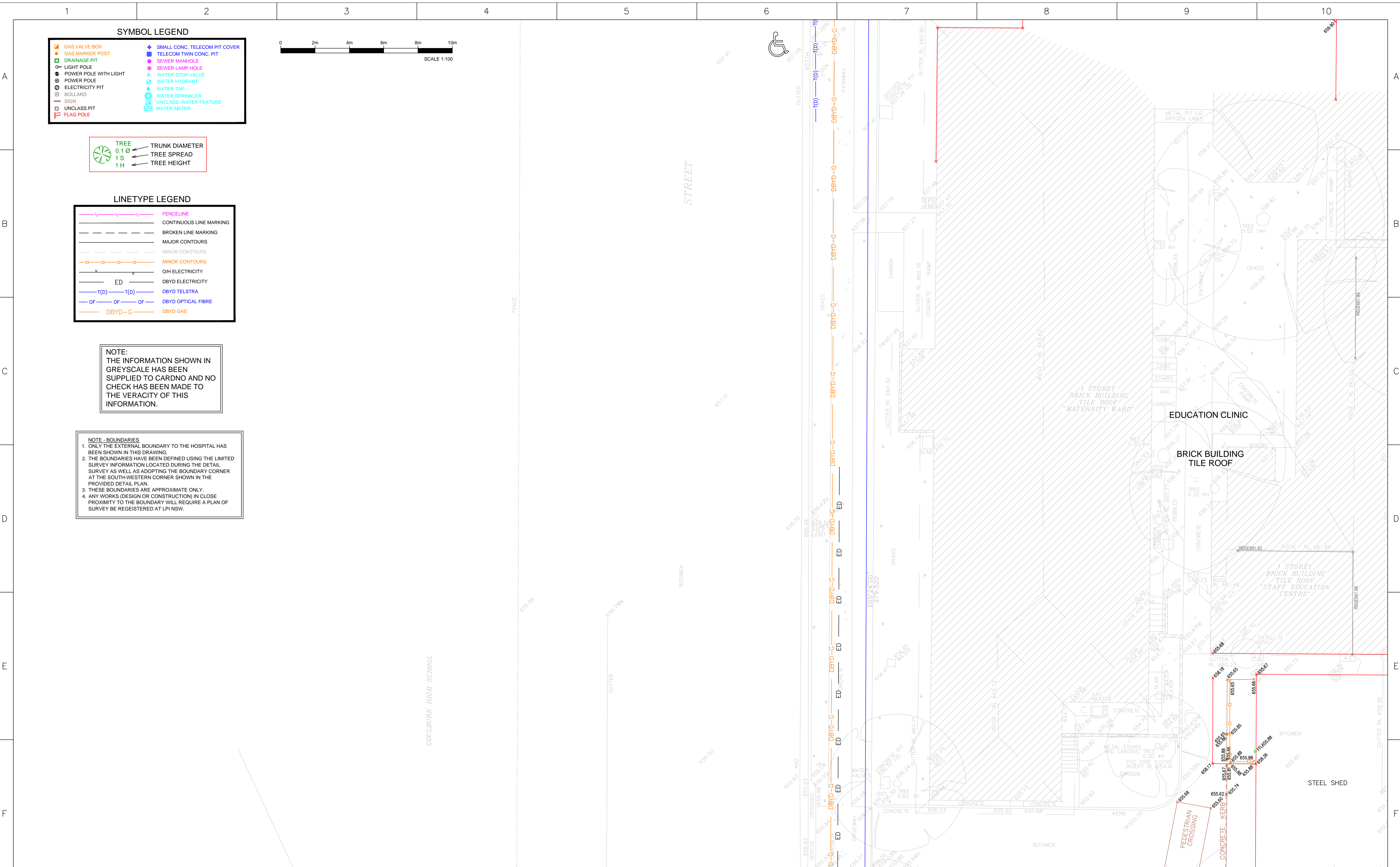

**SYMBOL LEGEND**

**TREE**

	TRUNK DIAMETER
0.1 Ø	TREE SPREAD
1 S	TREE HEIGHT
1 H	

**LINETYPE LEGEND**

	FENCELINE
	CONTINUOUS LINE MARKING
	BROKEN LINE MARKING
	MAJOR CONTOURS
	MINOR CONTOURS
	OH ELECTRICITY
	DBYD ELECTRICITY
	DBYD TELSTRA
	DBYD OPTICAL FIBRE
	DBYD GAS

**NOTE:**  
THE INFORMATION SHOWN IN GREYSCALE HAS BEEN SUPPLIED TO CARDNO AND NO CHECK HAS BEEN MADE TO THE VERACITY OF THIS INFORMATION.

**NOTE - BOUNDARIES**

- ONLY THE EXTERNAL BOUNDARY TO THE HOSPITAL HAS BEEN SHOWN IN THIS DRAWING.
- THE BOUNDARIES HAVE BEEN DEFINED USING THE LIMITED SURVEY INFORMATION LOCATED DURING THE DETAIL SURVEY AS WELL AS ADOPTING THE BOUNDARY CORNER AT THE SOUTH-WESTERN CORNER SHOWN IN THE PROVIDED DETAIL PLAN.
- THESE BOUNDARIES ARE APPROXIMATE ONLY.
- ANY WORKS (DESIGN OR CONSTRUCTION) IN CLOSE PROXIMITY TO THE BOUNDARY WILL REQUIRE A PLAN OF SURVEY BE REGISTERED AT LPI NSW.

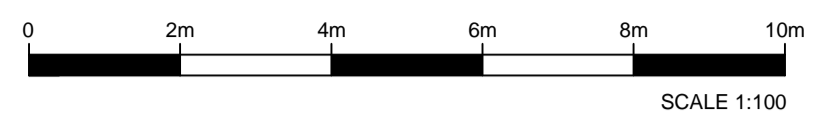

**IMPORTANT NOTE:**  
This plan is prepared for HEALTH INFRASTRUCTURE from a combination of field survey and existing records for the purpose of designing new constructions on the land and should not be used for any other purpose.  
The title boundaries shown hereon were not marked by the author at the time of survey and have been determined by plan dimensions only and not by field measurement.

A services search of the area surveyed above has not been undertaken. Visible services shown hereon have been located where possible by field survey. Prior to any demolition, excavation or construction on the site, the relevant authority should be contacted for possible location of further underground services and detailed locations of all services.  
This note is an integral part of this plan.

REVISION	DATE	DESCRIPTION	CCAD REF	APPROVED
01	11.12.2015	EXTRA DETAIL AND CONTOURS ADDED	117806AH	MC
00	7.12.2015	ORIGINAL ISSUE	117806AF	MC

SCALE: HORIZ. 1:100	VERT.
CONTOUR INTERVAL: MAJOR 0.0	MINOR 0.0
HORIZONTAL ORIGIN	
COORD. SYSTEM: MGA	MARK ADOPTED: PM 8838 (ZONE 55)
COORDINATES: E 748 515.204 N 6 151 573.634	
VERTICAL DATUM	
DATUM: AHD	BM ADOPTED: PM 8838 RL: 651.720

**Cardno**  
Shaping the Future

23-25 Frederick Street  
PO Box 175  
Rockdale NSW 2216  
t: (02) 9597 9700  
f: (02) 9599 2146  
e: surveynsw@cardno.com.au w: www.cardno.com.au

SURVEYED J.E./R.S.	DRAWN I.T.	CHECKED J.E./R.S.	PASSED M.C.
--------------------	------------	-------------------	-------------

PROJECT: GOULBURN HOSPITAL

**PLAN SHOWING LEVELS, DETAILS AND CONTOURS**

CLIENT: HEALTH INFRASTRUCTURE

SHEET 11 OF 21	
DRAWING NUMBER	REV
<b>117806501</b>	<b>01</b>

**SYMBOL LEGEND**

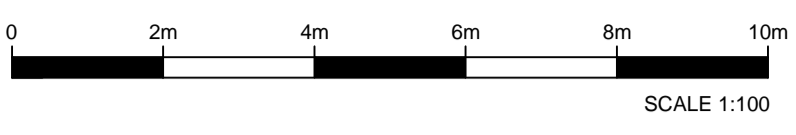
**LINETYPE LEGEND**

	FENCELINE
	CONTINUOUS LINE MARKING
	BROKEN LINE MARKING
	MAJOR CONTOURS
	MINOR CONTOURS
	OH ELECTRICITY
	DBYD ELECTRICITY
	DBYD TELSTRA
	DBYD OPTICAL FIBRE
	DBYD GAS

**NOTE:**  
THE INFORMATION SHOWN IN GREYSCALE HAS BEEN SUPPLIED TO CARDNO AND NO CHECK HAS BEEN MADE TO THE VERACITY OF THIS INFORMATION.

**NOTE - BOUNDARIES**  
1. ONLY THE EXTERNAL BOUNDARY TO THE HOSPITAL HAS BEEN SHOWN IN THIS DRAWING.  
2. THE BOUNDARIES HAVE BEEN DEFINED USING THE LIMITED SURVEY INFORMATION LOCATED DURING THE DETAIL SURVEY AS WELL AS ADOPTING THE BOUNDARY CORNER AT THE SOUTH-WESTERN CORNER SHOWN IN THE PROVIDED DETAIL PLAN.  
3. THESE BOUNDARIES ARE APPROXIMATE ONLY.  
4. ANY WORKS (DESIGN OR CONSTRUCTION) IN CLOSE PROXIMITY TO THE BOUNDARY WILL REQUIRE A PLAN OF SURVEY BE REREGISTERED AT LPI NSW.

**TREE**

	TRUNK DIAMETER
0.1 Ø	TRUNK DIAMETER
1 S	TREE SPREAD
1 H	TREE HEIGHT

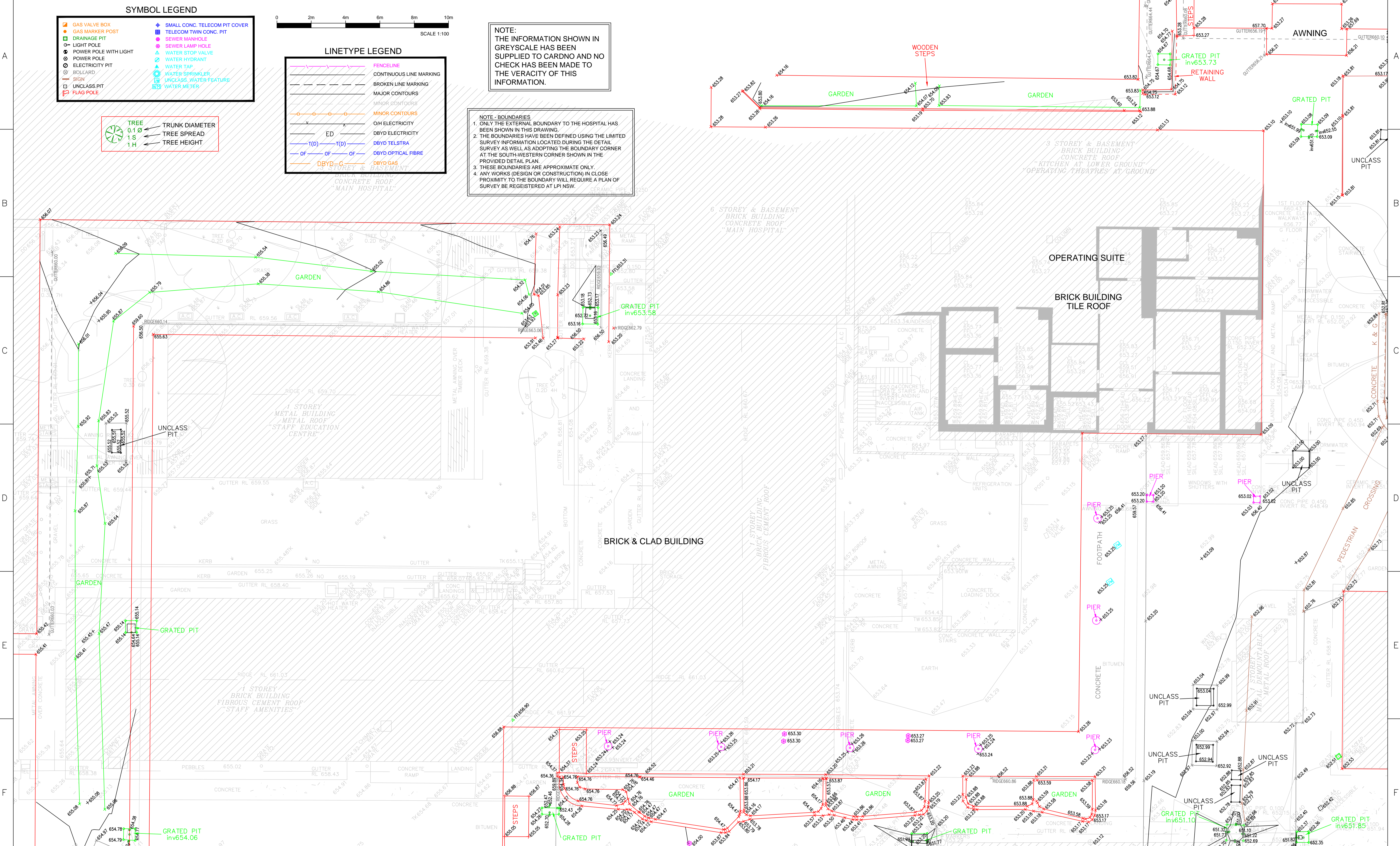

**IMPORTANT NOTE:**  
This plan is prepared for HEALTH INFRASTRUCTURE from a combination of field survey and existing records for the purpose of designing new constructions on the land and should not be used for any other purpose.  
The title boundaries shown hereon were not marked by the author at the time of survey and have been determined by plan dimensions only and not by field measurement.

A services search of the area surveyed above has not been undertaken. Visible services shown hereon have been located where possible by field survey. Prior to any demolition, excavation or construction on the site, the relevant authority should be contacted for possible location of further underground services and detailed locations of all services.  
This note is an integral part of this plan.

01	11.12.2015	EXTRA DETAIL AND CONTOURS ADDED	117806AH	MC
00	7.12.2015	ORIGINAL ISSUE	117806AF	MC
REVISION	DATE	DESCRIPTION	CCAD REF	APPROVED

SCALE: HORIZ. 1:100	VERT.	A1
CONTOUR INTERVAL: MAJOR 0.0	MINOR 0.0	
HORIZONTAL ORIGIN		
COORD. SYSTEM	MARK ADOPTED: PM 8838 (ZONE 55)	
MGA	COORDINATES: E 748 515 204 N 6 151 573.634	
VERTICAL DATUM		
DATUM: AHD	BM ADOPTED: PM 8838 RL: 651.720	

**Cardno**  
Shaping the Future

23-25 Frederick Street  
PO Box 175  
Rockdale NSW 2216  
t: (02) 9597 9700  
f: (02) 9599 2146  
e: surveynsw@cardno.com.au w: www.cardno.com.au

PROJECT: GOULBURN HOSPITAL

**PLAN SHOWING LEVELS, DETAILS AND CONTOURS**

SHEET 12 OF 21

DRAWING NUMBER	REV
117806501	01

CLIENT: HEALTH INFRASTRUCTURE

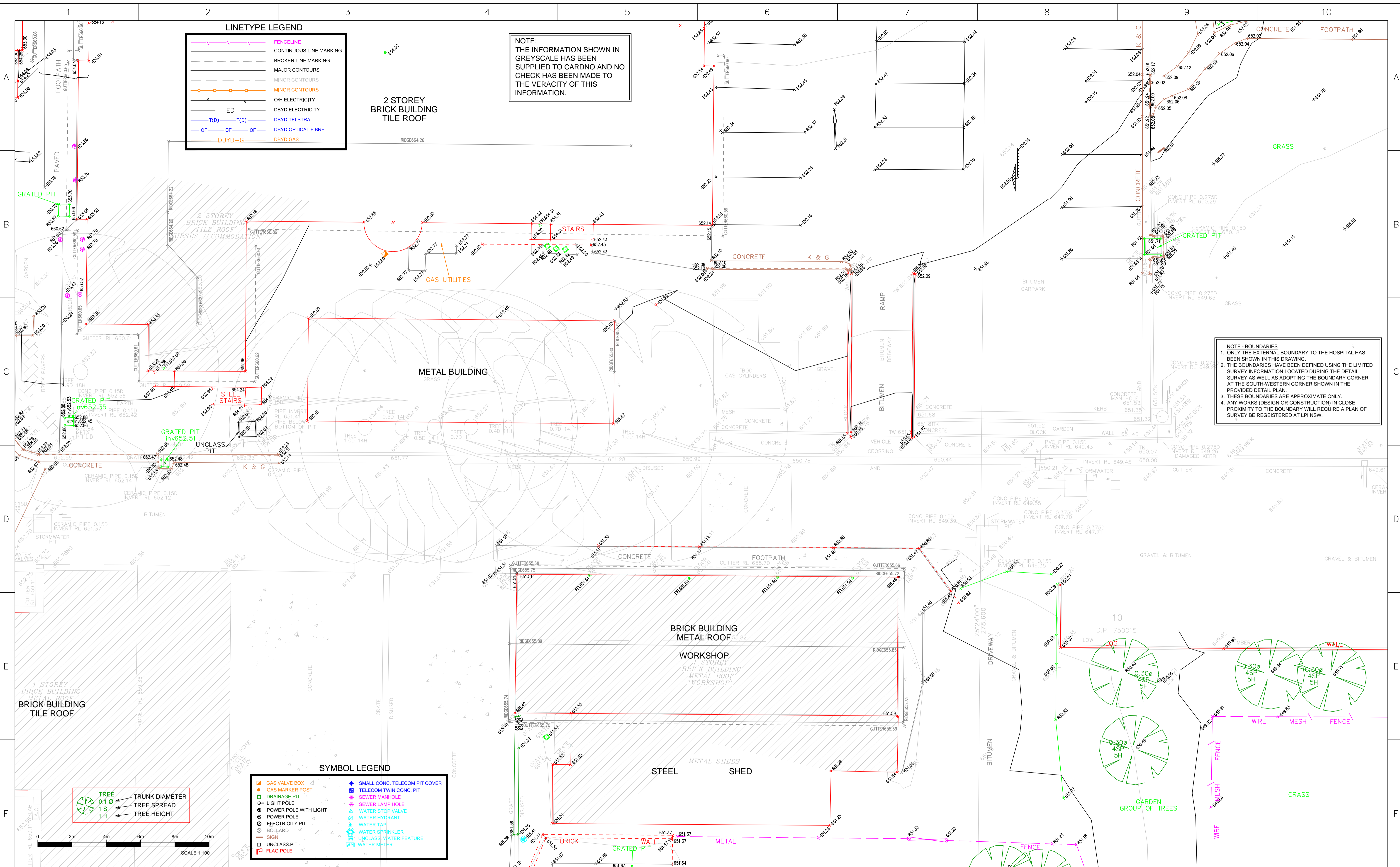

**LINETYPE LEGEND**

	FENCELINE
	CONTINUOUS LINE MARKING
	BROKEN LINE MARKING
	MAJOR CONTOURS
	MINOR CONTOURS
	MINOR CONTOURS
	O/H ELECTRICITY
	DBYD ELECTRICITY
	T(D) DBYD TELSTRA
	OF DBYD OPTICAL FIBRE
	DBYD-G DBYD GAS

**NOTE:**  
THE INFORMATION SHOWN IN GREYSCALE HAS BEEN SUPPLIED TO CARDNO AND NO CHECK HAS BEEN MADE TO THE VERACITY OF THIS INFORMATION.

**NOTE - BOUNDARIES**  
1. ONLY THE EXTERNAL BOUNDARY TO THE HOSPITAL HAS BEEN SHOWN IN THIS DRAWING.  
2. THE BOUNDARIES HAVE BEEN DEFINED USING THE LIMITED SURVEY INFORMATION LOCATED DURING THE DETAIL SURVEY AS WELL AS ADOPTING THE BOUNDARY CORNER AT THE SOUTH-WESTERN CORNER SHOWN IN THE PROVIDED DETAIL PLAN.  
3. THESE BOUNDARIES ARE APPROXIMATE ONLY.  
4. ANY WORKS (DESIGN OR CONSTRUCTION) IN CLOSE PROXIMITY TO THE BOUNDARY WILL REQUIRE A PLAN OF SURVEY BE REGISTERED AT LPI NSW.

**SYMBOL LEGEND**

	GAS VALVE BOX		SMALL CONC. TELECOM PIT COVER
	GAS MARKER POST		TELECOM TWIN CONC. PIT
	DRAINAGE PIT		SEWER MANHOLE
	LIGHT POLE		WATER STOP VALVE
	POWER POLE WITH LIGHT		WATER HYDRANT
	POWER POLE		WATER TAP
	ELECTRICITY PIT		WATER SPRINKLER
	BOLLARD		UNCLASS. WATER FEATURE
	SIGN		WATER METER
	UNCLASS. PIT		
	FLAG POLE		

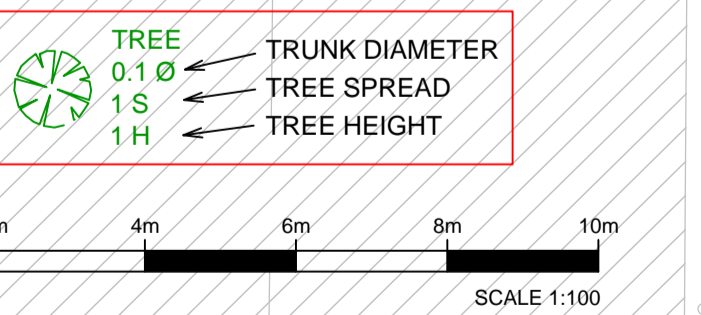

**IMPORTANT NOTE:**  
This plan is prepared for HEALTH INFRASTRUCTURE from a combination of field survey and existing records for the purpose of designing new constructions on the land and should not be used for any other purpose.  
The title boundaries shown hereon were not marked by the author at the time of survey and have been determined by plan dimensions only and not by field measurement.

A services search of the area surveyed above has not been undertaken. Visible services shown hereon have been located where possible by field survey. Prior to any demolition, excavation or construction on the site, the relevant authority should be contacted for possible location of further underground services and detailed locations of all services.  
This note is an integral part of this plan.

REVISION	DATE	DESCRIPTION	CCAD REF	APPROVED
01	11.12.2015	EXTRA DETAIL AND CONTOURS ADDED	117806AH	MC
00	7.12.2015	ORIGINAL ISSUE	117806AF	MC

SCALE: HORIZ. 1:100	VERT.
CONTOUR INTERVAL: MAJOR 0.0	MINOR 0.0
HORIZONTAL ORIGIN	
COORD. SYSTEM	MARK ADOPTED: PM 8838 (ZONE 55)
MGA	COORDINATES: E 748 515 204 N 6 151 573.634
VERTICAL DATUM	
DATUM: AHD	BM ADOPTED: PM 8838 RL: 651.720

**Cardno**  
Shaping the Future

23-25 Frederick Street  
PO Box 175  
Rockdale NSW 2216  
t: (02) 9597 9700  
f: (02) 9599 2146  
e: surveynsw@cardno.com.au w: www.cardno.com.au

SURVEYED J.E./R.S.	DRAWN I.T.	CHECKED J.E./R.S.	PASSED M.C.
-----------------------	---------------	----------------------	----------------

PROJECT: GOULBURN HOSPITAL

**PLAN SHOWING LEVELS, DETAILS AND CONTOURS**

SHEET 13 OF 21

DRAWING NUMBER 117806501 REV 01

CLIENT: HEALTH INFRASTRUCTURE

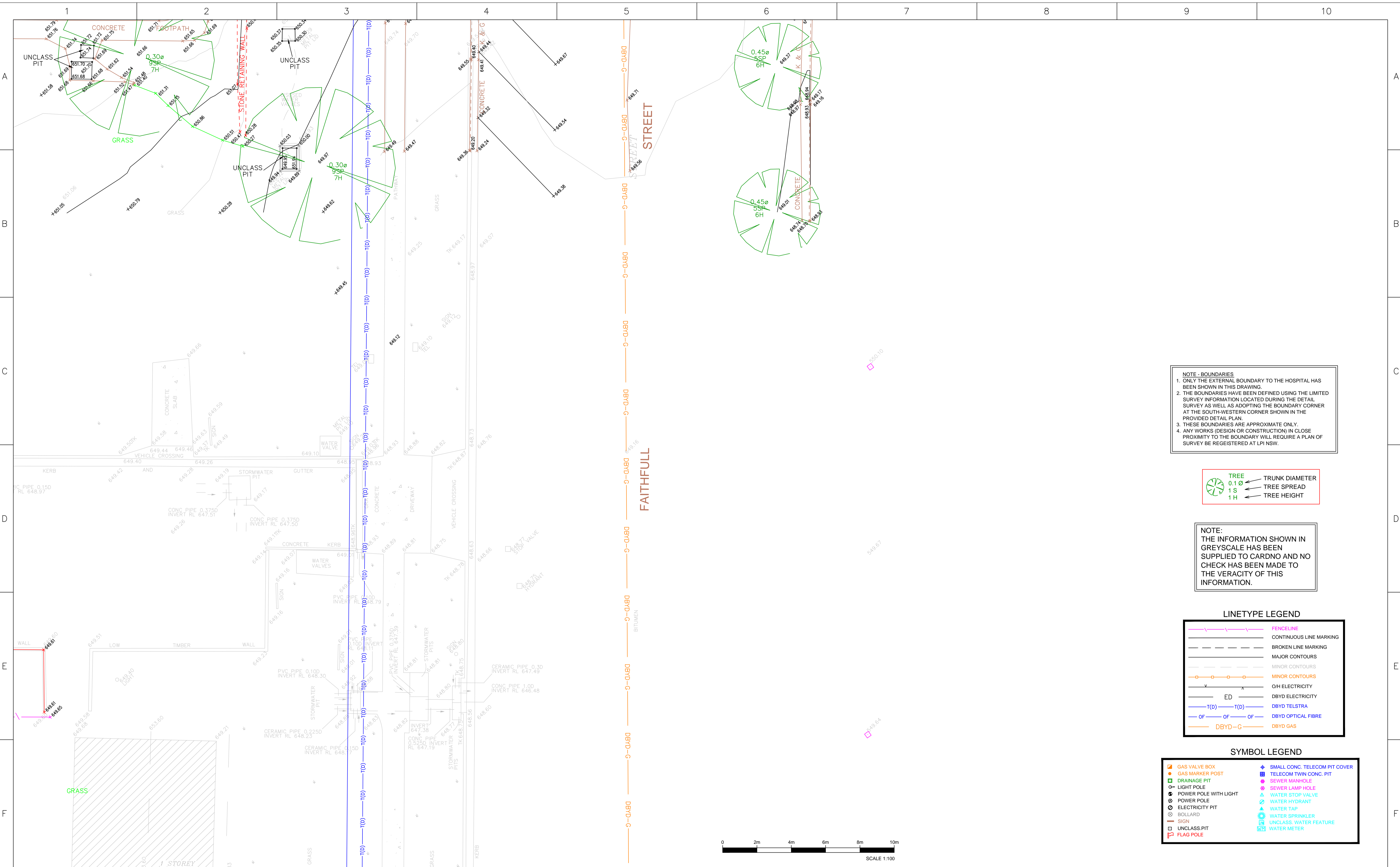

**NOTE - BOUNDARIES**

- ONLY THE EXTERNAL BOUNDARY TO THE HOSPITAL HAS BEEN SHOWN IN THIS DRAWING.
- THE BOUNDARIES HAVE BEEN DEFINED USING THE LIMITED SURVEY INFORMATION LOCATED DURING THE DETAIL SURVEY AS WELL AS ADOPTING THE BOUNDARY CORNER AT THE SOUTH-WESTERN CORNER SHOWN IN THE PROVIDED DETAIL PLAN.
- THESE BOUNDARIES ARE APPROXIMATE ONLY.
- ANY WORKS (DESIGN OR CONSTRUCTION) IN CLOSE PROXIMITY TO THE BOUNDARY WILL REQUIRE A PLAN OF SURVEY BE REGISTERED AT LPI NSW.

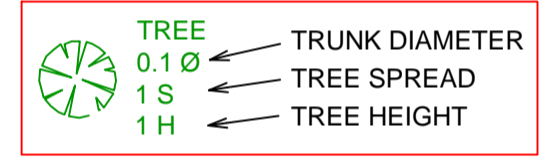

**NOTE:**  
THE INFORMATION SHOWN IN GREYSCALE HAS BEEN SUPPLIED TO CARDNO AND NO CHECK HAS BEEN MADE TO THE VERACITY OF THIS INFORMATION.

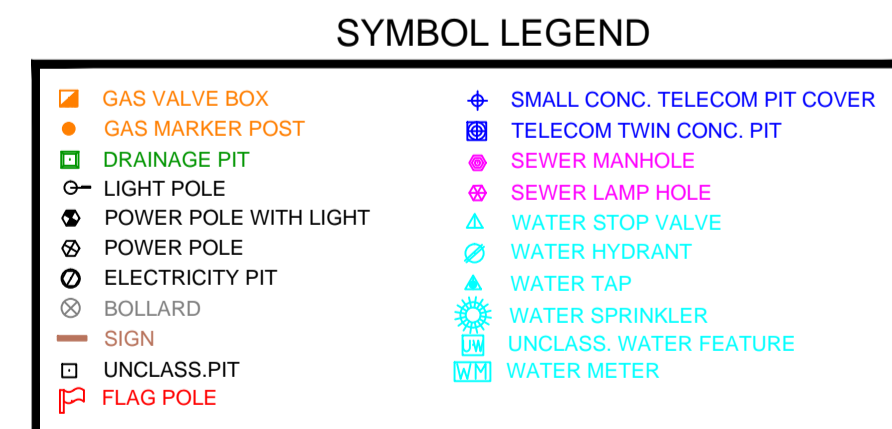
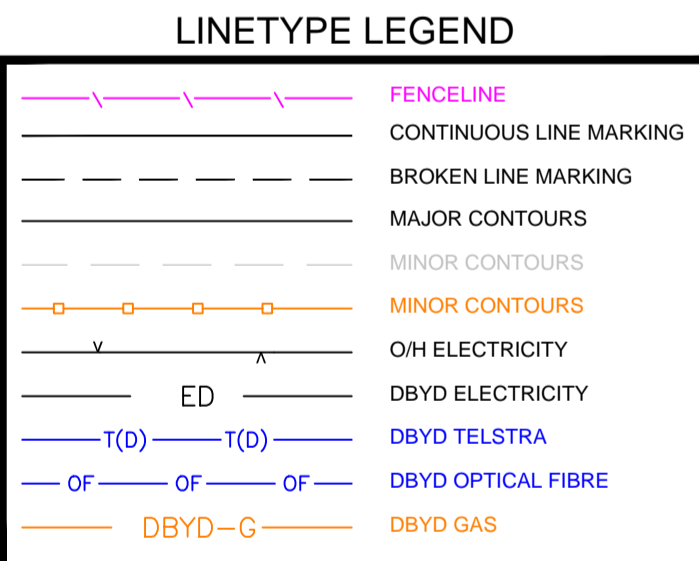

**IMPORTANT NOTE:**  
This plan is prepared for HEALTH INFRASTRUCTURE from a combination of field survey and existing records for the purpose of designing new constructions on the land and should not be used for any other purpose.  
The title boundaries shown hereon were not marked by the author at the time of survey and have been determined by plan dimensions only and not by field measurement.

A services search of the area surveyed above has not been undertaken. Visible services shown hereon have been located where possible by field survey. Prior to any demolition, excavation or construction on the site, the relevant authority should be contacted for possible location of further underground services and detailed locations of all services.  
This note is an integral part of this plan.

REVISION	DATE	DESCRIPTION	CCAD REF	APPROVED
01	11.12.2015	EXTRA DETAIL AND CONTOURS ADDED	117806AH	MC
00	7.12.2015	ORIGINAL ISSUE	117806AF	MC

SCALE: HORIZ. 1:100	VERT.	A1
CONTOUR INTERVAL: MAJOR 0.0	MINOR 0.0	
HORIZONTAL ORIGIN		
COORD. SYSTEM	MARK ADOPTED: PM 8838 (ZONE 55)	
MGA	COORDINATES: E 748 515.204 N 6 151 573.634	
VERTICAL DATUM		
DATUM: AHD	BM ADOPTED: PM 8838 RL: 651.720	

23-25 Frederick Street  
PO Box 175  
Rockdale NSW 2216  
t: (02) 9597 9700  
f: (02) 9599 2146  
e: surveynsw@cardno.com.au w: www.cardno.com.au

SURVEYED J.E./R.S.	DRAWN I.T.	CHECKED J.E./R.S.	PASSED M.C.
-----------------------	---------------	----------------------	----------------

PROJECT: GOULBURN HOSPITAL

**PLAN SHOWING LEVELS, DETAILS AND CONTOURS**

CLIENT: HEALTH INFRASTRUCTURE

SHEET 14 OF 21

DRAWING NUMBER	REV
117806501	01

**SYMBOL LEGEND**



**LINETYPE LEGEND**

	FENCELINE
	CONTINUOUS LINE MARKING
	BROKEN LINE MARKING
	MAJOR CONTOURS
	MINOR CONTOURS
	OH ELECTRICITY
	DBYD ELECTRICITY
	DBYD TELSTRA
	DBYD OPTICAL FIBRE
	DBYD GAS

**TREE**

	TRUNK DIAMETER
	TREE SPREAD
	TREE HEIGHT

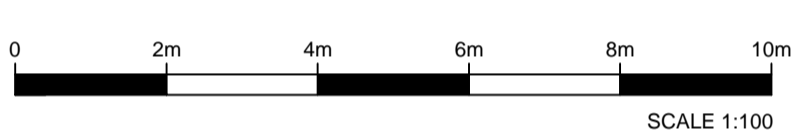
**NOTE:**  
THE INFORMATION SHOWN IN GREYSCALE HAS BEEN SUPPLIED TO CARDNO AND NO CHECK HAS BEEN MADE TO THE VERACITY OF THIS INFORMATION.



**NOTE - BOUNDARIES**

- ONLY THE EXTERNAL BOUNDARY TO THE HOSPITAL HAS BEEN SHOWN IN THIS DRAWING.
- THE BOUNDARIES HAVE BEEN DEFINED USING THE LIMITED SURVEY INFORMATION LOCATED DURING THE DETAIL SURVEY AS WELL AS ADOPTING THE BOUNDARY CORNER AT THE SOUTH-WESTERN CORNER SHOWN IN THE PROVIDED DETAIL PLAN.
- THESE BOUNDARIES ARE APPROXIMATE ONLY.
- ANY WORKS (DESIGN OR CONSTRUCTION) IN CLOSE PROXIMITY TO THE BOUNDARY WILL REQUIRE A PLAN OF SURVEY BE REREGISTERED AT LPI NSW.

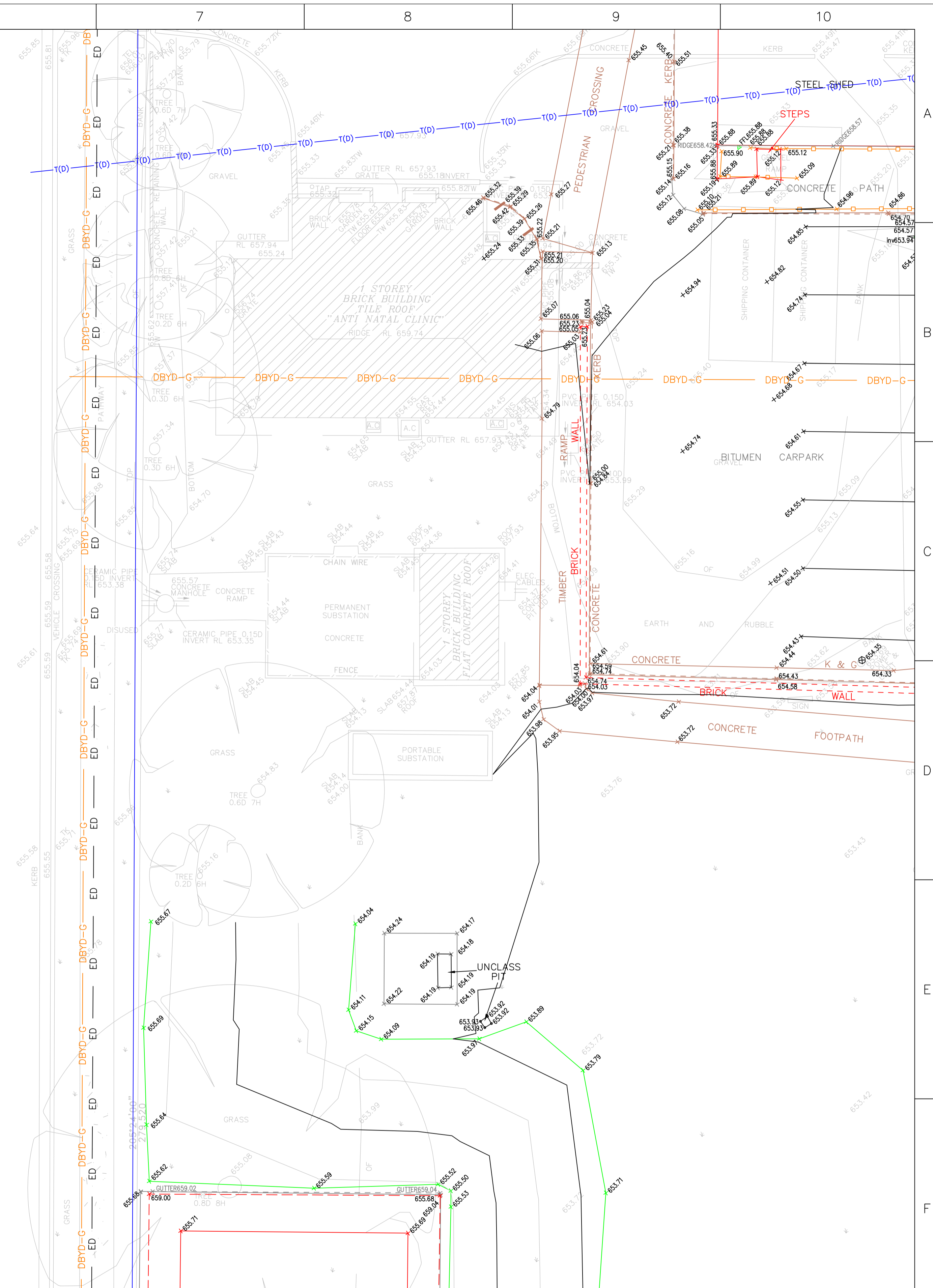

**IMPORTANT NOTE:**  
This plan is prepared for HEALTH INFRASTRUCTURE from a combination of field survey and existing records for the purpose of designing new constructions on the land and should not be used for any other purpose.  
The title boundaries shown hereon were not marked by the author at the time of survey and have been determined by plan dimensions only and not by field measurement.

A services search of the area surveyed above has not been undertaken. Visible services shown hereon have been located where possible by field survey. Prior to any demolition, excavation or construction on the site, the relevant authority should be contacted for possible location of further underground services and detailed locations of all services.  
This note is an integral part of this plan.

01	11.12.2015	EXTRA DETAIL AND CONTOURS ADDED	117806AH	MC
00	7.12.2015	ORIGINAL ISSUE	117806AF	MC
REVISION	DATE	DESCRIPTION	CCAD REF	APPROVED

SCALE: HORIZ. 1:100	VERT.
CONTOUR INTERVAL: MAJOR 0.0	MINOR 0.0
HORIZONTAL ORIGIN	
COORD. SYSTEM	MARK ADOPTED: PM 8838 (ZONE 55)
MGA	COORDINATES: E 748 515 204 N 6 151 573.634
VERTICAL DATUM	
DATUM: AHD	BM ADOPTED: PM 8838 RL: 651.720

**Cardno**  
Shaping the Future

23-25 Frederick Street  
PO Box 175  
Rockdale NSW 2216  
t: (02) 9597 9700  
f: (02) 9599 2146  
e: surveynsw@cardno.com.au w: www.cardno.com.au

SURVEYED J.E./R.S.	DRAWN I.T.	CHECKED J.E./R.S.	PASSED M.C.
-----------------------	---------------	----------------------	----------------

PROJECT: GOULBURN HOSPITAL

**PLAN SHOWING LEVELS, DETAILS AND CONTOURS**

CLIENT: HEALTH INFRASTRUCTURE

SHEET 15	OF 21
DRAWING NUMBER	REV
<b>117806501</b>	<b>01</b>

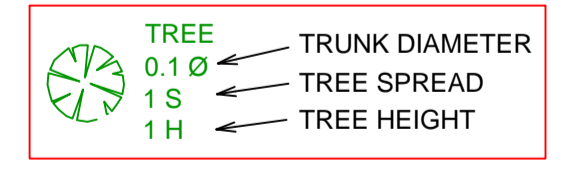
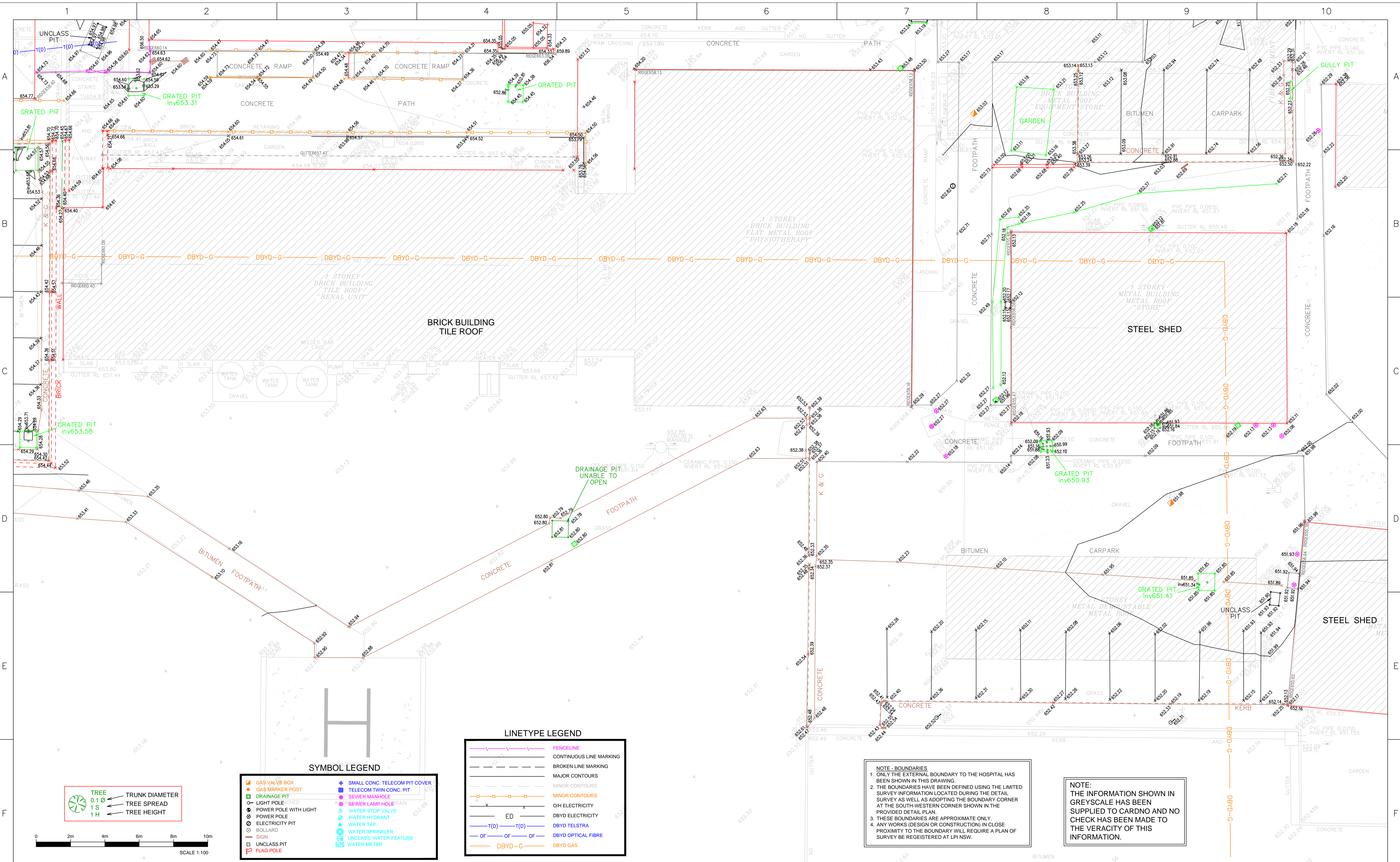

**SYMBOL LEGEND**

Gas Valve Box	Small Conc. Telecom Pit Cover
Drainage Pit	Telecom Twin Conc. Pit
Light Pole	Sewer Manhole
Power Pole with Light	Sewer Lamp Hole
Power Pole	Water Stop Valve
Electricity Pit	Water Tap
Bollard	Water Sprinkler
Sign	Unclass. Water Feature
Unclass Pit	Water Meter
Flag Pole	

**LINETYPE LEGEND**

Fenceline	DBYD Gas
Continuous Line Marking	DBYD Optical Fibre
Broken Line Marking	DBYD Telstra
Major Contours	
Minor Contours	
OH Electricity	
ED Electricity	
ED	
DBYD-G	

**NOTE - BOUNDARIES**

- ONLY THE EXTERNAL BOUNDARY TO THE HOSPITAL HAS BEEN SHOWN IN THIS DRAWING.
- THE BOUNDARIES HAVE BEEN DEFINED USING THE LIMITED SURVEY INFORMATION LOCATED DURING THE DETAIL SURVEY AS WELL AS ADOPTING THE BOUNDARY CORNER AT THE SOUTH-WESTERN CORNER SHOWN IN THE PROVIDED DETAIL PLAN.
- THESE BOUNDARIES ARE APPROXIMATE ONLY.
- ANY WORKS (DESIGN OR CONSTRUCTION) IN CLOSE PROXIMITY TO THE BOUNDARY WILL REQUIRE A PLAN OF SURVEY BE REGISTERED AT LPI NSW.

**NOTE:**  
THE INFORMATION SHOWN IN GREYSCALE HAS BEEN SUPPLIED TO CARDNO AND NO CHECK HAS BEEN MADE TO THE VERACITY OF THIS INFORMATION.

**IMPORTANT NOTE:**  
This plan is prepared for HEALTH INFRASTRUCTURE from a combination of field survey and existing records for the purpose of designing new constructions on the land and should not be used for any other purpose.  
The title boundaries shown hereon were not marked by the author at the time of survey and have been determined by plan dimensions only and not by field measurement.

A services search of the area surveyed above has not been undertaken. Visible services shown hereon have been located where possible by field survey. Prior to any demolition, excavation or construction on the site, the relevant authority should be contacted for possible location of further underground services and detailed locations of all services.  
This note is an integral part of this plan.

REVISION	DATE	DESCRIPTION	CCAD REF	APPROVED
01	11.12.2015	EXTRA DETAIL AND CONTOURS ADDED	117806AH	MC
00	7.12.2015	ORIGINAL ISSUE	117806AF	MC

SCALE: HORIZ. 1:100	VERT.	A1
CONTOUR INTERVAL: MAJOR 0.0	MINOR 0.0	
HORIZONTAL ORIGIN		
COORD. SYSTEM	MARK ADOPTED: PM 8838 (ZONE 55)	
MGA	COORDINATES: E 748 515.204 N 6 151 573.634	
VERTICAL DATUM		
DATUM: AHD	BM ADOPTED: PM 8838 RL: 651.720	

23-25 Frederick Street  
PO Box 175  
Rockdale NSW 2216  
t: (02) 9597 9700  
f: (02) 9599 2146  
e: surveynsw@cardno.com.au w: www.cardno.com.au

SURVEYED	DRAWN	CHECKED	PASSED
J.E./R.S.	I.T.	J.E./R.S.	M.C.

PROJECT: GOULBURN HOSPITAL

**PLAN SHOWING LEVELS, DETAILS AND CONTOURS**

CLIENT: HEALTH INFRASTRUCTURE

SHEET 16 OF 21
DRAWING NUMBER
<b>117806501</b>
REV
<b>01</b>

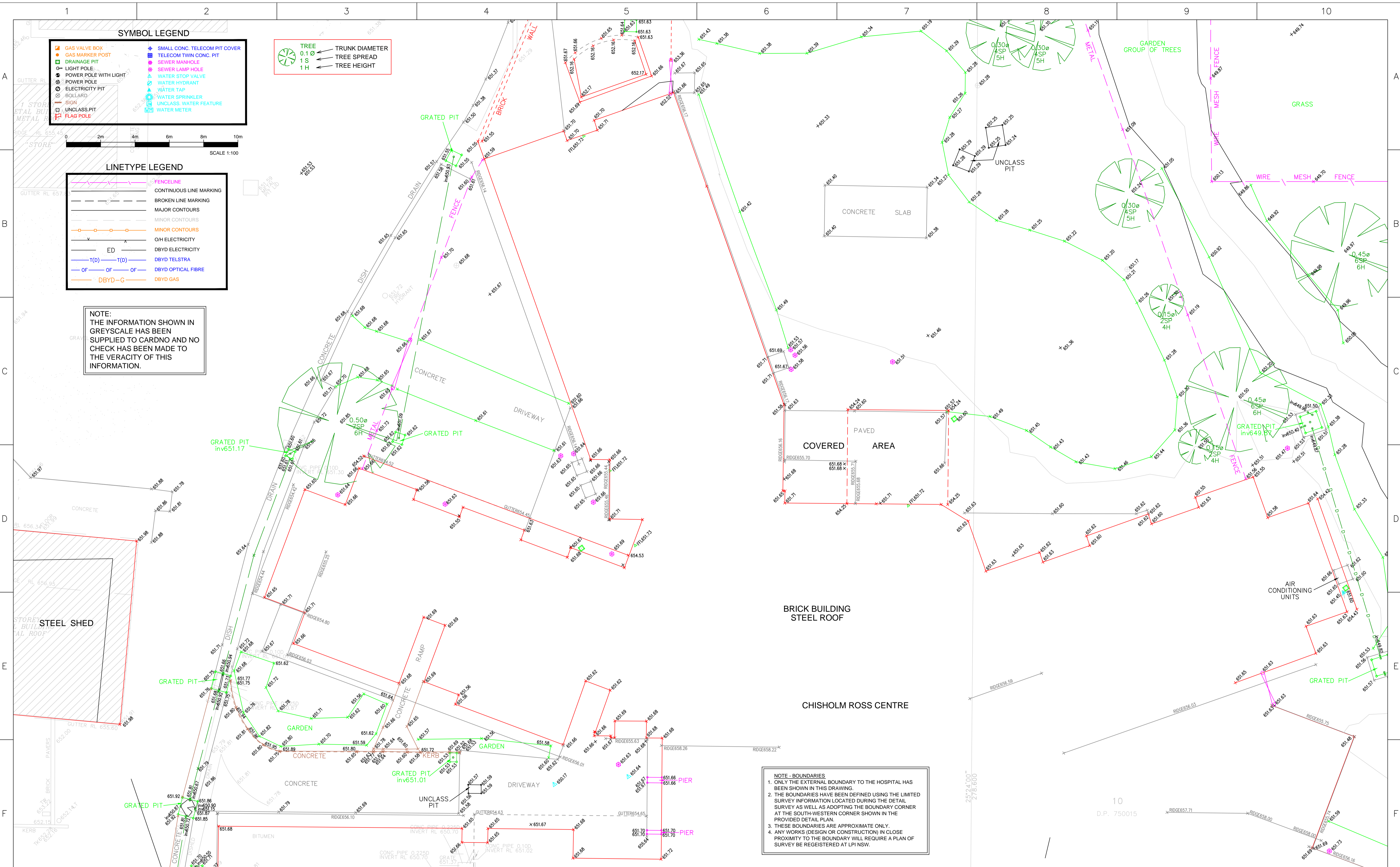

**SYMBOL LEGEND**

**TREE**

	TRUNK DIAMETER
0.1 Ø	TREE SPREAD
1 S	TREE HEIGHT
1 H	

**LINETYPE LEGEND**

	FENCELINE
	CONTINUOUS LINE MARKING
	BROKEN LINE MARKING
	MAJOR CONTOURS
	MINOR CONTOURS
	OH ELECTRICITY
	EDBY ELECTRICITY
	DBYD TELSTRA
	DBYD OPTICAL FIBRE
	DBYD GAS

**NOTE:**  
THE INFORMATION SHOWN IN GREYSCALE HAS BEEN SUPPLIED TO CARDNO AND NO CHECK HAS BEEN MADE TO THE VERACITY OF THIS INFORMATION.

**NOTE - BOUNDARIES**

- ONLY THE EXTERNAL BOUNDARY TO THE HOSPITAL HAS BEEN SHOWN IN THIS DRAWING.
- THE BOUNDARIES HAVE BEEN DEFINED USING THE LIMITED SURVEY INFORMATION LOCATED DURING THE DETAIL SURVEY AS WELL AS ADOPTING THE BOUNDARY CORNER AT THE SOUTH-WESTERN CORNER SHOWN IN THE PROVIDED DETAIL PLAN.
- THESE BOUNDARIES ARE APPROXIMATE ONLY.
- ANY WORKS (DESIGN OR CONSTRUCTION) IN CLOSE PROXIMITY TO THE BOUNDARY WILL REQUIRE A PLAN OF SURVEY BE REGISTERED AT LPI NSW.

**IMPORTANT NOTE:**  
This plan is prepared for HEALTH INFRASTRUCTURE from a combination of field survey and existing records for the purpose of designing new constructions on the land and should not be used for any other purpose.  
The title boundaries shown hereon were not marked by the author at the time of survey and have been determined by plan dimensions only and not by field measurement.

A services search of the area surveyed above has not been undertaken. Visible services shown hereon have been located where possible by field survey. Prior to any demolition, excavation or construction on the site, the relevant authority should be contacted for possible location of further underground services and detailed locations of all services.  
This note is an integral part of this plan.

REVISION	DATE	DESCRIPTION	CCAD REF	APPROVED
01	11.12.2015	EXTRA DETAIL AND CONTOURS ADDED	117806AH	MC
00	7.12.2015	ORIGINAL ISSUE	117806AF	MC

SCALE: HORIZ. 1:100	VERT.
CONTOUR INTERVAL: MAJOR 0.0	MINOR 0.0
HORIZONTAL ORIGIN	
COORD. SYSTEM	MARK ADOPTED: PM 8838 (ZONE 55)
MGA	COORDINATES: E 748 515.204 N 6 151 573.634
VERTICAL DATUM	
DATUM: AHD	BM ADOPTED: PM 8838 RL: 651.720

**Cardno**  
Shaping the Future

23-25 Frederick Street  
PO Box 175  
Rockdale NSW 2216  
t: (02) 9597 9700  
f: (02) 9599 2146  
e: surveynsw@cardno.com.au w: www.cardno.com.au

SURVEYED J.E./R.S.	DRAWN I.T.	CHECKED J.E./R.S.	PASSED M.C.
-----------------------	---------------	----------------------	----------------

PROJECT: GOULBURN HOSPITAL

**PLAN SHOWING LEVELS, DETAILS AND CONTOURS**

SHEET 17 OF 21

DRAWING NUMBER	REV
117806501	01

CLIENT: HEALTH INFRASTRUCTURE

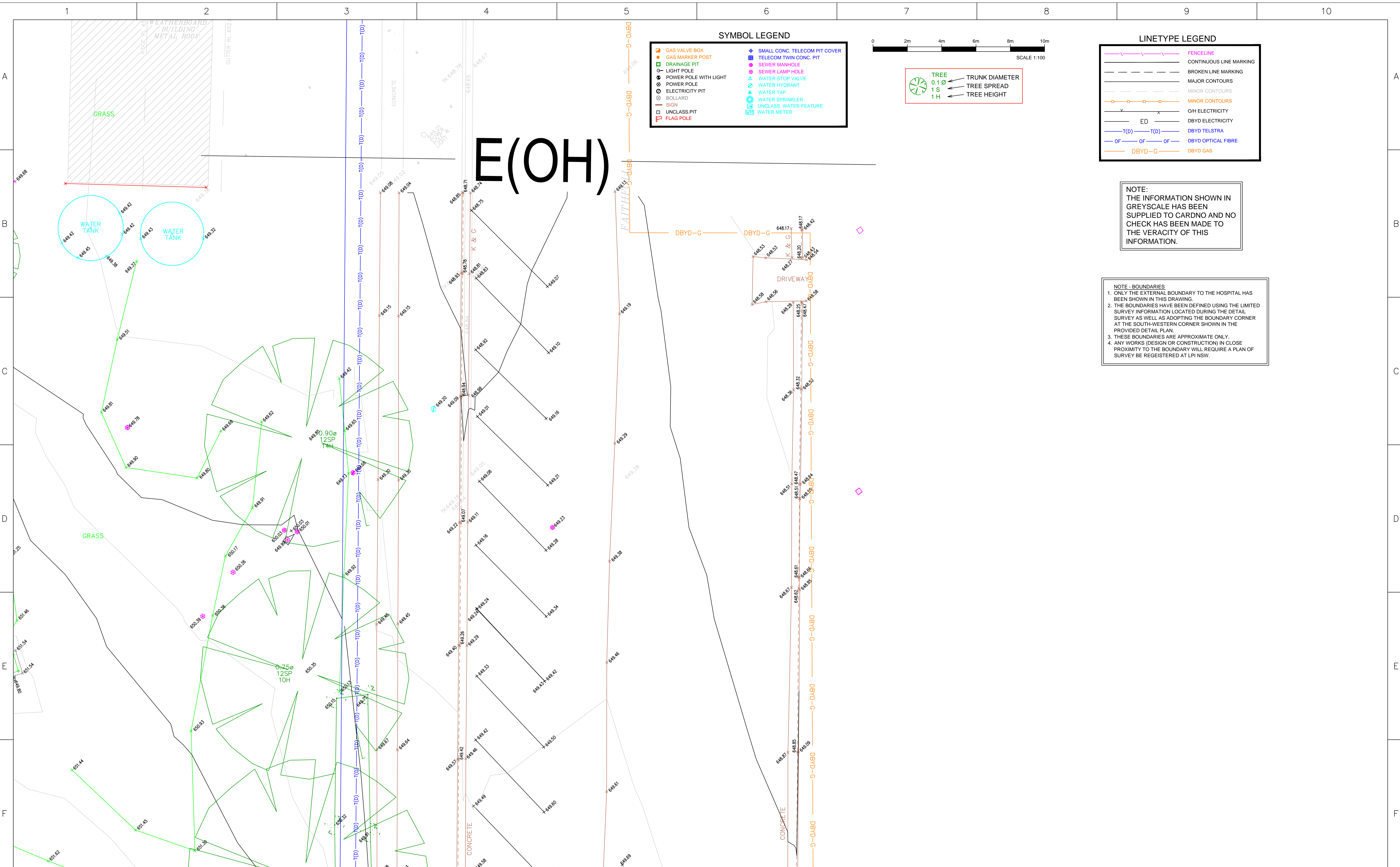

**NOTE:**  
 THE INFORMATION SHOWN IN GREYSCALE HAS BEEN SUPPLIED TO CARDNO AND NO CHECK HAS BEEN MADE TO THE VERACITY OF THIS INFORMATION.

**NOTE - BOUNDARIES**  
 1. ONLY THE EXTERNAL BOUNDARY TO THE HOSPITAL HAS BEEN SHOWN IN THIS DRAWING.  
 2. THE BOUNDARIES HAVE BEEN DEFINED USING THE LIMITED SURVEY INFORMATION LOCATED DURING THE DETAIL SURVEY AS WELL AS ADOPTING THE BOUNDARY CORNER AT THE SOUTH-WESTERN CORNER SHOWN IN THE PROVIDED DETAIL PLAN.  
 3. THESE BOUNDARIES ARE APPROXIMATE ONLY.  
 4. ANY WORKS (DESIGN OR CONSTRUCTION) IN CLOSE PROXIMITY TO THE BOUNDARY WILL REQUIRE A PLAN OF SURVEY BE REGISTERED AT LPI NSW.

**IMPORTANT NOTE:**  
 This plan is prepared for HEALTH INFRASTRUCTURE from a combination of field survey and existing records for the purpose of designing new constructions on the land and should not be used for any other purpose.  
 The title boundaries shown hereon were not marked by the author at the time of survey and have been determined by plan dimensions only and not by field measurement.

A services search of the area surveyed above has not been undertaken. Visible services shown hereon have been located where possible by field survey. Prior to any demolition, excavation or construction on the site, the relevant authority should be contacted for possible location of further underground services and detailed locations of all services.  
 This note is an integral part of this plan.

REVISION	DATE	DESCRIPTION	CCAD REF	APPROVED
01	11.12.2015	EXTRA DETAIL AND CONTOURS ADDED	117806AH	MC
00	7.12.2015	ORIGINAL ISSUE	117806AF	MC

SCALE: HORIZ. 1:100	VERT.	A1
CONTOUR INTERVAL: MAJOR 0.0	MINOR 0.0	
HORIZONTAL ORIGIN		
COORD. SYSTEM: MGA	MARK ADOPTED: PM 8838 (ZONE 55)	
COORDINATES: E 748 515.204 N 6 151 573.634		
VERTICAL DATUM		
DATUM: AHD	BM ADOPTED: PM 8838 RL: 651.720	

23-25 Frederick Street  
 PO Box 175  
 Rockdale NSW 2216  
 t: (02) 9597 9700  
 f: (02) 9599 2146  
 e: surveynsw@cardno.com.au w: www.cardno.com.au

SURVEYED J.E./R.S.	DRAWN I.T.	CHECKED J.E./R.S.	PASSED M.C.
-----------------------	---------------	----------------------	----------------

PROJECT: GOULBURN HOSPITAL

**PLAN SHOWING LEVELS, DETAILS AND CONTOURS**

CLIENT: HEALTH INFRASTRUCTURE

SHEET 18 OF 21	
DRAWING NUMBER	REV
<b>117806501</b>	<b>01</b>

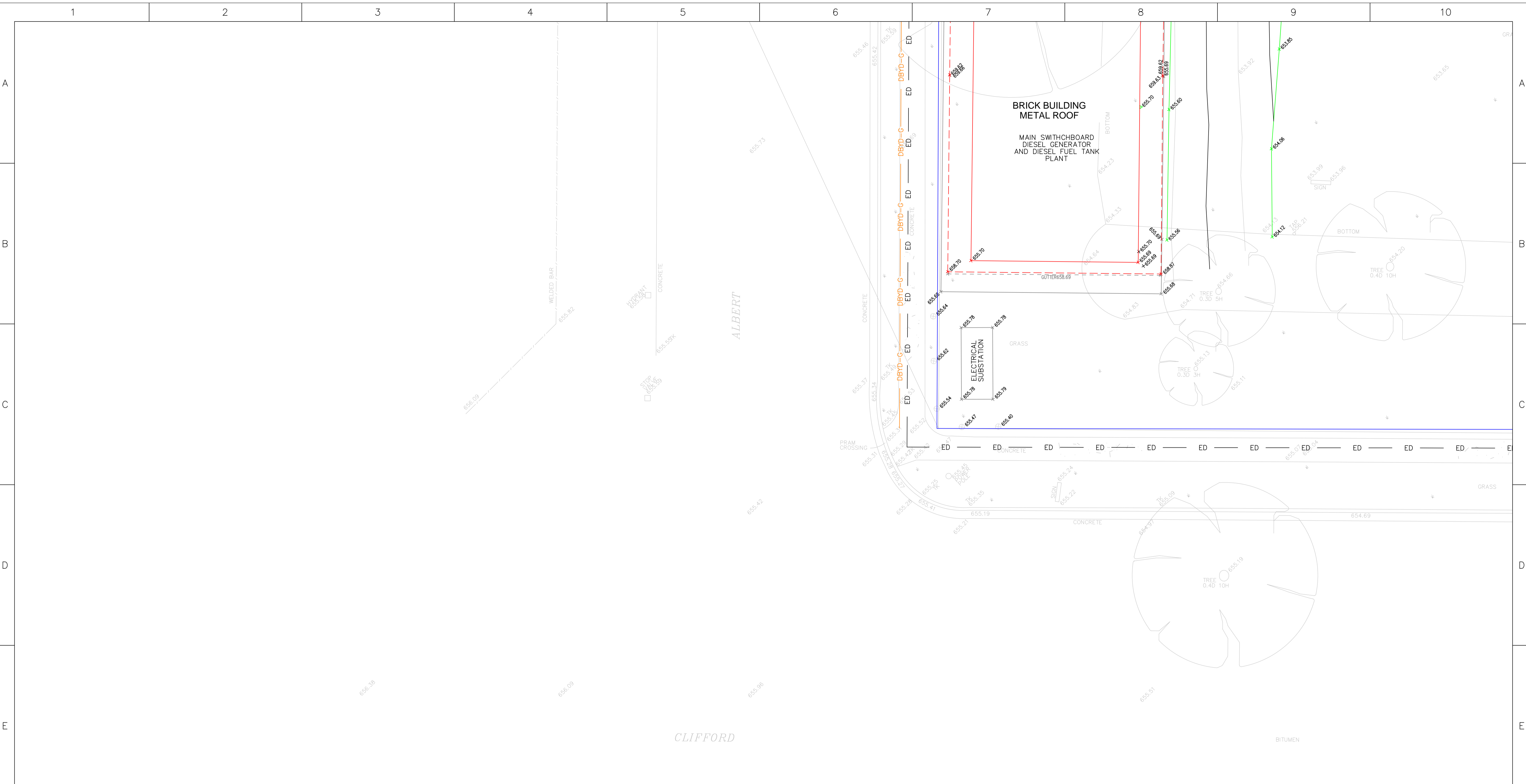

**NOTE:**  
THE INFORMATION SHOWN IN GREYSCALE HAS BEEN SUPPLIED TO CARDNO AND NO CHECK HAS BEEN MADE TO THE VERACITY OF THIS INFORMATION.

**NOTE - BOUNDARIES**  
1. ONLY THE EXTERNAL BOUNDARY TO THE HOSPITAL HAS BEEN SHOWN IN THIS DRAWING.  
2. THE BOUNDARIES HAVE BEEN DEFINED USING THE LIMITED SURVEY INFORMATION LOCATED DURING THE DETAIL SURVEY AS WELL AS ADOPTING THE BOUNDARY CORNER AT THE SOUTH-WESTERN CORNER SHOWN IN THE PROVIDED DETAIL PLAN.  
3. THESE BOUNDARIES ARE APPROXIMATE ONLY.  
4. ANY WORKS (DESIGN OR CONSTRUCTION) IN CLOSE PROXIMITY TO THE BOUNDARY WILL REQUIRE A PLAN OF SURVEY BE REGISTERED AT LPI NSW.

**LINETYPE LEGEND**

	FENCELINE
	CONTINUOUS LINE MARKING
	BROKEN LINE MARKING
	MAJOR CONTOURS
	MINOR CONTOURS
	OH ELECTRICITY
	ED
	DBYD TELSTRA
	DBYD OPTICAL FIBRE
	DBYD-G
	DBYD GAS

**SYMBOL LEGEND**

	GAS VALVE BOX		SMALL CONC. TELECOM PIT COVER
	GAS MARKER POST		TELECOM TWIN CONC. PIT
	DRAINAGE PIT		SEWER MANHOLE
	SEWER LAMP HOLE		WATER STOP VALVE
	POWER POLE WITH LIGHT		WATER TAP
	POWER POLE		WATER SPRINKLER
	ELECTRICITY PIT		UNCLASS. WATER FEATURE
	BOLLARD		WATER METER
	SIGN		
	UNCLASS.PIT		
	FLAG POLE		

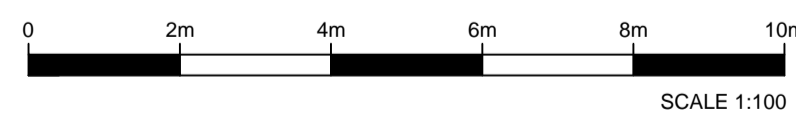
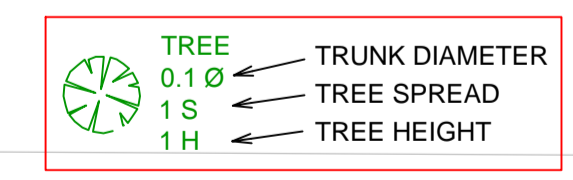

**IMPORTANT NOTE:**  
This plan is prepared for HEALTH INFRASTRUCTURE from a combination of field survey and existing records for the purpose of designing new constructions on the land and should not be used for any other purpose.  
The title boundaries shown hereon were not marked by the author at the time of survey and have been determined by plan dimensions only and not by field measurement.

A services search of the area surveyed above has not been undertaken. Visible services shown hereon have been located where possible by field survey. Prior to any demolition, excavation or construction on the site, the relevant authority should be contacted for possible location of further underground services and detailed locations of all services.  
This note is an integral part of this plan.

REVISION	DATE	DESCRIPTION	CCAD REF	APPROVED
01	11.12.2015	EXTRA DETAIL AND CONTOURS ADDED	117806AH	MC
00	7.12.2015	ORIGINAL ISSUE	117806AF	MC

SCALE: HORIZ. 1:100	VERT.
CONTOUR INTERVAL: MAJOR 0.0	MINOR 0.0
HORIZONTAL ORIGIN	
COORD. SYSTEM: MGA	MARK ADOPTED: PM 8838 (ZONE 55)
COORDINATES: E 748 515 204 N 6 151 573.634	
VERTICAL DATUM	
DATUM: AHD	BM ADOPTED: PM 8838 RL: 651.720

**Cardno**  
Shaping the Future

23-25 Frederick Street  
PO Box 175  
Rockdale NSW 2216  
t: (02) 9597 9700  
f: (02) 9599 2146  
e: surveynsw@cardno.com.au w: www.cardno.com.au

SURVEYED: J.E./R.S.	DRAWN: I.T.	CHECKED: J.E./R.S.	PASSED: M.C.
---------------------	-------------	--------------------	--------------

PROJECT: GOULBURN HOSPITAL

**PLAN SHOWING LEVELS, DETAILS AND CONTOURS**

CLIENT: HEALTH INFRASTRUCTURE

SHEET 19 OF 21

DRAWING NUMBER	REV
117806501	01

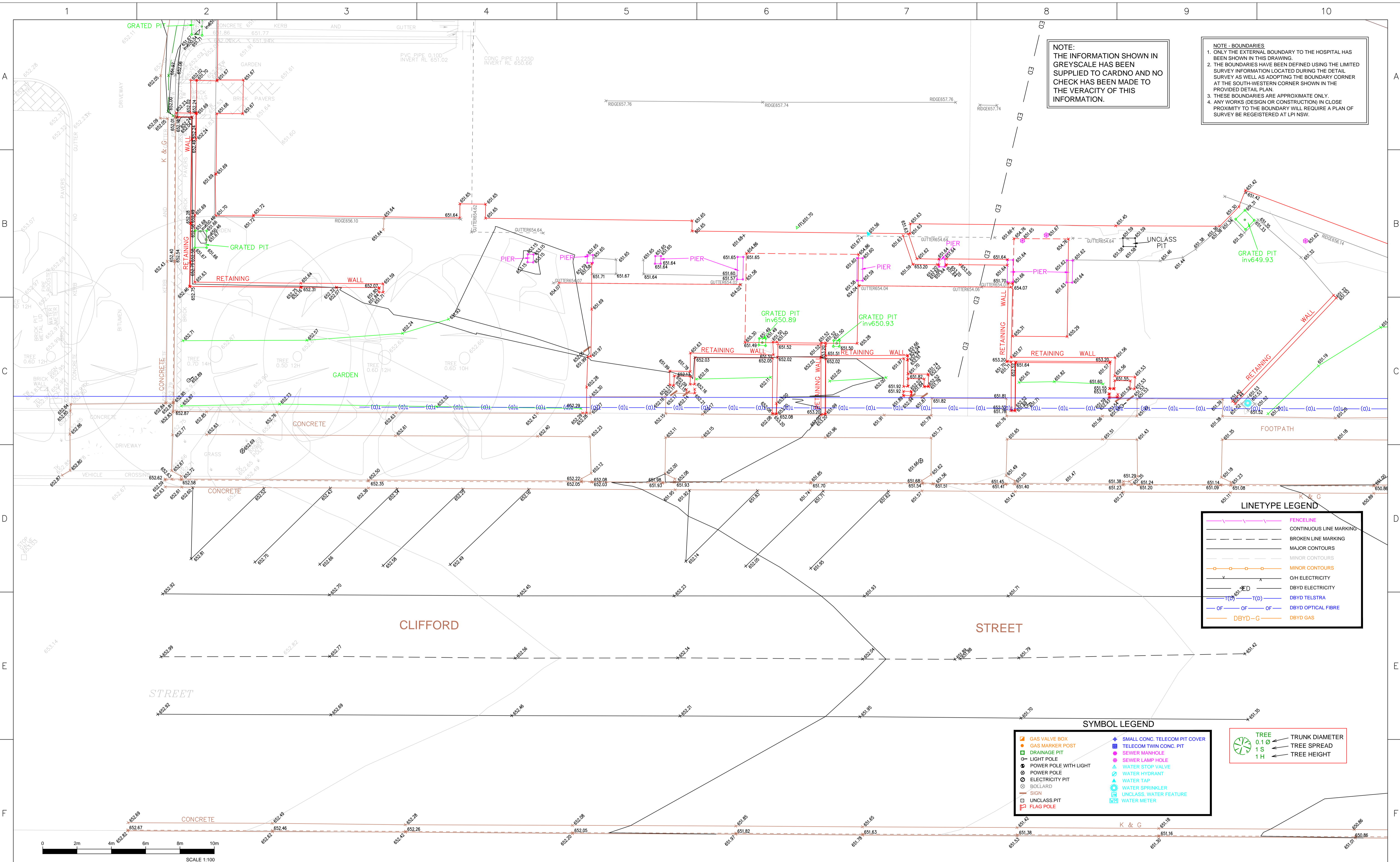

**NOTE:**  
THE INFORMATION SHOWN IN GREYSCALE HAS BEEN SUPPLIED TO CARDNO AND NO CHECK HAS BEEN MADE TO THE VERACITY OF THIS INFORMATION.

**NOTE - BOUNDARIES**  
1. ONLY THE EXTERNAL BOUNDARY TO THE HOSPITAL HAS BEEN SHOWN IN THIS DRAWING.  
2. THE BOUNDARIES HAVE BEEN DEFINED USING THE LIMITED SURVEY INFORMATION LOCATED DURING THE DETAIL SURVEY AS WELL AS ADOPTING THE BOUNDARY CORNER AT THE SOUTH-WESTERN CORNER SHOWN IN THE PROVIDED DETAIL PLAN.  
3. THESE BOUNDARIES ARE APPROXIMATE ONLY.  
4. ANY WORKS (DESIGN OR CONSTRUCTION) IN CLOSE PROXIMITY TO THE BOUNDARY WILL REQUIRE A PLAN OF SURVEY BE REGISTERED AT LPI NSW.

**LINETYPE LEGEND**

	FENCELINE
	CONTINUOUS LINE MARKING
	BROKEN LINE MARKING
	MAJOR CONTOURS
	MINOR CONTOURS
	MINOR CONTOURS
	O/H ELECTRICITY
	DBYD ELECTRICITY
	DBYD TELSTRA
	DBYD OPTICAL FIBRE
	DBYD-G
	DBYD GAS

**SYMBOL LEGEND**

	GAS VALVE BOX		SMALL CONC. TELECOM PIT COVER
	GAS MARKER POST		TELECOM TWIN CONC. PIT
	DRAINAGE PIT		SEWER MANHOLE
	LIGHT POLE		SEWER LAMP HOLE
	POWER POLE WITH LIGHT		WATER STOP VALVE
	POWER POLE		WATER HYDRANT
	ELECTRICITY PIT		WATER TAP
	BOLLARD		WATER SPRINKLER
	SIGN		UNCLASS. WATER FEATURE
	UNCLASS.PIT		WATER METER
	FLAG POLE		

**TREE**

	TRUNK DIAMETER
	TREE SPREAD
	TREE HEIGHT

**IMPORTANT NOTE:**  
This plan is prepared for HEALTH INFRASTRUCTURE from a combination of field survey and existing records for the purpose of designing new constructions on the land and should not be used for any other purpose.  
The title boundaries shown hereon were not marked by the author at the time of survey and have been determined by plan dimensions only and not by field measurement.

A services search of the area surveyed above has not been undertaken. Visible services shown hereon have been located where possible by field survey. Prior to any demolition, excavation or construction on the site, the relevant authority should be contacted for possible location of further underground services and detailed locations of all services.  
This note is an integral part of this plan.

REVISION	DATE	DESCRIPTION	CCAD REF	APPROVED
01	11.12.2015	EXTRA DETAIL AND CONTOURS ADDED	117806AH	MC
00	7.12.2015	ORIGINAL ISSUE	117806AF	MC

SCALE: HORIZ. 1:100 VERT. A1

CONTOUR INTERVAL: MAJOR 0.0 MINOR 0.0

HORIZONTAL ORIGIN

COORD. SYSTEM: MGA

MARK ADOPTED: PM 8838 (ZONE 55)

COORDINATES: E 748 515 204 N 6 151 573.634

VERTICAL DATUM: AHD

BM ADOPTED: PM 8838 RL: 651.720

**Cardno**  
Shaping the Future

23-25 Frederick Street  
PO Box 175  
Rockdale NSW 2216  
t: (02) 9597 9700  
f: (02) 9599 2146  
e: surveynsw@cardno.com.au w: www.cardno.com.au

SURVEYED J.E./R.S.	DRAWN I.T.	CHECKED J.E./R.S.	PASSED M.C.
-----------------------	---------------	----------------------	----------------

PROJECT: GOULBURN HOSPITAL

PLAN SHOWING LEVELS, DETAILS AND CONTOURS

CLIENT: HEALTH INFRASTRUCTURE

SHEET 20 OF 21	REV
117806501	01

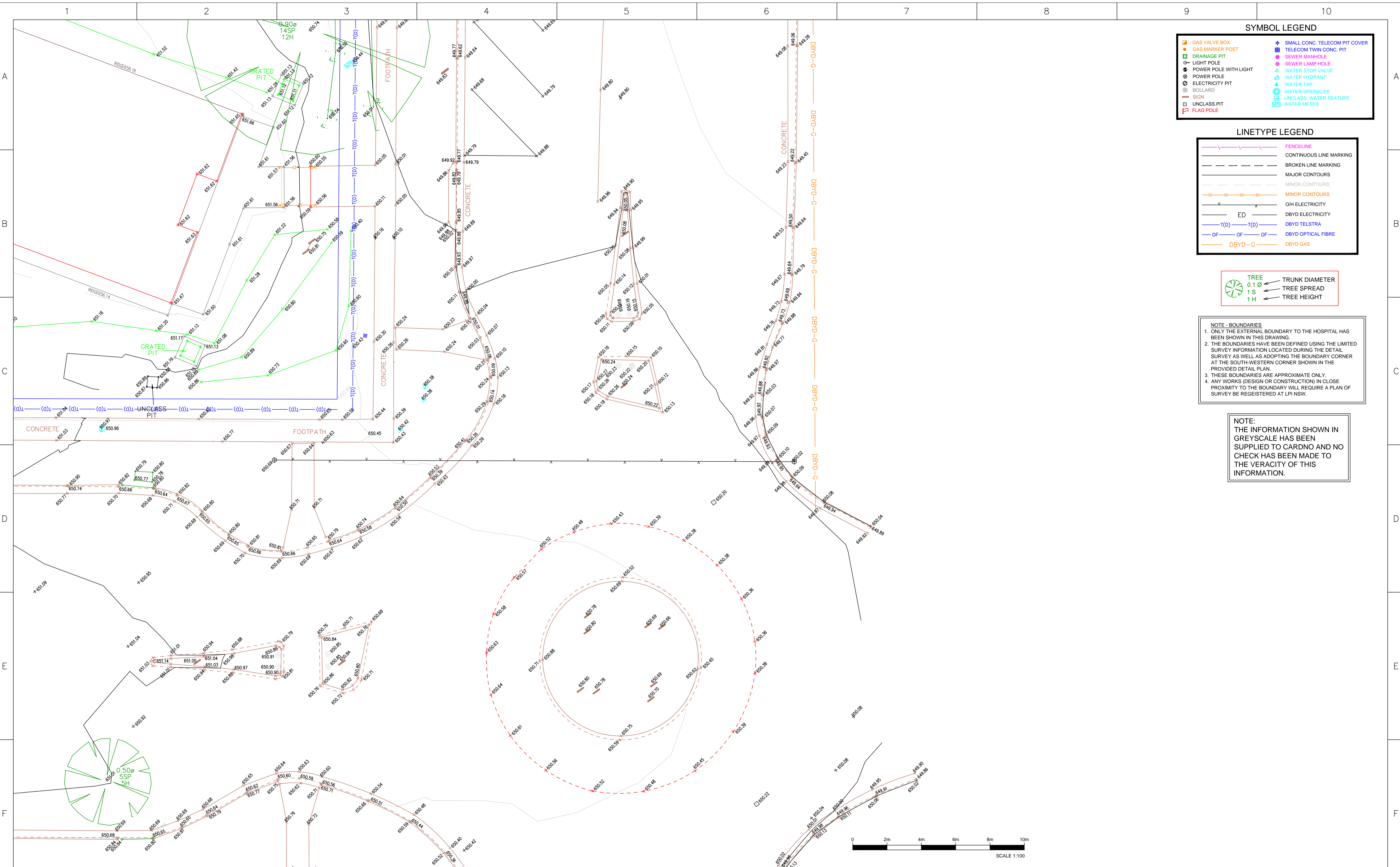

**SYMBOL LEGEND**

**LINETYPE LEGEND**

	FENCELINE
	CONTINUOUS LINE MARKING
	BROKEN LINE MARKING
	MAJOR CONTOURS
	MINOR CONTOURS
	O/H ELECTRICITY
	DBYD ELECTRICITY
	DBYD TELSTRA
	DBYD OPTICAL FIBRE
	DBYD GAS

**TREES**

	TRUNK DIAMETER
0.1 Ø	TREE SPREAD
1 S	TREE HEIGHT
1 H	

**NOTE - BOUNDARIES**

- ONLY THE EXTERNAL BOUNDARY TO THE HOSPITAL HAS BEEN SHOWN IN THIS DRAWING.
- THE BOUNDARIES HAVE BEEN DEFINED USING THE LIMITED SURVEY INFORMATION LOCATED DURING THE DETAIL SURVEY AS WELL AS ADOPTING THE BOUNDARY CORNER AT THE SOUTH-WESTERN CORNER SHOWN IN THE PROVIDED DETAIL PLAN.
- THESE BOUNDARIES ARE APPROXIMATE ONLY.
- ANY WORKS (DESIGN OR CONSTRUCTION) IN CLOSE PROXIMITY TO THE BOUNDARY WILL REQUIRE A PLAN OF SURVEY BE REGISTERED AT LPI NSW.

**NOTE:**  
THE INFORMATION SHOWN IN GREYSCALE HAS BEEN SUPPLIED TO CARDNO AND NO CHECK HAS BEEN MADE TO THE VERACITY OF THIS INFORMATION.

**IMPORTANT NOTE:**  
This plan is prepared for HEALTH INFRASTRUCTURE from a combination of field survey and existing records for the purpose of designing new constructions on the land and should not be used for any other purpose.  
The title boundaries shown hereon were not marked by the author at the time of survey and have been determined by plan dimensions only and not by field measurement.

A services search of the area surveyed above has not been undertaken. Visible services shown hereon have been located where possible by field survey. Prior to any demolition, excavation or construction on the site, the relevant authority should be contacted for possible location of further underground services and detailed locations of all services.  
This note is an integral part of this plan.

REVISION	DATE	DESCRIPTION	CCAD REF	APPROVED
01	11.12.2015	EXTRA DETAIL AND CONTOURS ADDED	117806AH	MC
00	7.12.2015	ORIGINAL ISSUE	117806AF	MC

SCALE: HORIZ. 1:100	VERT.
CONTOUR INTERVAL: MAJOR 0.0	MINOR 0.0
HORIZONTAL ORIGIN	
COORD. SYSTEM: MGA	MARK ADOPTED: PM 8838 (ZONE 55)
COORDINATES: E 748 515 204 N 6 151 573.634	
VERTICAL DATUM	
DATUM: AHD	BM ADOPTED: PM 8838 RL: 651.720

**Cardno**  
Shaping the Future

23-25 Frederick Street  
PO Box 175  
Rockdale NSW 2216  
t: (02) 9597 9700  
f: (02) 9599 2146  
e: surveynsw@cardno.com.au www.cardno.com.au

SURVEYED: J.E./R.S.	DRAWN: I.T.	CHECKED: J.E./R.S.	PASSED: M.C.
---------------------	-------------	--------------------	--------------

PROJECT: GOULBURN HOSPITAL

**PLAN SHOWING LEVELS, DETAILS AND CONTOURS**

CLIENT: HEALTH INFRASTRUCTURE

SHEET 21 OF 21	
DRAWING NUMBER	REV
<b>117806501</b>	<b>01</b>