



Building Code of Australia 2016

BCA CAPABILITY STATEMENT



Building 5
Lots 23 & 24 Hollinsworth Road, Marsden Park,
NSW 2765

Prepared for: Logos Property | Issue date: 23 Nov 17

Contents

EXECUTIVE SUMMARY	4
INTRODUCTION	5
BUILDING DESCRIPTION SUMMARY	6
Proposed Works	6
Building Assessment Data	6
ASSESSMENT	7
Relevant BCA Edition.....	7
Compliance with the BCA	7
Matters Requiring a Performance Assessment.....	8
CONCLUSION	9
APPENDIX A – DESIGN DOCUMENTATION	10

Authorisation

Revision	Comment / Reason for Issue	Issue Date	Prepared by	Reviewed by
1	SSD Lodgment	23.11.17		
			Matt Marks	Heath McNab

Revision History

Revision	Comment / Reason for Issue	Issue Date	Prepared By
1	SSD Lodgment	23.11.17	Matt Marks

© Copyright Modern Building Consultants Pty Ltd trading as Modern Building Certifiers

Commercial in Confidence

The report addressee may only reproduce this report in full for use with respect to the project specified in the report. No organizations or individuals are permitted to reproduce this report or any part thereof for any other purpose without the prior written consent of a Director of Modern Building Consultants Pty Ltd trading as Modern Building Certifiers.

The copyright and intellectual property rights of Modern Building Consultants Pty Ltd trading as Modern Building Certifiers extends to the data, methodologies and conclusions presented in this report.

Executive Summary

Modern Building Certifiers have been commissioned to carry out a detailed assessment of the proposed construction of new industrial estate which will contain seven (7) separate buildings all housed within a single estate, located at Lots 23 & 24 Hollinsworth Road, Marsden Park, NSW 2765, against the requirements of the National Construction Code Series (Volume 1) – Building Code of Australia (BCA) 2016.

The purpose of the assessment is to provide surety to the Consent Authority, Department of Planning and Environment NSW (DoPE), that the design of building number 5 is capable of complying with the BCA and that subsequent compliance with the provisions of Parts C, D E, F & J of the BCA will not give rise to further modifications to the building that may necessitate additional design changes.



Matt Marks
Building Certifier
Modern Building Certifiers

Introduction

The following Modern Building Certifiers Team Members have contributed to this assessment:

- Heath McNab – Director
- Matt Marks – Building Surveyor

Our assessment of the concept design documentation was based on the following:

- National Construction Code Series (Volume 1) Building Code of Australia 2016 (BCA)
- Architectural Drawings – Refer to Appendix A
- Guide to the Building Code of Australia 2016 (BCA Guide)
- Access to Premises – Buildings Standards 2010 (Access Code)
- Environmental Planning and Assessment Act 1979 (EP&A)
- Environmental Planning and Assessment Regulation 2000 (EP&AR)

The objectives of this statement are to:

- Undertake an assessment of the proposed architectural design documentation against the Performance Requirements of National Construction Code Series 2016 (Volume 1) - Building Code of Australia (BCA).
- Accompany the submission of the State Significant Development Submission to the Department of Planning and Environment NSW (DoPE) to enable the Consent Authority to be satisfied that the building design is capable of complying with the BCA and that subsequent compliance with Parts C, D, E, F & J of the BCA will not give rise to further design changes to the building.
- Identify any BCA compliance issues that require resolution at the Construction Certificate stage. These matters are to be considered pursuant to Cls 53 .4 of the EP&A Regulation 2000.
- Enable the certifying authority to satisfy its statutory obligations under Clause 145 of the Environmental Planning and Assessment Regulation, 2000.
- Enable the certifying authority to satisfy its statutory obligations under Clause 17 & 18 of the Building Professionals Regulation 2007.
- This Capability Statement is not intended to identify all issues of compliance or non-compliance with the BCA with such other issues to be appropriately addressed prior to issue of the Construction Certificate.

Building Description Summary

Proposed Works

The proposed development involves the construction of a new single storey warehouse and distribution centre identified as building 5 within the newly proposed industrial estate.

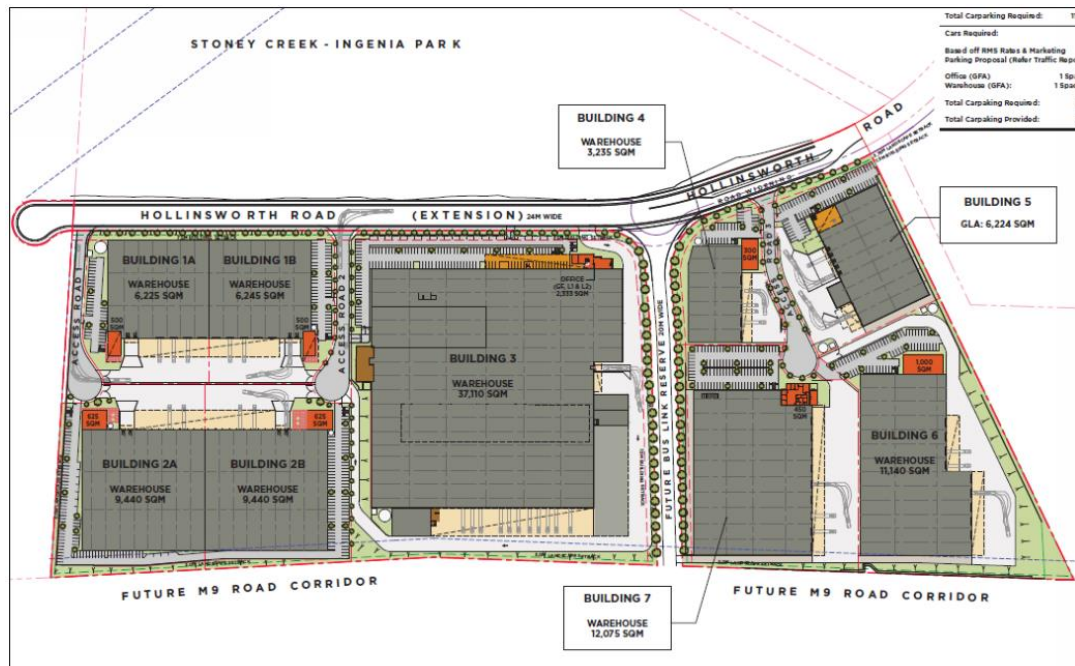

Building Assessment Data

Summary of Construction and Building	
Use(s)	Warehouse and distribution centre and Office
Classification(s)	5 & 7b & 8
Number of Storeys contained	2
Rise in Storeys	2
Type of Construction	Type C (Large isolated)
Effective Height	3.6m (<12m)
Climate Zone	6

Assessment

Relevant BCA Edition

The proposed building will be subject to compliance with the relevant requirements of the BCA as in force at the time that the application for the Construction Certificate is made. In this regard it is assumed that the Construction Certificate application will be made prior to the 1st May 2019, as such BCA 2016 Version applies to the new works proposed at the subject development.

Compliance with the BCA

The detailed desktop assessment was carried out against the technical provisions of the BCA and compliance matters will be addressed in the Construction Certificate documentation. It is noted that the proposed development must comply with the relevant requirements and this can be achieved by complying with the following:

- a) Complying with the Deemed-to-satisfy (DTS) Provisions; or
- b) Formulating an Alternative Solution which –
 - i) Complies with the performance requirements; or
 - ii) Is shown to be at least equivalent to the DTS provisions; or
- c) A combination of the above.

In accordance with the above, Modern Building Certifiers can verify that the proposed building design will entail a combination of compliance with the DTS provisions and Performance Requirements of the BCA.

It is also advised that the proposed design and associated Fire Engineering proposal will be requiring formal referral to Fire & Rescue NSW pursuant to Clause 144 of the Environmental Planning & Assessment Regulation 2000 (where any Category 2 fire safety provisions identified), and this process will need to be undertaken prior to a Part 4a Construction Certificate being issued by the Principal Certifying Authority (PCA).

Matters Requiring a Performance Assessment

DTS Clause	Description of Non-Compliance	Performance Requirement
C2.4	<u>Requirements for open space and vehicular access</u> <ul style="list-style-type: none"> The furthest boundary of vehicular access is greater than 18m from the north & western sides of the building with the maximum distance being 40m on the western side. The vehicular access is built upon by security gates. 	CP9
D1.4	<u>Exit travel distance</u> <ul style="list-style-type: none"> 26m to a single exit within the level 1 office portion 50m to an exit in lieu of 40m within the ground floor warehouse portion 	DP4, EP2.2
D1.5	<u>Distance between alternative exits</u> <ul style="list-style-type: none"> 65m between alternative exits in lieu of 60m 	DP4, EP2.2
E4.5/ E4.6	<u>Exit and directional signs</u> <ul style="list-style-type: none"> Exit signs are proposed to be located greater than 2.7m above the floor level. 	EP4.2

Conclusion

This report contains an assessment of the referenced architectural documentation for the proposed development against the Deemed-to-Satisfy provisions & Performance Requirements of the National Construction Code Series (Volume 1) Building Code of Australia 2016.

In view of the above assessment we can confirm that subject to the above measures being appropriately considered, that compliance with the Deemed-to-Satisfy Provisions and Performance Requirements of the BCA are readily achievable.

We trust that the above submission is of assistance to the DoPE and should you wish to discuss any aspect of this advice, please do not hesitate to contact me.

Best regards,



Matt Marks
Building Certifier
Modern Building Certifiers

Appendix A – Design Documentation

The following documentation was used in the assessment and preparation of this report.

Title	Prepared by	Reference No.
Estate Master Plan	watch this SPACE design	LG MAR DA01/C
Building 5 - Site Plan	watch this SPACE design	LG MAR DA50/C
Building 5 – Warehouse Plan	watch this SPACE design	LG MAR DA51/B
Building 5 – Office & WH Office Plan	watch this SPACE design	LG MAR DA52/B
Building 5 – Roof Plan	watch this SPACE design	LG MAR DA53/C
Building 5 – Elevations	watch this SPACE design	LG MAR DA54/C
Building 5 – Sections	watch this SPACE design	LG MAR DA55/C



Building Code of Australia 2016

COMPLIANCE SUMMARY REPORT