



NSW Site Auditor Scheme

Site Audit Notification

Section 53C of the *Contaminated Land Management Act 1997* requires auditors to notify the NSW Environment Protection Authority (EPA) of statutory site audits within seven days of their being commissioned.

Proposed site audit details

Site audit no. **233**

This proposed site audit is a:

statutory audit

~~non-statutory audit~~

within the meaning of the *Contaminated Land Management Act 1997* (s. 47).

Site auditor details

(As accredited under the *Contaminated Land Management Act 1997*)

Name **Dr Ian C Swane (accreditation number 9821)**

Company **Ian Swane & Associates**

Address **PO Box 359, Mortdale NSW**

Postcode **2223**

Phone **0418 867 112**

Email iswane@bigpond.com

Site details

Address **Part of The Hermitage Estate, 810 - 812 Camden Valley Way, Gledswood Hills**

NSW (Figures 1 & 2)

Postcode **2557**

Property description

(Attach a separate list if several properties are included in the site audit.)

Lot 3 in DP1227491 located in the eastern part of The Hermitage Estate being developed by Sekisui House

Local government area **Camden Council**

Area of site (include units, e.g. hectares) **2.437 ha (24,370 m²) out of a total area for The Hermitage Estate of 113.6 ha**

Current zoning **General Residential (R1)**

Regulation and notification

To the best of my knowledge:

~~the site is the subject of a declaration, order, agreement, proposal or notice under the Contaminated Land Management Act 1997 or the Environmentally Hazardous Chemicals Act 1985, as follows: (provide the no. if applicable)~~

~~Declaration no.~~

~~Order no.~~

~~Proposal no.~~

~~Notice no.~~

the site is not the subject of a declaration, order, proposal or notice under the *Contaminated Land Management Act 1997* or the *Environmentally Hazardous Chemicals Act 1985*.

To the best of my knowledge:

~~the site has been notified to the EPA under section 60 of the Contaminated Land Management Act 1997~~

the site **has not** been notified to the EPA under section 60 of the *Contaminated Land Management Act 1997*.

Site audit commissioned by

Name **Raj Sharma**

Company **Sekisui House Australia Pty Limited**

Address **68 Waterloo Road, Macquarie Park NSW**

Postcode **2113**

Phone **0430 303 171**

Email Raj.Sharma@sekisuihouse.com.au

Purpose of site audit

- A1** To determine land use suitability

Intended uses of the land: **Public school (NEPM Residential A)**

~~OR AND~~

~~**A2** To determine land use suitability subject to compliance with either an active or passive environmental management plan~~

~~Intended uses of the land:~~

~~OR~~

~~(Tick all that apply)~~

- ~~**B1** To determine the nature and extent of contamination~~

- ~~**B2** To determine the appropriateness of:~~

~~an investigation plan~~

~~a remediation plan~~

~~a management plan~~

- ~~**B3** To determine the appropriateness of a **site testing plan** to determine if groundwater is safe and suitable for its intended use as required by the *Temporary Water Restrictions Order for the Botany Sands Groundwater Resource 2017*~~

- ~~**B4** To determine the compliance with an approved:~~

~~**voluntary management proposal** or~~

~~**management order** under the *Contaminated Land Management Act 1997*~~

- ~~**B5** To determine if the land can be made suitable for a particular use (or uses) if the site is remediated or managed in accordance with a specified plan.~~

~~Intended uses of the land:~~

Nature of statutory requirements (not applicable for non-statutory audits)

- ~~Requirements under the *Contaminated Land Management Act 1997* (e.g. management order; please specify, including date of issue)~~

- ~~Requirements imposed by an environmental planning instrument (please specify, including date of issue)~~

- Development consent requirements under the *Environmental Planning and Assessment Act 1979* (please specify consent authority and date of issue)

Development Consent DA 854/2013 issued by Camden Council and dated 28/01/2014

- ~~Requirements under other legislation (please specify, including date of issue)~~

Overall comments:

The original site audit notification for The Heritage residential development site was issued by Dr Ian Swane on 4/09/12. The development is being undertaken by Sekisui House in a staged manner. Dr Swane has since issued 6 SASs/SARs numbered 233, 233B – 233F. The last SAS/SAR (numbered 233F) was issued on 5/10/17 for the part of The Hermitage Estate where a public school is to be constructed. Sekisui House requires additional site audit work to be undertaken. The Site Auditor's circumstances have since changed as he no longer works for Jacobs Australia.

Auditor's declaration

I certify that the information supplied in this form and any attached pages is, to the best of my knowledge, true, accurate and complete.

I am aware that there are penalties under the *Contaminated Land Management Act 1997* for wilfully making false or misleading statements.



Signed

Date **31 May 2018**

Please send completed forms to:

NSW Environment Protection Authority

nswauditors@epa.nsw.gov.au or as specified by the EPA

Figure 1 Staging Plan for The Hermitage Estate Residential Development

(Source: Figure 6, Ref [14])

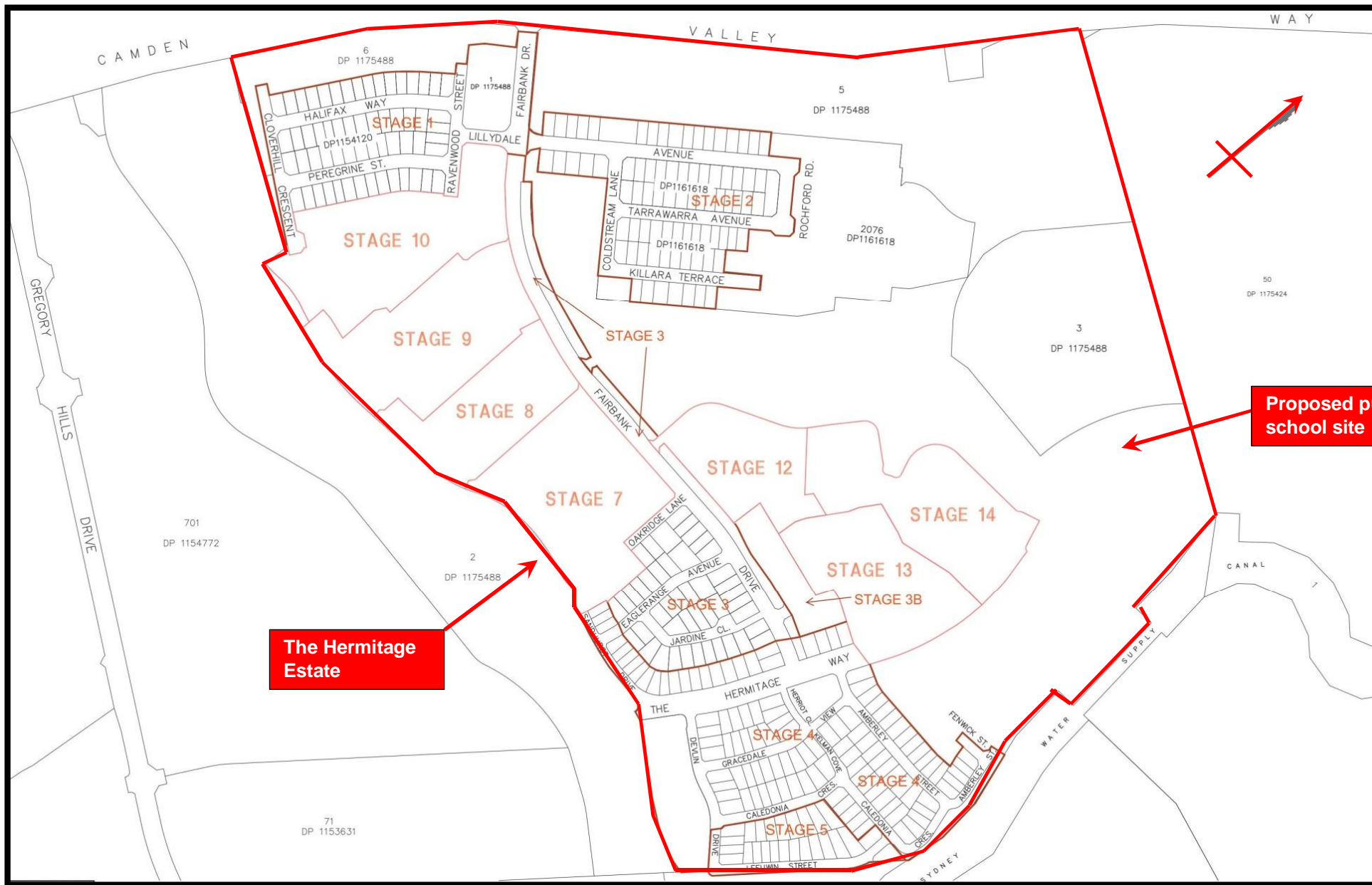
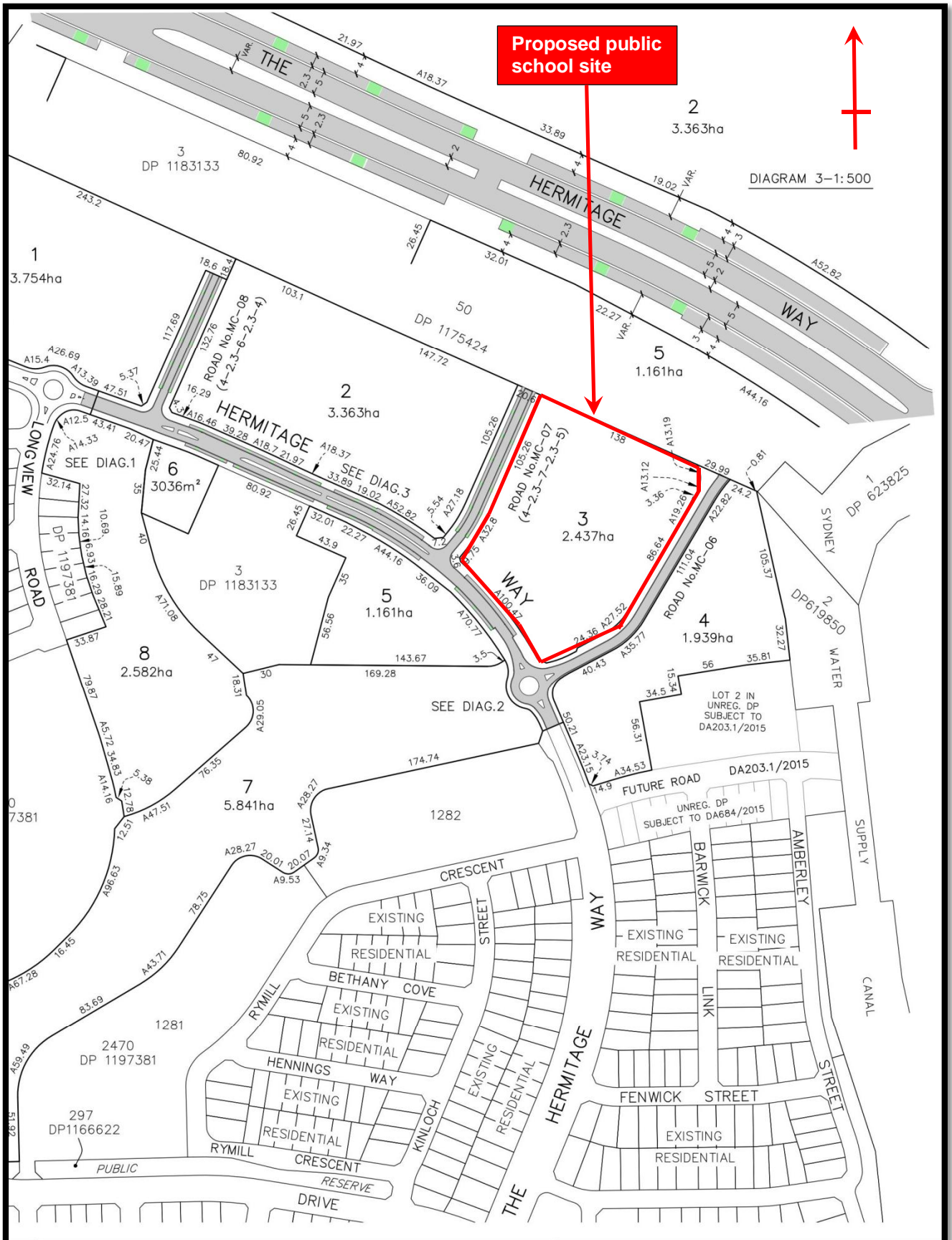

Figure 2 Site Survey Plan

(Source: Ref [32])



 <p>YSCO GEOMATICS LAND RESOURCE CONSULTANTS</p> <p>SUITE 4, 114 HAMPDEN ROAD, ARTARMON, 2064 PH: (02) 94198222 FAX: (02) 94194762 Email: enquiries@yscogeomatics.com.au Website: www.yscogeomatics.com.au YOUDALE STRONKOW & COMPANY PTY LTD A.C.N. 002 819 865</p>	<p>GEOMATIC ENGINEERING LAND & ENGINEERING SURVEYING PROJECT MANAGEMENT SOIL AND WATER MANAGEMENT ENVIRONMENTAL PLANNING & DESIGN</p> <p> Liability limited by a scheme approved under Professional Standards Legislation</p>	<p>PLAN OF PROPOSED SUBDIVISION OF LOT 2467&2471 IN DP1197381, LOT 1284 IN DP1200894 AND LOTS 1&2 IN DP1183133 AT THE HERMITAGE ESTATE - GLEDSDOOD HILLS, CAMDEN LGA</p>			
		<p>DRAWN: 7 OCT. 2015</p>	<p>CHECKED: VK</p>	<p>SCALE: 1:2000 © A1</p>	<p>DATUM: N/A</p>

San C. Duran