

<b>CLIENT</b> DEPARTMENT OF EDUCATION T + 61 2 9561 1927 F + 61 2 9561 8077	
<b>BUILDER</b> RICHARD CROOKES CONSTRUCTIONS T + 61 2 9902 4700 F + 61 2 943 1114	
<b>PROJECT MANAGER</b> SAVILLS AUSTRALIA T + 61 2 8913 4612	
<b>LANDSCAPE CONSULTANT</b> CONTEXT T + 61 2 8244 8900	
<b>STRUCTURAL &amp; CIVIL CONSULTANT</b> SCP T + 61 2 9267 8312	
<b>GEOTECHNICAL CONSULTANT</b> J+K GROUP T + 61 2 9688 5000	
<b>MECHANICAL CONSULTANT</b> ACES T + 61 2 9336 3200	
<b>ELECTRICAL CONSULTANT</b> PRO ELECTRICAL T + 61 2 9651 3455	
<b>HYDRAULIC CONSULTANT</b> SPARKS & PARTNERS T + 61 2 9691 5033	
<b>NCO/BCA CONSULTANT</b> BLACKETT MAGUIRE + GOLDSMITH T + 61 2 9211 7777	
<b>ACCESS CONSULTANT</b> MORRIS GOODING T + 61 2 9692 8322	
<b>SITE INVESTIGATION &amp; ENVIRONMENTAL ASSESSMENT</b> COFFEY T + 61 2 9408 1000	
<b>TRAFFIC CONSULTANT</b> ARUP T + 61 2 9320 9320	
<b>BIODIVERSITY CONSULTANT</b> UBM ECOLOGICAL T + 61 2 4567 7979	
<b>ARBORIST</b> REDGUM HORTICULTURAL T + 61 2 8824 8314	
<b>EUROPEAN AND ABORIGINAL ARCHAEOLOGY</b> EXTENT T + 61 2 9555 4000	
<b>ACOUSTIC CONSULTANT</b> WHITE NOISE T + 61 498 728 303	
<b>WASTE MANAGEMENT CONSULTANT</b> FORESIGHT ENVIRONMENTAL T + 61 2 9303 7270	
<b>WIND &amp; REFLECTIVITY CONSULTANT</b> WINDTECH T + 61 2 9503 0300	
<b>3D RENDERER</b> NARRATIVE T + 61 439 295 296	
<b>LAND SURVEYOR</b> LTS LOCKLEY T + 1300 587 000	
<b>QUANTITY SURVEYOR</b> TURNER & TOWNSEND T + 61 2 8245 0000	
<b>TOWN PLANNER &amp; SOCIAL IMPACT CONSULTANT</b> URBIS T + 61 2 8233 9900	

NSW Nominated Architects: Robert Denton Reg. No. 5782, Alex Kibble Reg. No. 6015  
Do not scale drawings. Verify all dimensions on site. Notify architect of all discrepancies

Rev	Date	Description	Checked	Auth.
P1	08.12.17	Issue For SSDA	AH	AK
P2	20.04.18	Response to Submissions	AH	AK
A	12.03.20	Level 4 Phasing	AH	AK
B	06.04.20	Sportsfield Modification	AH	AK
C	08.12.20	Sportsfield Modification	AH	AK
D	08.03.22	Sportsfield Mid-Way Stair Modification	AH	AK

**NOT FOR CONSTRUCTION**

Project  
**ALEXANDRIA PARK  
COMMUNITY SCHOOL**

Drawing Title  
**PROPOSED SITE PLAN -  
COMPLETED PROJECT**

Proj. Dir	Proj. Arch	Drawn	
AK	AH	HC	
Job No.	Sheet	Scale	
161044	B1	1 : 1000	
Drawing No.			Revision
			<b>D</b>

**AR.DA. 1101**  
Tanner Kibble Denton Architects Pty Ltd  
PO Box 660 Darlinghurst NSW 1500 Australia  
Level 1, 19 Foster Street, Surry Hills NSW 2010 Australia  
T + 61 2 9261 4399  
F + 61 2 9281 4337  
www.tkda.com.au



**1 PROPOSED SITE PLAN - COMPLETED PROJECT**  
1 : 1000

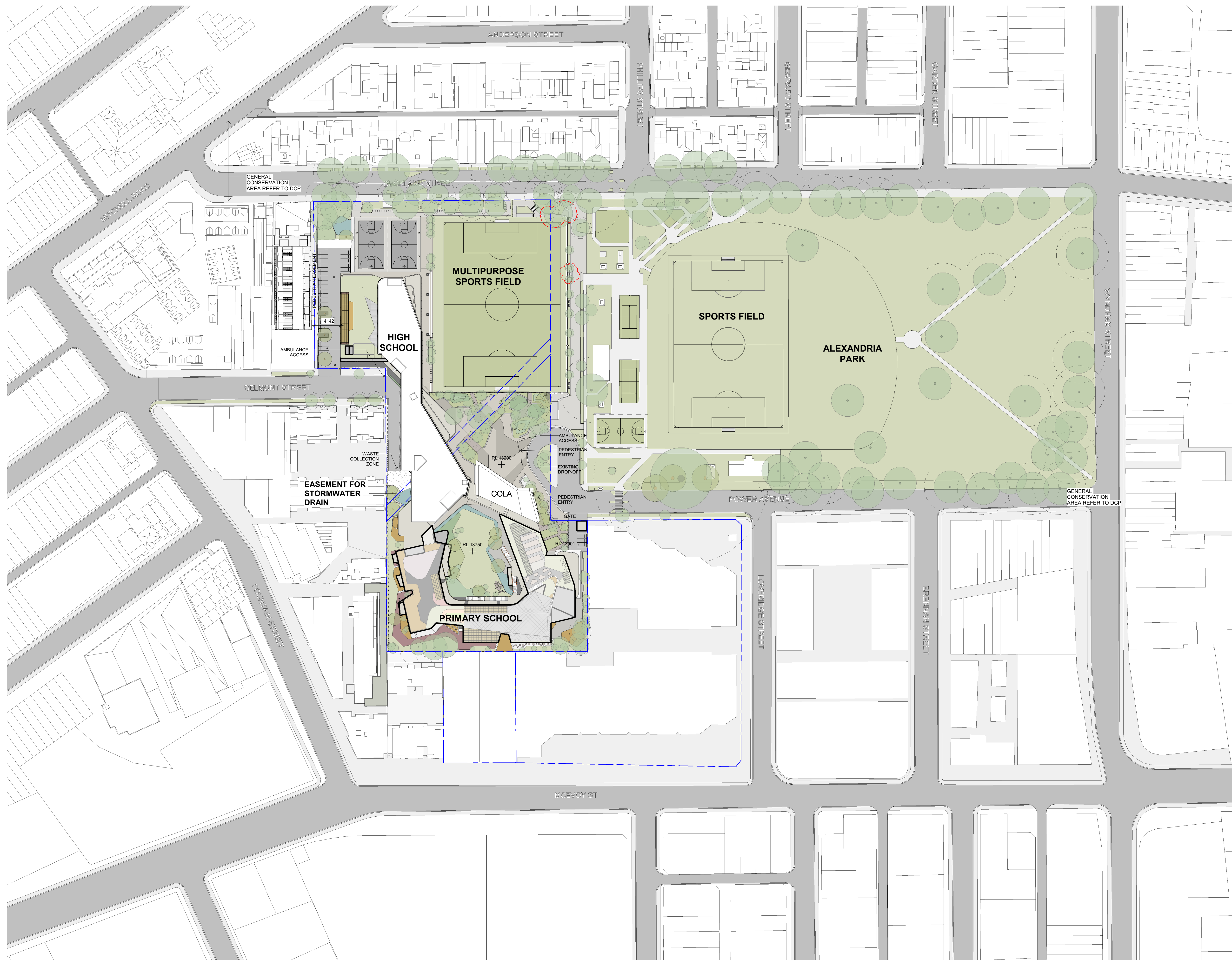

CLIENT  
DEPARTMENT OF EDUCATION  
T + 61 2 9561 1927  
F + 61 2 9561 8077

BUILDER  
RICHARD CROOKES CONSTRUCTIONS  
T + 61 2 9902 4700  
F + 61 2 943 1114

PROJECT MANAGER  
SAVILLS AUSTRALIA  
T + 61 2 8913 4612

LANDSCAPE CONSULTANT  
CONTEXT  
T + 61 2 8244 8900

STRUCTURAL & CIVIL CONSULTANT  
SCP  
T + 61 2 9267 9312

GEOTECHNICAL CONSULTANT  
J+K GROUP  
T + 61 2 9688 5000

MECHANICAL CONSULTANT  
ACES  
T + 61 2 9336 3200

ELECTRICAL CONSULTANT  
PRO ELECTRICAL  
T + 61 2 9651 3455

HYDRAULIC CONSULTANT  
SPARKS & PARTNERS  
T + 61 2 9691 5033

NCC/BCA CONSULTANT  
BLACKETT MAGUIRE + GOLDSMITH  
T + 61 2 9211 7777

ACCESS CONSULTANT  
MORRIS GOODING  
T + 61 2 9692 9322

SITE INVESTIGATION & ENVIRONMENTAL ASSESSMENT  
COFFEY  
T + 61 2 9408 1000

TRAFFIC CONSULTANT  
ARUP  
T + 61 2 9320 9320

BIODIVERSITY CONSULTANT  
UBM ECOLOGICAL  
T + 61 2 4567 7979

ARBORIST  
REDGUM HORTICULTURAL  
T + 61 2 8824 8314

EUROPEAN AND ABORIGINAL ARCHAEOLOGY  
EXTENT  
T + 61 2 9555 4000

ACOUSTIC CONSULTANT  
WHITE NOISE  
T + 61 498 728 303

WASTE MANAGEMENT CONSULTANT  
FORESIGHT ENVIRONMENTAL  
T + 61 2 9303 7270

WIND & REFLECTIVITY CONSULTANT  
WINDTECH  
T + 61 2 9503 0300

3D RENDERER  
NARRATIVE  
T + 61 439 295 296

LAND SURVEYOR  
LTS LOCKLEY  
T + 1300 587 000

QUANTITY SURVEYOR  
TURNER & TOWNSEND  
T + 61 2 8245 0000

TOWN PLANNER & SOCIAL IMPACT CONSULTANT  
URBIS  
T + 61 2 8233 9900

NSW Nominated Architects: Robert Denton Reg. No. 5782, Alex Kibble Reg. No. 6015  
Do not scale drawings. Verify all dimensions on site. Notify architect of all discrepancies

Rev	Date	Description	Checked	Auth.
A	12.03.20	Level 4 Phasing	AH	AK
B	06.04.20	Sportsfield Modification	AH	AK
C	08.12.20	Sportsfield Modification	AH	AK
D	08.03.22	Sportsfield Mid-Way Stair Modification	AH	AK

**NOT FOR CONSTRUCTION**

Project  
**ALEXANDRIA PARK COMMUNITY SCHOOL**

Drawing Title  
**PROPOSED SITE PLAN PHASE 2 COMPLETION**

Proj. Dir	Proj. Arch	Drawn
AK	AH	LEG
Job No.	Sheet	Scale
161044	B1	1 : 1000
Drawing No.	Revision	
AR.DA. 1102	D	

Tanner Kibble Denton Architects Pty Ltd  
PO Box 660 Darlinghurst NSW 1300 Australia  
Level 1, 19 Foster Street, Surry Hills NSW 2010 Australia  
T + 61 2 9261 4399  
F + 61 2 9281 4337  
www.tkda.com.au



**1** PROPOSED SITE PLAN - PHASE 2  
1 : 1000

NSW Nominated Architect: Robert Denton Reg. No. 5782, Alex Kibble Reg. No. 6015  
Do not scale drawings. Verify all dimensions on site. Notify architect of all discrepancies

Rev	Date	Description	Checked	Auth.
P1	08.12.17	Issue For SSDA	AH	AK
P2	20.04.18	Response to Submissions	AH	AK
A	12.03.20	Level 4 Phasing	AH	AK
B	06.04.20	Sportsfield Modification	AH	AK
C	08.12.20	Sportsfield Modification	AH	AK
D	08.03.22	Sportsfield Mid-Way Stair Modification	AH	AK

**NOT FOR CONSTRUCTION**

Project  
**ALEXANDRIA PARK  
COMMUNITY SCHOOL**

Drawing Title  
**EXISTING AND PROPOSED  
SITE PLANS**

Proj. Dir	Proj. Arch	Drawn
AK	AH	HC
Job No.	Sheet	Scale
161044	B1	1 : 500
Drawing No.	Revision	
AR.DA. 1201	D	

Tanner Kibble Denton Architects Pty Ltd  
PO Box 680 Darlinghurst NSW 1300 Australia  
Level 1, 19 Foster Street, Surry Hills NSW 2010 Australia  
T + 61 2 9281 4399  
F + 61 2 9281 4337  
www.tkda.com.au

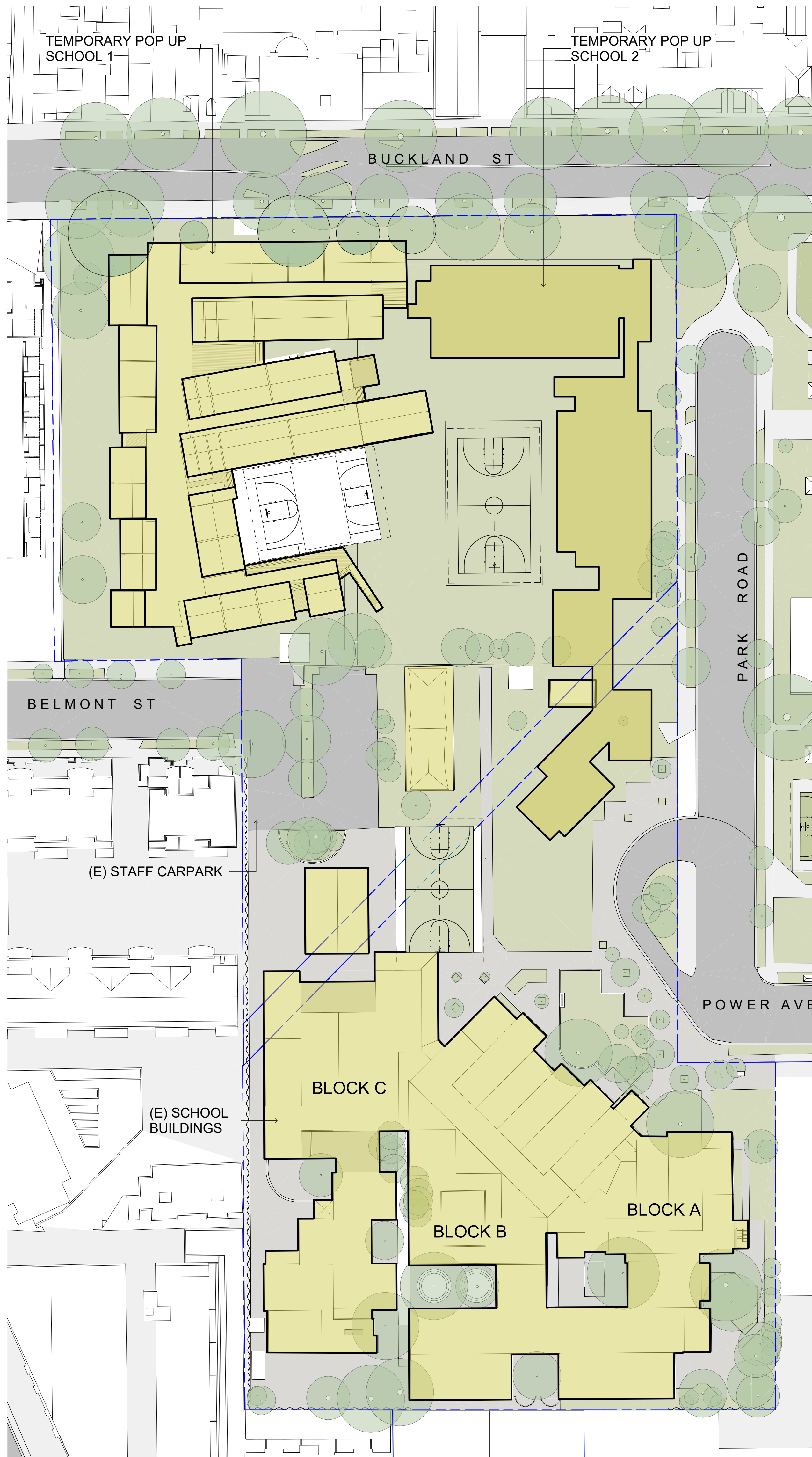

**1** EXISTING SITE PLAN DECEMBER 2017  
1 : 500

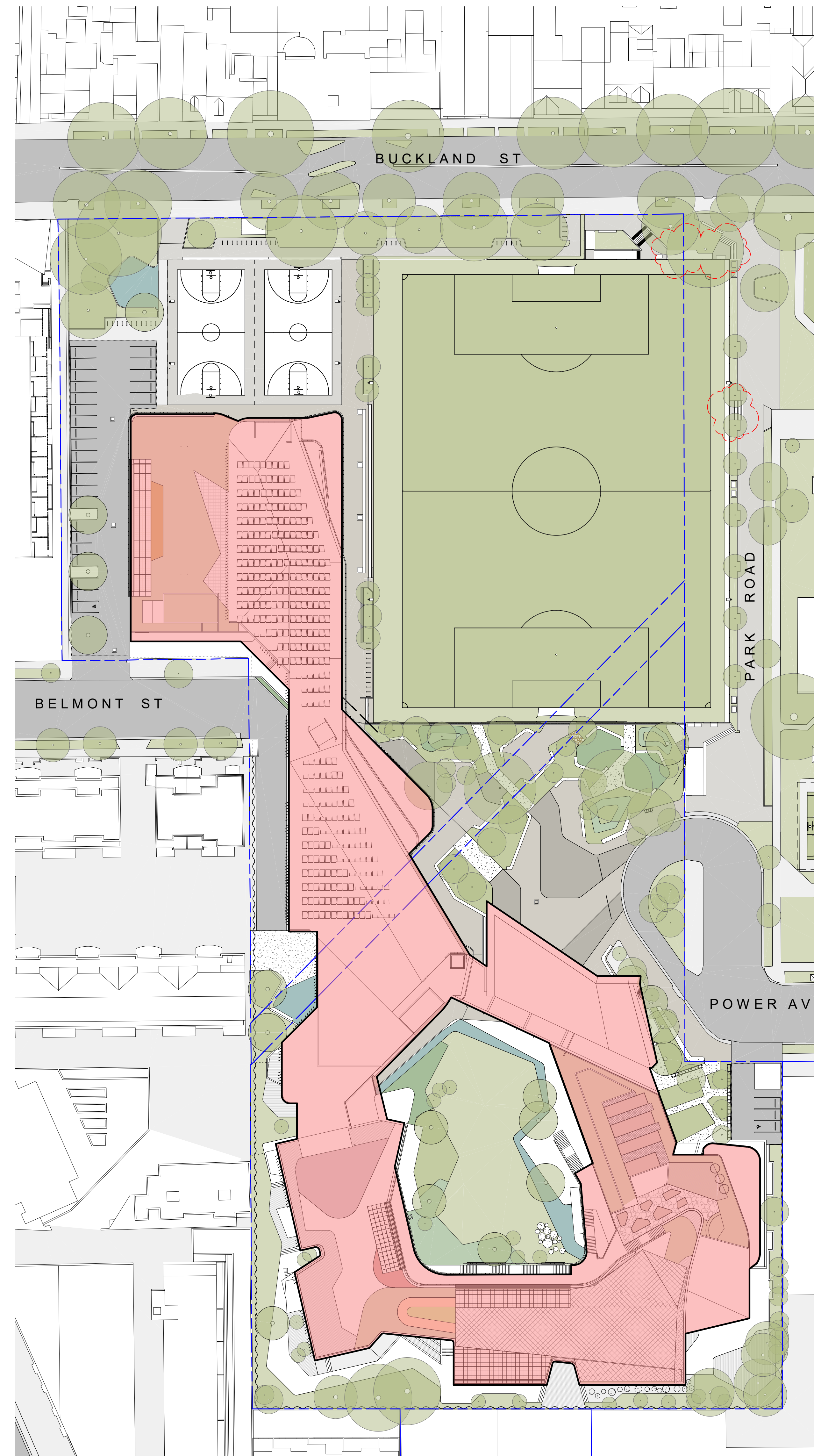

**3** PROPOSED SITE PLAN AT COMPLETION OF PROJECT  
1 : 500

CLIENT  
DEPARTMENT OF  
EDUCATION  
T + 61 2 9561 1927  
F + 61 2 9561 9077

BUILDER  
RICHARD CROOKES  
CONSTRUCTIONS  
T + 61 2 9602 4700  
F + 61 2 9693 1114

PROJECT MANAGER  
SAVILLS AUSTRALIA  
T + 61 2 8913 4612

LANDSCAPE CONSULTANT  
CONTEXT  
T + 61 2 8244 8900

STRUCTURAL & CIVIL CONSULTANT  
SCP  
T + 61 2 9267 9312

GEOTECHNICAL CONSULTANT  
J&K GROUP  
T + 61 2 9688 5000

MECHANICAL CONSULTANT  
ACES  
T + 61 2 9336 3200

ELECTRICAL CONSULTANT  
PRO ELECTRICAL  
T + 61 2 9651 3455

HYDRAULIC CONSULTANT  
SPARKS & PARTNERS  
T + 61 2 9691 5033

NCO/BCA CONSULTANT  
BLACKETT MAGUIRE + GOLDSMITH  
T + 61 2 9211 7777

ACCESS CONSULTANT  
MORRIS GODING  
T + 61 2 9692 9322

SITE INVESTIGATION & ENVIRONMENTAL ASSESSMENT  
COFFEY  
T + 612 9406 1000

TRAFFIC CONSULTANT  
ARUP  
T + 612 9320 9320

BIODIVERSITY CONSULTANT  
UBM ECOLOGICAL  
T + 612 4567 7979

ARBORIST  
REDGUM HORTICULTURAL  
T + 612 8824 8314

EUROPEAN AND ABORIGINAL ARCHAEOLOGY  
EXTENT  
T + 612 9555 4000

ACOUSTIC CONSULTANT  
WHITE NOISE  
T + 61 498 728 303

WASTE MANAGEMENT CONSULTANT  
FORESIGHT ENVIRONMENTAL  
T + 612 9003 7270

WIND & REFLECTIVITY CONSULTANT  
WINDTECH  
T + 612 9503 0300

3D RENDERER  
NARRATIVE  
T + 61 439 295 296

LAND SURVEYOR  
LTS LOCKLEY  
T + 1300 587 000

QUANTITY SURVEYOR  
TURNER & TOWNSEND  
T + 612 8245 0000

TOWN PLANNER & SOCIAL IMPACT CONSULTANT  
URBIS  
T + 612 8233 9900

**Legend**

- Existing Building
- Completed Building
- Under Construction

NSW Nominated Architects: Robert Denton Reg. No. 5782, Alex Kibble Reg. No. 6015  
Do not scale drawings. Verify all dimensions on site. Notify architect of all discrepancies

Rev	Date	Description	Checked	Auth.
P1	08.12.17	Issue For SSDA	AH	AK
P2	20.04.18	Response to Submissions	AH	AK
A	12.03.20	Level 4 Phasing	AH	AK
B	06.04.20	Sportsfield Modification	AH	AK
C	08.12.20	Sportsfield Modification	AH	AK
D	08.03.22	Sportsfield Mid-Way Stair Modification	AH	AK

**NOT FOR CONSTRUCTION**

Project  
**ALEXANDRIA PARK  
COMMUNITY SCHOOL**

Drawing Title  
**PHASE 2 - CONSTRUCTION  
EXTENT**

Proj. Dir	Proj. Arch	Drawn
AK	AH	HC
Job No.	Sheet	Scale
161044	B1	1 : 500
Drawing No.	Revision	
AR.DA. 1203	D	

Tanner Kibble Denton Architects Pty Ltd  
PO Box 660 Darlinghurst NSW 1300 Australia  
Level 1, 19 Foster Street, Surry Hills NSW 2010 Australia  
T +61 2 9261 4399  
F +61 2 9281 4337  
www.tkda.com.au

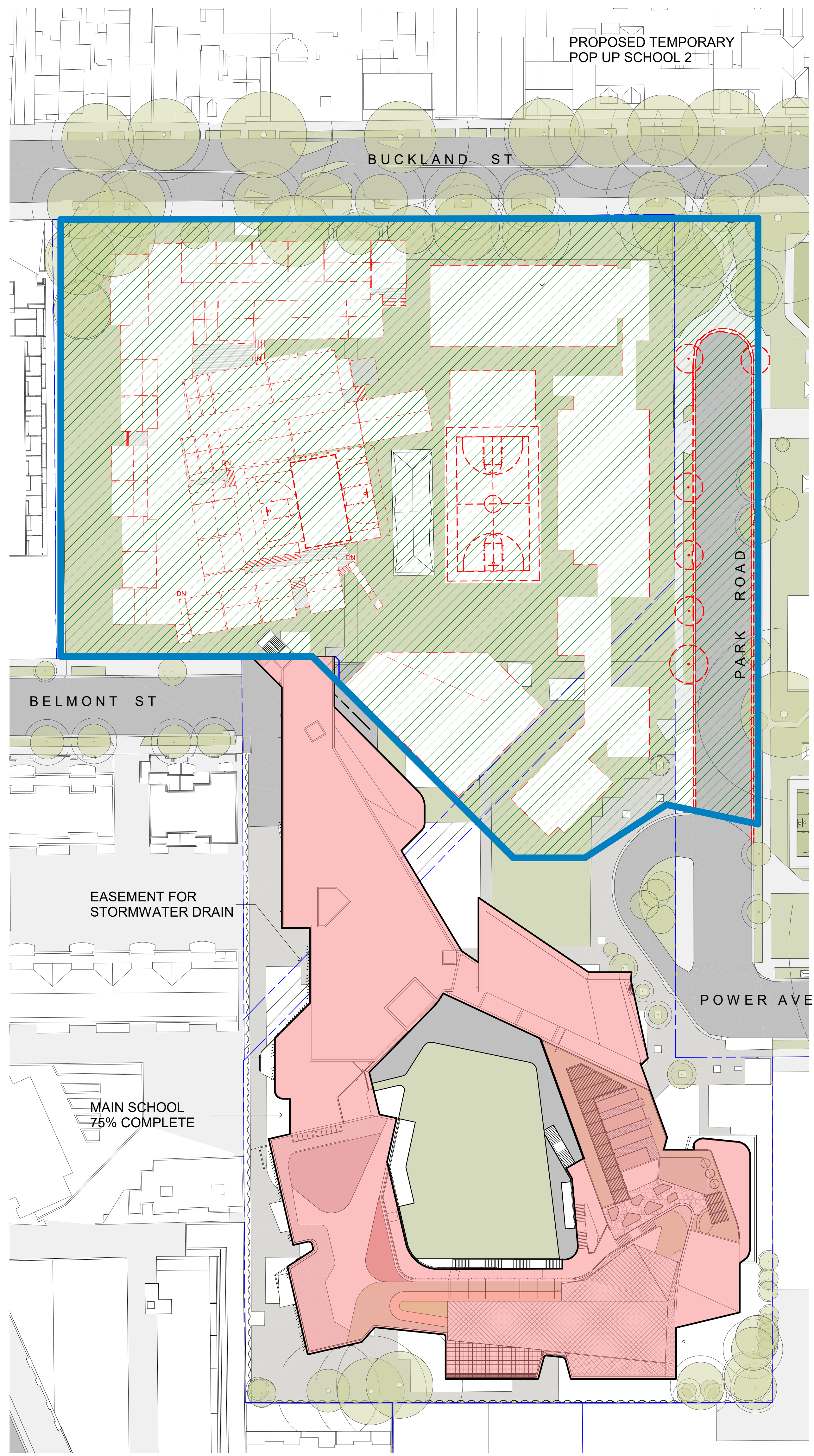

75% Permanent School complete and occupied.  
Temporary School 2 Demolished  
Temporary School 1 Demolished

**2 PHASE 2 DEMOLITION**  
1 : 500

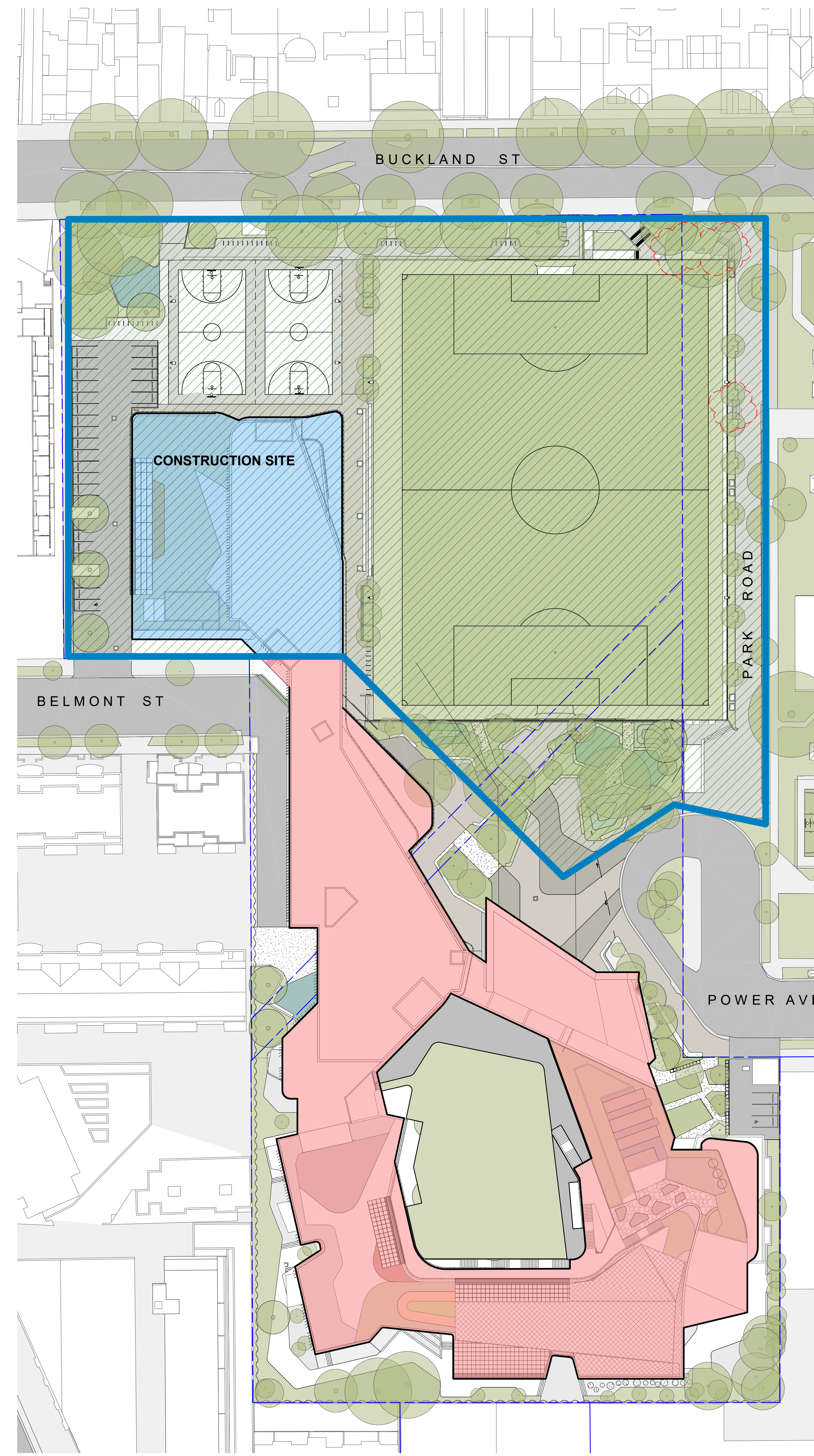

75% Permanent School complete and occupied.  
Temporary School 2 Occupied  
Temporary School 1 Demolished  
Remaining High School Hubs and Gym under construction.

**1 PHASE 2 CONSTRUCTION**  
1 : 500

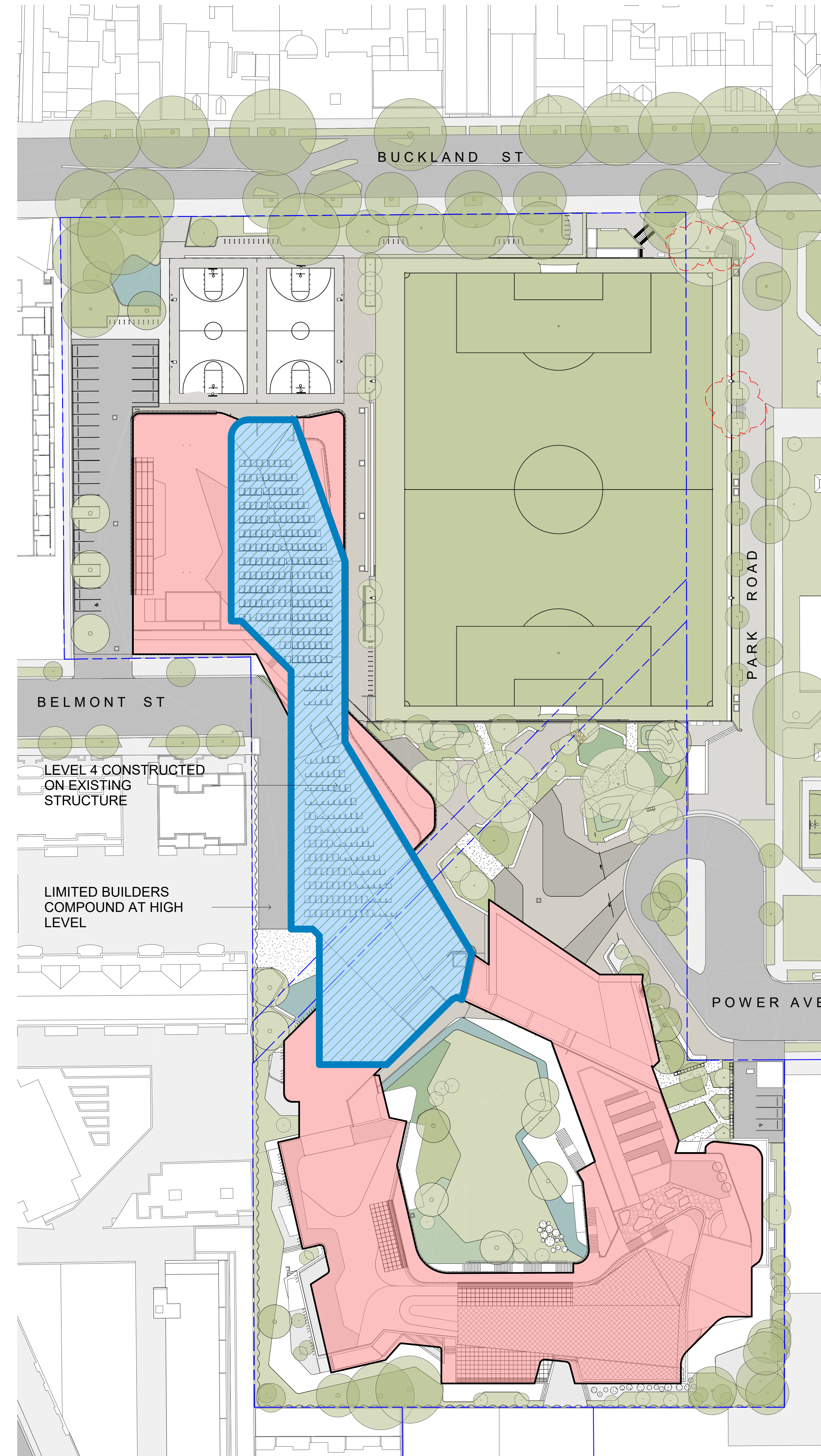

NSW Nominated Architects: Robert Denton Reg. No. 5782, Alex Kibble Reg. No. 6015  
 Do not scale drawings. Verify all dimensions on site. Notify architect of all discrepancies

Rev	Date	Description	Checked	Auth.
P1	08.12.17	Issue For SSDA	AH	AK
A	12.03.20	Level 4 Phasing	AH	AK
B	06.04.20	Sportsfield Modification	AH	AK
C	08.12.20	Sportsfield Modification	AH	AK
D	08.03.22	Sportsfield Mid-Way Stair Modification	AH	AK

**NOT FOR CONSTRUCTION**

Project  
**ALEXANDRIA PARK COMMUNITY SCHOOL**

Drawing Title  
**PHASE 3 - CONSTRUCTION EXTENT**

Proj. Dir	Proj. Arch	Drawn
Approver AK	DS	
Job No.	Sheet	Scale
161044	B1	1 : 500
Drawing No.	Revision	
AR.DA. 1204	D	

Tanner Kibble Denton Architects Pty Ltd  
 PO Box 660 Darlinghurst NSW 1300 Australia  
 Level 1, 19 Foster Street, Surry Hills NSW 2010 Australia  
 T +61 2 9261 4399  
 F +61 2 9281 4337  
 www.tkda.com.au

CLIENT  
DEPARTMENT OF  
EDUCATION  
T + 61 2 9561 1927  
F + 61 2 9561 9077

BUILDER  
RICHARD CROOKES  
CONSTRUCTIONS  
T + 61 2 9602 4700  
F + 61 2 9601 1114

PROJECT MANAGER  
SAVILLS AUSTRALIA  
T + 61 2 8913 4612

LANDSCAPE CONSULTANT  
CONTEXT  
T + 61 2 6244 8900

STRUCTURAL & CIVIL CONSULTANT  
SCP  
T + 61 2 9267 9312

GEOTECHNICAL CONSULTANT  
JHK GROUP  
T + 61 2 9688 5000

MECHANICAL CONSULTANT  
ACES  
T + 61 2 9336 3200

ELECTRICAL CONSULTANT  
PRO ELECTRICAL  
T + 61 2 9651 3455

HYDRAULIC CONSULTANT  
SPARKS & PARTNERS  
T + 61 2 9691 5033

NCC/BCA CONSULTANT  
BLACKETT MAGUIRE + GOLDSMITH  
T + 61 2 9211 7777

ACCESS CONSULTANT  
MORRIS GODING  
T + 61 2 9692 9322

SITE INVESTIGATION & ENVIRONMENTAL ASSESSMENT  
COFFEY  
T + 612 9408 1000

TRAFFIC CONSULTANT  
ARUP  
T + 612 9320 9320

BIODIVERSITY CONSULTANT  
UBM ECOLOGICAL  
T + 612 4567 7979

ARBORIST  
REDGUM HORTICULTURAL  
T + 612 8824 8314

EUROPEAN AND ABORIGINAL ARCHAEOLOGY  
EXTENT  
T + 612 9555 4000

ACOUSTIC CONSULTANT  
WHITE NOISE  
T + 61 498 728 303

WASTE MANAGEMENT CONSULTANT  
FORESIGHT ENVIRONMENTAL  
T + 612 9003 7270

WIND & REFLECTIVITY CONSULTANT  
WINDTECH  
T + 612 9503 0300

3D RENDERER  
NARRATIVE  
T + 61 439 295 296

LAND SURVEYOR  
LTS LOCKLEY  
T + 1300 587 000

QUANTITY SURVEYOR  
TURNER & TOWNSEND  
T + 612 8245 0000

TOWN PLANNER & SOCIAL IMPACT CONSULTANT  
URBIS  
T + 612 8233 9900

NSW Nominated Architect: Robert Denton Reg. No. 5782, Alex Kibble Reg. No. 6015  
Do not scale drawings. Verify all dimensions on site. Notify architect of all discrepancies

Rev	Date	Description	Checked	Auth.
A	12.03.20	Level 4 Phasing	AH	AK
B	08.12.20	Sportsfield Modification	AH	AK
C	08.03.22	Sportsfield Mid-Way Stair Modification	AH	AK

**NOT FOR CONSTRUCTION**

Project  
**ALEXANDRIA PARK  
COMMUNITY SCHOOL**

Drawing Title  
**EXISTING AND PROPOSED  
SITE PLANS - PHASE 2  
COMPLETION**

Proj. Dir	Proj. Arch	Drawn
AK	AH	LEG
Job No.	Sheet	Scale
161044	B1	1 : 500
Drawing No.	Revision	
AR.DA. 1205	C	

Tanner Kibble Denton Architects Pty Ltd  
PO Box 680 Darlinghurst NSW 1300 Australia  
Level 1, 19 Foster Street, Surry Hills NSW 2010 Australia  
T +61 2 9261 4399  
F +61 2 9281 4337  
www.tkda.com.au

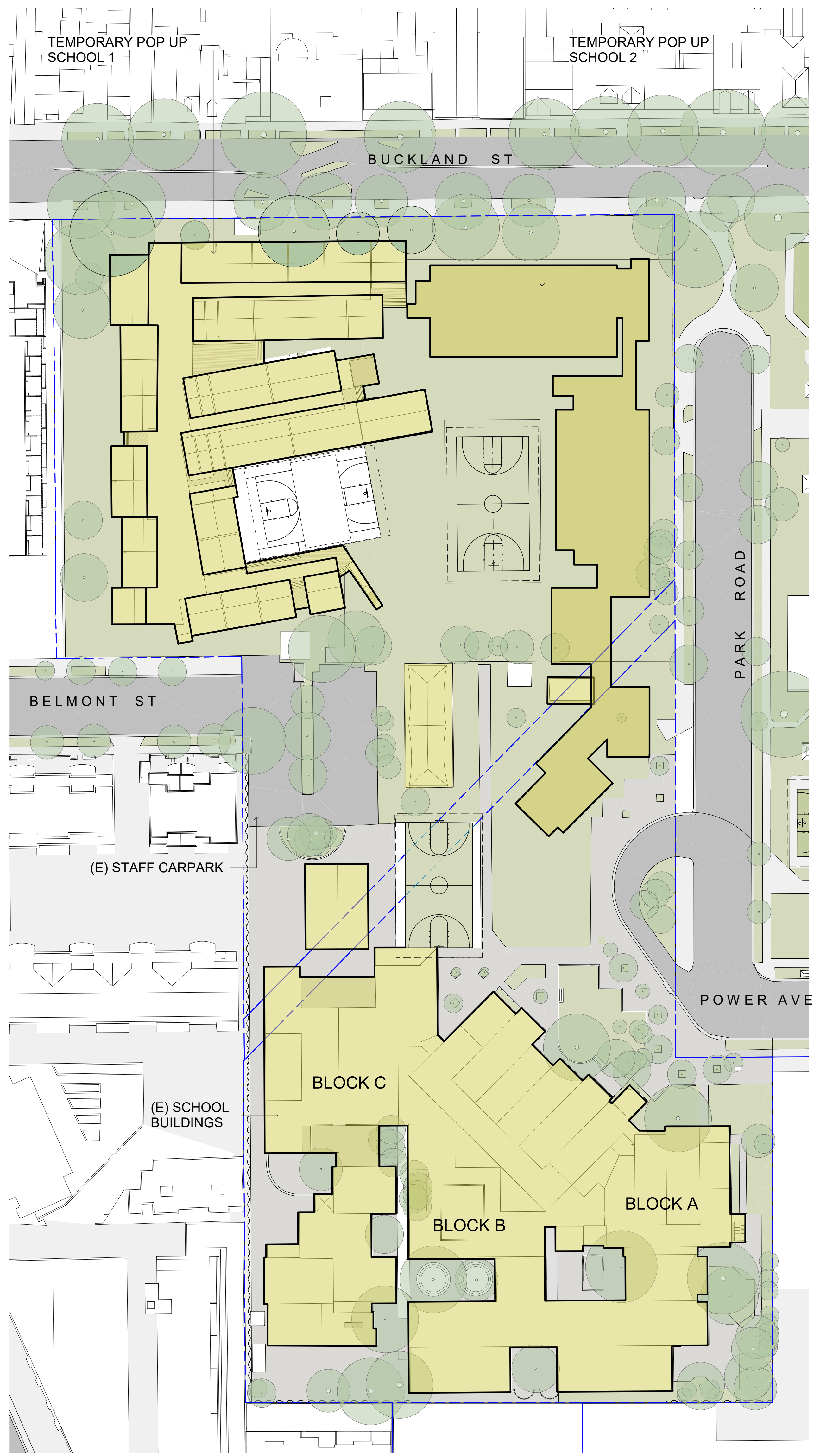

**2** EXISTING SITE PLAN DECEMBER 2017  
1 : 500

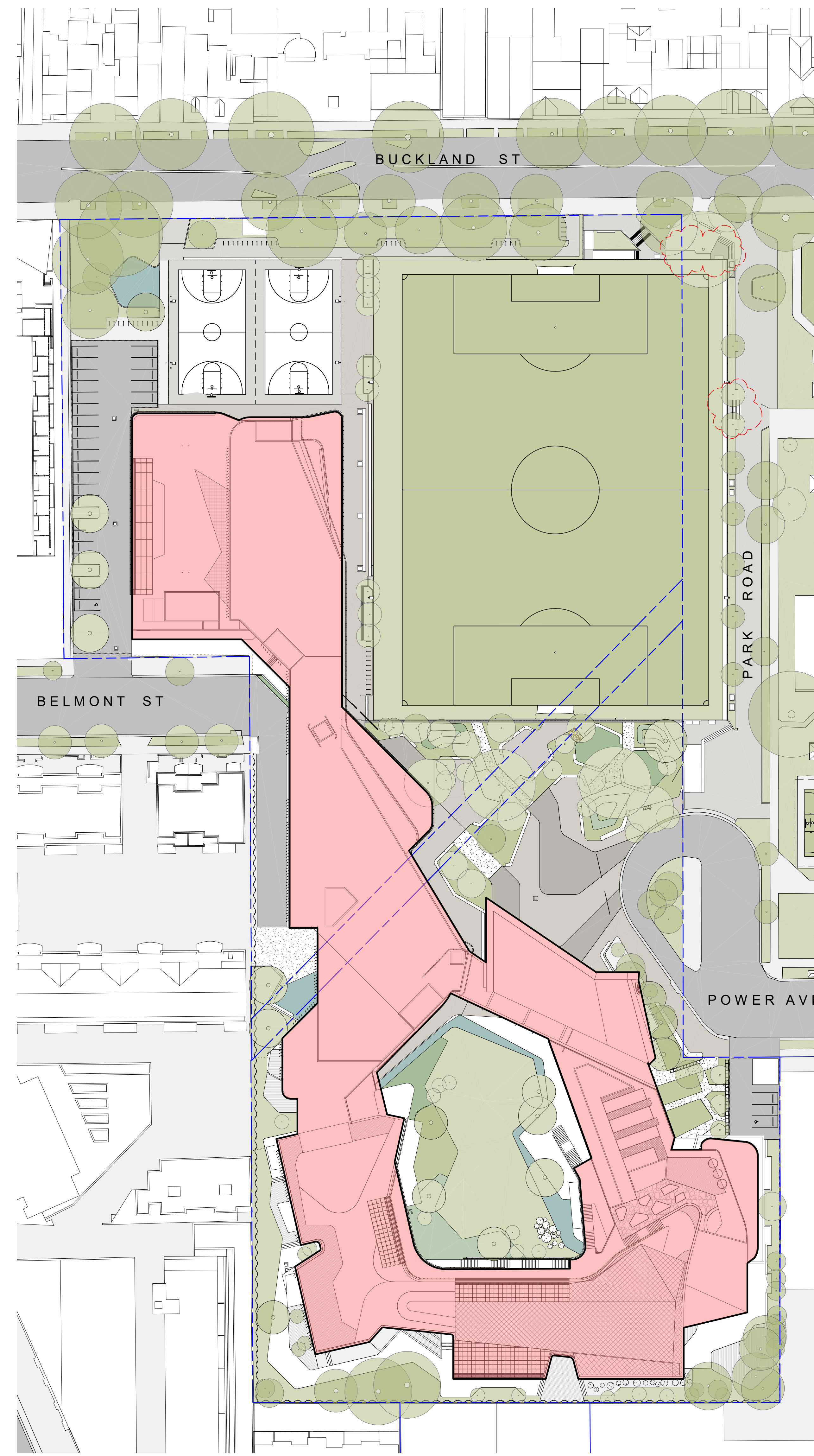

**1** PROPOSED SITE PLAN AT PHASE 2 COMPLETION  
1 : 500

CLIENT  
DEPARTMENT OF  
EDUCATION  
T + 61 2 9561 1927  
F + 61 2 9561 9077

BUILDER  
RICHARD CROOKES  
CONSTRUCTIONS  
T + 61 2 9902 4700  
F + 61 2 943 1114

PROJECT MANAGER  
SAVILLS AUSTRALIA  
T + 61 2 8913 4612

LANDSCAPE CONSULTANT  
CONTEXT  
T + 61 2 6244 8900

STRUCTURAL & CIVIL CONSULTANT  
SCP  
T + 61 2 9267 9312

GEOTECHNICAL CONSULTANT  
JHK GROUP  
T + 61 2 9688 5000

MECHANICAL CONSULTANT  
ACES  
T + 61 2 9336 3200

ELECTRICAL CONSULTANT  
PRO ELECTRICAL  
T + 61 2 9651 3455

HYDRAULIC CONSULTANT  
SPARKS & PARTNERS  
T + 61 2 9691 5033

NCO/BCA CONSULTANT  
BLACKETT MAGUIRE + GOLDSMITH  
T + 61 2 9211 7777

ACCESS CONSULTANT  
MORRIS GODING  
T + 61 2 9692 9322

SITE INVESTIGATION & ENVIRONMENTAL ASSESSMENT  
COFFEY  
T + 61 2 9408 1000

TRAFFIC CONSULTANT  
ARUP  
T + 61 2 9320 9320

BIODIVERSITY CONSULTANT  
UBM ECOLOGICAL  
T + 61 2 4567 7979

ARBORIST  
REDGUM HORTICULTURAL  
T + 61 2 8824 8314

EUROPEAN AND ABORIGINAL ARCHAEOLOGY  
EXTENT  
T + 61 2 9555 4000

ACOUSTIC CONSULTANT  
WHITE NOISE  
T + 61 498 728 303

WASTE MANAGEMENT CONSULTANT  
FORESIGHT ENVIRONMENTAL  
T + 61 2 9093 7270

WIND & REFLECTIVITY CONSULTANT  
WINDTECH  
T + 61 2 9503 0300

3D RENDERER  
NARRATIVE  
T + 61 439 295 296

LAND SURVEYOR  
LTS LOCKLEY  
T + 1300 587 000

QUANTITY SURVEYOR  
TURNER & TOWNSEND  
T + 61 2 8245 0000

TOWN PLANNER & SOCIAL IMPACT CONSULTANT  
URBIS  
T + 61 2 8233 9900

NSW Nominated Architect: Robert Denton Reg. No. 5782, Alex Kibble Reg. No. 6015  
Do not scale drawings. Verify all dimensions on site. Notify architect of all discrepancies

Rev	Date	Description	Checked	Auth.
P2	01.02.18	Issue for Costing	AH	AK
P3	20.04.18	Response to Submissions	AH	AK
P4	24.04.18	Response to Submissions	AH	AK
P5	28.11.18	Response to Submissions	AH	AK
A	06.04.20	Sportsfield Modification	AH	AK
B	08.12.20	Sportsfield Modification	AH	AK
C	08.03.22	Sportsfield Mid-Way Stair Modification	AH	AK

**NOT FOR CONSTRUCTION**

Project  
**ALEXANDRIA PARK  
COMMUNITY SCHOOL**

Drawing Title  
**CAMPUS PLANS - GROUND  
AND FIRST FLOORS**

Proj. Dir	Proj. Arch	Drawn
AK	AH	BO/HC
Job No.	Sheet	Scale
161044	B1	1 : 500
Drawing No.	Revision	
AR.DA. 2001	C	

Tanner Kibble Denton Architects Pty Ltd  
PO Box 660 Darlinghurst NSW 1300 Australia  
Level 1, 19 Foster Street, Surry Hills NSW 2010 Australia  
T + 61 2 9261 4399  
F + 61 2 9281 4337  
www.tkda.com.au

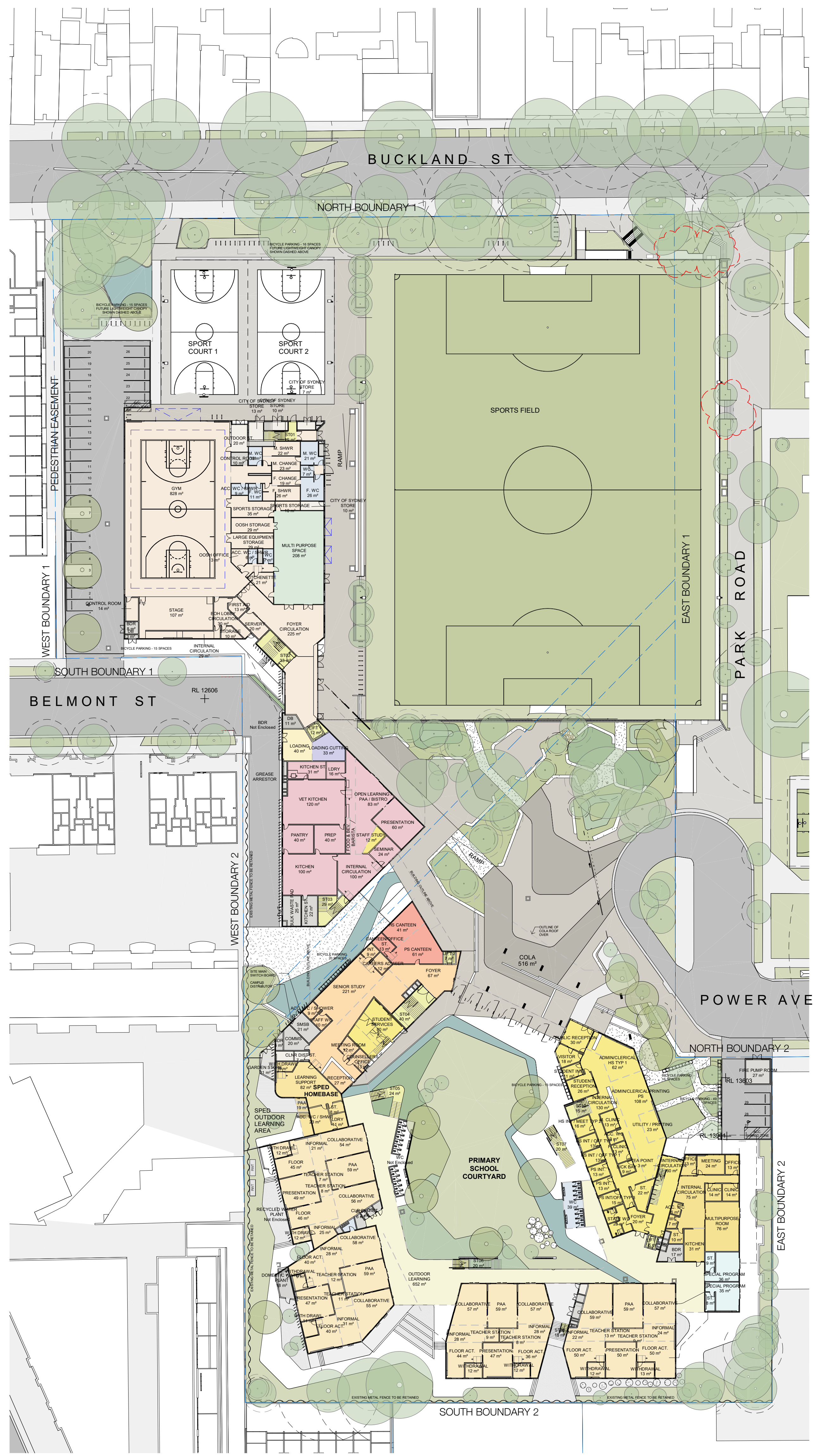

**1 GROUND FLOOR - CAMPUS PLAN**  
1 : 500

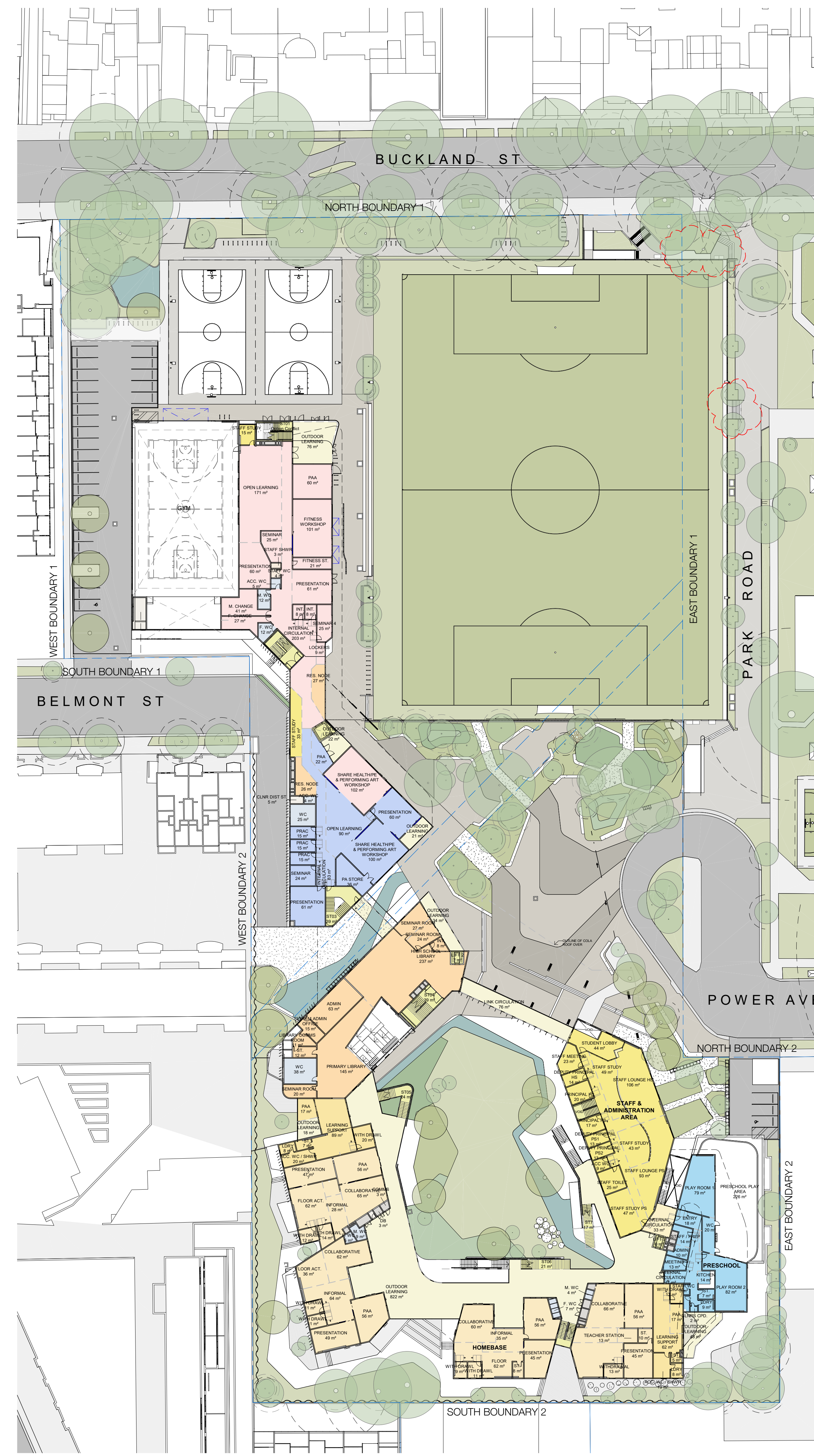

**2 FIRST FLOOR - CAMPUS PLAN**  
1 : 500