Preliminary Construction Management Plan Penshurst Public School

NSW Department of Education

Revision 4
4 October 2018

**ROOT
PARTNERSHIPS**

Advisory+
Project Management

Date	Revision	Prepared	Approved
7/11/17	1	AJ	FL
14/11/17	2	AJ	FL
29/03/18	3	AJ	FL
4/10/18	4	GC	OJ

Copyright, Confidentiality and Circulation

This document is the copyright of Root Partnerships Pty Ltd. It is not to be copied in any form without the written permission of Root Partnerships Pty Ltd and NSW Department of Education.

This document is confidential. It is not to be used for any purpose other than that intended by the issuing party. The contents of this document are not to be conveyed to any person or organisation other than the person to whom it has been issued.

This document is subject to controlled circulation. It is not to be circulated to any person or organisation other than the person it has been issued to without the written permission of Root Partnerships Pty Ltd.

Limitations Statement

In preparing this document, Root Partnerships Pty Ltd has relied upon and presumed accurate certain information (or the absence thereof) provided by government officials and authorities, NSW Department of Education, and others identified herein. Except as otherwise stated in this document, Root Partnerships Pty Ltd has used its best endeavours to verify the accuracy or completeness of any such information. To the extent that such information has proved inconsistent with NSW Department of Education previously stated position, NSW Department of Education has been advised. No warranty or guarantee, whether express or implied, is made with respect to the data reported or to the findings, observations and conclusions expressed in this document.

This document has been prepared on behalf of and for the exclusive use of NSW Department of Education and is subject to and issued in connection with the provisions of the contract between Root Partnerships Pty Ltd and NSW Department of Education. Root Partnerships Pty Ltd accepts no liability or responsibility whatsoever for or in respect of any use of or reliance upon this report by any third party.

The estimates contained in this report were prepared by WT Partnerships for the NSW Department of Education pursuant to the scope of services set out in the contract between WT Partnerships and NSW Department of Education. Root Partnerships Pty Ltd has reproduced WT Partnership's estimates in this report in good faith and has relied upon them in reaching conclusions and making recommendations pursuant to the project. Root Partnerships Pty Ltd has not verified the accuracy or completeness of the WT Partnership's estimates. The WT Partnership's report should be referred to for information on the accuracy and reliability of then WT Partnership's estimates. Root Partnerships Pty Ltd the Departments not accept any liability for the actual costs of the project varying from those estimated.

Level 2, 14 Martin Place
Sydney NSW 2000
T +61 2 8272 9300

Level 12, 500 Collins St
Melbourne VIC 3000
T +61 3 9653 0600

E info@rootpartnerships.com.au
ABN 62 065 072 193

Contents

1	Overview	4
	1.1 Relevant Documents	4
2	Revision List	5
3	References	6
	3.1 Legislation	6
	3.2 Other Documents	6
4	Description of the Works	7
	4.1 Introduction	7
	4.2 Background	8
5	General Management	9
	5.1 Site Establishment	9
	5.2 Preliminary Construction Traffic Management Plan	9
	5.3 Hours of Works	10
	5.4 Construction of Works	11
	5.5 Heritage	11
	5.6 Trees	11
	5.7 Access for Emergency Vehicles and Personnel	12
	5.8 Access for construction personnel	12
	5.9 Access for The Department and Visitors	12
	5.10 No Smoking Policy	12
	5.11 Adjoining Properties	12
	5.12 Noise and Vibration	12
	5.13 Dust and Pollution	13
	5.14 Site Security	13
	5.15 Stakeholder Communication	14
	5.16 Site Signage	14
	5.17 Parking	14
	5.18 Waste Management	14
	5.19 Deliveries	15
6	Daily Tasks	16
	6.1 Prior to Work Commencing	16
	6.2 During Hours of Work	16
7	Record Keeping	17
	7.1 Site Quality Assurance and Daily Records	17

7.2 Incident / Accident Management and Reporting	17
7.3 Waste Management Reporting	17
8 Emergency Procedure	18
Appendix 1 - Preliminary Site Establishment Plan	19

1 Overview

In developing the Preliminary Construction Management Plan (the Plan) to support the State Significant Development Application (SSDA) for the Penshurst Public School project, Root Partnerships confirms the intent that the project has a safe work site for employees, contractors, suppliers, subcontractors, as well as NSW Department of Education (the Department) staff, students, visitors, pedestrians and the travelling public.

The Plan outlines preliminary parameters to allow for reasonable site management practices to be considered prior to the engagement of a suitably qualified Principal Contractor, and provides sufficient detail to support the SSDA for the Works.

It will be the responsibility of the appointed Principal Contractor to prepare and submit for approval a detailed final Construction Management Plan, in accordance with the Works consent, associated approvals and relevant policies, guidelines and legislation, for implementation prior to the commencement of onsite works.

1.1 Relevant Documents

The Plan incorporates and must be read in conjunction with the following technical reports and documentation produced to support the SSDA as follows;

- Site Survey Plan
- Statement of Heritage Impact
- Aborigicultural Impact Assessment
- Traffic Management Plan
- Transport and Accessibility Impact Assessment Report
- Civil Design Package
- Ecologically Sustainability Design Report
- Acoustic Assessment of Works Noise and Vibration Control (Construction Noise and Vibration)
- Hazardous Materials Risk Assessment Report
- Construction Waste Management Plan
- Contamination Management Plan (Remedial Action Plan)

Construction information contained within these technical reports and documentation must be considered by the Principal Contractor and addressed in the preparation of their detailed Construction Management Plan.

2 Revision List

Draft / tender issue of the Plan shall be identified as revision 1, 2, 3, etc. Upon initial issue (generally Contract Award) this shall be changed to a sequential number commencing at revision A.

All copies shall be distributed in accordance with an agreed distribution list. On receipt of a revision, the copyholder shall incorporate the revised pages into their copy of the document.

The document shall be subject to reissue after a practical number of changes have been made.

3 References

3.1 Legislation

- Work Health and Safety NSW
- NSW Environmental Protection Agency

3.2 Other Documents

- Root Partnerships Project Management Plan
- Georges River Council Regulation <http://www.georgesriver.nsw.gov.au/Development/Building-and-Construction/Temporary-Structures>

4 Description of the Works

4.1 Introduction

The Department has prepared an SSDA for the Penshurst Public School project's Works. The project is located at the corner of Arcadia Street and Forest Road, Penshurst; 18 Arcadia Street.



Figure 1: Penshurst Public School project, 18 Arcadia Street, Surry Hills (Google, 2017)

An Environmental Impact Statement (EIS) is an environmental assessment required in accordance with clause 6 and 7 of schedule 2 of the Environmental Planning and Assessment Regulation 2000, and is required as part of the assessment of activities needing approval under NSW legislation for the SSDA.

The EIS examines the significance of likely environmental impacts of the project and the measures required to mitigate any adverse impacts to the environment associated with the Works. The Department of Planning and Environment will be the determining public authority for the SSDA. Prior to determination, comments from RMS, TfNSW and Georges River Council will be sought.

The Works scope comprises the following:

- removal of selected trees (down to existing ground level only)
- site services isolation

- demolition of all Buildings
- construction of temporary works including:
 - on-site truck turning
 - hoardings
 - site amenities
 - support gantry's
 - site services connections
- Removal of hazardous materials
- Remediation of contaminated soils
- Connection of incoming infrastructure services
- Construction of new school facilities

4.2 Background

The population of Sydney is forecast to grow by over one million people in the next 10 years, with noticeable growth in the Hurstville area due to the substantive quantity of residential development. This growth is occurring rapidly, putting pressure on existing public infrastructure including transport, health and education. The Department has a legislative responsibility to provide teaching spaces to meet demand in all areas across NSW. The new Penshurst Public School project proposes to meet this demand in the Hurstville area. The current Penshurst Public School will be redeveloped with staff and students relocated offsite to a temporary facility during the construction period.

Upon completion of the Main Works, the Penshurst Public School proposes to accommodate 1,012 students, assisting in alleviating current enrolment pressures within the Hurstville Local Government Area (LGA). The Penshurst Public School will contain high quality collaborative learning spaces and associated facilities, creating future focused education through new and sustainable buildings.

A building of local heritage significance is proposed to be demolished as part of the redevelopment, refer to the Statement of Heritage Impact for further detail, including details of any archival and interpretation measures required

The completed Penshurst Public School will offer:

- facilities that are readily accessible and flexible to meet the demands of an evolving curriculum in line with future-focused learning principles
- flexible and well-connected teaching and learning spaces that enable a variety of teaching and learning practices
- spaces that are engaging and supportive for students and teachers
- technology-rich settings with an emphasis on mobility and flexibility
- a healthy and environmentally sustainable environment
- innovative, connected outdoor spaces that enable play and collaborative learning
- connected open space, creating a welcoming and accessible school with indoor and outdoor teaching and learning opportunities

New teaching spaces will incorporate principles of energy efficiency and ecologically sustainable development (ESD) including:

- passive design principles
- thermal performance and comfort
- natural lighting
- water recycling management

Works are programmed to commence in early-2019, with completion of the Main Works programmed for mid-2020.

5 General Management

Root Partnerships will manage and coordinate all other project managers, contractors and consultants engaged on the Works, including designated staff from the Department, relevant stakeholders, authorities and agencies.

Planning and implementation of the Works on site, including access to, from and around the site, will be coordinated by Root Partnerships. A site-specific Access Plan will be developed by the Principal Contractor to ensure suitable and safe access is known and maintained at all times between the site and its' interface with Arcadia Street and Forest Road. This will include, but not be limited to, the following:

- temporary signage around the site
- temporary pedestrian crossings
- temporary paths / ramps
- hoardings / protective screens / covers
- temporary lighting

The Access Plan will comply and / or respond to the Georges River Council's temporary structures requirements.

5.1 Site Establishment

Prior to commencement of the Works, the Principal Contractor will complete a thorough Dilapidation Report for the site and the immediately adjoining / impacted properties and submit this to Root Partnerships for review / approval. Due to the local heritage significance of the site, the Dilapidation Report must present an 'archival recording' of the site, with a particular focus on the areas accessed by the Works. This recording is to be carried out in accordance with NSW Heritage Division guidelines and Policy 9 of the Conservation Management Plan, Volume One.

The site will be secured and made safe from the public throughout the Works via the erection of a 1.8m to 2.4m high perimeter fence, including shade cloth hoarding attached where appropriate, along the entire site boundary to prevent unauthorised entry to the site.

The Principal Contractor will prepare and submit for review / approval a site-specific Erosion and Sediment Control Plan (ESCP) which establishes the proposed measures to be implemented within the site to protect adjoining properties and downstream drainage systems. The ESCP will be designed, installed, monitored and maintained in accordance with the -Protection of the Environment Operations Act 1997 and Landcom's Managing Urban Stormwater: Soils and Construction (<http://www.environment.nsw.gov.au/resources/water/BlueBookVol1.pdf>).

Exclusion zones around existing trees to be retained will be demarcated by protection fencing, boarding and wraps, as per the Aboricultural Impact Assessment. The Principal Contractor will prepare and submit for review / approval a site-specific Construction Management Plan that demonstrates protection of trees and other identified vegetation including, but not limited to:

- trees / vegetation to be retained are to be clearly marked, protected and maintained
- trees to be removed are inspected by a suitably qualified person for the presence of fauna immediately prior to their removal
- storage of stockpiles / equipment are to be outside of tree protection / vegetation areas
- the spread / introduction of weeds is to be effectively controlled

5.2 Preliminary Construction Traffic Management Plan

To aid with the planning application a preliminary construction traffic management plan has been developed, please refer to section 7 of the Traffic Assessment Report prepared by TTM for full details.

Generally, the methods of management are summarised below;

The proposed haulage route is shown below;



Construction vehicles will arrive from Penshurst Street and Percival Street onto Arcadia Street and exit along Arcadia Street, turning left onto Forest Road. This is to maintain a single direction of traffic flow on Arcadia Street.

Vehicle access is to be minimised during peak commuter periods along Forest Road (6.00am to 9.00am and 3.00 pm to 7.00pm, Monday to Friday), with call-up / pre-arranged times and strategies in place to avoid / minimise queuing of Works vehicles on approach roads to the site. All heavy goods will be delivered outside of peak traffic hours.

The maximum sized vehicles will be heavy rigid vehicles and rigid truck and dog trailer, both vehicles are legally allowed on the local road system.

Pedestrian management during construction will require the development of a detailed strategy in consultation with Georges River Council.

Temporary Works service supplies for power, water, sewage and communications will be made.

Other management measures to be implemented during construction could include, but are not limited to, the following:

- construction site access locations and management measures
- construction personnel parking controls
- stage by stage construction traffic generation
- impacts of construction on adjoining traffic and pedestrian movements
- temporary signage around the site
- temporary pedestrian crossings
- temporary paths and ramps
- hoardings and site fencing

The Principal Contractor will prepare and submit for review / approval a site-specific Construction Traffic Management Plan to maintain safe vehicle and pedestrian traffic routes throughout the Works. Vehicle entry / exit access points off Arcadia Street and Forest Road are to be managed by fulltime qualified traffic controllers.

5.3 Hours of Works

Construction hours for the Works are requested to be as follows:

- Monday to Friday: 7am to 6pm
- Saturday: 8am to 1pm

No activities are to be undertaken on Sundays and Public Holidays unless approvals have been obtained by the Principal Contractor from Root Partnerships, The Department and the relevant approval authority. The Principal Contractor will need to provide the details and reasons for undertaking Works outside of the standard hours.

It is envisaged that construction works will be required outside of standard hours for, but not limited to;

- delivery of large/oversized goods
- carrying out of activities which would impact on traffic flows (such as craning from the street) so as to minimise those impacts
- carrying out loud/invasive works outside of times when the adjoining school would be impacted etc.

In addition to the items noted above, Works undertaken outside of the standard hours will generally only be considered for special applications when it becomes necessary, such as:

- it is an emergency
- a situation that would create hazardous conditions
- plant breakdowns have delayed an activity that cannot be stopped
- the extended working hours will not impact on The Department's operations

5.4 Construction of Works

The Works shall be undertaken within the standard hours, with the exception of the following restricted work hours / times where an approval has been sought prior by the Principal Contractor from Root Partnerships, the Department and the approval authority for the works to be undertaken:

- delivery / removal of plant / vehicles / equipment to and from site where noise from the operation is managed to not cause disturbance to neighbouring properties
- delivery of material to site where noise from the operation is managed to not cause disturbance to neighbouring properties (Note, pumping of concrete to be undertaken within standard hours only)
- Works within Forest Road and Arcadia Street which need to be carried out at night due to traffic conditions

Deliveries of material to site will be minimised during the morning and afternoon peak traffic hours and all material movements shall be carried out in accordance with contractor's material handling procedures and Construction Traffic Management Plan. Qualified traffic controllers will be in place to safely manage vehicle access to and from site.

The Department staff members and other non-site project team personal must be accompanied by a representative of Root Partnerships or the Principal Contractor while on site. All non-site stakeholders whom require regular access to the site are recommended to undertake the Building Industry Induction Course and obtain a white card.

5.5 Heritage

Refer to the Statement of Heritage Impact by Perumal Murphy Alessi Heritage Consultants for details on the required archival and interpretation measures for the site. All salvageable significant or original fabric identified by the Statement of Heritage Impact, or by Root Partnerships, for removal during the course of the Works are to be stored on site for possible reinstatement at a future date.

5.6 Trees

Trees to be retained are to be managed and protected for the duration of the works in accordance with the Aborigicultural Impact Assessment, particularly Section 4 of the report. This will best assist in reducing the disturbance to the trees nominated to be retained.

5.7 Access for Emergency Vehicles and Personnel

Works will not affect access for emergency vehicles and personnel during the course of the project, however in the event of a particular construction activity that the Departments affect the access path:

- the Principal Contractor shall seek prior approval from Root Partnerships for temporary alternate access
- the Principal Contractor shall ensure the approved temporary alternate access is maintained at all times for emergency vehicles and personnel on and around the site

5.8 Access for construction personnel

Access by the Principal Contractors, subcontractors, workers and visitors to the site will be via the Principal Contractor's site compound located on the eastern boundary. The Principal Contractor will need to consult with the RMS and the local council office for construction vehicle deliveries and waste removal access and coordinate to avoid morning and afternoon peak traffic periods. Qualified traffic controllers will be in place to safely manage vehicle access to and from site. All Principal Contractors personnel will be advised of the requirements of access as part of the site inductions prior to commencing Work on site.

General circulation from the Principal Contractor's site compound and the site will be in accordance with the approved Access Plan.

5.9 Access for The Department and Visitors

At commencement of the Works all The Department school operations will have ceased onsite and been relocated offsite. The Department school staff and students do not need to access the site once Works commence, however should The Department school staff need to access the site, arrangements will be made to suit the Principal Contractor's staging and entry requirements. The final access arrangement will be agreed with the contractor prior to the commencement of the Works.

The Principal Contractor will be responsible for the implementation and management of the approved Access Plan

The Principal Contractor shall ensure suitable and safe access is maintained at all times around the site. The Principal Contractor will consult with Root Partnerships and The Department in the development of the Access Plan.

5.10 No Smoking Policy

The Department promotes smoke free environment and as such, the Principal Contractor is to ensure there is no smoking on site, including within existing buildings site accommodation, amenities, offices, sheds and vehicles.

5.11 Adjoining Properties

As per 5.1 Site Establishment, the Principal Contractor shall undertake a Dilapidation Reports that addresses adjoining properties, including roads and surrounding landscaping.

The Principal Contractor shall inform all construction personnel that the adjoining spaces to the site will remain operational during the course of the Works, and that all construction personnel must behave in an acceptable manner that the Departments not disrupt the daily operations of neighbouring residents, the surrounding road network and its users.

5.12 Noise and Vibration

The Acoustic Assessment of Works Noise and Vibration Control report identifies the general work practices to be implemented by the Principal Contractor to minimise noise and vibration at the source, as well as control of the transmission path between the site and proximate social infrastructure / residential receivers. The Principal Contractor will prepare and submit a Noise and Vibration Management Plan for Georges River Council's review and approval prior to commencement of the Works. This will be informed by the Acoustic Consultants report and is to include, but not be limited to, the following:

- Description of 'noisy' works

- Proposed timing of 'noisy' works and expected noise levels
 - Intra-day respite hours will be implemented where necessary for any works considered to be noise intrusive. This will generally apply to any jack hammering of concrete slabs adjacent to residential noise receivers.
- Noise Complaint management process which will be developed by the Contractor once appointed
- Community Liaison Officer details
- Noise monitoring locations
- Vibration monitoring locations
- Noise control measures such as idling and queuing of construction vehicles being managed to reduce impact on residential receivers. Vehicles will avoid reversing wherever possible to minimise reversing alarms being activated.

5.13 Dust and Pollution

Dust and pollution control during Works will be carried out in accordance with the Principle Contractors approved Construction Environmental Management Plan. Measures will include limiting the volume of material stockpiles on site, shade cloth screens, solid hoardings and the dampening down of loose material in dry / windy conditions.

The Principal Contractor is to ensure that any dust / pollution caused by the Works is actively reduced. Areas worked in by the Principal Contractor will be adequately protected to prevent dust/ pollution spreading to neighbouring properties, pedestrians and Prince Alfred Park users. Specific requirements which will be addressed are;

- The Site will implement a sedimentation and erosion control plan to EPA guidelines. Sediment control measures will be inspected daily to retain effectiveness
- All waste materials to be removed will be assessed, classified and managed in accordance with 'Waste Classification Guidelines Part 1: Classifying Waste.
- Asbestos management will be carried out according to the Contractor's Asbestos Works Management Plan (once the Contractor is appointed) and which will be assessed by the Site Auditor. This will include how to deal with unexpected finds.
- Dust emissions will be controlled by the following actions;
 - Demolition works will utilise dust suppression by hosing down construction debris
 - Demolition and other contaminated materials will be removed off site in covered dump trucks and trailers
 - Soil stockpiles will be covered with tarpaulins to mitigate dust emissions outside of the site boundaries.
 - Site fences will be covered in shade cloth to minimise dust emissions from the site.

The Principal Contractor shall notify Root Partnerships and the Department in advance of work which may require additional dust / pollution protection.

5.14 Site Security

The Principal Contractors will secure the boundaries of the site for the entire duration of the Works. The external area will be fenced off using temporary fence panels 1.8m to 2.4m in height with shade cloth hoarding attached to help minimise dust, pollution and to assist in presenting a clean and well managed site.

Appropriate signage will be displayed at all access points to the site warning staff, visitors and the general public that an area which is fenced and / or hoarded off is a construction site.

All access points allowing entry to the construction site will be locked at all times with the exception of the main entry gate to the site which will be manned and remain open during standard working hours. The Principal Contractor will issue a key to Root Partnerships to allow access to the site in an emergency situation for emergency services teams only.

The Principal Contractor will prepare and submit for review / approval an Emergency Site Access Procedure (ESAP) for implementation. The EASP will be issued to The Department Security for use after standard hours. Where Root Partnerships or The Department allow access for emergency services teams to the construction site for an emergency situation, notification to the Principal Contractor will be provided immediately, and thereafter in writing of the date and time they have entered the site and an explanation of the emergency situation that arose.

5.15 Stakeholder Communication

The Principal Contractor will prepare and submit for review / approval Monthly Project Updates for uploading onto The Department's Project Management System. The Principal Contractor will outline all site activities and works planned one month in advance, highlighted those which may have an impact to the local community (including residents, businesses, pedestrians and commuters).

A weblink to the monthly updates will be distributed to the local community by email and by letter box drop as required.

Regular stakeholder communication meetings will be established so as to keep key stakeholders informed on key milestones and any changes on and off-site access and impacts.

Communication meetings will include the following:

- Construction Liaison Committee (monthly / when required)
- Site Meetings (weekly)

A Works Contact List is to be provided by the Principal Contractor prior to commencement of the works.

5.16 Site Signage

The Principal Contractor is to submit a proposal covering the extent and design of all proposed temporary signage to be displayed in accordance with the Principal Contractors management plans / systems for Root Partnerships approval.

5.17 Parking

Parking for all Principal Contractor personnel on site is likely not achievable. The Principal Contractor shall ensure that all persons inducted for the Works are advised of this 'No Parking' policy. It is envisaged that most Works personnel will commute to / from site on public transport.

Parking for Principle Contractor's trade vehicles will be in accordance with local parking bylaws and controls set out by relevant authorities.

Refer to the Traffic Assessment Report for further guidance.

5.18 Waste Management

The Principal Contractor will engage a waste professional specialist to prepare and submit for review / approval a site-specific Construction Waste Management Plan (CWMP). The CWMP must:

- be provided in a format appropriate to assist with the Waste Auditor Report, required as part of the future Green Star submission
- aim for a waste diversion target rate of 80%
- provide guidance for waste minimisation from Works activities
- identify and classify the likely waste streams to be generated by the Works
- describe the measures to be implemented to safely manage this waste

The Principal Contractor shall remove all waste from site resulting from the Works. Waste shall be handled in a manner so as to confine the material completely, minimise dust / pollution emissions and disposed of to a standard suitable for approval under the Environmental Planning and Assessment Act, 1979. Suitable areas on site are to be allocated to provide adequate space / access for:

- separated storage of building materials

- separated storage of Works waste
- separated sorting of Works waste
- removal of Works waste for recycling, re-use or landfill

Waste that is unable to be reused or recycled will be disposed of offsite at an EPA-approved waste management facility following classification. Hazardous waste will be correctly labelled, shall not be mixed with non-hazardous waste, securely contained and disposed of by a certified waste carrier for hazardous waste.

Prior to transporting waste materials to offsite facilities, it will be verified that the transporter / facility is licensed to handle the material it is designated to carry / receive.

Refer to the Construction Waste Management Plan, Ecologically Sustainability Design Report and Hazardous Materials Risk Assessment Report.

A third party contractor that provides specialised concrete washout solutions and which utilise specialised trucks that contain all concrete waste and slurries and dispose of these materials off site (e.g. PumperDump) will be used for disposal of concrete waste and clean out slurry. The benefit is that a managed solution is available for a reasonable cost to avoid accidental discharges of slurries off site and also minimise site laydown areas for waste concrete.

Concrete trucks, concrete pumps and (clean out trucks if used) will enter site over a cattle grate wheel shaker to dislodge earth and other materials from tyres before proceeding onto public streets. Wherever necessary wheels will be pressure water washed to remove mud. All such activities will be contained within the site perimeter bounded by the sedimentation and control fence.

Where the Contractor utilises conventional concrete clean out methods, concrete waste and concrete rinse water will be retained on site. Waste water will be evaporated wherever possible.

Solidified concrete waste will be removed in a skip bin.

Wash out from agitator trucks and concrete pump lines will be directed into leak proof sedimentation and settlement ponds, where the wash out water will be allowed to settle to remove suspended solids. These ponds will be regularly cleaned to ensure minimum depths are maintained to aid in settlement of sediments.

Water from sedimentation and settlement ponds will be evaporated and not directed to stormwater point of discharge. On no account will water containing any slurry or fines be allowed to leave the site. In times of heavy rain the contractor will ensure that sedimentation ponds are checked to ensure overflow of sediment or slurry containing water is prevented from leaving the site.

5.19 Deliveries

Deliveries to the site will be minimised during the morning and afternoon peak traffic periods and in accordance with the standard work hours. The Principal Contractor will be responsible for producing and adhering to a traffic management plan.

6 Daily Tasks

6.1 Prior to Work Commencing

The Principal Contractor Site Supervisor will carry out the following operations to ensure acceptable safety at all times, before work starts:

1. Obtain all necessary construction traffic permits
2. Letter box drop to local community advising of the commencement of works and programme of activities
3. Complete Dilapidation Report for the site and adjoining properties
4. Daily prestart toolbox talks with all personnel
5. Inspect all signs / devices, note any signs out of place / damaged overnight and rectify as soon as possible
6. Inspect all emergency / pedestrian egress paths and ensure that they are clear of Works plant, vehicles, equipment, materials, stockpiles and waste
7. Make the programmed adjustments to the site management provisions for the day
8. Check for safety and effectiveness of site management provisions by an inspection around the site
9. Maintain, regularly clean and repair / replace signs and devices as necessary
10. Check all environmental barriers remain in place, have been cleaned out and are effective.

6.2 During Hours of Work

The Principal Contractor's Site Supervisor will:

1. Undertake approved induction of Works personnel and visitors with specific instructions on the protection of people and property
2. Arrange work to minimise nuisance to Arcadia Street / Forest Road pedestrians and ensure their safety
3. Attend to problems as they occur
4. Where there are any hazards or potential hazards to the public or The Department identified, the Principal Contractor's personnel will ensure these are attended to immediately, photographed and accurately recorded for reporting
5. Reposition barriers and signage as necessary
6. Co-ordinate maintenance of access paths, footpaths with other job operations
7. Promptly notify Root Partnerships of any accidents or near misses involving loss of time or injury

7 Record Keeping

7.1 Site Quality Assurance and Daily Records

The Principal Contractor's representative will keep adequate records of daily activities and any significant departures or additions within the Project Diary. An Inspection and Test Plan (ITP) shall be completed daily to ensure compliance with the approved management plans.

7.2 Incident / Accident Management and Reporting

Incident Management

The objective of the incident plan is to minimise such disruptions and provide a clear and simple guideline for disruptive events. The Principal Contractor will prepare and submit for review / approval a site-specific Construction Incident Management Plans (CIMP). The CIMP will be implemented on the Works upon award of the Works Contract.

Accident Management

The Principal Contractor shall promptly notify Root Partnerships and The Department of the occurrence and furnish a written report of the following incidents and accidents:

- Accident involving death or personal injury
- Accident involving lost time
- Incidents with accident potential, such as equipment failure, slides, cave ins, and the like

In the case of accidents either witnessed or reported, involving The Department staff, student, public or from which legal proceedings might arise:

- Record the actual type, size and location of signs / devices in use at the time of the accident
- Notify The Department management as soon as possible
- Take photographs of the arrangement for subsequent reporting

A file shall be kept including any relevant information on traffic arrangements used and completed.

7.3 Waste Management Reporting

The Works will generate quantities of materials such as concrete, other masonry products, timber, steel and plastic. Wastes will be segregated and recycled as per the Principal Contractor's CWMP and The Department's waste minimisation strategy.

The Principle Contractor will collate monthly CWMP Tracking Schedules and Report and issue them to the Root Partnerships. The CWMP Tracking Schedules and Report will measure the weight of waste generated of material by classification, total weight of waste, percentage by weight recycled and percentage by weight to landfill for reporting to The Department.

Details of waste types, volumes and destinations will be recorded in CWMP Tracking Schedules and Report. The monthly CWMP Tracking Schedules are to detail, but not be limited to, the following:

- a list quantifying the amount and types of waste generated at the Penshurst Public School.
- a list of contamination incidents including the masses of contaminated bins
- records and evidence to substantiate data contained within reports to the nominated reporting standard

8 Emergency Procedure

In the event of any emergency situation arising during the course of the Works, including:

- Emergency evacuation,
- Fire,
- Flooding and water damage,
- Gas leak,
- Mains power failure
- Explosion,
- Bomb threat,
- Chemical Spill,
- Construction accident,
- Medical Emergency,
- Theft of Collection items,
- Criminal or accidental damage.

The Principal Contractor responsible for the Works is responsible for ensuring all personnel are evacuated from the site in accordance with the Principal Contractor's Emergency Procedures and Evacuation Plan.

On evacuation of the site, the Principal Contractor's representative will notify The Department and Root Partnerships, advising the status of the site, and await any further instructions.

The Principle Contractor is to ensure that Evacuation Plan are displayed around the site to direct personnel evacuating in the event of an emergency.

The Principle Contractor shall ensure that the Emergency Procedures are incorporated into the onsite inductions and relevant plans.

In the event of any emergency the following project team personnel will be contactable during all hours of the day:

No.	Position	Name	Telephone Numbers
1	<i>To be completed on award of Contractor</i>		
2	<i>To be completed on award of Contractor</i>		
3	<i>To be completed on award of Contractor</i>		
4	<i>To be completed on award of Contractor</i>		

The above numbering designates the order of precedence, which may depend on availability at a particular time of day or period of construction.

Appendix 1 - Preliminary Site Establishment Plan

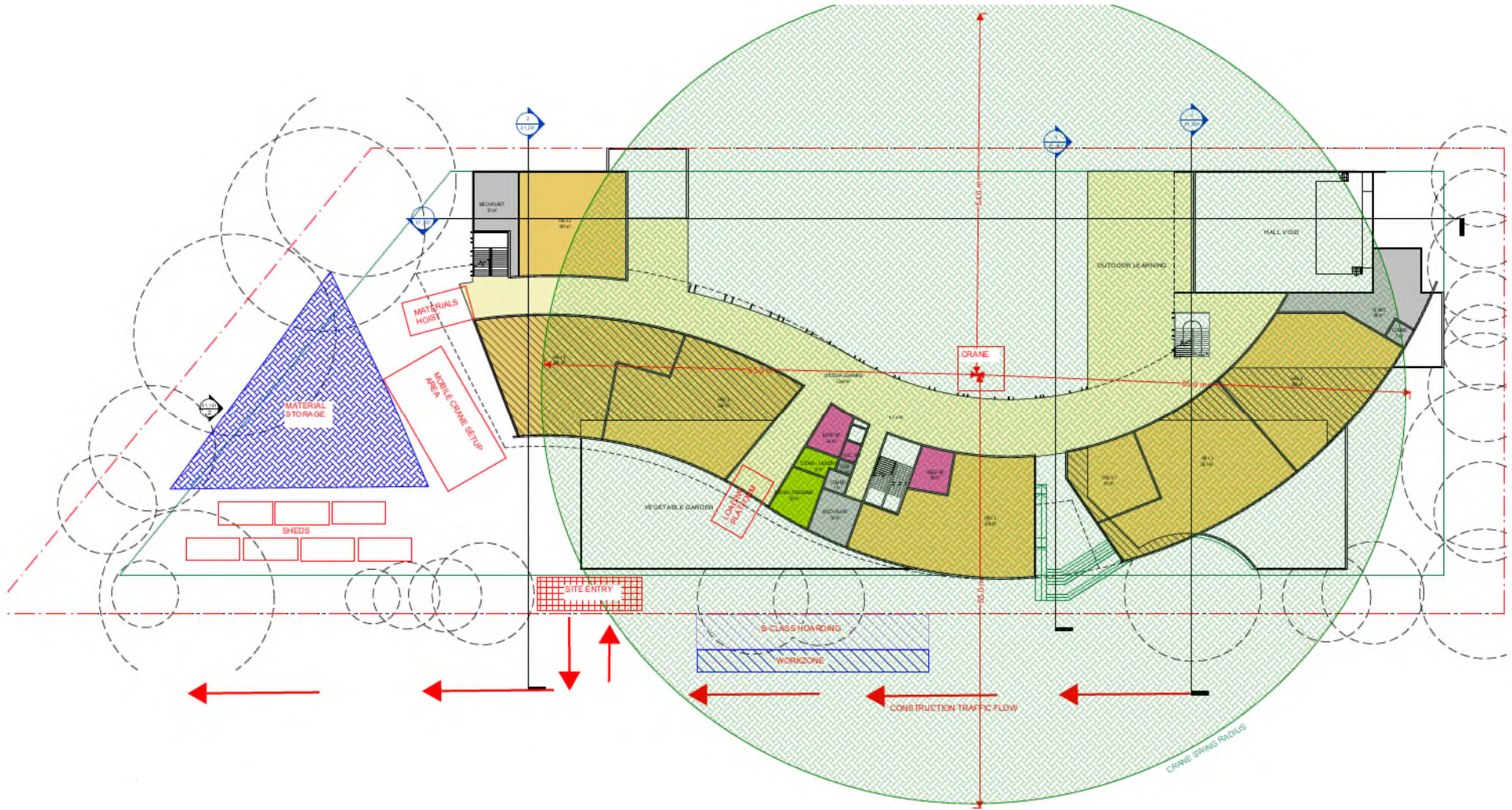



Level 2,
14 Martin Place
Sydney NSW 2000
T +61 2 8272 9300

Level 12, 500 Collins St
Melbourne VIC 3000
T +61 3 9654 0488

E info@rootpartnerships.com.au

rootpartnerships.com.au