

S-KU-RING-RAI

6

9.10.8.

5/9.10.08
1908

PLAN

5374

of lots Nos 1 to 16 inclusive subdivision of land comprised in Certificate of Title Vol. 1442 fol. 226

Parish of Gordon County of Cumberland DP5374

Note: The position of the boundaries is incorrect



DECLARATION.

I Arnold Wellesley Lore of Sydney
 Licensed Surveyor, specially licensed under the Real Property Act, do hereby solemnly
 and sincerely declare that the boundaries and measurements shown on this Plan are
 correct for the purposes of the said Act, and that the said Plan and the survey of
 the land to which the same relates, have been prepared and made by me, or under my
 immediate supervision; and I make this solemn declaration conscientiously believing
 the same to be true, and by virtue of the provisions of the Oaths Act 1900

Subscribed and declared before me at Sydney
 this 9th day of October A.D. 1908

Arnold Wellesley Lore
 Licensed Surveyor

A. C. K. J. P. J.P.

Date of Survey October 1908

Assumed Magnetic Variation 9° 30' East
 Azimuth taken from Middle Harbour Road

Scale 80 feet to an Inch.

Wilson's Point
 from Sydney



CONVERSION TABLE ADDED IN
REGISTRAR GENERAL'S DEPARTMENT

DP 5374

FEET INCHES		METRES
10	-	3.05
50	-	15.24
52	8	16.055
66	-	20.115
67	1	20.445
92	10 1/2	28.31
192	11 3/4	58.82
231	-	70.41

AC	RD	P	SQ M
-	1	2 1/4	1069
-	1	5 3/4	1157
-	1	16 3/4	1435
-	1	22 1/2	1581

S-KU-RING-RAI

6

9.10.8.

5/9.10.08
1908

PLAN

5374

of lots Nos 1 to 16 inclusive subdivision of land comprised in Certificate of Title Vol: 1442 fol: 226

Parish of Gordon County of Cumberland
DP5374

Note: The position of the boundaries is incorrect



DECLARATION.

I Arnold Wellesley Lore of Sydney
 Licensed Surveyor, specially licensed under the Real Property Act, do hereby solemnly
 and sincerely declare that the boundaries and measurements shown on this Plan are
 correct for the purposes of the said Act, and that the said Plan and the survey of
 the land to which the same relates, have been prepared and made by me, or under my
 immediate supervision; and I make this solemn declaration conscientiously believing
 the same to be true, and by virtue of the provisions of the Oaths Act 1900

Subscribed and declared before me at Sydney
 this 9th day of October A.D. 1908

Arnold Wellesley Lore
 Licensed Surveyor

A. C. Hall J.P.

Date of Survey October 1908

Assumed Magnetic Variation 9° 30' East
 Azimuth taken from Middle Harbour Road

Scale **80 feet to an Inch.**

Wilson's Point
 from Sydney



CONVERSION TABLE ADDED IN
REGISTRAR GENERAL'S DEPARTMENT

DP 5374

FEET INCHES		METRES
10	-	3.05
50	-	15.24
52	8	16.055
66	-	20.115
67	1	20.445
92	10 1/2	28.31
192	11 3/4	58.82
231	-	70.41

AC	RD	P	SQ M
-	1	2 1/4	1069
-	1	5 3/4	1157
-	1	16 3/4	1435
-	1	22 1/2	1581

S-KU-RING-RAI

6

9.10.8.

5/9.10.08
1908

PLAN

5374

of lots Nos 1 to 16 inclusive subdivision of land comprised in Certificate of Title Vol: 1442 fol: 226

Parish of Gordon County of Cumberland
DP5374

Note: The position of the boundaries is incorrect



DECLARATION.

I Arnold Wellesley Lore of Sydney
 Licensed Surveyor, specially licensed under the Real Property Act, do hereby solemnly
 and sincerely declare that the boundaries and measurements shown on this Plan are
 correct for the purposes of the said Act, and that the said Plan and the survey of
 the land to which the same relates, have been prepared and made by me, or under my
 immediate supervision; and I make this solemn declaration conscientiously believing
 the same to be true, and by virtue of the provisions of the Oaths Act 1900

Subscribed and declared before me at Sydney
 this 9th day of October A.D. 1908

Arnold Wellesley Lore
 Licensed Surveyor

A. C. K. J. P. J.P.

Date of Survey October 1908

Assumed Magnetic Variation 9° 30' East
 Azimuth taken from Middle Harbour Road

Scale **80 feet to an Inch.**

Wilson's Point
 from Sydney



CONVERSION TABLE ADDED IN
REGISTRAR GENERAL'S DEPARTMENT

DP 5374

FEET INCHES		METRES
10	-	3.05
50	-	15.24
52	8	16.055
66	-	20.115
67	1	20.445
92	10 1/2	28.31
192	11 3/4	58.82
231	-	70.41

AC	RD	P	SQ M
-	1	2 1/4	1069
-	1	5 3/4	1157
-	1	16 3/4	1435
-	1	22 1/2	1581

LT27

PLAN OF PART OF LOT 15 IN D.P. 5374
 BEING THE LAND IN VOL.7420FOL.213

D. P. 119944

Registered: 19-4-1989

C.A.: _____

Title System: TORRENS

Purpose: DEPARTMENTAL

Ref. Map: D.P. 5374 #

Last Plan: _____

Mun./Shire/City KU-RING-GAI

Town or Locality LINDFIELD

Parish GORDON

County CUMBERLAND

Reduction Ratio 1:

Lengths are in metres

N 0 0 1 D 1 B

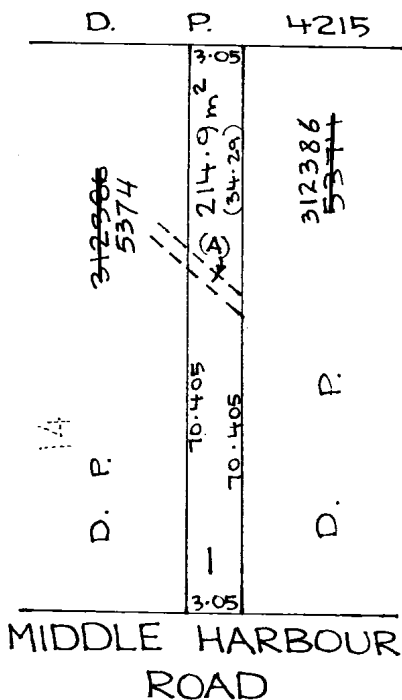

(A) EASEMENT FOR DRAINAGE - B978533

PLAN AMENDED BY L10.8 - 6 - 93

B240325

B240325

FP 312386

SKETCH shewing proposed subdivision of the whole of the land comprised in Certificate of Title registered volume 2422 folio 180, having a frontage of 35 feet to Middle Harbour Road, into the two portions edged red and green respectively: the former to be incorporated with the land now comprised in Certificate of Title Volume 2139 folio 71 and a consolidated Certificate of Title applied for in respect thereof: the latter to be incorporated with the land now comprised in Certificate of Title Volume 2570 folio 225 and sold as a whole.

KU-RING-GAI COUNCIL

Ph: Gordon
Co: C.



Scale: approximately 50ft to 1 inch.

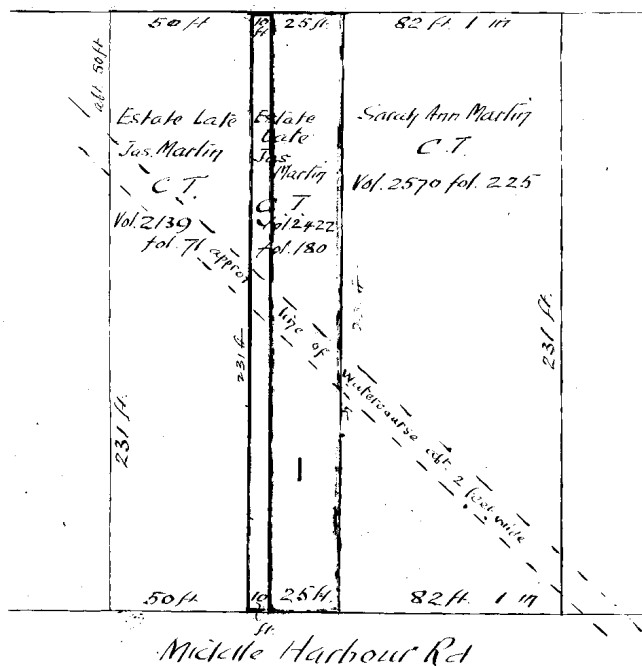

Note: this subdivision is required in order to give effect to 2 contracts of sale, in the first of these Sarah Ann Martin as administratrix of the estate of James Martin deceased contracts to sell to Robert Moreton Friend 25 feet of the estate property and in the second she contracts to sell to the same purchaser the whole of the immediately adjoining land which belongs to her in her own right. In the result the estate would be left with land having a frontage of 60 feet and the purchaser would acquire a block having a frontage of 107 feet 1 inch.

CA. No 48 of 1961/25

M P S (RP)
12386

PX M

PLAN AMENDED IN LTO 4-2-1994 - LOT 1 ADDED



CONVERSION TABLE ADDED IN
DEPARTMENT OF LANDS

DP 312386		
FEET	INCHES	METRES
2	-	0.610
10	-	3.048
25	-	7.620
50	-	15.240
82	1	25.019
231	-	70.409



Full dimensions and/or area(s) are not available for all lots. Any division of the lands herein may necessitate the lodgement of a plan of survey.

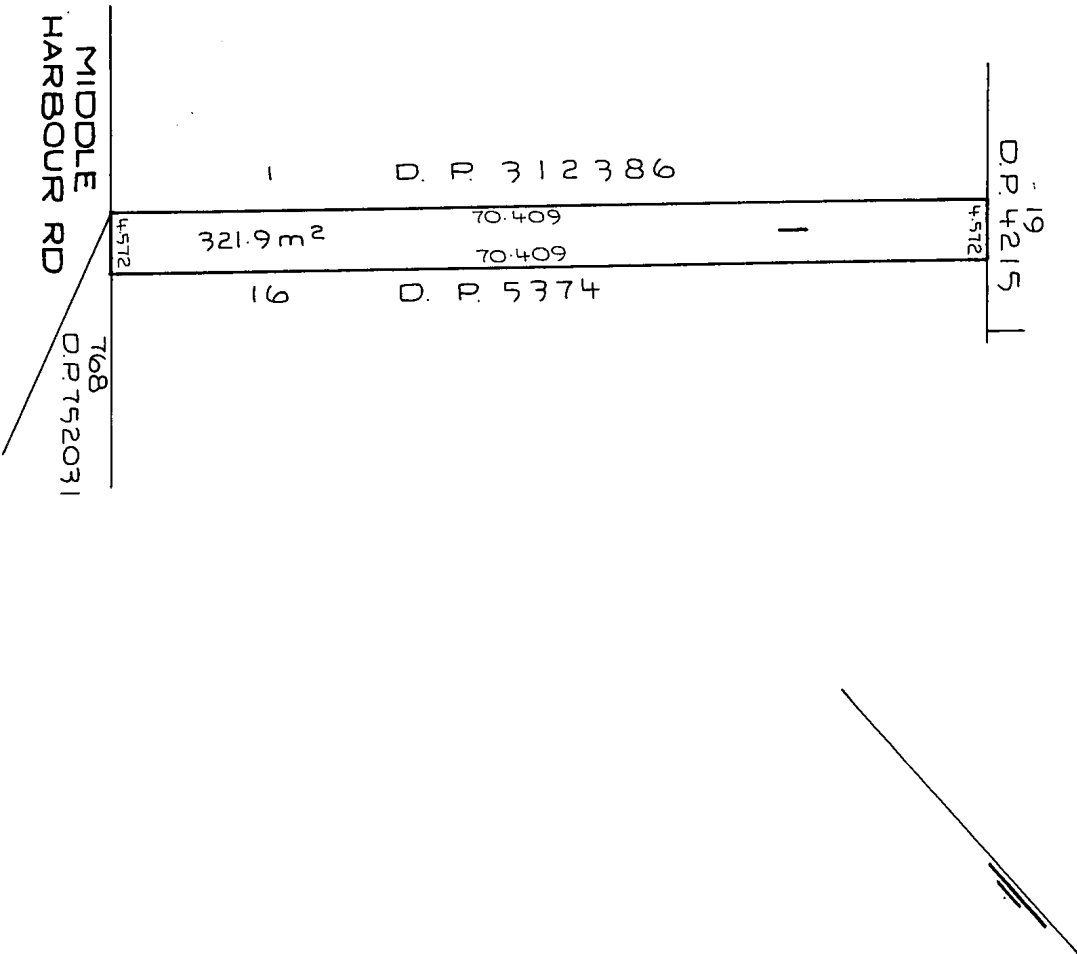

DP 1192386

Registered : 17.12.2013

Title System : TORRENS

Purpose : DEPARTMENTAL

Ref. Map : KU-RING-GAI SH. 31

Last Plan : DP 5374 & DP 312386

PLAN OF PART LOT 15 IN DP 5374 FORMERLY COMPRISED IN VOL. 3762 FOL. 21

Lengths are in metres. Reduction Ratio - NTS
 LPI Ref : 2013 - 1699

Sheet 1 of 1 sheets

L.G.A. : KU-RING-GAI

LOCALITY : LINDFIELD

PARISH : GORDON

COUNTY : CUMBERLAND

LOT PRIOR IDENTITY

THIS PLAN HAS BEEN PREPARED TO PROVIDE AN UNIQUE IDENTITY FOR THE LAND IN THE CERTIFICATE OF TITLE REFERRED TO ABOVE.
 IT IS NOT A CURRENT PLAN IN THE TERMS OF 7A OF THE CONVEYANCING ACT, 1919.



FOLIO: AUTO CONSOL 7420-213

SEARCH DATE	TIME	EDITION NO	DATE
2/5/2025	2:56 PM	4	11/4/2025

LAND

LAND DESCRIBED IN SCHEDULE OF PARCELS

AT LINDFIELD

LOCAL GOVERNMENT AREA KU-RING-GAI

PARISH OF GORDON COUNTY OF CUMBERLAND

TITLE DIAGRAM SEE SCHEDULE OF PARCELS

FIRST SCHEDULE

AMANDA JANE SETON

(T I390002)

SECOND SCHEDULE (5 NOTIFICATIONS)

- 1 RESERVATIONS AND CONDITIONS IN THE CROWN GRANT(S)
- 2 601168 COVENANT AS REGARDS LOT 14 DP5374
- 3 A62578 COVENANT AS REGARDS LOT 1 DP119944
- 4 B978533 EASEMENT FOR DRAINAGE AFFECTING THE PART OF THE
LAND ABOVE DESCRIBED SHOWN SO BURDENED IN VOL 7420 FOL
213
- * 5 AU962515 CAVEAT BY SNOW EAST INVESTMENTS PTY LTD

NOTATIONS

UNREGISTERED DEALINGS: NIL

SCHEDULE OF PARCELS

LOT 14 IN DP5374

LOT 1 IN DP119944

TITLE DIAGRAM

DP5374

DP119944.

*** END OF SEARCH ***



FOLIO: AUTO CONSOL 3762-21

SEARCH DATE	TIME	EDITION NO	DATE
2/5/2025	2:55 PM	9	8/4/2025

LAND

LAND DESCRIBED IN SCHEDULE OF PARCELS
AT LINDFIELD
LOCAL GOVERNMENT AREA KU-RING-GAI
PARISH OF GORDON COUNTY OF CUMBERLAND
TITLE DIAGRAM SEE SCHEDULE OF PARCELS

FIRST SCHEDULE

SNOW EAST INVESTMENTS PTY LTD (TZ AU960829)

SECOND SCHEDULE (5 NOTIFICATIONS)

- 1 RESERVATIONS AND CONDITIONS IN THE CROWN GRANT(S)
- 2 A62578 COVENANT AFFECTING LOT 1 IN DP312386 AND LOT 1 IN DP1192386
- 3 A168568 COVENANT
- 4 B468406 DRAINAGE EASEMENT 1.83 METRE(S) WIDE AFFECTING THE PART(S) SHOWN SO BURDENED IN DP183415
- 5 AU586735 MORTGAGE TO WESTPAC BANKING CORPORATION

NOTATIONS

UNREGISTERED DEALINGS: NIL

SCHEDULE OF PARCELS

LOT 16 IN DP5374
LOT 1 IN DP312386
LOT 1 IN DP1192386

TITLE DIAGRAM

DP5374
DP312386
DP1192386.

*** END OF SEARCH ***



FOLIO: AUTO CONSOL 3762-21

SEARCH DATE	TIME	EDITION NO	DATE
-----	----	-----	----
2/5/2025	2:55 PM	9	8/4/2025

LAND

LAND DESCRIBED IN SCHEDULE OF PARCELS

AT LINDFIELD

LOCAL GOVERNMENT AREA KU-RING-GAI

PARISH OF GORDON COUNTY OF CUMBERLAND

TITLE DIAGRAM SEE SCHEDULE OF PARCELS

FIRST SCHEDULE

SNOW EAST INVESTMENTS PTY LTD

(TZ AU960829)

SECOND SCHEDULE (5 NOTIFICATIONS)

- 1 RESERVATIONS AND CONDITIONS IN THE CROWN GRANT(S)
- 2 A62578 COVENANT AFFECTING LOT 1 IN DP312386 AND LOT 1 IN DP1192386
- 3 A168568 COVENANT
- 4 B468406 DRAINAGE EASEMENT 1.83 METRE(S) WIDE AFFECTING THE PART(S) SHOWN SO BURDENED IN DP183415
- 5 AU586735 MORTGAGE TO WESTPAC BANKING CORPORATION

NOTATIONS

UNREGISTERED DEALINGS: NIL

SCHEDULE OF PARCELS

LOT 16 IN DP5374
 LOT 1 IN DP312386
 LOT 1 IN DP1192386

TITLE DIAGRAM

DP5374
 DP312386
 DP1192386.

*** END OF SEARCH ***



FOLIO: 13/5374

SEARCH DATE	TIME	EDITION NO	DATE
-----	----	-----	----
2/5/2025	2:57 PM	13	10/4/2025

LAND

LOT 13 IN DEPOSITED PLAN 5374
AT LINDFIELD
LOCAL GOVERNMENT AREA KU-RING-GAI
PARISH OF GORDON COUNTY OF CUMBERLAND
TITLE DIAGRAM DP5374

FIRST SCHEDULE

RICHARD ZHOU JIN
XIN CHEN
AS JOINT TENANTS (T AG429302)

SECOND SCHEDULE (4 NOTIFICATIONS)

- 1 RESERVATIONS AND CONDITIONS IN THE CROWN GRANT(S)
- 2 588158 COVENANT
- 3 AG429303 MORTGAGE TO WESTPAC BANKING CORPORATION
- * 4 AU962543 CAVEAT BY SNOW EAST INVESTMENTS PTY LTD

NOTATIONS

UNREGISTERED DEALINGS: NIL

*** END OF SEARCH ***



FOLIO: AUTO CONSOL 7420-213

SEARCH DATE	TIME	EDITION NO	DATE
2/5/2025	2:56 PM	4	11/4/2025

LAND

LAND DESCRIBED IN SCHEDULE OF PARCELS

AT LINDFIELD

LOCAL GOVERNMENT AREA KU-RING-GAI

PARISH OF GORDON COUNTY OF CUMBERLAND

TITLE DIAGRAM SEE SCHEDULE OF PARCELS

FIRST SCHEDULE

AMANDA JANE SETON

(T I390002)

SECOND SCHEDULE (5 NOTIFICATIONS)

- 1 RESERVATIONS AND CONDITIONS IN THE CROWN GRANT(S)
- 2 601168 COVENANT AS REGARDS LOT 14 DP5374
- 3 A62578 COVENANT AS REGARDS LOT 1 DP119944
- 4 B978533 EASEMENT FOR DRAINAGE AFFECTING THE PART OF THE
LAND ABOVE DESCRIBED SHOWN SO BURDENED IN VOL 7420 FOL
213
- * 5 AU962515 CAVEAT BY SNOW EAST INVESTMENTS PTY LTD

NOTATIONS

UNREGISTERED DEALINGS: NIL

SCHEDULE OF PARCELS

LOT 14 IN DP5374

LOT 1 IN DP119944

TITLE DIAGRAM

DP5374

DP119944.

*** END OF SEARCH ***



FOLIO: AUTO CONSOL 3762-21

SEARCH DATE	TIME	EDITION NO	DATE
2/5/2025	2:55 PM	9	8/4/2025

LAND

LAND DESCRIBED IN SCHEDULE OF PARCELS

AT LINDFIELD

LOCAL GOVERNMENT AREA KU-RING-GAI

PARISH OF GORDON COUNTY OF CUMBERLAND

TITLE DIAGRAM SEE SCHEDULE OF PARCELS

FIRST SCHEDULE

SNOW EAST INVESTMENTS PTY LTD

(TZ AU960829)

SECOND SCHEDULE (5 NOTIFICATIONS)

- 1 RESERVATIONS AND CONDITIONS IN THE CROWN GRANT(S)
- 2 A62578 COVENANT AFFECTING LOT 1 IN DP312386 AND LOT 1 IN DP1192386
- 3 A168568 COVENANT
- 4 B468406 DRAINAGE EASEMENT 1.83 METRE(S) WIDE AFFECTING THE PART(S) SHOWN SO BURDENED IN DP183415
- 5 AU586735 MORTGAGE TO WESTPAC BANKING CORPORATION

NOTATIONS

UNREGISTERED DEALINGS: NIL

SCHEDULE OF PARCELS

LOT 16 IN DP5374
 LOT 1 IN DP312386
 LOT 1 IN DP1192386

TITLE DIAGRAM

DP5374
 DP312386
 DP1192386.

*** END OF SEARCH ***



FOLIO: 768/752031

SEARCH DATE	TIME	EDITION NO	DATE
-----	----	-----	----
2/5/2025	2:55 PM	7	8/4/2025

LAND

LOT 768 IN DEPOSITED PLAN 752031
AT LINDFIELD
LOCAL GOVERNMENT AREA KU-RING-GAI
PARISH OF GORDON COUNTY OF CUMBERLAND
(FORMERLY KNOWN AS PORTION 768)
TITLE DIAGRAM CROWN PLAN 7022.2030

FIRST SCHEDULE

SNOW EAST INVESTMENTS PTY LTD (TZ AU960829)

SECOND SCHEDULE (1 NOTIFICATION)

1 LAND EXCLUDES MINERALS AND IS SUBJECT TO RESERVATIONS AND
CONDITIONS IN FAVOUR OF THE CROWN - SEE CROWN GRANT(S)

NOTATIONS

UNREGISTERED DEALINGS: NIL

*** END OF SEARCH ***