

10 May 2017

Leena Singh  
Director Strategic Business development and Commercial Services  
Western Sydney Local Health District

To Ms Singh,

**Re: Western Sydney Stadium (Stage 2 Design & Construction), Parramatta (SSD 8175)**

Your feedback provided on the 7<sup>th</sup> April noted the following,

***It is suggested that considerations for incorporating design options to reduce the health impacts of heat stress where people queue or congregate outside the stadium and encouraging visitors to drink water by providing free water filling stations within the stadium surrounds and also inside the stadium.***

In response:

The comfort of patrons queuing or gathering during the day outside the stadium has been considered. Paving materials and their colouring will be chosen to avoid those that are too dark/ heat absorbent or too light / glare inducing. Water filling stations will be provided within the public realm available for free use by visitors. Shade will be provided by canopy trees, and on particularly hot days, temporary shade structures could be provided by the stadium management.

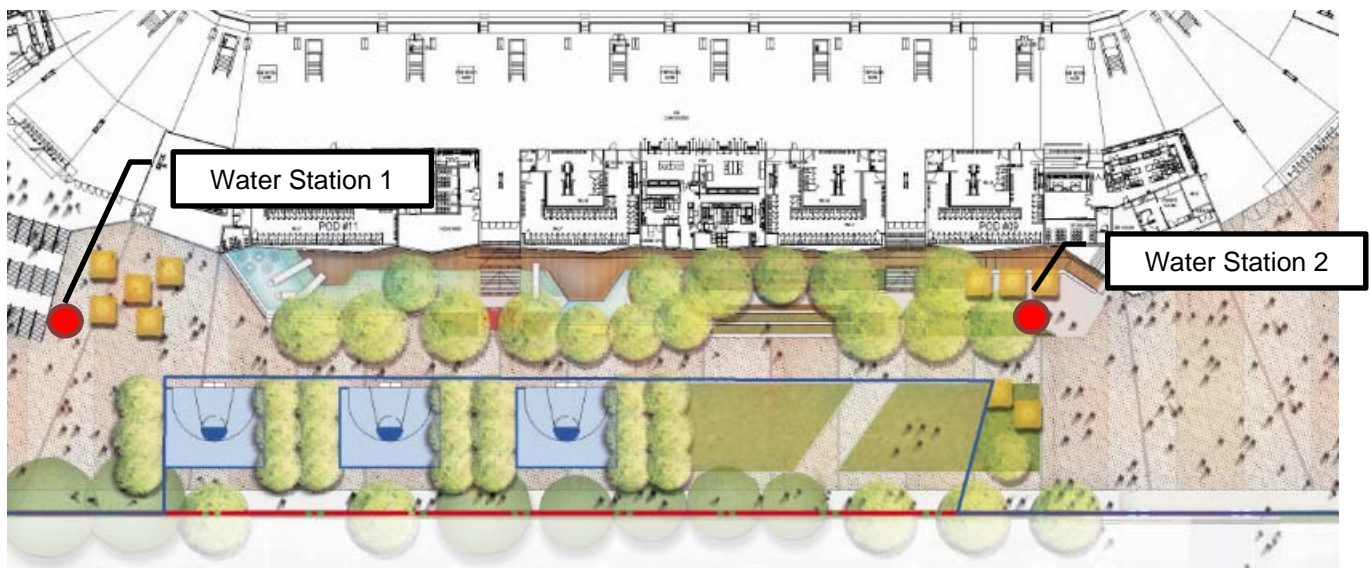

#### Sydney

P +61 2 9699 7182  
F +61 2 9699 7192  
E [sydney@aspect.net.au](mailto:sydney@aspect.net.au)  
Level 1, 78-80 George Street  
Redfern NSW 2016 Australia

#### Studios

Adelaide  
Brisbane  
Melbourne  
Sydney  
Shanghai

ASPECT Studios Pty Ltd ABN 11 120 219 561

q:\s16029\_wss\04\_transfer\02\_out\02\_lendlease\20170505\_stage 2 responses\wss\_department of health - western sydney local health district - heat stress.docx

Refer to Landscape Plan WSS\_L\_MP\_1.11.100\_E to view the full site plan, and to Pg 12 of the Design Report for contextual information.

Yours sincerely



**Scott van den Boogaard**  
Senior Associate

scott.boogaard@aspect.net.au