

8. PRECINCT ACTIVATION

The focus of the Stadium public realm is to enhance recreational, sporting and cultural opportunities -providing a suite of free activities including, outdoor performance space's, locations for markets, and community events. Western Sydney Stadium and the adjacent Parramatta parkland becomes a place for events, a place to enjoy everyday -a celebrated place for all peoples.

7 day a week activation of the site has been a key driver in the

design of significant spaces such as the Civic Plaza, O'Connell Place, Southern Plaza and Riverside Terraces. Each of these spaces has thoughtfully been designed to accommodate large crowds during events while also providing drawcards for everyday use of the site.

Flexibility in the design of the Western Carpark allows this space to be closed to vehicular traffic in order to

accommodate an event overlay. There is capability for this carpark to be used in tandem with the adjacent Riverside Terraces to form a larger event spaces across the two sites.

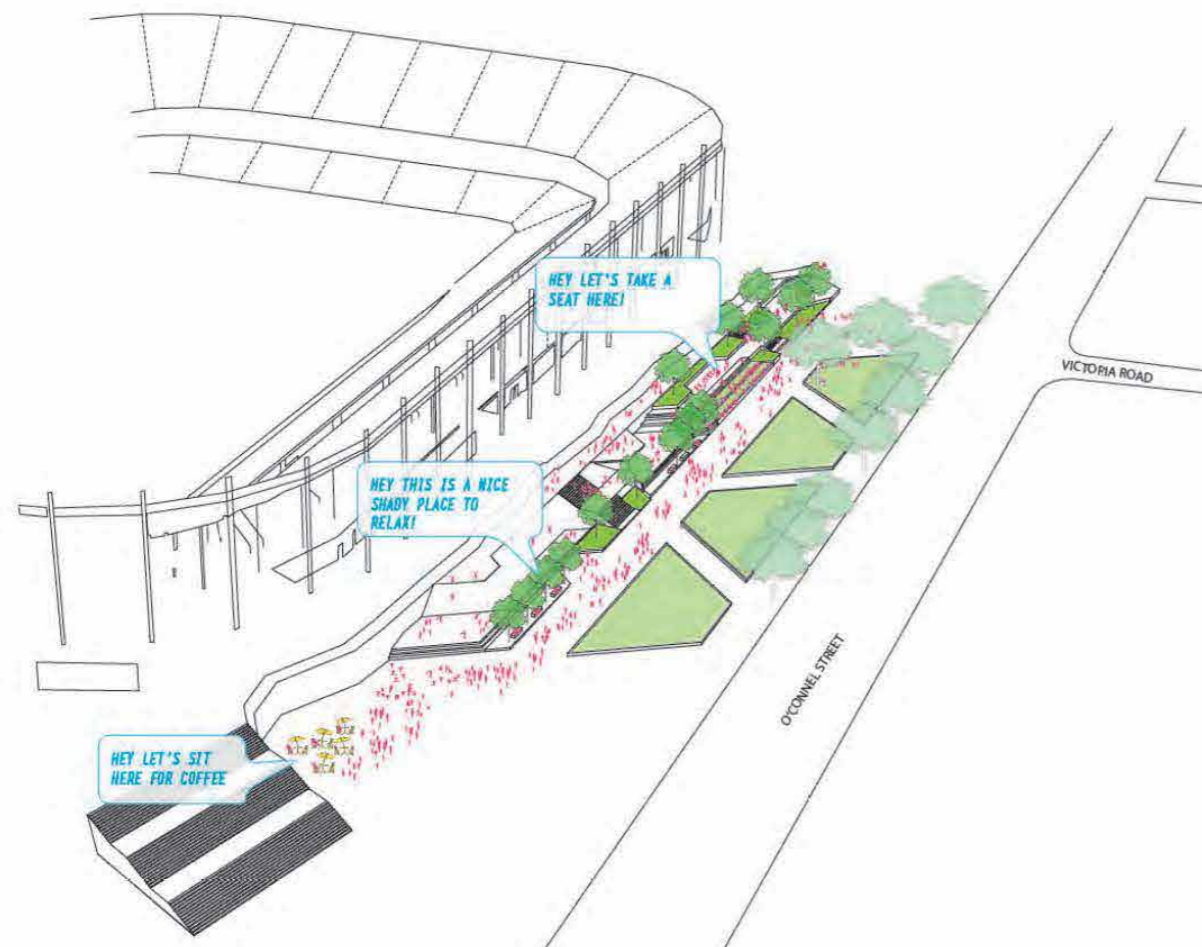

O'Connell Place - Everyday Mode

- Destinal space of a scale that encourages users from all age groups
- Grassed areas providing casual seating for groups and individuals
- Cafe spillout
- Seating terraces providing seating opportunities

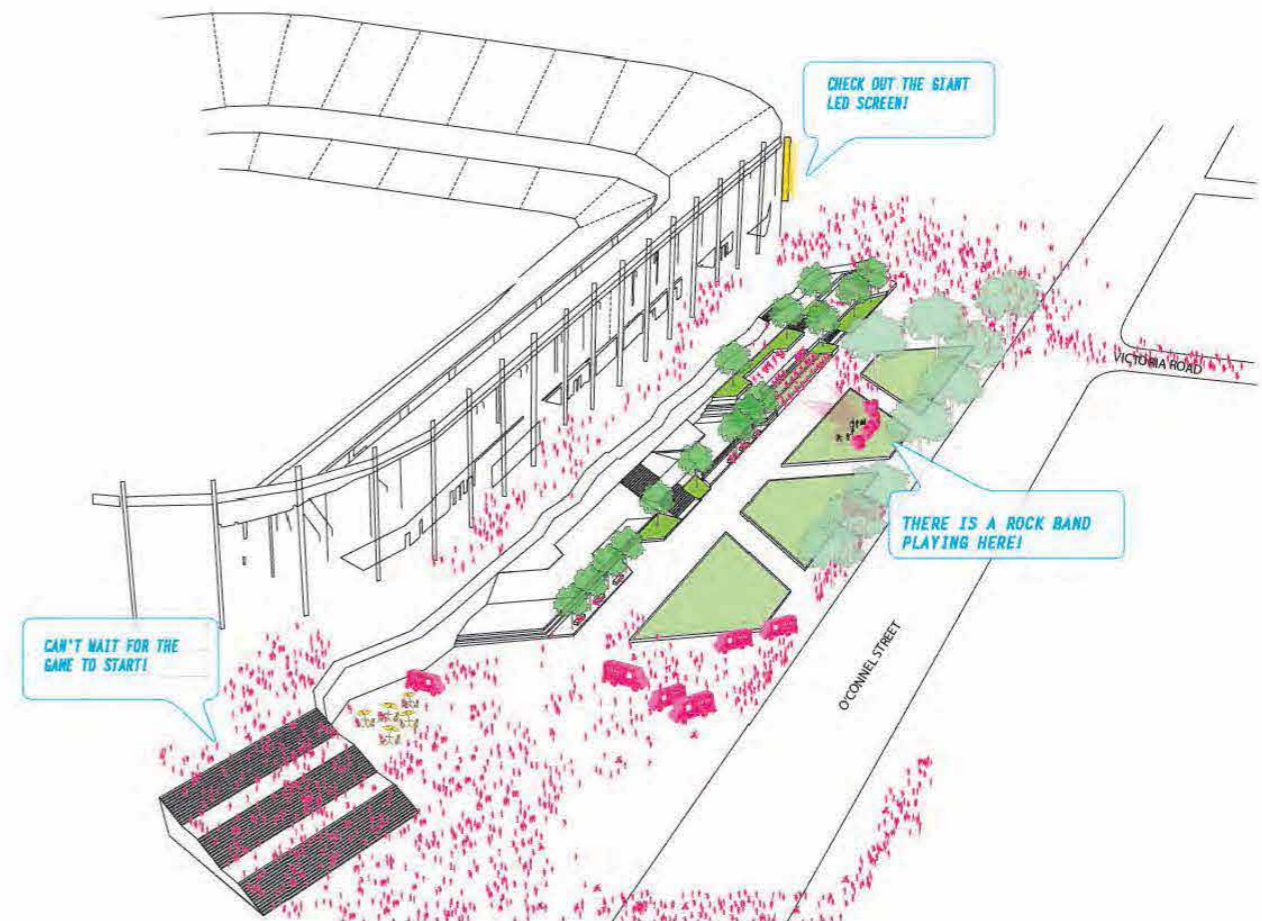

O'Connell Place - Game Day Mode

- Outdoor concerts on the central lawn
- Pop-up dining zones with food trucks and market stalls
- Open areas for queuing at entries
- Entertainment on the external LED screen

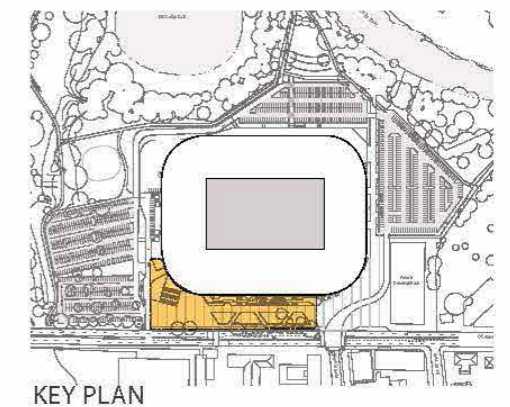

KEY PLAN

Precinct activation - Western Carpark

Modes of Use

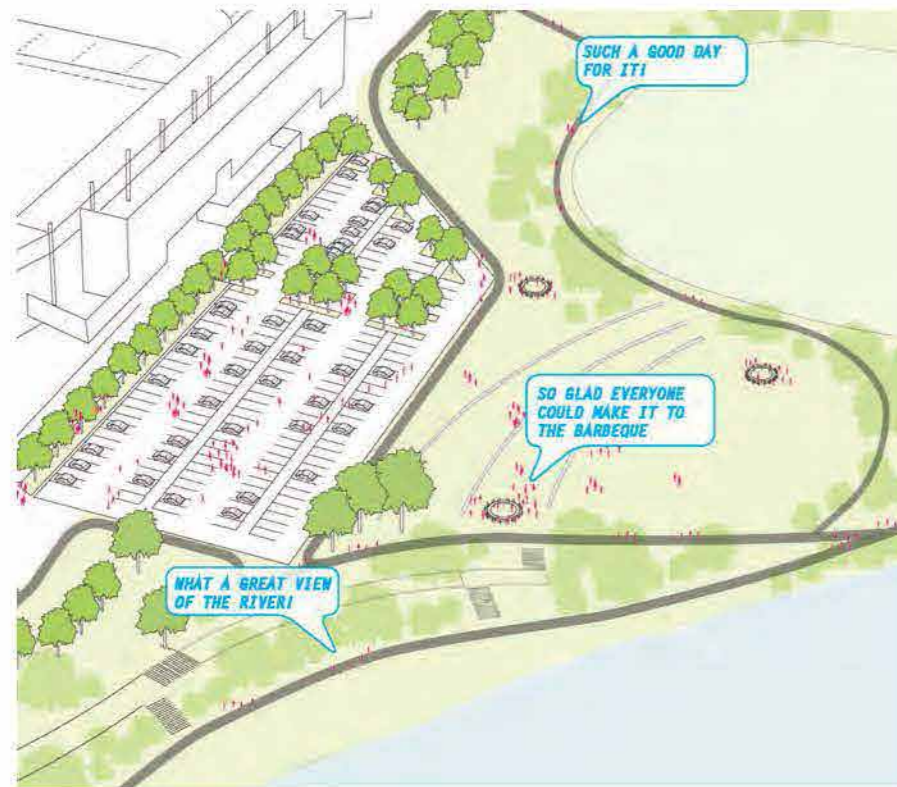

River Terraces - Everyday Mode

- Group gatherings for picnics and small scale celebrations
- Walking and cycling along pedestrian pathways
- Casual seating on terrace walls
- Informal games in the event lawn

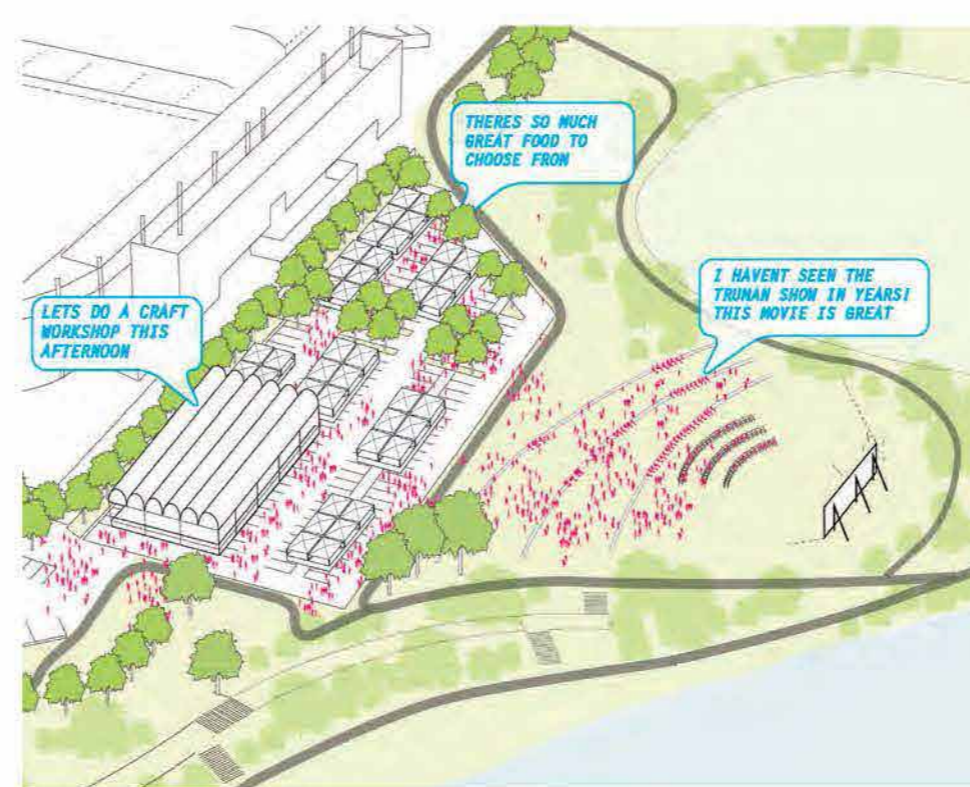

River Terraces - Event Mode

- Outdoor temporary screen for night cinema
- Markets and food fair with marquees and stalls installed on the Western Carpark
- Casual dining zones established on the turf terraces
- Stadium toilets opened to allow use during the event

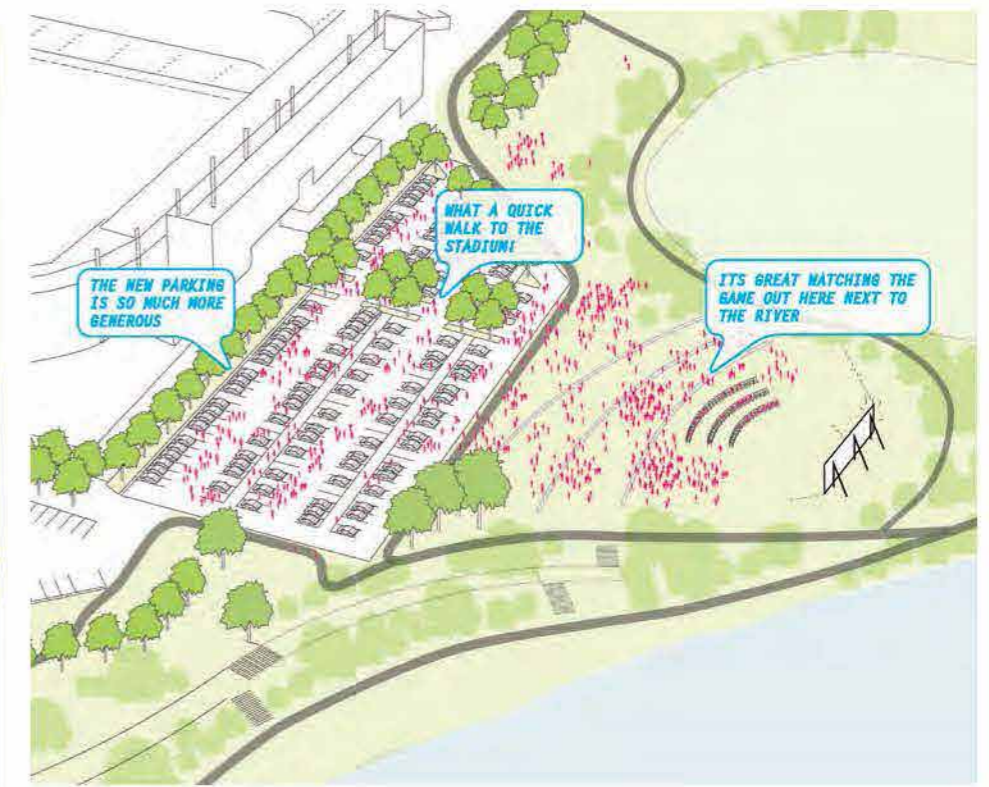

River Terraces - Game Day

- Outdoor live-site setup on the event lawn
- Pre-match entertainment including competitions, and BBQs on the turf terraces
- Opportunities for food trucks to setup within western carpark

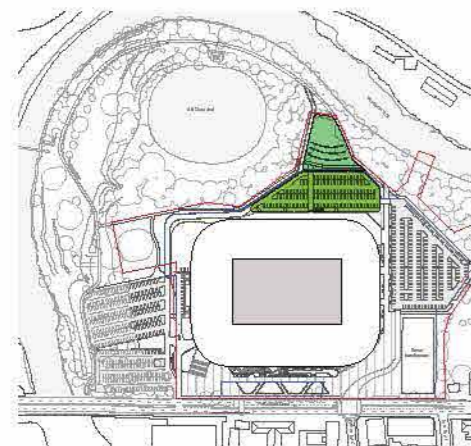

KEY PLAN

9. STADIUM DESIGN

Stadium Design

The design team have developed a precinct and stadium design, on the site of the existing Parramatta Stadium, that will change how people experience and perceive live major sporting and cultural events.

The design has been developed to focus on the key live experience differentiators: what makes it unique and special attending live sporting events, for everyone within the community.

The design team have drawn on their experience in designing over similar scaled projects in Australia and New Zealand, and related projects globally. Whilst this is very much a Western Sydney venue, the team have drawn on this local and global experience to ensure every consideration has been taken into account, every opportunity has been explored, to ensure the ultimate success of the Western Sydney Stadium.

This is the 'people's venue'

This precinct is ultimately about people: whether they are attending a sporting event, a function, using the facilities for training, or simply walking through the parkland. The stadium and its precinct needs to be about people and enhancing their experience of using the stadium on a game day and living with it as part of their every day.

It has to be a part of the park

Stadia, their materiality and composition are not always the best of neighbors in a community. By their function they are large in scale, traditionally built of hard working materials such as concrete and steel. Their immediate surrounds are hard barren places that service the purpose of safely moving large numbers of people. These factors often make them unattractive for nonevent day use or enjoyment. The new Western Sydney Stadium sits within a beautiful structured and open structured parkland. The two need to work together.

The stadium is not a foreign object inserted in the park simply as an architectural edifice, it integrates itself through the use of 'warm' textured materiality, physical and visual connections so that it works with its context to create a high quality urban environment.

It is to be clearly identifiable

This stadium has an important role in place making and recognition. Someone glancing at a television broadcast, or catching a glimpse of a photo in an article will be able to recognise the unique nature of the Western Sydney

Stadium instantaneously. This aspect is important as a form of place making and community ownership and is achieved through the iconic floating fabric roof and structural steel pattern language

It is to be a reflection of the history and culture of Parramatta and West Sydney

The overall design concept and building materiality is respectful of the past, whilst appreciating the vibrancy of West Sydney now and where it is headed into the future as a major city centre in its own right.

The northern 'Boulevard of Legends' is a place for people to learn about the history of this extraordinary sporting precinct and its heroes, and to look forward to the next great event or hero of the future.

The steel structure, manufactured in western Sydney, reflects the working class and industrial roots of Sydney's west, while the opportunity for varied and adaptable food and beverage speaks of the cosmopolitan nature of Parramatta's present and future.

Connections to surrounding park, river and CBD

The stadium and its precinct is a fantastic opportunity to leverage and sensitively engage with the parkland setting, with adjacent Parramatta River, Kings School Oval, the First Farm, and the UNESCO World Heritage Listed Parramatta Park over the river. The stadium and its surrounds have been designed to cater for festivals and events within the stadium and in the adjacent park areas as a way that will allow the adjacent parklands and urban spaces to utilise the support infrastructure the stadium has at podium level - food and beverage, toilet facilities, even the premium spaces, to offer a unique type of outdoor event experience both during and in between events.

Enhancing the connections across barriers, such as O'Connell Street, brings greater numbers of people into the precinct, particularly on non- event days. Having it as a destination will draw people from the CBD into the streets and parks between the CBD and the stadium precinct.

Beyond the build

Whilst the present challenge is to deliver a high quality building and precinct on time and on budget, an appreciation for what happens over the lifetime of the building and precinct has been taken into account to ensure operational and commercial success is delivered, forming a strong legacy benefit for the community. Operational and peer reviews have been undertaken to affirm affinities, spatial requirements, constituent user group access, staffing numbers, and the ability to close

or open parts of the venue as required, particularly on non- event days. The design has been developed as far as possible to ensure the operational workings of the venue are inherent within the infrastructure thus reducing overhead costs and pressure on the neighbouring infrastructure. Flexibility for the future has been considered, with the opportunity to modify significant areas within the stadium, particularly in the premium west stand, to allow for future market trends and maximise its value to western Sydney.

10. CONSISTENCY WITH THE STAGE 1 DA

Consistency with the WSS Urban Design & Public Realm Guidelines and Planning Issues

This INSW brief for the Western Sydney Stadium design and construct competitive process instructed the designers to remain consistent with the Urban Design & Public Realm Guidelines that were prepared for the Stage 1 DA.

Our proposed design was deemed to satisfy this requirement.

The following drawings and diagrams demonstrate consistency with these guidelines as well as addressing the site's macro planning issues.

Heritage considerations, although addressed in part here, will be more fully dealt with in Section 8 of the EIS.

For further details on Stage 1 DA Urban Design & Public Realm Guidelines please refer to Section 21 of this report.

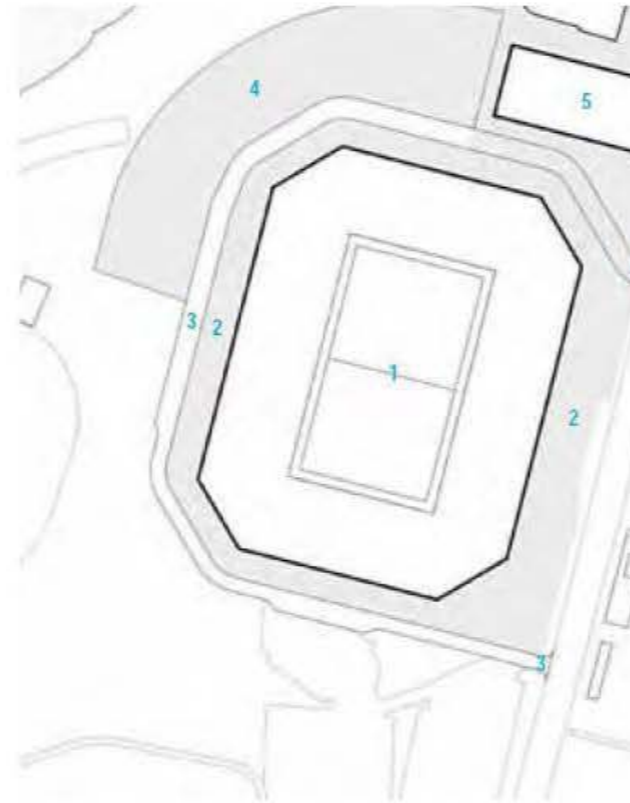

- 1. Stadium
- 2. Stadium Curtilage
- 3. Ring Road
- 4. Parking
- 5. Future Development Building

6.1.1 WSS Predinct: Stage 1 DA

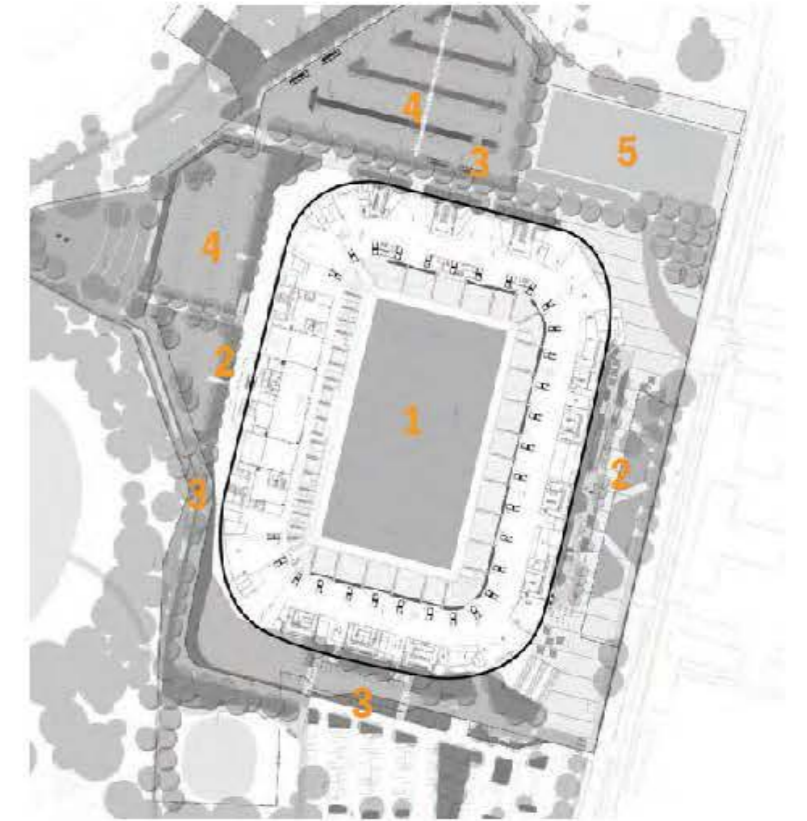

6.1.1 WSS Predinct: Stage 2 DA

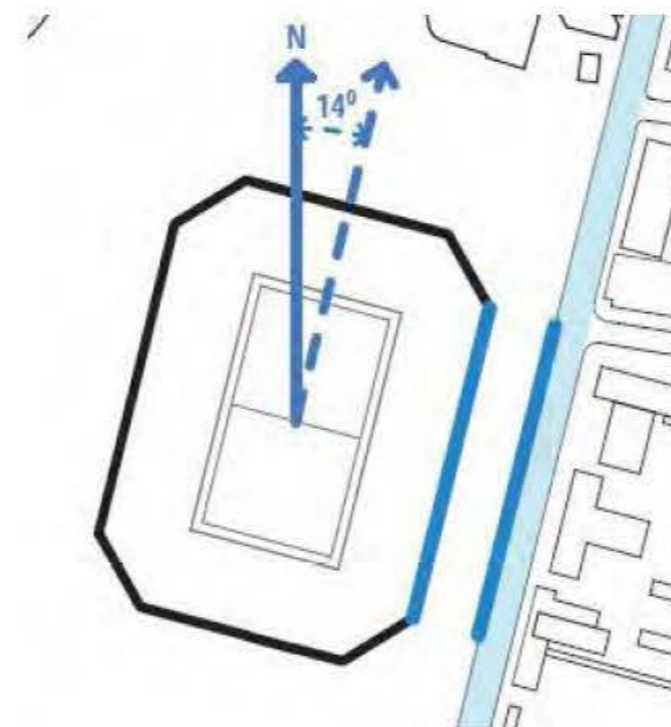

6.1.2 Locating the Stadium: Stage 1 DA

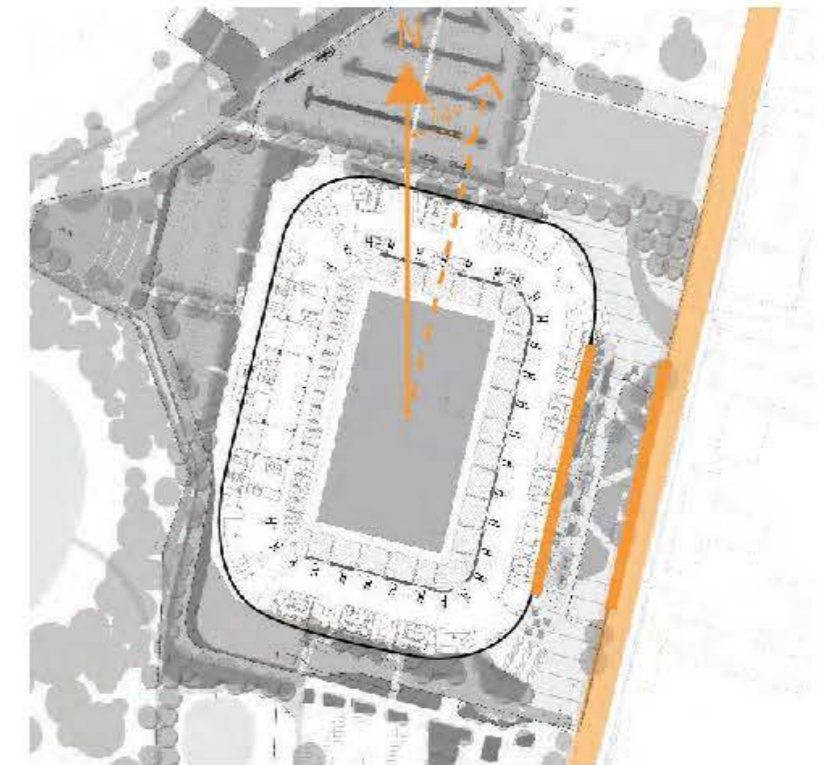

6.1.2 Locating the Stadium: Stage 2 DA

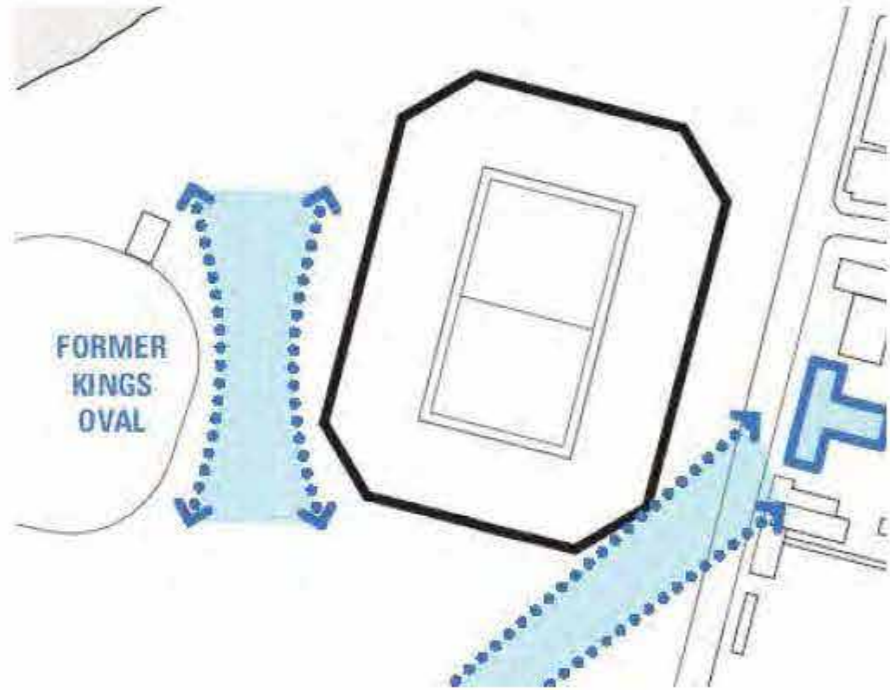

6.1.2 Locating the Stadium: Stage 1 DA

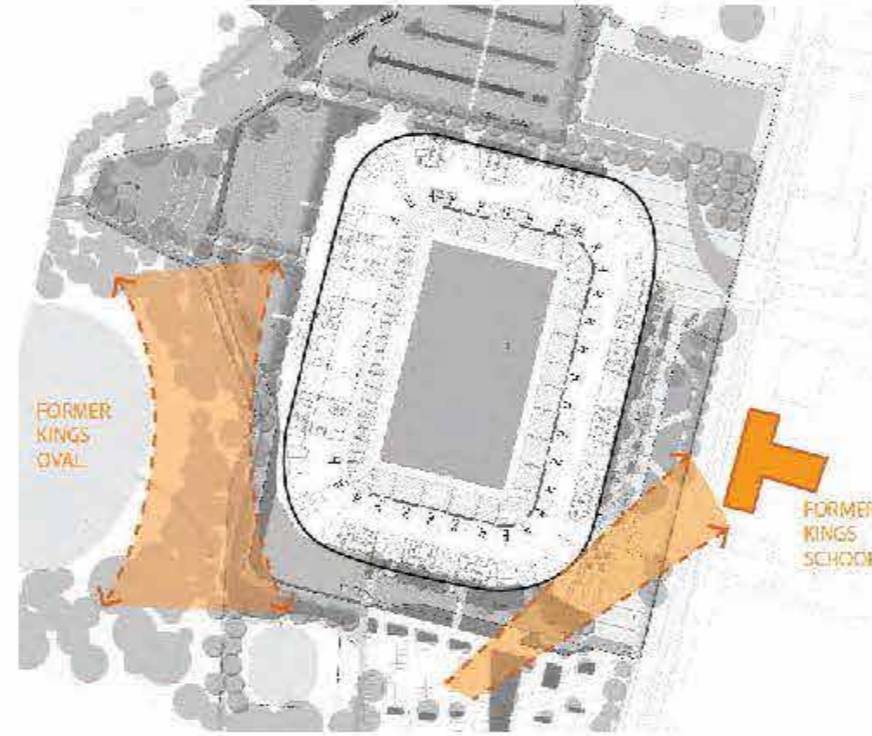

6.1.2 Locating the Stadium: Stage 2 DA

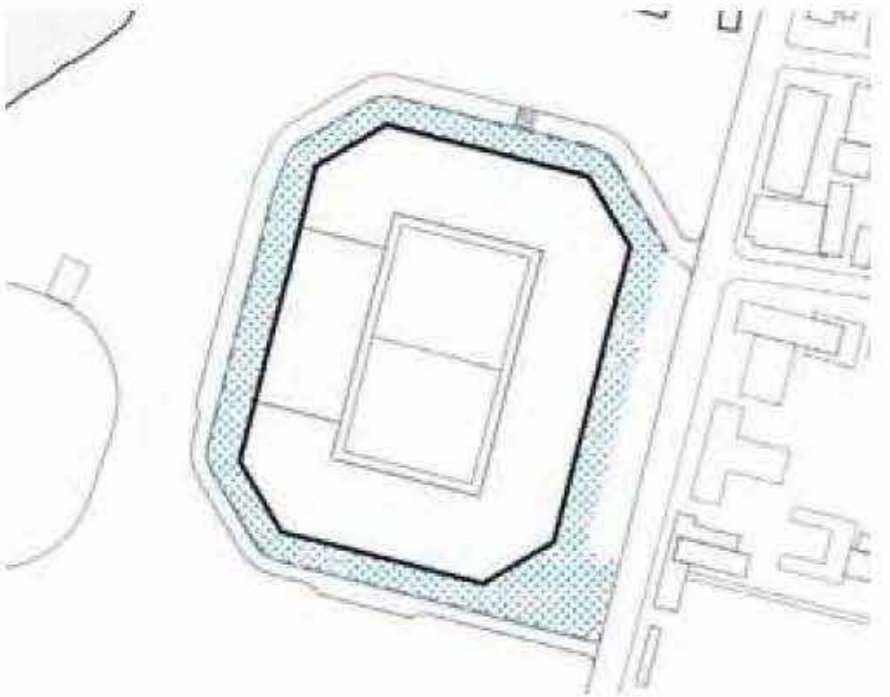

6.1.3 Stadium Curtilage: Stage 1 DA

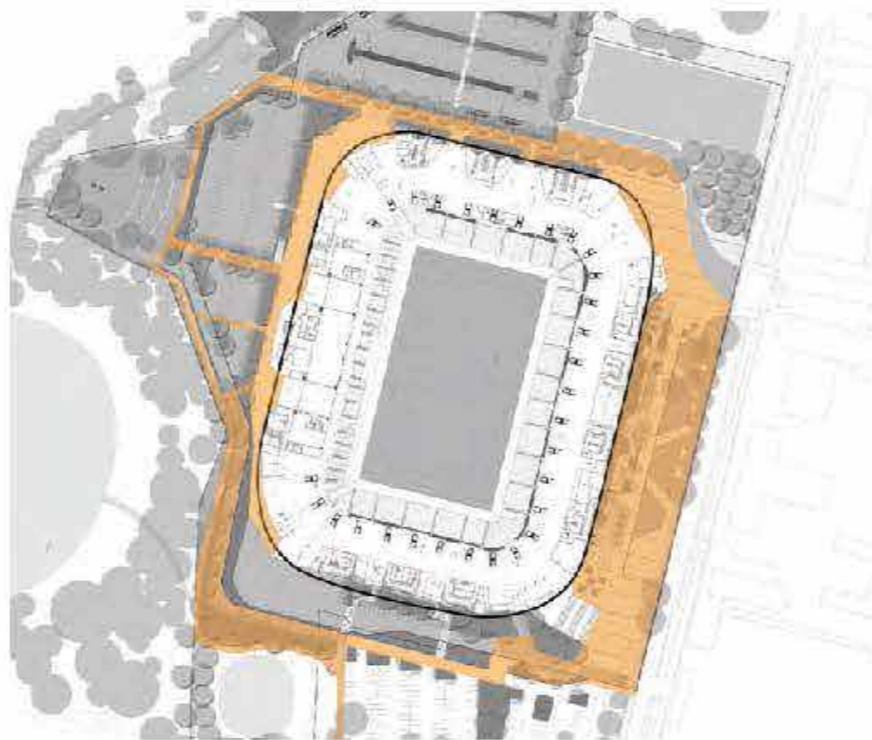

6.1.3 Stadium Curtilage: Stage 2 DA

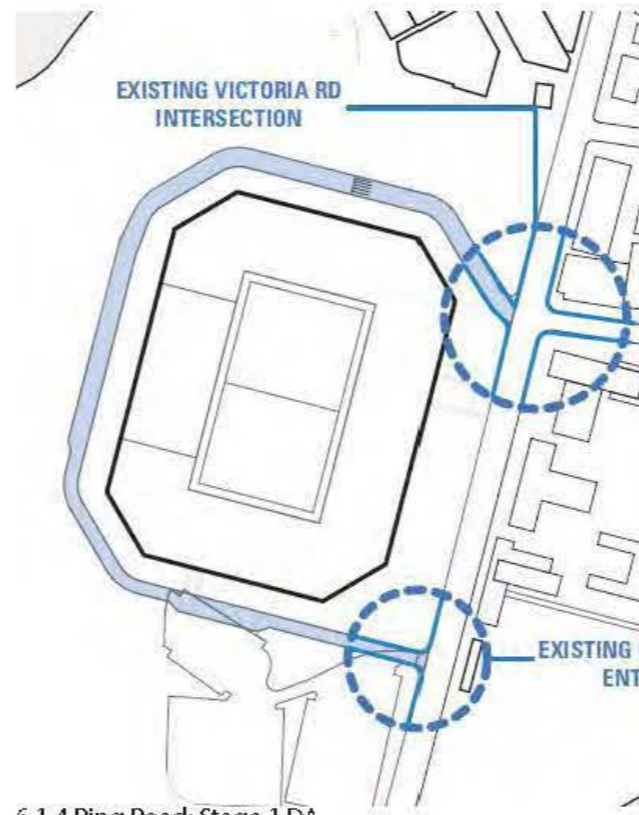

6.1.4 Ring Road: Stage 1 DA

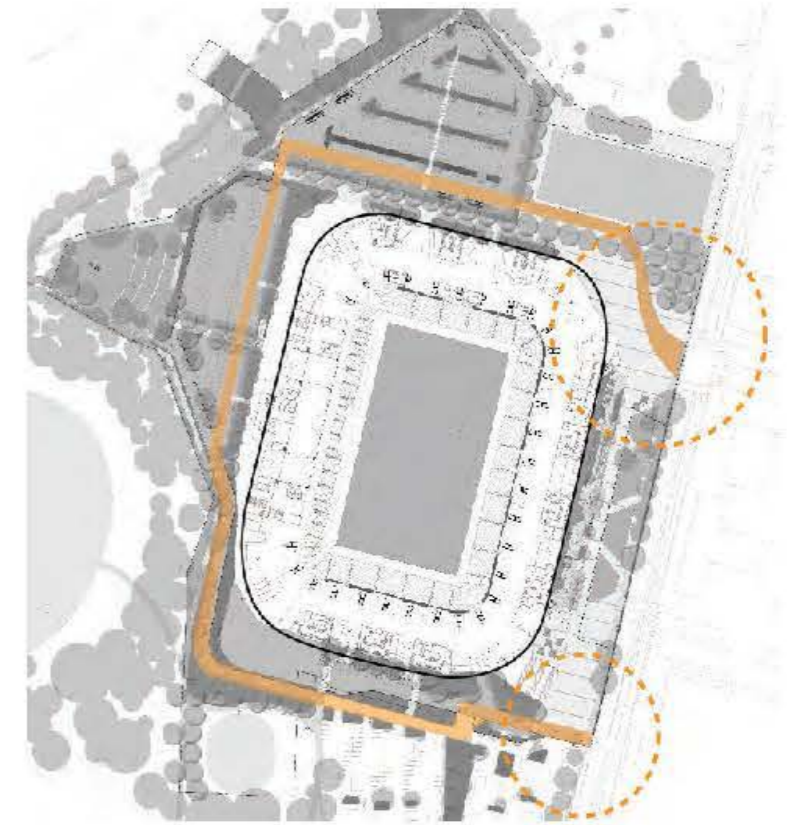

6.1.4 Ring Road: Stage 2 DA

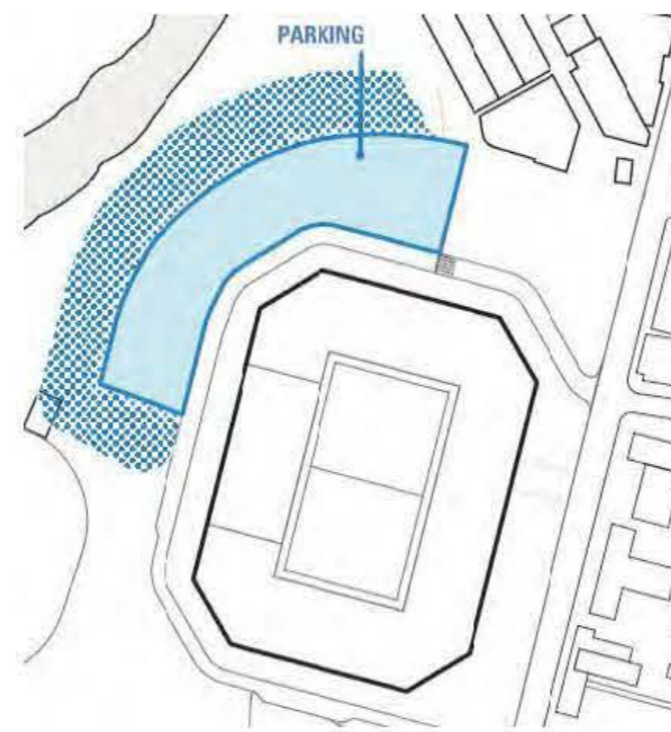

6.1.5 Parking: Stage 1 DA

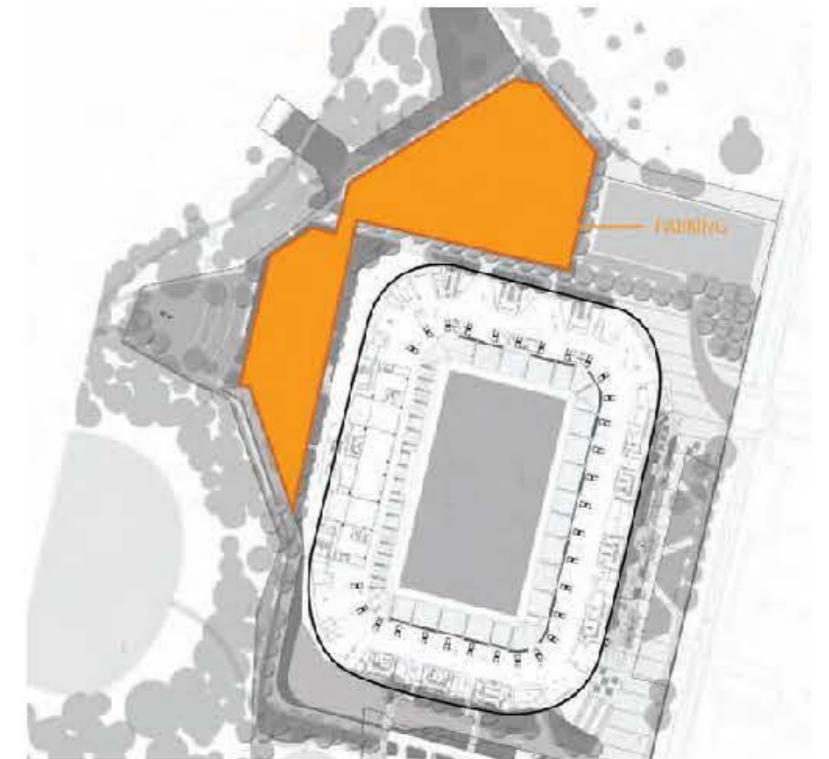

6.1.5 Parking: Stage 2 DA



6.2 Height & Massing from OGH: Stage 1 DA



6.2 Height & Massing from OGH: Stage 2 DA

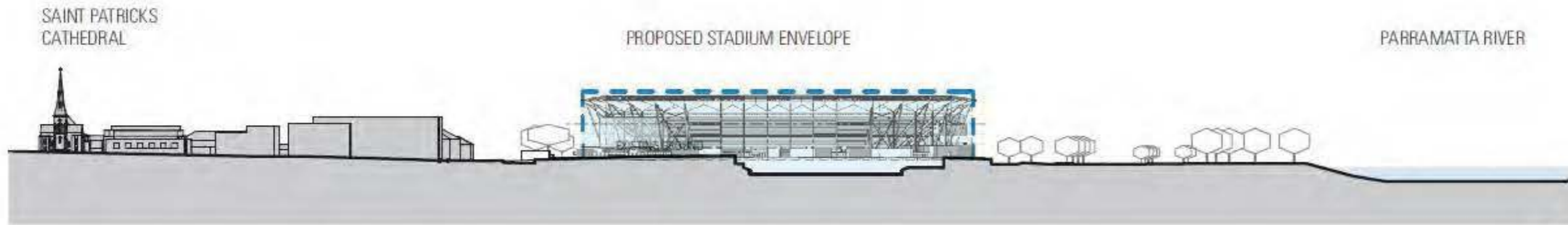

6.2 Massing

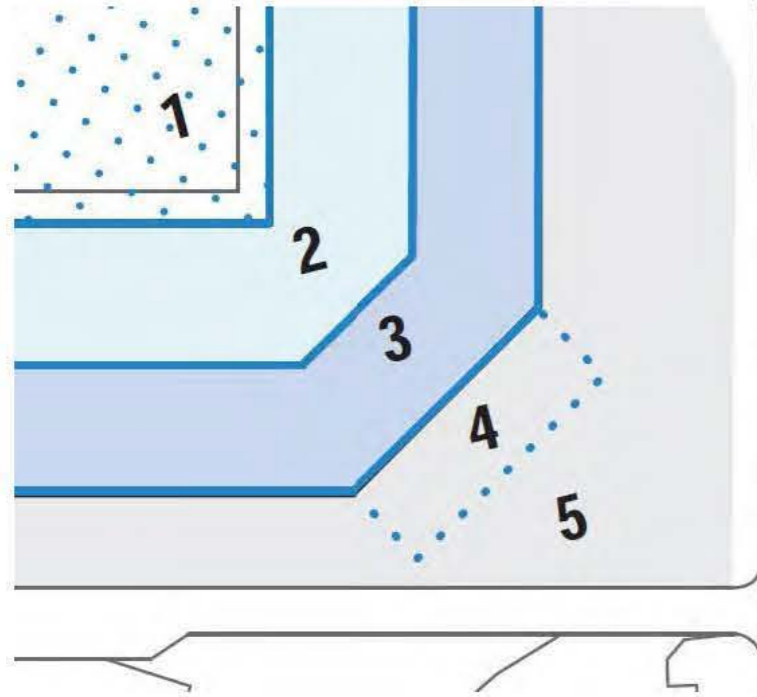

6.5 Security Zones: Stage 1 DA

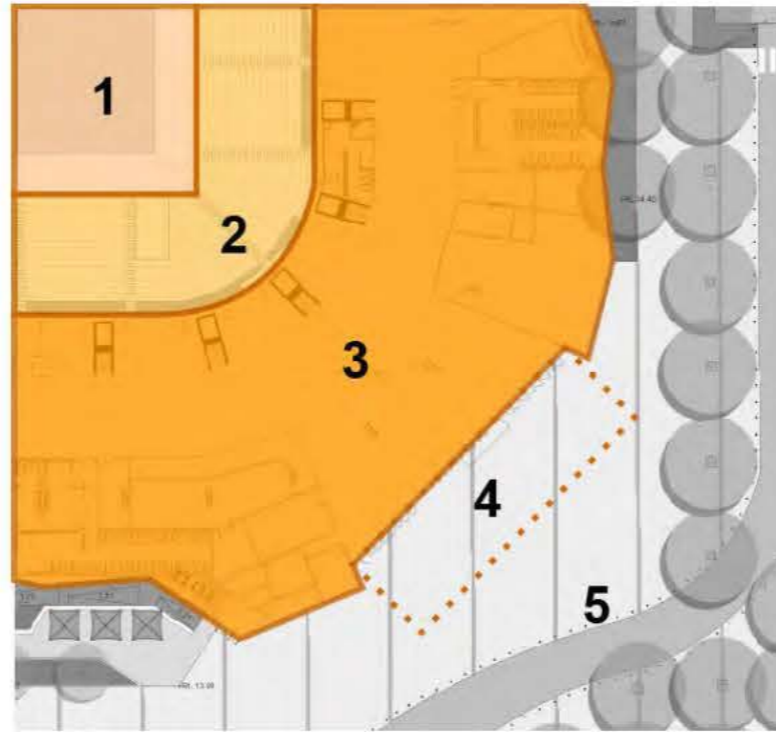

6.5 Security Zones: Stage 2 DA

- 1. Pitch/activity area
- 2. Spectator seating and standing area
- 3. Internal concourse
- 4. Circulation external to stadium structure separating it from the outer security line
- 5. Open space outside security line

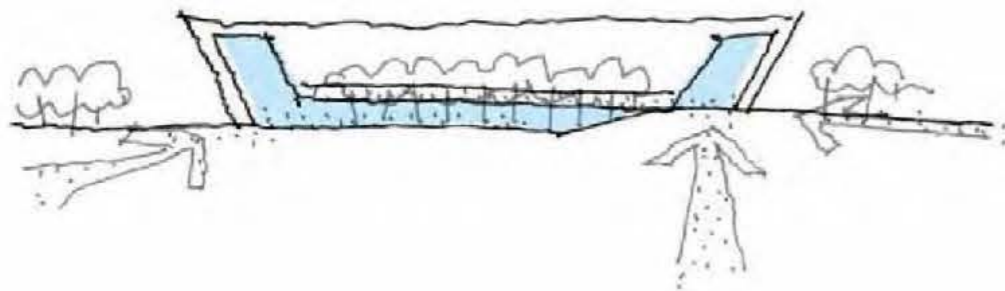

6.9.1 Landmark Opportunity: Stage 1 DA



6.9.1 Landmark Opportunity: Stage 2 DA

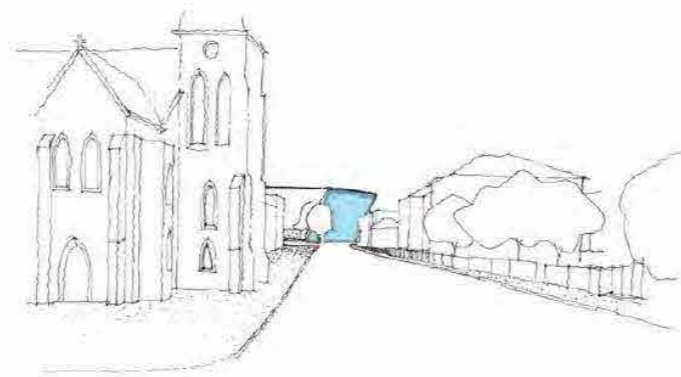

6.9.1 View Along Victoria St: Stage 1 DA



6.9.1 View Along Victoria St: Stage 2 DA

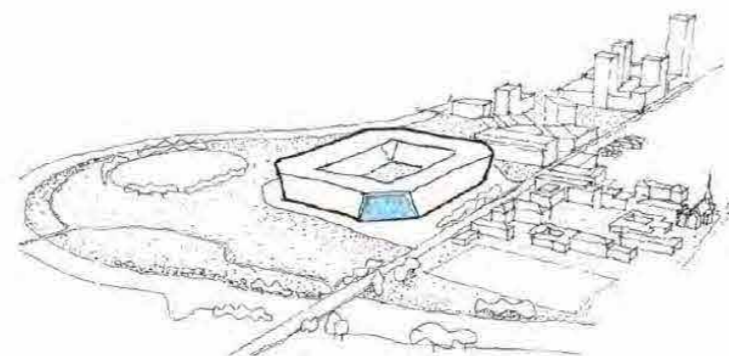

6.9.1 From CBD: Stage 1 DA



6.9.1 From CBD & O'Connell St. South: Stage 2 DA

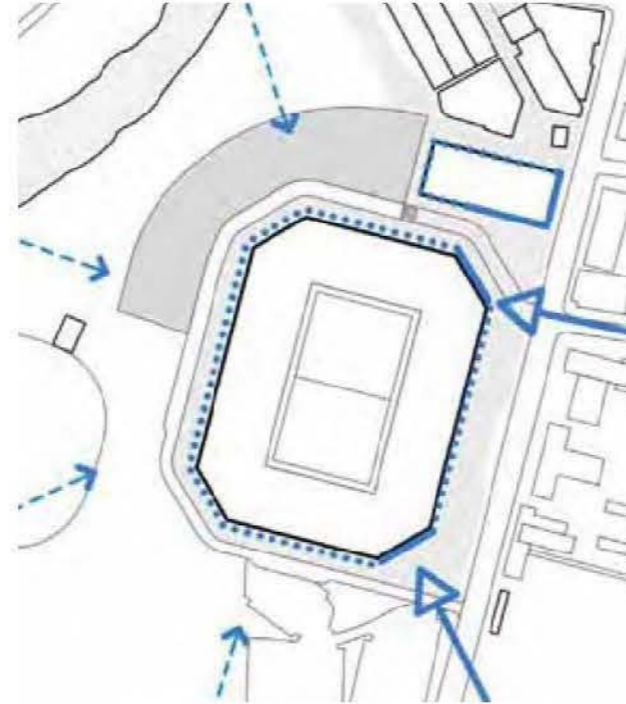

6.9.2 Dual Expression: Stage 1 DA



6.9.2 Expressive urban character of entrances: eastern facade



6.9.2 Respectful expression with muted colours and matt finishes: western facade

Material Guidelines

- External building materials must be muted in colour with matt finished to minimise contrast with the park surrounds and be complementary to its setting (Conservation Agreement - Parramatta DCP 2011)
- Reference local historical character
- Materiality and lighting at stadium entrance should contrast to the general stadium expression
- All lighting external to the stadium and visible from the park must be below the tree line
- Safe lighting of public domain to be obtained
- If possible utilise pitch lighting on leading edge of roof as opposed to pole mounted



6.9.3 Materiality and lighting of Stadium Entrance



6.9.3 Pitch lighting on leading edge of roof

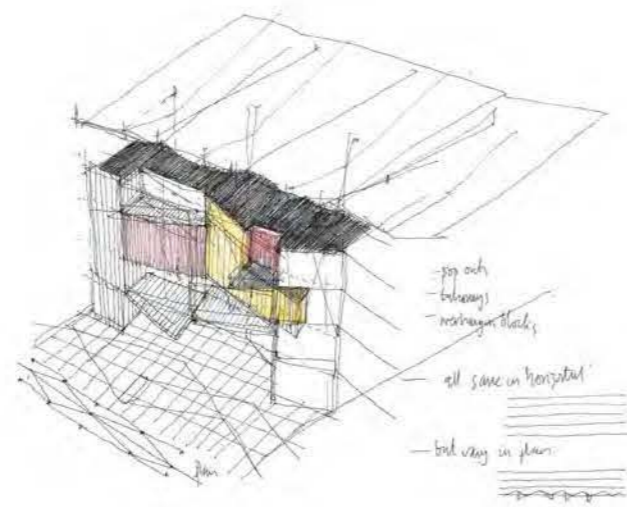

6.9.3 Building materials complementary to its park surrounds



6.9.3 Sydney's Historic Materiality Reference



6.9.3 Materials muted in colour with matt finishes



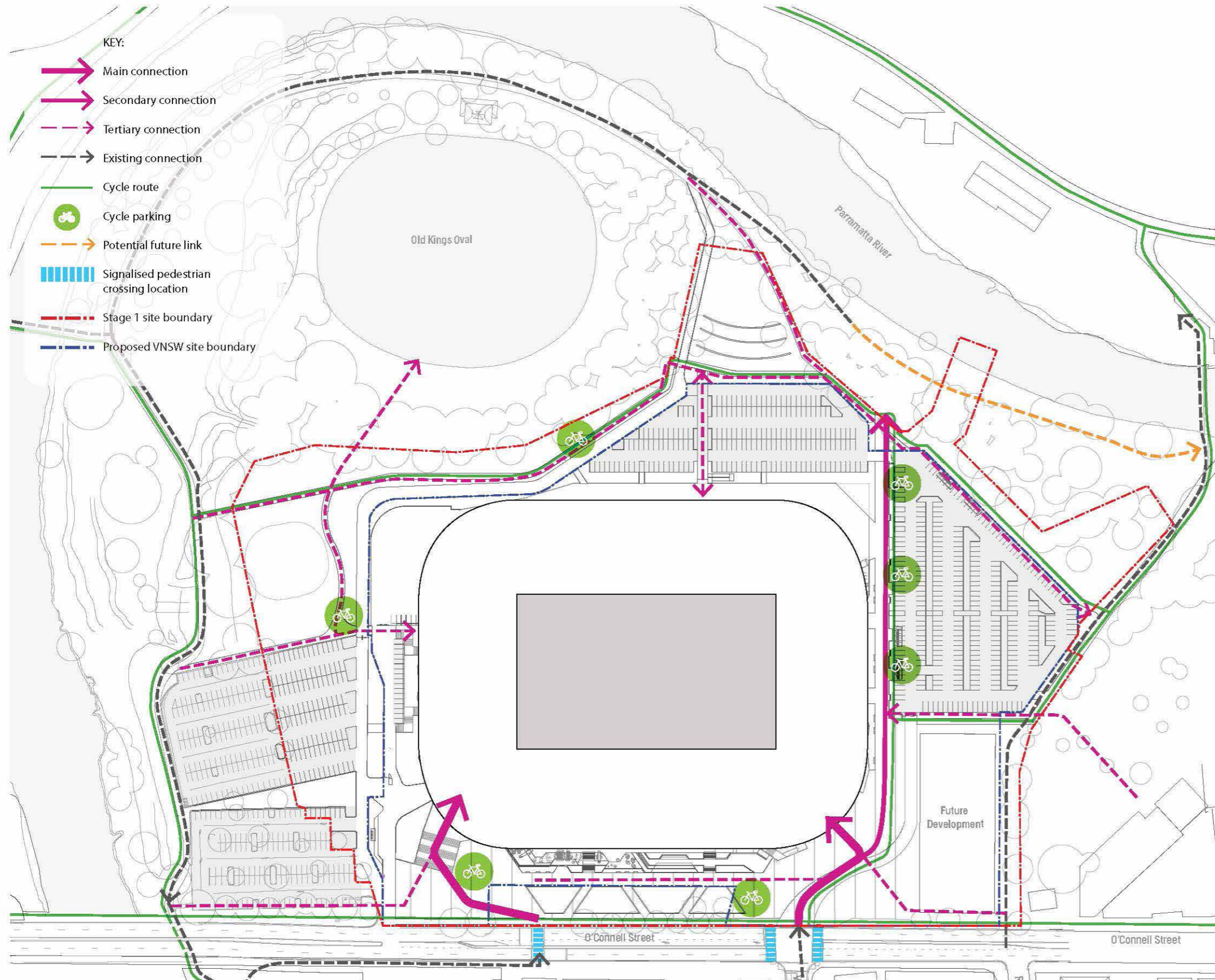

Pedestrian and bicycle circulation

Pedestrian

Pedestrian pathways have been designed to maximise permeability around the stadium. New path connections are integrated with the existing path network along the riverfront and across the river to 'The People's Loop' within Parramatta Park. The Boulevard of Legends provides a defined tree lined east west connection through the precinct, from O'Connell Street to the River.

Enhanced pedestrian connections include:

- DDA compliant access across the precinct where possible
- Increased amenities along paths including seats, water fountains and lighting
- Way-finding signage to direct users throughout the precinct

Cycle

Existing cycle connections will be maintained within the precinct with enhancements to include:

- Removal of on road cycle paths in lieu of off road paths
- Bicycle parking facilities for approximately 100 no. bicycles
- Increased lighting along paths

Pedestrian

Pedestrian arrival points primarily occur from the east at one of two entry plazas. The Northern Civic Plaza will provide the main entry to the precinct due to its proximity to the Victoria Road, the major connection to the CBD and train station. This entry will offer on-grade access to the concourse level.

A secondary arrival point is located in the south eastern corner of the stadium with stair and lift access up to concourse level. This entry will facilitate patron arriving from the southern carpark and the riverfront.

An away team supporter entry is located on the southern edge of the stadium in close proximity to the southern carpark.

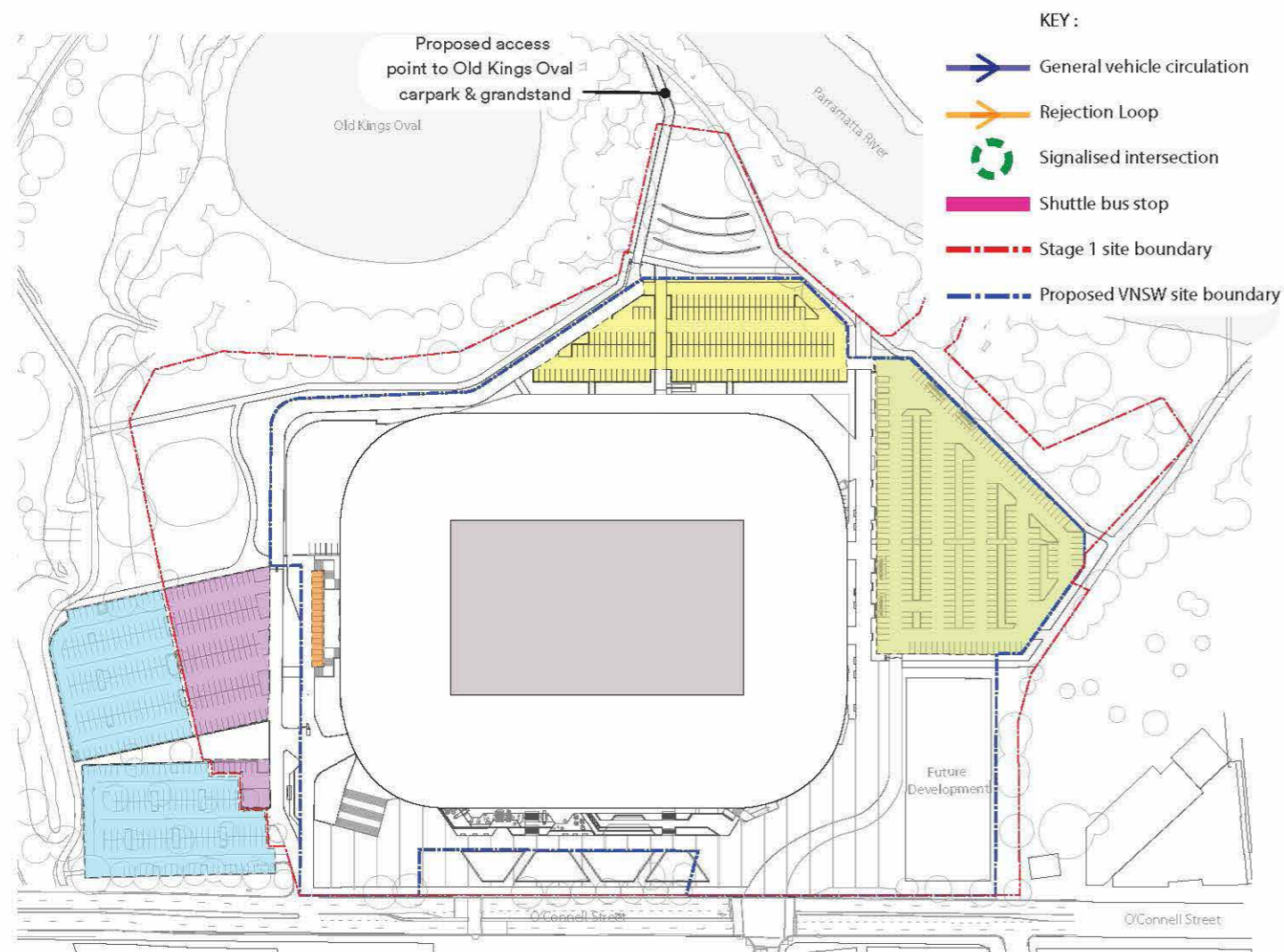

Vehicular access and circulation

Arrival Points

Vehicular access into the precinct will occur from two locations on O'Connell Street. The southern access point is located at the existing Southern Carpark driveway. It provides vehicular access to the Southern Carpark, the basement loading dock and around the south western corner of the Stadium to Old Kings Oval and the Western Carpark.

The northern access point uses the existing driveway at the O'Connell Street and Victoria Road intersection, providing access to the Northern and Western Carparks, and the VIP drop off zone. A gated check point at the entry to the Northern Carpark will form the secured arrival point for officials and VIP's entering.

Vehicular circulation

General vehicular circulation within the precinct is limited to accessing the carpark, loading docks and Old Kings Oval.

A dedicated, ramped access road around the north western edge of the stadium provides 360 degree access to the stadium, linking the Southern and Western carparks. Flexibility in the design of the Western carpark allows this space to be shut off to cars via gates for event overlays. In this instance both the Northern and Southern vehicular entries would be in used to access each carpark.

During event mode a managed solution will limit vehicular movement through the civic and southern plazas to and from the Northern and Southern Carparks one hour before and after an event. This will ensure vehicular and pedestrian conflict is limited as patrons enter, queue and leave the stadium.

Access to the Old Kings Oval is maintained via the service road which connects to the western and southern carparks.

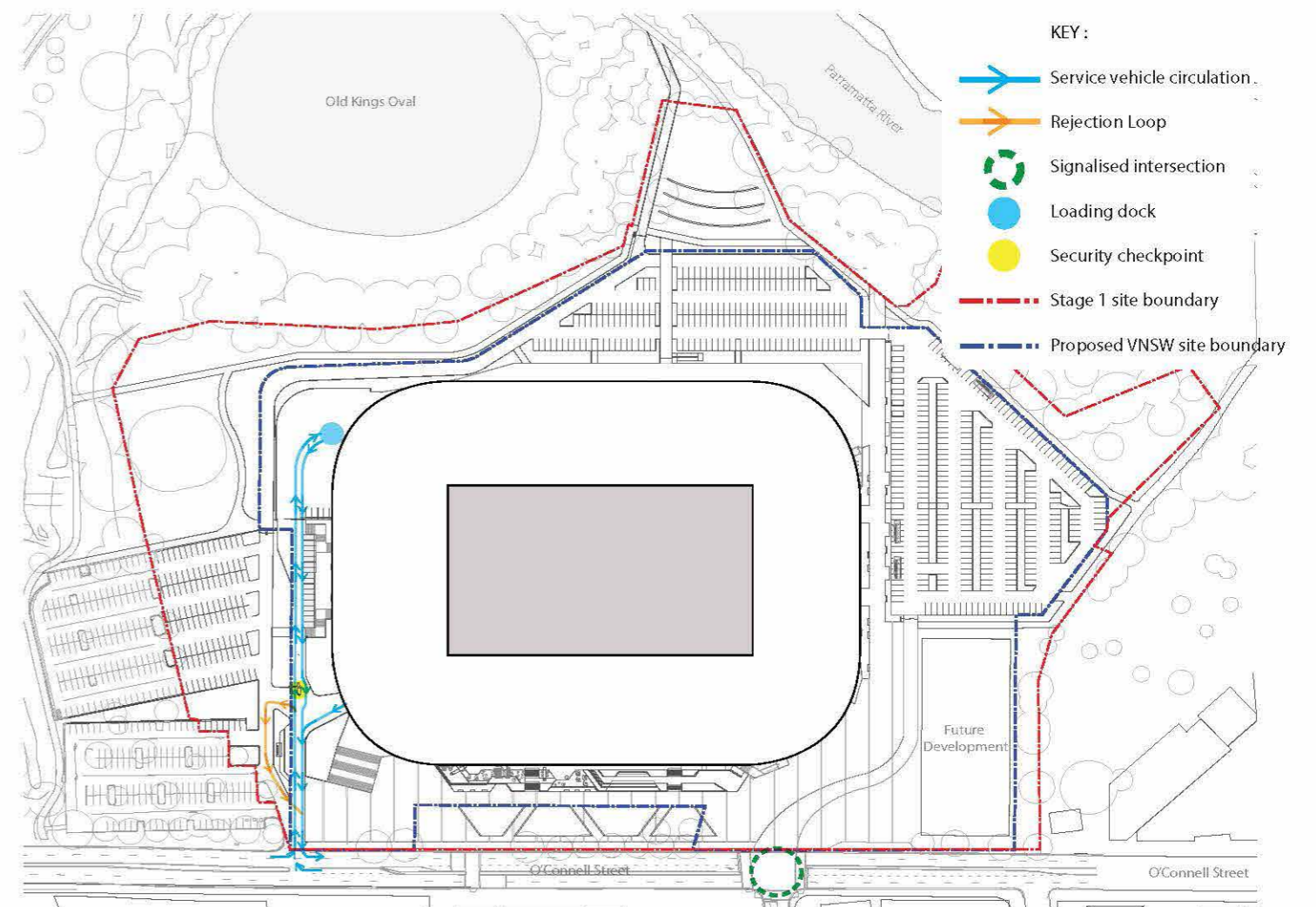

Service Vehicle Access

Access for to the stadium for service vehicles is through the southern entry and loading dock. The loading dock area has a controlled entry point, with a rejection loop to return vehicles incorrectly using this access path.

Two way access is allowed for service vehicles entering and leaving the loading dock area.

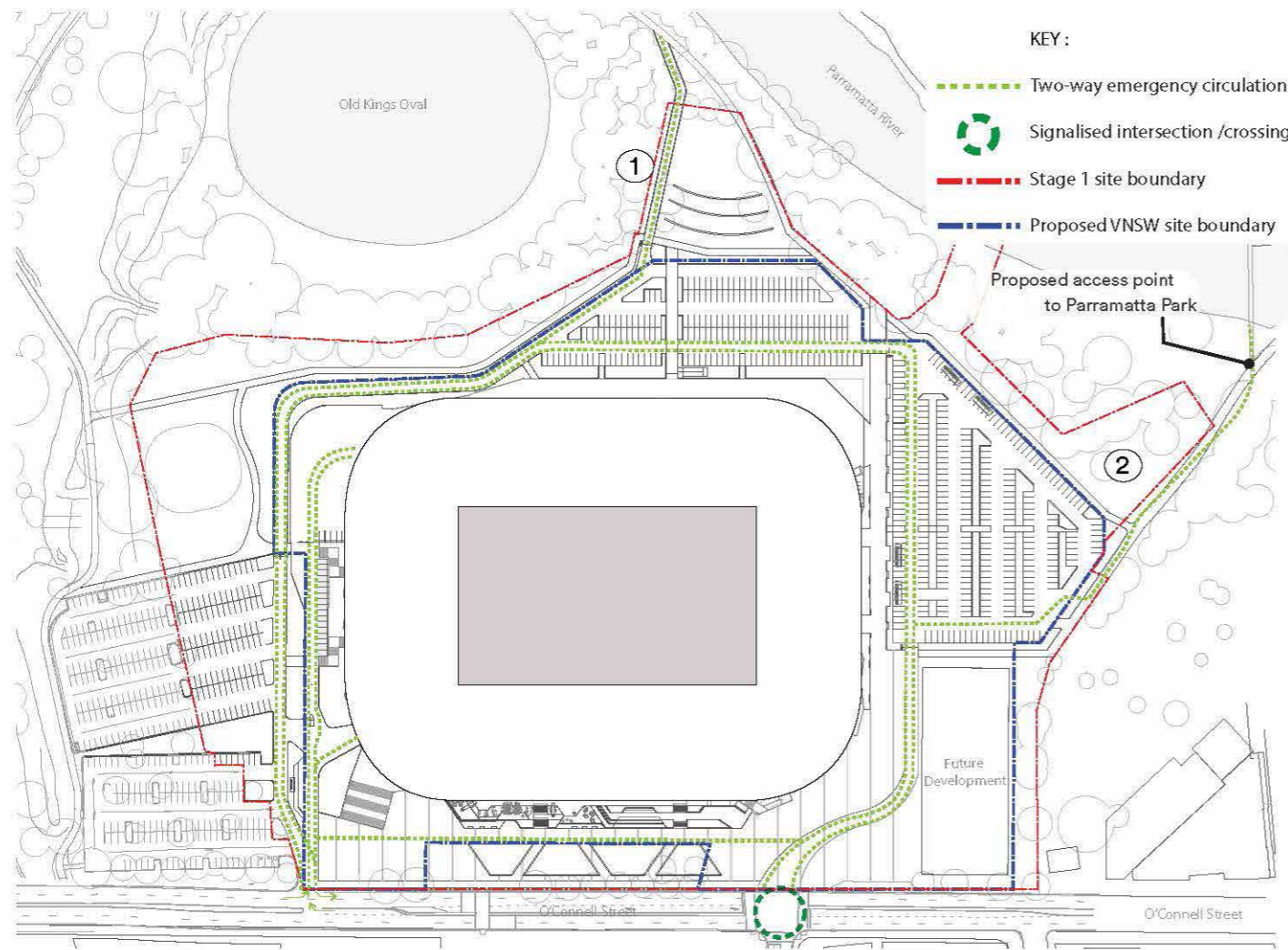

Emergency Vehicle Access

Access for emergency vehicles is through both the southern and northern entry points from O'Connell street. They have 360 degree access around the stadium via the Western carpark and ramped access road. Access for emergency vehicles into the stadium gained be gained through the southern entry and loading dock area.

In everyday mode, Old Kings Oval can be accessed by emergency vehicles using either entry, through the Western carpark or ramped access road (1)

Emergency vehicles access has also been maintained from the north of the site via Parramatta park (2)

Car Parking

A total of 500 carparking spaces including 4 coach parkings, spaces have been accommodated within the site over three carparks, accessed via O'Connell Street. An additional 350 carparking spaces sit to the south of the site within the Parramatta Parks Trust carpark.

Northern Carpark

The Northern carpark sits north of the stadium and west of the future development lot. It accommodates 297 parking spaces including four coach parking spaces, 7 disabled parking spaces and parking for emergency vehicles, PRUA (persons requiring Universal Access), the hirer, match officials and media personnel. Planted swales located between parking aisles collect and filter excess stormwater from the carpark prior to release in the river. Native trees are planted within the swales, offering shade to cooling the carpark whilst providing a green outlook.

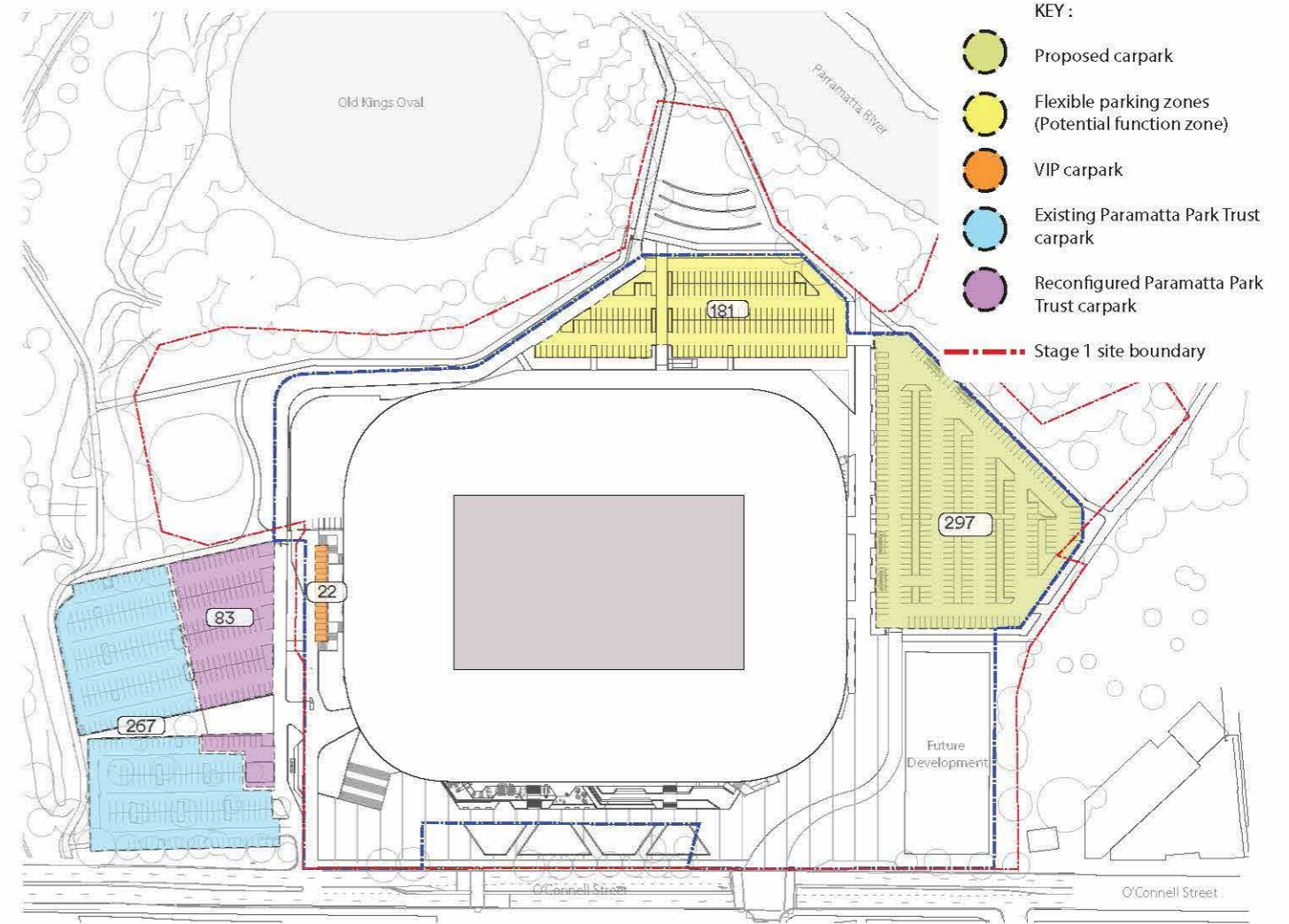

Western Carpark

The Western Carpark is an intermediate terrace to the west of the stadium concourse. The carpark is paved with asphalt and decorative concrete banding providing 181 parking spaces as well as a VIP drop off. During major events this carpark has the ability to be gated off to enable an overlay of events to occur such as markets, outdoor functions and game day events. A generous tree lined path through this carpark offers pedestrian connections from the stadium concourse to the River Terraces.

Southern Carpark

The Southern Carpark comprises 267 retained parking spaces as part of the original Parramatta Park Trust carpark, accompanied by an additional 83 new parking spaces within a reconfigured arrangement to achieve a total of 350 parking spaces. This carpark retains a number of existing mature trees where possible in turf verges.

VIP Parking

An additional 22 parking spaces are located within the loading dock. These spaces are reserved for use by VIPs.